



US00D903580S

(12) **United States Design Patent** (10) **Patent No.:** **US D903,580 S**  
**Austin** (45) **Date of Patent:** **\*\* Dec. 1, 2020**

(54) **VEHICLE ROOF**

(71) Applicant: **Jaguar Land Rover Limited**, Coventry (GB)

(72) Inventor: **Robin Austin**, Coventry (GB)

(73) Assignee: **Jaguar Land Rover Limited**, Coventry (GB)

(\*\*) Term: **15 Years**

(21) Appl. No.: **29/706,096**

(22) Filed: **Sep. 18, 2019**

**Related U.S. Application Data**

(62) Division of application No. 29/591,418, filed on Jan. 19, 2017, now Pat. No. Des. 865,641.

(30) **Foreign Application Priority Data**

Jul. 20, 2016 (EM) ..... 003313477-0004

Jul. 20, 2016 (EM) ..... 003313477-0005

Jul. 20, 2016 (EM) ..... 003313477-0006

(51) **LOC (12) Cl.** ..... **12-16**

(52) **U.S. Cl.**  
USPC ..... **D12/404**

(58) **Field of Classification Search**  
USPC ..... D12/401-405; D6/610, 611, 596,  
D6/601-603, 615, 617, 621; D7/332,  
D7/334-337

(Continued)

(56) **References Cited**

**U.S. PATENT DOCUMENTS**

D678,173 S \* 3/2013 McIntire ..... D12/401

D686,136 S \* 7/2013 Galley ..... D12/401

(Continued)

*Primary Examiner* — Katrina A Betton

(74) *Attorney, Agent, or Firm* — Wood Herron & Evans LLP

(57) **CLAIM**

The ornamental design for a vehicle roof, as shown and described.

**DESCRIPTION**

FIG. 1 is a left side elevated view of a vehicle roof according to the present invention.

FIG. 2 is a bottom right perspective view of the roof shown in FIG. 1.

FIG. 3 is a front right perspective view thereof, from below.

FIG. 4 is a rear right perspective view thereof, from below.

FIG. 5 is a rear view thereof.

FIG. 6 is a top view thereof.

FIG. 7 is another top view showing the vehicle roof of FIGS. 1-6, but with the vehicle roof mounted on a vehicle shown in de-emphasized and half-tone portions so as to illustrate environmental structure. These portions form no part of the claimed design. More particularly, in FIG. 7 the inventive vehicle roof is shown within the broken line, and any elements shown outside the broken line form no part of the claimed design, but are instead included to show environmental aspects thereof.

FIG. 8 is a front left perspective view of a vehicle roof according to an alternative embodiment of the present invention.

FIG. 9 is a rear left perspective view of the roof shown in FIG. 8.

FIG. 10 is a rear right perspective view thereof, from below.

FIG. 11 is a front right perspective view thereof, from below.

FIG. 12 is left side elevated view thereof.

FIG. 13 is a right side elevated view thereof.

FIG. 14 is a front view thereof.

FIG. 15 is a rear view thereof.

FIG. 16 is a top view thereof; and,

FIG. 17 is another top view showing the vehicle roof of FIGS. 8-16, but with the vehicle roof mounted on a vehicle shown in de-emphasized and half-tone portions so as to illustrate environmental structure. These portions form no part of the claimed design. More particularly, in FIG. 17 the inventive vehicle roof is shown within the broken line, and

(Continued)

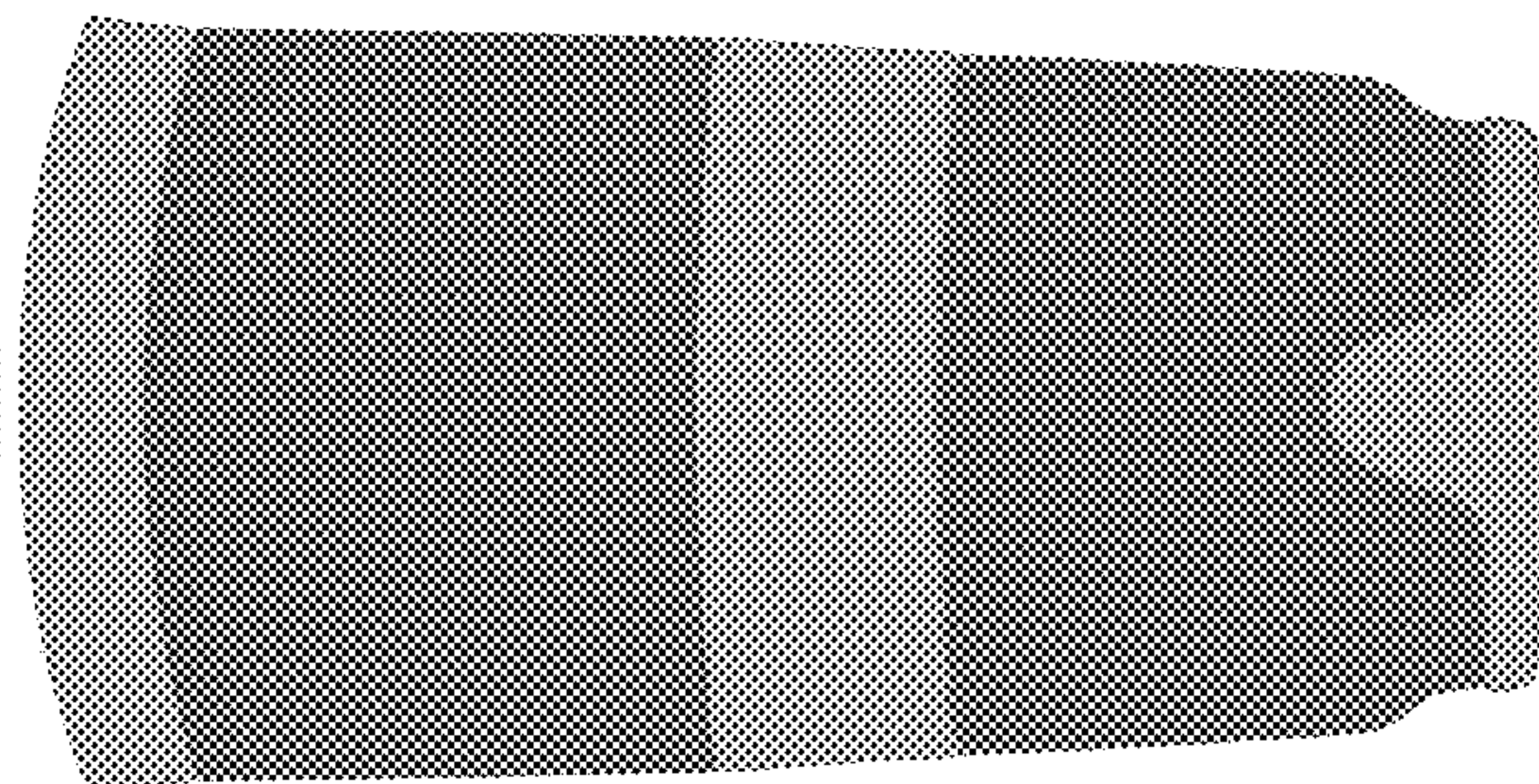
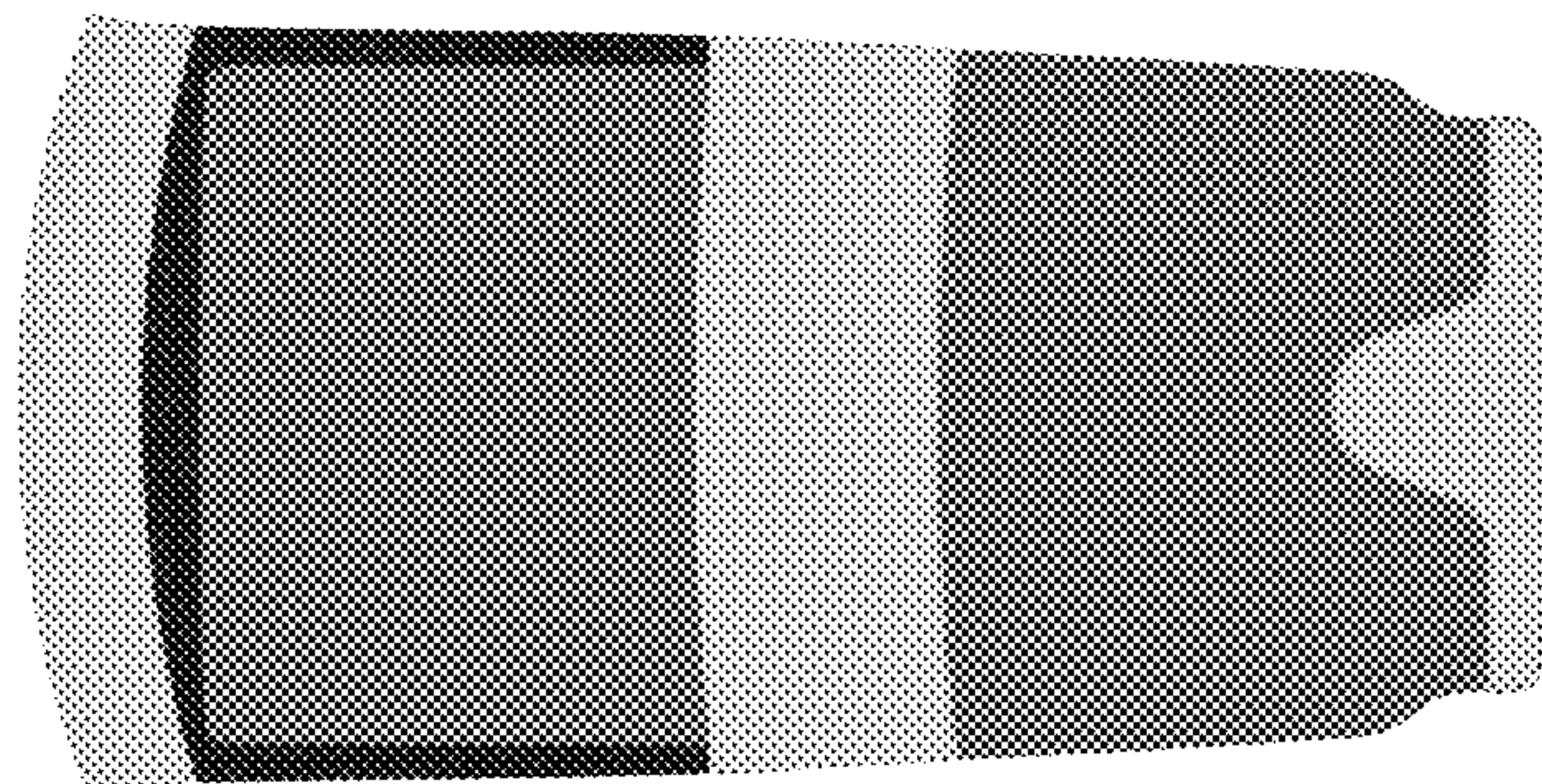

any elements shown outside the broken line form no part of the claimed design, but are instead included to show environmental aspects thereof.

**1 Claim, 14 Drawing Sheets**

(58) **Field of Classification Search**

CPC ..... B65D 85/68; B65D 31/16; B65D 33/02;  
B60R 5/04; B60R 5/045; B60P 7/04

See application file for complete search history.

(56) **References Cited**

U.S. PATENT DOCUMENTS

D776,601 S *	1/2017	McDonald, II	.....	D12/401
D785,542 S *	5/2017	Patel	.....	D12/404
D786,173 S *	5/2017	Peat	.....	D12/404
D803,141 S *	11/2017	Peat	.....	D12/401
D829,635 S *	10/2018	Verachtert	.....	D12/404
D864,310 S *	10/2019	Jens Christensen	.....	D21/562
D865,641 S *	11/2019	Austin	.....	D12/401
2007/0182217 A1 *	8/2007	Saleen	.....	B62D 25/06 296/215
2010/0045075 A1 *	2/2010	Mack	.....	B62D 27/026 296/215
2013/0257108 A1 *	10/2013	Sugimoto	.....	B60J 7/0007 296/214

\* cited by examiner



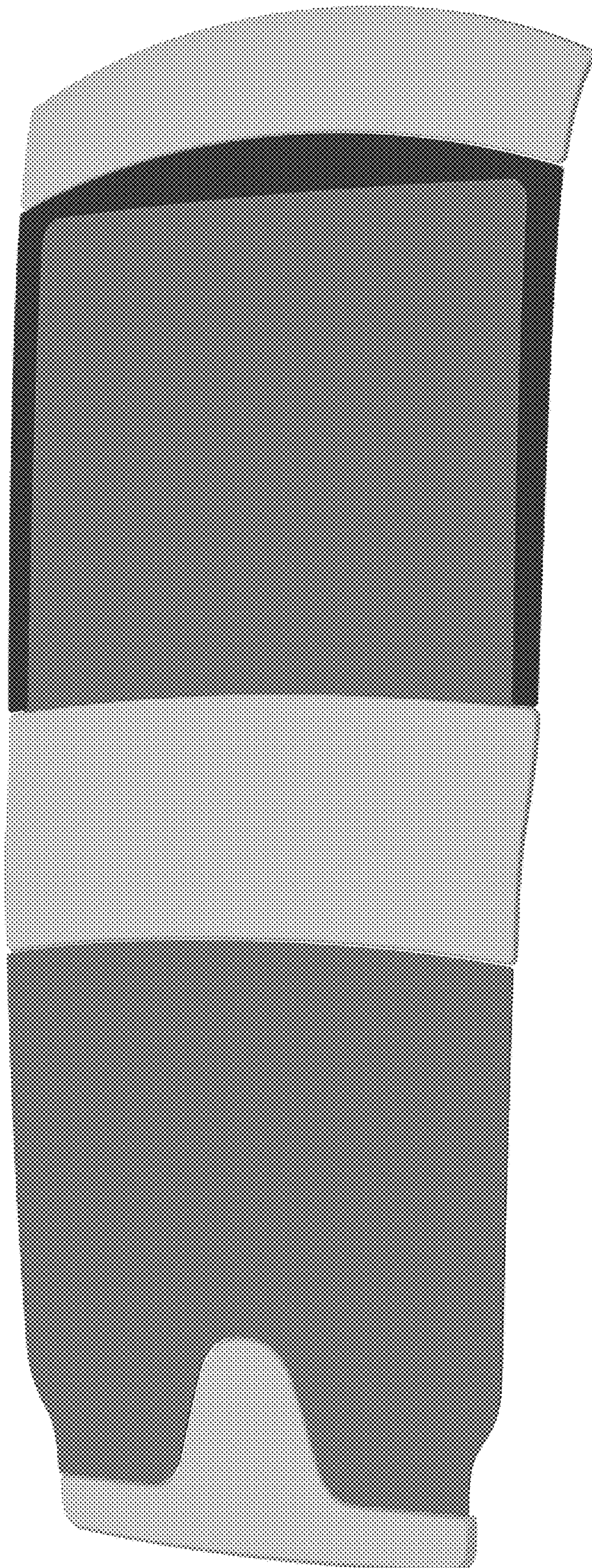

FIG. 1



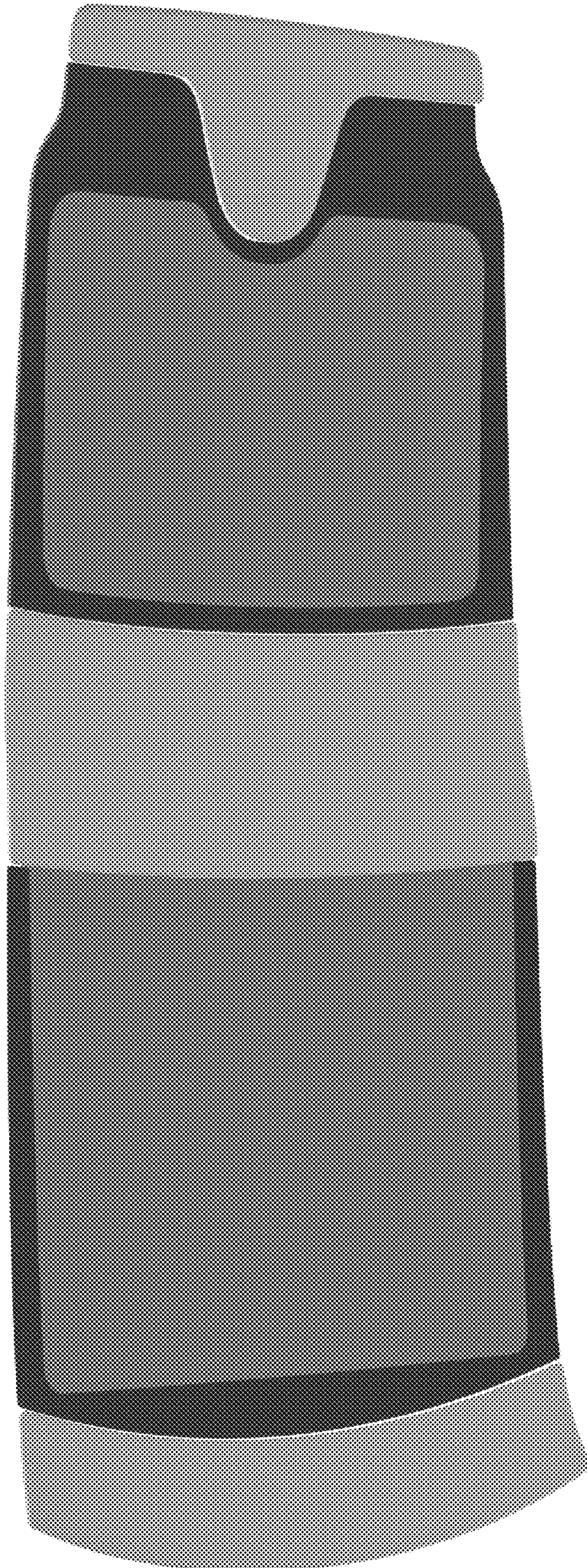

FIG. 2



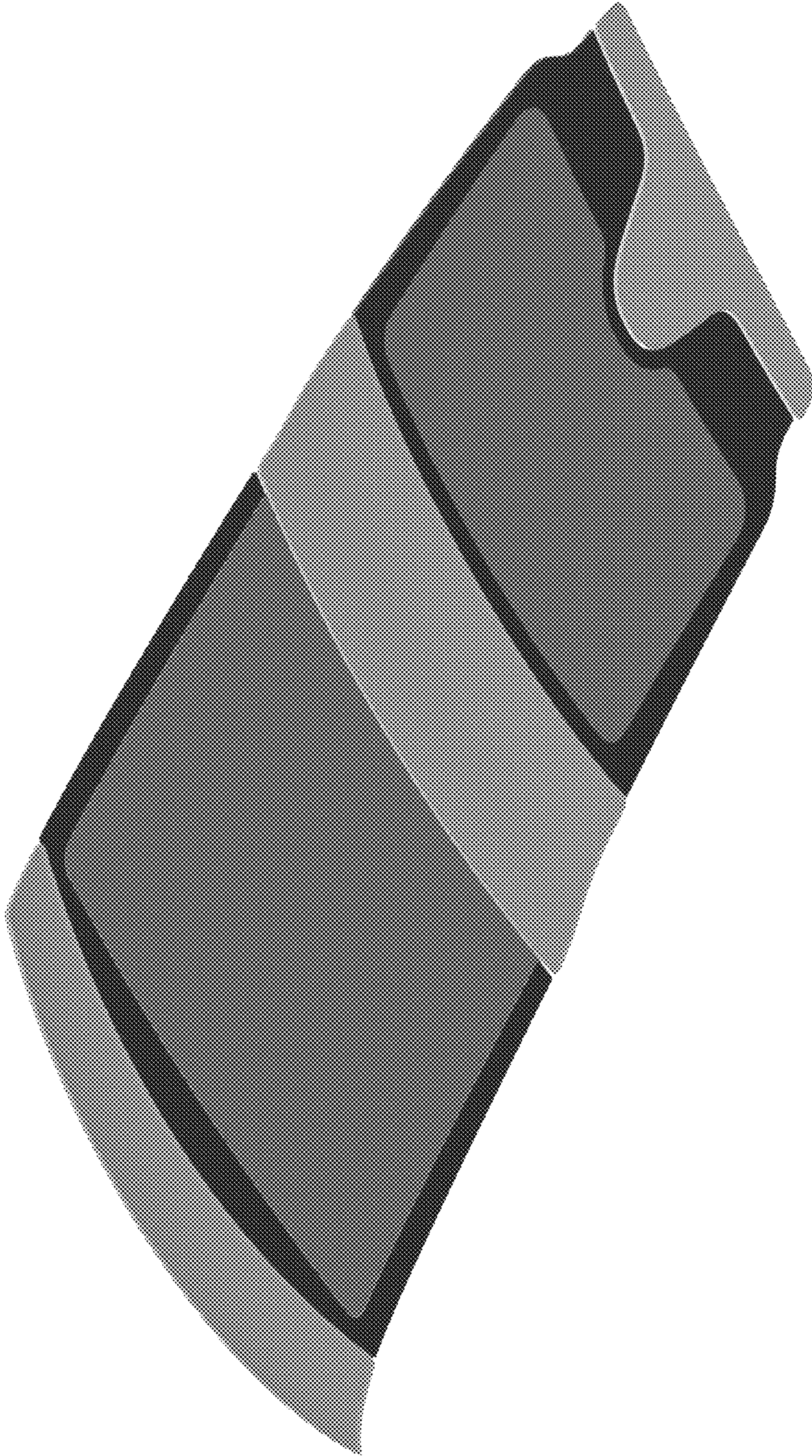

FIG. 3



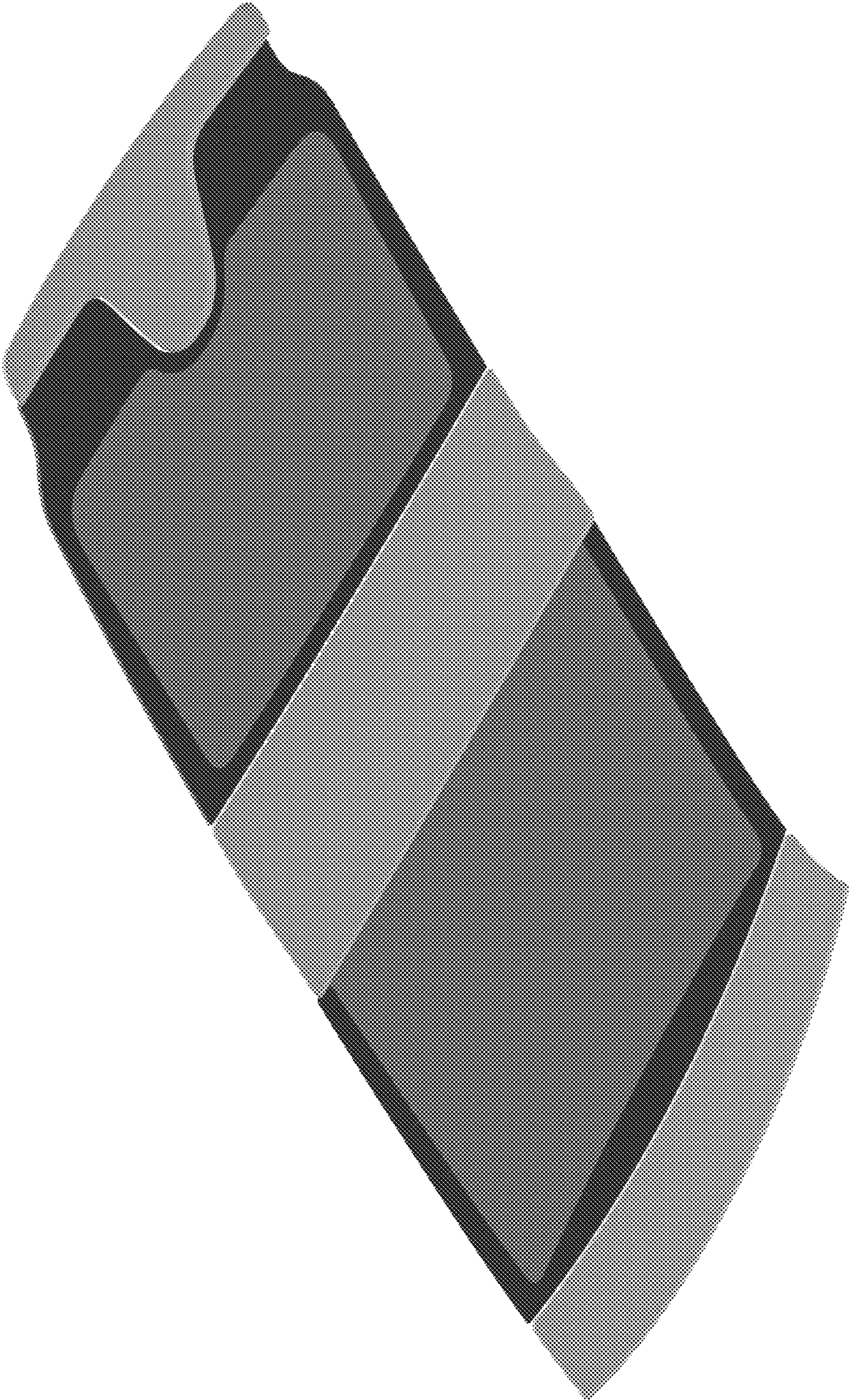

FIG. 4



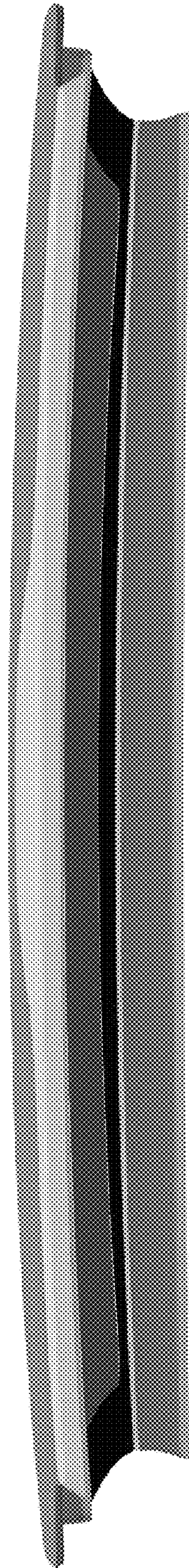

FIG. 5



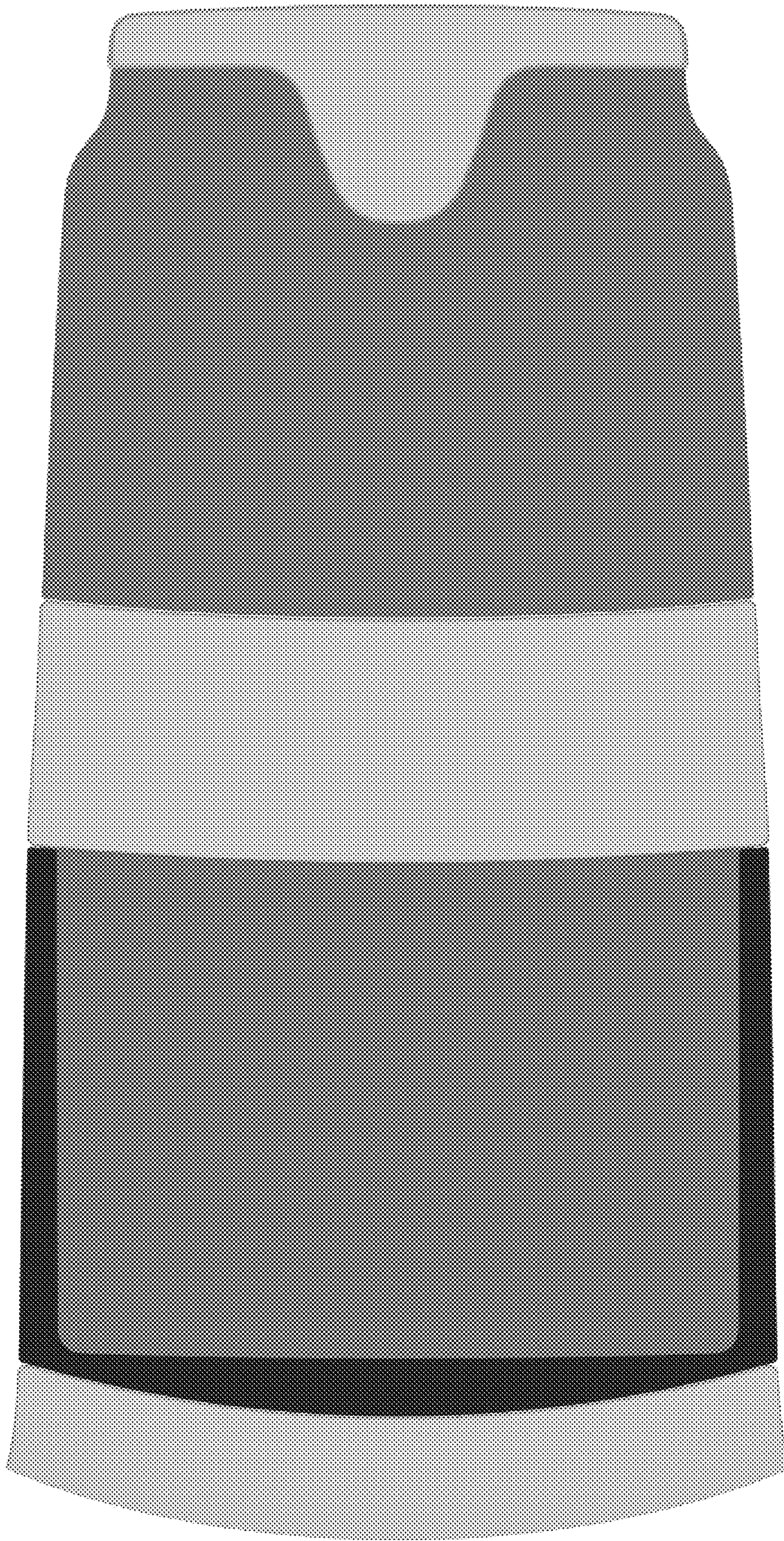

FIG. 6



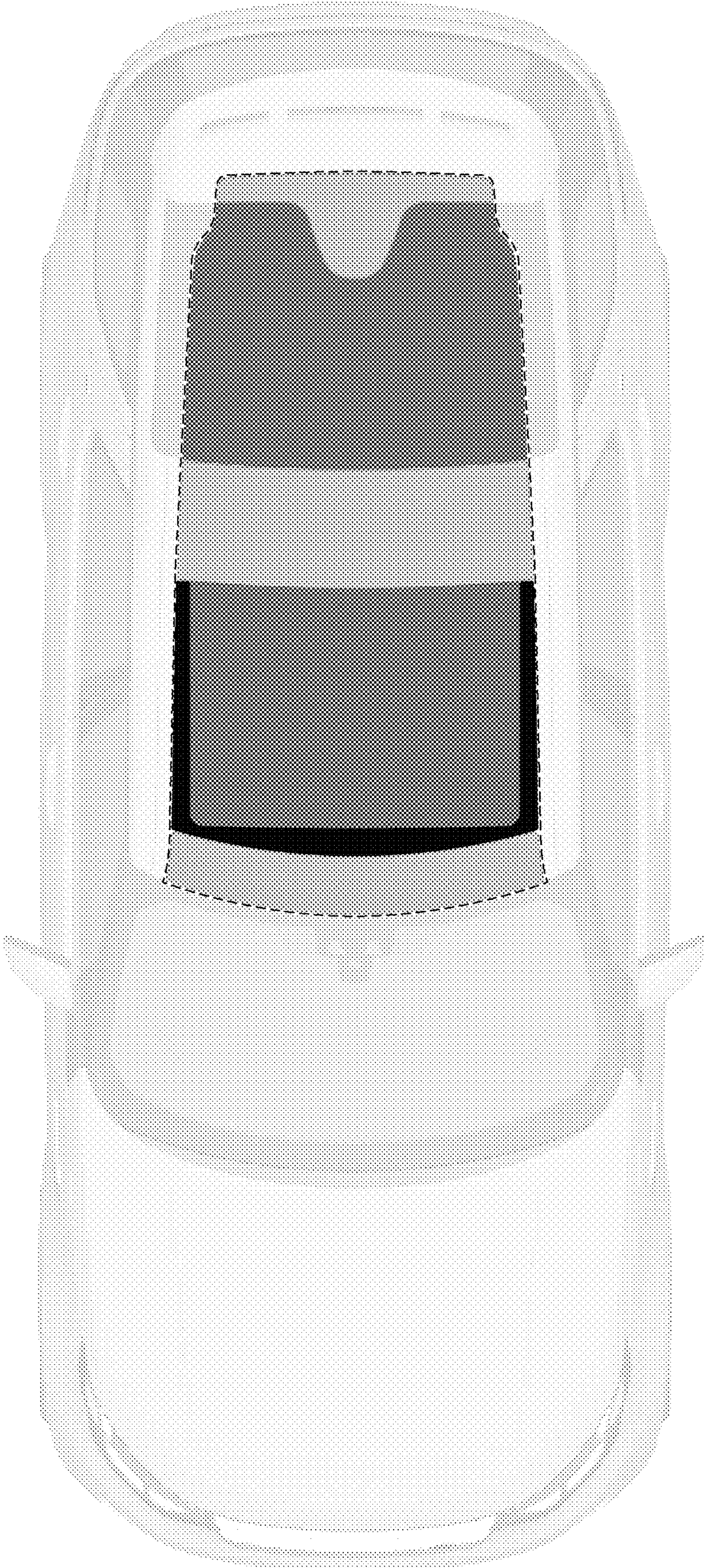

FIG. 7



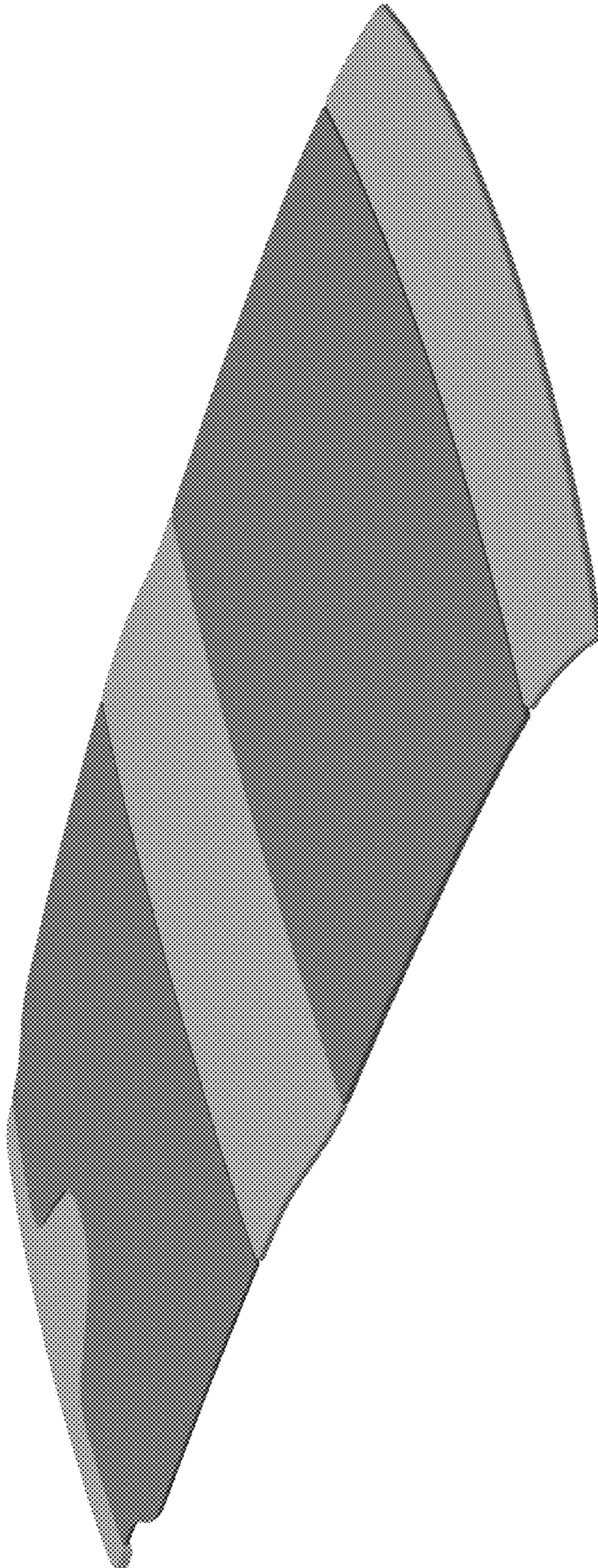

FIG. 8



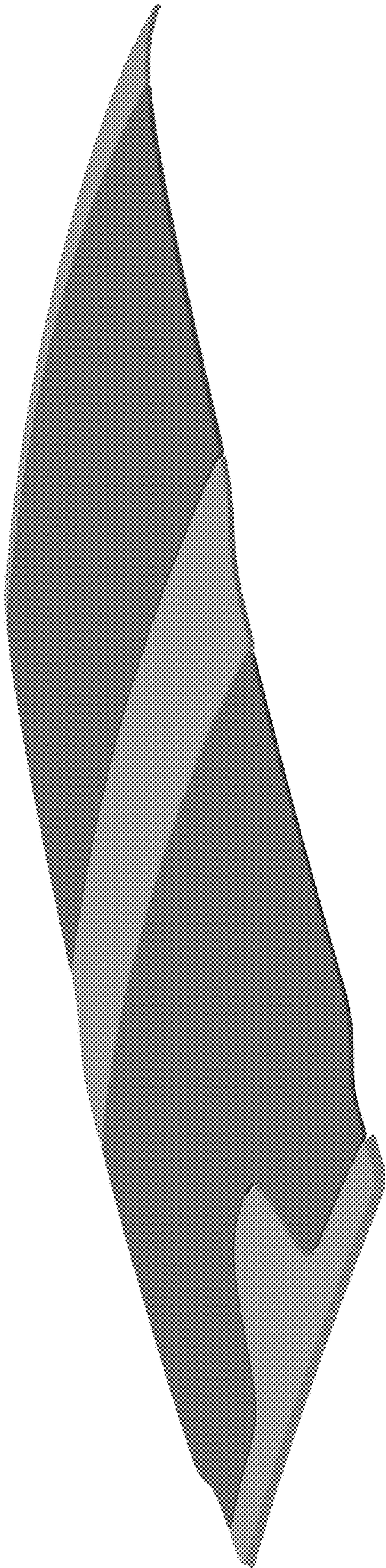

FIG. 9

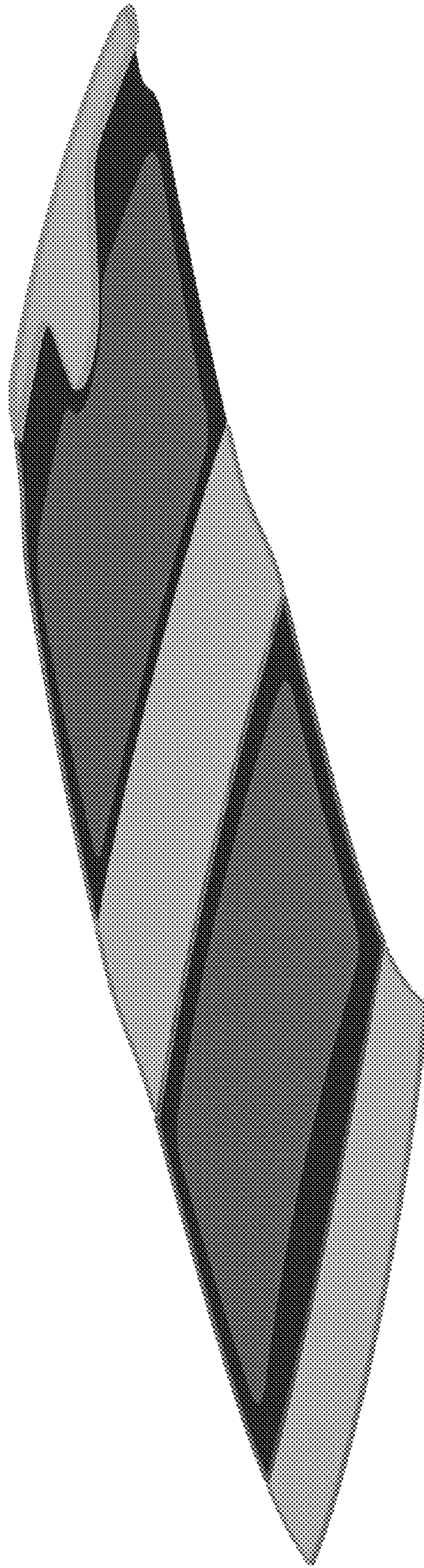

FIG. 10



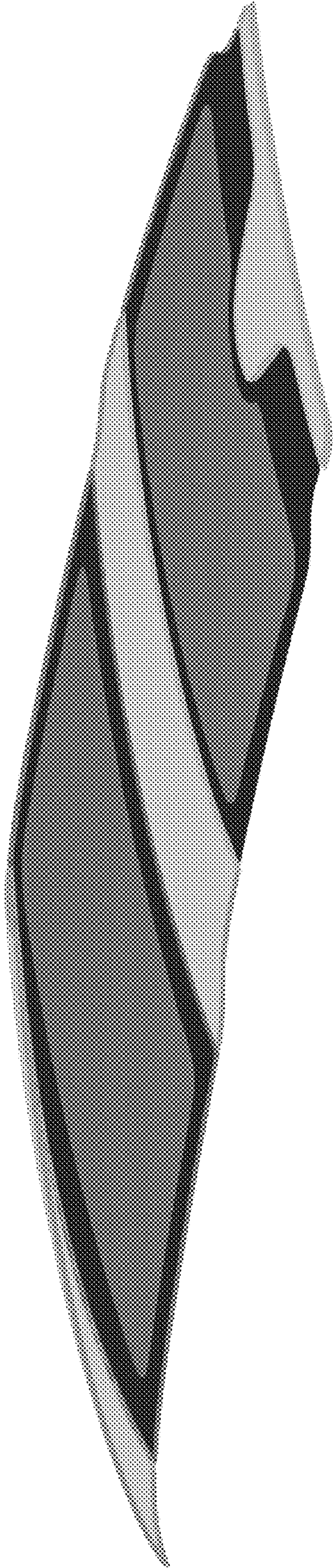

FIG. 11

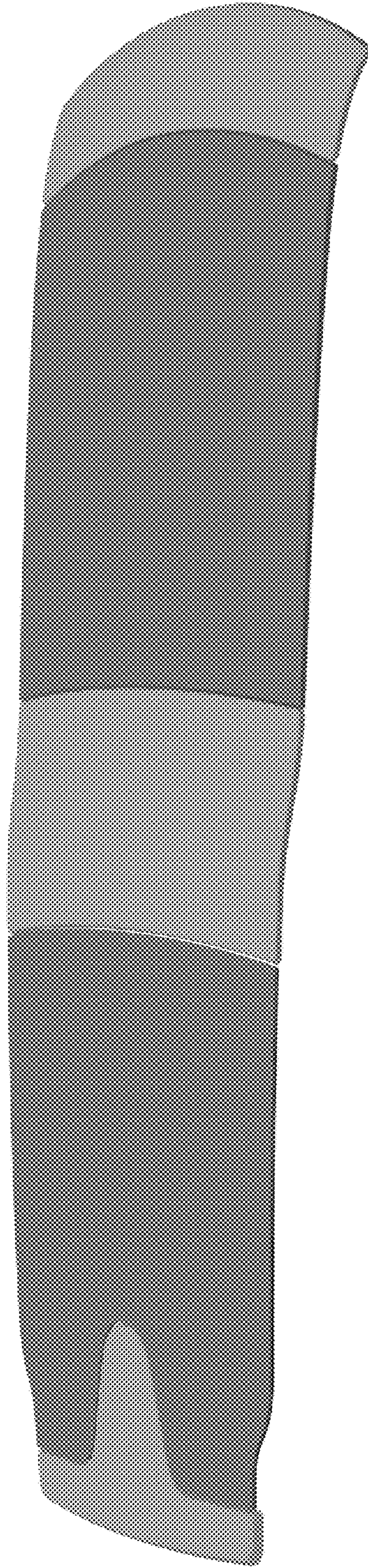

FIG. 12



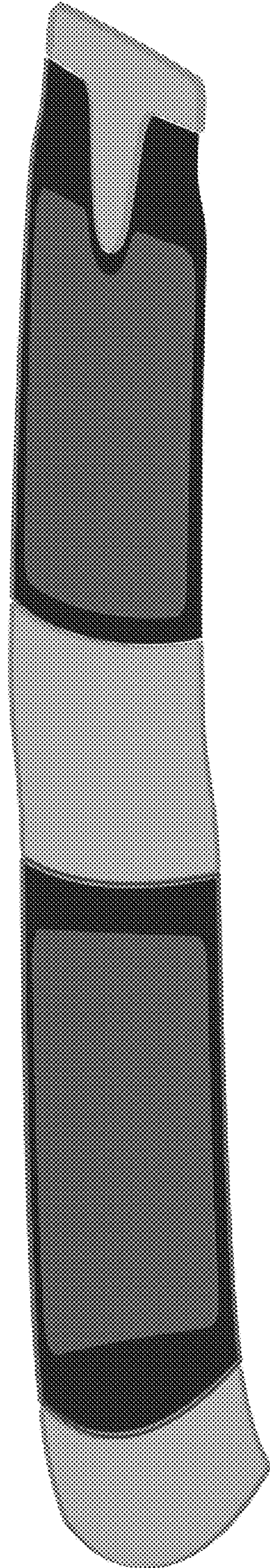

FIG. 13



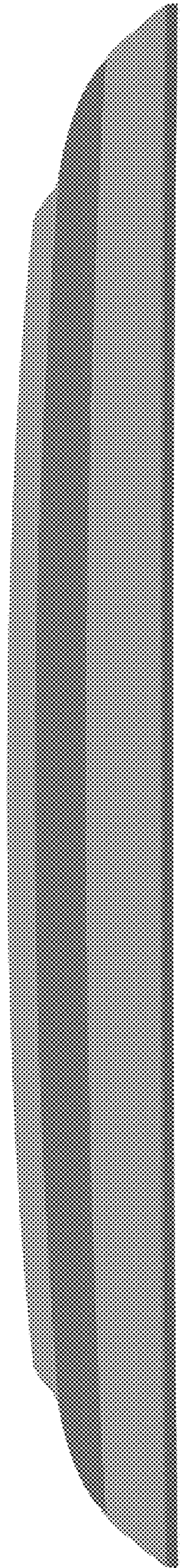

FIG. 14

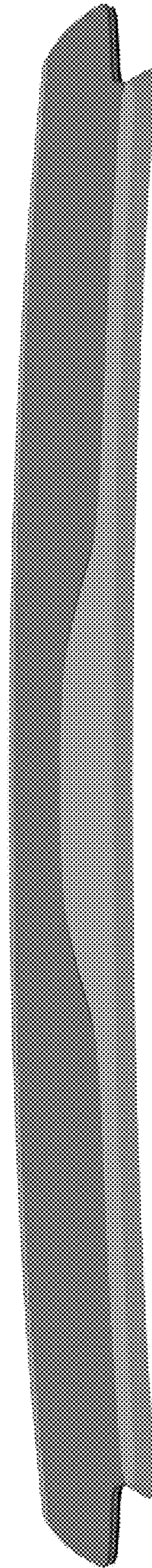

FIG. 15



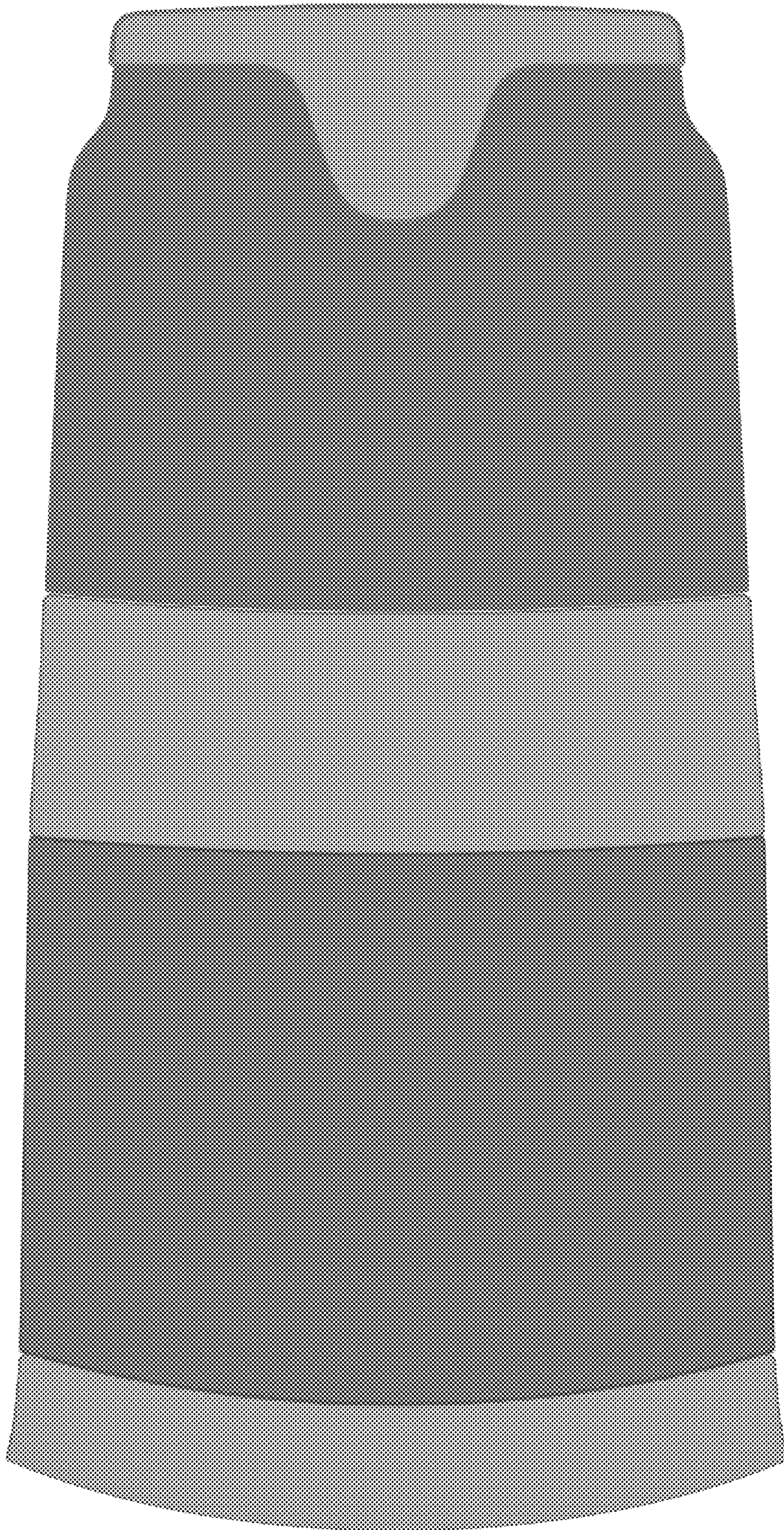

FIG. 16



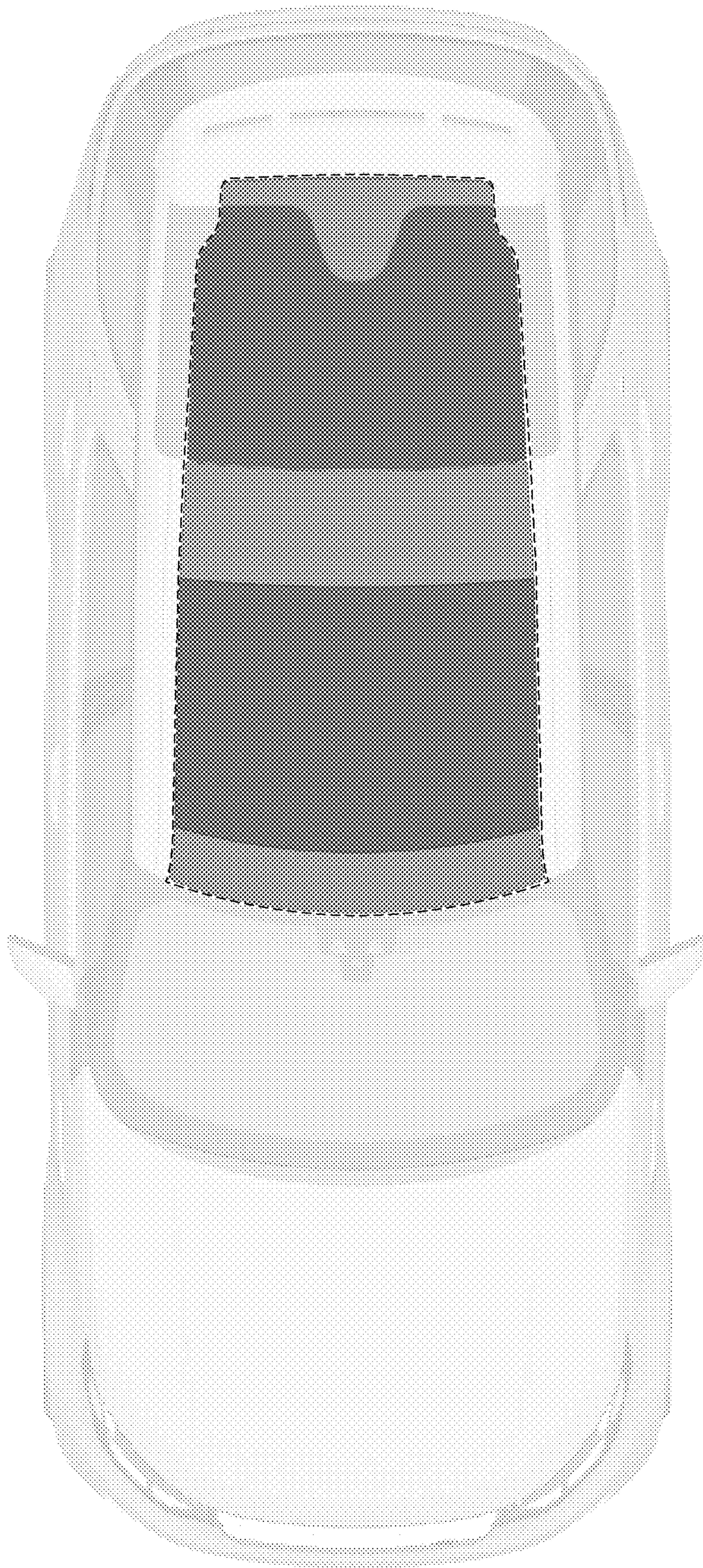

FIG. 17