



US00D902087S

(12) **United States Design Patent**
Kuehne et al.

(10) **Patent No.:** **US D902,087 S**

(45) **Date of Patent:** **** Nov. 17, 2020**

(54) **ELECTRIC VEHICLE POWER UNIT**

(71) Applicant: **Harley-Davidson Motor Company Group, LLC, Milwaukee, WI (US)**

(72) Inventors: **Tyler Kuehne, Milwaukee, WI (US); Michael Decaluwe, Jackson, WI (US); Casey Ketterhagen, Hartland, WI (US); Samuel N. Reiting, Wauwatosa, WI (US); Ben McGinley, Glendale, WI (US)**

(73) Assignee: **Harley-Davidson Motor Company Group, LLC, Milwaukee, WI (US)**

(**) Term: **15 Years**

(21) Appl. No.: **29/691,270**

(22) Filed: **May 15, 2019**

(51) **LOC (12) Cl.** **12-11**

(52) **U.S. Cl.**
USPC **D12/126**

(58) **Field of Classification Search**
USPC D12/114, 126, 179, 180, 207, 208;
D15/5; D23/364, 365
CPC ... B60B 7/0026; B60B 7/061; F16D 65/0081;
F16D 65/00; F02M 35/02; F02M 35/024;
B62M 7/04; B62K 11/04; B60K 13/02;
B60K 13/00

See application file for complete search history.

(56) **References Cited**

U.S. PATENT DOCUMENTS

D200,286 S * 2/1965 Ryan D21/528
D203,146 S * 12/1965 Ryan D12/108
D203,492 S * 1/1966 Nault D12/114
3,875,696 A * 4/1975 Howland A63H 17/34
446/404
D267,472 S * 1/1983 Kanemitsu D8/360
4,396,085 A * 8/1983 Inoue F02B 67/10
180/219
D279,376 S * 6/1985 Davidson D15/5

D319,040 S * 8/1991 Evans D12/180
D348,036 S * 6/1994 Rossigno D12/180
D348,676 S * 7/1994 Fuller D15/5
D364,129 S * 11/1995 Davidson D12/126
D367,021 S * 2/1996 Camfield D12/114

(Continued)

OTHER PUBLICATIONS

Harley Davidson, "CES 2019:Harley-Davidson New Concepts and Livewire Motorcycle", Webpage: <https://www.totalmotorcycle.com/ces-2019-harley-davidson-electrifies-the-future-with-new-concepts-and-livewire-motorcycle/>, May 9, 2019.

(Continued)

Primary Examiner — Darlington Ly

(74) *Attorney, Agent, or Firm* — Michael Best & Friedrich LLP

(57) **CLAIM**

We claim the ornamental design for an electric vehicle power unit, as shown and described.

DESCRIPTION

FIG. 1 is a top, front, and right side perspective view of an electric vehicle power unit showing our new design; FIG. 2 is a top, front, and left side perspective view thereof; FIG. 3 is a right side elevation view thereof; FIG. 4 is a left side elevation view thereof; FIG. 5 is a front elevation view thereof; FIG. 6 is a rear elevation view thereof; FIG. 7 is a top plan view thereof; FIG. 8 is a bottom plan view thereof; and, FIG. 9 is a perspective view thereof when part of a fully assembled electric vehicle.

The broken lines in the drawings illustrate portions of the electric vehicle power unit and environmental structure of a vehicle that form no part of the claimed design.

1 Claim, 8 Drawing Sheets

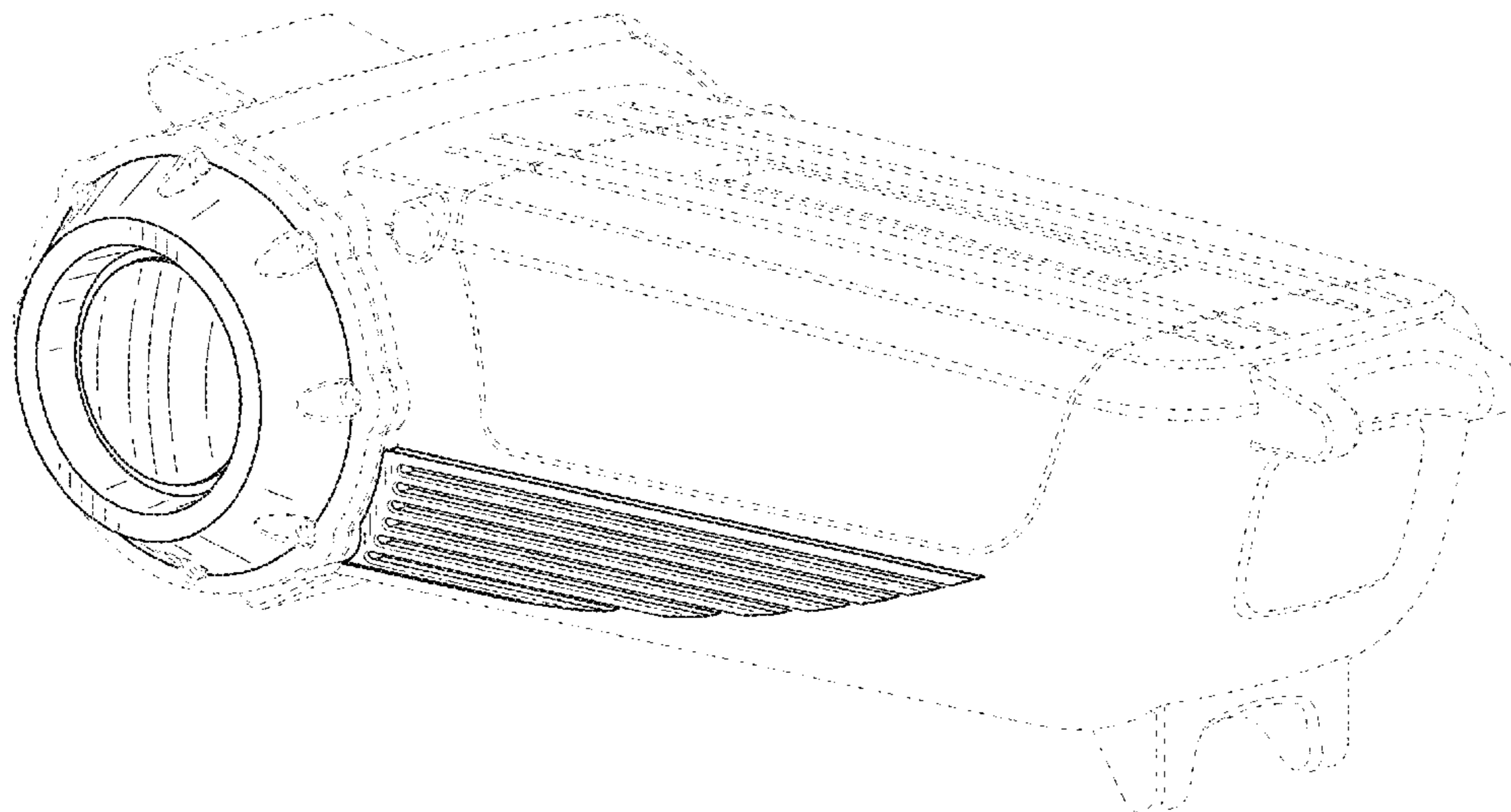

(56)

References Cited

U.S. PATENT DOCUMENTS

D376,567 S * 12/1996 Davidson D12/126
 D411,489 S * 6/1999 Davidson D12/126
 D411,817 S * 7/1999 Davidson D12/126
 D424,480 S * 5/2000 Ricci D12/126
 D428,832 S * 8/2000 Matthies D12/126
 D509,188 S * 9/2005 Mayer D13/112
 D554,245 S * 10/2007 Geyer, III D23/365
 D556,101 S * 11/2007 Hurlbutt D12/180
 D564,420 S * 3/2008 Devlin D12/126
 D570,272 S * 6/2008 Jones D12/180
 D619,945 S * 7/2010 Sadanowicz D12/180
 D688,608 S * 8/2013 Amy D12/180
 D723,983 S * 3/2015 Blanca D12/180
 D783,463 S * 4/2017 Reed D12/126
 D820,199 S * 6/2018 Francis D13/103
 D838,230 S * 1/2019 Ghannam D12/400
 D838,231 S * 1/2019 Ghannam D12/400

D852,680 S * 7/2019 Ness D12/114
 D852,847 S * 7/2019 Christoph D15/1
 10,488,231 B2 * 11/2019 Ghannam H05K 5/0226
 D878,973 S * 3/2020 McGinley D12/126
 2005/0092560 A1 * 5/2005 Brotherton F16D 65/10
 188/218 R
 2007/0289826 A1 * 12/2007 Suryatama F16D 65/10
 188/218 R
 2014/0084623 A1 * 3/2014 Miyamoto B62J 17/00
 296/180.1
 2015/0167765 A1 * 6/2015 Plantan F16D 65/22
 188/332

OTHER PUBLICATIONS

Harley Davidson, "Electric Motorcycles Harley Davidson USA",
 Webpage: <https://www.harley-davidson.com/us/en/motorcycles/future-vehicles/electric.html>, May 9, 2019.

* cited by examiner



FIG. 1

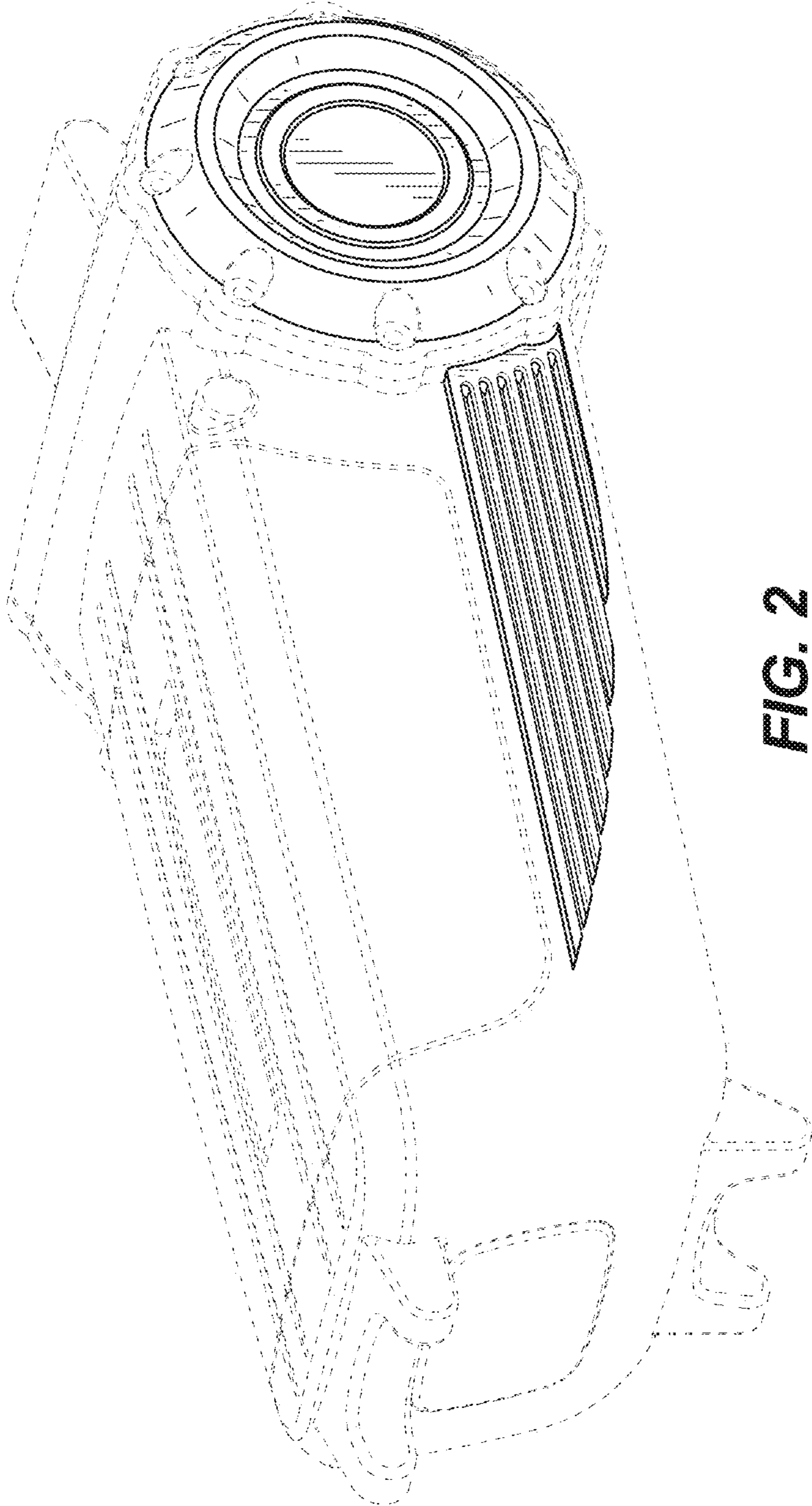

FIG. 2

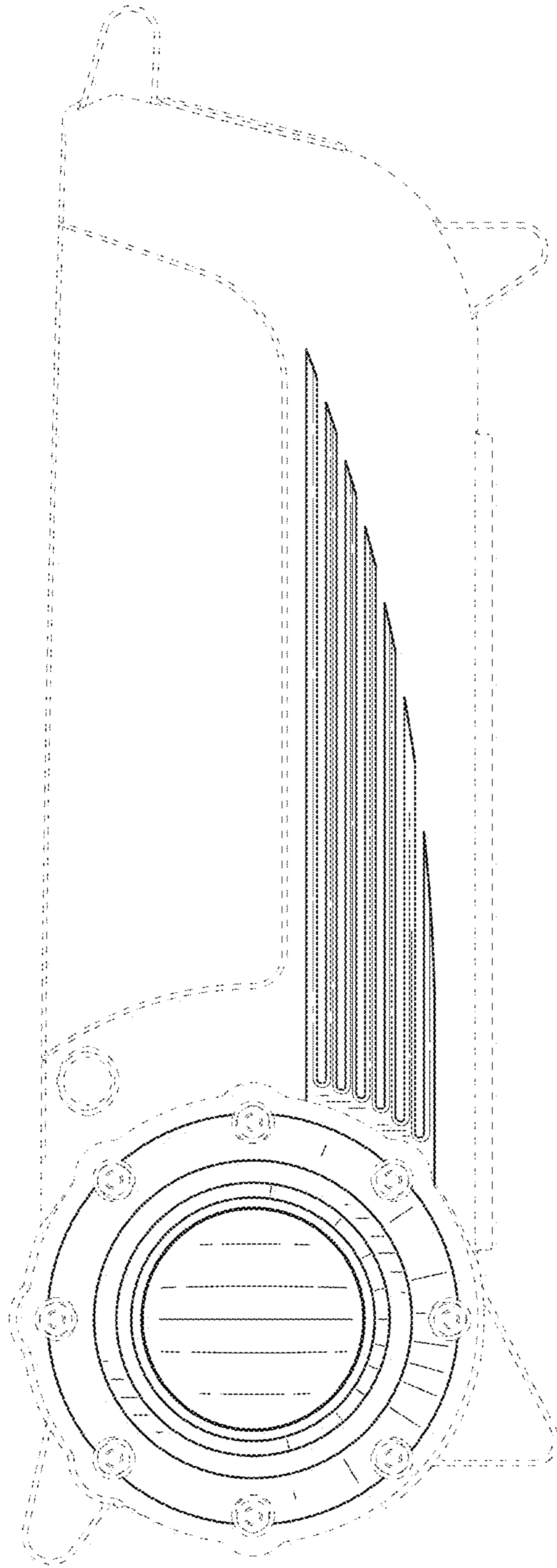

FIG. 3

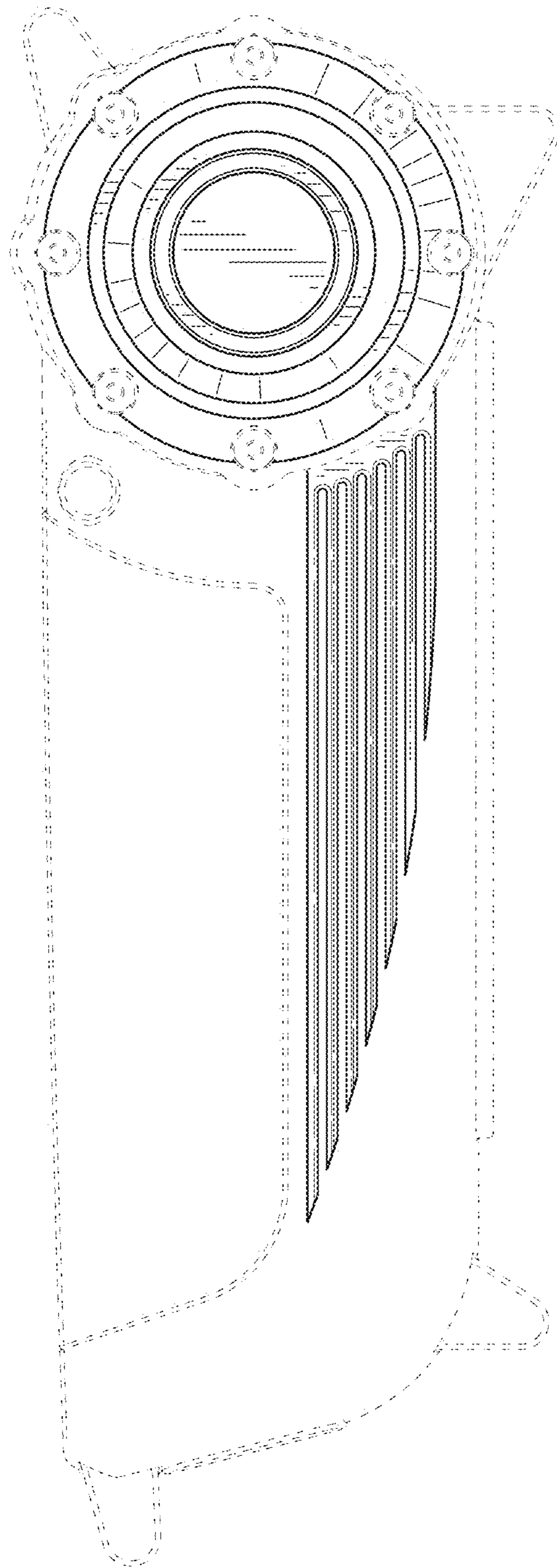

FIG. 4

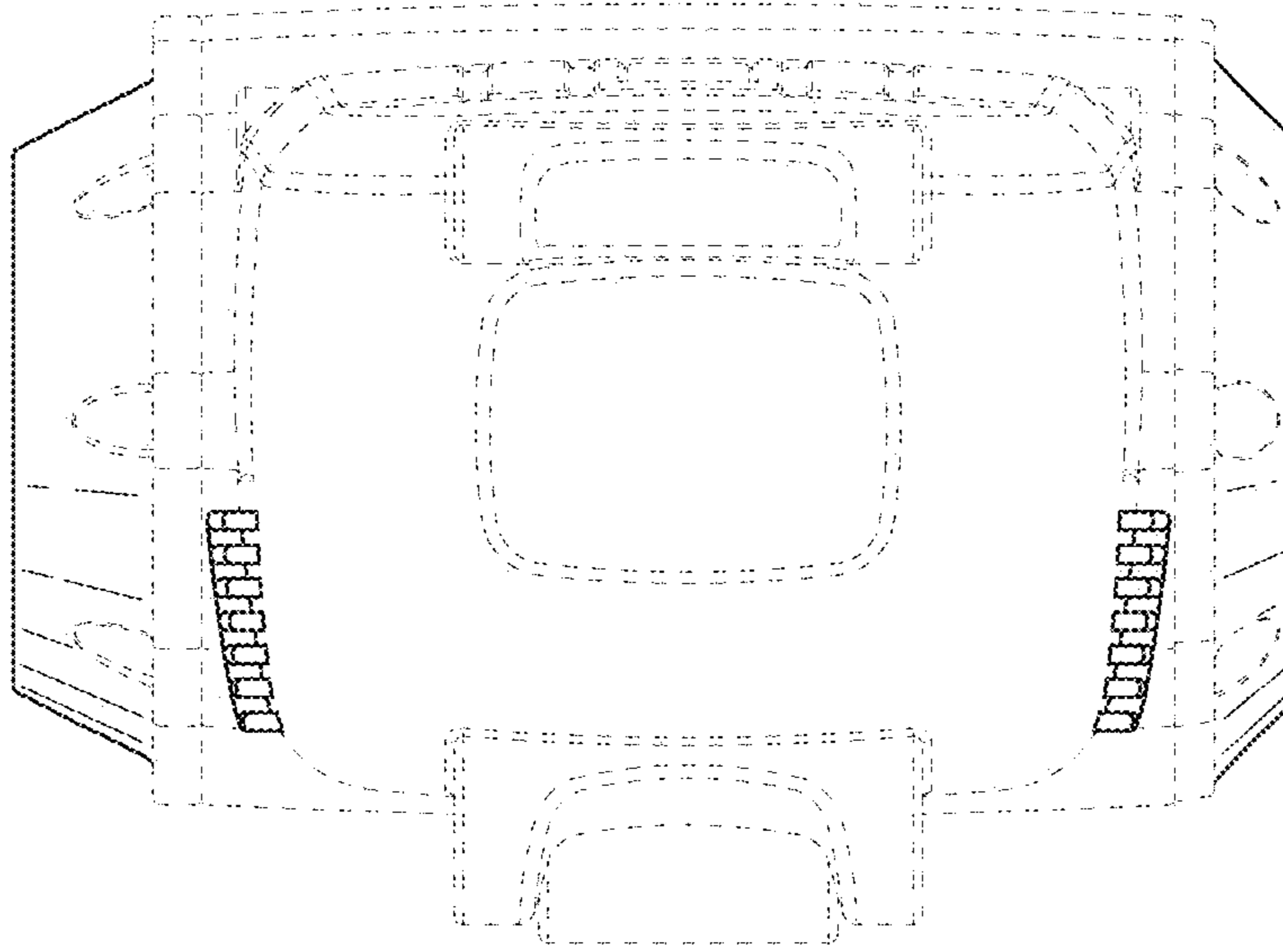

FIG. 5

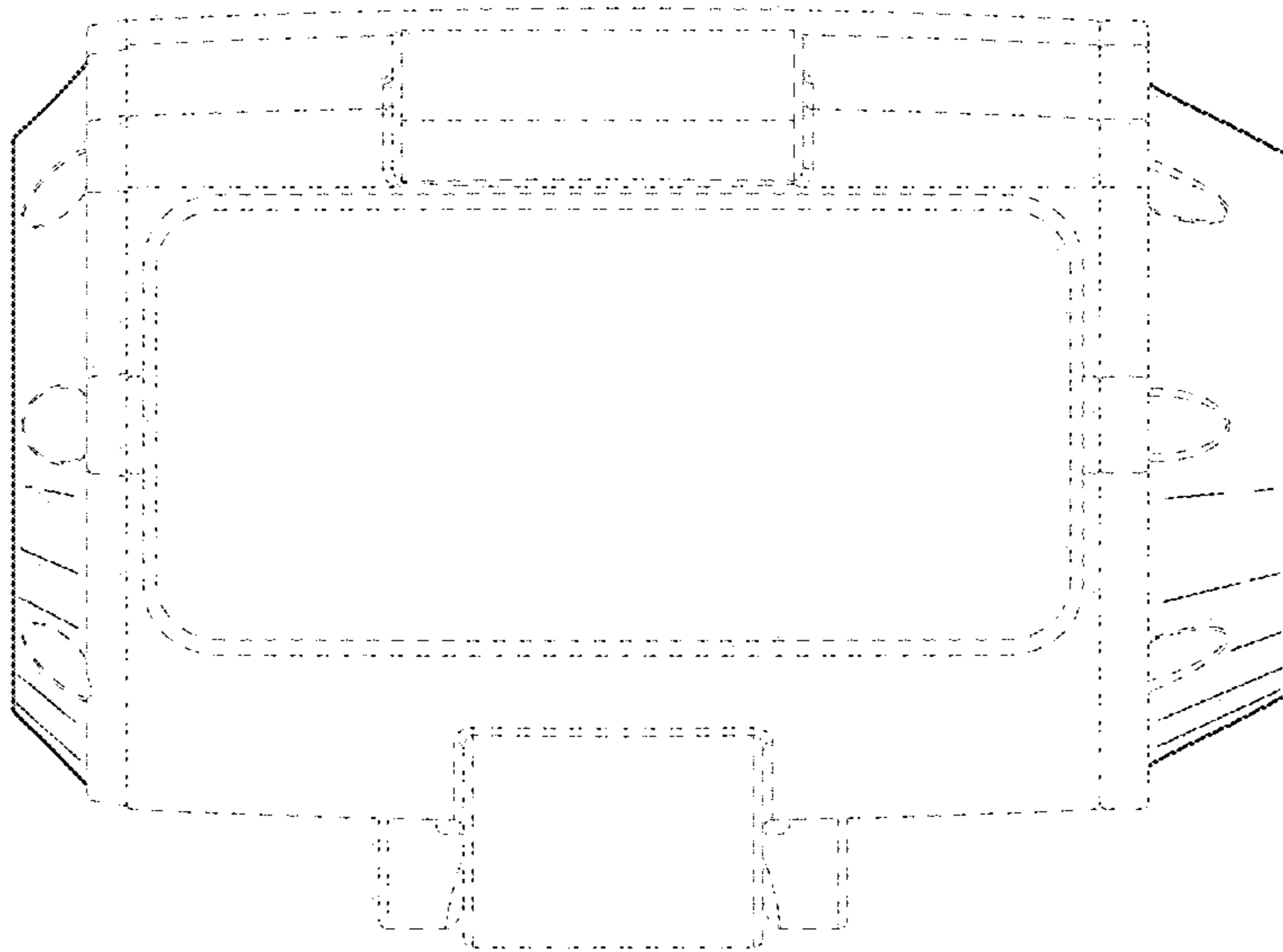

FIG. 6

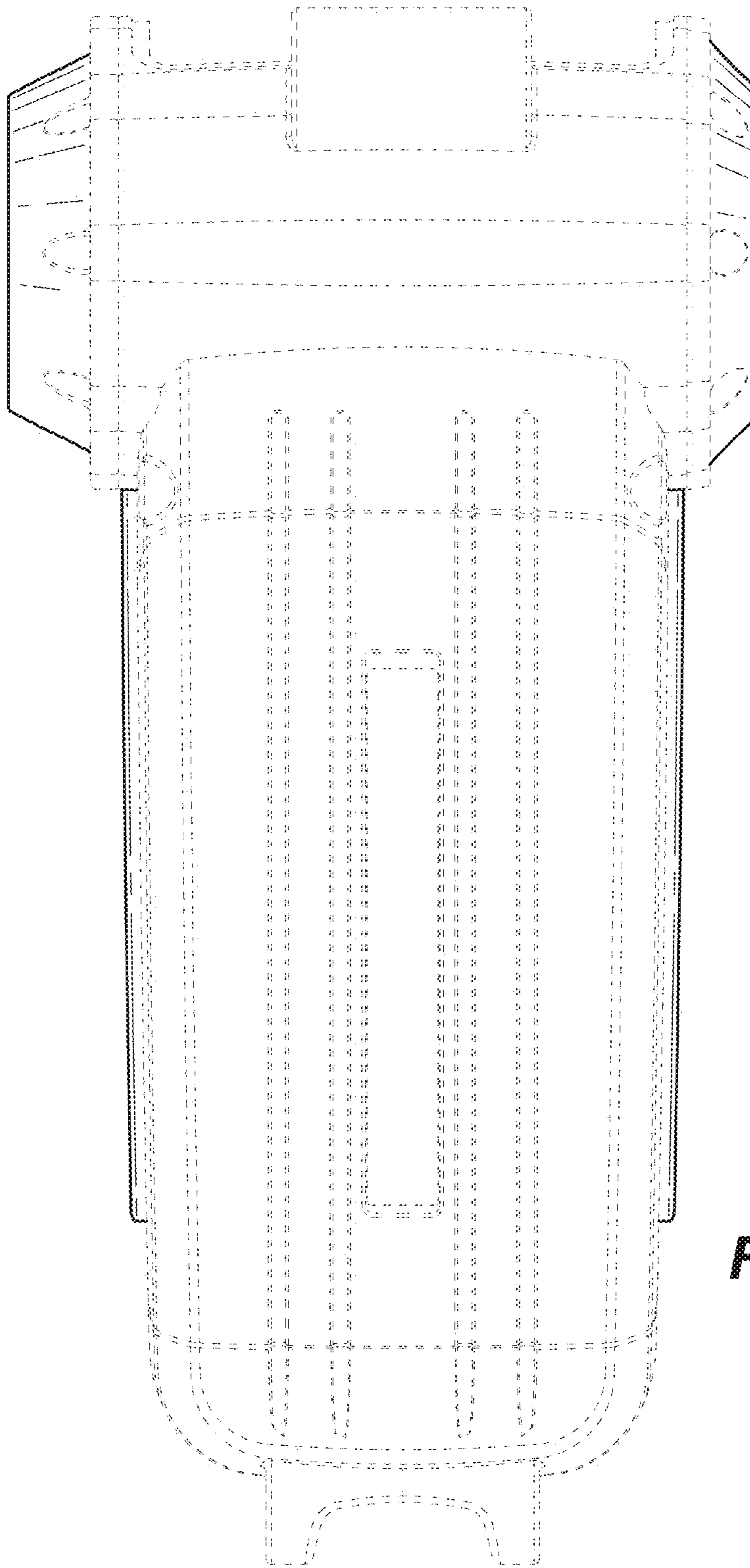

FIG. 7

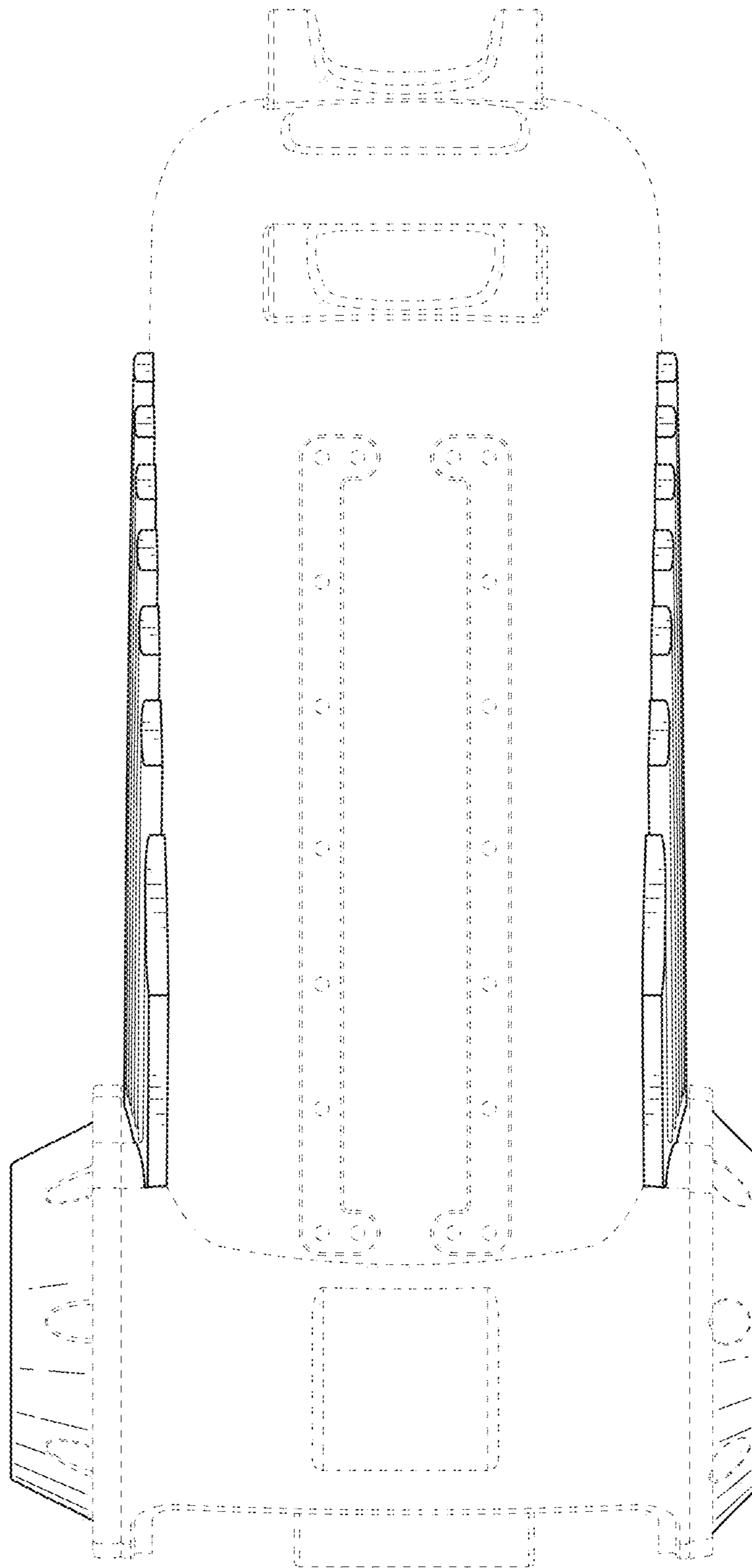

FIG. 8

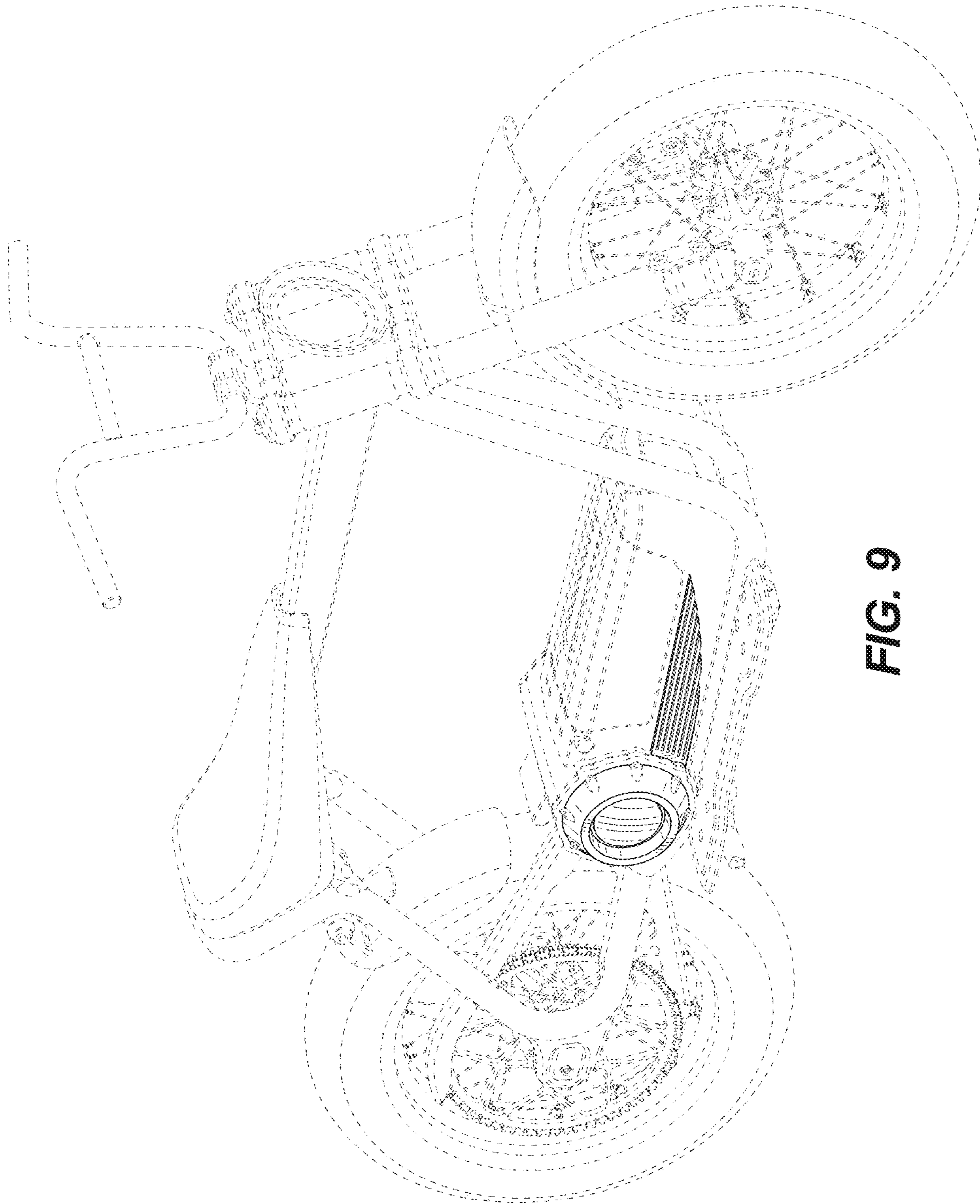

FIG. 9