



US00D901732S

(12) **United States Design Patent** (10) **Patent No.:** **US D901,732 S**
Abina (45) **Date of Patent:** **** Nov. 10, 2020**

(54) **MOTORCYCLE LED TAILLIGHT WITH INTEGRATED TURN SIGNALS**

D643,955 S * 8/2011 Tsai D26/28
D673,701 S * 1/2013 Davies D26/28
D715,469 S * 10/2014 Chou D26/28
D747,516 S * 1/2016 Yang D26/28

(71) Applicant: **Richard Lee Abina**, El Mirage, AZ (US)

* cited by examiner

(72) Inventor: **Richard Lee Abina**, El Mirage, AZ (US)

Primary Examiner — Marcus A Jackson
(74) *Attorney, Agent, or Firm* — Quickpatents, LLC; Kevin Prince

(**) Term: **15 Years**

(57) **CLAIM**

(21) Appl. No.: **29/706,736**

The ornamental design for a motorcycle LED taillight with integrated turn signals, as shown and described.

(22) Filed: **Sep. 23, 2019**

DESCRIPTION

(51) **LOC (12) Cl.** **26-06**

(52) **U.S. Cl.**
USPC **D26/28**

(58) **Field of Classification Search**
USPC D26/28–36, 139
CPC F21S 48/00; F21S 48/10; F21S 48/115;
F21S 48/225; F21S 48/1233; F21S 48/1266; F21S 48/1388; F21V 21/04;
F21V 29/004; B60Q 9/13; B60Q 9/135; B60Q 9/1375

See application file for complete search history.

FIG. 1 is a rear perspective view of a motorcycle LED taillight with integrated turn signals, showing my new design;
FIG. 2 is an enlarged rear perspective view thereof;
FIG. 3 is a rear elevational view thereof;
FIG. 4 is a front elevational view thereof;
FIG. 5 is a right-side elevational view thereof;
FIG. 6 is a left-side elevational view thereof;
FIG. 7 is a top plan view thereof;
FIG. 8 is a bottom plan view thereof;
FIG. 9 is an enlarged perspective view of a first type of LED of the design, taken along line 9 of FIG. 2; and,
FIG. 10 is an enlarged perspective view of a second type of LED of the design, taken along line 10 of FIG. 2.

(56) **References Cited**

U.S. PATENT DOCUMENTS

D436,194 S * 1/2001 Reinbach D26/28
D552,274 S * 10/2007 Tanaka D26/28
D568,501 S * 5/2008 Nakazawa D26/28
D569,015 S * 5/2008 Tsukui D26/28
D573,734 S * 7/2008 Watanabe D26/28
D617,020 S * 6/2010 Ishiguri D26/28
D625,034 S * 10/2010 Metzger D26/28
D643,559 S * 8/2011 Seymour D26/28

The broken lines showing a motorcycle and lamp enclosure in FIG. 1 depict environmental matter and form no part of the claimed design. The remaining broken lines depict portions of the motorcycle LED taillight with integrated turn signals that form no part of the claimed design.

1 Claim, 6 Drawing Sheets

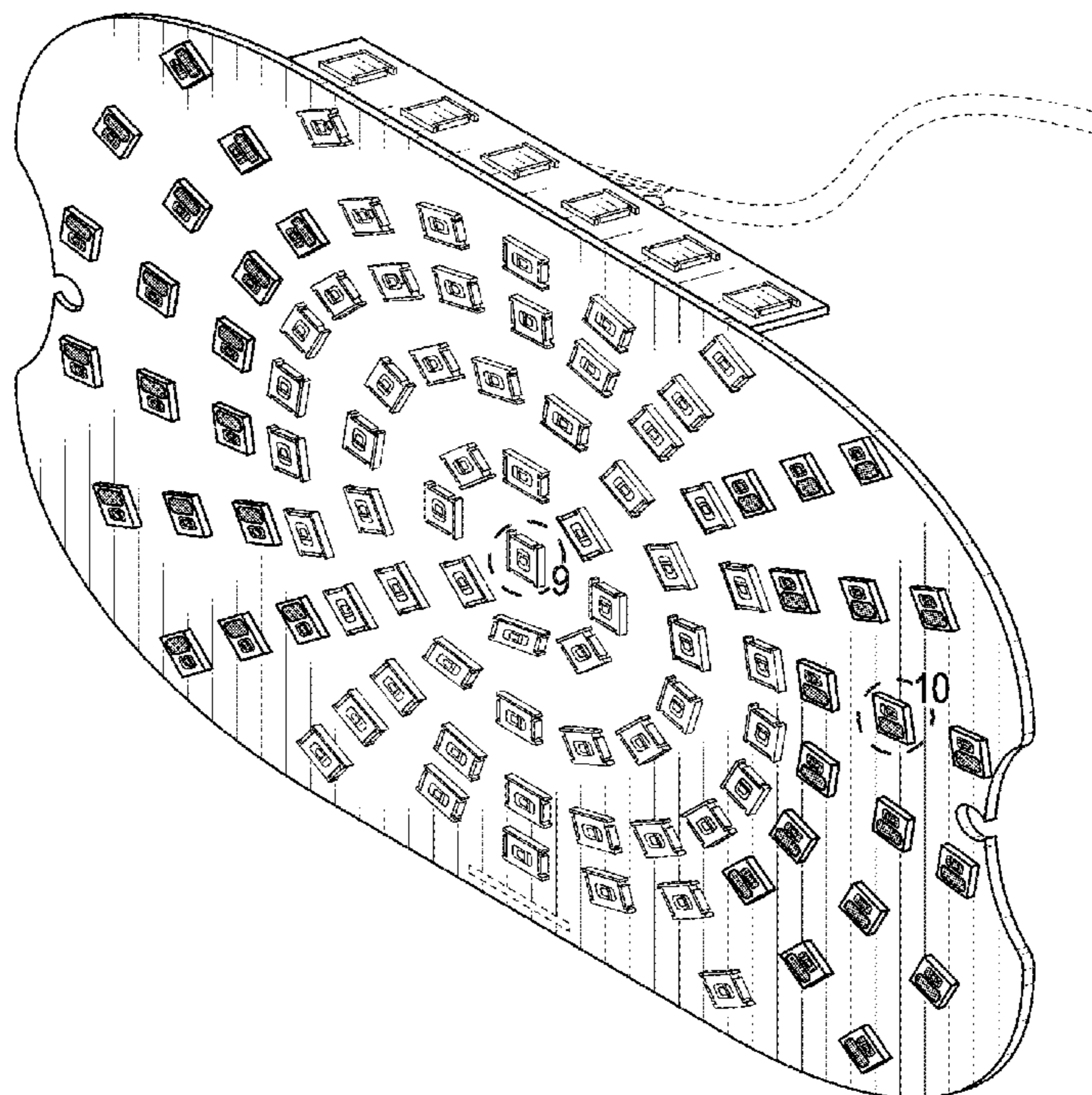

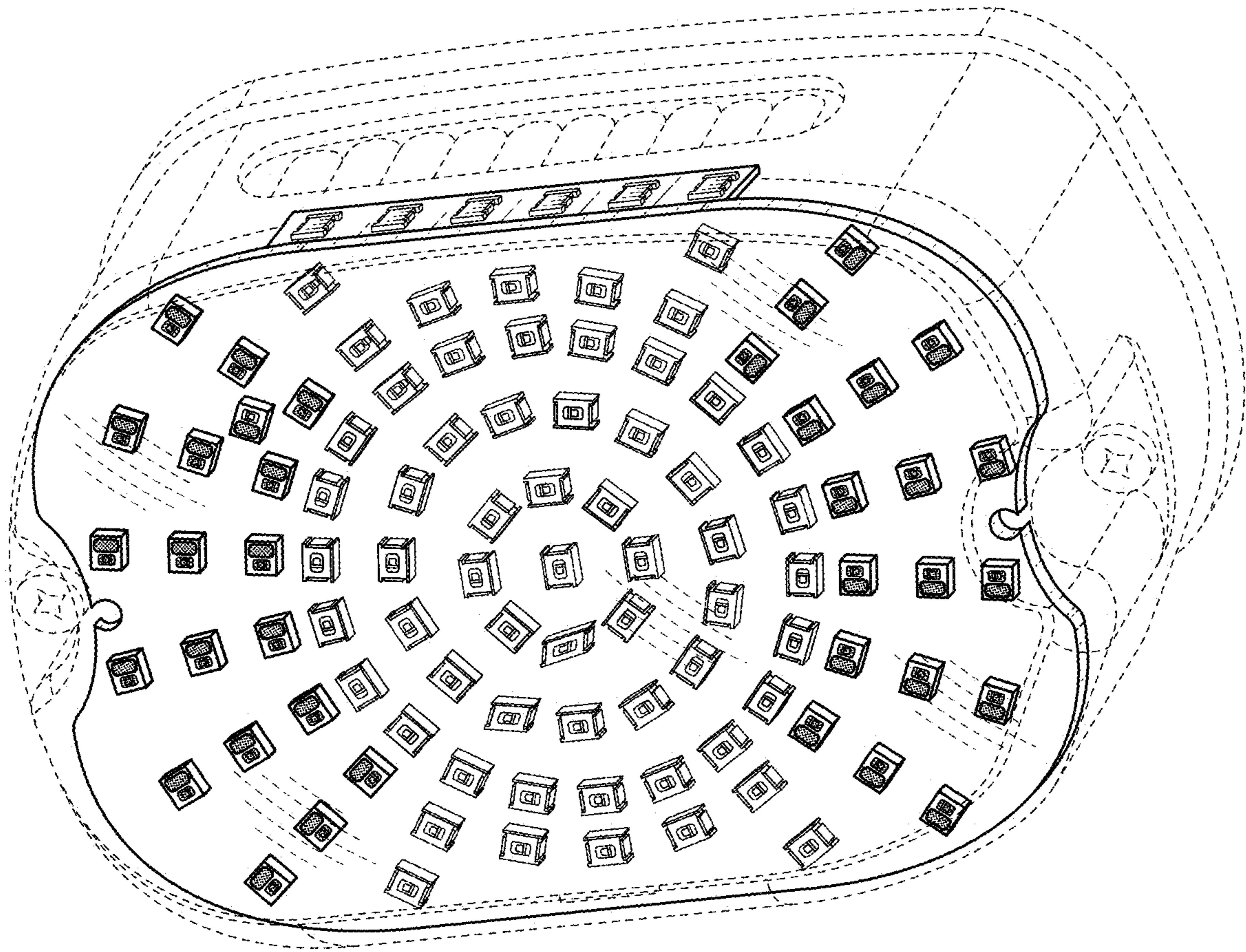

FIG. 1

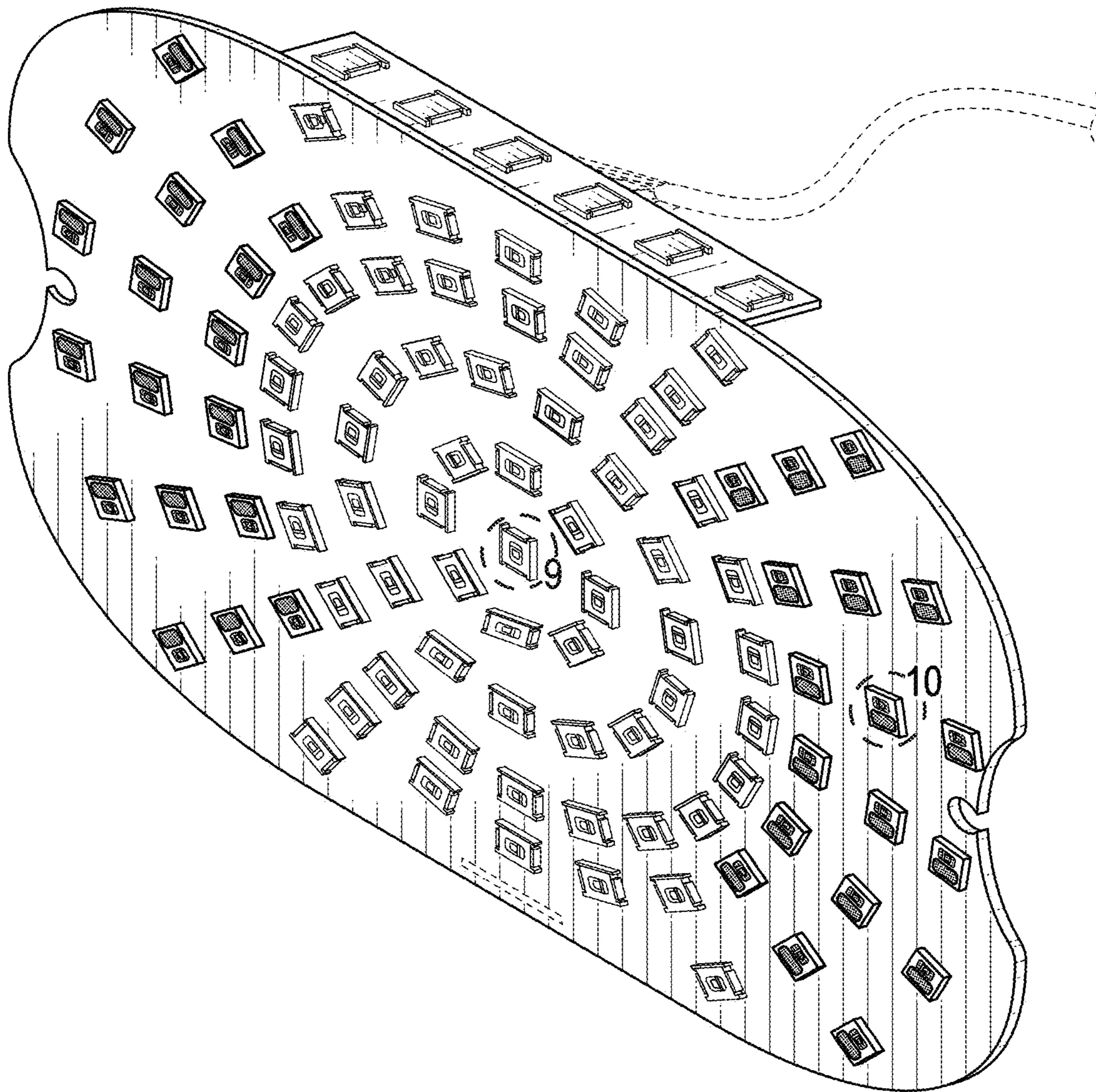

FIG. 2

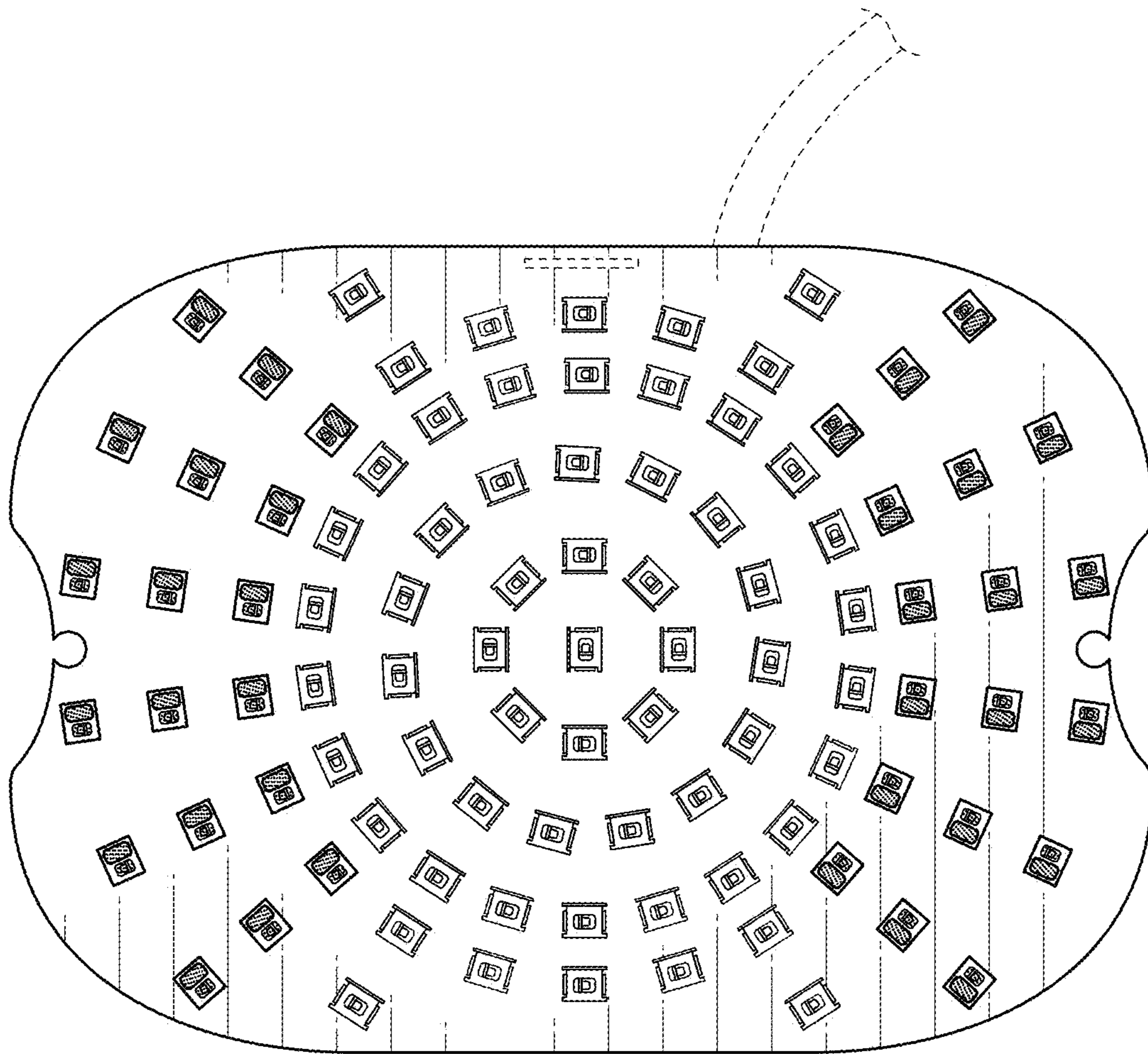

FIG. 3

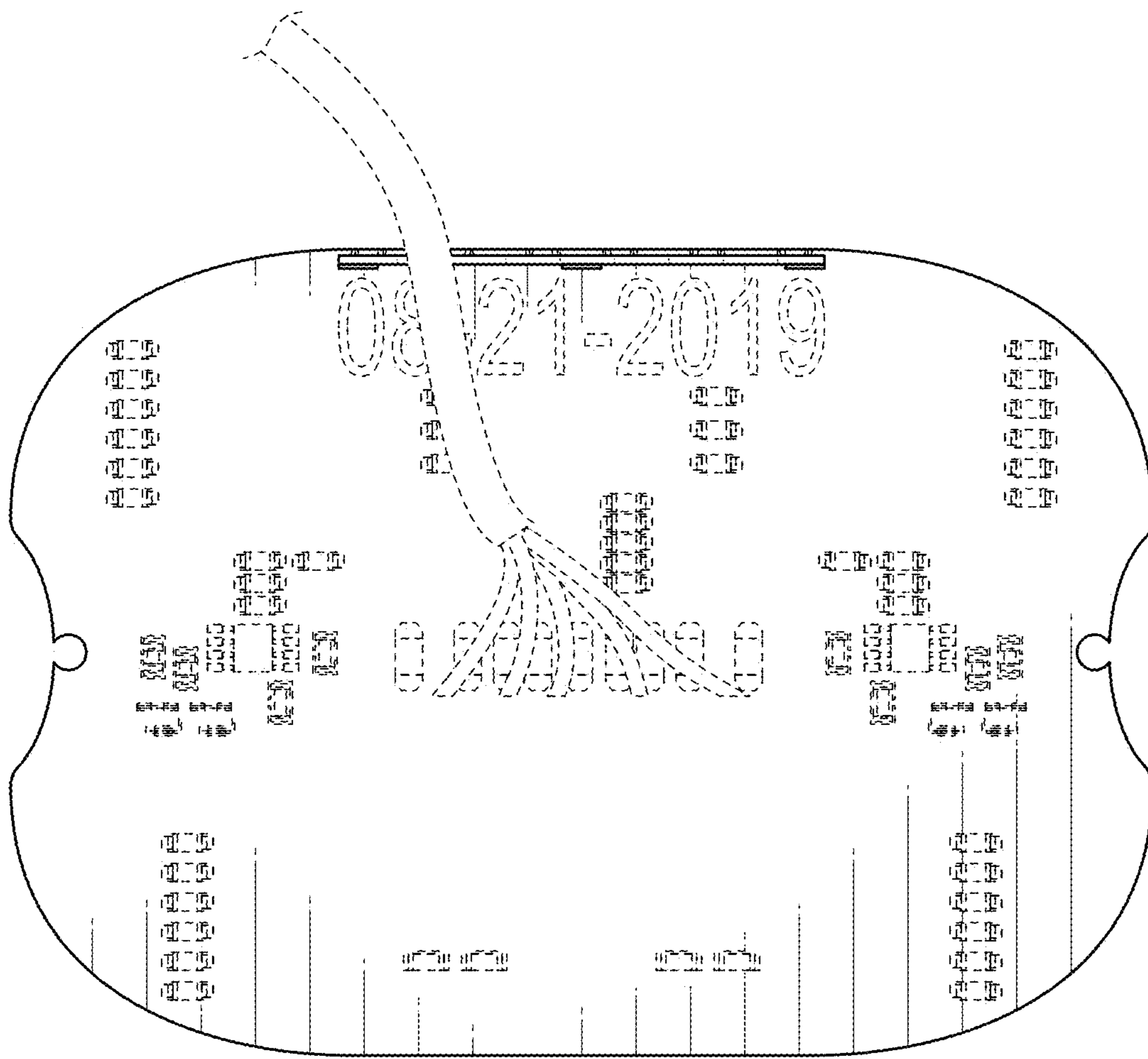

FIG. 4

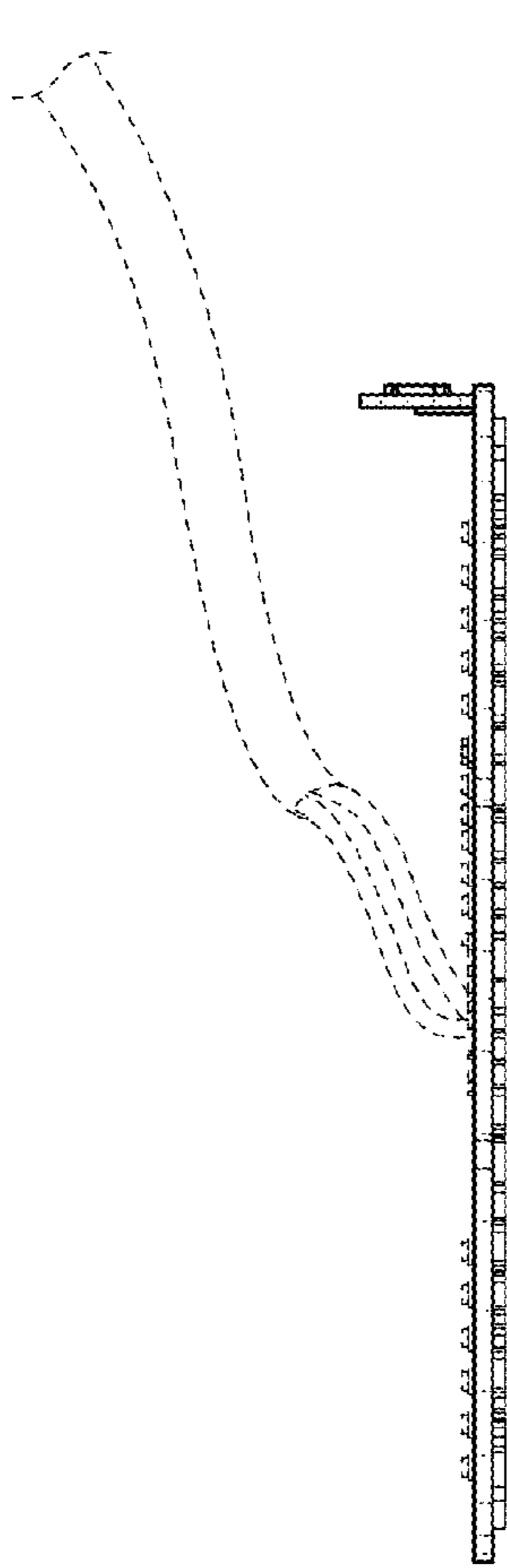

FIG. 5

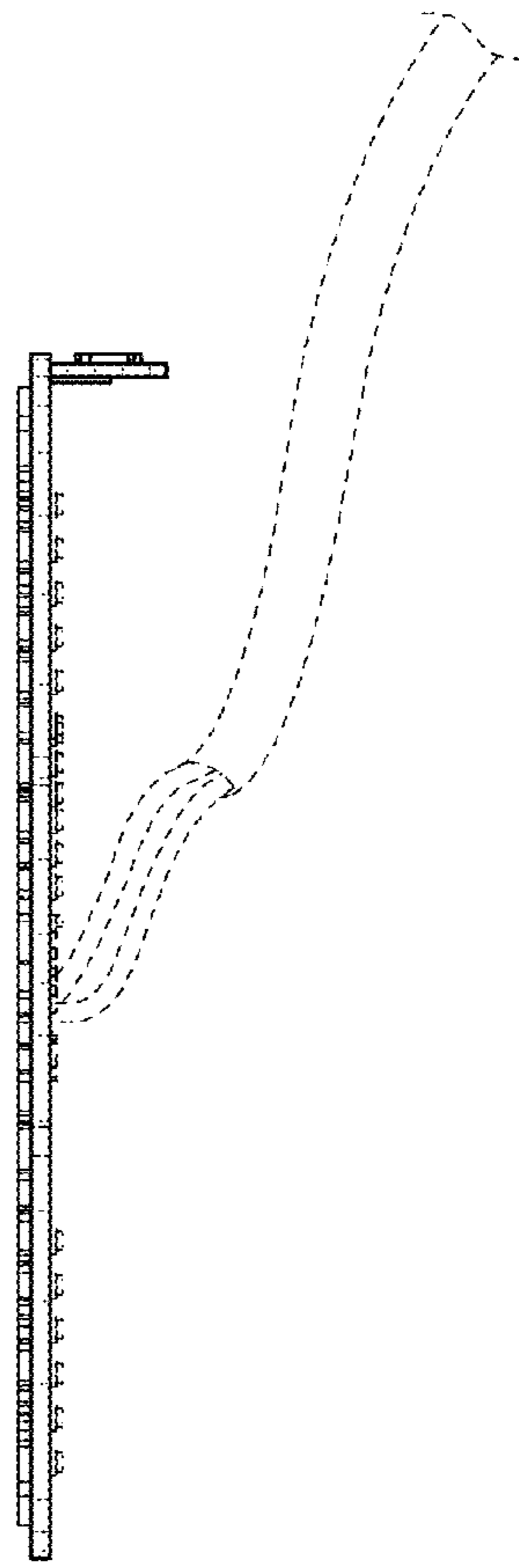

FIG. 6

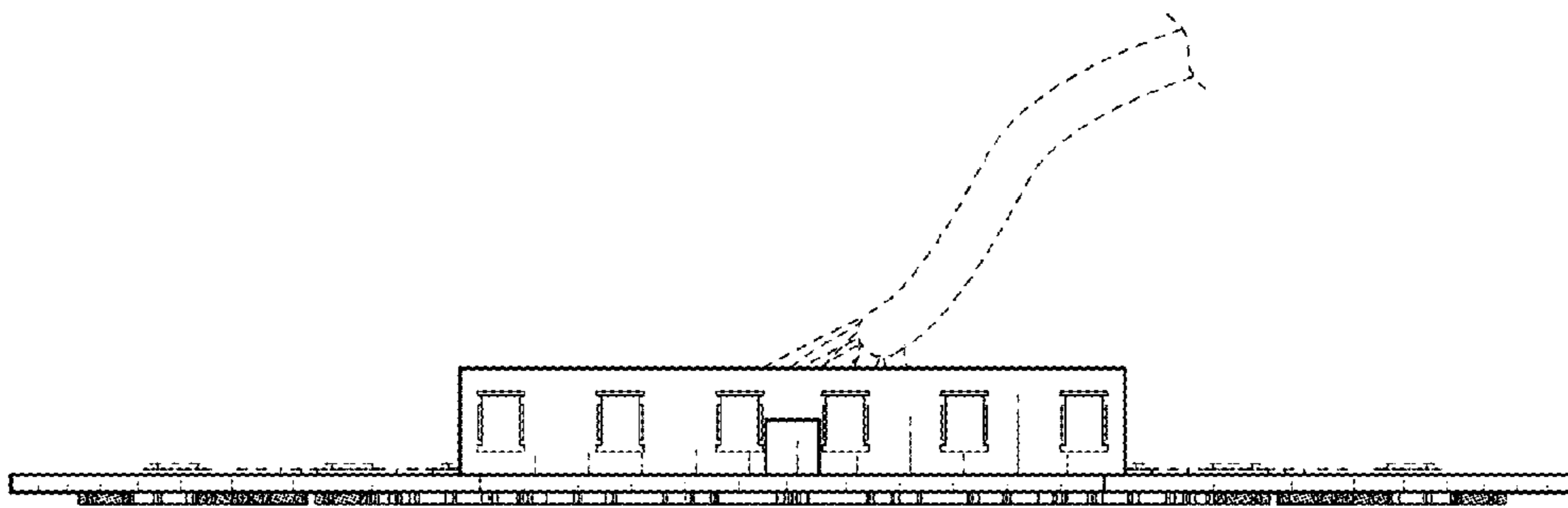

FIG. 7

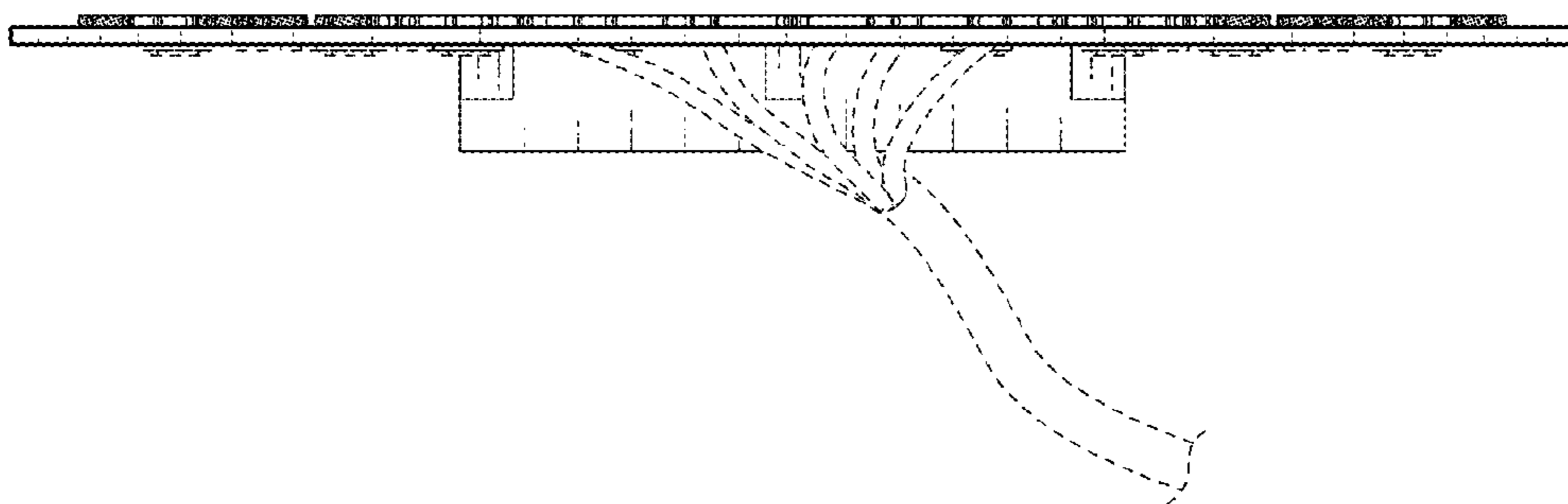

FIG. 8

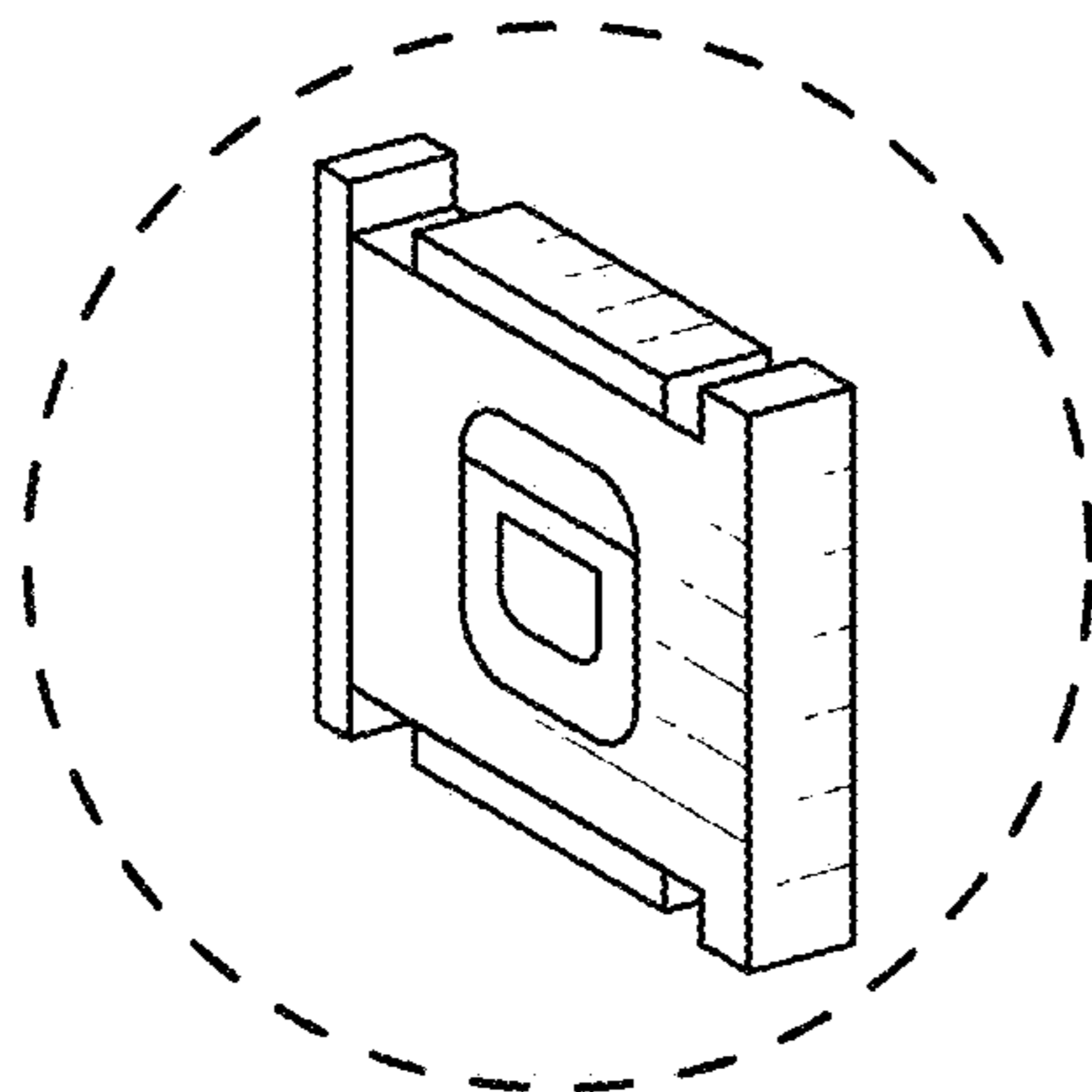

FIG. 9

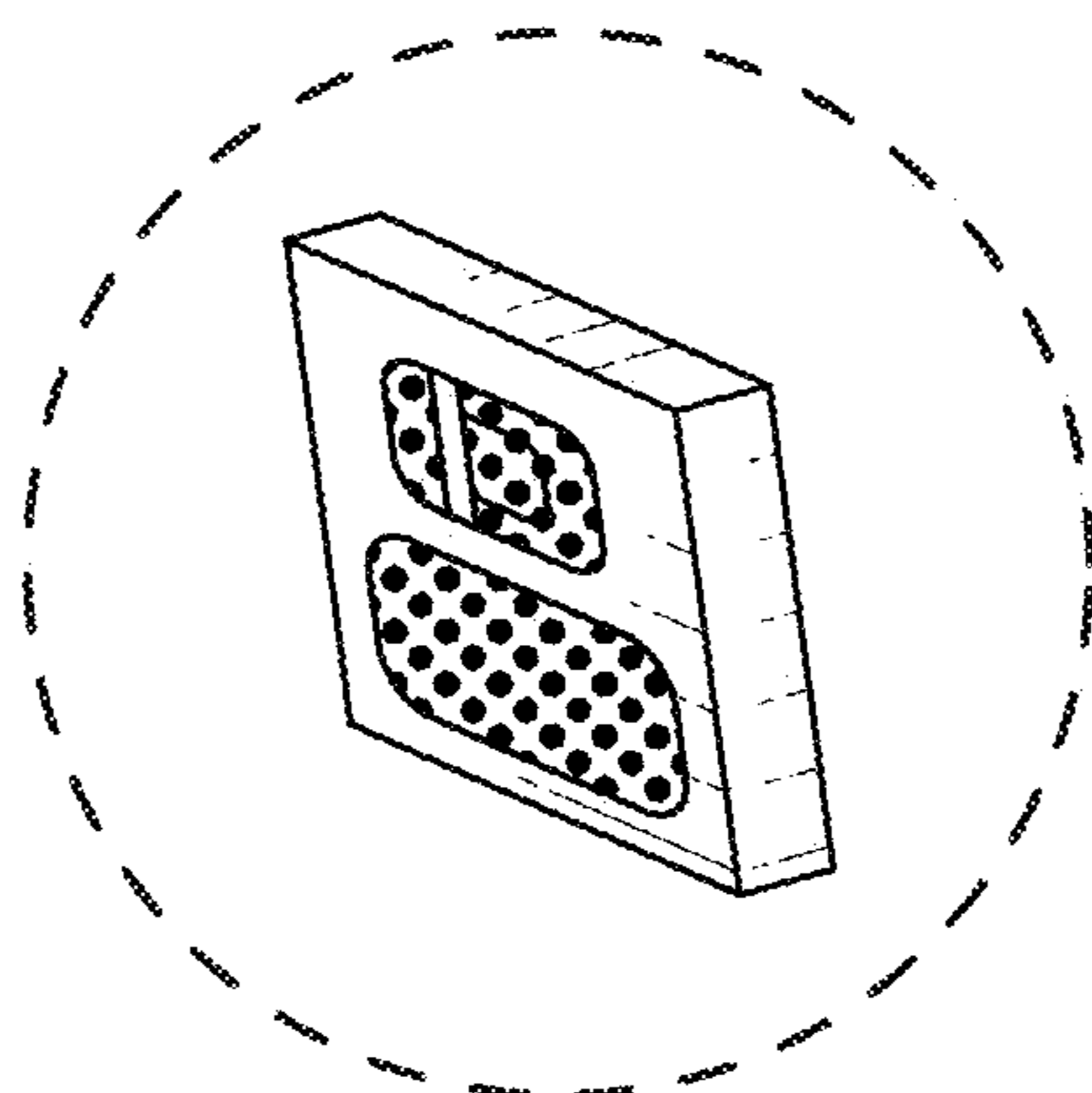

FIG. 10