



US00D901338S

(12) **United States Design Patent** (10) **Patent No.:** **US D901,338 S**  
**Luo** (45) **Date of Patent:** **\*\* Nov. 10, 2020**

(54) **VEHICLE LED GRILLE**  
(71) Applicant: **Xing Wen Luo**, City of Industry, CA (US)  
(72) Inventor: **Xing Wen Luo**, City of Industry, CA (US)  
(\*\*) Term: **15 Years**  
(21) Appl. No.: **29/671,476**  
(22) Filed: **Nov. 27, 2018**  
(51) **LOC (12) Cl.** ..... **12-16**  
(52) **U.S. Cl.**  
USPC ..... **D12/163; D26/28**  
(58) **Field of Classification Search**  
USPC ..... D12/163, 196, 86, 90-92, 169, 190, 98, D12/164; D26/28-30; 296/180.1, 180.2; 180/68.1, 68.6; 293/102, 196, 86, 90-92, 293/169, 190, 98, 164  
CPC ..... B60R 19/52; B60K 11/08; B62D 25/08; B62B 9/16  
See application file for complete search history.

D607,785 S \* 1/2010 Walter ..... D12/163  
D614,544 S \* 4/2010 Ectors ..... D12/163  
D624,469 S \* 9/2010 Miyazawa ..... D12/163  
D670,619 S \* 11/2012 Frei ..... D12/163  
D670,620 S \* 11/2012 Frei ..... D12/163  
D678,824 S \* 3/2013 Behmer ..... D12/163  
D680,033 S \* 4/2013 Behmer ..... D12/163  
D702,155 S \* 4/2014 Hanaoka ..... D12/163  
D712,321 S \* 9/2014 Mays ..... D12/163  
D722,923 S \* 2/2015 George ..... D12/163  
D740,724 S \* 10/2015 Burki ..... D12/163  
D758,926 S \* 6/2016 Rupar ..... D12/163  
D783,467 S \* 4/2017 Svensson ..... D12/163  
D807,242 S \* 1/2018 Piscitelli ..... D12/163  
D861,936 S \* 10/2019 Li ..... D26/28  
D878,642 S \* 3/2020 Ren ..... D26/28  
D881,425 S \* 4/2020 Hu ..... D26/28  
D884,229 S \* 5/2020 Huang ..... D26/28

\* cited by examiner

*Primary Examiner* — Melody N Brown  
(74) *Attorney, Agent, or Firm* — Raymond Y. Chan; David and Raymond Patent Firm

(57) **CLAIM**

The ornamental design for a vehicle LED grille, as shown and described.

**DESCRIPTION**

FIG. 1 is a front elevation view of a vehicle LED grille showing my new design;  
FIG. 2 is a rear view thereof;  
FIG. 3 is a right view thereof;  
FIG. 4 is a left view thereof;  
FIG. 5 is a top view thereof; and,  
FIG. 6 is a bottom view thereof.

**1 Claim, 6 Drawing Sheets**

(56) **References Cited**  
U.S. PATENT DOCUMENTS  
D310,650 S \* 9/1990 Cressoni ..... D12/163  
D466,453 S \* 12/2002 Elwell ..... D12/163  
D510,303 S \* 10/2005 Spagnola ..... D12/163  
D535,223 S \* 1/2007 Gaffka ..... D12/163  
D547,705 S \* 7/2007 Marchese ..... D12/163  
D560,572 S \* 1/2008 Okamoto ..... D12/163  
D567,154 S \* 4/2008 Cunningham ..... D12/163  
D569,772 S \* 5/2008 Saridakis ..... D12/163  
D583,283 S \* 12/2008 Cunningham ..... D12/163  
D589,853 S \* 4/2009 Saridakis ..... D12/163

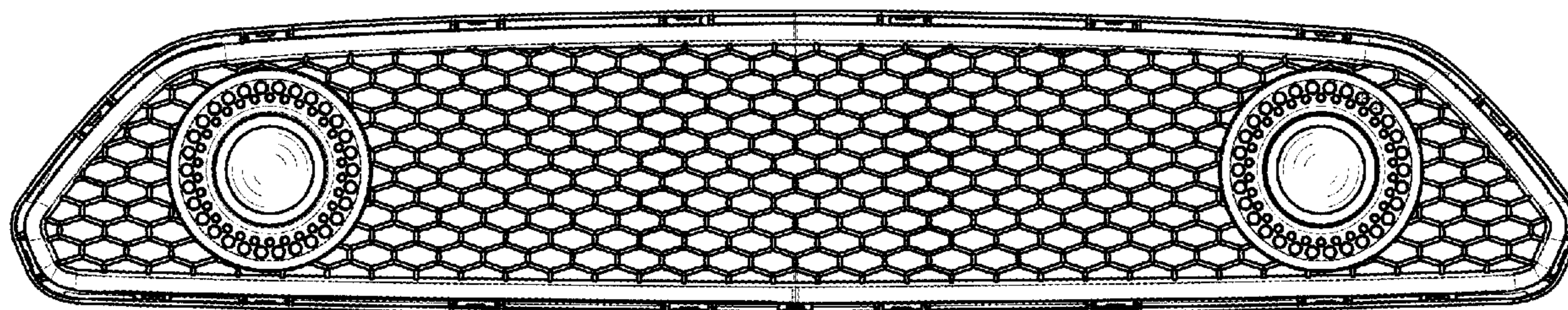

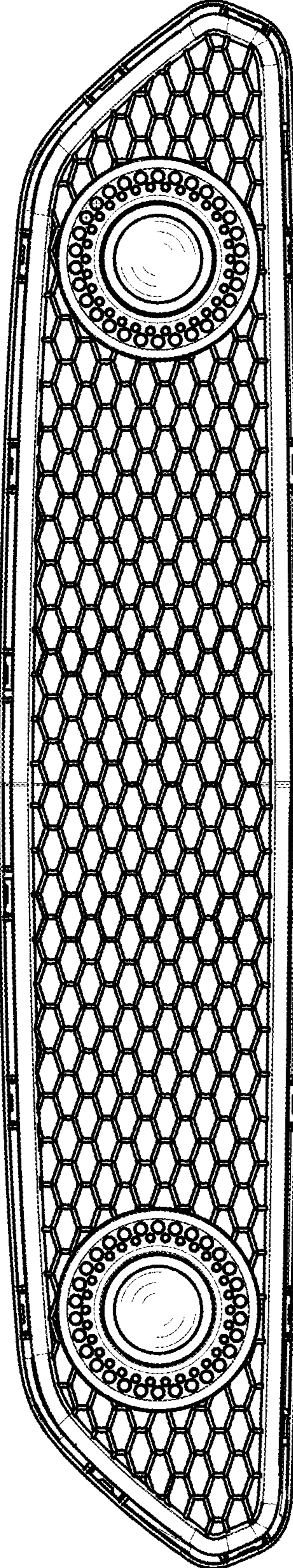

FIG. 1



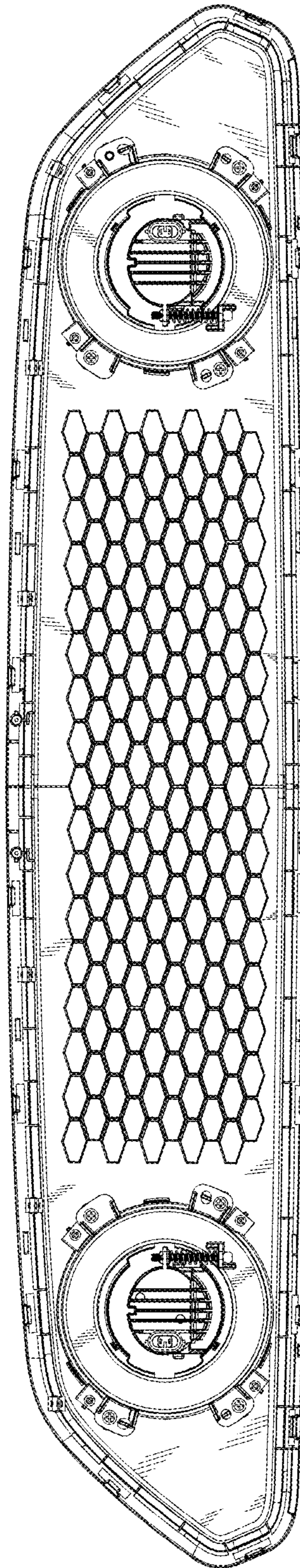

FIG. 2

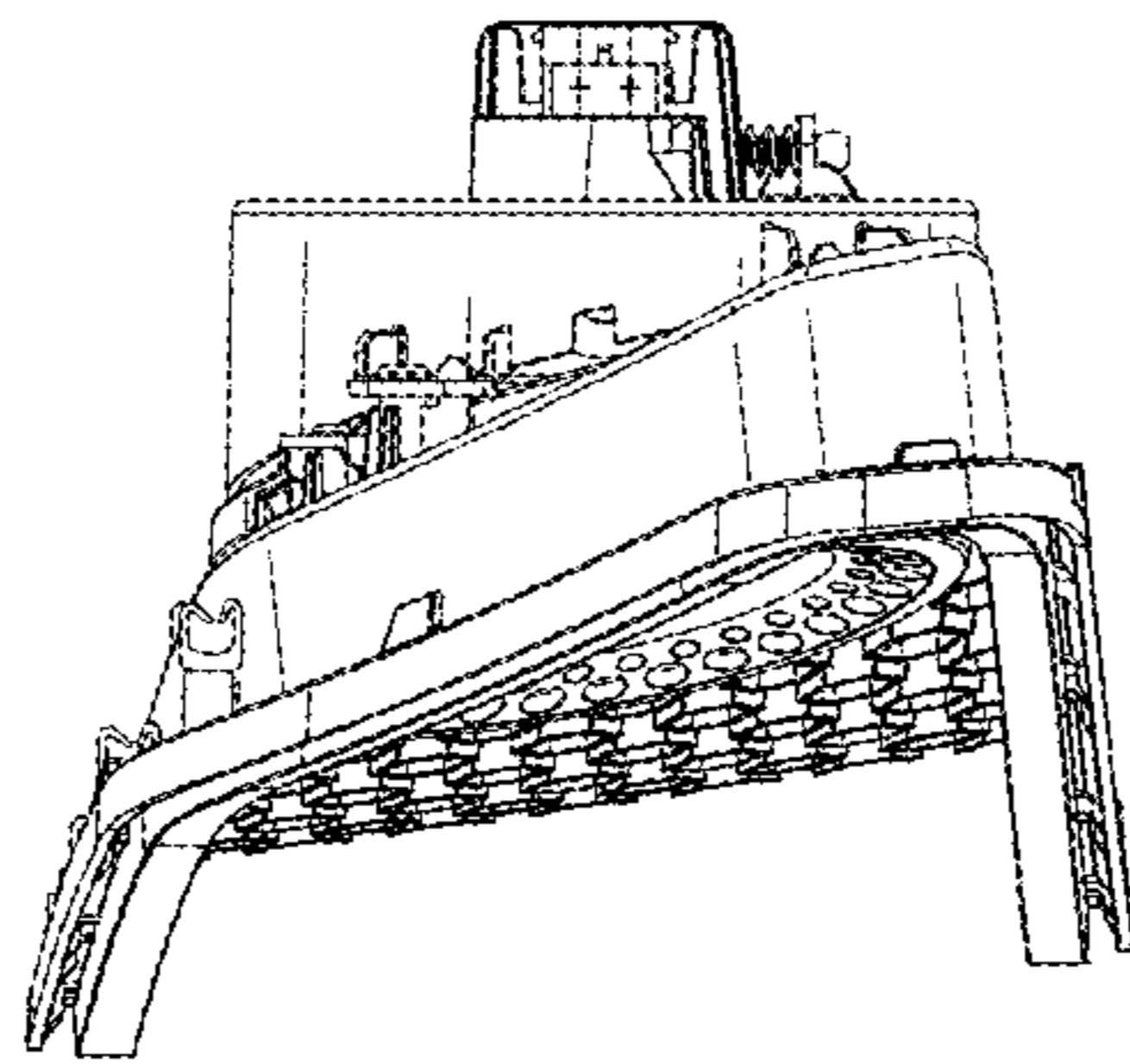

FIG. 3

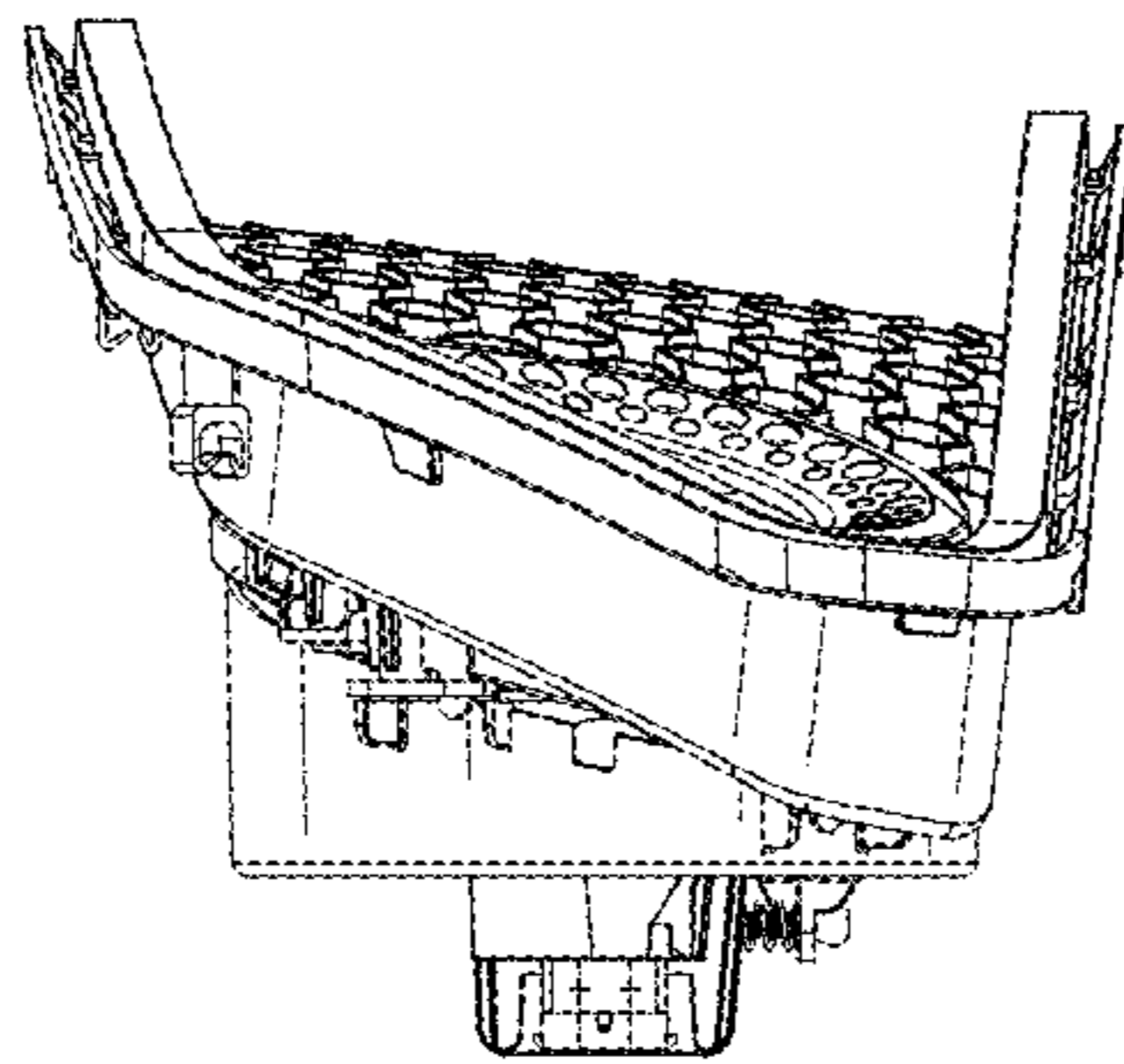

FIG. 4

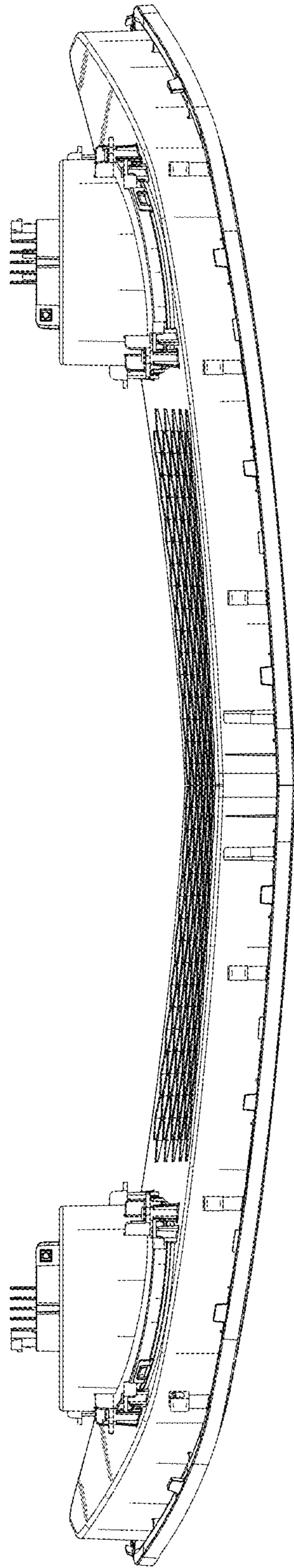

FIG. 5

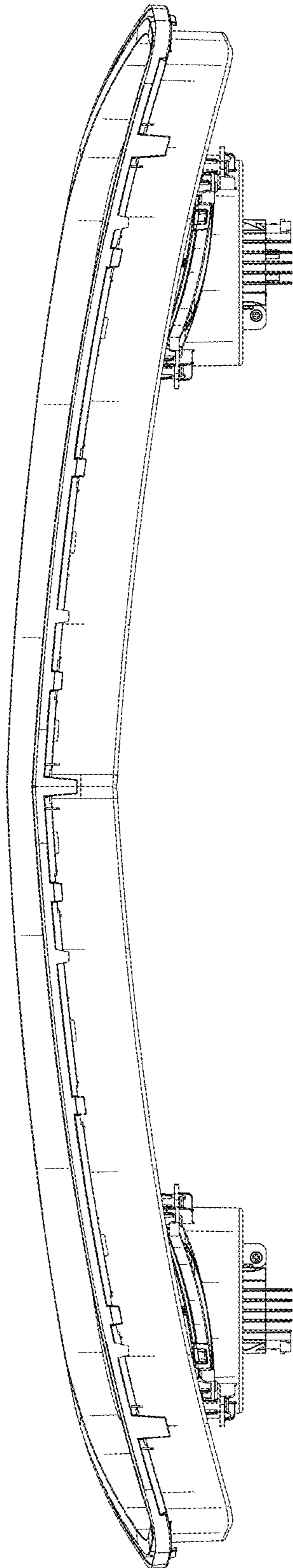

FIG. 6