



US00D901273S

(12) **United States Design Patent** (10) **Patent No.:** **US D901,273 S**
Shi (45) **Date of Patent:** **** Nov. 10, 2020**

(54) **RECIPROCATING SAW**
(71) Applicant: **BLACK & DECKER INC.**, New Britain, CT (US)
(72) Inventor: **Windy Shi**, Suzhou (CN)
(73) Assignee: **Black & Decker Inc.**, New Britain, CT (US)
(**) Term: **15 Years**

2003/0163924 A1* 9/2003 Hempe H02K 7/145
30/388
2009/0241354 A1* 10/2009 Zhou B25F 5/02
30/393
2011/0107608 A1* 5/2011 Wattenbach B23D 49/165
30/394
2012/0096721 A1* 4/2012 Sinur B23D 51/16
30/392
2014/0047720 A1* 2/2014 Vitantonio F21V 33/0084
30/369
2014/0053420 A1* 2/2014 Sugino B23D 51/08
30/392

(Continued)

(21) Appl. No.: **29/645,316**
(22) Filed: **Apr. 25, 2018**
(51) **LOC (12) Cl.** **08-03**
(52) **U.S. Cl.**
USPC **D8/64**
(58) **Field of Classification Search**
USPC D8/61, 62, 64, 65, 66, 67, 68, 69
CPC B23D 49/10; B23D 49/16; B23D 49/162;
B23D 46/165; B23D 51/00; B23D 51/08;
B23D 51/16; B25F 5/02
See application file for complete search history.

OTHER PUBLICATIONS

Pictures of Porter Cable 20v Max Cordless Reciprocating Tigersaw (PCC670B)—<https://www.portercable.com/products/power-tools/saws/reciprocating-saws/20v-max-cordless-reciprocating-tigersaw-tool-only/pcc670b>—accessed on Aug. 27, 2018.

(Continued)

Primary Examiner — Nathan M Johnston
(74) *Attorney, Agent, or Firm* — Stephen R. Valancius

(57) **CLAIM**

The ornamental design for a reciprocating saw, as shown and described.

DESCRIPTION

FIG. 1 is a perspective view of a reciprocating saw showing my new design;
FIG. 2 is a front view thereof
FIG. 3 is a rear view thereof;
FIG. 4 is a right side view thereof;
FIG. 5 is a left side view thereof;
FIG. 6 is a top plan view thereof; and,
FIG. 7 is a bottom plan view thereof.
In the above drawings, the broken lines and the areas within the broken lines form no part of the claimed design.

1 Claim, 6 Drawing Sheets

(56) **References Cited**

U.S. PATENT DOCUMENTS

D468,982 S *	1/2003	Brazell	D8/64
D479,453 S *	9/2003	Lind	D8/64
D524,130 S *	7/2006	Wolf	D8/64
D551,930 S *	10/2007	Yamada	D8/64
D591,574 S *	5/2009	DiPasquale	D8/64
D685,242 S *	7/2013	Vitantonio	D8/64
D705,028 S *	5/2014	Vitantonio	D8/64
D705,627 S	5/2014	Schoch	
D790,939 S *	7/2017	Elder	D8/64
D830,146 S *	10/2018	Croghan	D8/64
D867,843 S *	11/2019	Itoh	D8/64
D872,551 S *	1/2020	Clark	D8/64
2003/0051352 A1 *	3/2003	Clark, Jr.	B23D 51/16 30/392

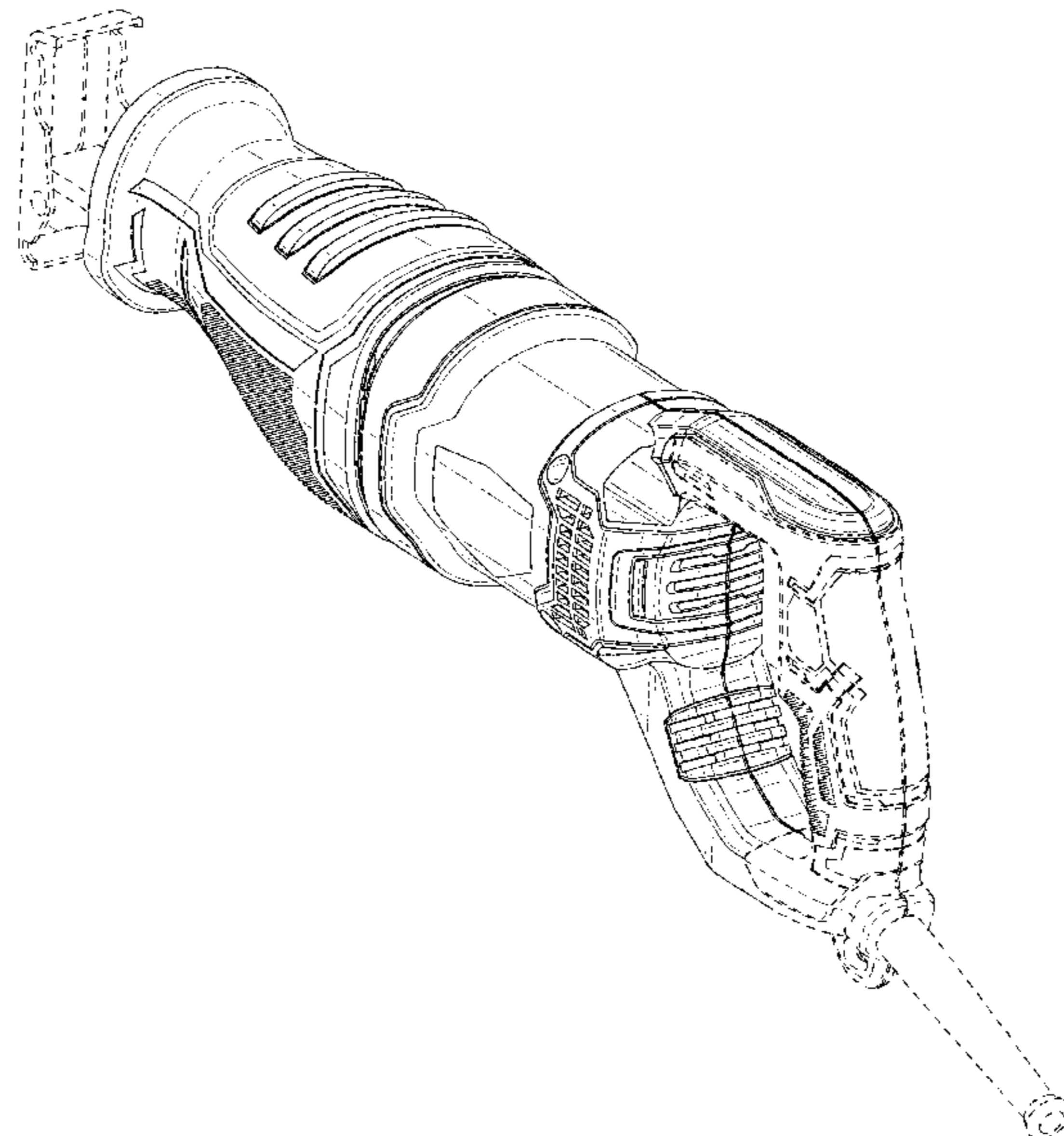

(56)

References Cited

U.S. PATENT DOCUMENTS

2014/0190023 A1* 7/2014 Vitantonio B23D 49/006
30/369
2014/0283394 A1* 9/2014 Adams B23D 49/162
30/374
2014/0360029 A1* 12/2014 Adams B25F 5/02
30/392
2017/0157760 A1* 6/2017 McAuliffe B23D 49/16
2017/0361448 A1* 12/2017 Krupsaw B25F 5/006
2018/0126470 A1* 5/2018 Banholzer B23D 49/162
2019/0375032 A1* 12/2019 Mikat-Stevens B23D 49/162
2019/0381586 A1* 12/2019 Cholst B23D 51/10

OTHER PUBLICATIONS

Pictures of Porter Cable PCE360 7.5 AMP Variable Speed Recip-
rocating Saw—[https://www.amazon.com/PORTER-CABLE-PCE360-
Variable-Speed-Reciprocating/dp/B01HCVGMOC](https://www.amazon.com/PORTER-CABLE-PCE360-Variable-Speed-Reciprocating/dp/B01HCVGMOC)—accessed on Aug.
29, 2018.

* cited by examiner

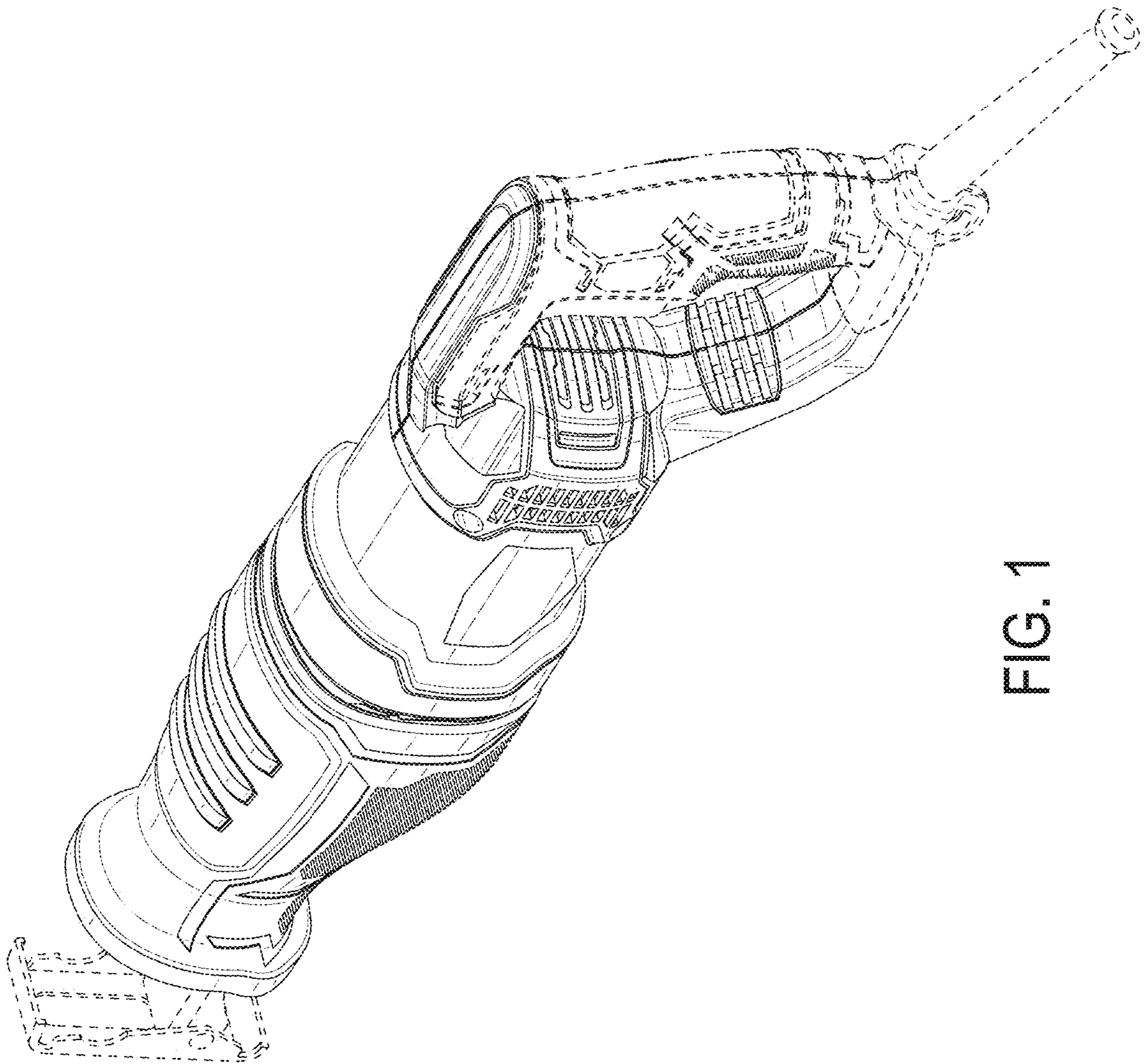

FIG. 1

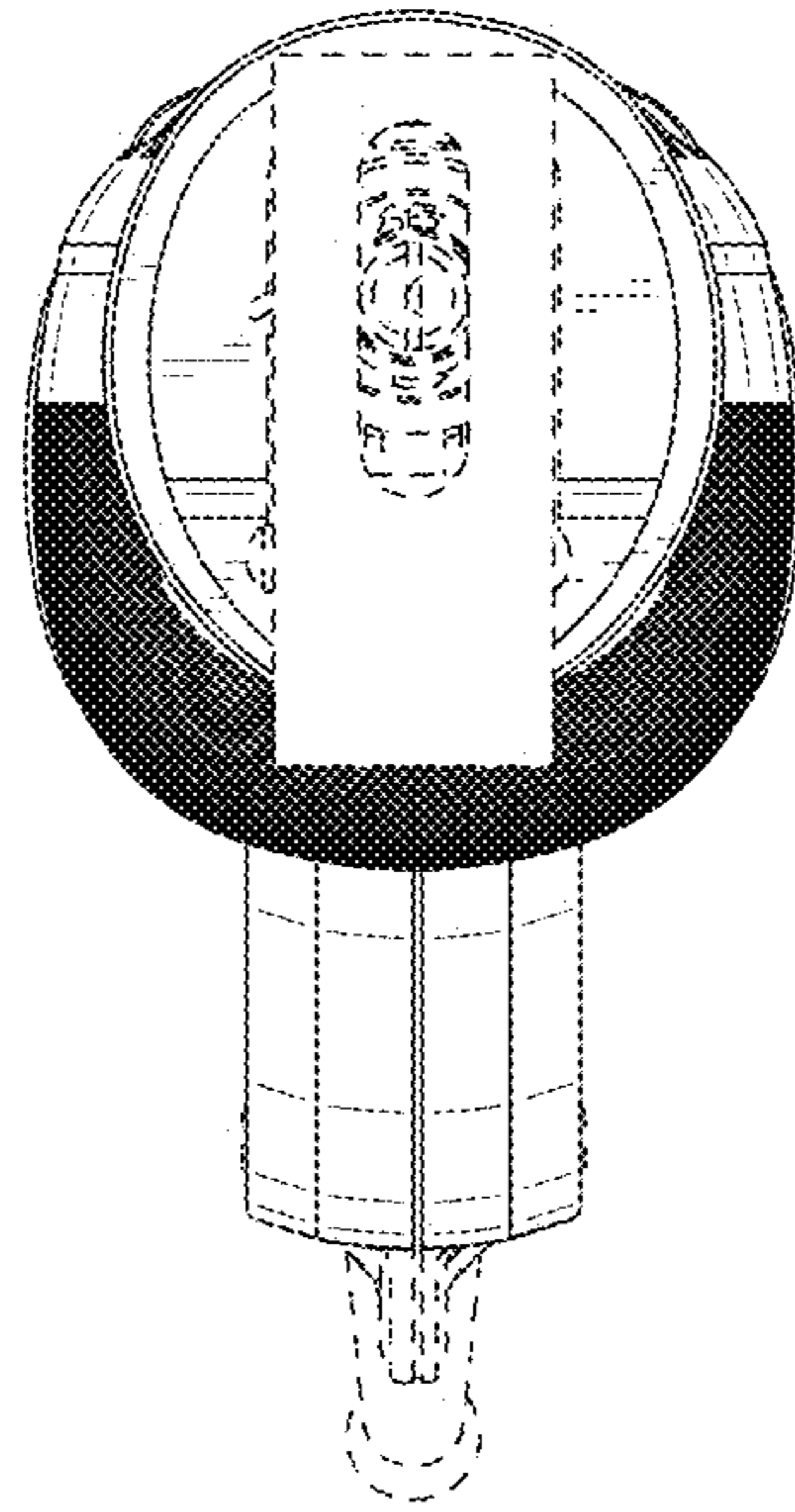

FIG. 2

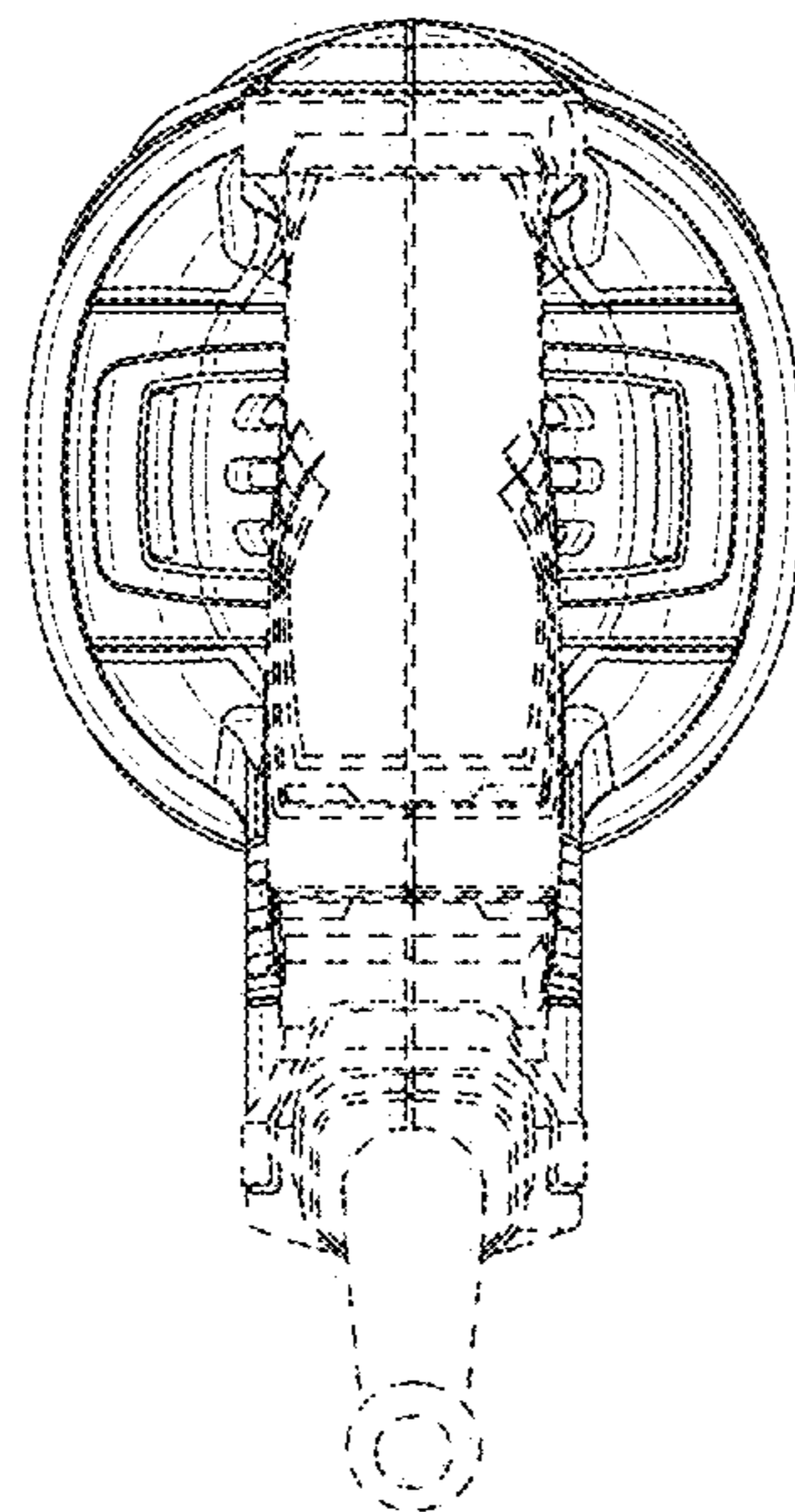

FIG. 3

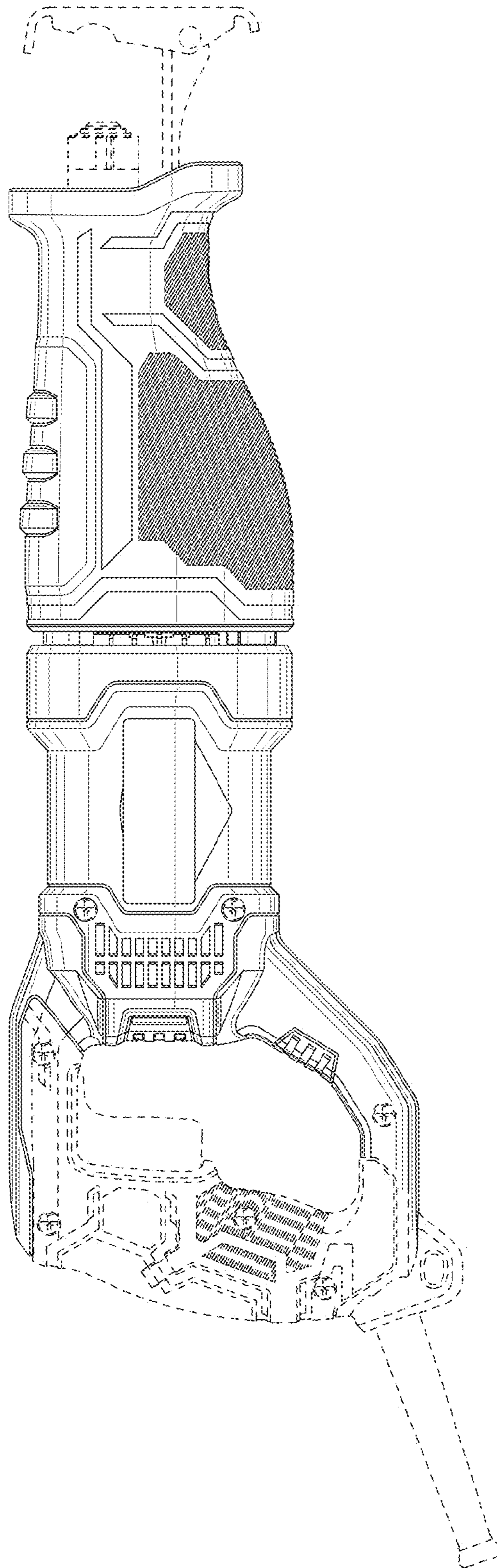

FIG. 4

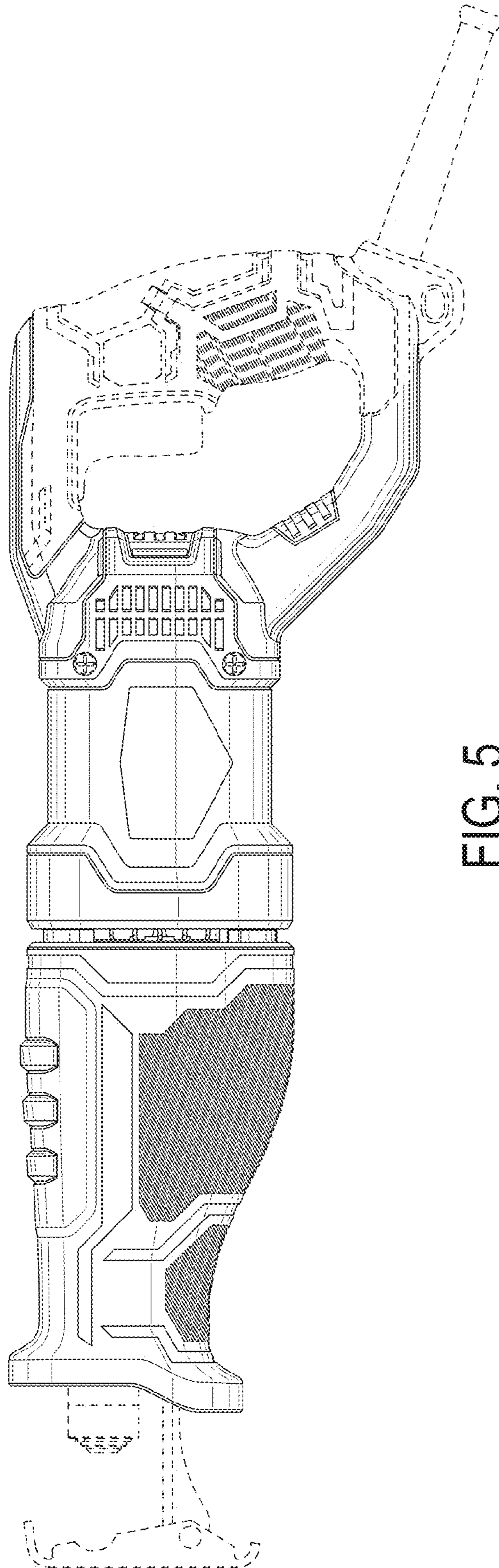

FIG. 5

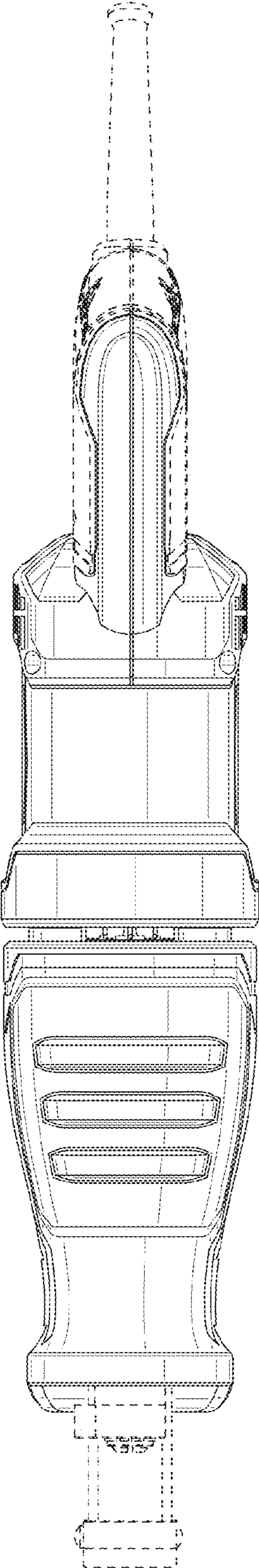

FIG. 6

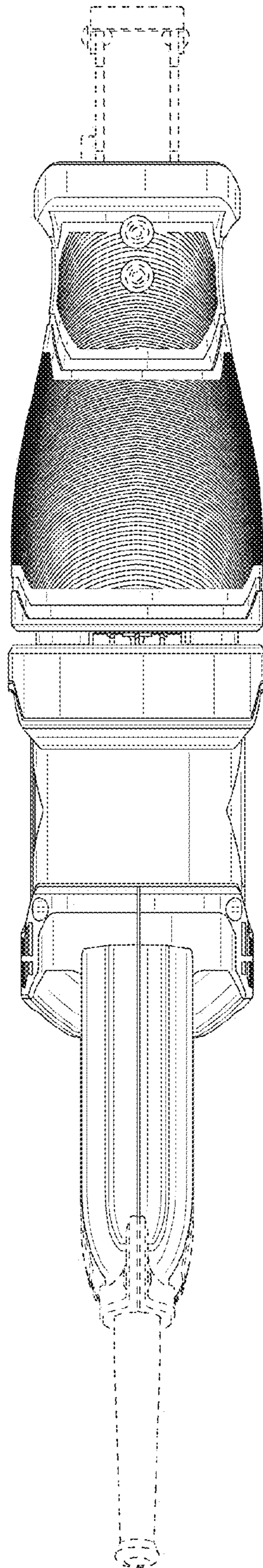

FIG. 7