



US00D900144S

(12) **United States Design Patent**  
**Lee et al.**

(10) **Patent No.:** **US D900,144 S**  
(45) **Date of Patent:** **\*\* Oct. 27, 2020**

(54) **DISPLAY SCREEN OR PORTION THEREOF WITH GRAPHICAL USER INTERFACE**

(71) Applicant: **Samsung Electronics Co., Ltd.**,  
Suwon-si (KR)  
(72) Inventors: **Bo La Lee**, Suwon-si (KR); **Yeong Seo Hong**, Suwon-si (KR)

(73) Assignee: **Samsung Electronics Co., Ltd.**,  
Suwon-si (KR)

(\*\*) Term: **15 Years**

(21) Appl. No.: **29/687,632**

(22) Filed: **Apr. 15, 2019**

(30) **Foreign Application Priority Data**

Dec. 20, 2018 (KR) ..... 30-2018-0060488

(51) **LOC (12) Cl.** ..... **14-04**

(52) **U.S. Cl.**  
USPC ..... **D14/486**

(58) **Field of Classification Search**  
USPC ..... D14/485-95  
CPC .. G06F 3/0481; G06F 3/0482; G06F 3/04812;  
G06F 3/04817; G06F 3/0484; G06F  
3/0485; G06F 3/048; G06F 3/0487; G06F  
3/0488; G06F 3/04883; G06F 3/04886;  
G06F 3/0489; G06F 3/0486; G06F  
3/04842; G06F 3/04845; G06F 3/04847  
See application file for complete search history.

(56) **References Cited**

**U.S. PATENT DOCUMENTS**

D695,776 S \* 12/2013 Edwards ..... D14/488  
D695,778 S \* 12/2013 Edwards ..... D14/488  
D717,808 S \* 11/2014 Tsuru ..... D14/485  
D725,125 S \* 3/2015 Capela ..... D14/485

D730,919 S \* 6/2015 Jeong ..... D14/485  
D730,927 S \* 6/2015 Lee ..... D14/486  
D733,162 S \* 6/2015 Aoshima ..... D14/485  
D753,142 S \* 4/2016 Hwang ..... D14/485  
D754,697 S \* 4/2016 Follett ..... D14/486  
D755,202 S \* 5/2016 Seo ..... D14/485  
D755,217 S \* 5/2016 Park ..... D14/486  
D757,040 S \* 5/2016 Zankowski ..... D14/485  
D760,254 S \* 6/2016 Seo ..... D14/486  
D760,755 S \* 7/2016 Russell ..... D14/486  
D763,893 S \* 8/2016 Kisselev ..... D14/486  
D764,488 S \* 8/2016 Bae ..... D14/485  
D764,524 S \* 8/2016 Hoang ..... D14/488  
D765,090 S \* 8/2016 Yang ..... D14/485  
D766,286 S \* 9/2016 Lee ..... D14/486  
D766,929 S \* 9/2016 Webster ..... D14/485  
D766,952 S \* 9/2016 Gedrich ..... D14/486

(Continued)

**FOREIGN PATENT DOCUMENTS**

CN 2015305649555 8/2016  
CN 201630285394X 11/2016

(Continued)

*Primary Examiner* — Melanie H Tung

(74) *Attorney, Agent, or Firm* — NSIP Law

(57) **CLAIM**

We claim the ornamental design for a display screen or portion thereof with graphical user interface, as shown and described.

**DESCRIPTION**

The sole FIGURE is a front view of a display screen or portion thereof with graphical user interface showing our new design.

The outer perimeter broken lines show a display screen or portion thereof and forms no part of the claimed design.

The remaining broken lines in the figures depict portions of the display screen or portion thereof with graphical user interface which form no part of the claimed design.

**1 Claim, 1 Drawing Sheet**

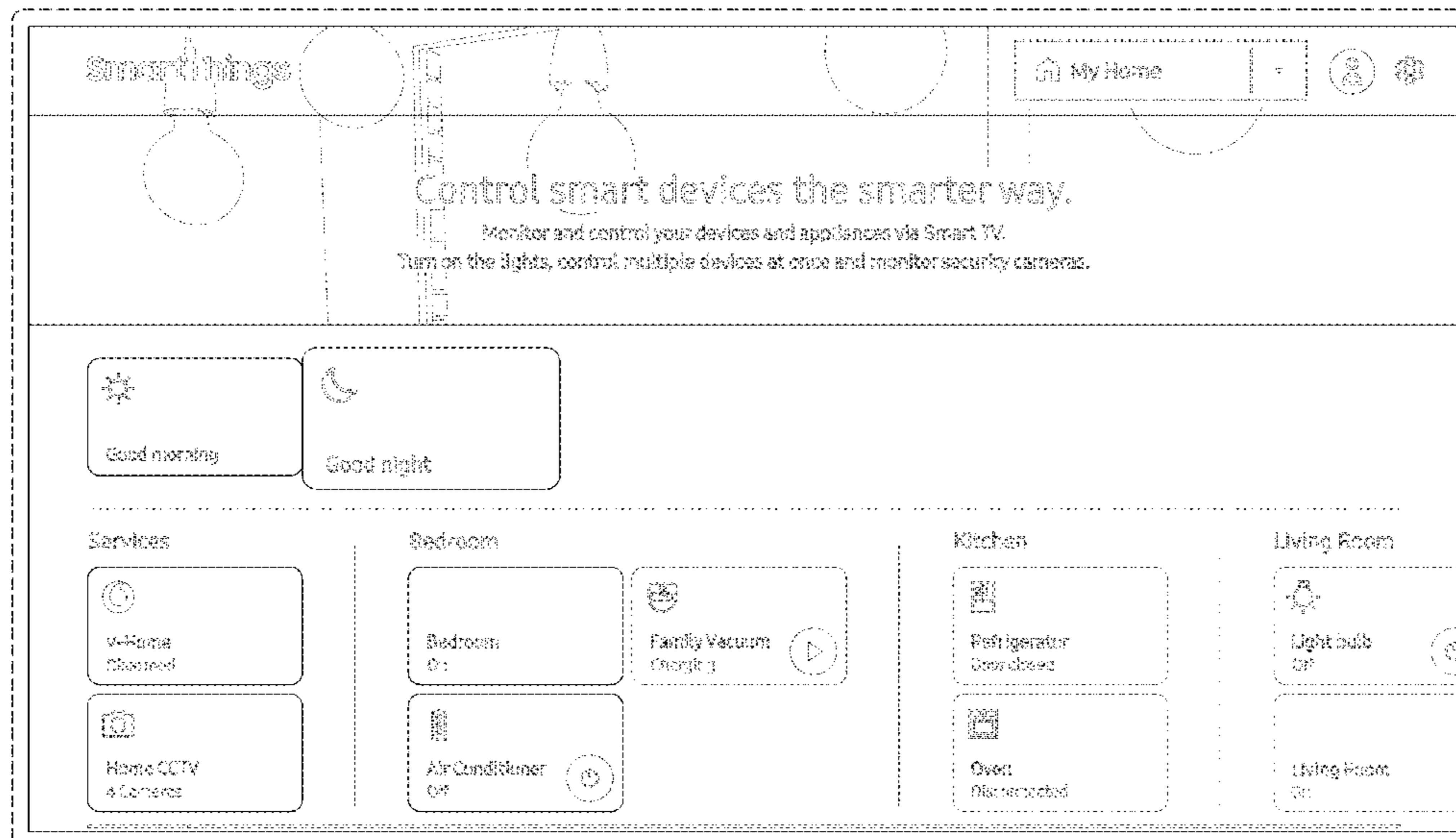

(56)

**References Cited**

U.S. PATENT DOCUMENTS

D768,160	S	*	10/2016	McRae	.....	D14/486
D768,161	S	*	10/2016	McRae	.....	D14/486
D768,662	S	*	10/2016	McRae	.....	D14/486
D768,664	S	*	10/2016	Davis	.....	D14/486
D770,462	S	*	11/2016	Gray	.....	D14/485
D771,083	S	*	11/2016	McRae	.....	D14/486
D773,495	S	*	12/2016	McRae	.....	D14/486
D774,069	S	*	12/2016	Gardner	.....	D14/486
D774,531	S	*	12/2016	Righter	.....	D14/486
D789,388	S	*	6/2017	Gedrich	.....	D14/486
D793,419	S	*	8/2017	Gedrich	.....	D14/486
D808,423	S	*	1/2018	Jiang	.....	D14/492
D809,003	S	*	1/2018	Sowden	.....	D14/488
D823,870	S	*	7/2018	Yan	.....	D14/486
D829,234	S	*	9/2018	Yuguchi	.....	D14/486
D831,694	S	*	10/2018	Chu	.....	D14/488
D843,384	S	*	3/2019	Smith	.....	D14/485
D863,344	S	*	10/2019	Ashworth	.....	D14/488
D877,186	S	*	3/2020	Parks	.....	D14/488
D880,518	S	*	4/2020	Martell	.....	D14/488
D882,586	S	*	4/2020	Jaini	.....	D14/485
D885,410	S	*	5/2020	Butler	.....	D14/485

FOREIGN PATENT DOCUMENTS

CN	2016300261054	3/2017
CN	2017305178221	6/2018
CN	2017304603426	7/2018

\* cited by examiner

