



US00D899889S

(12) **United States Design Patent** (10) **Patent No.:** **US D899,889 S**  
**Eads** (45) **Date of Patent:** **\*\* Oct. 27, 2020**

(54) **KNOB** 1,830,383 A \* 11/1931 Bos ..... E05B 1/0061  
74/558.5  
(71) Applicant: **DELTA FAUCET COMPANY,** D511,931 S \* 11/2005 Sano ..... D7/393  
Indianapolis, IN (US) D680,406 S \* 4/2013 Ramsland ..... D8/305  
D680,407 S \* 4/2013 Ramsland ..... D8/307  
(72) Inventor: **Thad Eads,** Urbana, IN (US) D680,848 S \* 4/2013 Jou ..... D8/305  
D772,684 S \* 11/2016 Zimmer ..... D8/307  
(73) Assignee: **DELTA FAUCET COMPANY,** D787,296 S \* 5/2017 Zimmer ..... D8/307  
Indianapolis, IN (US) D833,056 S \* 11/2018 Sonneman ..... D26/86  
D854,909 S \* 7/2019 Wells ..... D8/315  
D867,101 S \* 11/2019 Minale ..... D8/307  
(\*\*) Term: **15 Years** D875,894 S \* 2/2020 Eads ..... D23/253  
D883,480 S \* 5/2020 Leibowitz ..... D24/133  
(21) Appl. No.: **29/683,520** 2010/0288087 A1 \* 11/2010 Lai ..... B25G 1/085  
81/490

(22) Filed: **Mar. 13, 2019**  
(51) **LOC (12) Cl.** ..... **08-06**  
(52) **U.S. Cl.**  
USPC ..... **D8/307**  
(58) **Field of Classification Search**  
USPC ..... D8/300, 307, 310; D7/393; D23/250,  
D23/252, 254  
CPC ... Y10T 292/57; Y10T 16/469; Y10T 292/82;  
Y10T 74/2084; Y10T 292/85; Y10T  
16/458; Y10T 16/506; Y10T 70/5155;  
Y10T 16/46; Y10T 16/4559; Y10T  
74/20828; Y10T 70/8541; Y10T  
74/20612; Y10T 16/459; Y10T 16/487;  
Y10T 70/5389; Y10T 16/462; Y10T  
16/4636; E05B 1/0007; E05B 3/00; Y10S  
16/30; Y10S 292/53; Y10S 292/27  
See application file for complete search history.

(56) **References Cited**  
U.S. PATENT DOCUMENTS  
742,448 A \* 10/1903 Konrad ..... E05B 1/0015  
16/412  
1,611,999 A \* 12/1926 Cummins ..... E05B 3/06  
292/356

\* cited by examiner  
*Primary Examiner* — Lauren R Calve  
(74) *Attorney, Agent, or Firm* — Nirav D. Parikh; Edgar  
A. Zarins

(57) **CLAIM**  
The ornamental design for a knob, as shown and described.

**DESCRIPTION**  
FIG. 1 is a front perspective view of a knob showing my new design;  
FIG. 2 is a rear perspective view thereof;  
FIG. 3 is a front elevational view thereof;  
FIG. 4 is a left side view thereof;  
FIG. 5 is a rear view thereof;  
FIG. 6 is a right side view thereof;  
FIG. 7 is a top plan view thereof; and,  
FIG. 8 is a bottom view thereof.

**1 Claim, 4 Drawing Sheets**

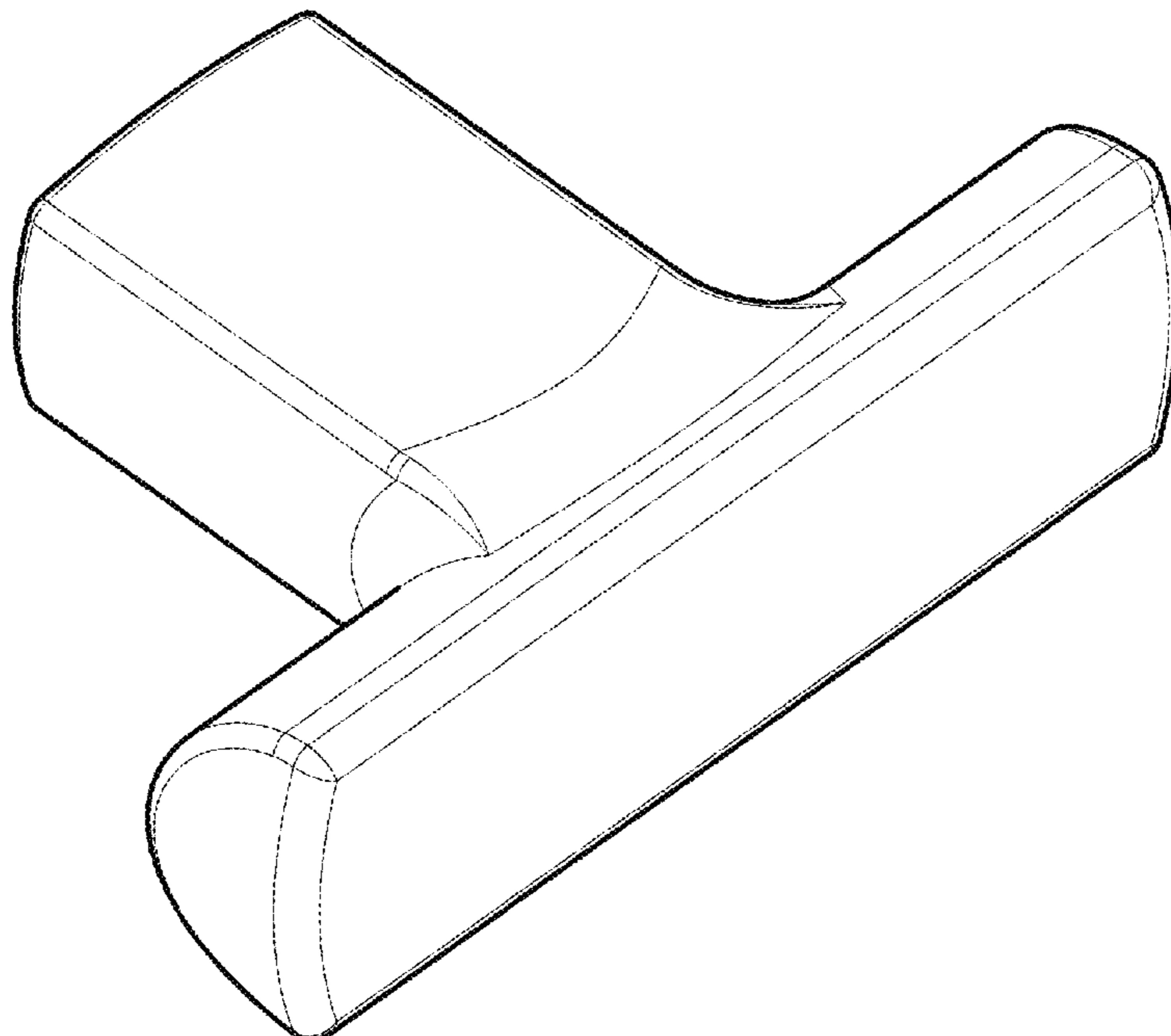

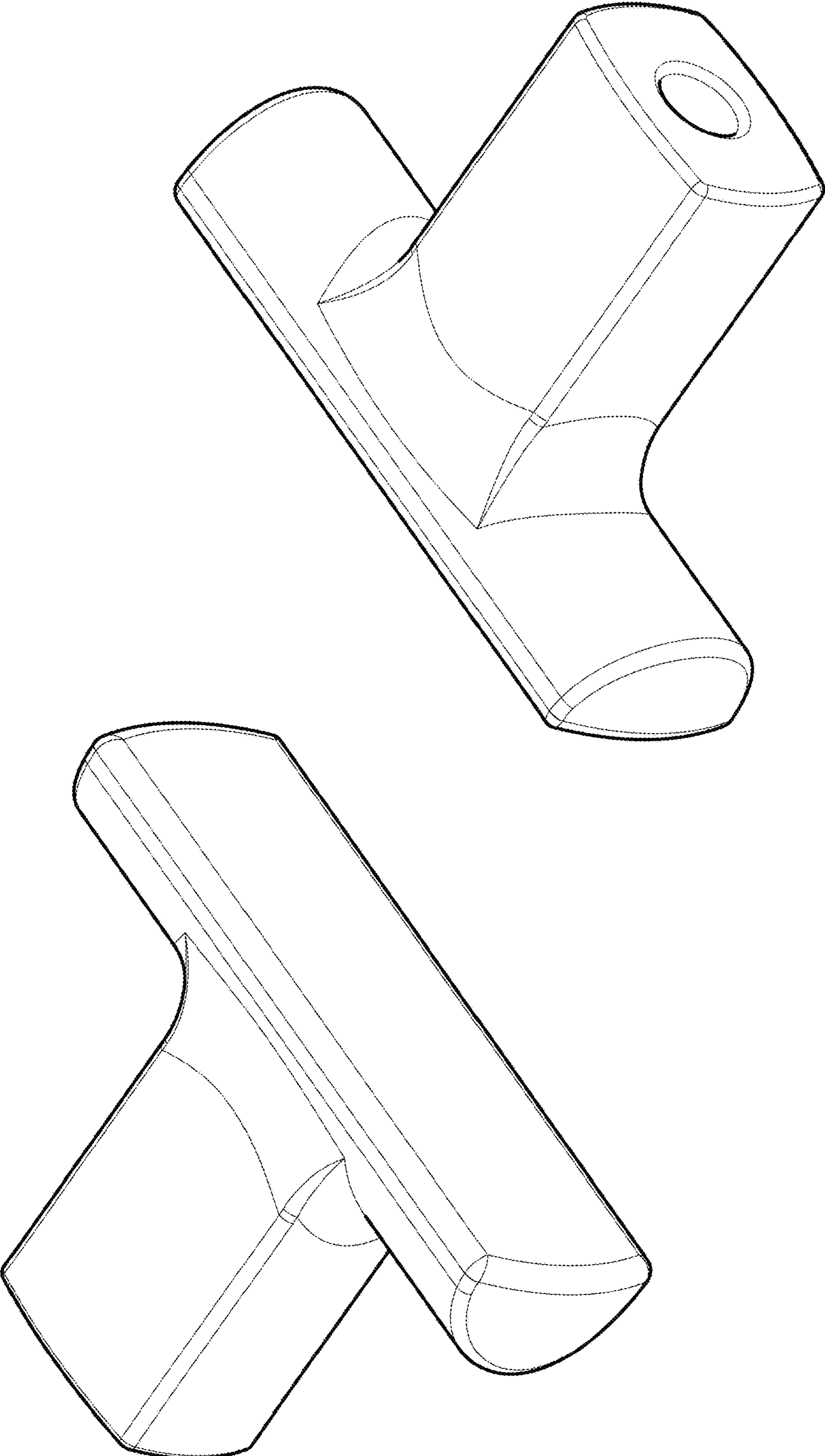

FIG - 2

FIG - 1

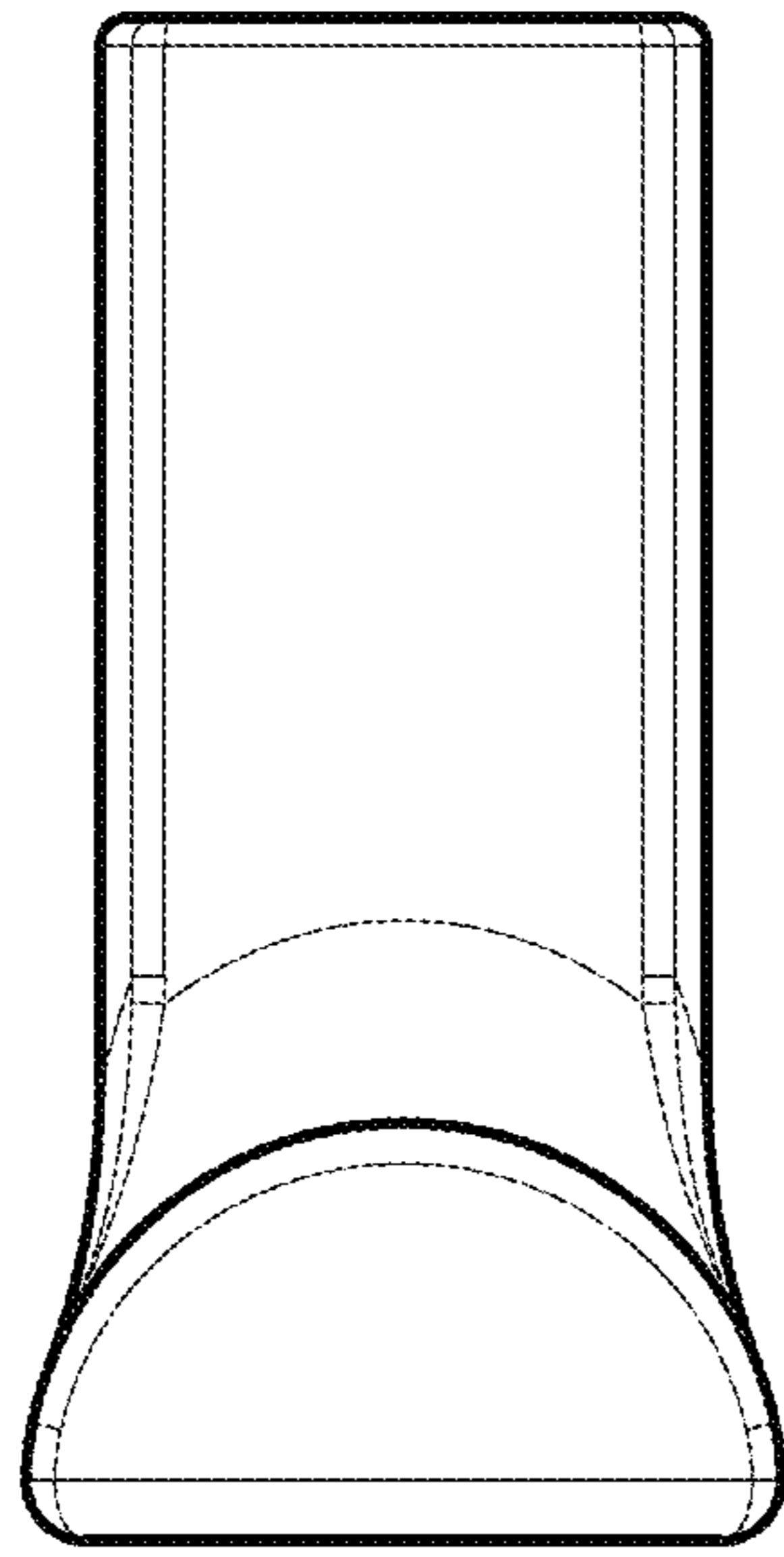

FIG - 4

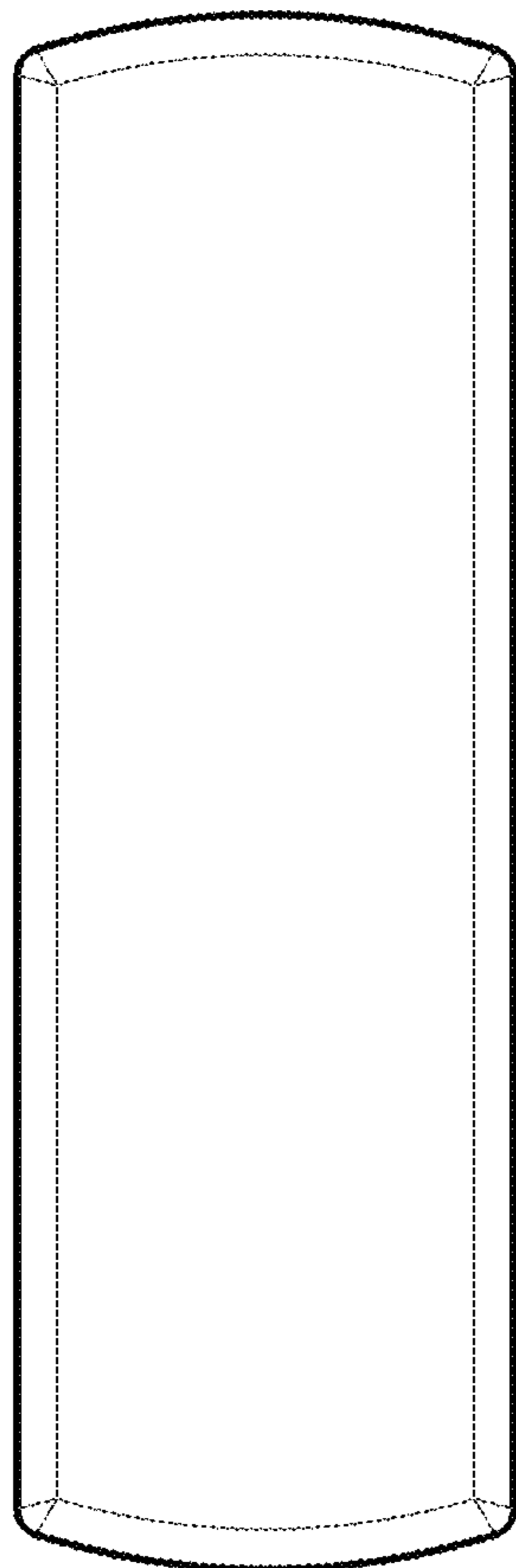

FIG - 3

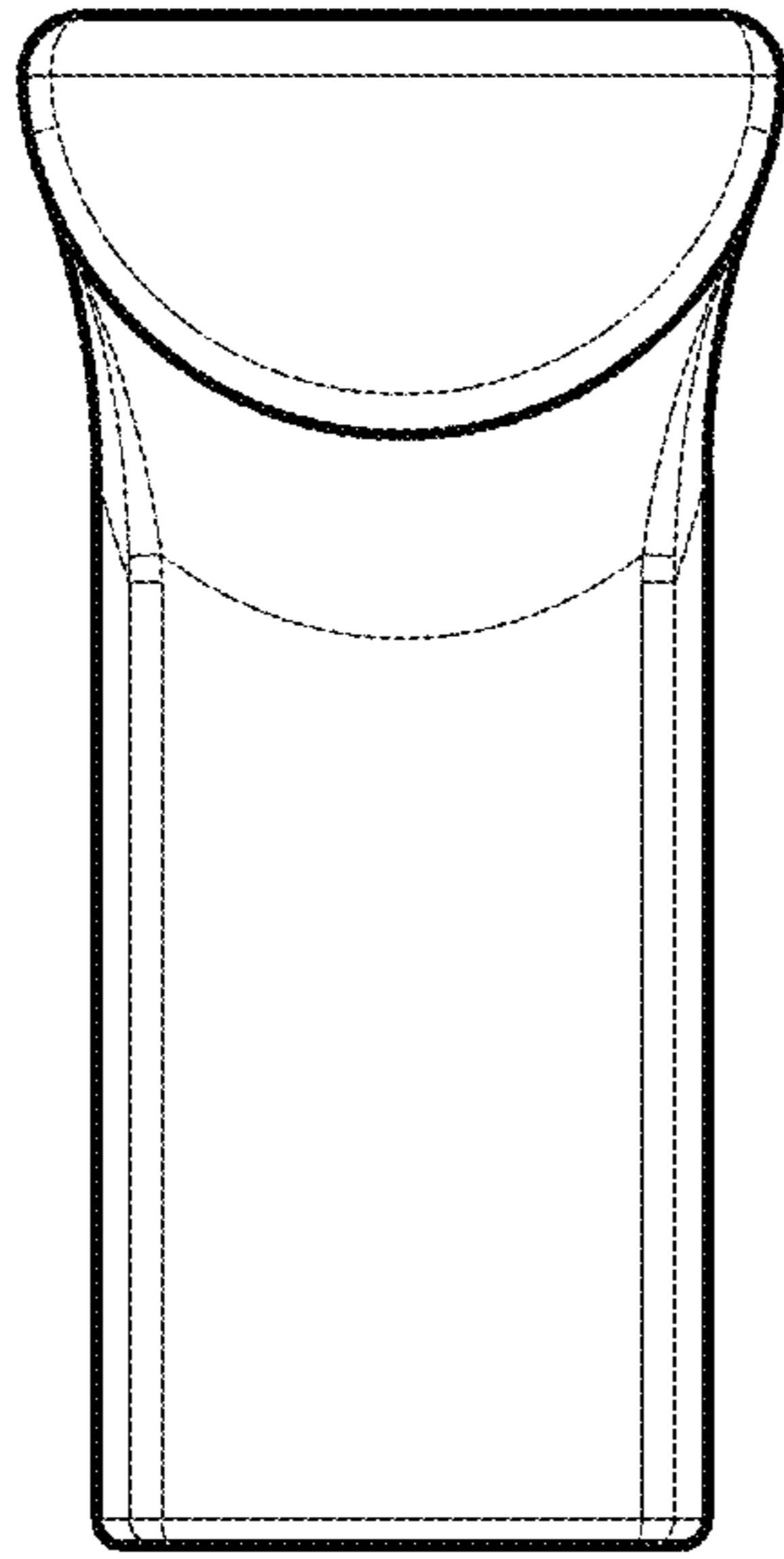

FIG - 6

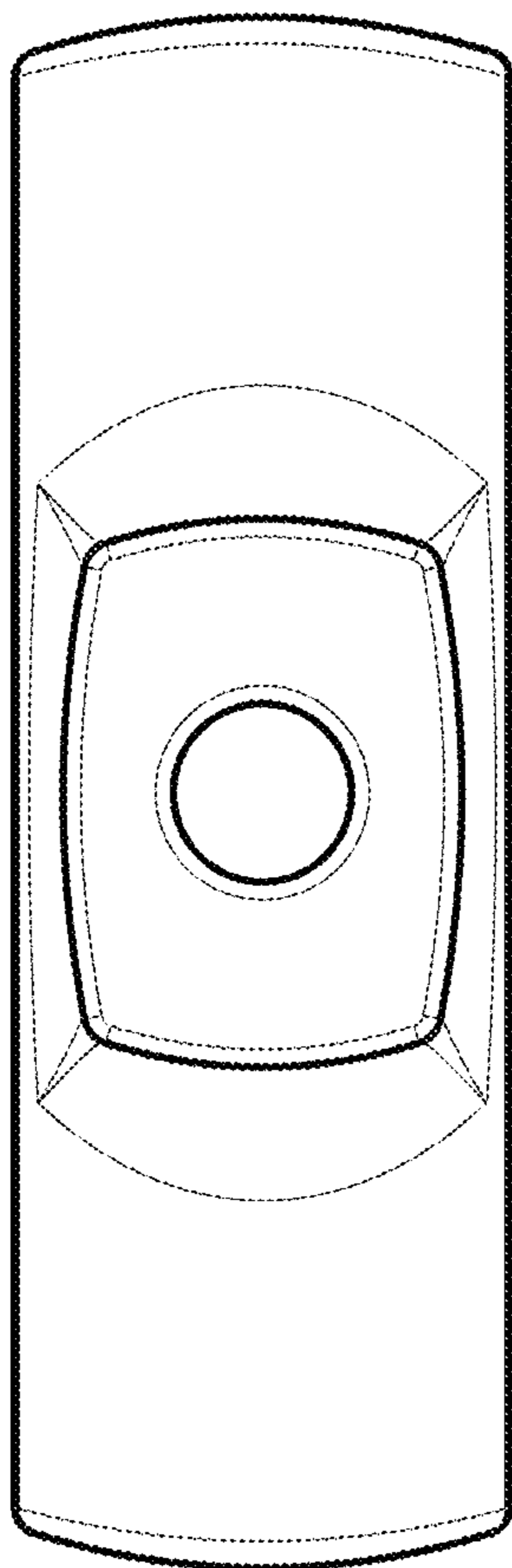

FIG - 5

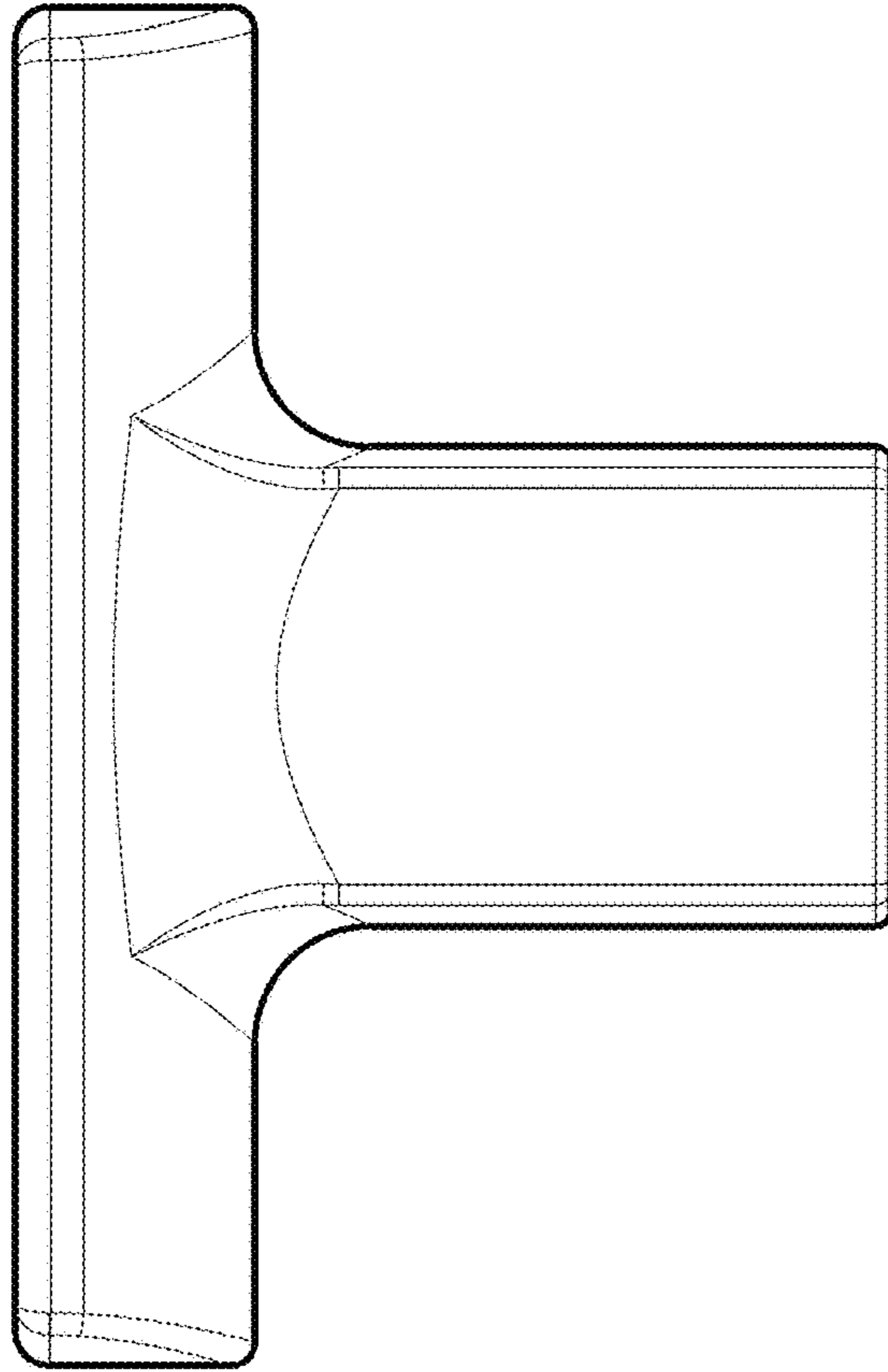

FIG - 8

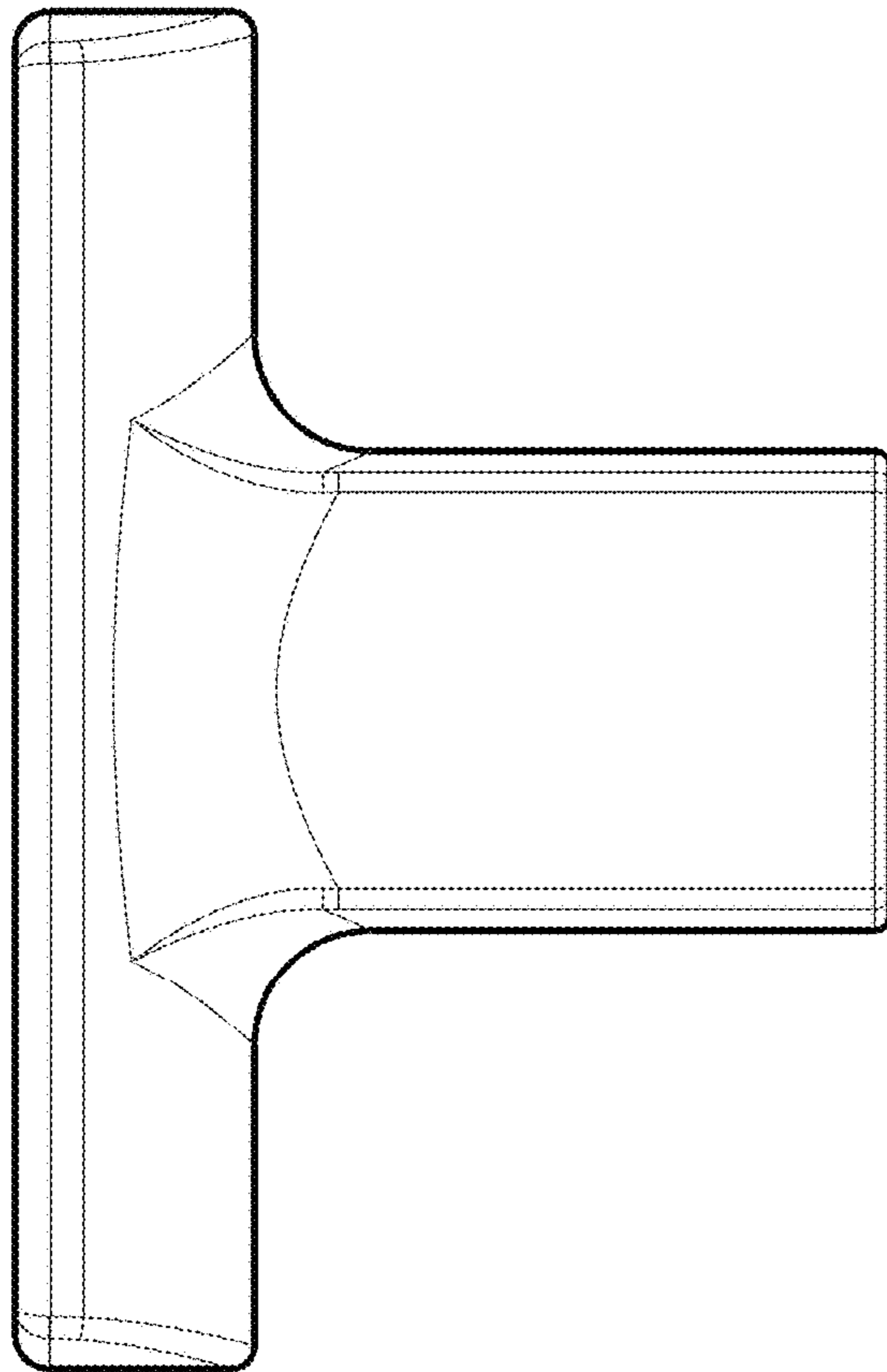

FIG - 7