



US00D898637S

(12) **United States Design Patent** (10) **Patent No.:** **US D898,637 S**
Van Osten et al. (45) **Date of Patent:** **** Oct. 13, 2020**

(54) **SHIFT CABLE BUSHING**
(71) Applicant: **RB Distribution Inc.**, Colmar, PA (US)
(72) Inventors: **Christopher Thomas Van Osten**,
Souderton, PA (US); **John T. Malone, III**,
Hillsborough, NJ (US); **Joseph W. Lonergan, III**,
Lansdale, PA (US)
(73) Assignee: **RB Distribution, Inc.**, Colmar, PA
(US)

6,675,546 B2 1/2004 Coles
D510,259 S * 10/2005 Yoshimoto D8/397
8,771,000 B2 7/2014 Melni
D719,821 S 12/2014 McGrath
D746,129 S * 12/2015 Kishida D8/399
9,518,649 B2 12/2016 Tanaka
9,556,925 B2 1/2017 Marking
D786,056 S * 5/2017 Baiz D8/387
D787,924 S * 5/2017 Baiz D8/387
9,650,779 B2 * 5/2017 Tello E04B 1/2403

(Continued)

(**) Term: **15 Years**
(21) Appl. No.: **29/698,368**
(22) Filed: **Jul. 16, 2019**

Related U.S. Application Data

(63) Continuation of application No. 29/612,491, filed on
Aug. 1, 2017, now Pat. No. Des. 862,329.
(51) **LOC (12) Cl.** **12-16**
(52) **U.S. Cl.**
USPC **D12/180**
(58) **Field of Classification Search**
USPC D12/180, 123, 179, 202, 213, 223, 400,
D12/207, 208; D8/387, 397, 399, 21-29,
D8/97, 107, 382, 388, 391, 393
CPC E04B 1/2403; F16F 9/464; F16F 9/537;
F16B 7/185; B25B 13/465; F16C
11/0614; B63H 20/20
See application file for complete search history.

(56) **References Cited**

U.S. PATENT DOCUMENTS

D267,627 S * 1/1983 Hultin D8/387
4,872,361 A 10/1989 Muller
5,597,566 A 1/1997 Huls
5,626,062 A 5/1997 Colvin
6,196,362 B1 3/2001 Daugherty, Jr.
6,416,367 B1 7/2002 Goebel

OTHER PUBLICATIONS

The disclosed photograph shows an original equipment Toyota shift
cable bushing.

Primary Examiner — Susan E Krakower
Assistant Examiner — Jerry Shiuan-Hua Hsu
(74) *Attorney, Agent, or Firm* — Volpe and Koenig, P.C.

(57) **CLAIM**

The ornamental design for a shift cable bushing, as shown
and described.

DESCRIPTION

FIG. 1 is a perspective view of our shift cable bushing;
FIG. 2 is a front elevation of the shift cable bushing in FIG.
1;
FIG. 3 is a rear elevation of the shift cable bushing in FIG.
1;
FIG. 4 is a right side elevation of the shift cable bushing in
FIG. 1;
FIG. 5 is a left side elevation of the shift cable bushing in
FIG. 1;
FIG. 6 is a top plan view of the shift cable bushing in FIG.
1; and,
FIG. 7 is a bottom plan view of the shift cable bushing in
FIG. 1.
The broken lines illustrate portions of the shift cable bushing
that form no part of the claimed design.

1 Claim, 5 Drawing Sheets

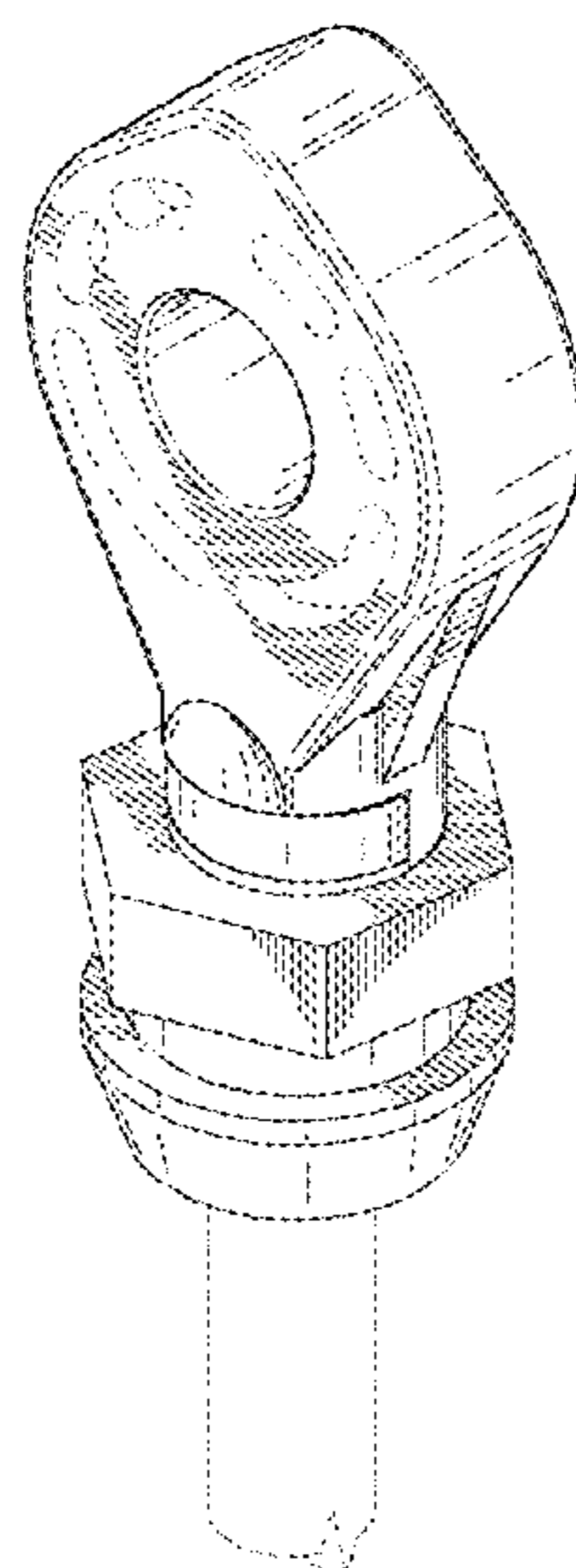

(56)

References Cited

U.S. PATENT DOCUMENTS

9,863,138	B2	1/2018	Tello	
D862,329	S *	10/2019	Van Osten D12/180
2006/0060032	A1	3/2006	Baker	
2009/0294231	A1 *	12/2009	Carlson F16F 9/537 188/267.2
2010/0047010	A1	2/2010	Halcom	
2013/0001030	A1 *	1/2013	Goldasz F16F 9/464 188/313

* cited by examiner

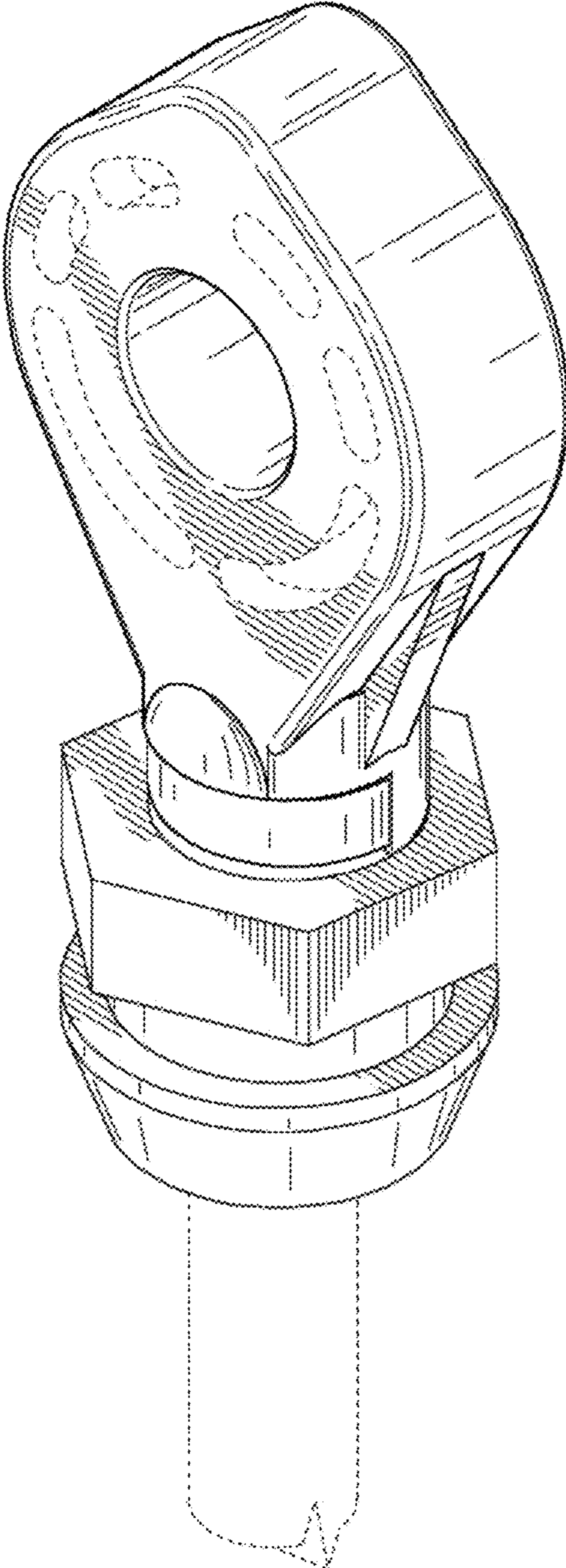

FIG. 1

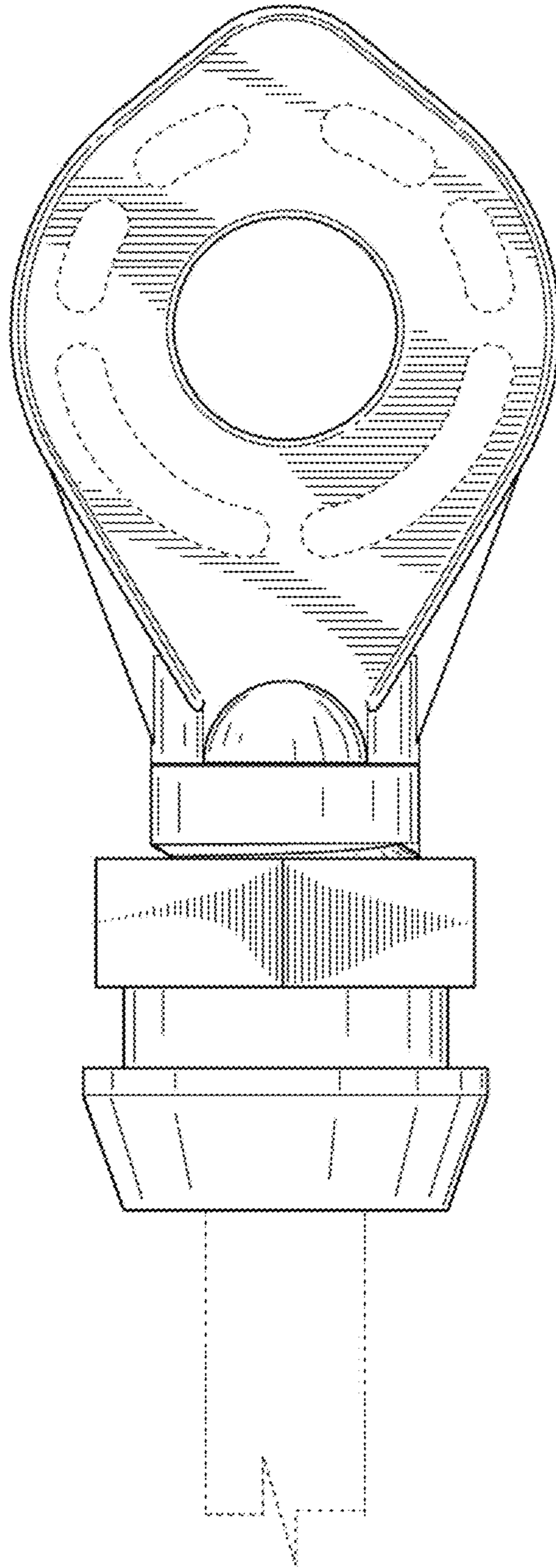

FIG. 2

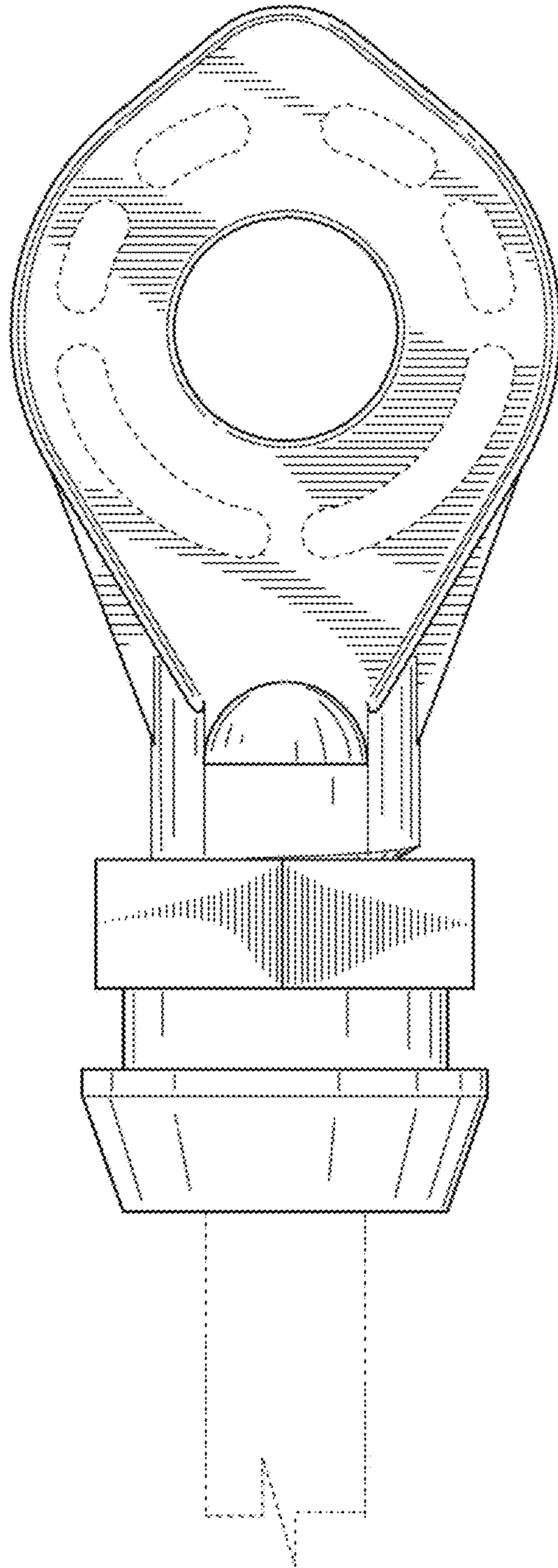

FIG. 3

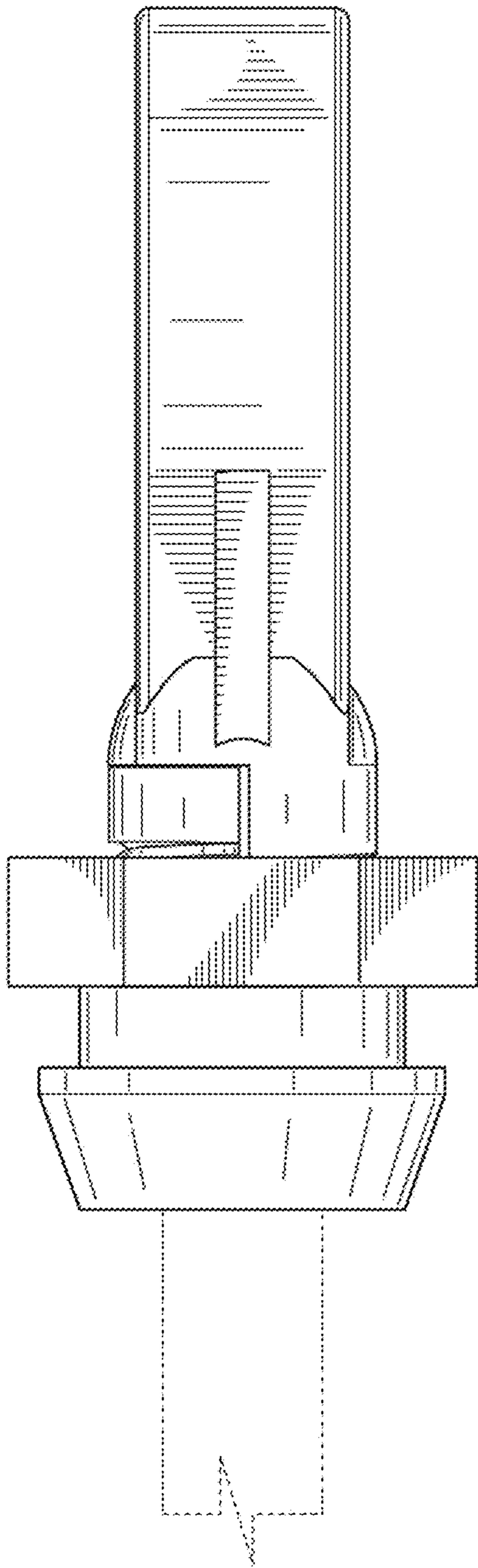

FIG. 4

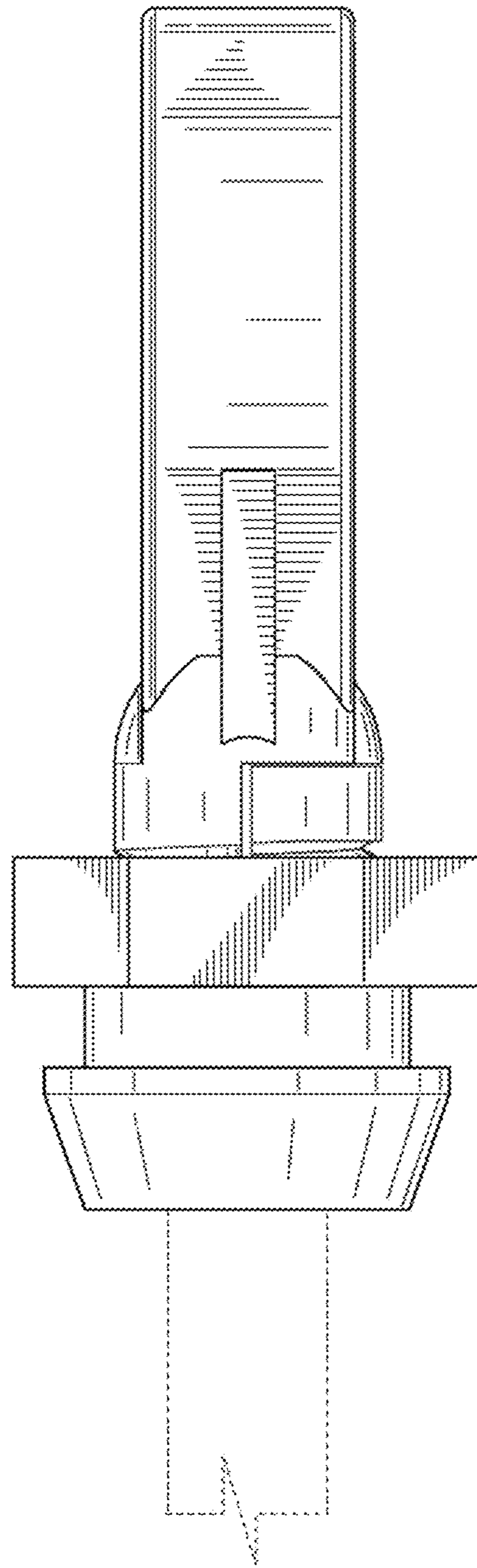

FIG. 5

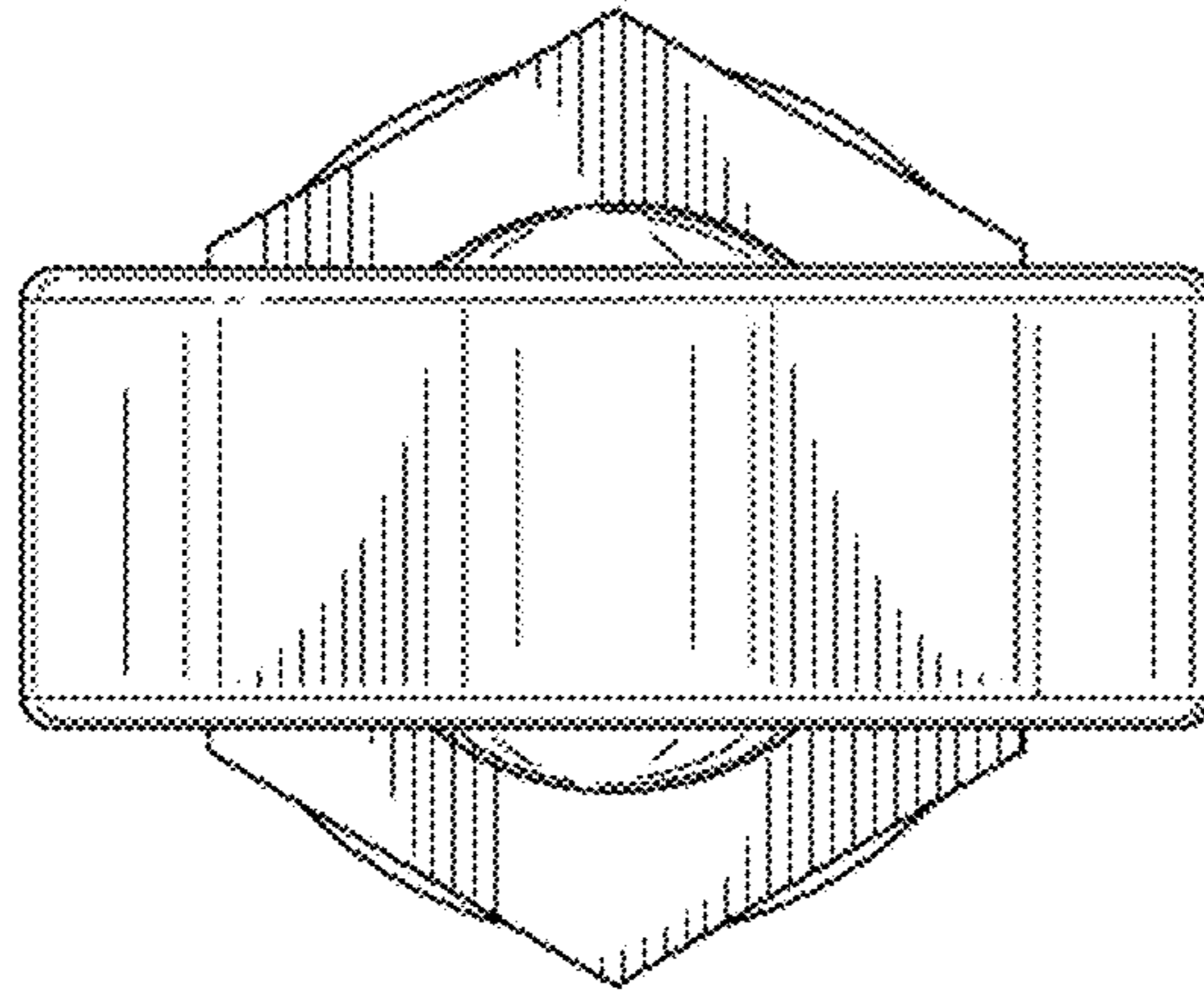

FIG. 6

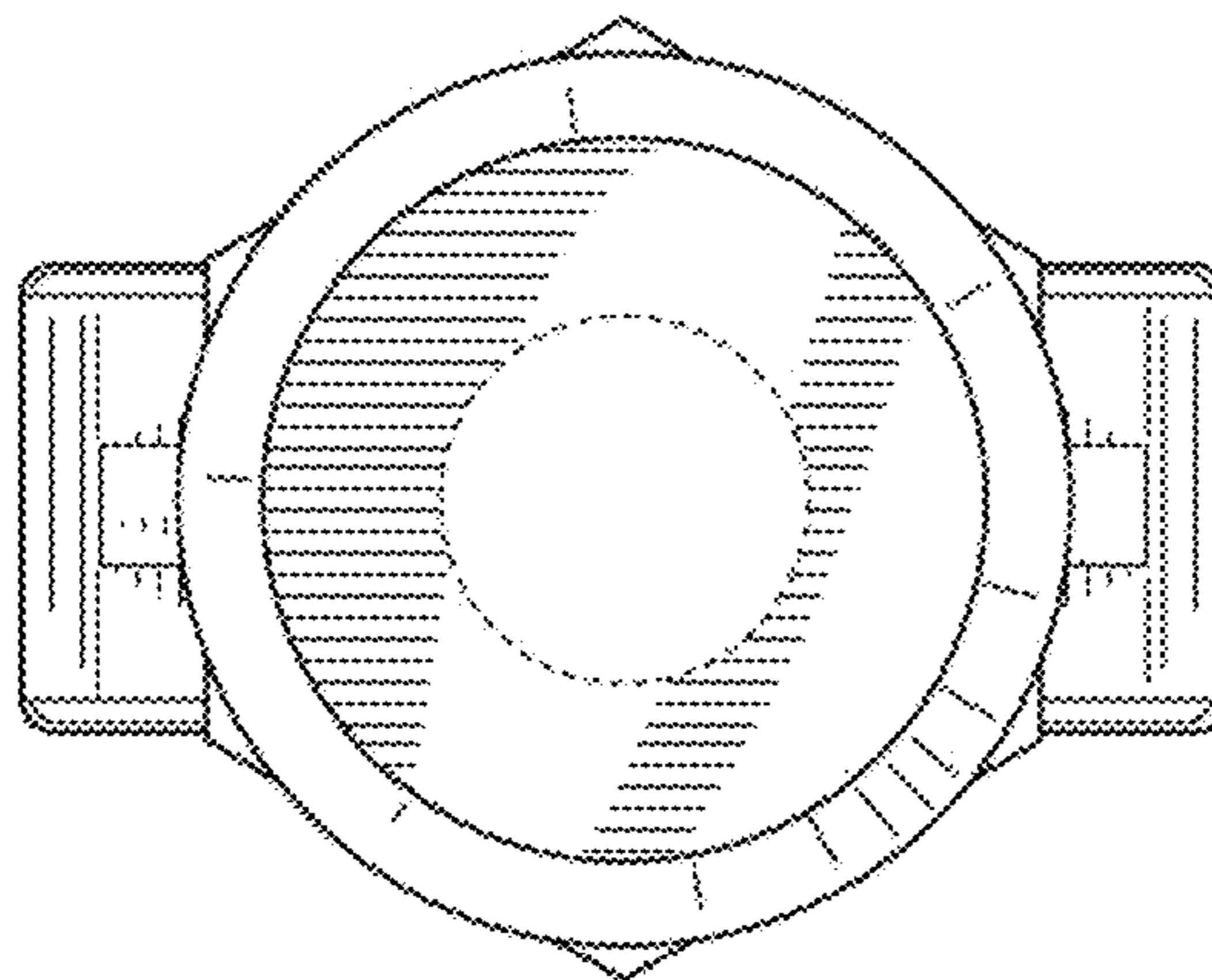

FIG. 7