

US00D898508S

(12) **United States Design Patent** (10) **Patent No.:** **US D898,508 S**
Barberi (45) **Date of Patent:** **** Oct. 13, 2020**

(54) **ELONGATED SIDE HANDLE FOR COOKWARE**

(71) Applicant: **Meyer Intellectual Properties Limited**, Kowloon (HK)

(72) Inventor: **Philip D. Barberi**, Vallejo, CA (US)

(73) Assignee: **MEYER INTELLECTUAL PROPERTIES LIMITED**, Hong Kong (CN)

(**) Term: **15 Years**

(21) Appl. No.: **29/661,725**

(22) Filed: **Aug. 30, 2018**

(51) **LOC (12) Cl.** **07-99**

(52) **U.S. Cl.**
USPC **D7/393**

(58) **Field of Classification Search**
USPC D7/354-361, 393-395, 664, 401.2;
D8/107, 300, 303, 307, 308, 321;
D4/138, 129
CPC A47J 45/06; A47J 45/061; A47J 45/62;
A47J 45/071; A47J 45/072; A47J 45/08;
A47J 45/085

See application file for complete search history.

(56) **References Cited**

U.S. PATENT DOCUMENTS

D297,902 S *	10/1988	Ryan	D7/395
D482,567 S *	11/2003	Demers	D7/395
D615,810 S *	5/2010	Munari	D7/395
D618,051 S *	6/2010	Munari	D7/395
D693,636 S *	11/2013	Sweet	D7/395
D693,638 S *	11/2013	Sweet	D7/395
D713,677 S *	9/2014	Rae	D7/395
D713,681 S *	9/2014	Rae	D7/395
D724,378 S *	3/2015	Munari	D7/395

D724,379 S *	3/2015	Munari	D7/395
D740,604 S *	10/2015	Barberi	D7/395
D779,874 S *	2/2017	Barberi	D7/395
D783,343 S *	4/2017	Barberi	D7/395
D795,638 S *	8/2017	Barberi	D7/395
D804,242 S *	12/2017	Barberi	D7/395
D809,337 S *	2/2018	Chen	D7/395
D824,211 S *	7/2018	Kastner	D7/395
D831,418 S *	10/2018	Kastner	D7/395
D832,034 S *	10/2018	Munari	D7/395
D833,808 S *	11/2018	Kastner	D7/395
D839,046 S *	1/2019	Munari	D7/395
D874,871 S *	2/2020	Barberi	D7/395
D877,562 S *	3/2020	Gabbay	D7/395

* cited by examiner

Primary Examiner — Susan E Krakower

Assistant Examiner — Andrew Kerr

(74) *Attorney, Agent, or Firm* — Edward S. Sherman

(57) **CLAIM**

The ornamental design for an elongated side handle for cookware, as shown and described.

DESCRIPTION

FIG. 1 is a perspective view of a elongated side handle for cookware, showing my new design;
FIG. 2 is a right side elevational view thereof, being the mirror image of the left side elevation view;
FIG. 3 is a top plan view thereof;
FIG. 4 is a bottom plan view thereof;
FIG. 5 is a front elevation thereof;
FIG. 6 is a back elevation view thereof; and,
FIG. 7 is a cross-sectional side elevational view taken at section line 7-7 in FIG. 3.

The broken lines in FIGS. 1-7 depict a portion of the elongated handle for cookware that forms no part of the claimed design.

1 Claim, 4 Drawing Sheets

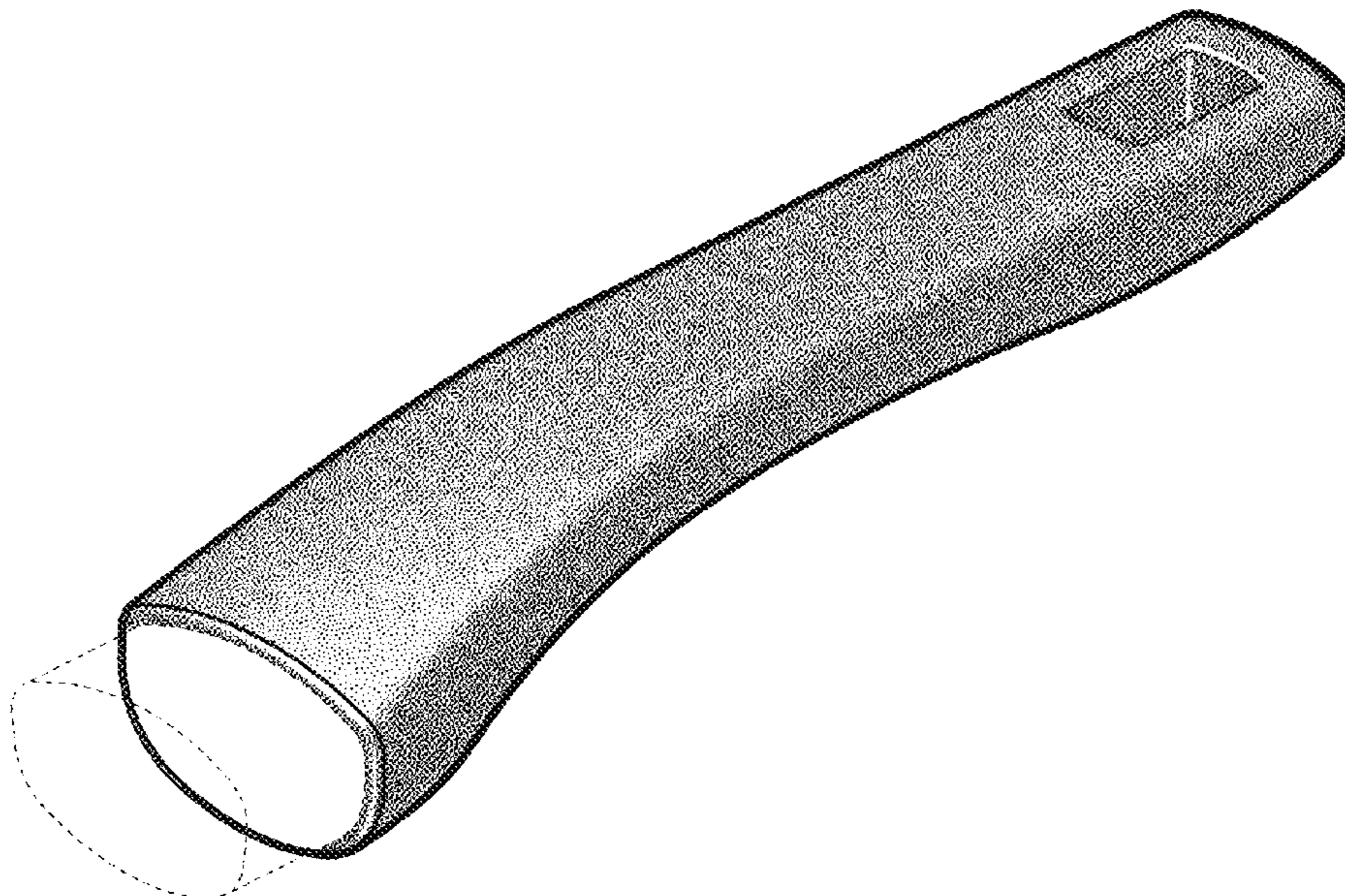

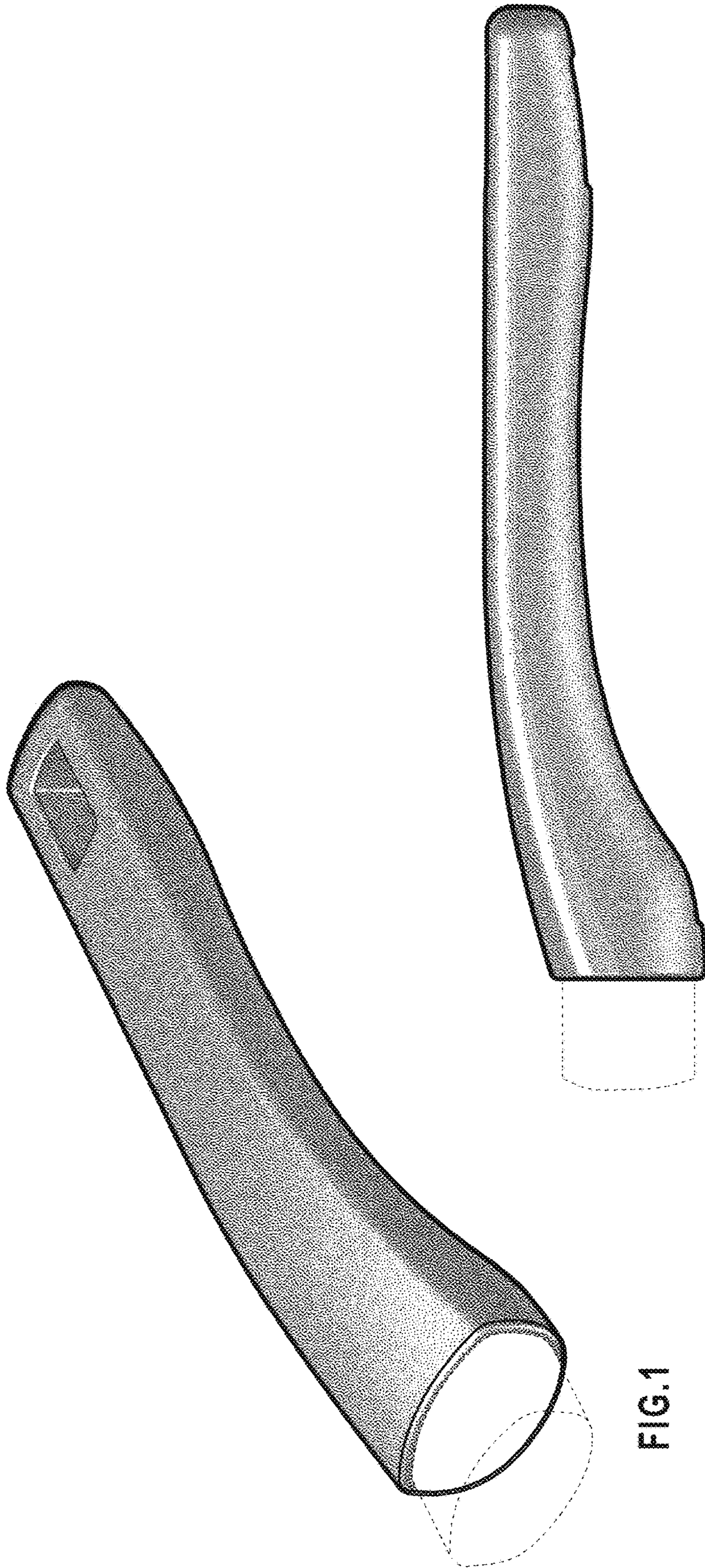
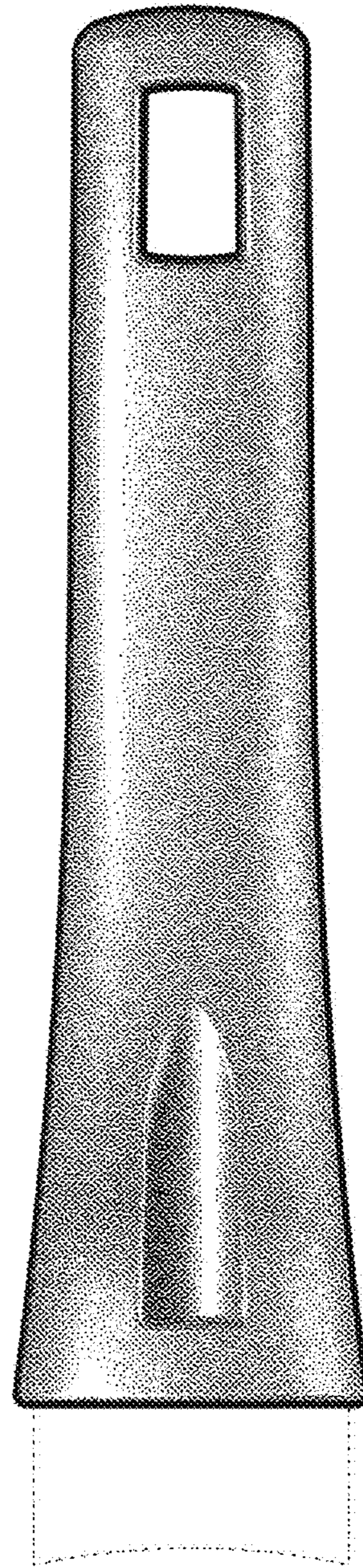
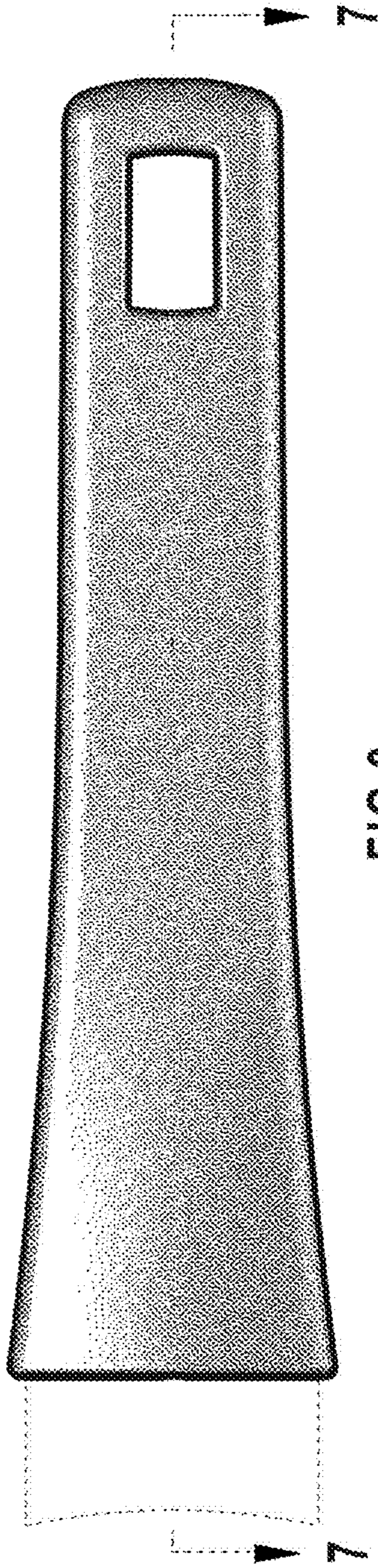

FIG.1

FIG.2



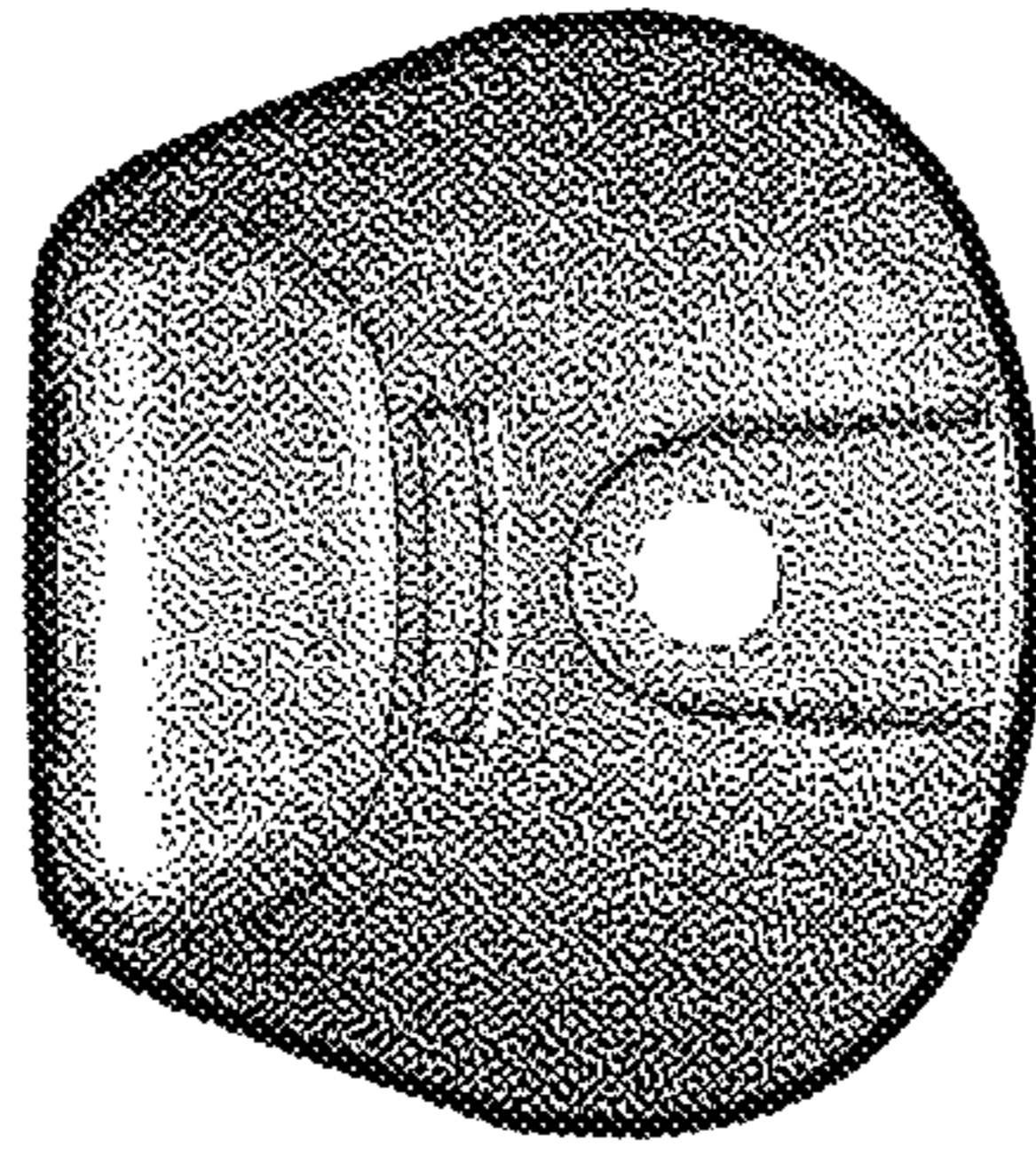

FIG. 6

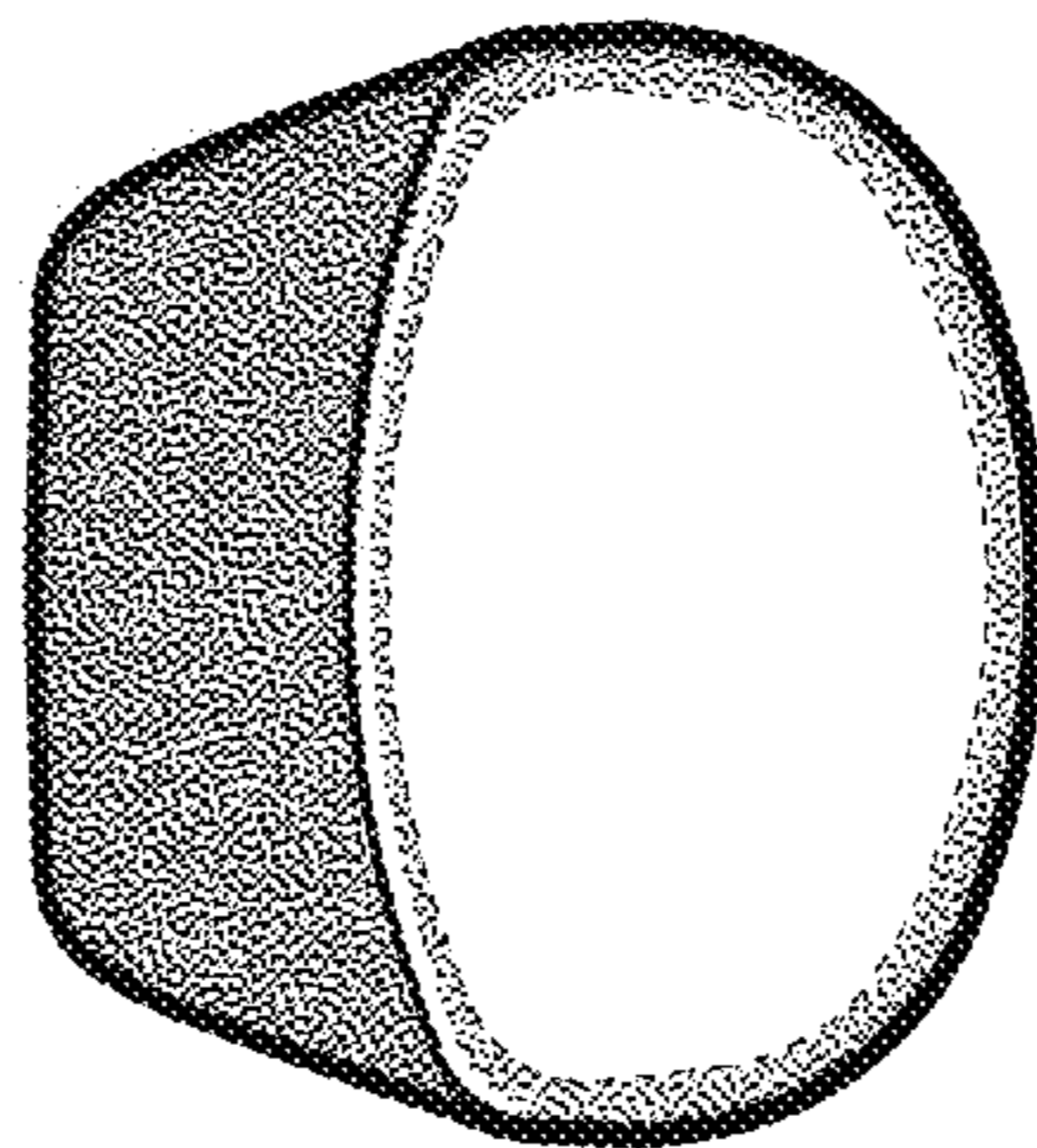

FIG. 5

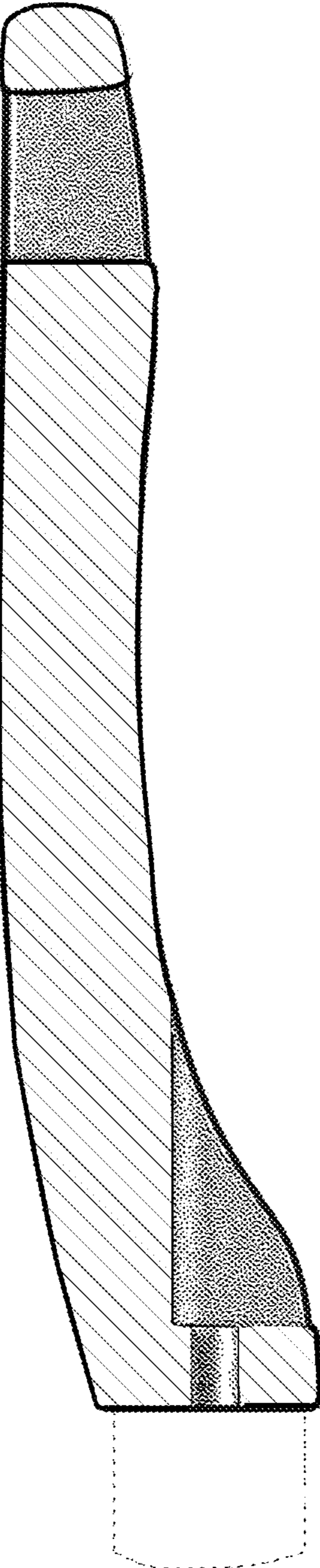

FIG.7