



US00D898019S

(12) **United States Design Patent**  
**Fiore, IV**

(10) **Patent No.:** **US D898,019 S**

(45) **Date of Patent:** **\*\* Oct. 6, 2020**

(54) **AUTO STEREO MOUNTING DEVICE**

D489,031 S \* 4/2004 Leibman ..... D12/193  
6,956,628 B2 \* 10/2005 Huang ..... B60R 11/0235

(71) Applicant: **Metra Electronics Corporation**, Holly Hill, FL (US)

349/149

D602,930 S \* 10/2009 Quilling, II ..... D14/258

D824,307 S \* 7/2018 Spencer ..... D12/193

D863,166 S \* 10/2019 Summers ..... D12/192

(72) Inventor: **Anthony Fiore, IV**, Holly Hill, FL (US)

\* cited by examiner

(73) Assignee: **Metra Electronics Corporation**, Holly Hill, FL (US)

*Primary Examiner* — Sandra L Morris

(74) *Attorney, Agent, or Firm* — J. Wiley Horton

(\*\*) Term: **15 Years**

(21) Appl. No.: **29/703,525**

(57) **CLAIM**

The ornamental design for an “auto stereo mounting device,” as shown and described.

(22) Filed: **Aug. 28, 2019**

(51) **LOC (12) Cl.** ..... **14-03**

(52) **U.S. Cl.**  
USPC ..... **D14/258**

**DESCRIPTION**

(58) **Field of Classification Search**  
USPC ..... D12/192–193, 195, 415, 420; D14/496,  
D14/498–506, 154, 157, 168–171,  
D14/188–198, 257–258; 248/27.1, 27.3,  
248/558  
CPC ..... B60R 11/02; B60K 37/04; B60K 37/06;  
B60K 35/00  
See application file for complete search history.

FIG. 1 is a perspective view of an auto stereo mounting device, showing my design;  
FIG. 2 is a rear perspective view of the auto stereo device, shown in FIG. 1;  
FIG. 3 is a front elevation view of FIG. 1;  
FIG. 4 is a rear elevation view of FIG. 1;  
FIG. 5 is a left side elevation view of FIG. 1;  
FIG. 6 is a right side elevation view of FIG. 1;  
FIG. 7 is a top plan view of FIG. 1; and,  
FIG. 8 is a bottom plan view of FIG. 1.  
The broken lines shown in all views illustrate mounting features which form no part of the claimed design.

(56) **References Cited**

**U.S. PATENT DOCUMENTS**

D414,772 S \* 10/1999 Adelaar ..... D14/258  
D430,555 S \* 9/2000 Adelaar ..... D14/258

**1 Claim, 8 Drawing Sheets**

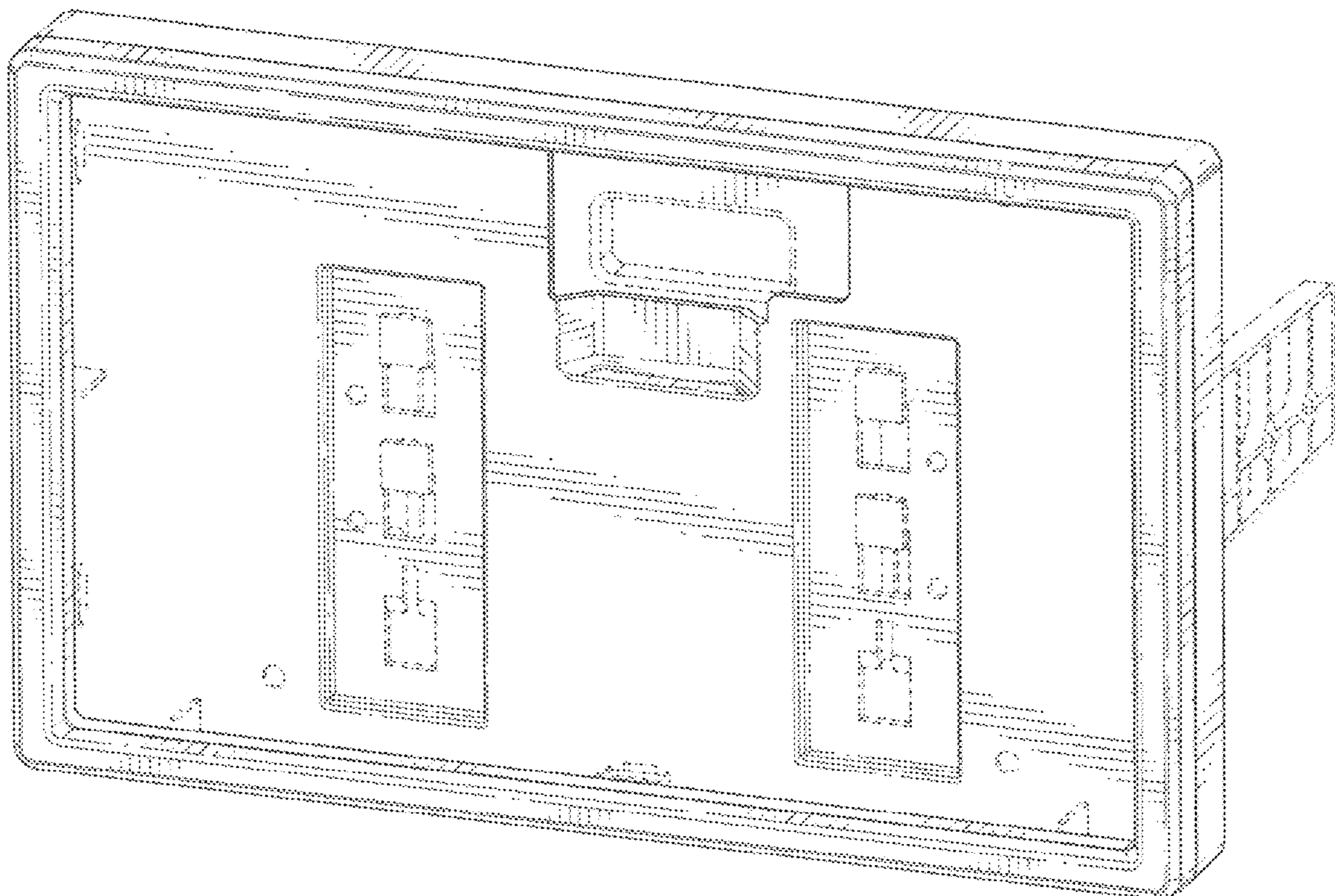

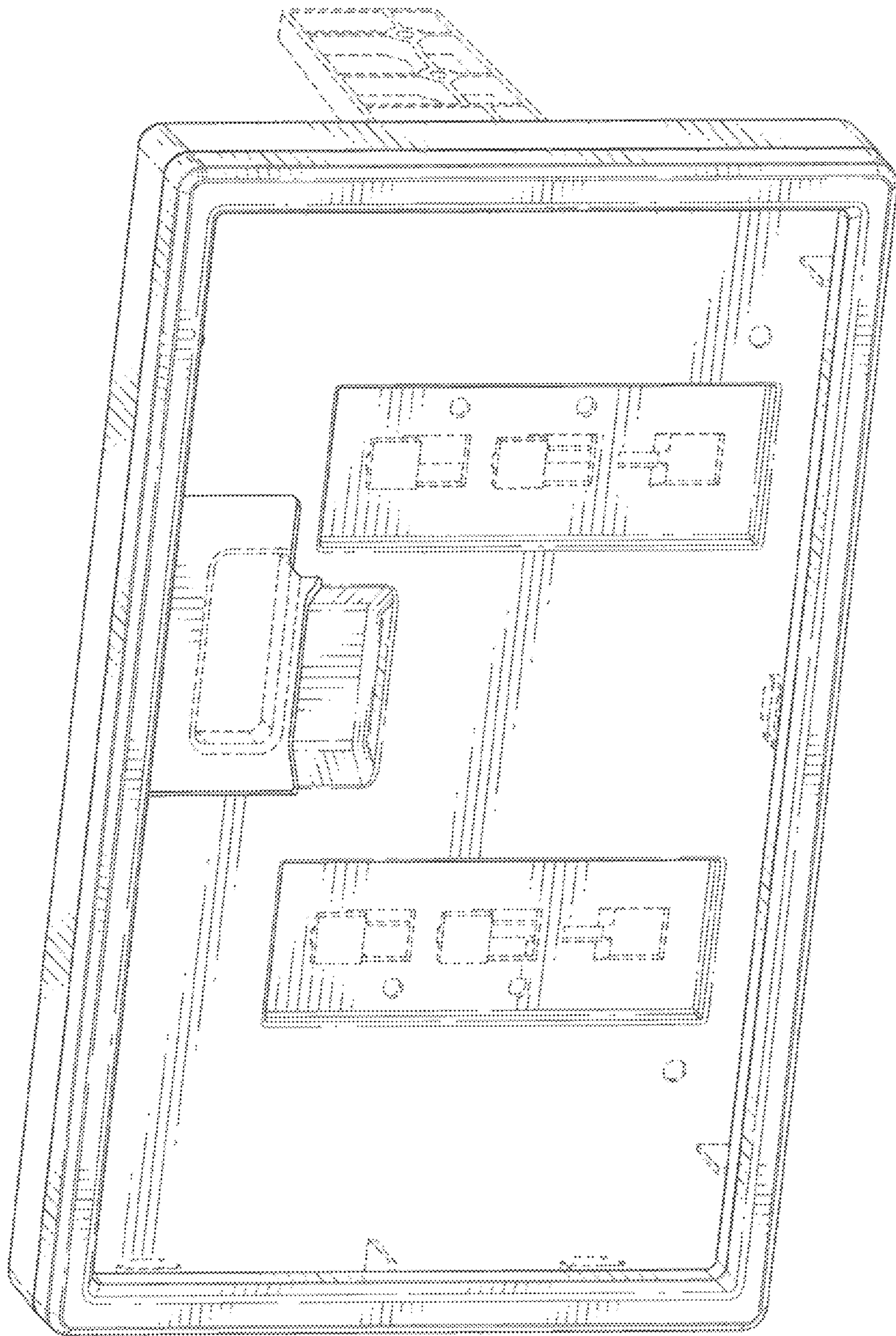

FIG. 1

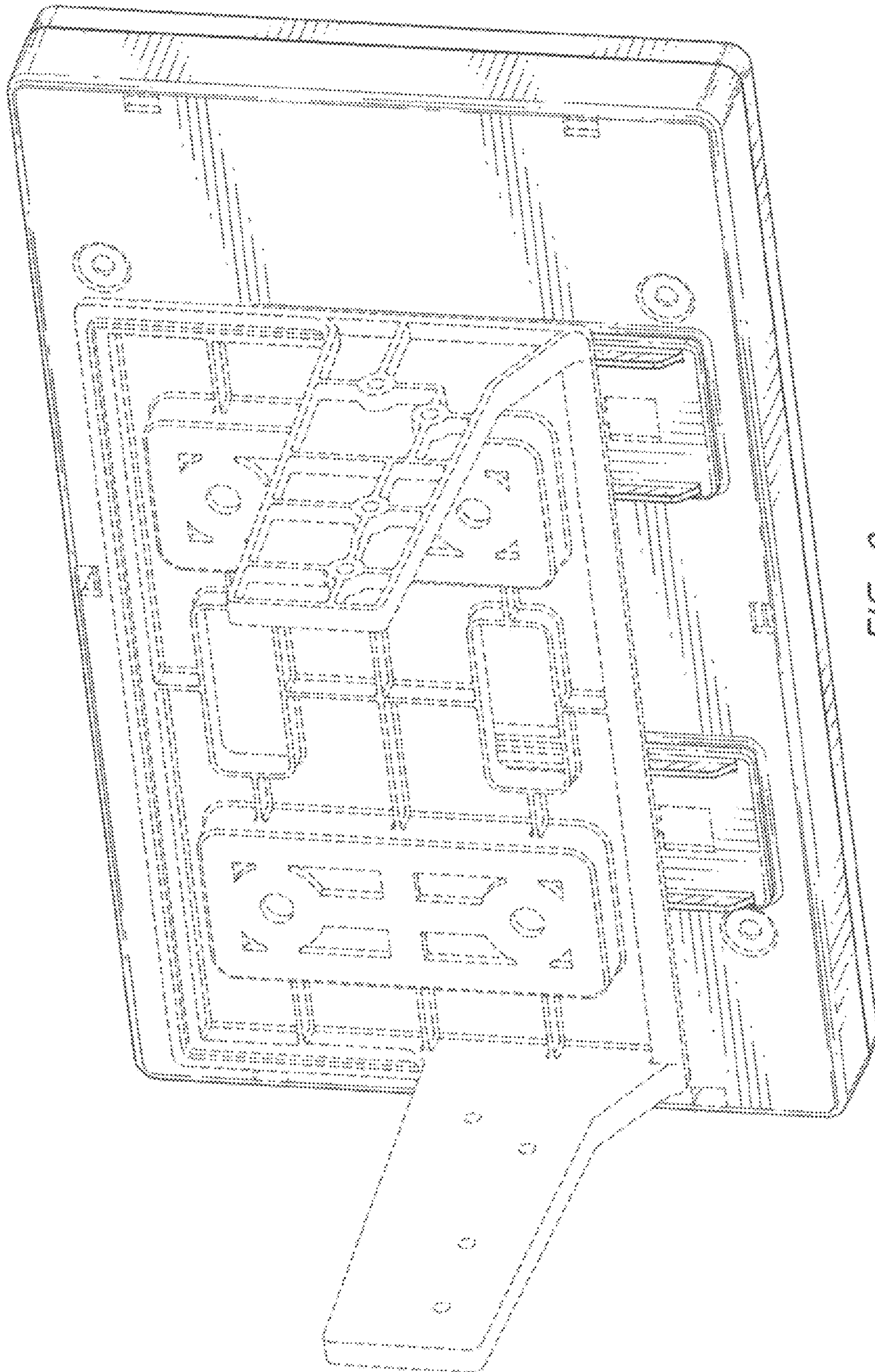

FIG. 2

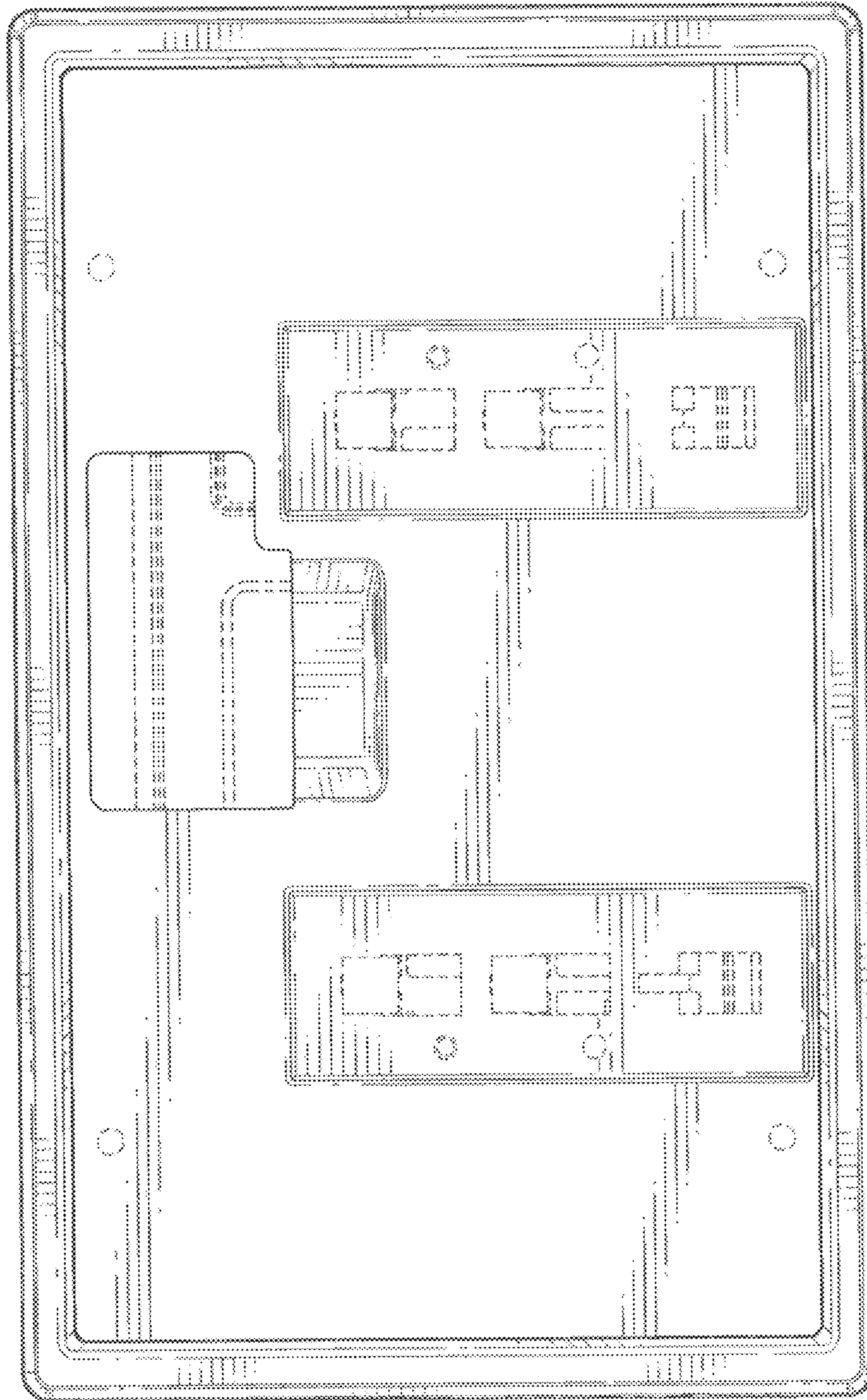

FIG. 3

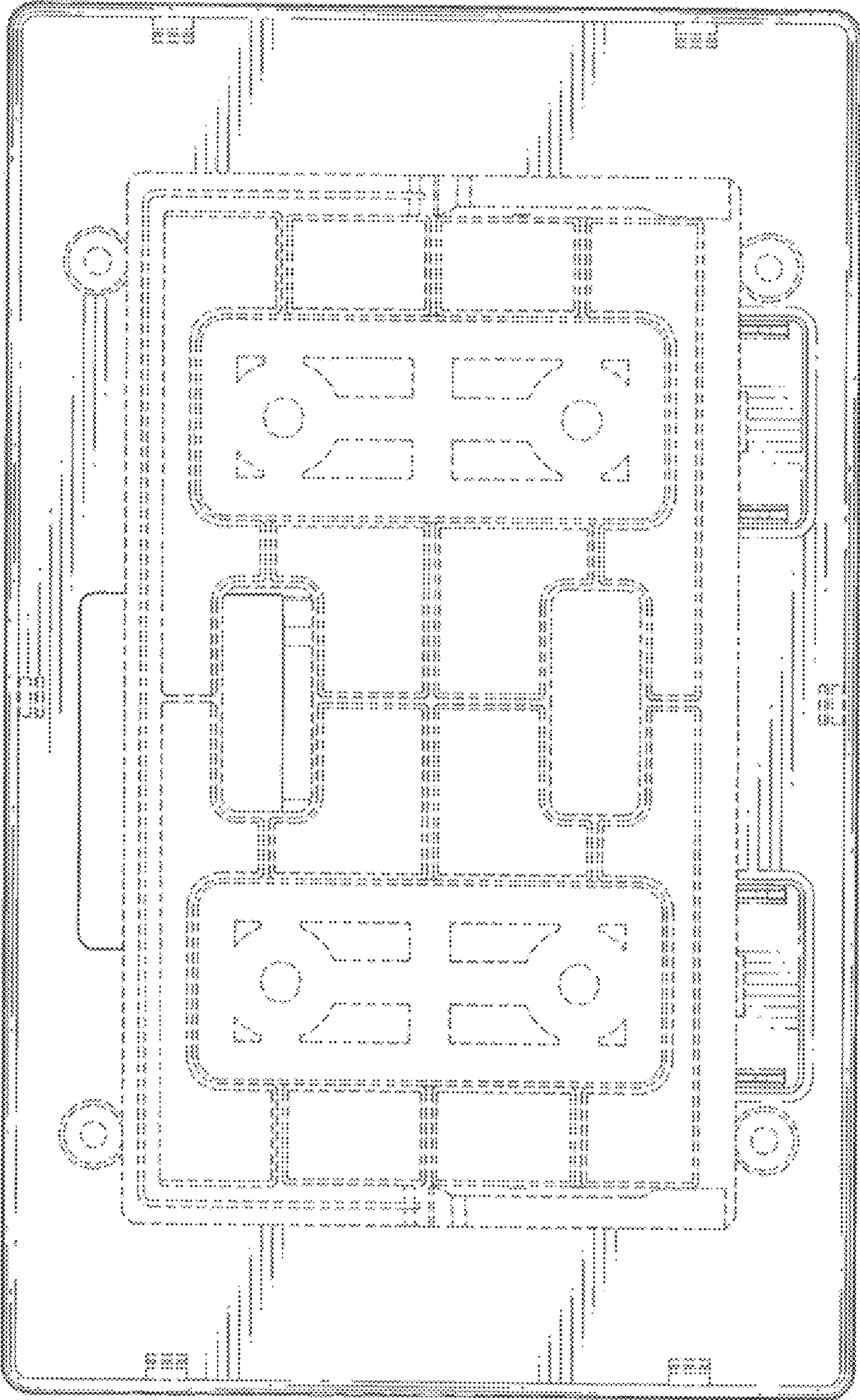

FIG. 4

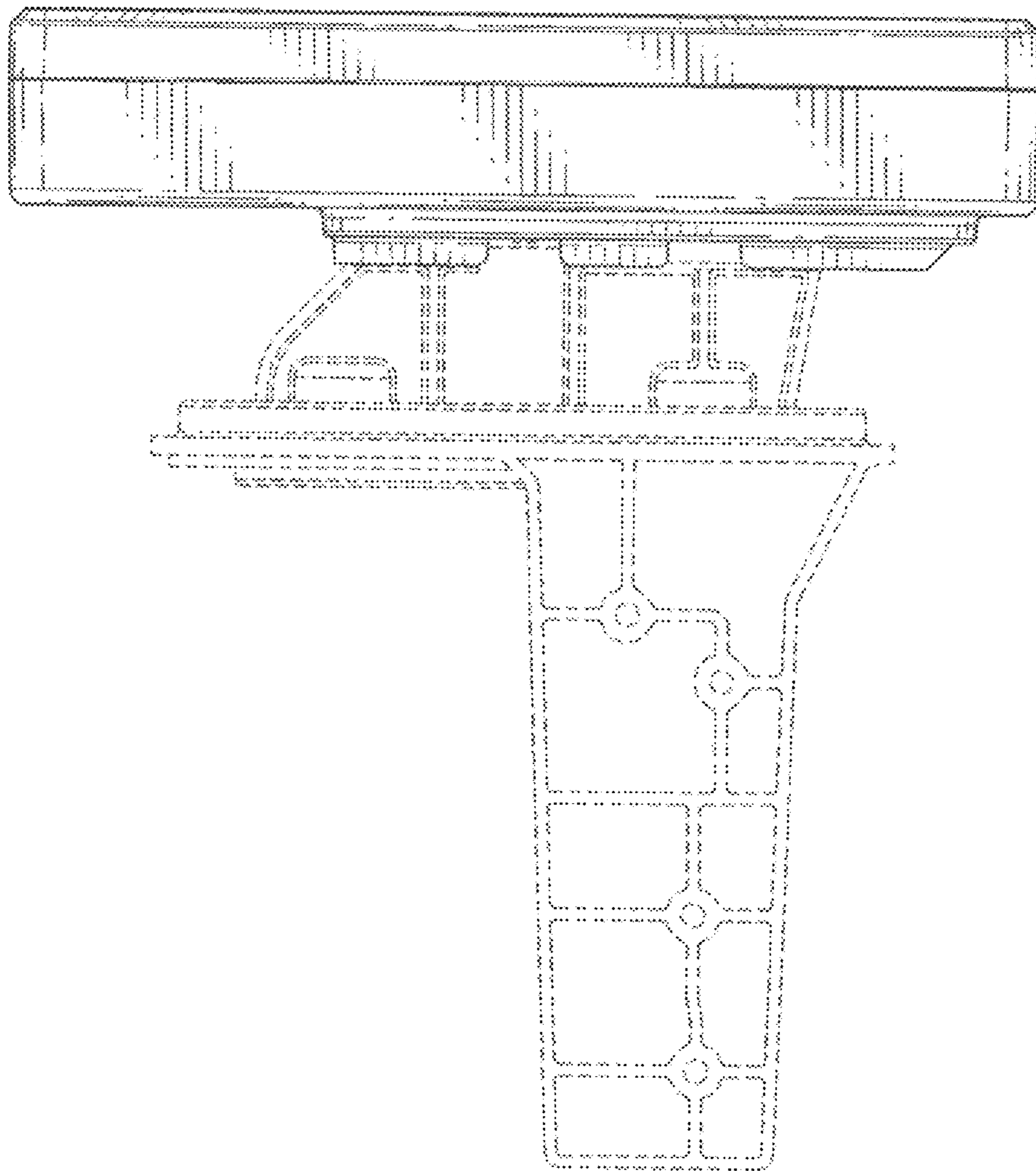

FIG. 5

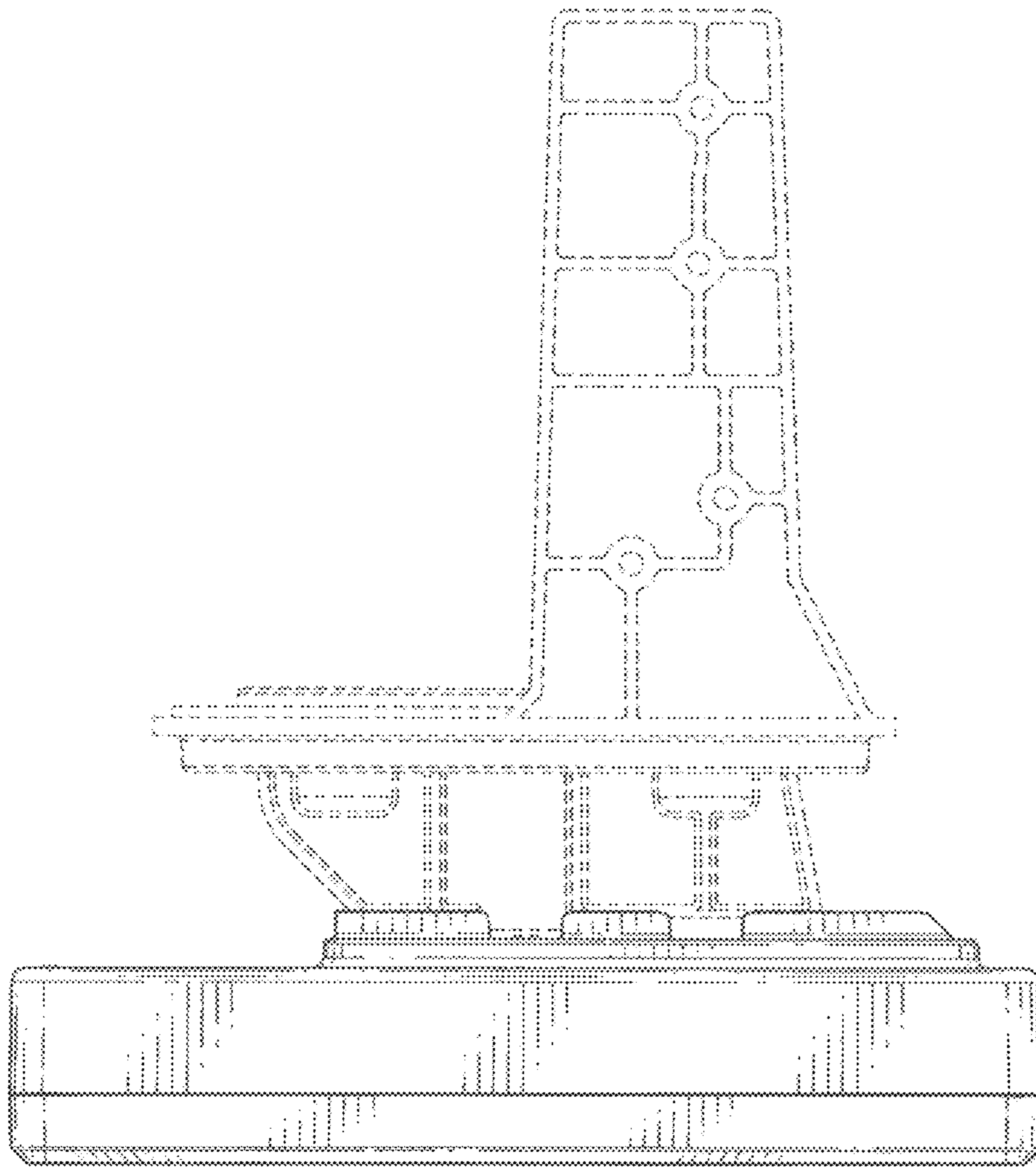

FIG. 6

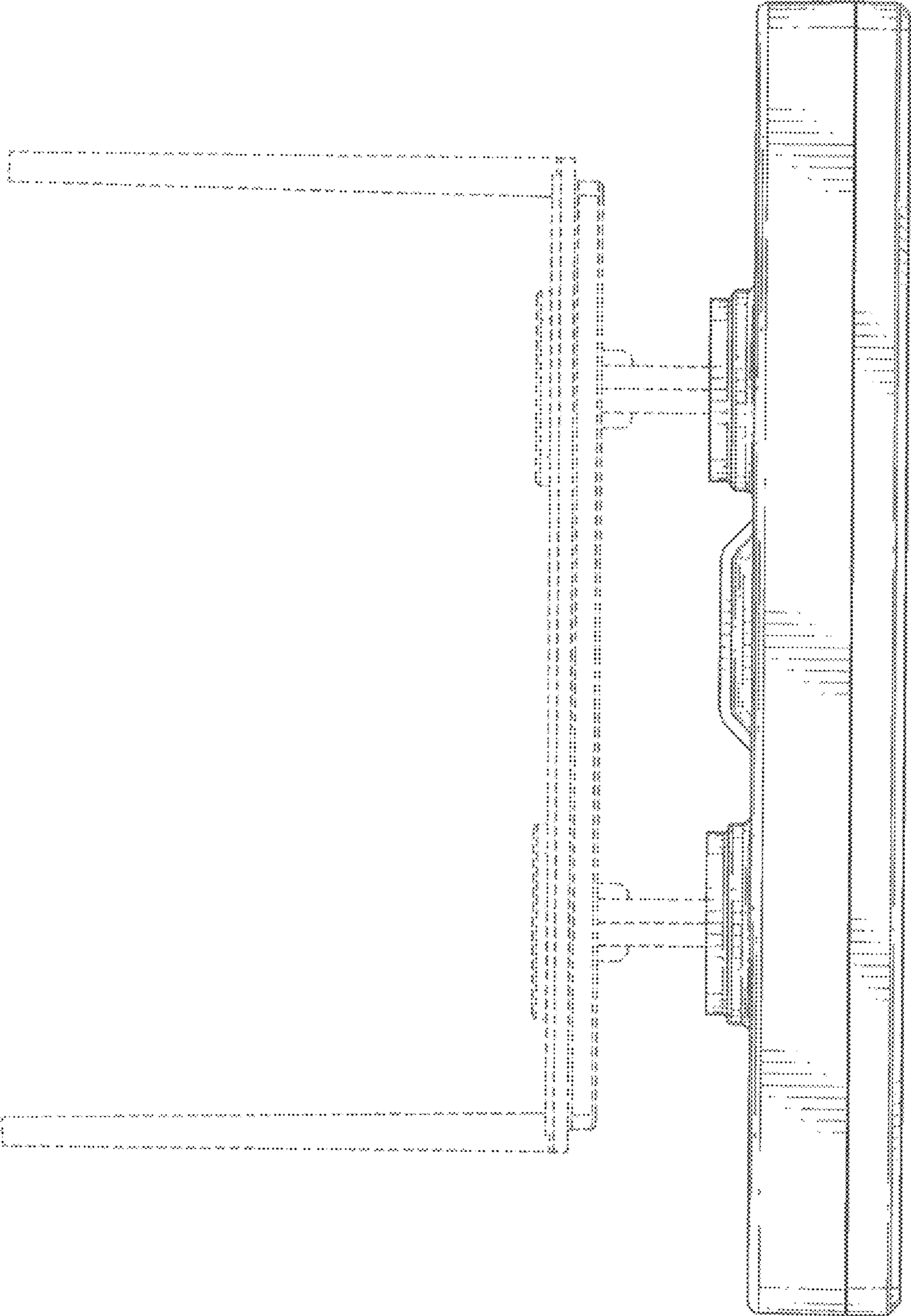

FIG. 7



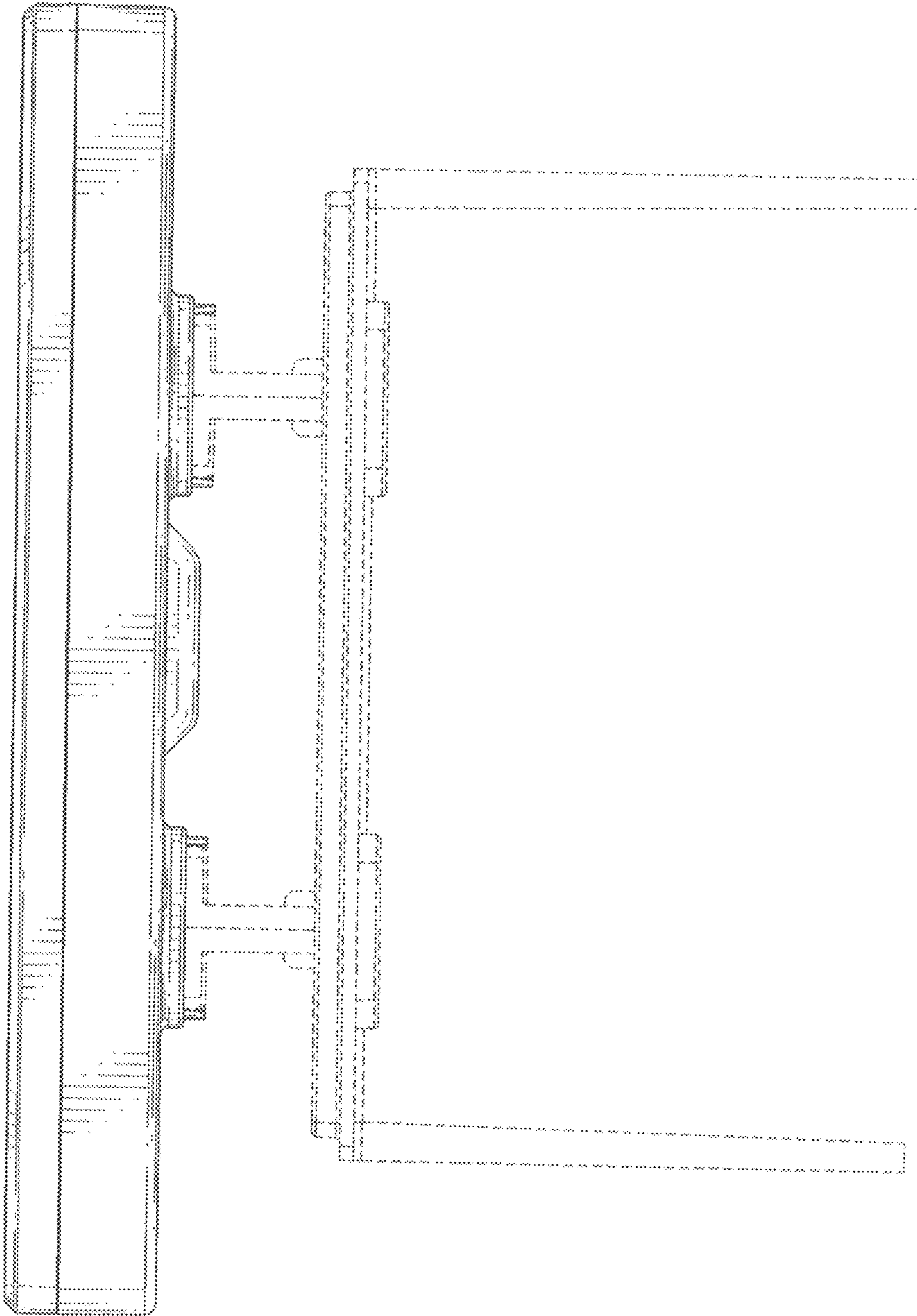

FIG. 8