



US00D896707S

(12) **United States Design Patent** (10) **Patent No.:** **US D896,707 S**
Buell (45) **Date of Patent:** **** Sep. 22, 2020**

(54) **MOTOCYCLE**
(71) Applicant: **FUELL Inc.**, New York, NY (US)
(72) Inventor: **Erik Buell**, Mukwonago, WI (US)
(73) Assignee: **FUELL Inc.**, New York, NY (US)
(**) Term: **15 Years**
(21) Appl. No.: **29/681,991**
(22) Filed: **Feb. 28, 2019**
(51) **LOC (12) Cl.** **12-11**
(52) **U.S. Cl.**
USPC **D12/114**
(58) **Field of Classification Search**
USPC D12/114, 110, 107, 117, 119, 126, 222,
D12/223
CPC B62K 11/04; B62K 11/02; B62K 11/00;
B62K 19/12; B62K 25/04; B62J 7/04;
B62J 1/12; B62J 1/28
See application file for complete search history.

D527,314 S * 8/2006 Czysz D12/117
D541,706 S * 5/2007 Goldstein D12/117
D542,191 S * 5/2007 Alsop D12/117
D544,409 S * 6/2007 Hutchison D12/114
D583,717 S * 12/2008 Brown D12/117
D737,729 S * 9/2015 Seo D12/114
D786,739 S * 5/2017 Fujimoto D12/110

* cited by examiner

Primary Examiner — Michelle E. Wilson
Assistant Examiner — Clese Moore, Jr.
(74) *Attorney, Agent, or Firm* — Banner & Witcoff, Ltd.

(57) **CLAIM**

The ornamental design for a motorcycle, as shown and described.

DESCRIPTION

FIG. 1 is a top, front, right perspective view of a motorcycle showing my new design;
FIG. 2 is a right side view thereof;
FIG. 3 is a top view thereof;
FIG. 4 is a rear right perspective view thereof; and,
FIG. 5 is an enlarged view of FIG. 4 with environment removed to enhance clarity.
The broken lines immediately adjacent to the shaded area represent unclaimed boundaries of the design. The broken lines showing the remainder of the motorcycle represent unclaimed subject matter and form no part of the claimed design. Pursuant to MPEP 608.02(VIII), FIGS. 1-5 are lined for the color orange.

1 Claim, 5 Drawing Sheets

(56) **References Cited**

U.S. PATENT DOCUMENTS

D497,332 S * 10/2004 Sugimoto D12/114
D503,363 S * 3/2005 Alsop D12/117
D509,462 S * 9/2005 Ford D12/117
D516,470 S * 3/2006 Clements D12/114
D520,414 S * 5/2006 Tanaka D12/119
D521,418 S * 5/2006 Lee D12/114
D521,419 S * 5/2006 Mezzasalma D12/117

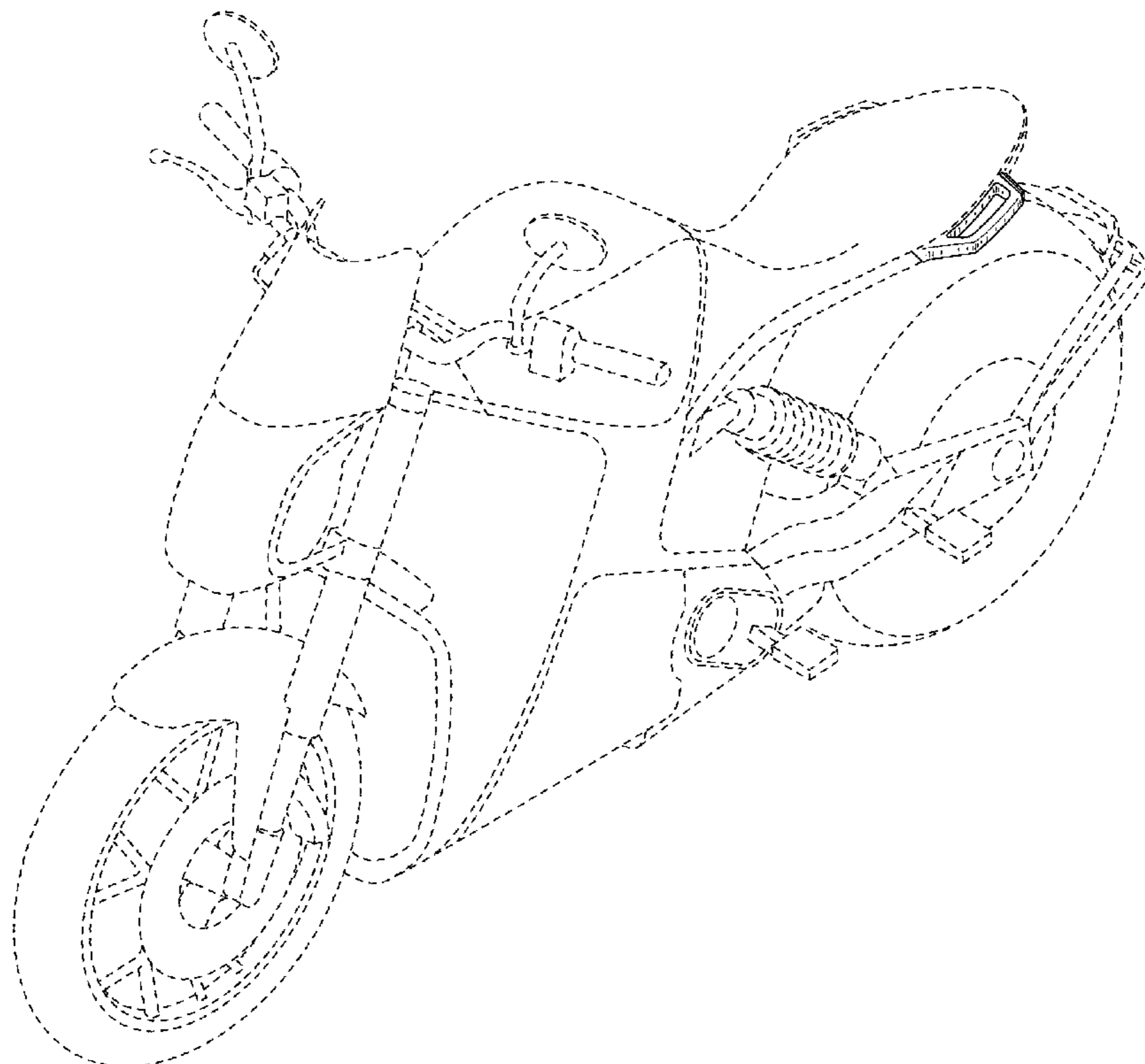

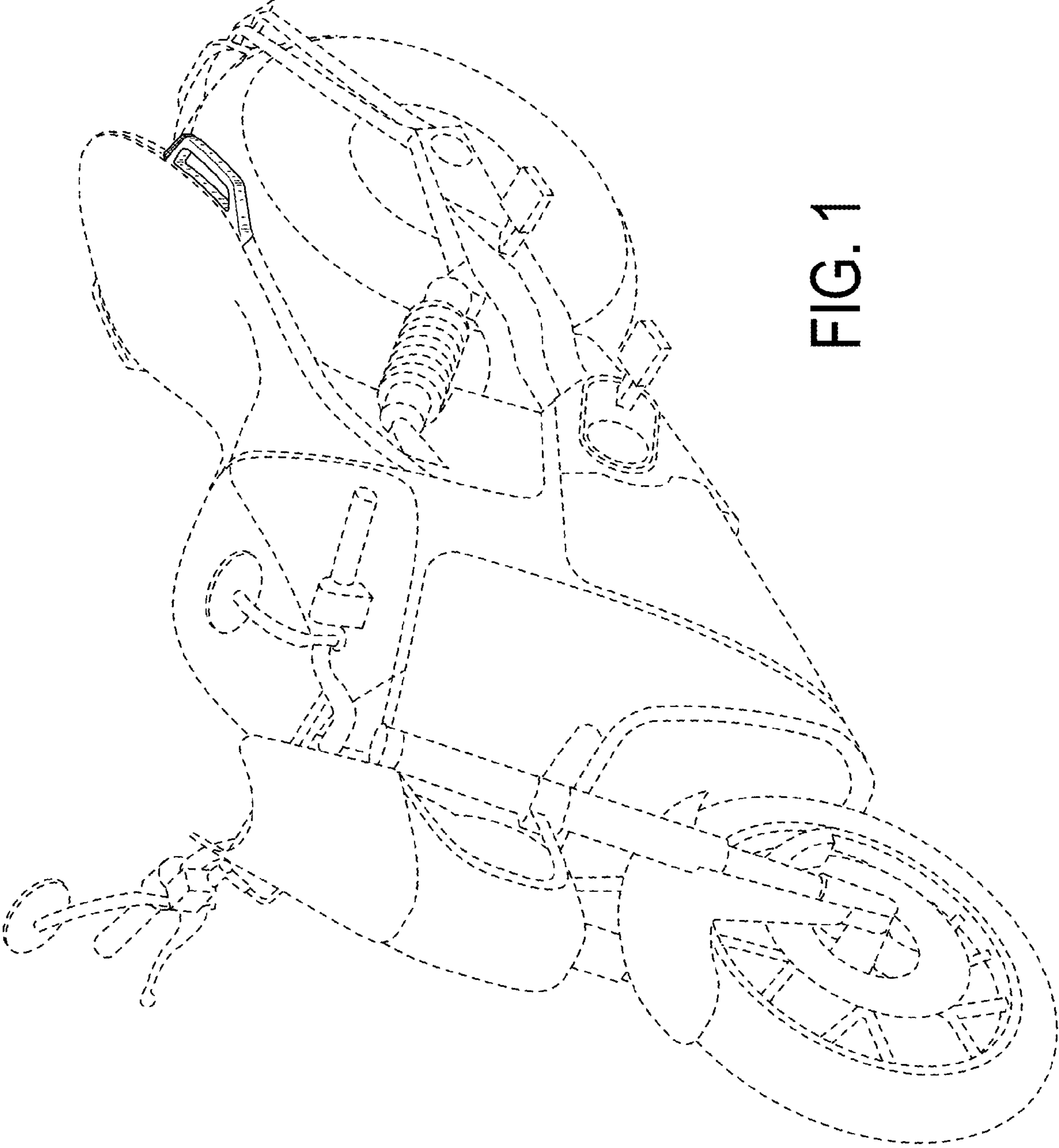

FIG. 1

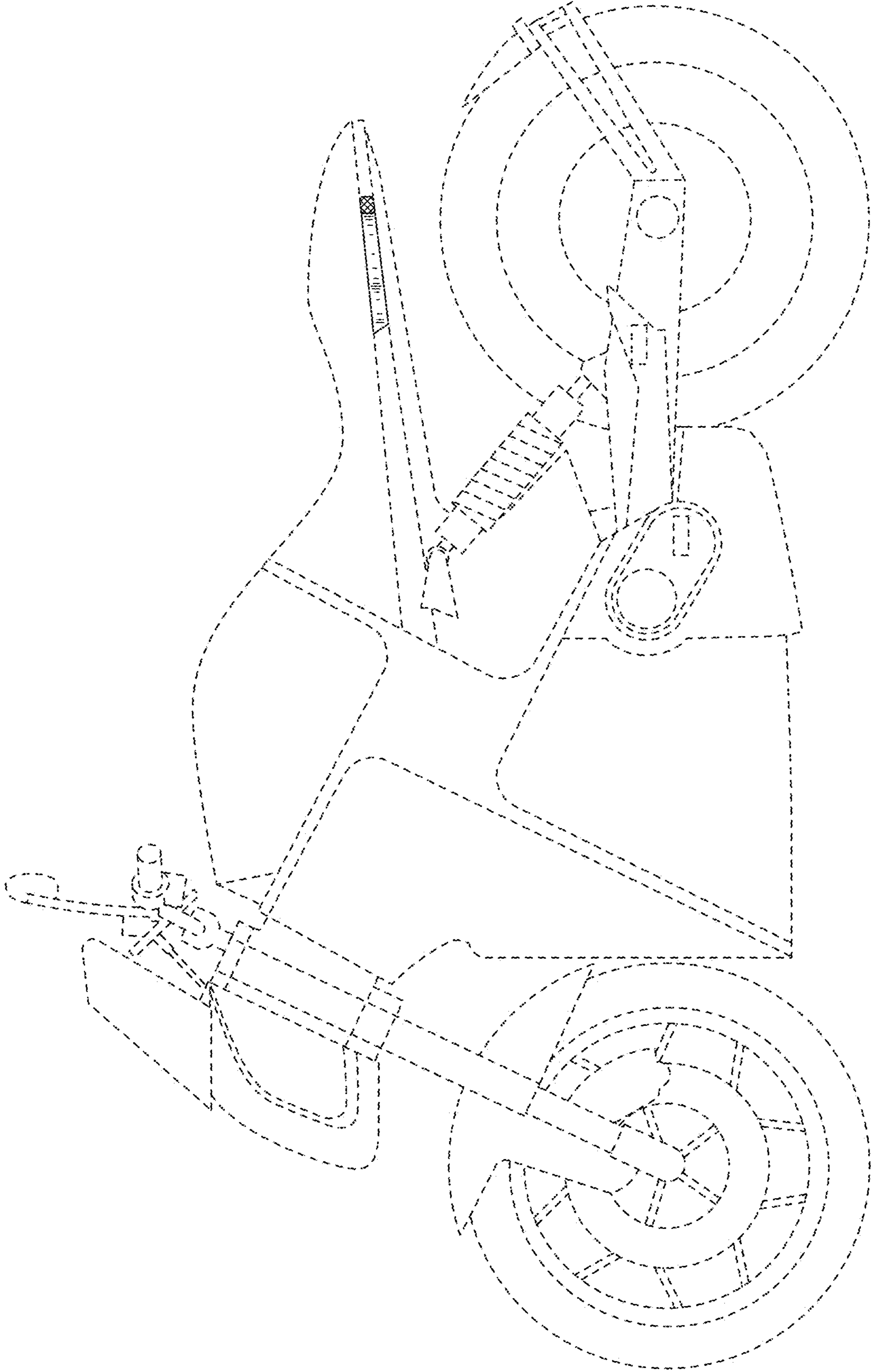

FIG. 2

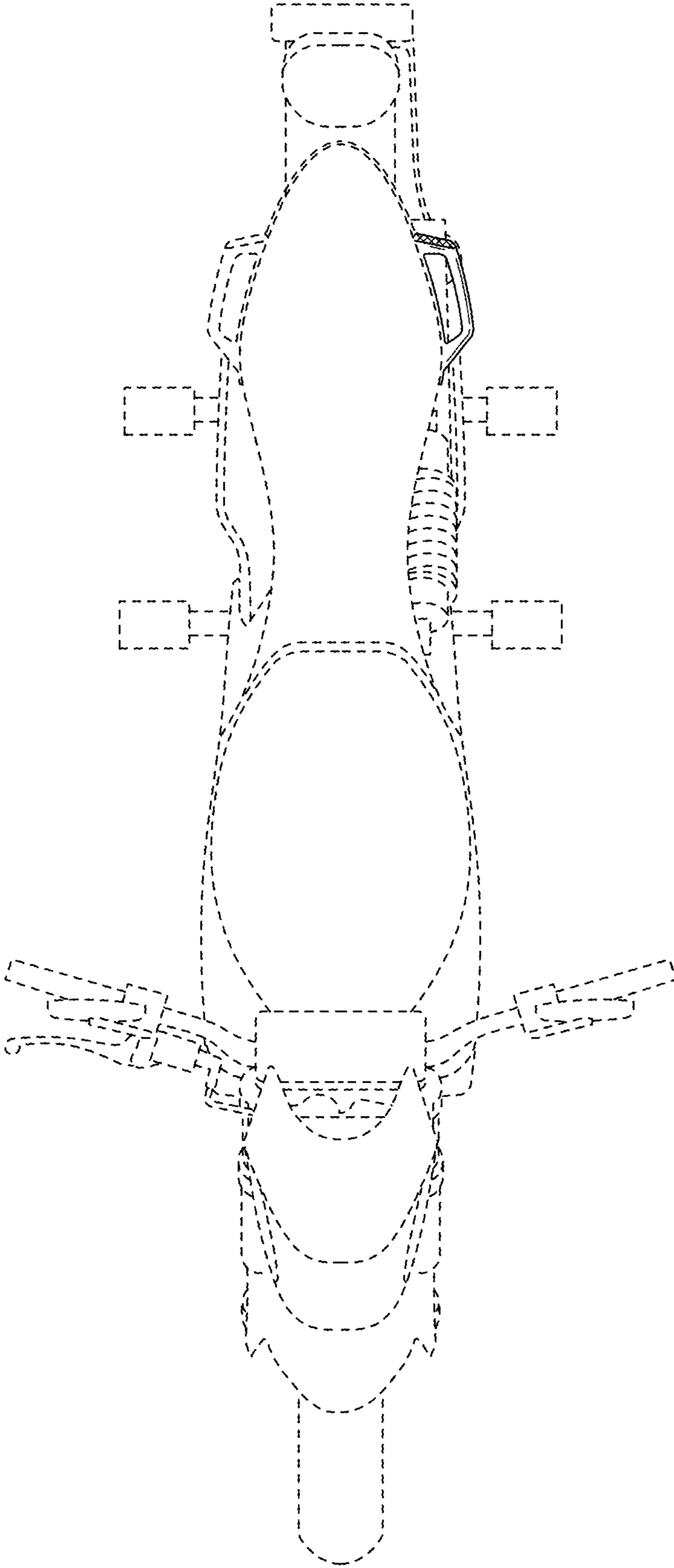
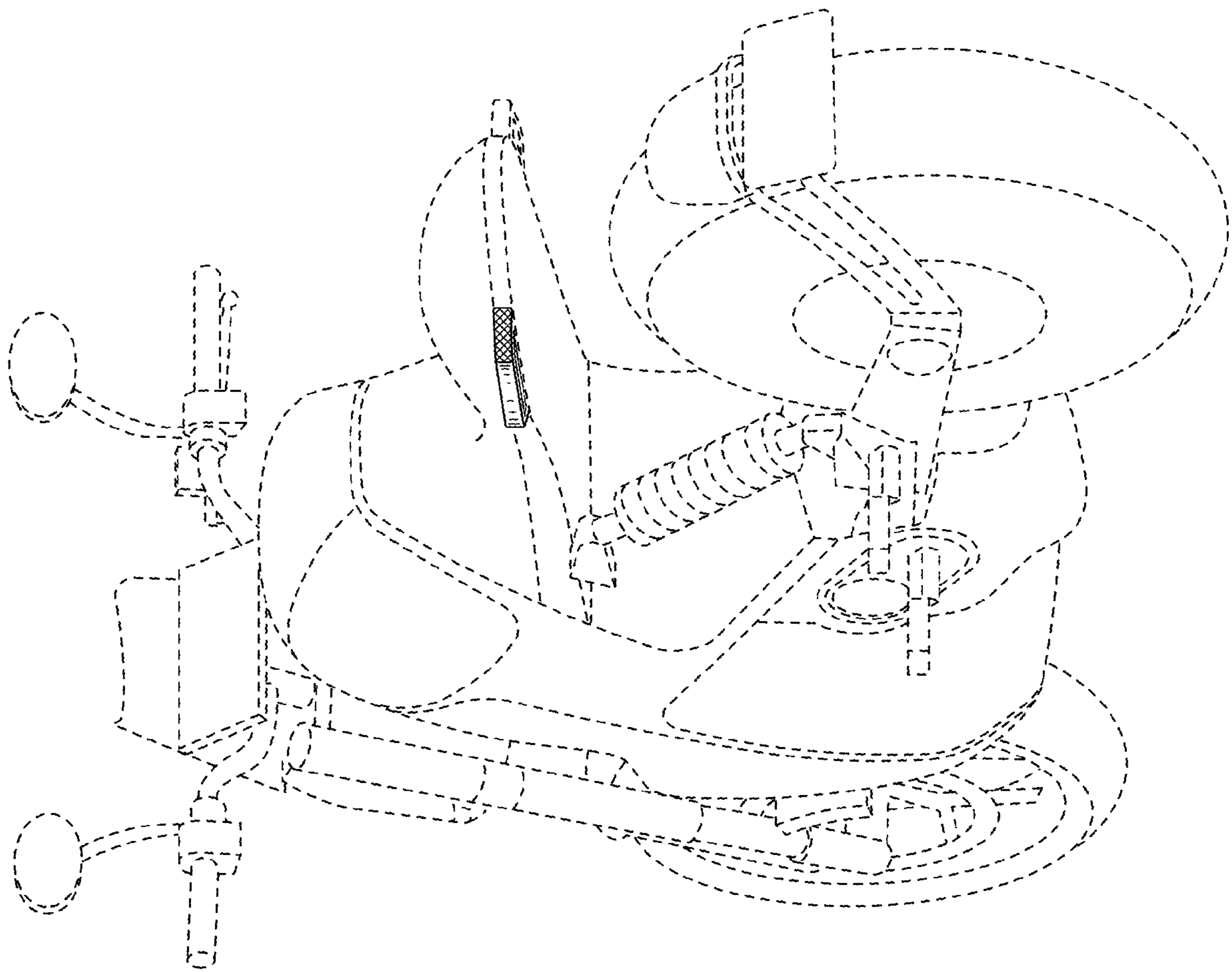

FIG. 3

FIG. 4



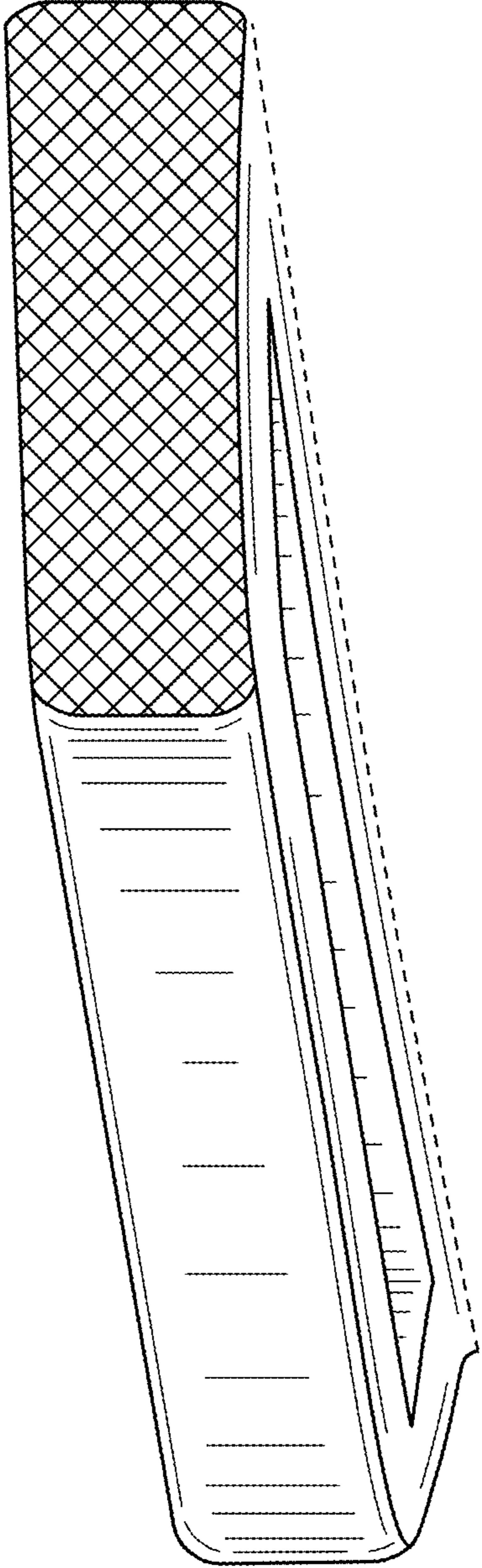

FIG. 5