



US00D896274S

(12) **United States Design Patent** (10) **Patent No.:** **US D896,274 S**
McGinley et al. (45) **Date of Patent:** **** Sep. 15, 2020**

(54) **ENGINE**

(56) **References Cited**

(71) Applicant: **Harley-Davidson Motor Company Group, LLC**, Milwaukee, WI (US)
(72) Inventors: **Ben McGinley**, Glendale, WI (US); **Frank Savage**, Fox Point, WI (US); **Brad Richards**, Grafton, WI (US); **Chetan Shedjale**, Wauwatosa, WI (US); **Nathan Abplanalp**, Milwaukee, WI (US); **Stephen R. Collins**, Fond du Lac, WI (US); **Richard W. Elchert**, Mequon, WI (US); **Dane Schwegman**, Wauwatosa, WI (US); **Michael DeCaluwe**, Jackson, WI (US); **Brian Saiia**, Milwaukee, WI (US); **Scott Matthews**, Franklin, WI (US)
(73) Assignee: **Harley-Davidson Motor Company Group, LLC**, Milwaukee, WI (US)
(**) Term: **15 Years**

U.S. PATENT DOCUMENTS

D331,410	S	*	12/1992	Binversie	D15/4
6,382,169	B1	*	5/2002	Gausman	F01P 7/026 123/195 R
D541,300	S	*	4/2007	Geisheker	D15/5
D541,303	S	*	4/2007	Drew	D15/5
D553,645	S	*	10/2007	Drew	D15/5
D584,318	S	*	1/2009	Olsen	D15/5
D594,476	S	*	6/2009	Mayer	D15/5
D596,199	S	*	7/2009	Drysdale	D15/1
D784,413	S	*	4/2017	Thorn	D15/5
D787,558	S	*	5/2017	Thorn	D15/5
D798,906	S	*	10/2017	Bennett	D15/5
D799,552	S	*	10/2017	McGinley	D15/5
D800,783	S	*	10/2017	Savage	D15/5

(Continued)

Primary Examiner — Ania Aman

(74) *Attorney, Agent, or Firm* — Foley & Lardner LLP

(21) Appl. No.: **29/658,347**

(22) Filed: **Jul. 30, 2018**

(51) **LOC (12) Cl.** **15-01**

(52) **U.S. Cl.**
USPC **D15/3**

(58) **Field of Classification Search**
CPC F02B 75/007; F02B 61/02; F02B 75/005;
F02B 2075/022; F02B 75/16; F02B
2075/1808; F02B 75/34; F02B 77/02;
F02B 2700/03; F02B 2710/03; F02B
2730/011; F02B 63/02; F02B 2075/027;
F02B 2075/1816; F02B 2075/1824; F02B
2063/045; F01M 13/022; F01M
2013/0461; F01M 13/04; F02F 7/0068;
F02F 2007/0075; F02M 35/0201

See application file for complete search history.

(57) **CLAIM**

We claim the ornamental design for an engine, as shown and described.

DESCRIPTION

FIG. 1 is a top, front, right perspective view of the claimed design;
FIG. 2 is a top, rear, left perspective view thereof;
FIG. 3 is a front elevation view thereof;
FIG. 4 is a right side elevation view thereof;
FIG. 5 is a left side elevation view thereof;
FIG. 6 is a top plan view thereof;
FIG. 7 is a bottom plan view thereof; and,
FIG. 8 is a rear elevation view thereof.

(Continued)

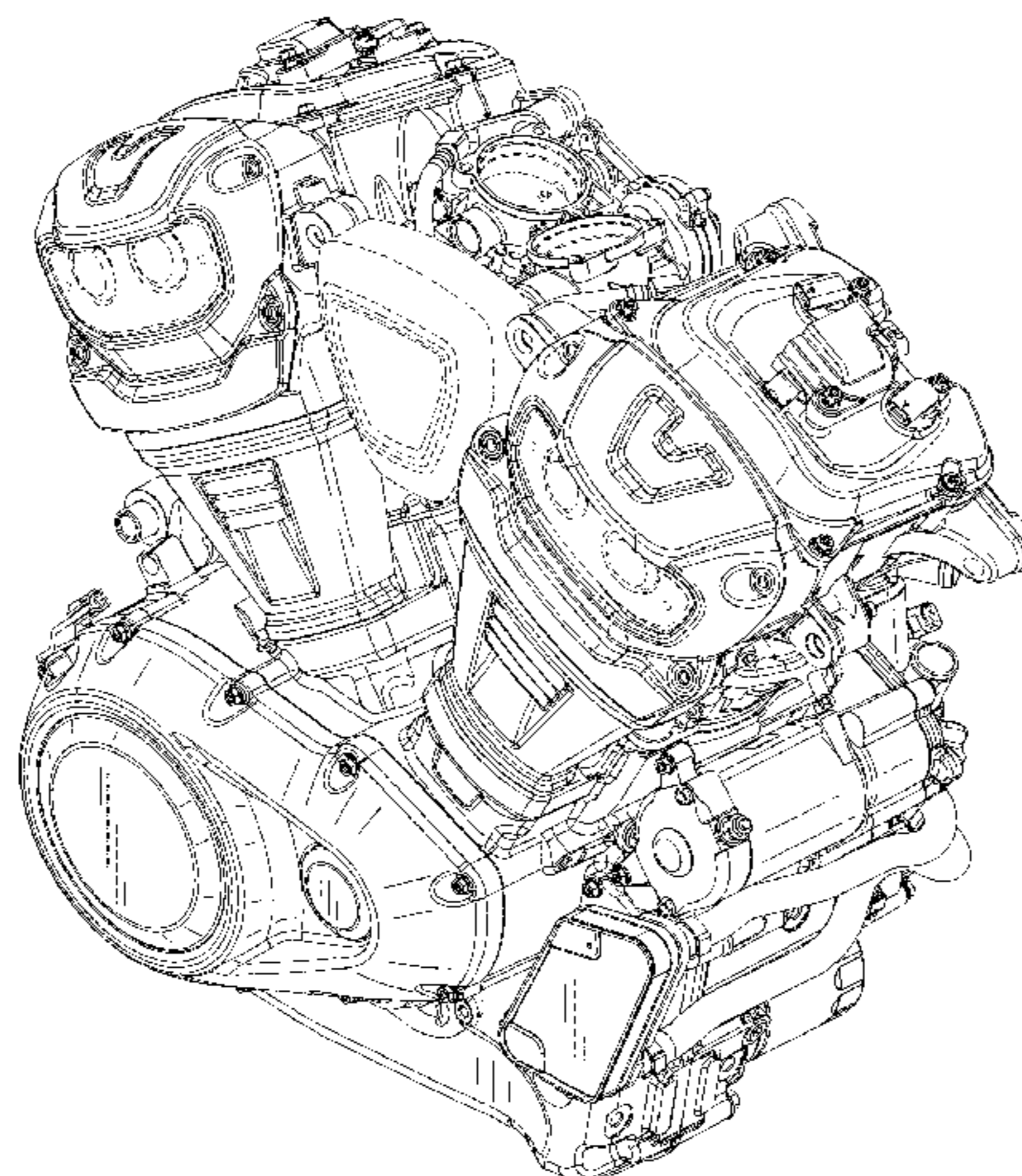

The broken lines shown in the drawings are for the purpose of illustrating the engine that form no part of the claimed design.

1 Claim, 8 Drawing Sheets

(56) **References Cited**

U.S. PATENT DOCUMENTS

2002/0011222 A1* 1/2002 Bilek F01B 1/12
123/52.1
2003/0070649 A1* 4/2003 Okano F02B 61/02
123/198 E
2019/0136721 A1* 5/2019 Wenger F01L 1/344

* cited by examiner

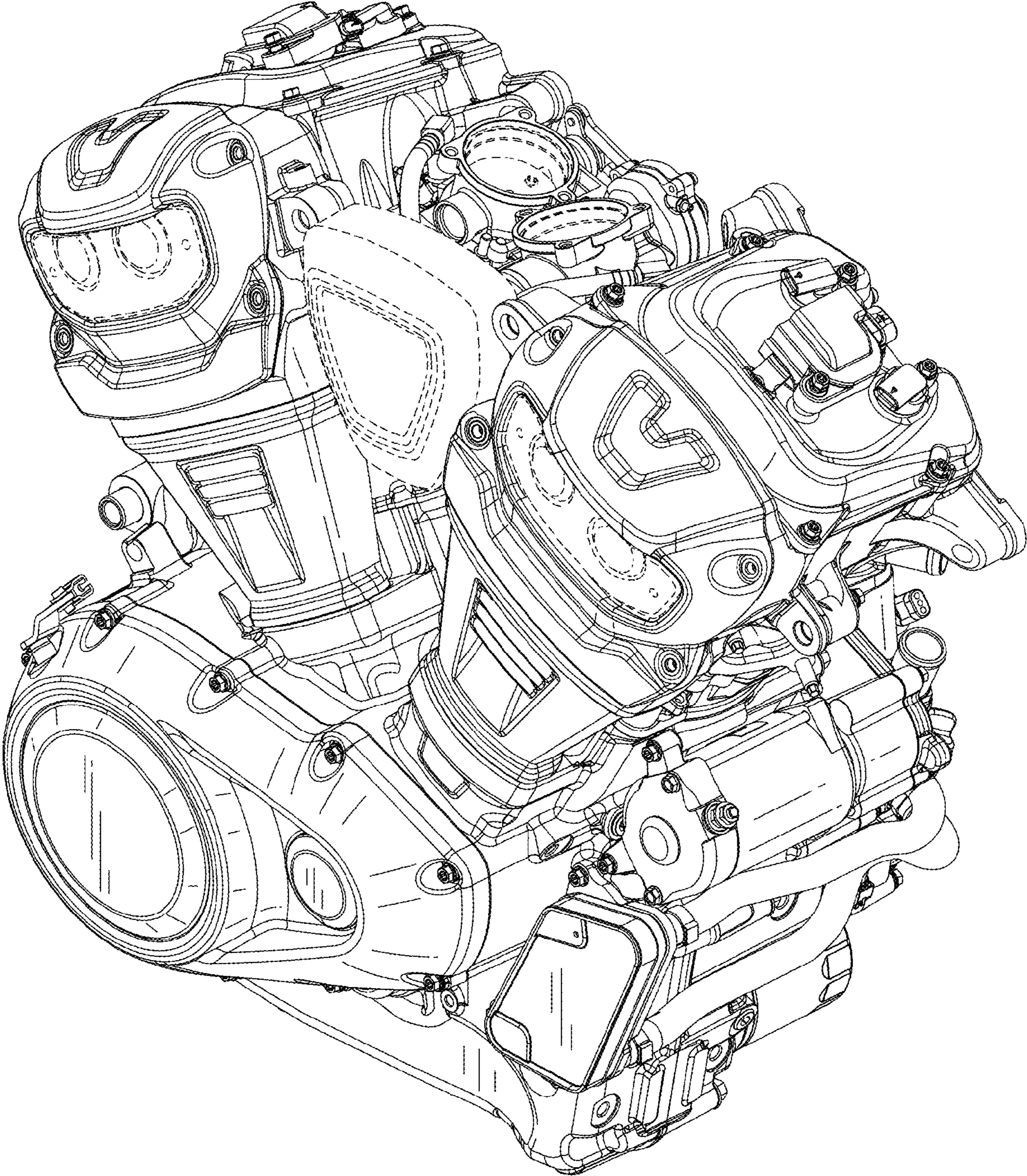

FIG. 1

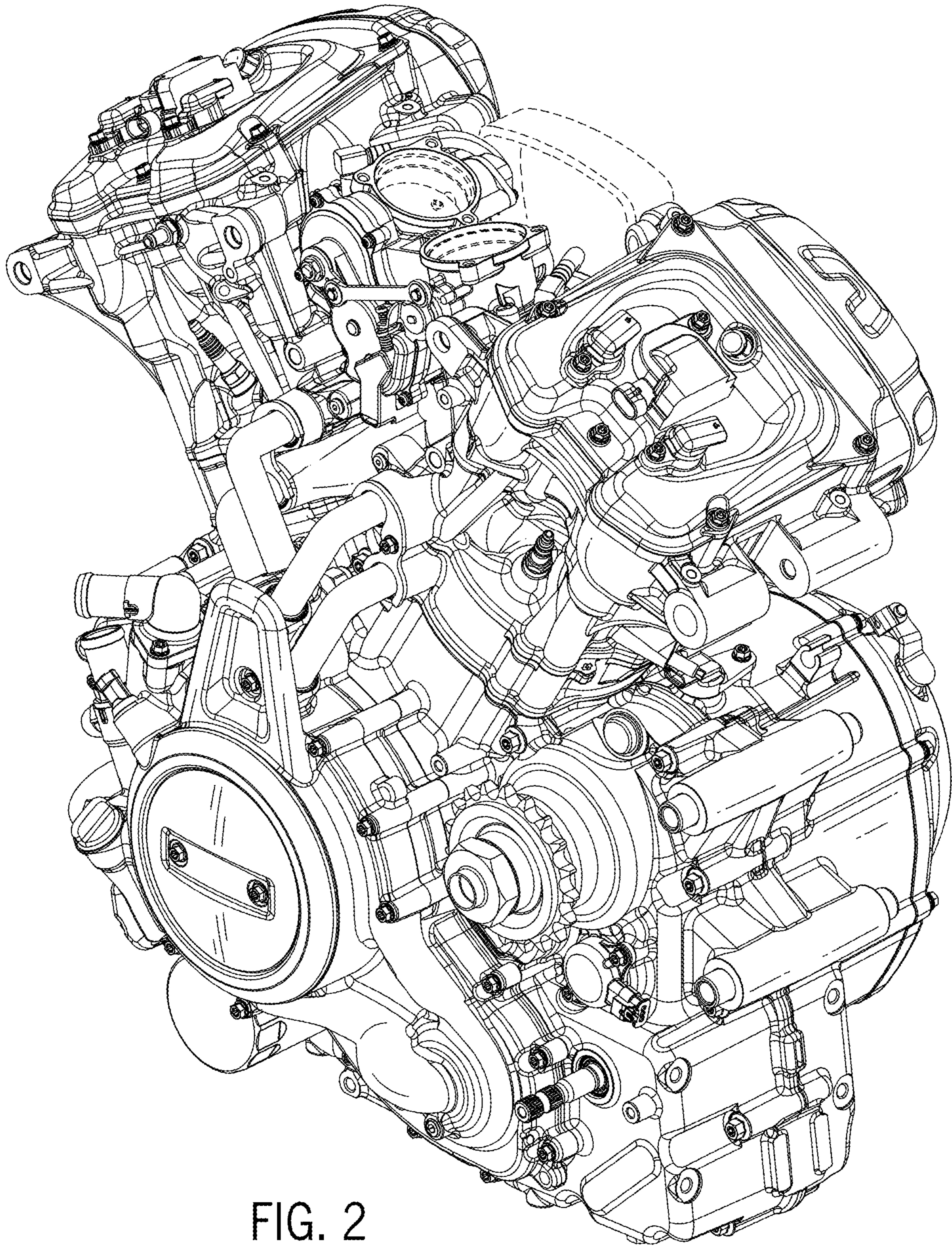

FIG. 2

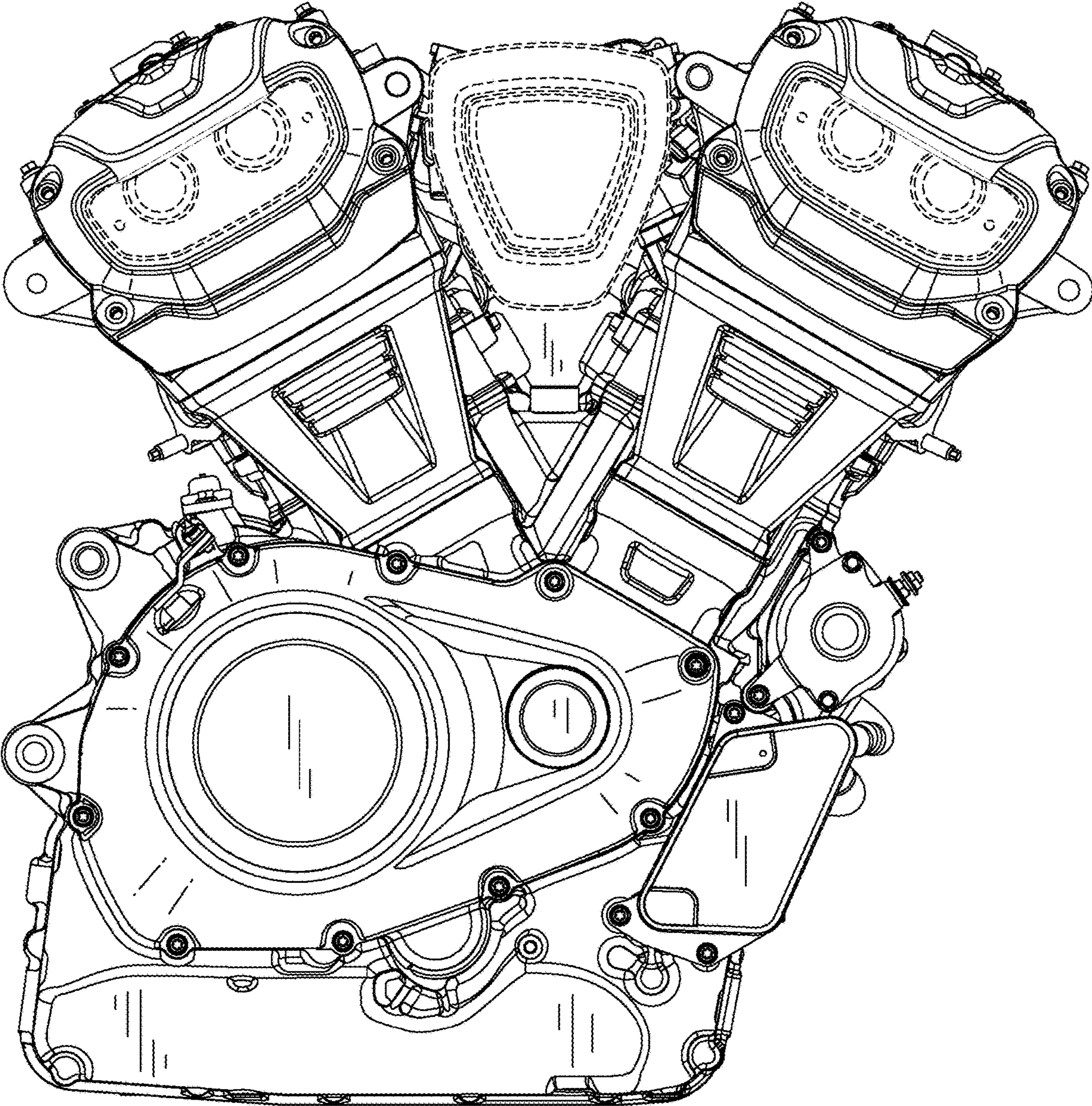

FIG. 3

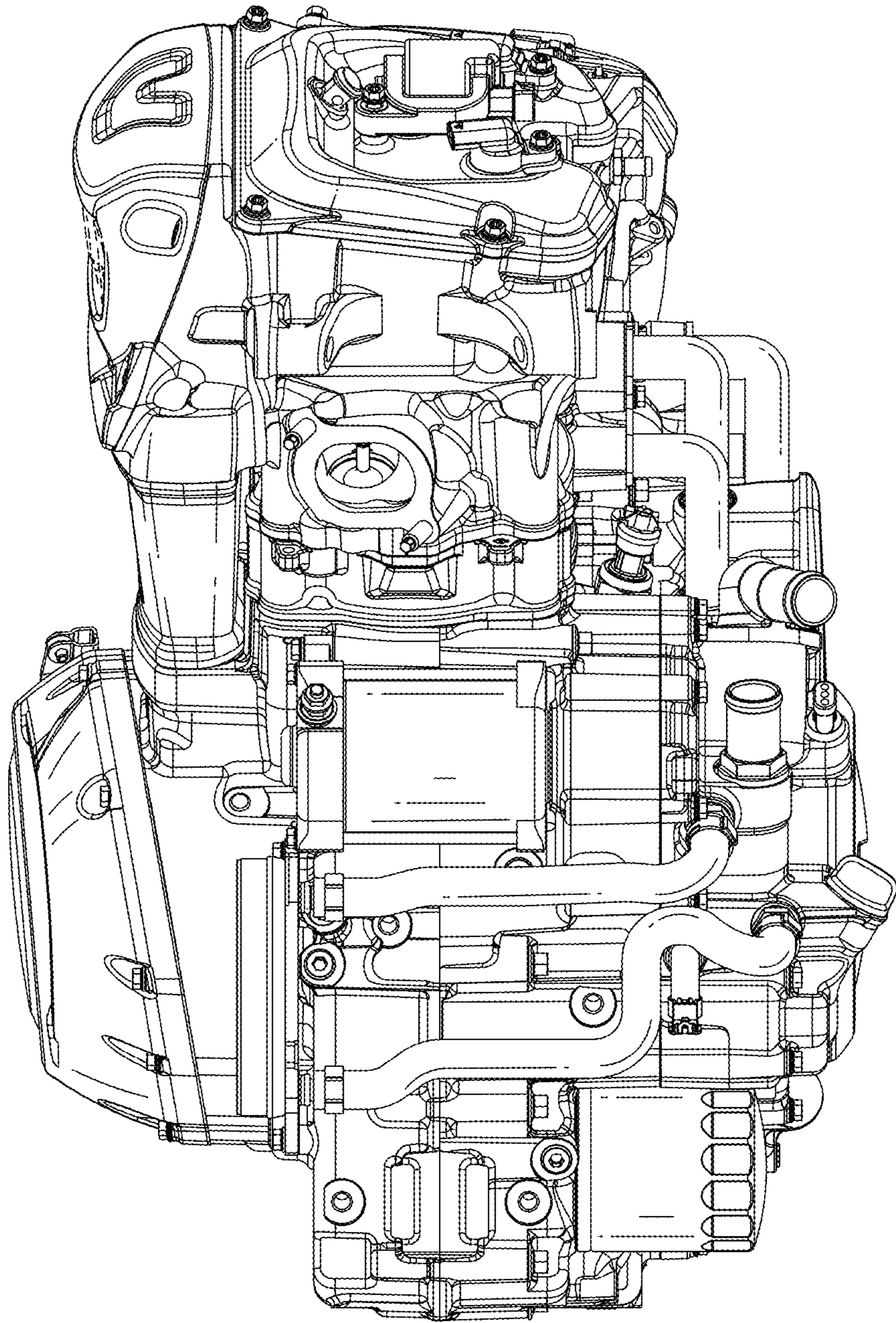

FIG. 4

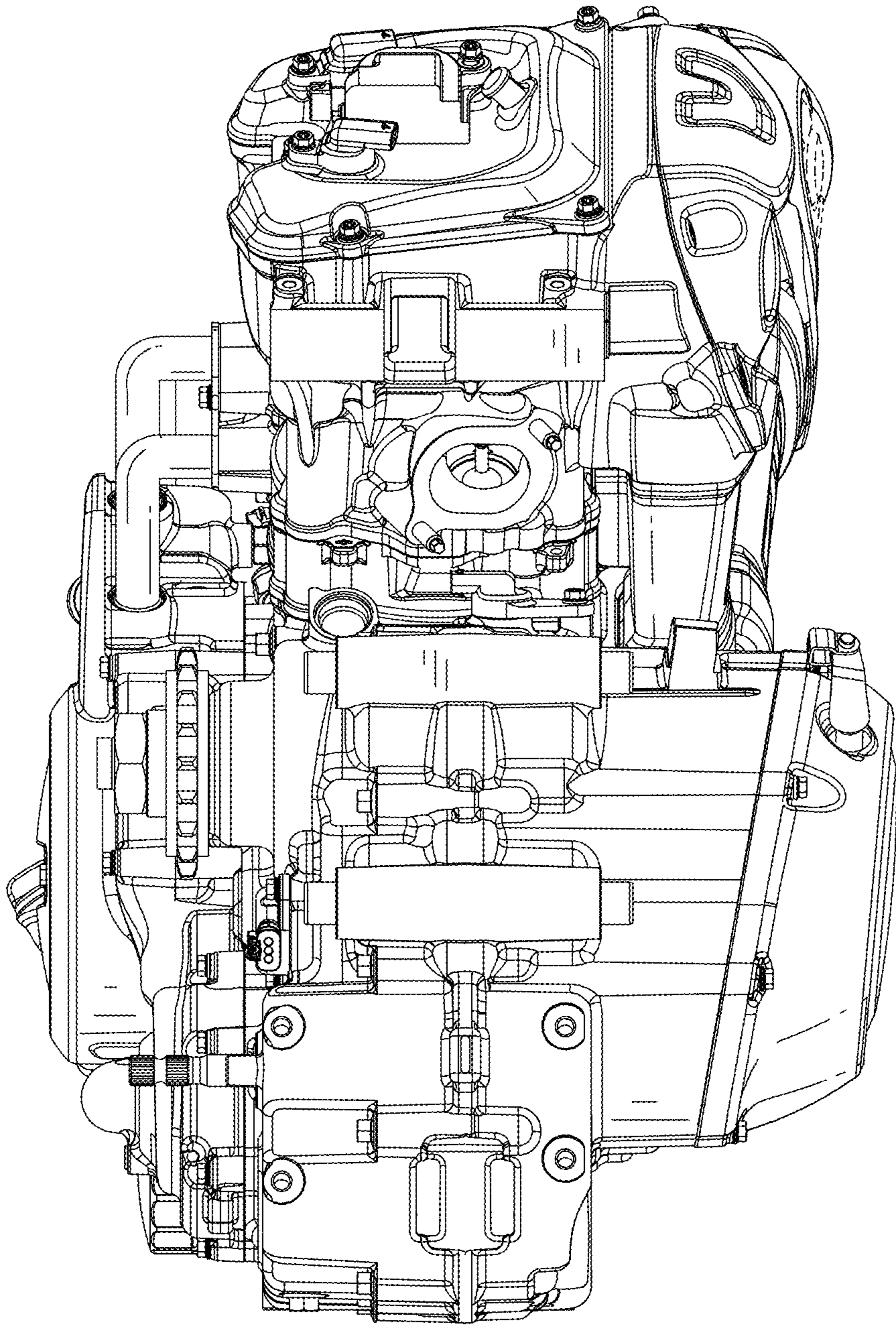

FIG. 5

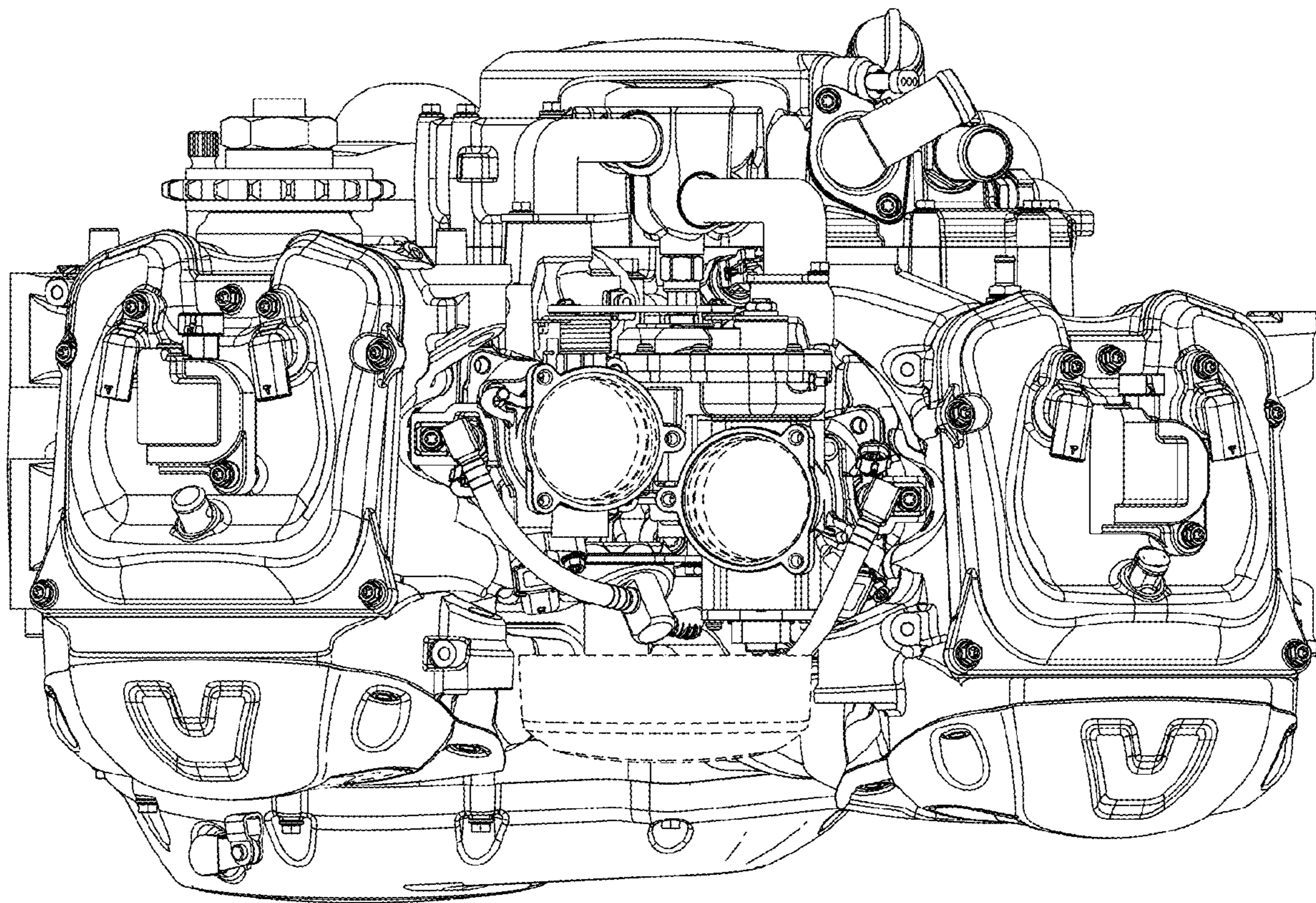

FIG. 6

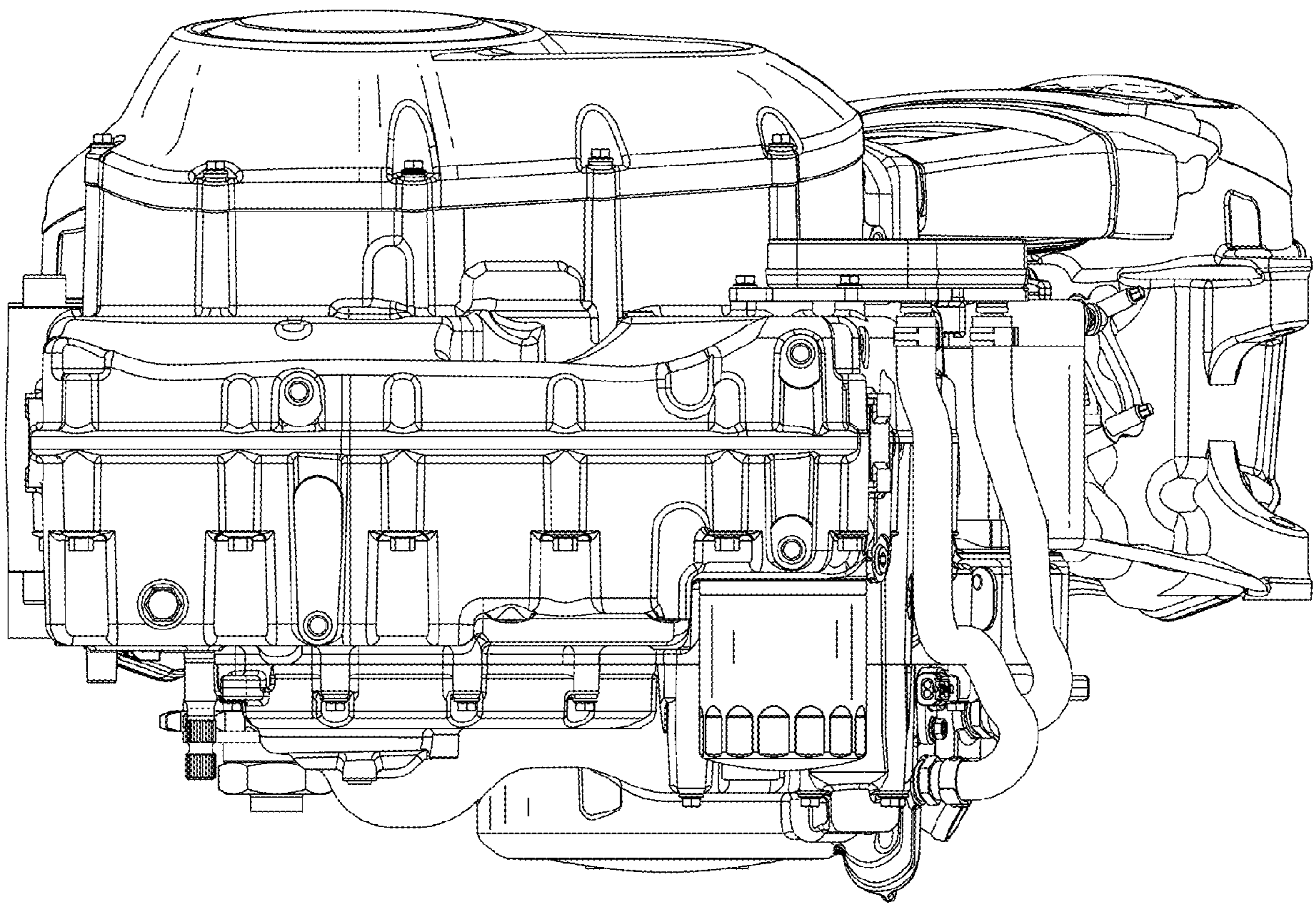

FIG. 7

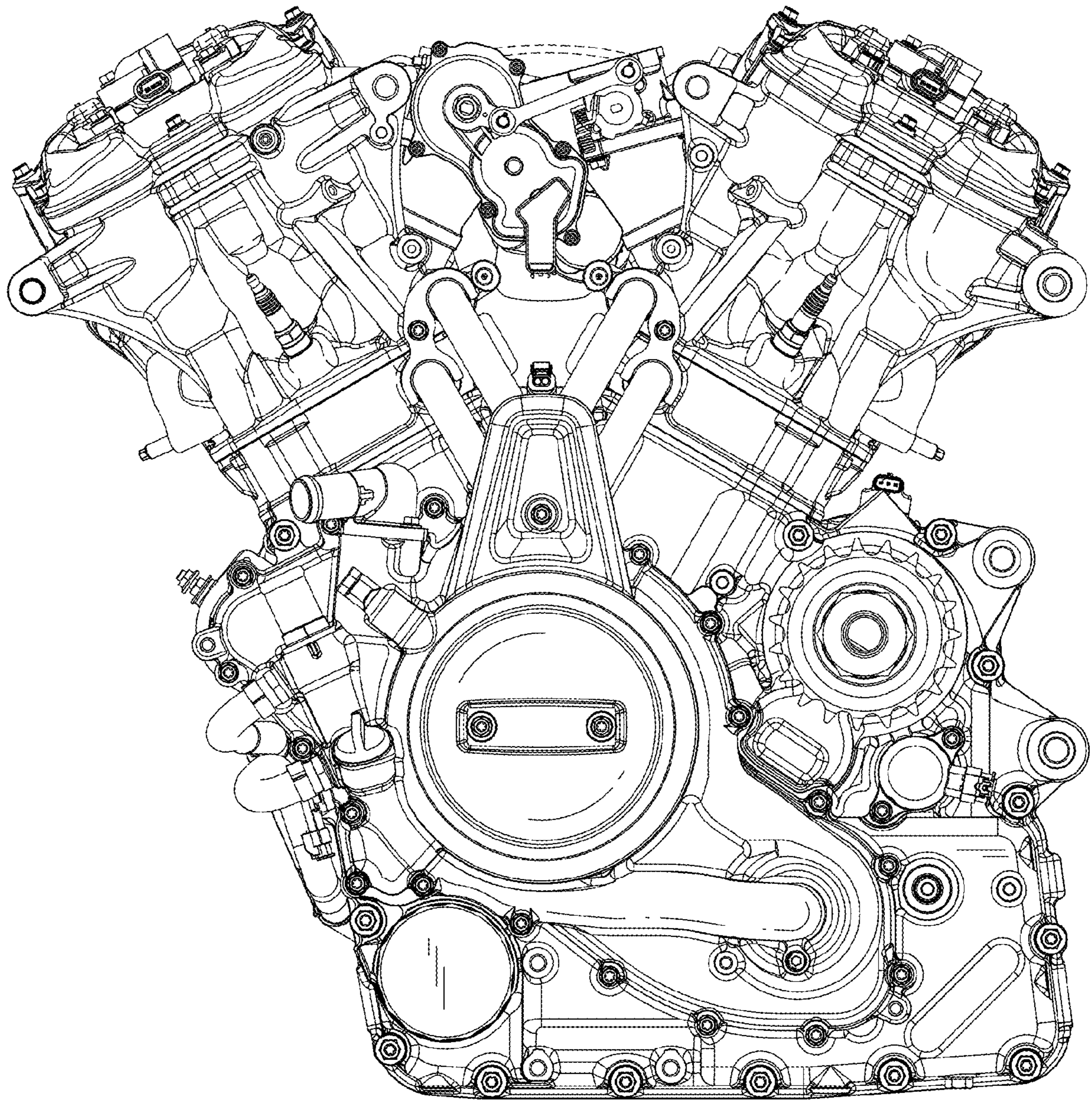

FIG. 8