



US00D896239S

(12) **United States Design Patent** (10) **Patent No.:** **US D896,239 S**
Lee et al. (45) **Date of Patent:** **** Sep. 15, 2020**

(54) **DISPLAY SCREEN OR PORTION THEREOF WITH GRAPHICAL USER INTERFACE**

H04N 5/445; H04N 5/44543; H04N 5/45; H04N

(Continued)

(71) Applicant: **Samsung Electronics Co., Ltd.**,
Suwon-si (KR)

(56) **References Cited**

U.S. PATENT DOCUMENTS

(72) Inventors: **Suengmin Lee**, Gwacheon-si (KR);
Heejin Ko, Bucheon-si (KR); **Hyunjee Kwak**, Seoul (KR); **Yoojin Choi**, Seoul (KR)

D406,123 S * 2/1999 Hodgson D14/487
D416,241 S * 11/1999 Faris D14/487

(Continued)

FOREIGN PATENT DOCUMENTS

(73) Assignee: **Samsung Electronics Co., Ltd.**,
Suwon-si (KR)

CN 2016306096224 5/2017
CN 2017304949566 6/2018

(Continued)

(**) Term: **15 Years**

OTHER PUBLICATIONS

(21) Appl. No.: **29/671,554**

“Gloss transparent yellow frame vector illustration.” publicdomainvectors.org. Apr. 22, 2015. Accessed Jan. 29, 2020. Available online at URL: <https://publicdomainvectors.org/en/free-clipart/Gloss-transparent-yellow-frame-vector-illustration/25936.html> (Year: 2015).*

(22) Filed: **Nov. 28, 2018**

(Continued)

(30) **Foreign Application Priority Data**

Aug. 29, 2018 (KR) 30-2018-0040323

(51) **LOC (12) Cl.** **14-04**

(52) **U.S. Cl.**
USPC **D14/485**

(58) **Field of Classification Search**

USPC D14/485–495; 345/1.1, 1.2, 2.1–2.3, 3.1, 345/902; 715/763, 810, 836, 837, 846, 715/847, 977

CPC G06F 3/048; G06F 3/0481; G06F 3/04812; G06F 3/04817; G06F 3/0482; G06F 3/0483; G06F 3/0484; G06F 3/04847; G06F 3/0485; G06F 3/04855; G06F 3/04886; G06Q 30/00; H03J 1/00; H03J 1/0008; H03J 1/0016; H03J 1/0025; H04N 5/00; H04N 5/08; H04N 5/14; H04N 5/222; H04N 5/225; H04N 5/232;

Primary Examiner — Cathron C Brooks

Assistant Examiner — Christian P. McLean

(74) *Attorney, Agent, or Firm* — NSIP Law

(57) **CLAIM**

We claim the ornamental design for a display screen or portion thereof with graphical user interface, as shown and described.

DESCRIPTION

The sole FIGURE is a front view of a display screen or portion thereof with graphical user interface showing our new design.

The outer dash-dash broken lines showing the display screen or portion thereof form no part of the claimed design. The remaining dash-dash broken lines in the FIGURE depict portions of the graphical user interface that form no part of the claimed design.

(Continued)

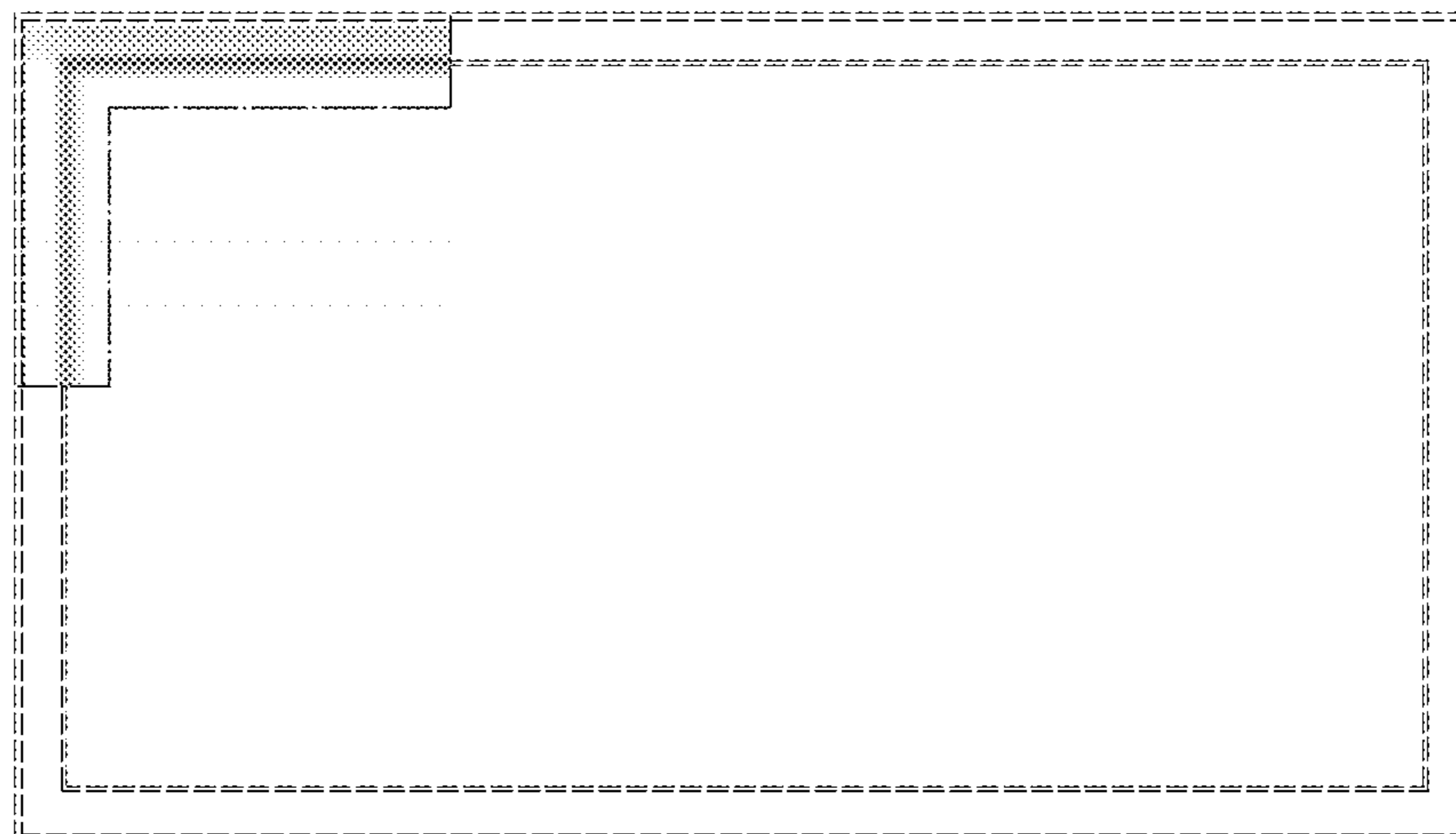

The dot-dash broken lines in the FIGURE represent bounds of the claimed design and form no part thereof.

1 Claim, 1 Drawing Sheet

(58) **Field of Classification Search**

CPC 2005/44517; H04N 2005/44521; H04N 2005/44526; H04N 2005/4453; H04N 2005/44534; H04N 2005/44539; H04N 2005/44547; H04N 2005/44556; H04N 2005/4456; H04N 2005/44565; H04N 2005/44569; H04N 2005/44573; H04N 21/00; H04N 21/234; H04N 21/431; H04N 21/4312; H04N 21/4314; H04N 21/4316

See application file for complete search history.

(56) **References Cited**

U.S. PATENT DOCUMENTS

D554,146 S	10/2007	Gusmorino et al.	
D563,964 S *	3/2008	Viegers	D14/485
D570,861 S *	6/2008	Sadler	D14/486
D570,867 S *	6/2008	Sadler	D14/488
D576,175 S *	9/2008	Onodera	D14/487
D695,754 S *	12/2013	Woo-Seok	D14/485
D697,521 S *	1/2014	Nishina	D14/486
D698,360 S *	1/2014	Hwang	D14/485
D699,263 S *	2/2014	Courage	D14/489
D726,735 S *	4/2015	Asai	D14/485
D729,817 S *	5/2015	Roberts	D14/485
D733,725 S *	7/2015	Seo	D14/486
D734,766 S *	7/2015	Hyo-Sang	D14/485
D742,900 S *	11/2015	Seo	D14/486
D742,901 S *	11/2015	Choi	D14/486
D745,039 S *	12/2015	Jou	D14/488
D749,605 S *	2/2016	Choi	D14/486
D753,675 S *	4/2016	Yang	D14/485
D774,075 S *	12/2016	Konishi	D14/487
D791,789 S *	7/2017	Binne	D14/485
D792,421 S *	7/2017	Day, II	D14/485
D818,472 S *	5/2018	Kondo	D14/485

D857,735 S *	8/2019	Ferrante	D14/487
D858,536 S *	9/2019	Sum	D14/485
D860,243 S *	9/2019	Yoshio	D14/487
D868,102 S *	11/2019	Meixner	D14/487
D873,278 S *	1/2020	Nakahara	D14/485
D873,292 S *	1/2020	Kikkawa	D14/487
D886,832 S *	6/2020	Schuler	D14/485
2013/0212535 A1 *	8/2013	Kim	G06F 3/0482 715/841
2013/0235271 A1 *	9/2013	Kasuga	H04N 21/4854 348/569
2017/0003873 A1 *	1/2017	Park	G06F 3/0236

FOREIGN PATENT DOCUMENTS

EM	001227201-0016	1/2011
EM	001262968-0013	6/2011
KR	30-2009-0042689	12/2009
KR	30-2012-0036228	3/2013

OTHER PUBLICATIONS

“The Frame.” samsung.com. Date note available. Accessed Jan. 29, 2020. Available online at URL: <https://www.samsung.com/uk/tvs/the-frame/art-mode/> (Year: N/A).*

Makpan, Pakpoom. “HUD Futuristic Elements Poor Interface . . .” shutterstock.com. Date not available. Accessed Jan. 29, 2020. Available online at URL: <https://www.shutterstock.com/video/clip-1007580574-hud-futuristic-elements-poor-interference-signal-screen>.*

Cantor, Jan. “Frame Editor (Frayme).” dribbble.com. Jul. 24, 2017. Accessed Jan. 29, 2020. Available online at URL: <https://dribbble.com/shots/3681467-Frame-Editor-Frayme> (Year: 2017).*

“Image Frames.” dribbble.com. Dec. 12, 2011. Accessed Jan. 29, 2020. Available online at URL: <https://dribbble.com/shots/349576-Image-Frames> (Year: 2011).*

Swearingen, Jake. “Samsung’s Newest TVs Are High-Design, High-Tech Chameleons” [2018] www.nymag.com Mar. 7, 2018 < <http://nymag.com/selectall/2018/03/samsungs-qlcd-tvs-blend-into-your-wall-like-a-chameleon.html>>.

MR 4K Upscaler “My Official Review on 2017 C7P OLED TV: from LG” [2017] www.youtube.com Jun. 29, 2017 < <https://www.youtube.com/watch?v=Eknl-tWycBA>>.

* cited by examiner

