



US00D895177S

(12) **United States Design Patent** (10) **Patent No.:** **US D895,177 S**
Smirnov (45) **Date of Patent:** **** Sep. 1, 2020**

(54) **MOTORCYCLE**
(71) Applicant: **FUELL Inc.**, New York, NY (US)
(72) Inventor: **Artem Smirnov**, Minsk (BY)
(73) Assignee: **FUELL Inc.**, New York, NY (US)
(**) Term: **15 Years**
(21) Appl. No.: **29/681,986**
(22) Filed: **Feb. 28, 2019**
(51) **LOC (12) Cl.** **26-06**
(52) **U.S. Cl.**
USPC **D26/28**
(58) **Field of Classification Search**
USPC D12/114, 110, 107, 117, 126, 186;
D26/28, 35
CPC B62J 6/02; F21S 41/28; F21S 43/31; F21S
43/241
See application file for complete search history.

D695,648 S * 12/2013 Yamazaki D12/110
D713,072 S * 9/2014 Phutrakool D26/28
D713,573 S * 9/2014 Futamata D26/28
D732,214 S * 6/2015 Ishiguri D26/28
D741,524 S * 10/2015 Ohashi D26/28
D742,566 S * 11/2015 Kuriki D26/28
D752,251 S * 3/2016 Tsukui D26/28
D761,984 S * 7/2016 Kobayashi D26/28
D773,698 S * 12/2016 Yamada D26/28
D796,087 S * 8/2017 Futamata D26/28
D822,863 S * 7/2018 Kiska D26/28
D823,501 S * 7/2018 Kiska D26/28
2007/0047249 A1* 3/2007 Kogo F21S 43/31
362/538

* cited by examiner

Primary Examiner — Michelle E. Wilson
Assistant Examiner — Clese Moore, Jr.
(74) *Attorney, Agent, or Firm* — Banner & Witcoff, Ltd.

(57) **CLAIM**

The ornamental design for a motorcycle, as shown and described.

DESCRIPTION

FIG. 1 is a front, right perspective view of a motorcycle showing my new design;
FIG. 2 is a front, left perspective view thereof;
FIG. 3 is a right side view thereof;
FIG. 4 is a left side view thereof; and,
FIG. 5 is a top view thereof.
The broken lines immediately adjacent to the shaded area define the bounds of the claimed design and form no part thereof. The broken lines depicting the remainder of the motorcycle show features that form no part of the claimed design.

1 Claim, 5 Drawing Sheets

(56) **References Cited**

U.S. PATENT DOCUMENTS

D496,613 S * 9/2004 Everitt D12/182
D523,168 S * 6/2006 Reed D26/139
D559,738 S * 1/2008 Takigawa D12/110
D568,501 S * 5/2008 Nakazawa D26/28
D573,734 S * 7/2008 Watanabe D26/28
D580,076 S * 11/2008 Ichihara D26/28
D602,617 S * 10/2009 Kogo D26/28
D617,020 S * 6/2010 Ishiguri D26/28
D638,151 S * 5/2011 Hung D26/28
D649,914 S * 12/2011 Marasco D12/110
D652,769 S * 1/2012 Kudo D12/110
D692,167 S * 10/2013 Yamazaki D26/28
D693,275 S * 11/2013 Murakami D12/110

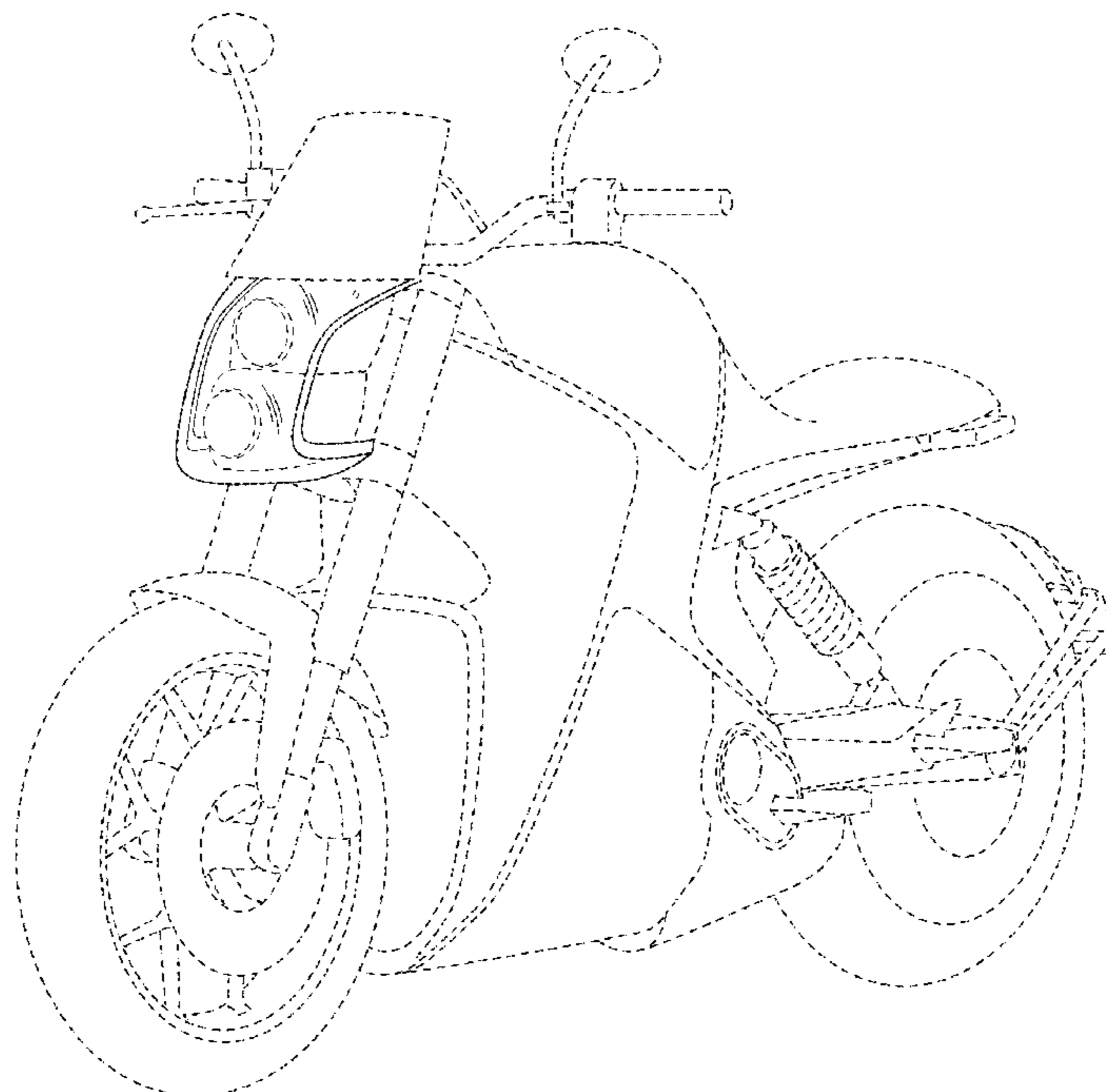

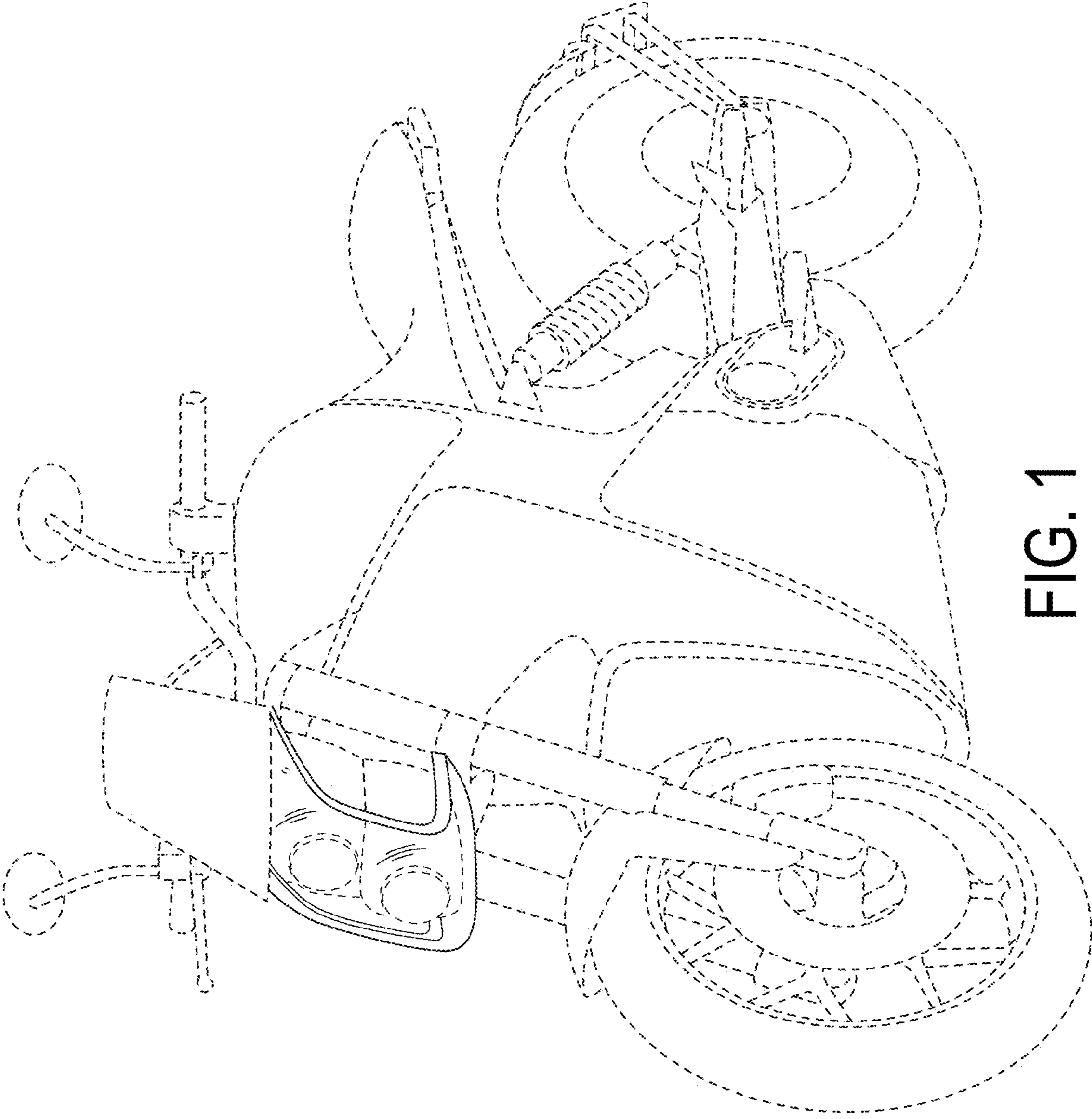

FIG. 1

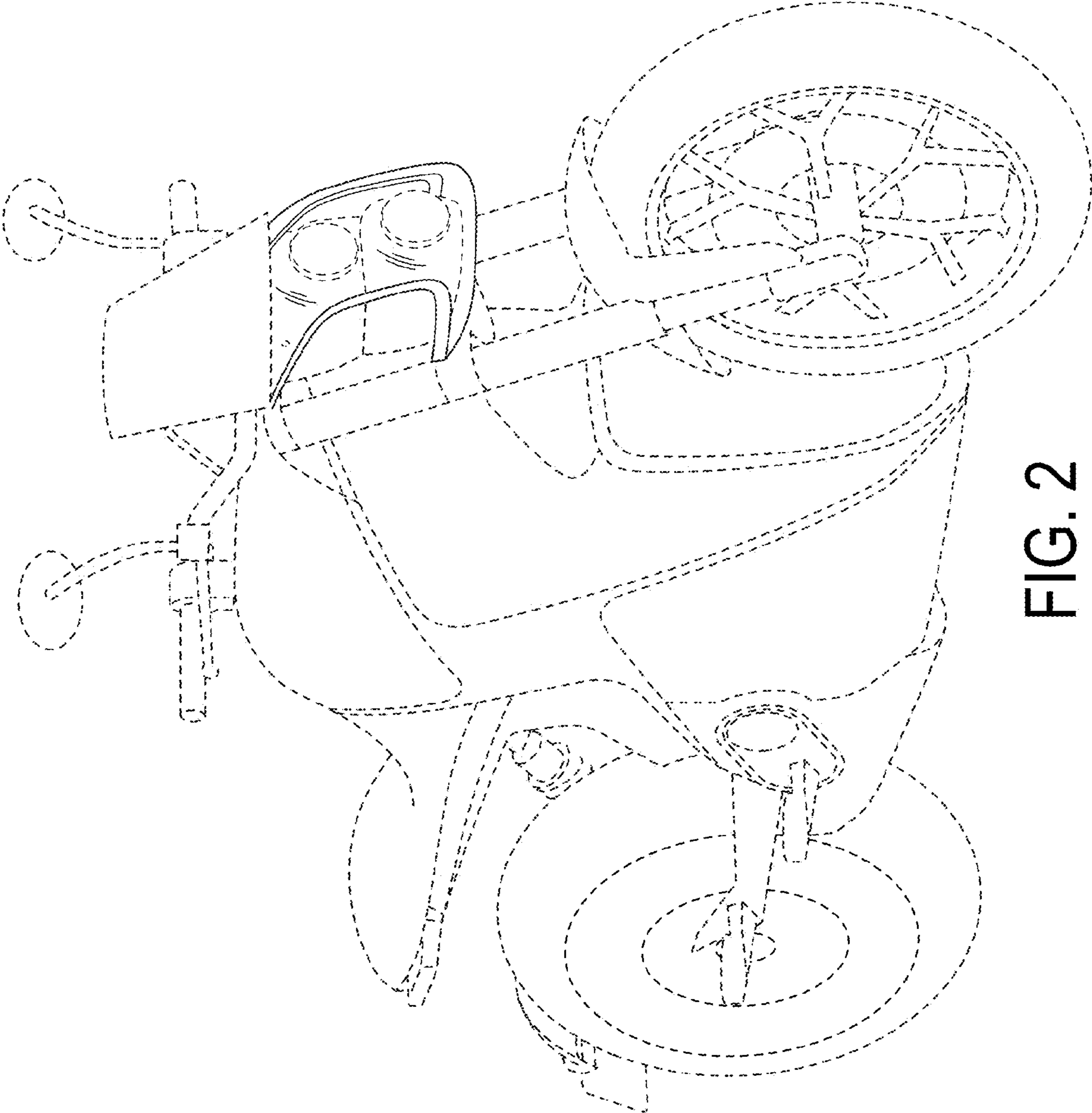

FIG. 2

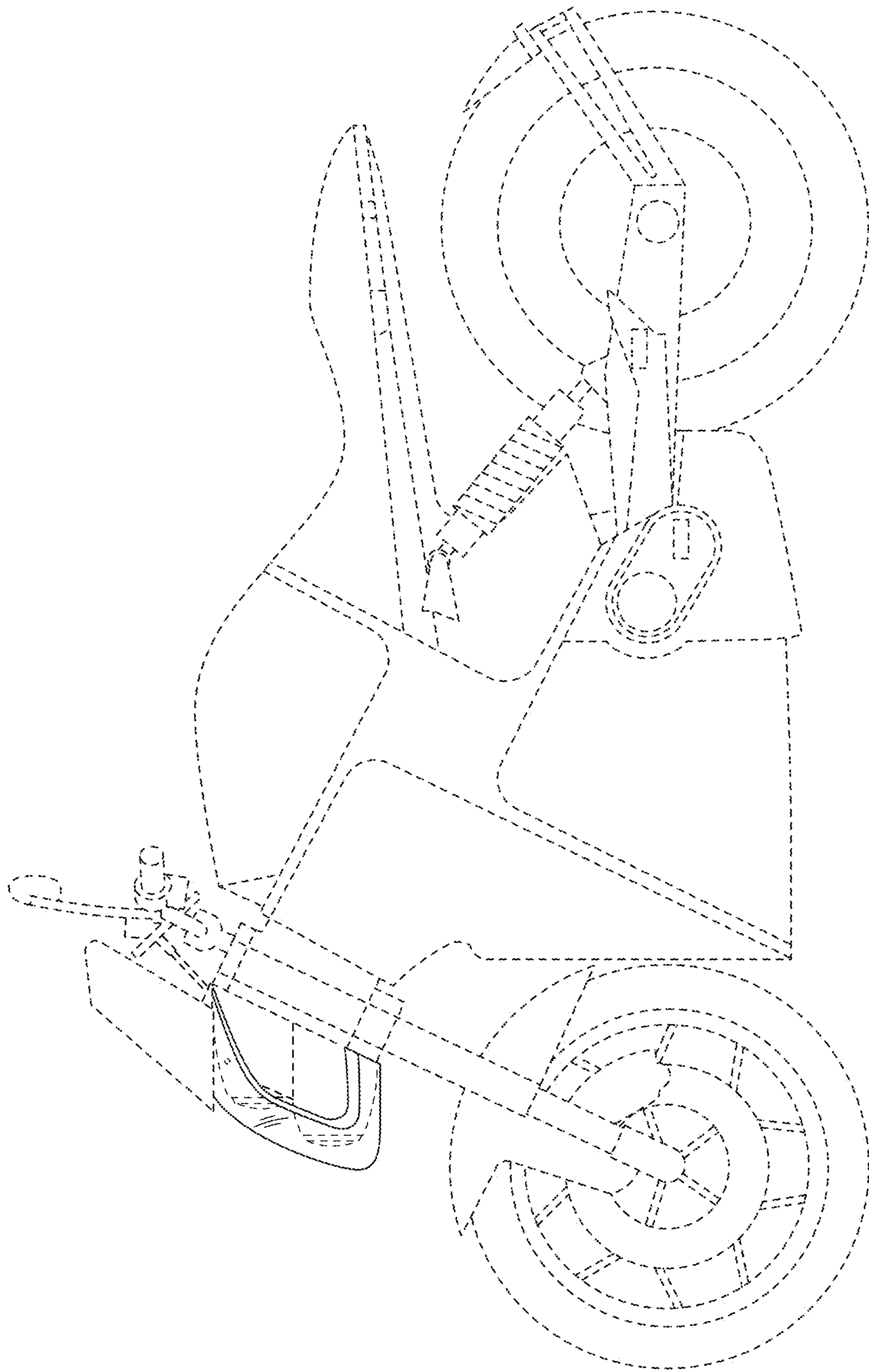

FIG. 3

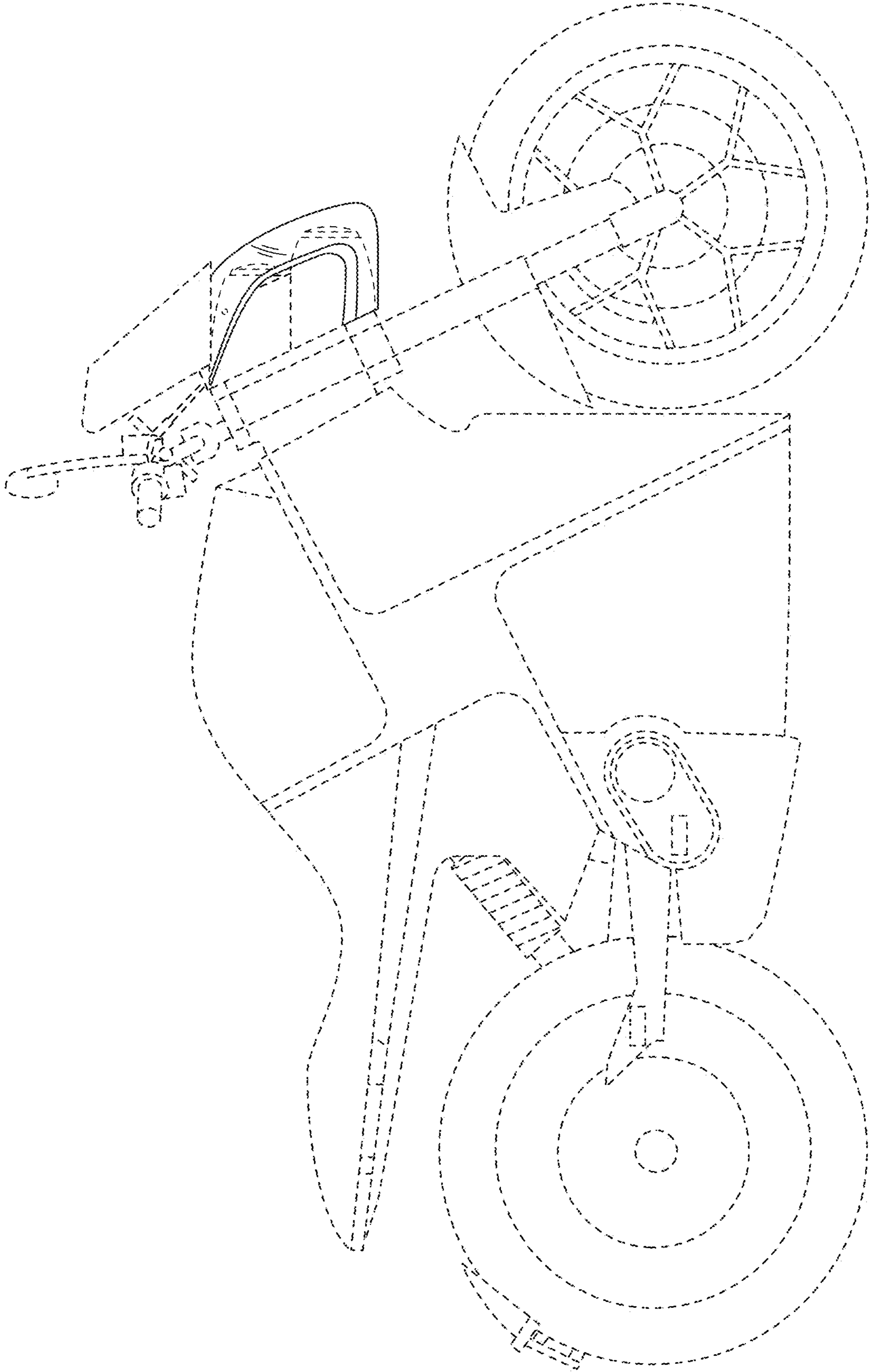

FIG. 4

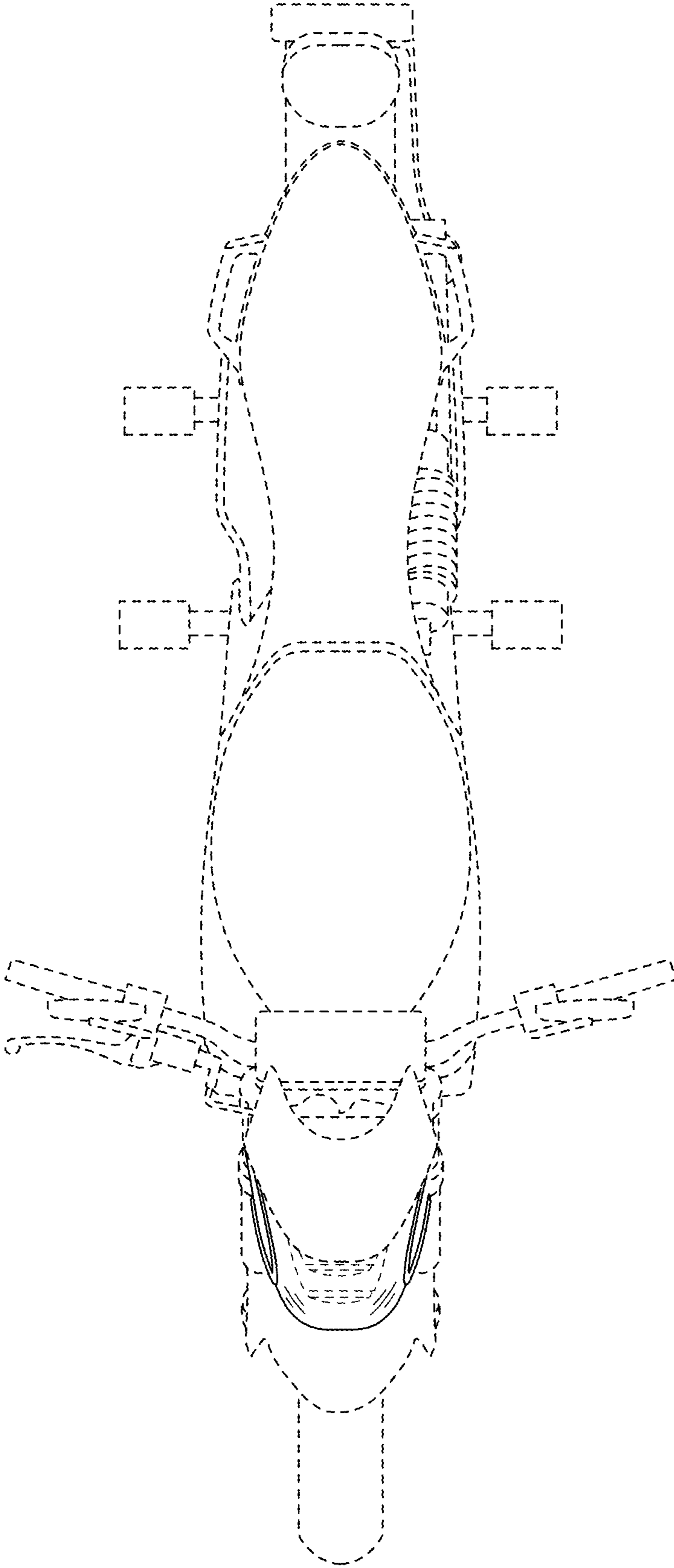

FIG. 5