



US00D894797S

(12) **United States Design Patent** (10) **Patent No.:** **US D894,797 S**
Lee (45) **Date of Patent:** **** Sep. 1, 2020**

(54) **LINK PACKING INSTALLED BETWEEN TRACK BUSH AND BOTTOM OF LINK COUNTER HOLE FOR ROAD-RAIL VEHICLE**

(71) Applicant: **Ki Kwang Lee**, Siheung-si (KR)

(72) Inventor: **Ki Kwang Lee**, Siheung-si (KR)

(**) Term: **15 Years**

(21) Appl. No.: **29/670,910**

(22) Filed: **Nov. 20, 2018**

(51) **LOC (12) Cl.** **12-16**

(52) **U.S. Cl.**
USPC **D12/159**

(58) **Field of Classification Search**
USPC D12/159-160
CPC F16J 15/0887; F16J 15/52; F16J 15/38;
F16J 3/04; B62D 55/0887; B62D 55/15
See application file for complete search history.

(56) **References Cited**

U.S. PATENT DOCUMENTS

- 4,201,391 A * 5/1980 Bankstahl B63H 20/02
277/636
- D274,128 S * 6/1984 Bennett D23/231
- 4,678,064 A * 7/1987 Adachi F16D 55/22655
188/73.45
- 4,927,203 A * 5/1990 Mayer E05B 81/25
292/201

- 4,938,726 A * 7/1990 Bland B63H 20/02
440/112
- D413,794 S * 9/1999 Sawicki D9/683
- 2008/0314356 A1* 12/2008 Kamen F16C 11/12
123/197.3
- 2019/0202255 A1* 7/2019 Ohmura F16J 15/52

FOREIGN PATENT DOCUMENTS

WO WO-2020022139 A1 * 1/2020 F16D 3/74

* cited by examiner

Primary Examiner — Michael A. Pratt

(74) *Attorney, Agent, or Firm* — Novick, Kim & Lee, PLLC; Jae Youn Kim; Hyun Woo Shin

(57) **CLAIM**

I claim, the ornamental design for a link packing installed between track bush and bottom of link counter hole for road-rail vehicle, as shown and described.

DESCRIPTION

FIG. 1 is a perspective view of a link packing installed between track bush and bottom of link counter hole for road-rail vehicle, showing my new design; FIG. 2 is a front elevational view thereof, the rear, left side, and right side elevational views being identical; FIG. 3 is a top plan view thereof; and, FIG. 4 is a bottom plan view thereof.

1 Claim, 4 Drawing Sheets

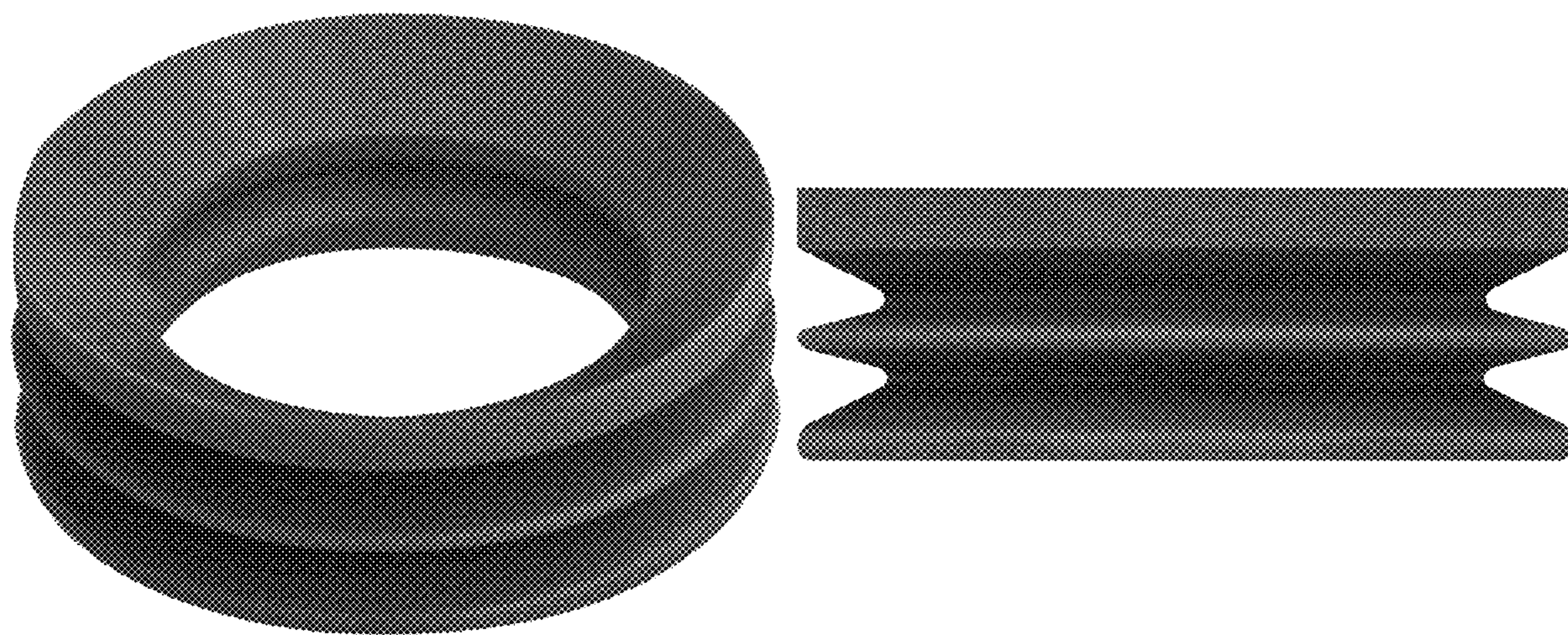



FIG. 1

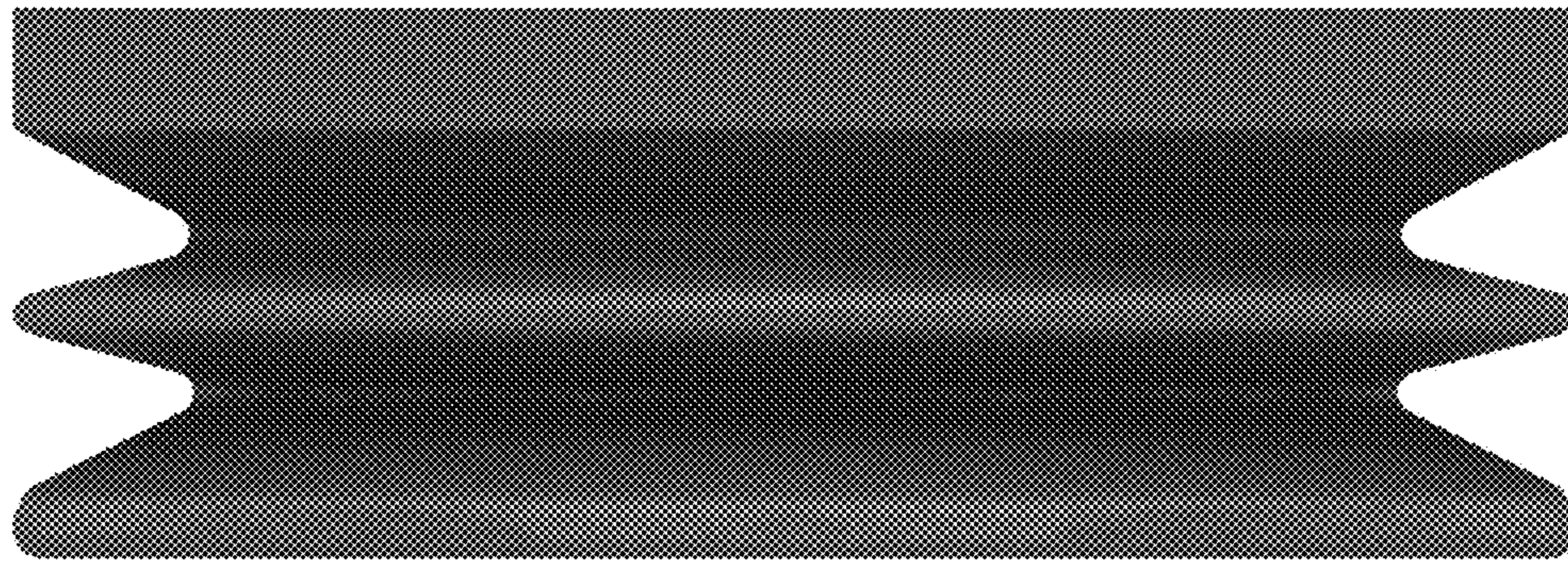

FIG. 2

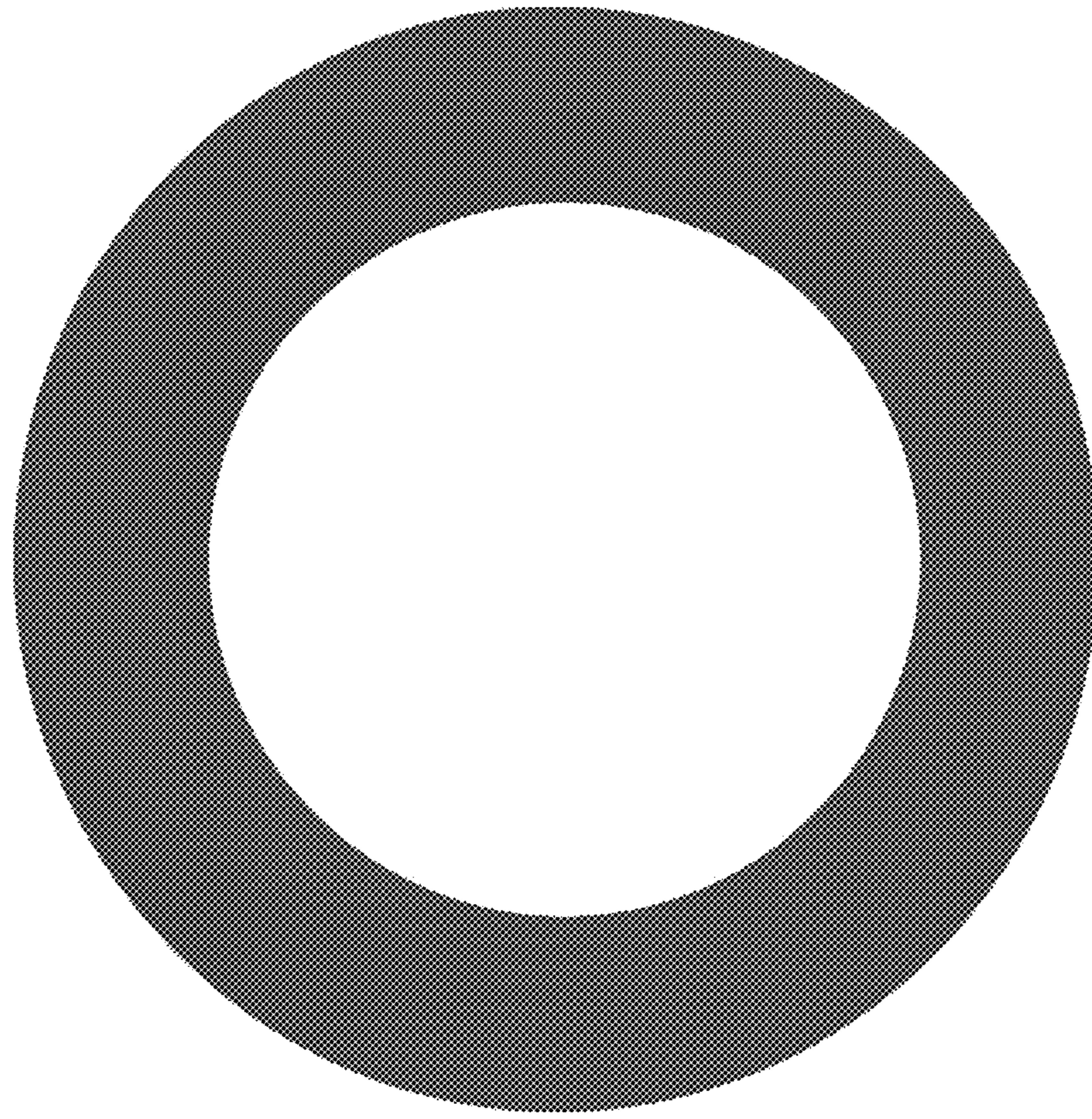

FIG. 3

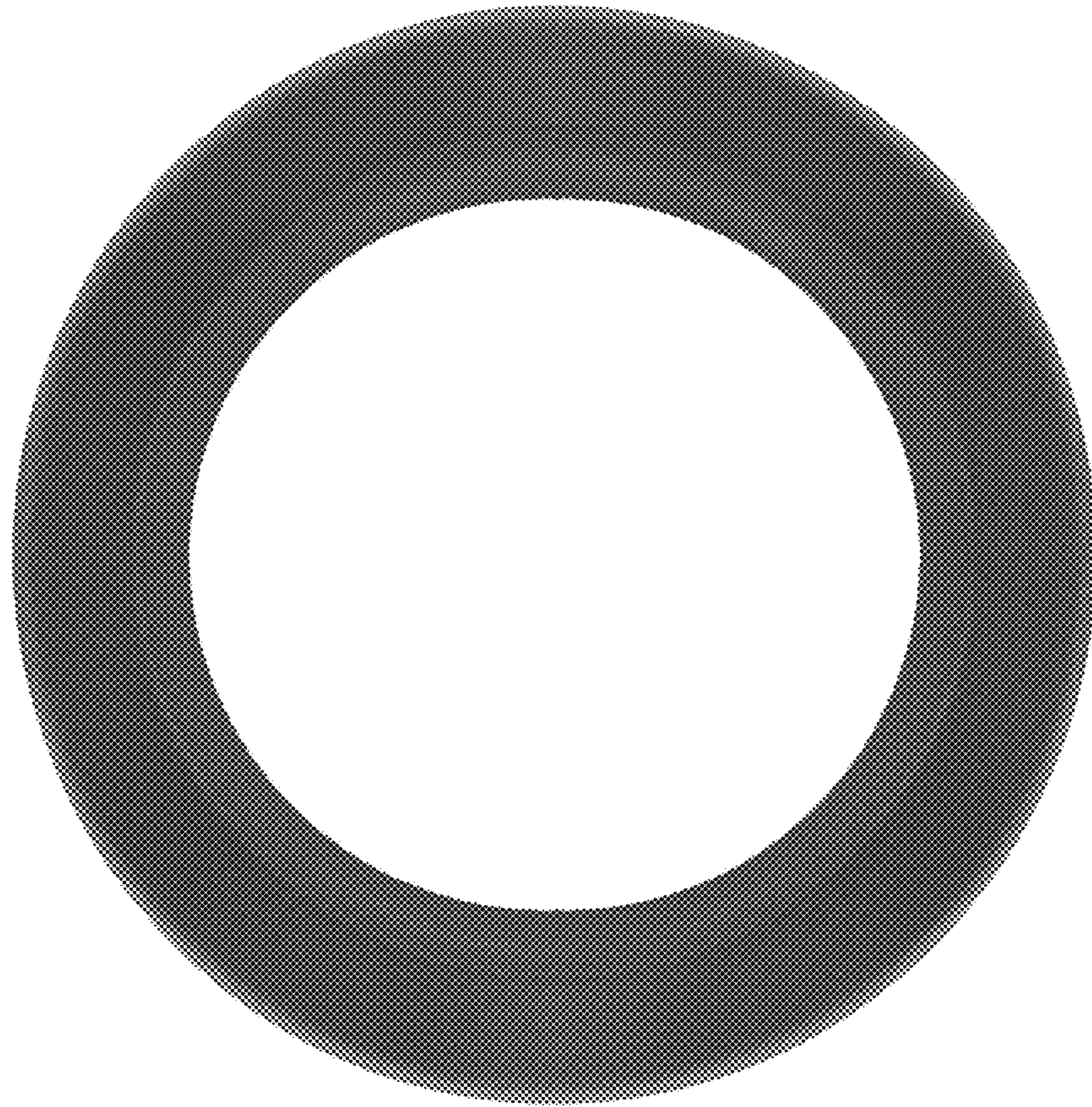

FIG. 4