

US00D892822S

(12) **United States Design Patent** (10) **Patent No.:** **US D892,822 S**
Suzuki et al. (45) **Date of Patent:** **** Aug. 11, 2020**

(54) **DISPLAY SCREEN WITH GRAPHICAL USER INTERFACE**

(71) Applicant: **IPOC Co., Ltd.**, Tokyo (JP)

(72) Inventors: **Koichi Suzuki**, Tokyo (JP); **Shinji Nakai**, Tokyo (JP)

(73) Assignee: **IPOC Co., Ltd.** (JP)

(**) Term: **15 Years**

(21) Appl. No.: **29/670,726**

(22) Filed: **Nov. 19, 2018**

(30) **Foreign Application Priority Data**

May 21, 2018 (JP) 2018-011035

(51) **LOC (12) Cl.** **14-04**

(52) **U.S. Cl.**
USPC **D14/485**

(58) **Field of Classification Search**
USPC D14/485-495
CPC G06Q 10/063114; H04N 1/00477; G11B 27/34; G06F 3/0484; G06F 3/048; G05B 19/418

See application file for complete search history.

(56) **References Cited**

U.S. PATENT DOCUMENTS

D395,291 S * 6/1998 Mason D14/490
D484,142 S * 12/2003 Bungert D14/489
D501,484 S * 2/2005 Platz D14/489
D735,743 S * 8/2015 Kanenari D14/486
D737,293 S * 8/2015 Kanenari D14/486
D738,896 S * 9/2015 Kanenari D14/486
D740,840 S * 10/2015 Zhang H04L 41/22
D14/486

D759,686 S * 6/2016 Chen B64D 43/00
D14/486
D766,280 S * 9/2016 Mesguen D14/486
D819,650 S * 6/2018 Wang D14/485
D830,388 S * 10/2018 Day D14/486
2014/0181676 A1* 6/2014 Samborsky H04L 41/22
715/736
2015/0217874 A1* 8/2015 Mesguen B64D 43/00
701/29.1

OTHER PUBLICATIONS

Stover, Ben and Muller, Kai. "TreeGraph 2: Combining and visualizing evidence . . ." BMC Bioinformatics, v. 11 No. 7 (2010), published Jan. 5, 2010 (Retrieved from the Internet Apr. 8, 2020). Internet URL: <<https://bmcbioinformatics.biomedcentral.com/articles/10.1186/1471-2105-11-7>> (Year: 2010).*

(Continued)

Primary Examiner — Jack Reickel
Assistant Examiner — Rachel A Voorhies

(57) **CLAIM**

The ornamental design for a display screen with graphical user interface, as shown and described.

DESCRIPTION

FIG. 1 is a front view of a display screen or portion thereof with graphical user interface showing our new design; and, FIG. 2 is a front view of a display screen or portion thereof with graphical user interface, in accordance with a second embodiment.

The broken line showings of the display screen or portion thereof in all views are for the purpose of illustrating environmental structure and form no part of the claimed design.

1 Claim, 2 Drawing Sheets

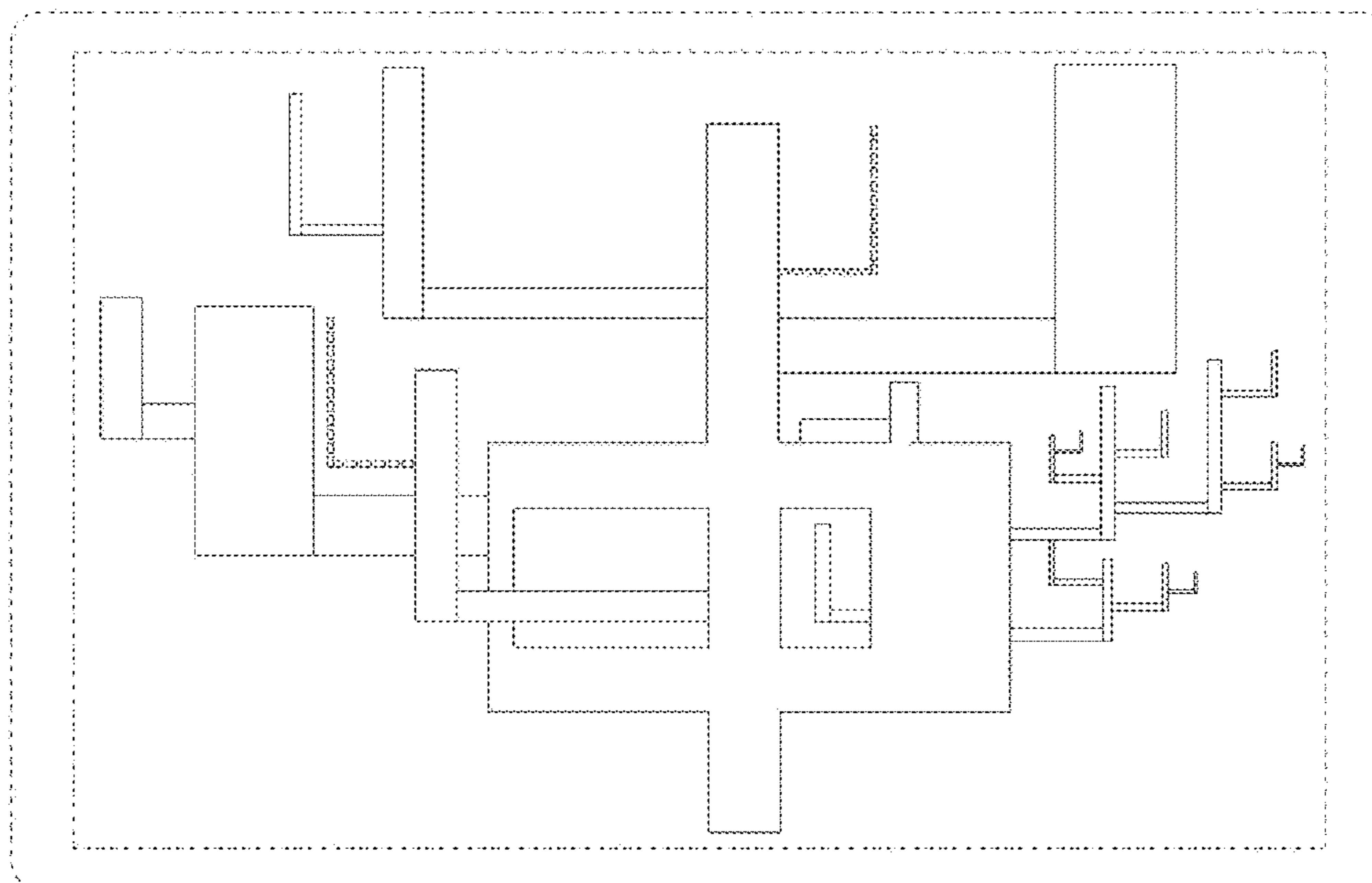

(56)

References Cited

OTHER PUBLICATIONS

Galili, Tal. "Dendextend: an R package for visualizing, adjusting and comparing trees or hierarchical clustering." *Bioinformatics*, 31(22), published Jul. 23, 2015 (Retrieved from the Internet Apr. 8, 2020). (Year: 2015).*

Bahl, Annol Sarita. "27 Dendogram." Dribbble, published Feb. 19, 2018 (Retrieved from the Internet Apr. 8, 2020). Internet URL: <<https://dribbble.com/shots/4243040-27-Dendogram>> (Year: 2018).*

* cited by examiner

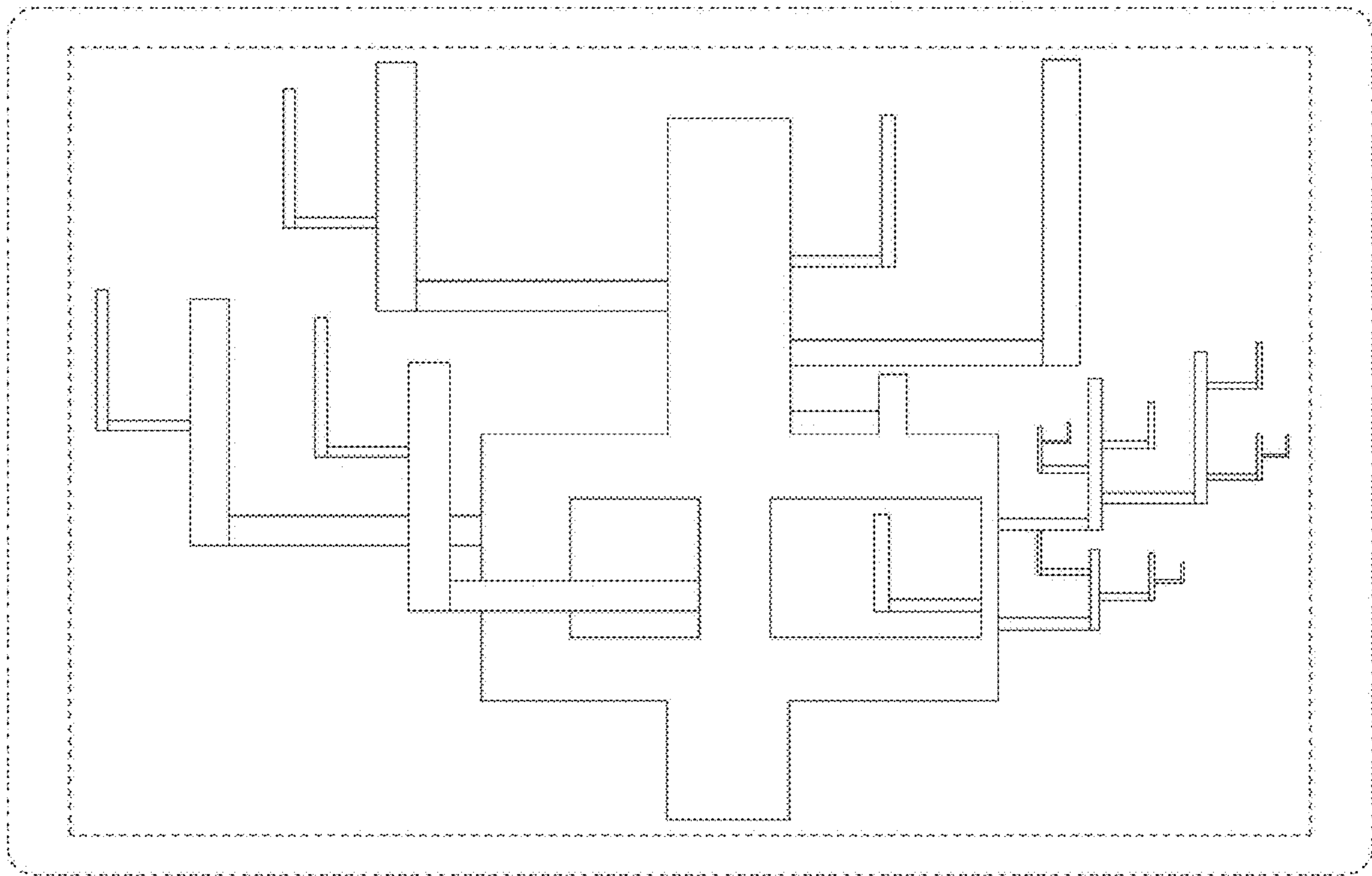

FIG. 1

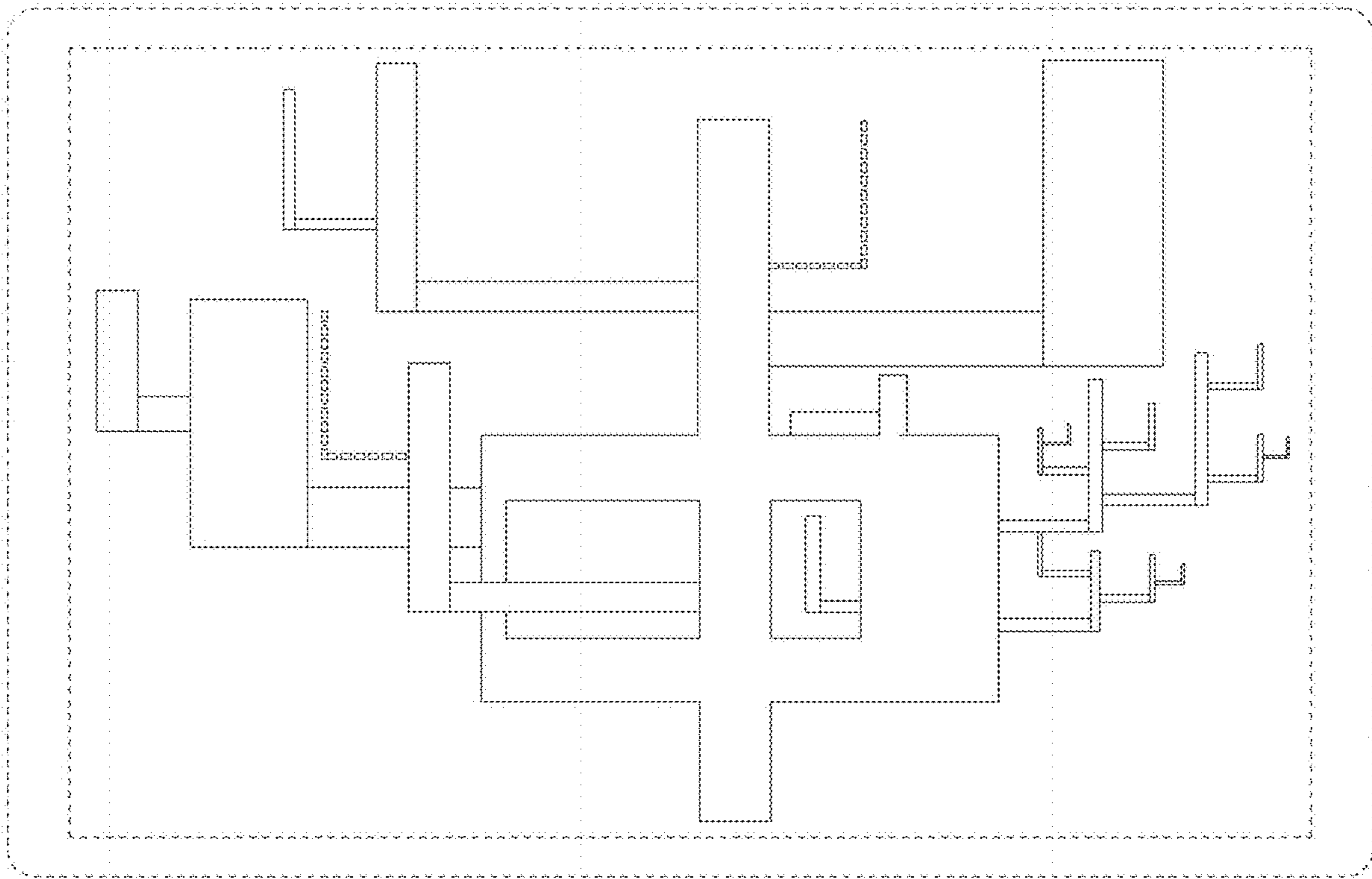

FIG. 2