



US00D890836S

(12) **United States Design Patent** (10) **Patent No.:** **US D890,836 S**  
**Wang et al.** (45) **Date of Patent:** **\*\* Jul. 21, 2020**

(54) **PROJECTOR EQUIPPED WITH A LAMP**

(71) Applicants: **Wei-Jun Wang**, Taipei (TW); **Ting-Wei Wu**, Taipei (TW); **Wen-Yi Chiu**, Taipei (TW); **Po-Hsien Yang**, Taipei (TW); **Shi-Kuan Chen**, Taipei (TW)

(72) Inventors: **Wei-Jun Wang**, Taipei (TW); **Ting-Wei Wu**, Taipei (TW); **Wen-Yi Chiu**, Taipei (TW); **Po-Hsien Yang**, Taipei (TW); **Shi-Kuan Chen**, Taipei (TW)

(73) Assignee: **COMPAL ELECTRONICS, INC.**, Taipei (TW)

(\*\*) Term: **15 Years**

(21) Appl. No.: **29/578,192**

(22) Filed: **Sep. 19, 2016**

(51) **LOC (12) Cl.** ..... **16-02**

(52) **U.S. Cl.**  
USPC ..... **D16/235**

(58) **Field of Classification Search**  
USPC ..... D16/200, 211, 221, 225, 230, 231, 232, D16/233, 234, 235; D26/24, 27, 34, 43, D26/62, 123, 124, 138, 139, 153, 155  
CPC ..... G03B 13/00; G03B 13/02; G03B 21/00; G03B 21/001; G03B 21/12; G03B 21/14; G03B 21/132; G03B 21/145; G03B 17/00; G03B 17/54; G03B 17/56  
See application file for complete search history.

(56) **References Cited**

U.S. PATENT DOCUMENTS

D342,272 S \* 12/1993 Saito ..... D14/423  
D397,709 S \* 9/1998 Park ..... D16/232  
D482,382 S \* 11/2003 Kurokawa ..... D16/232

(Continued)

*Primary Examiner* — Wan Laymon

*Assistant Examiner* — Clint A Samuel

(74) *Attorney, Agent, or Firm* — JCIPRNET

(57) **CLAIM**

The ornamental design for a projector equipped with a lamp, as shown and described.

**DESCRIPTION**

FIG. 1 is a perspective view of a projector equipped with a lamp showing our new design; FIG. 2 is a front view thereof; FIG. 3 is a rear view thereof; FIG. 4 is a left side view thereof; FIG. 5 is a right side view thereof; FIG. 6 is a top view thereof; FIG. 7 is a bottom view thereof; FIG. 8 is a cross-sectional view taken along line 8-8 in FIG. 2 thereof; FIG. 9 is an enlarged view of the circled portion so indicated in FIG. 1 thereof; FIG. 10 is an enlarged view of the circled portion so indicated in FIG. 6 thereof; FIG. 11 is an enlarged view of the circled portion so indicated in FIG. 8 thereof; FIG. 12 is a perspective view thereof in a state that the projector equipped with a lamp is rotated by a certain angle; FIG. 13 is a perspective view thereof in a state that the projector equipped with a lamp is rotated by 180 degrees; and, FIG. 14 is a perspective view thereof in a state that the projector equipped with a lamp is rotated by 270 degrees. The dot-dashed broken lines represent a boundary of the claimed design and form no part of the claimed design. The dashed broken line showing of portions of the projector equipped with a lamp is for the purpose of illustrating unclaimed portions of the projector equipped with a lamp and forms no part of the claimed design.

**1 Claim, 10 Drawing Sheets**

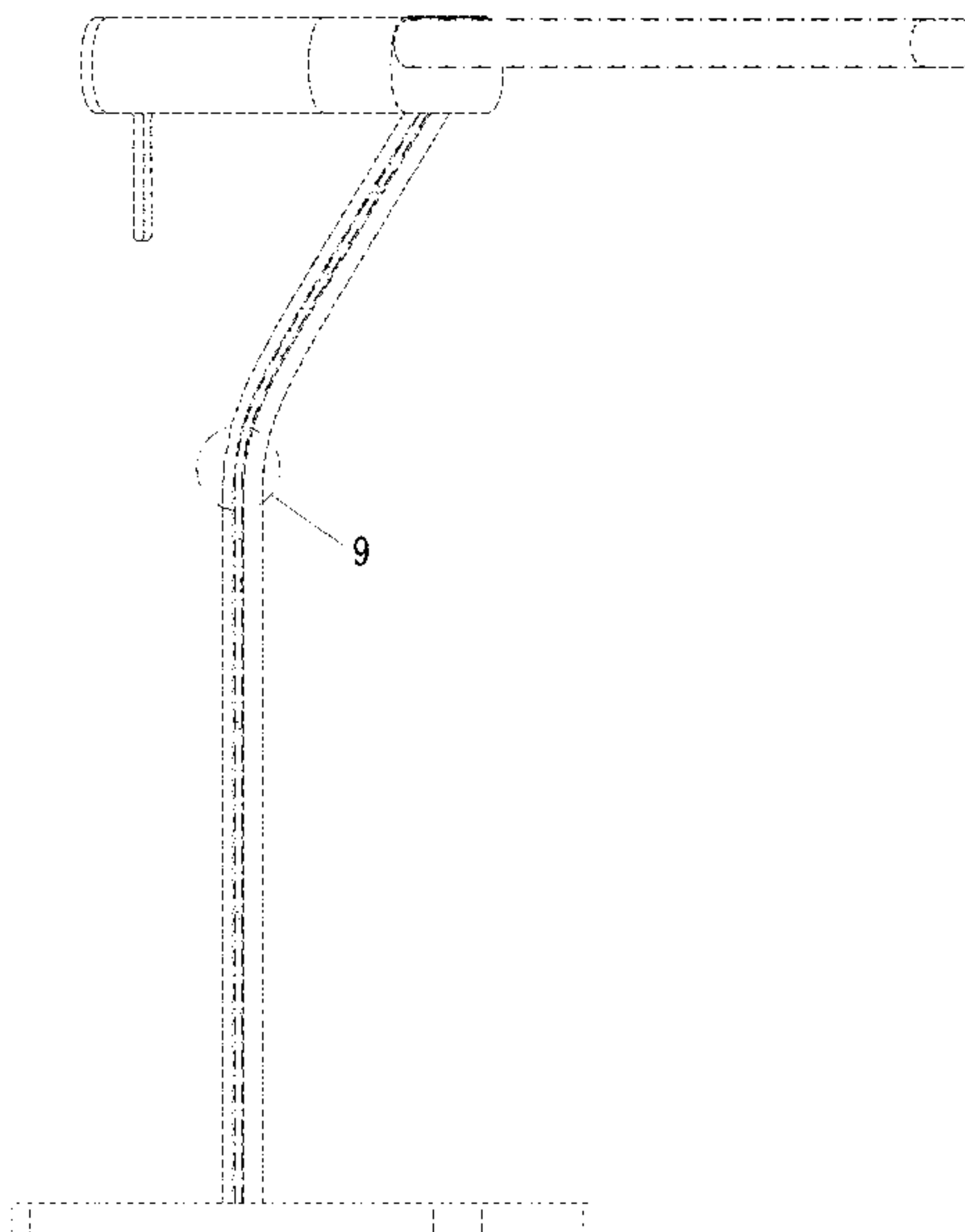

(56)

**References Cited**

## U.S. PATENT DOCUMENTS

7,245,441 B2 \* 7/2007 Wu ..... G03B 17/04  
348/207.1  
D569,890 S \* 5/2008 Sukenari ..... D14/423  
D602,063 S \* 10/2009 Su ..... D14/423  
D603,889 S \* 11/2009 Sukenari ..... D14/423  
D608,047 S \* 1/2010 Scheper ..... D26/138  
D623,679 S \* 9/2010 Dittmer ..... D16/235  
D626,164 S \* 10/2010 Kato ..... D14/423  
D642,608 S \* 8/2011 Kato ..... D14/423  
D651,635 S \* 1/2012 Hong ..... D14/423  
D662,121 S \* 6/2012 Rodriguez ..... D14/423  
D685,017 S \* 6/2013 Kato ..... D16/235  
D746,893 S \* 1/2016 Dong ..... D16/135  
D753,209 S \* 4/2016 Zetsu ..... D16/208  
D773,548 S \* 12/2016 Huang ..... D16/225  
D782,558 S \* 3/2017 Tabuchi ..... D16/214  
D799,355 S \* 10/2017 Riffner ..... D10/111  
D807,540 S \* 1/2018 Soofer ..... D26/27  
D807,541 S \* 1/2018 Soofer ..... D26/27  
D863,409 S \* 10/2019 Wang ..... D16/235  
2019/0049827 A1 \* 2/2019 Wang ..... G03B 21/145  
2019/0101816 A1 \* 4/2019 Kuroda ..... G02B 7/02  
2019/0137077 A1 \* 5/2019 Komatsu ..... F21V 9/30

\* cited by examiner

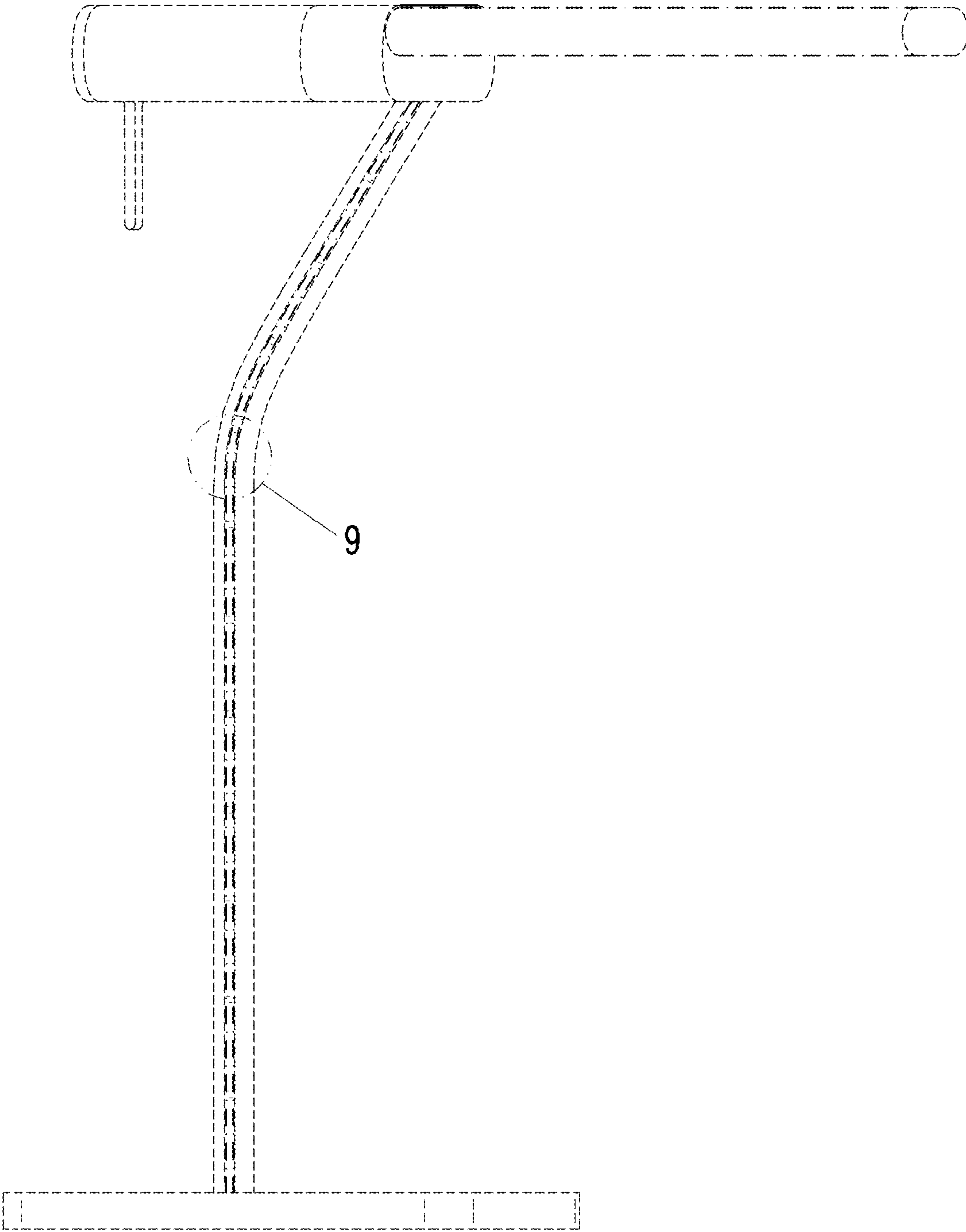

FIG. 1

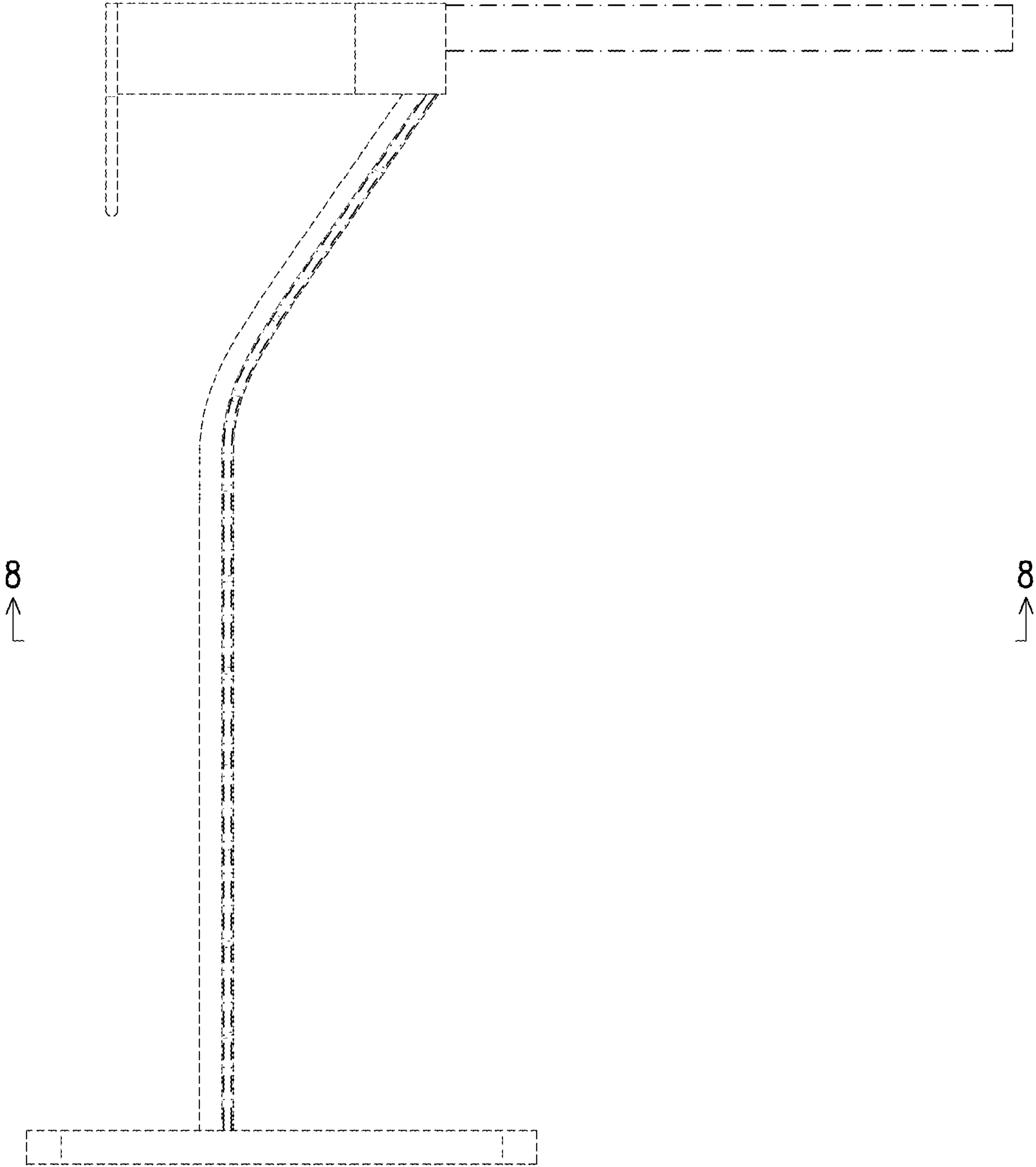

FIG. 2

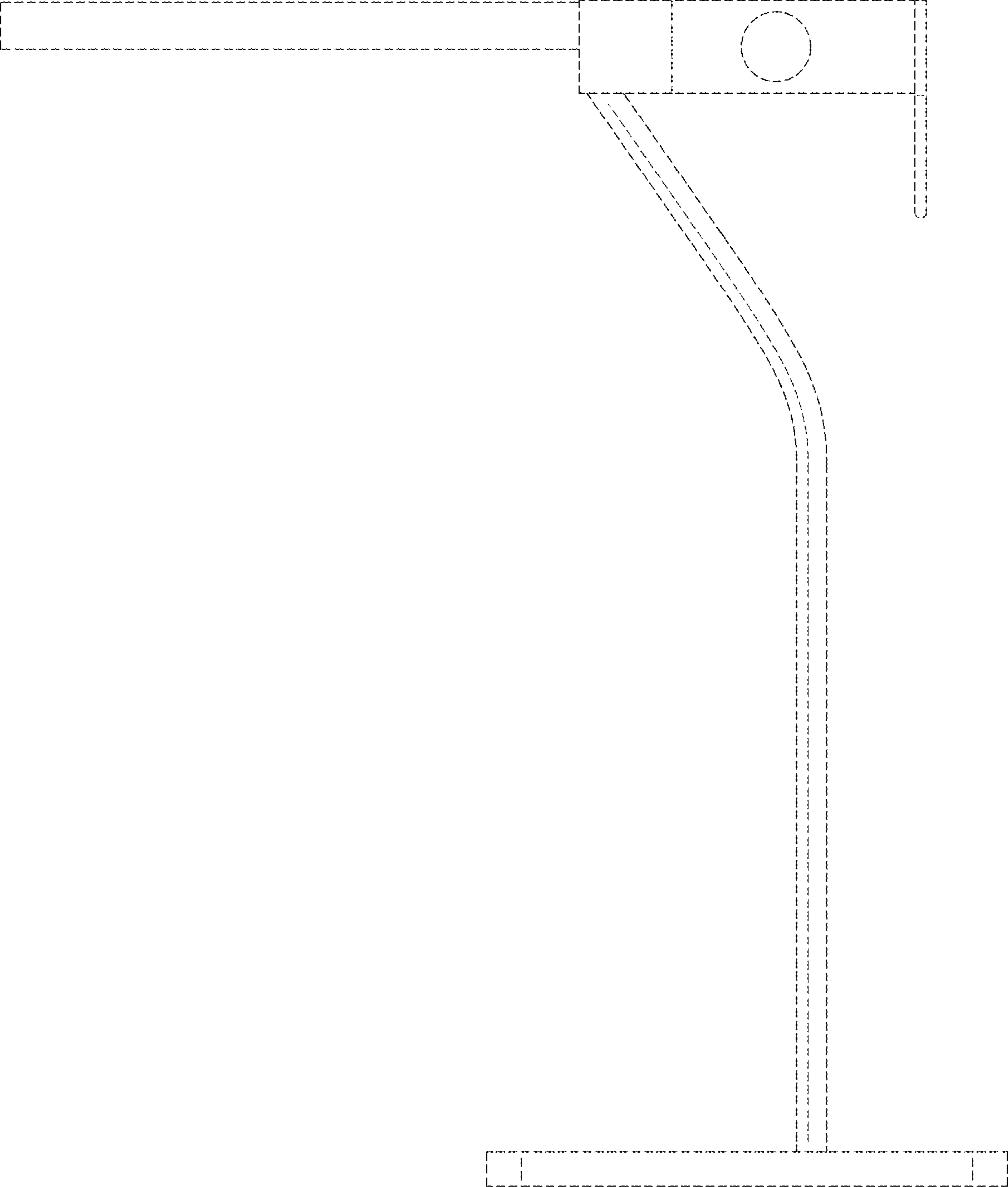

FIG. 3

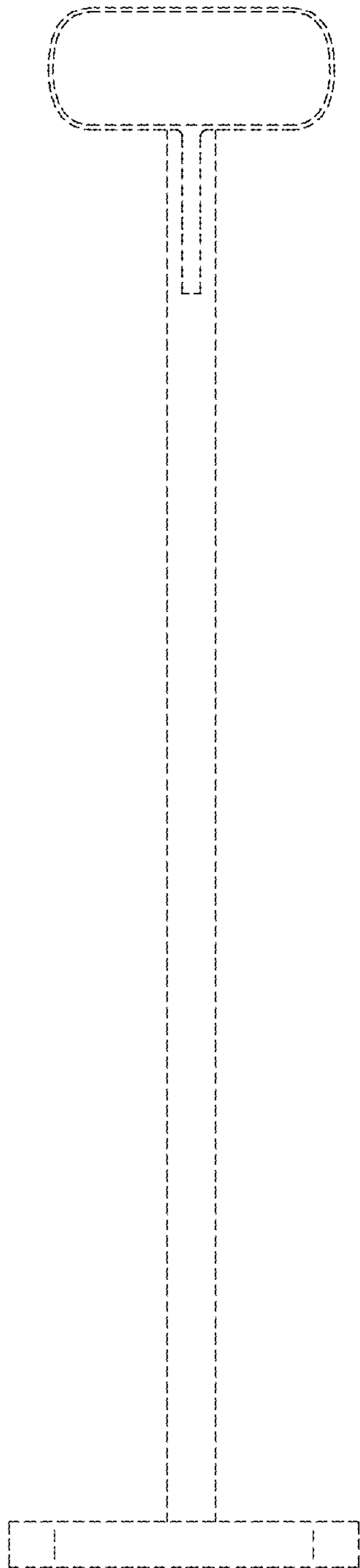

FIG. 4

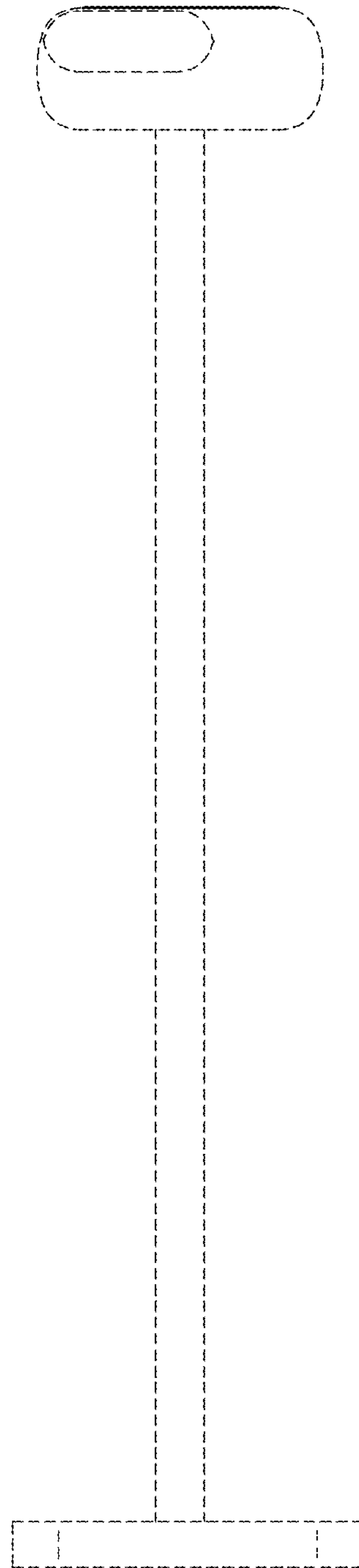

FIG. 5

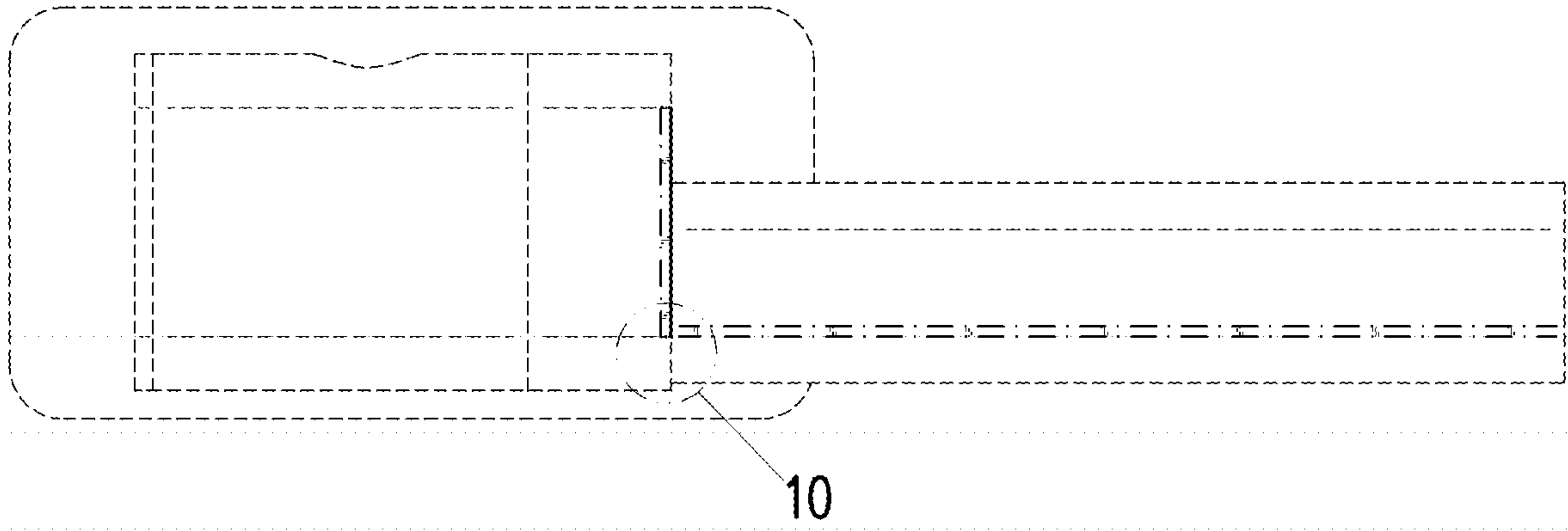

FIG. 6

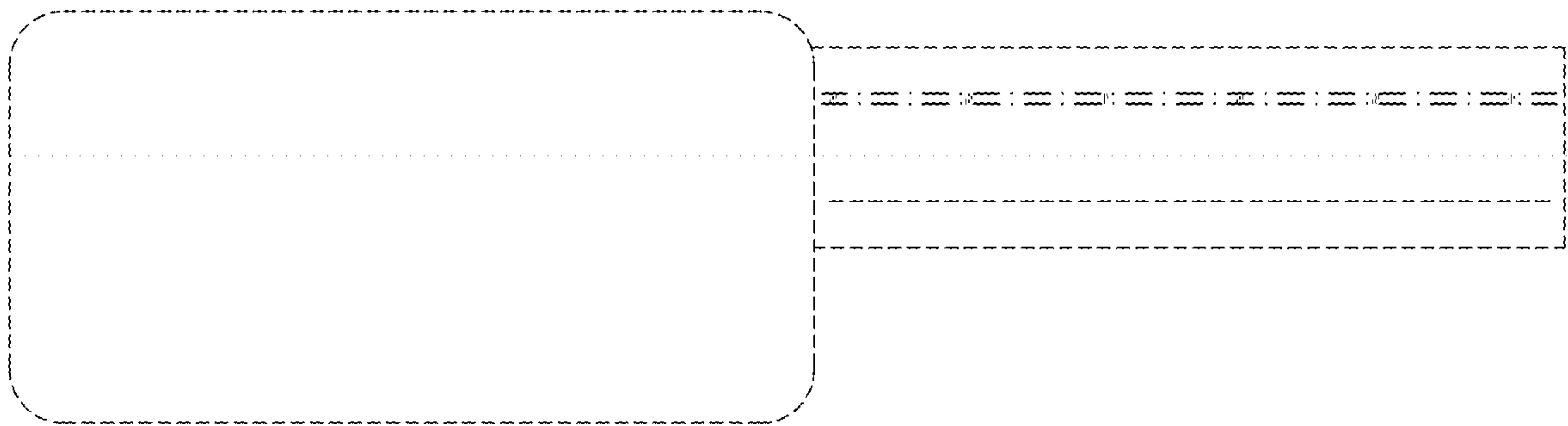

FIG. 7

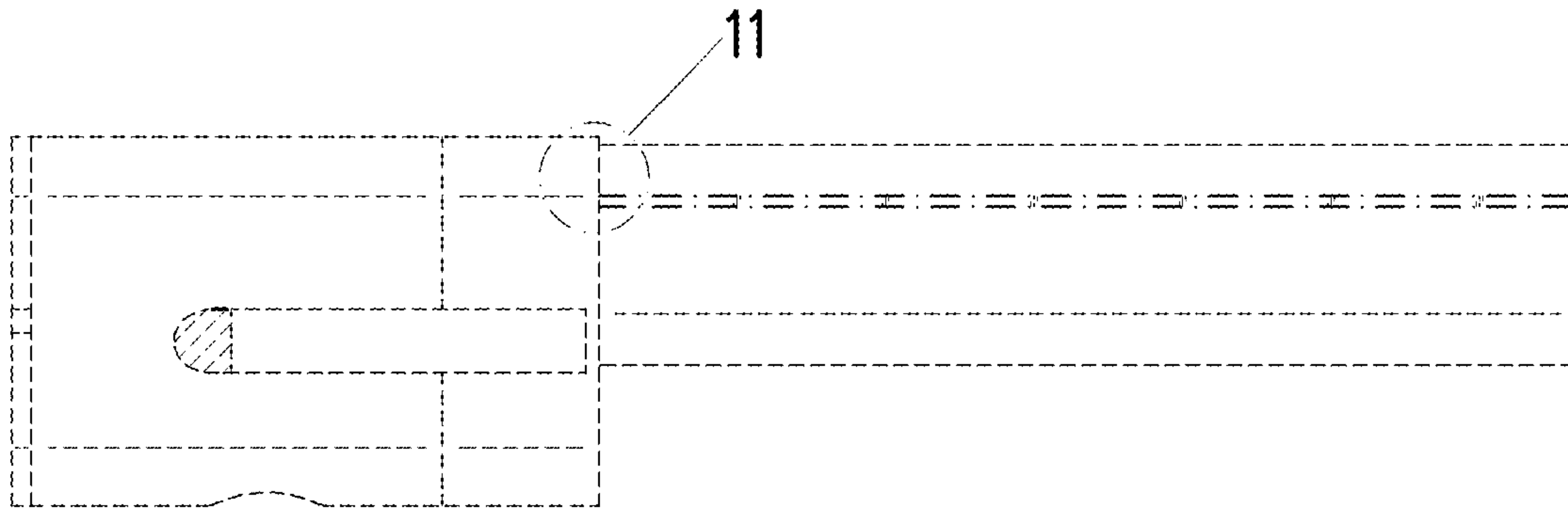

FIG. 8

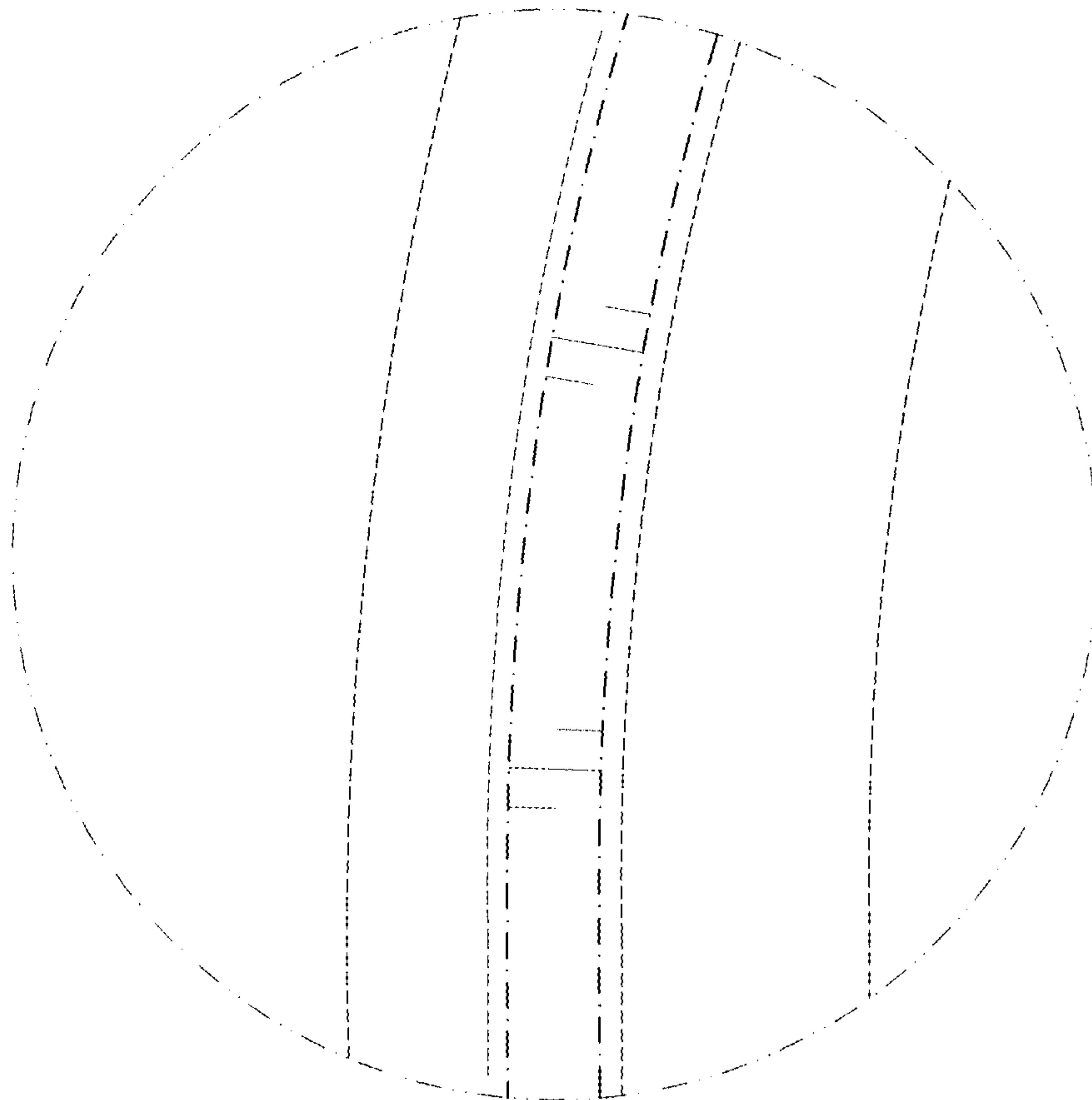

FIG. 9



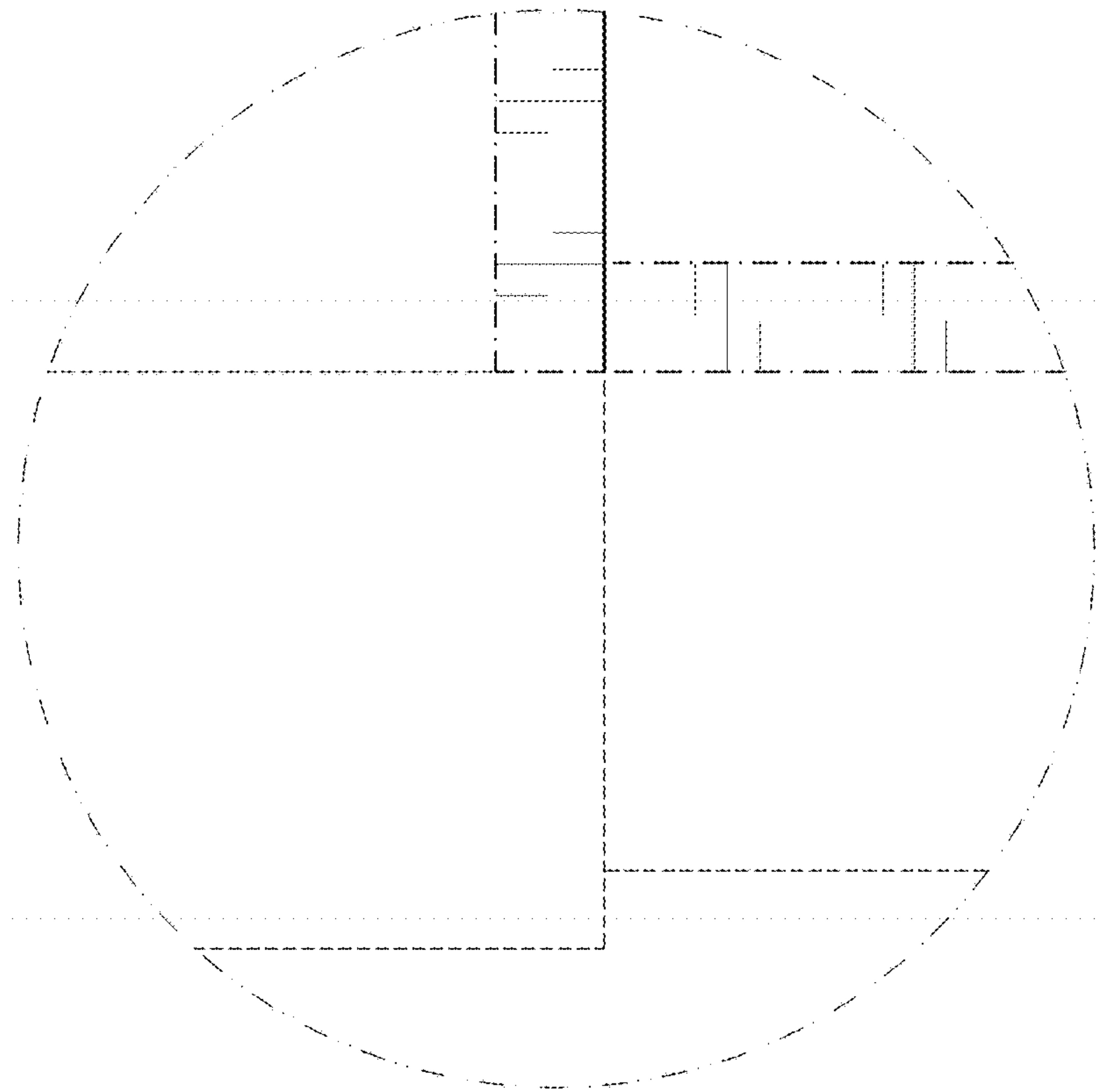

FIG. 10

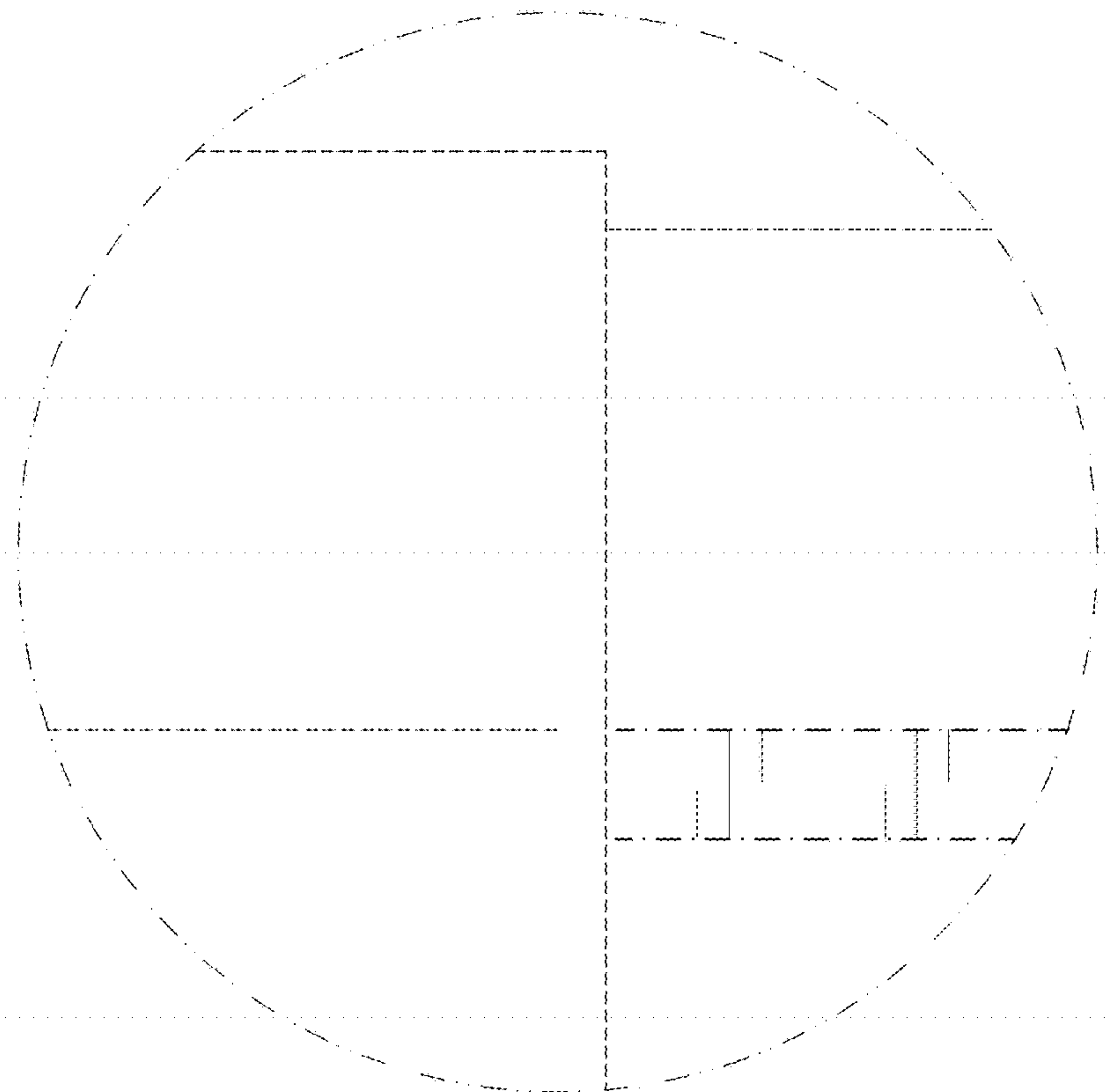

FIG. 11

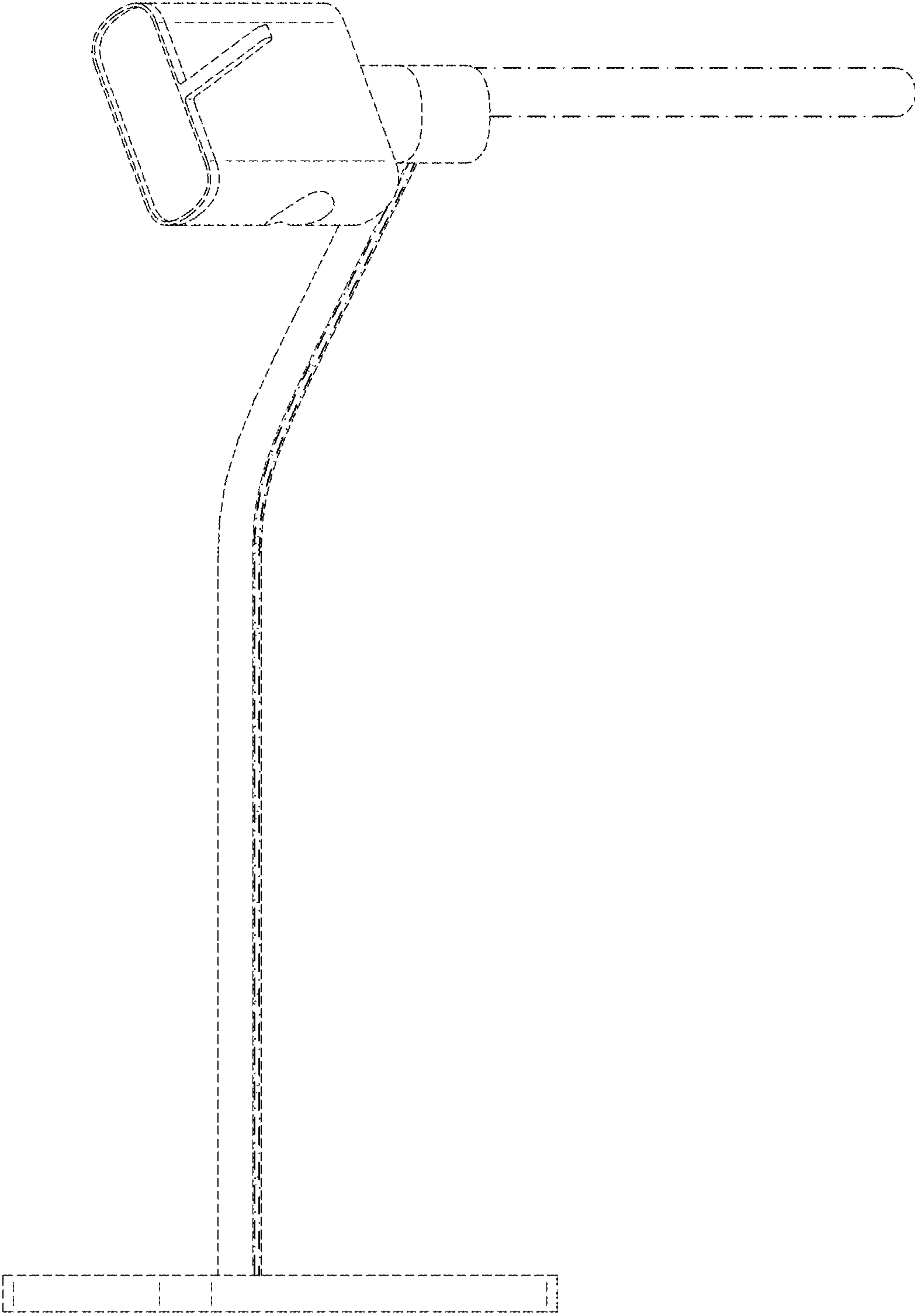

FIG. 12

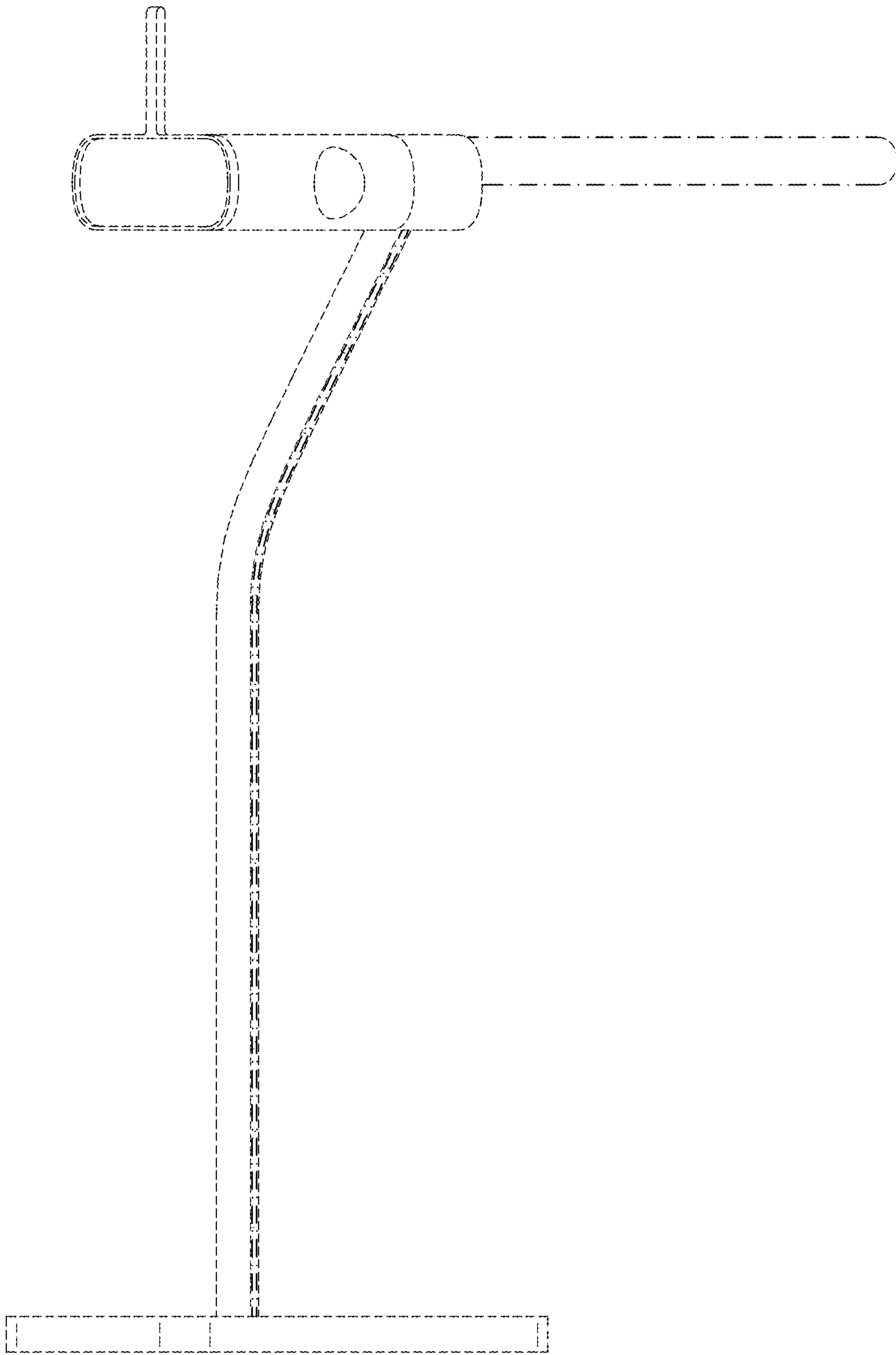

FIG. 13

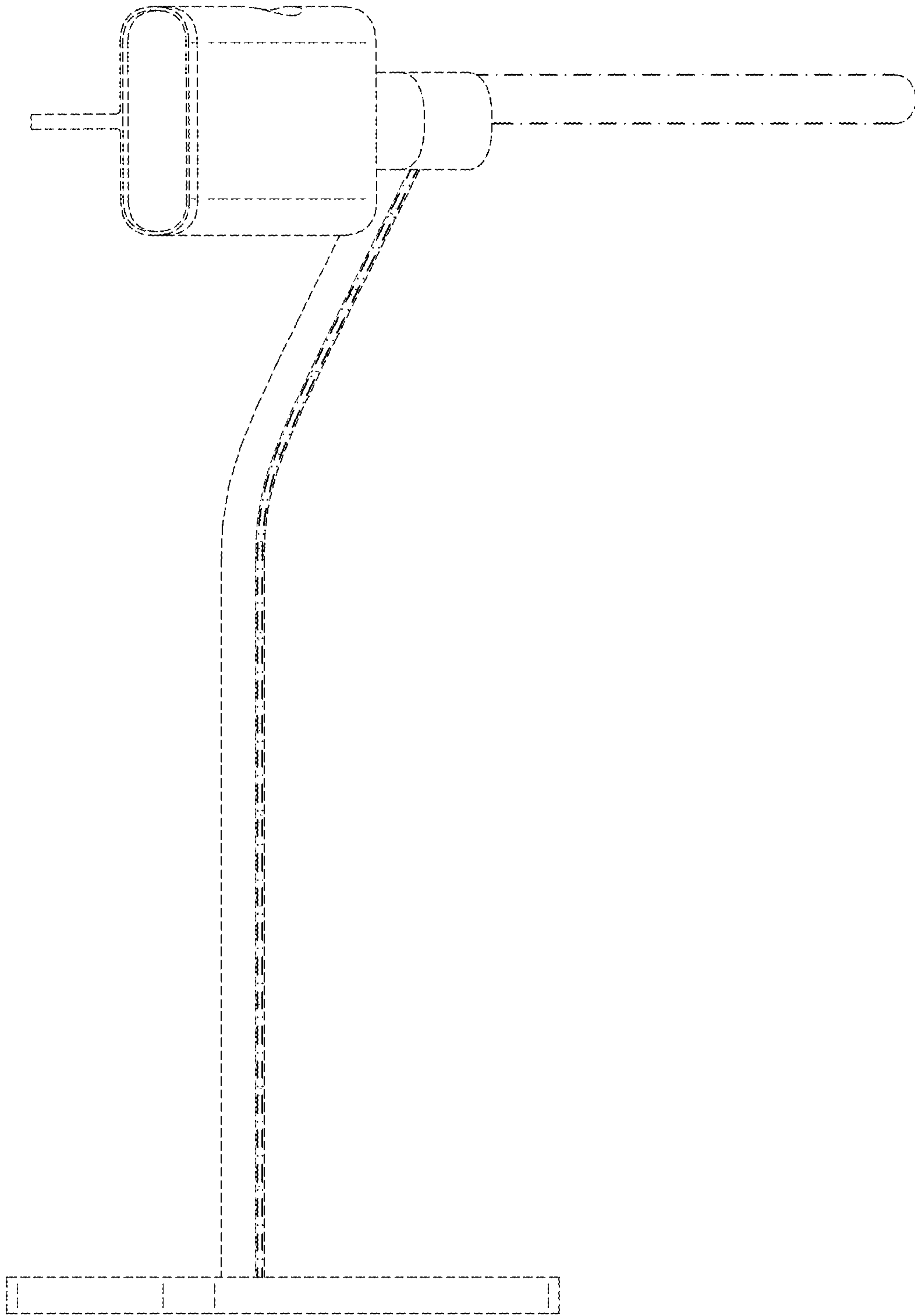

FIG. 14