



US00D890212S

(12) **United States Design Patent**
Green

(10) **Patent No.:** **US D890,212 S**

(45) **Date of Patent:** **** Jul. 14, 2020**

(54) **VACUUM PUMP SOCKET COVER PLATE**

(71) Applicant: **USP Motorsports Inc**, Pompano Beach,
FL (US)

(72) Inventor: **Christopher Green**, Pompano Beach,
FL (US)

(73) Assignee: **USP Motorsports Inc**, Pompano Beach,
FL (US)

(**) Term: **15 Years**

(21) Appl. No.: **29/668,963**

(22) Filed: **Nov. 3, 2018**

(51) **LOC (12) Cl.** **15-02**

(52) **U.S. Cl.**
USPC **D15/7**

(58) **Field of Classification Search**
USPC D15/7-9; D23/231, 232, 225
CPC F02M 37/04; F02M 37/14
See application file for complete search history.

(56) **References Cited**

U.S. PATENT DOCUMENTS

| | | | | |
|--------------|---------|-------------|-------|---------|
| D229,866 S * | 1/1974 | Marr | | D15/7 |
| D243,714 S * | 3/1977 | Younger | | D15/5 |
| D367,023 S * | 2/1996 | Benson | | D12/126 |
| D375,961 S * | 11/1996 | Kotlarek | | D15/7 |
| D383,140 S * | 9/1997 | Middlebrook | | D15/5 |
| D461,828 S * | 8/2002 | Sodergard | | D15/7 |
| D461,829 S * | 8/2002 | Sodergard | | D15/7 |

| | | | | |
|----------------|---------|------------|-------|-------------------------|
| D464,977 S * | 10/2002 | Futterer | | D15/7 |
| 7,194,994 B1 * | 3/2007 | Chisenhall | | F02B 67/04 123/195 A |
| D600,720 S * | 9/2009 | Iwanicki | | D15/5 |
| D602,501 S * | 10/2009 | Ton | | D15/7 |
| D615,996 S * | 5/2010 | Orlowski | | D15/7 |
| D791,841 S * | 7/2017 | Obuchi | | D15/7 |
| 9,719,513 B2 * | 8/2017 | Geue | | F04C 29/0092 |
| D836,677 S * | 12/2018 | Alexander | | D15/7 |

* cited by examiner

Primary Examiner — Mitchell I. Siegel

(74) *Attorney, Agent, or Firm* — Pearson IP; Loren
Donald Pearson

(57) **CLAIM**

The ornamental design for a vacuum pump socket cover plate, as shown and described.

DESCRIPTION

FIG. 1 is a front, bottom, right perspective view of the vacuum pump socket cover plate.
FIG. 2 is a rear, top left perspective view thereof.
FIG. 3 is a front elevational view thereof.
FIG. 4 is a rear elevational view thereof.
FIG. 5 is a right elevational view thereof.
FIG. 6 is a left elevational view thereof.
FIG. 7 is a bottom elevational view thereof; and,
FIG. 8 is a top elevational view thereof.
The broken lines shown in the drawing are included for the purpose of illustrating unclaimed subject matter and form no part of the claimed design.

1 Claim, 6 Drawing Sheets

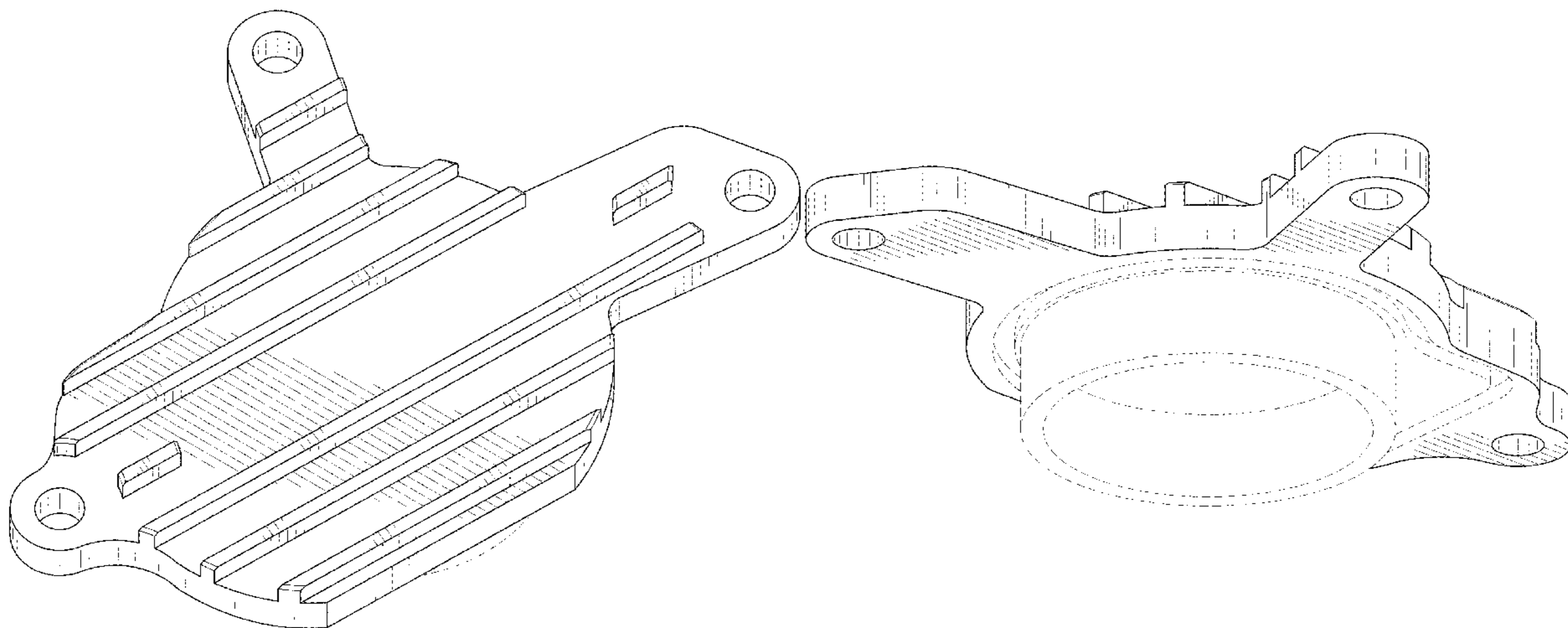

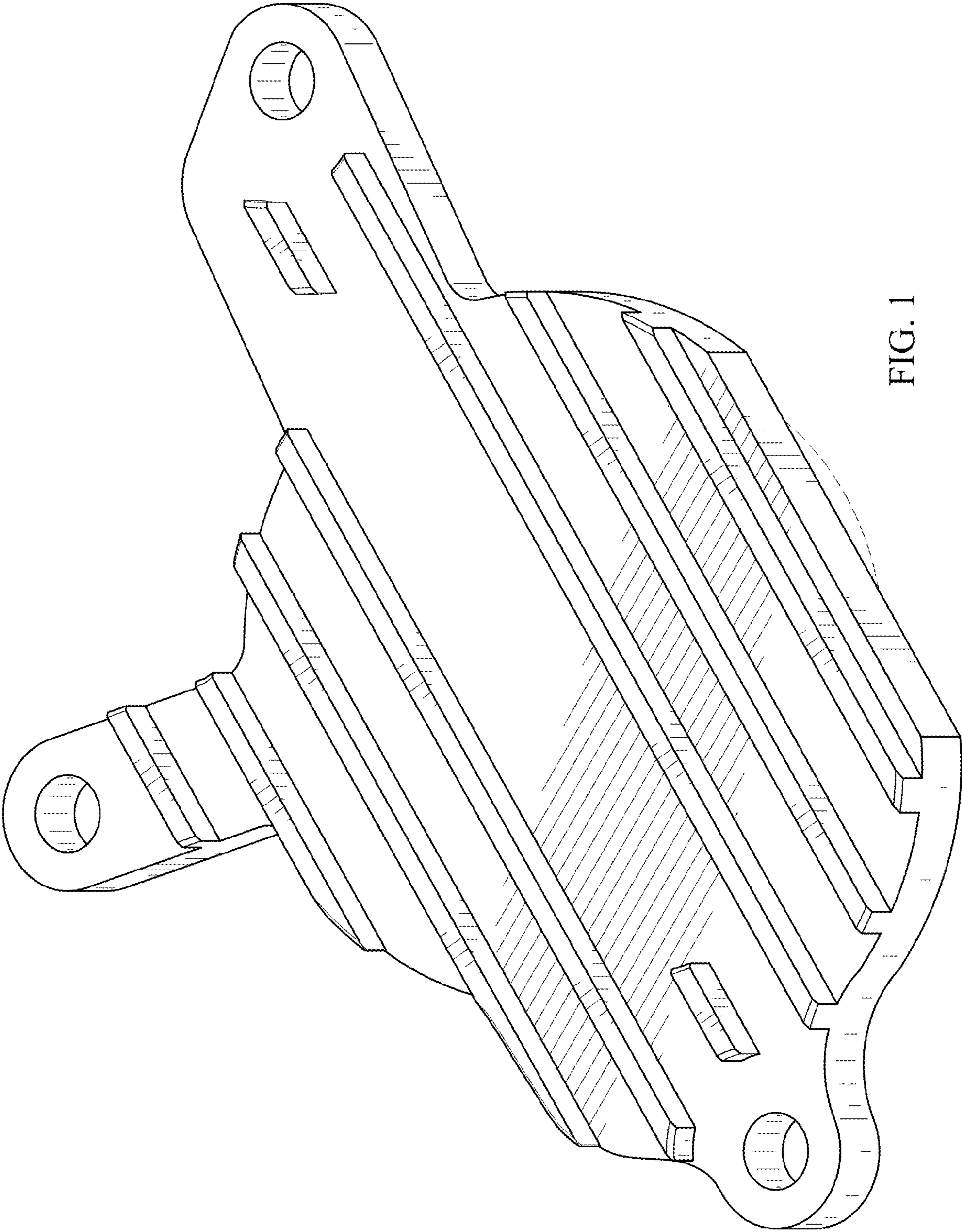

FIG. 1

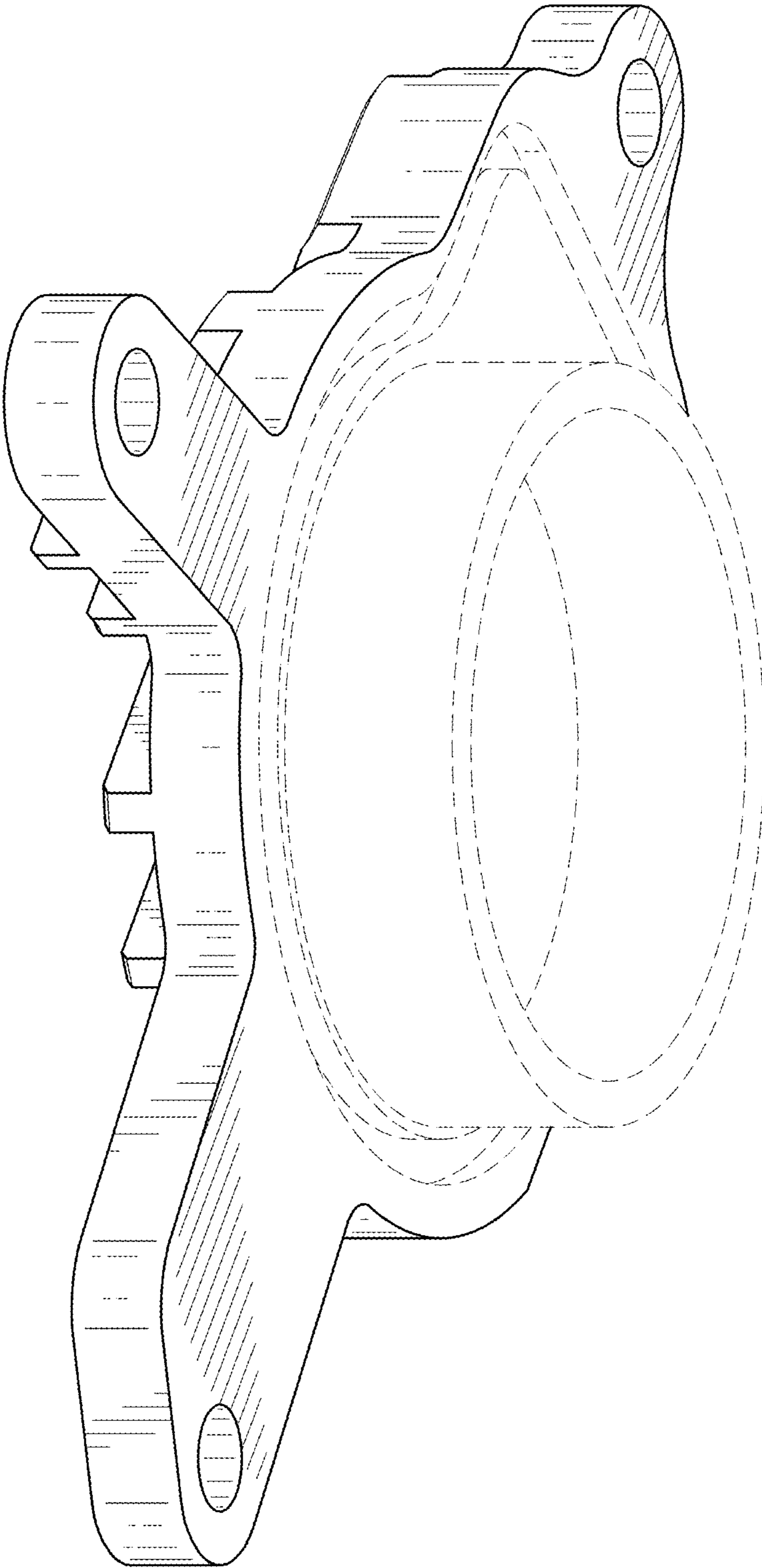

FIG. 2

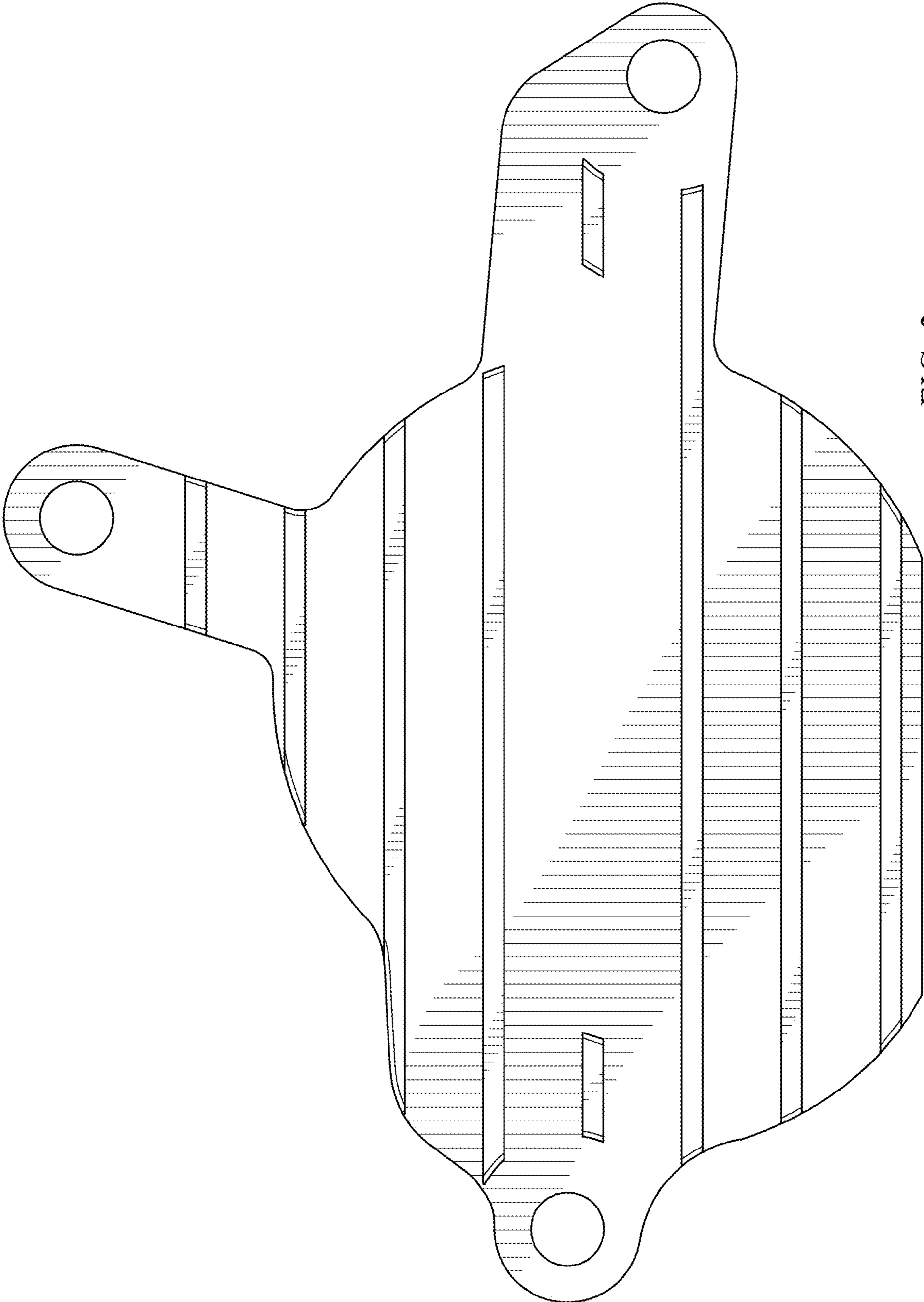

FIG. 3

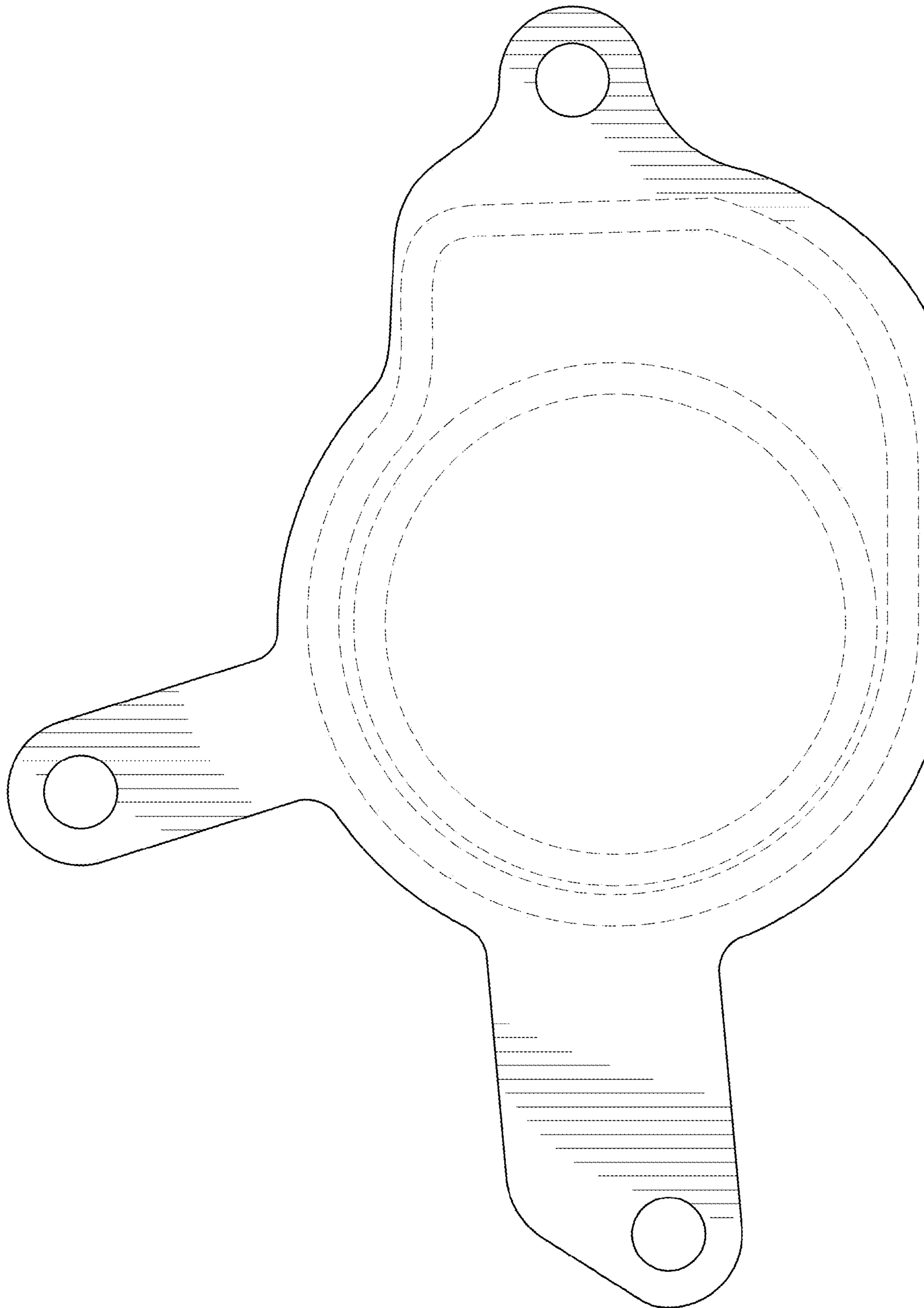

FIG. 4

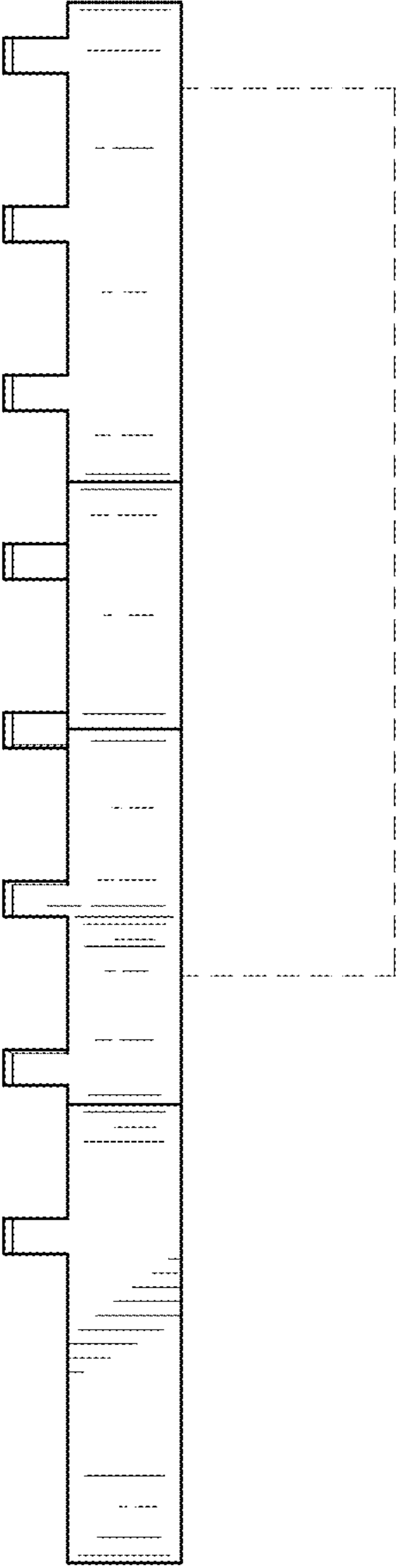

FIG. 5

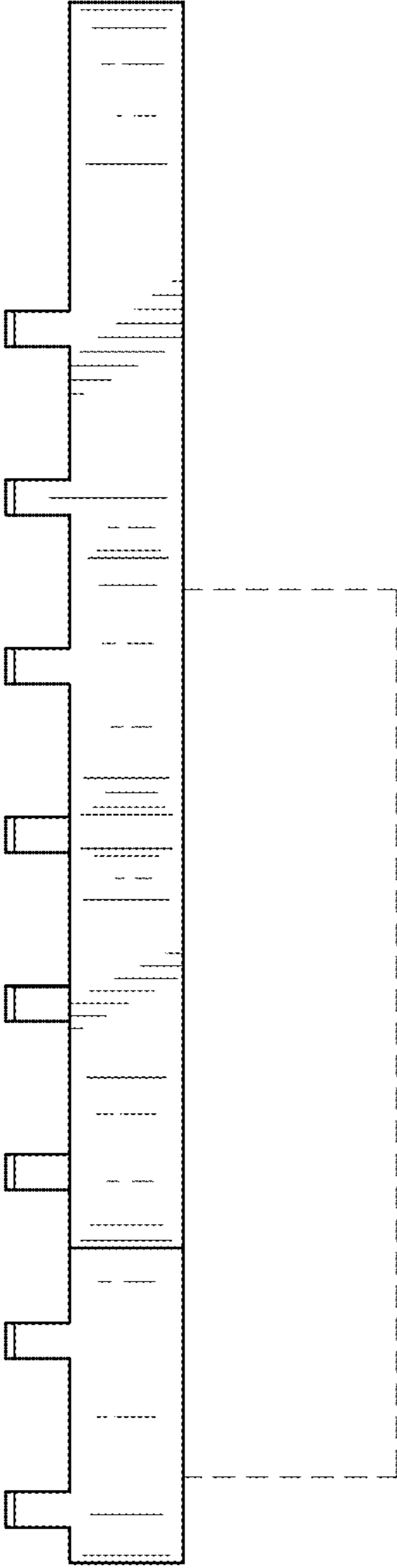

FIG. 6

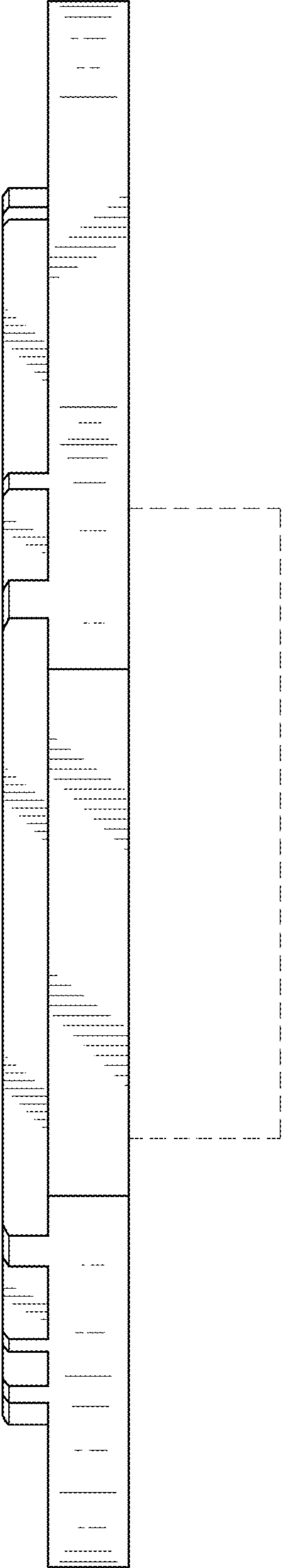

FIG. 7



FIG. 8