



US00D889007S

(12) **United States Design Patent** (10) **Patent No.:** **US D889,007 S**  
**Lim et al.** (45) **Date of Patent:** **\*\* Jun. 30, 2020**

(54) **REAR COMBINATION LAMP FOR AN AUTOMOBILE**

(71) Applicant: **Kia Motors Corporation**, Seoul (KR)

(72) Inventors: **Dae Hwan Lim**, Ansan-si (KR); **Byung Ho Kong**, Hwaseong-si (KR)

(73) Assignees: **Hyundai Motor Company**, Seoul (KR); **Kia Motors Corporation**, Seoul (KR)

(\*\*) Term: **15 Years**

(21) Appl. No.: **35/506,904**

(22) Filed: **Dec. 7, 2018**

(80) **Hague Agreement Data**

Int. Filing Date: **Dec. 7, 2018**  
Int. Reg. No.: **DM/200316**  
Int. Reg. Date: **Dec. 7, 2018**  
Int. Reg. Pub. Date: **Jun. 14, 2019**

(51) **LOC (12) Cl.** ..... **26-06**

(52) **U.S. Cl.**  
USPC ..... **D26/28**

(58) **Field of Classification Search**  
USPC ..... D26/28  
CPC ..... F21S 48/00; F21S 48/10; F21S 48/115;  
F21S 48/225; F21S 48/1233; F21S  
48/1266; F21S 48/1388; F21S 48/2266;  
F21V 21/04; B60Q 1/30; B60Q 1/2607;  
B60Q 1/2696; B62J 6/00; B62J 6/04  
See application file for complete search history.

(56) **References Cited**

U.S. PATENT DOCUMENTS

D412,214 S \* 7/1999 Hejtmanek ..... D26/28  
D755,420 S \* 5/2016 Ko ..... D26/28  
D774,221 S \* 12/2016 Lim ..... D26/28  
D776,313 S \* 1/2017 Han ..... D26/28

D857,955 S \* 8/2019 Han ..... D26/28  
D857,956 S \* 8/2019 Han ..... D26/28  
D866,026 S \* 11/2019 Hannemann ..... D26/28  
D868,320 S \* 11/2019 Kong ..... D26/28  
D868,321 S \* 11/2019 Kong ..... D26/28  
D869,717 S \* 12/2019 Shim ..... D26/36  
D871,632 S \* 12/2019 Kim ..... D26/28  
D873,457 S \* 1/2020 Han ..... D26/28  
D874,032 S \* 1/2020 Lin ..... D26/28  
D874,042 S \* 1/2020 Lee ..... D26/28  
D876,685 S \* 2/2020 Lin ..... D26/28

\* cited by examiner

*Primary Examiner* — Natasha Vujcic

(74) *Attorney, Agent, or Firm* — Mintz Levin Cohn Ferris  
Glovsky and Popeo, P.C.; Peter F. Corless; Carolina E.  
Säve

(57) **CLAIM**

The ornamental design for a rear combination lamp for an automobile, as shown and described.

**DESCRIPTION**

1. Rear combination lamp for an automobile
- 1.1 is a front view.
- 1.2 is a front perspective view.
- 1.3 is a rear view.
- 1.4 is a top view.
- 1.5 is a bottom view.
- 1.6 is a right side view.
- 1.7 is a left side view.

**1 Claim, 7 Drawing Sheets**

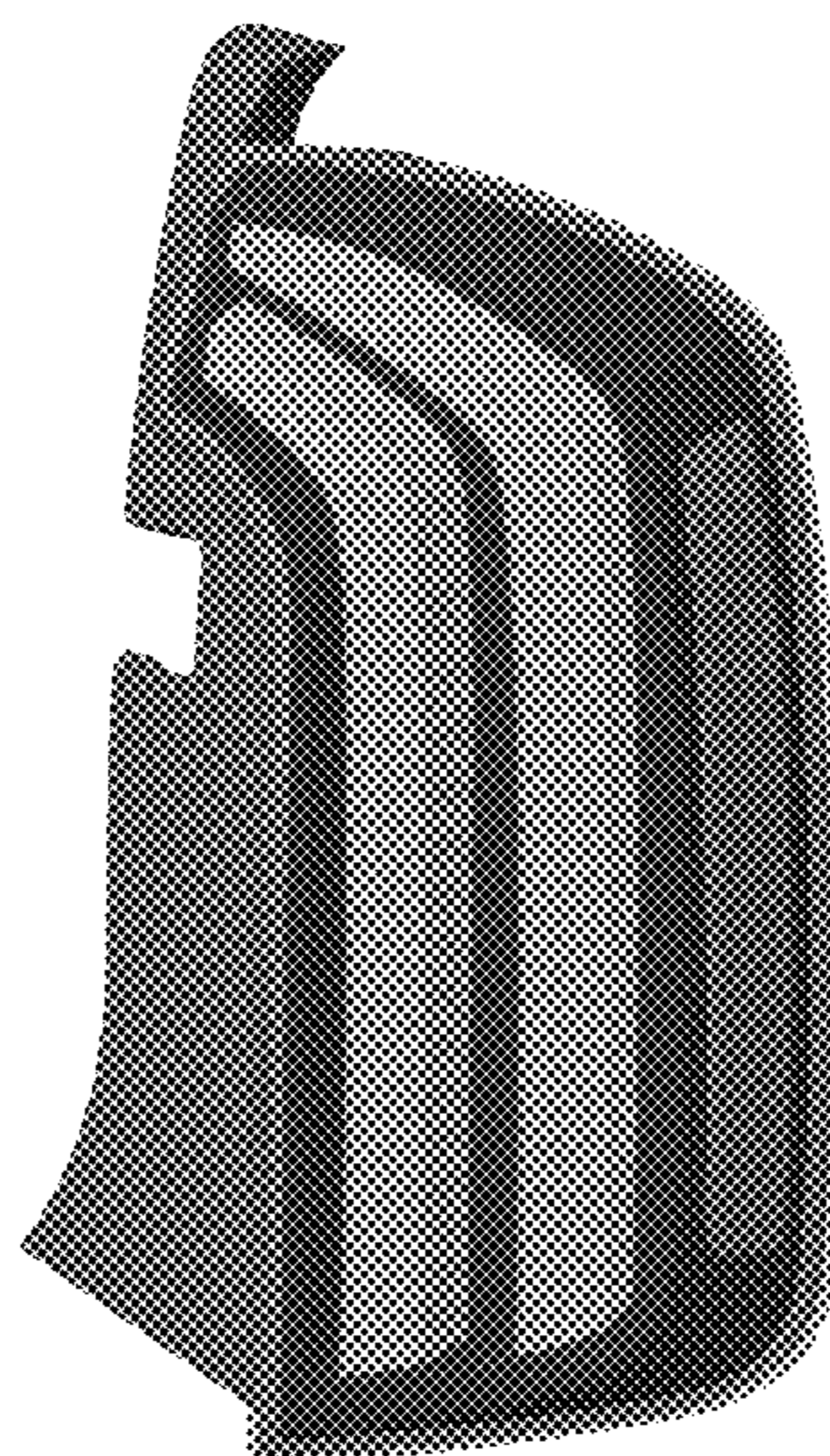

1.1

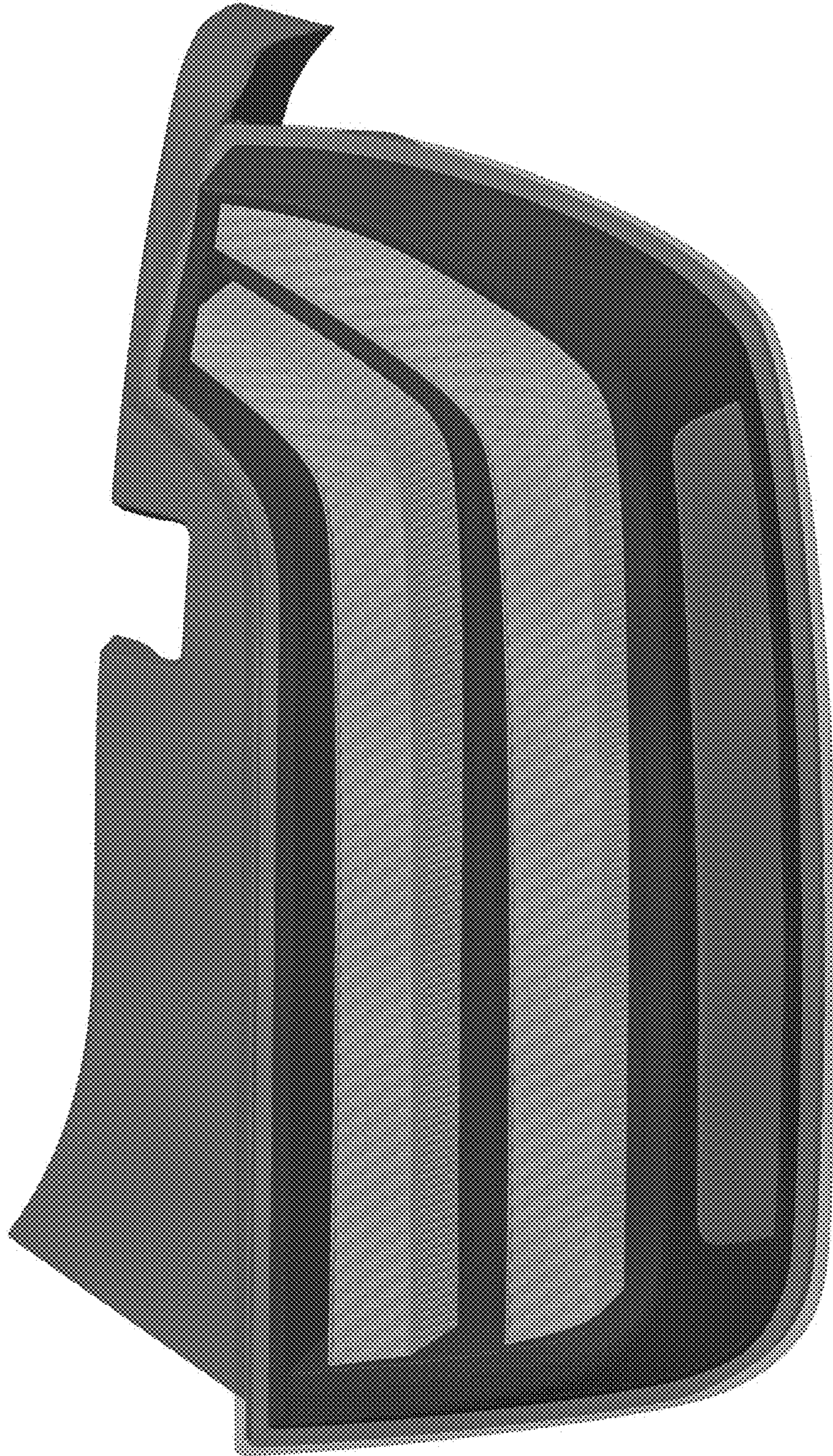

1.2

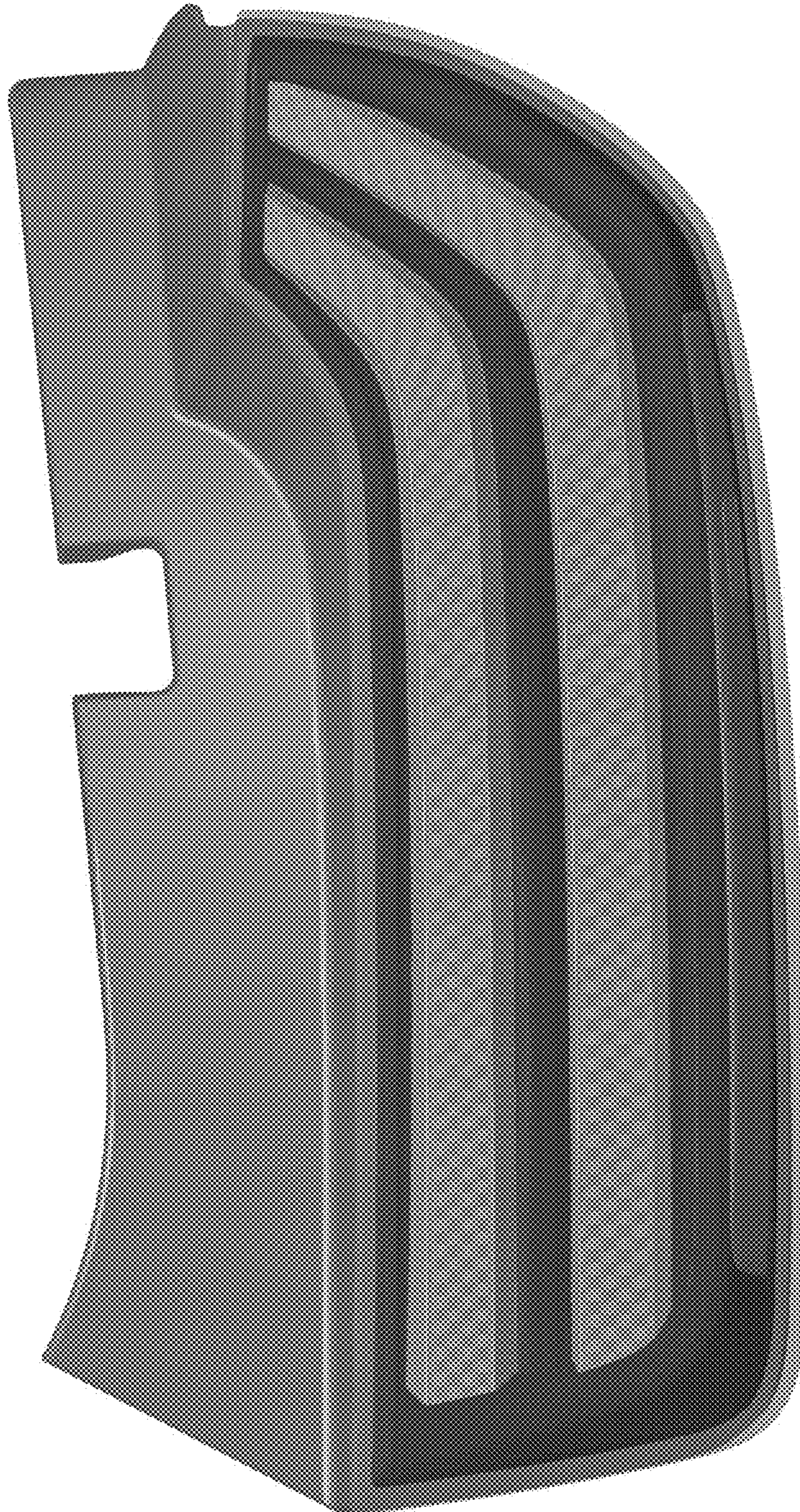

1.3

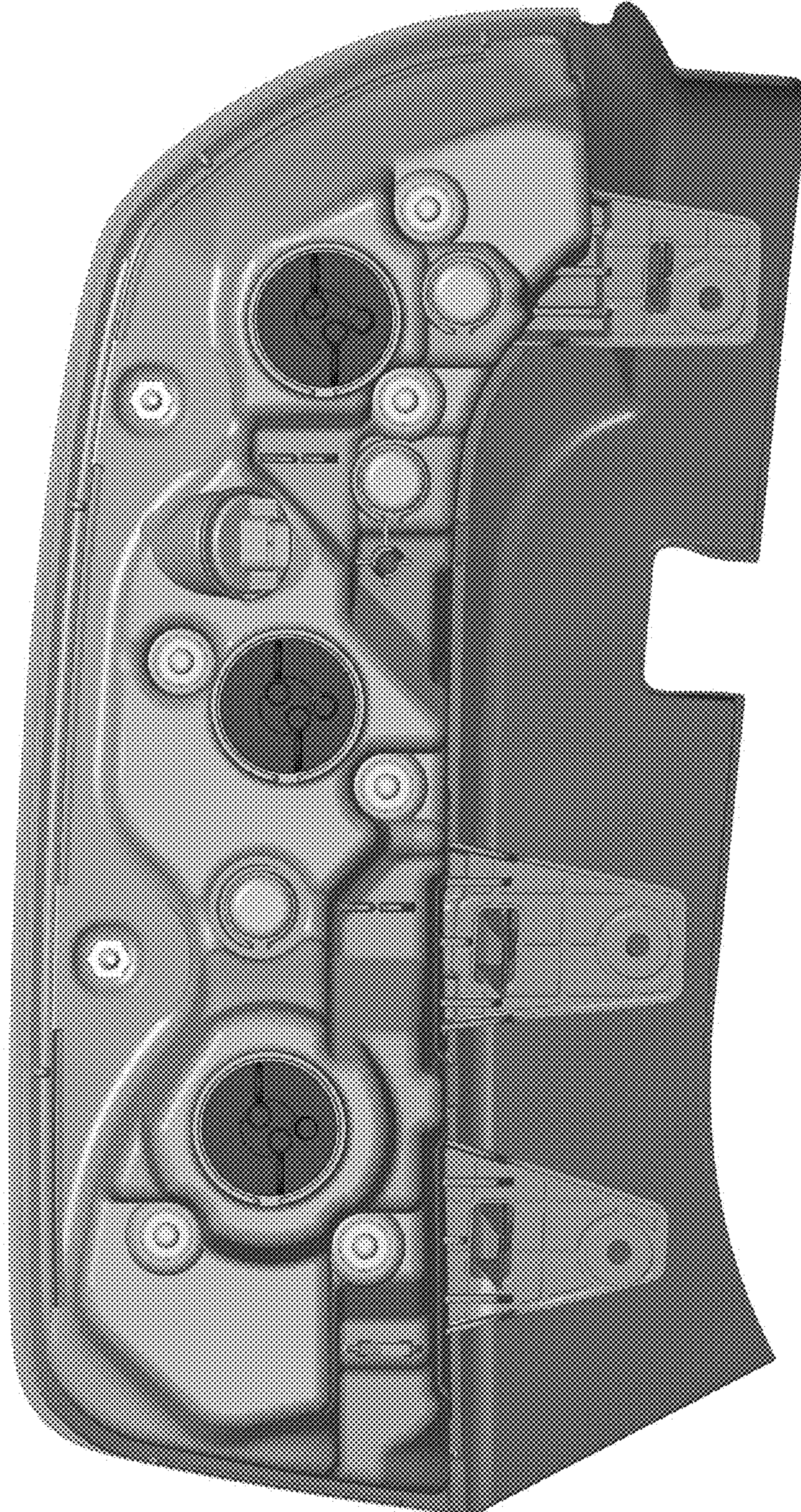

1.4

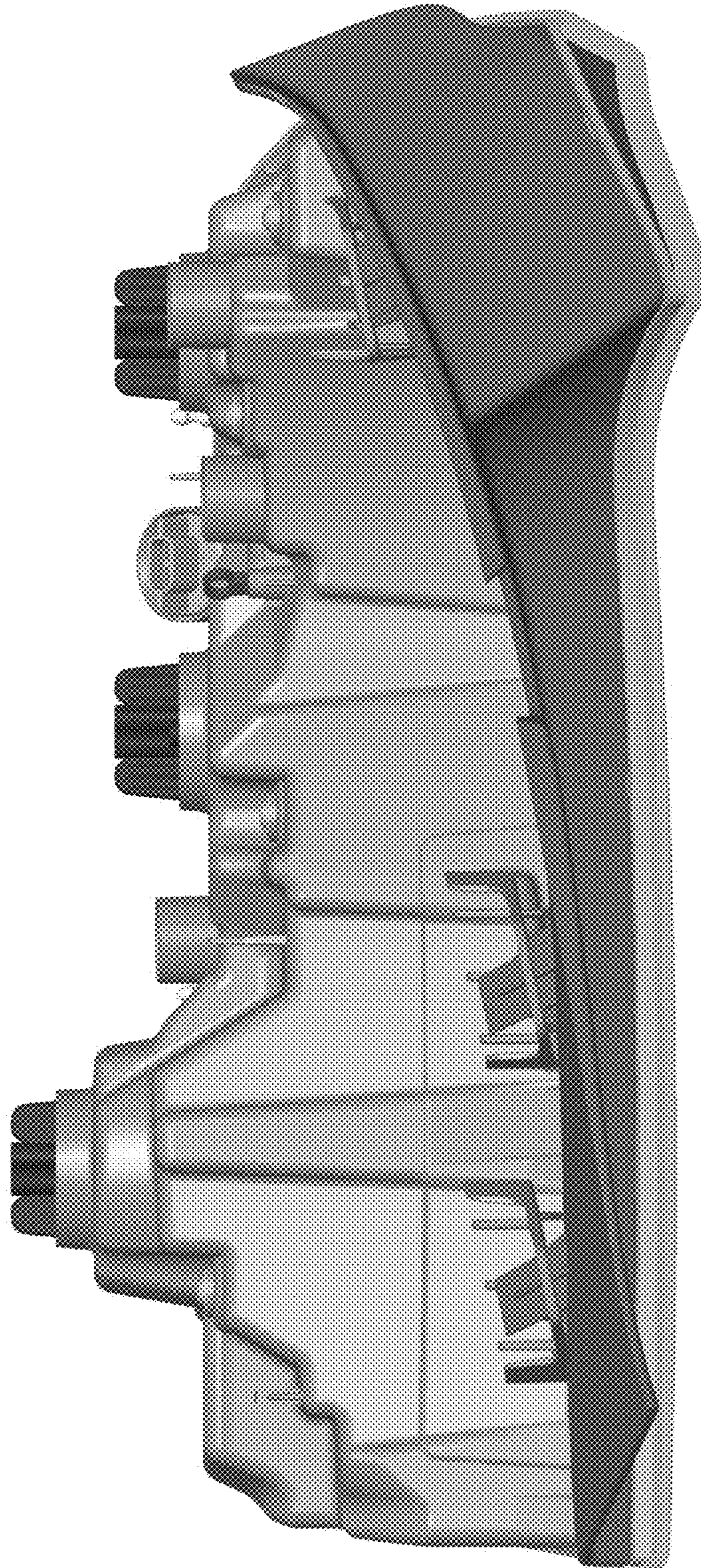

1.5

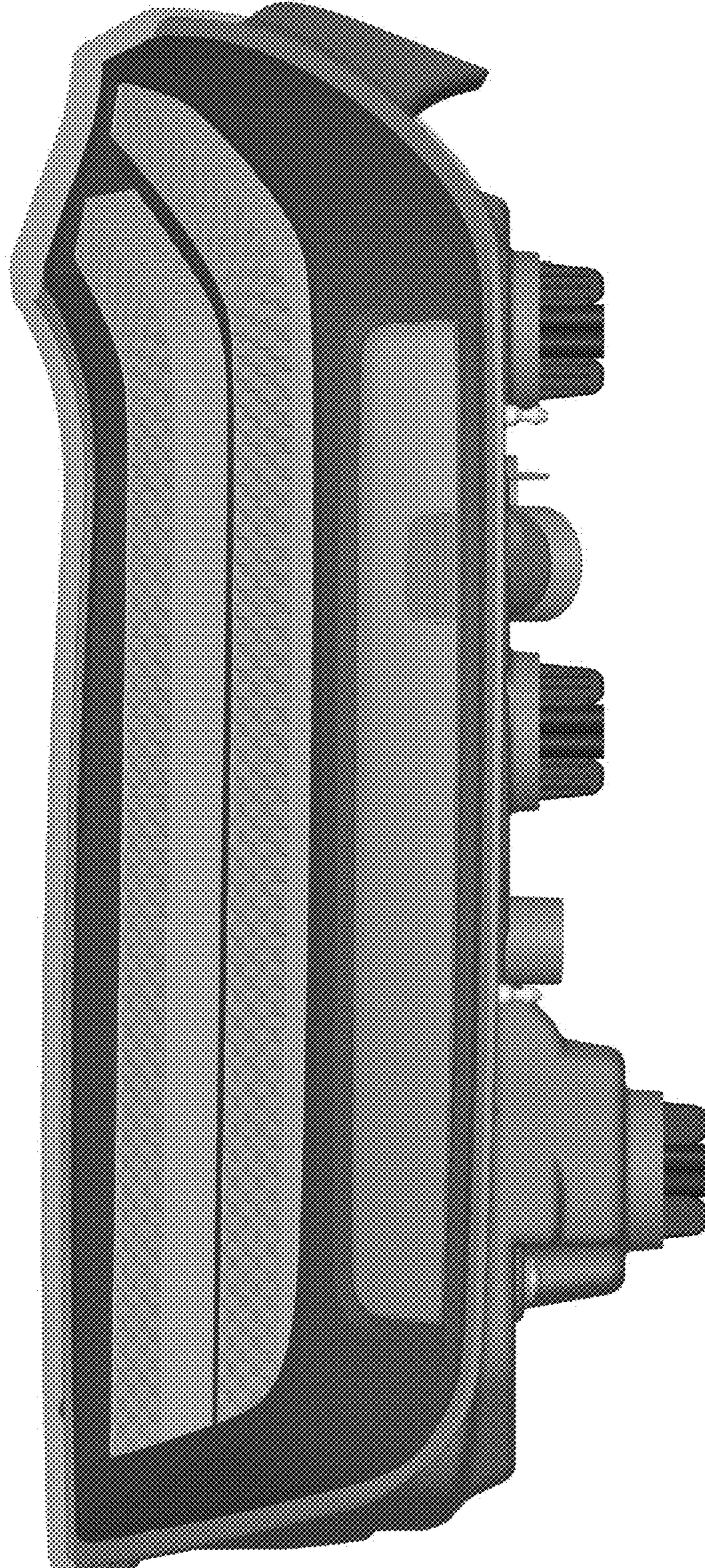

1.6

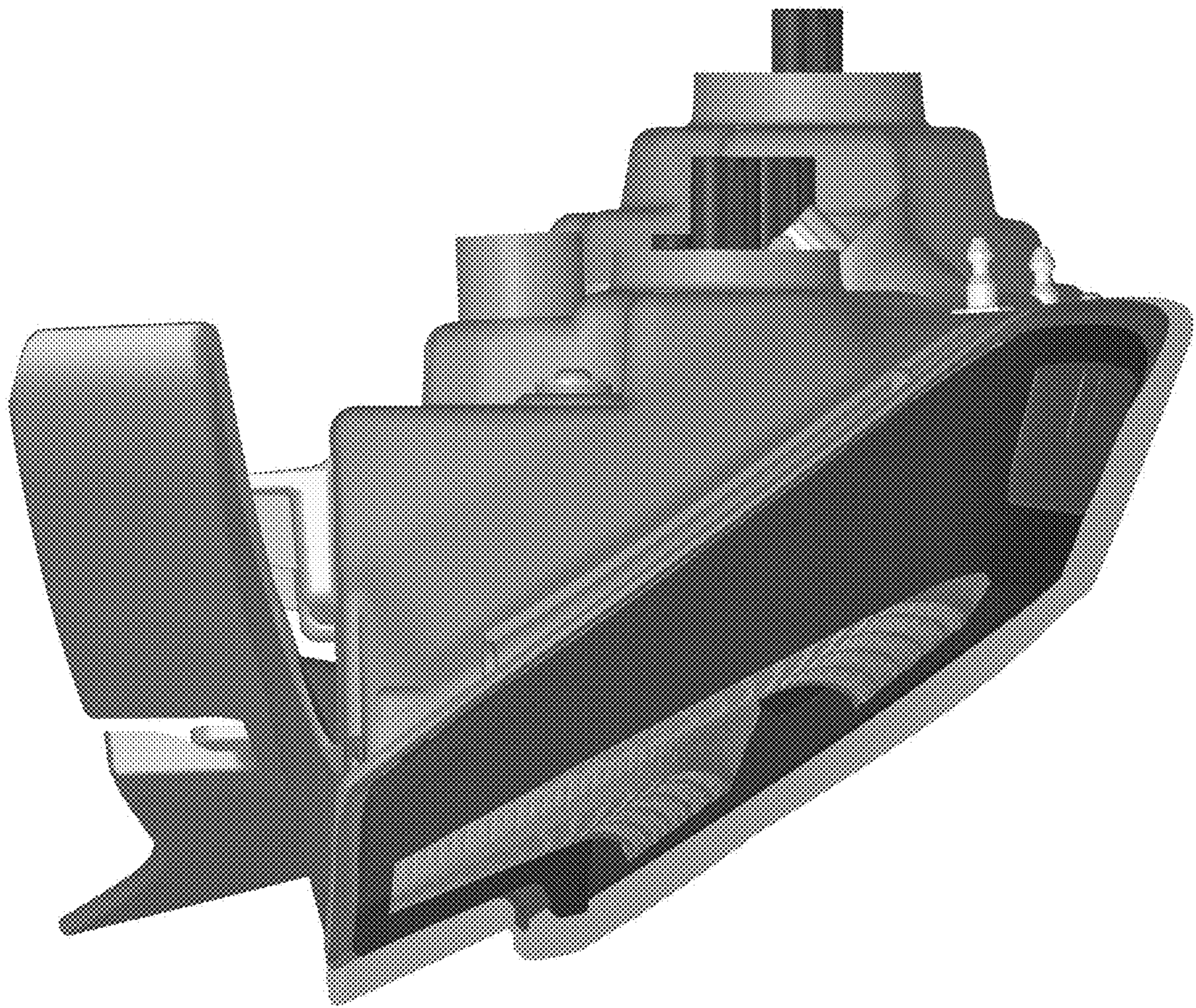

1.7

