



US00D888065S

(12) **United States Design Patent**
Ahn

(10) **Patent No.:** **US D888,065 S**
(45) **Date of Patent:** **** Jun. 23, 2020**

- (54) **MOUNT ACCESSORY FOR ELECTRONIC DEVICE**
- (71) Applicant: **SPIGEN KOREA CO., LTD.**, Seoul (KR)
- (72) Inventor: **Deok Hyun Ahn**, Seoul (KR)
- (73) Assignee: **Spigen Korea CO., LTD.**, Seoul (KR)
- (**) Term: **15 Years**
- (21) Appl. No.: **29/685,768**
- (22) Filed: **Mar. 29, 2019**
- (51) **LOC (12) Cl.** **08-07**
- (52) **U.S. Cl.**
USPC **D14/447**
- (58) **Field of Classification Search**
USPC D14/447, 432, 434, 439, 440, 451, 452, D14/457, 239, 253, 345; D8/363, 373, D8/380; D6/406.3, 406.4, 406.5, 406.6; D12/415; D13/108
CPC A47B 21/04; A47B 2097/006; A47B 2097/005; A47B 2023/049; A45C 2011/002; A45C 2011/003; F16M 2200/00; F16M 13/00
See application file for complete search history.

- D592,188 S 5/2009 Huang
- D664,952 S 8/2012 Richter
- D685,687 S 7/2013 Richter
- D690,707 S 10/2013 Minn et al.
- 8,708,151 B2 4/2014 Whitten et al.
- D704,199 S 5/2014 Byun
- D706,785 S * 6/2014 Brittain D14/447
- D709,066 S 7/2014 Byun
- D709,074 S 7/2014 Tsui et al.
- D713,398 S 9/2014 Alesi et al.
- D713,837 S 9/2014 Chul Kim
- 8,830,663 B2 9/2014 Child et al.
- D715,790 S 10/2014 Conomos et al.
- D717,307 S * 11/2014 Chun D14/447

(Continued)

Primary Examiner — Angela J Lee
(74) *Attorney, Agent, or Firm* — Heedong Chae; Lucem, PC

(57) **CLAIM**

The ornamental design for a mount accessory for electronic device, as shown and described.

DESCRIPTION

FIG. 1 is a front perspective view of a mount accessory for electronic device showing my new design; FIG. 2 is a rear perspective view thereof; FIG. 3 is a front elevational view thereof; FIG. 4 is a rear elevational view thereof; FIG. 5 is a left side elevational view thereof; FIG. 6 is a right side elevational view thereof; FIG. 7 is a top plan view thereof; FIG. 8 is a bottom plan view thereof; FIG. 9 is another perspective view thereof shown in an environment of use; and, FIG. 10 is another perspective view thereof, but shown in an alternate in-use position with environment. The broken lines depict environmental subject matter and portions of the mount accessory for electronic device that form no part of the claimed design.

1 Claim, 10 Drawing Sheets

- (56) **References Cited**
U.S. PATENT DOCUMENTS
- D337,333 S 7/1993 Turk
- D361,768 S 8/1995 Chen
- D388,795 S 1/1998 Richter
- D391,265 S 2/1998 Richter
- D391,266 S 2/1998 Richter
- D404,038 S 1/1999 Fransson et al.
- D405,453 S 2/1999 Richter
- D406,591 S 3/1999 Richter
- D428,002 S 7/2000 Lindahl
- D432,530 S 10/2000 Lindahl

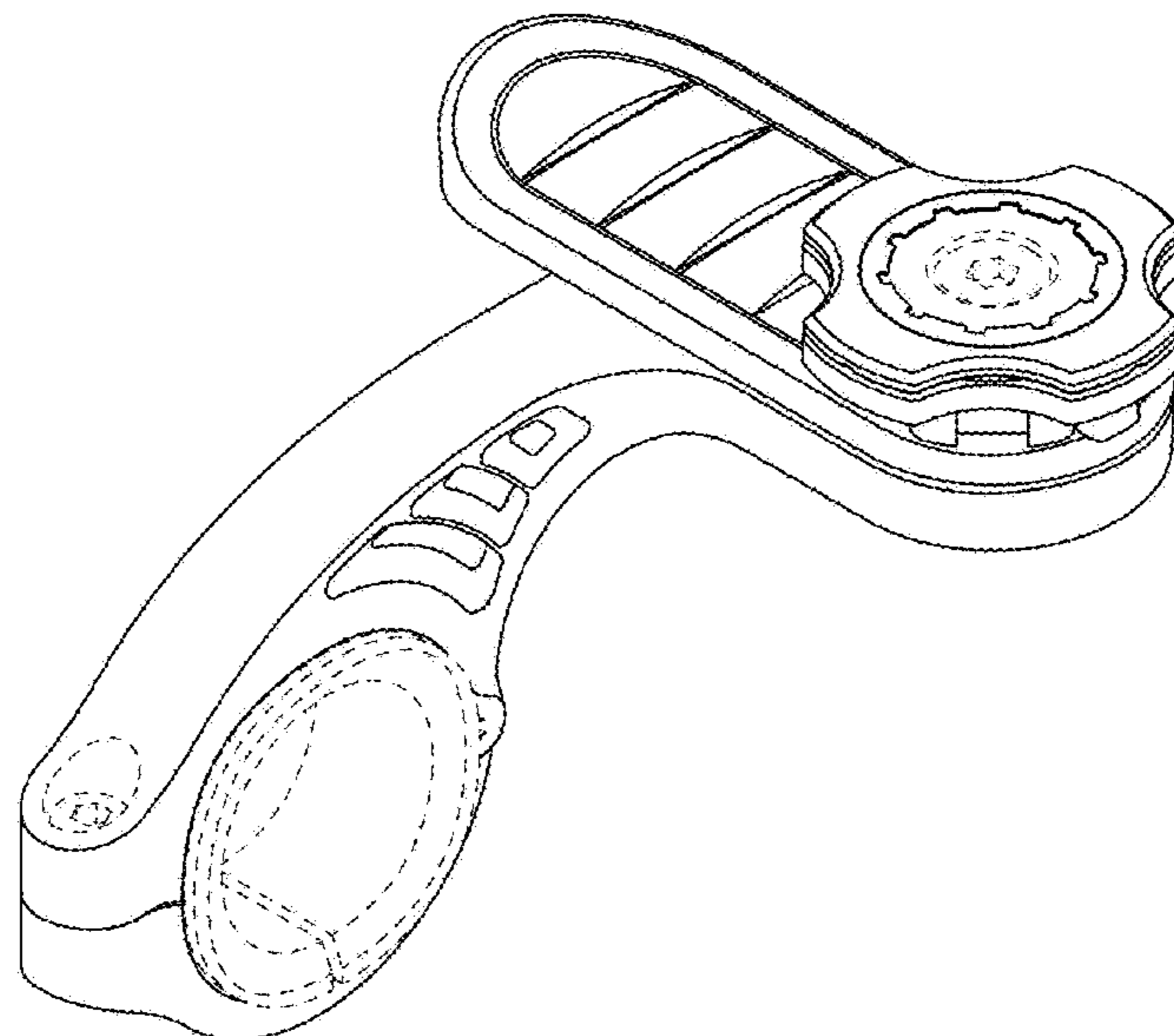

(56)

References Cited

U.S. PATENT DOCUMENTS

9,243,739	B2	1/2016	Peters	
D755,797	S *	5/2016	Liu	D14/452
D765,549	S *	9/2016	Khodapanah	D12/114
D772,739	S *	11/2016	Browning	D10/74
D773,325	S	12/2016	Browning et al.	
D780,743	S *	3/2017	Chun	D14/253
D783,013	S *	4/2017	Chun	D14/253
D783,014	S *	4/2017	Chun	D14/253
D783,593	S	4/2017	Chen	
D783,624	S	4/2017	Reaux	
D784,977	S	4/2017	Ormsbee et al.	
D790,527	S	6/2017	O'Neill et al.	
D806,714	S	1/2018	Nelson et al.	
D808,396	S	1/2018	Nelson et al.	
D808,430	S	1/2018	Wang	
D825,545	S	8/2018	McSweyn et al.	
D831,666	S	10/2018	Yao et al.	
D838,266	S *	1/2019	Ho	D14/253
D845,309	S *	4/2019	Goldstein	D14/447
D852,681	S	7/2019	Peters et al.	
D860,189	S *	9/2019	Gu	D14/253
D861,668	S *	10/2019	Ho	D14/253
2011/0255219	A1	10/2011	Ou	
2012/0050968	A1	3/2012	Child et al.	
2013/0318775	A1	12/2013	Peters	
2019/0094853	A1 *	3/2019	Overall	F16M 11/041

* cited by examiner

FIG. 1

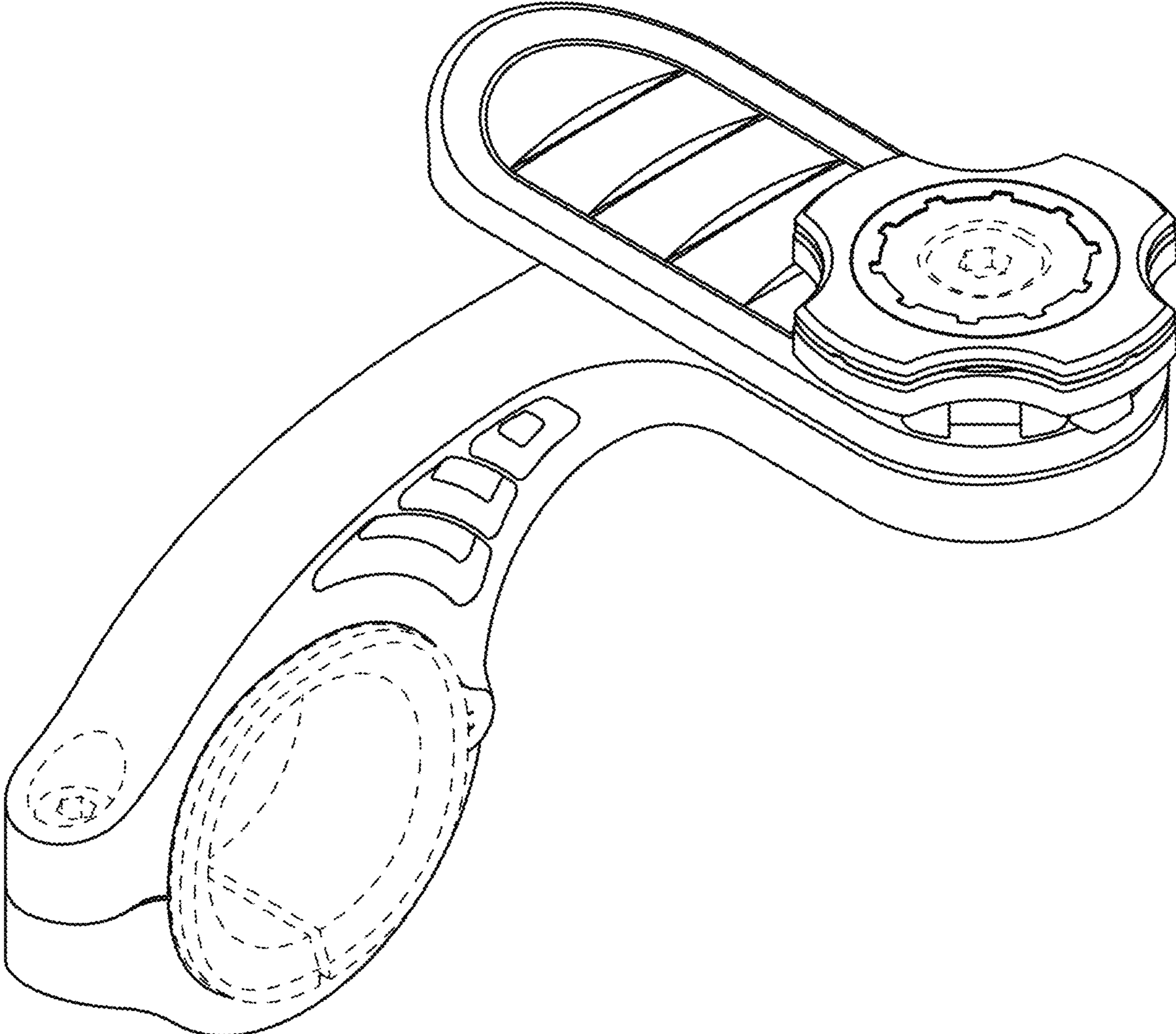

FIG. 2

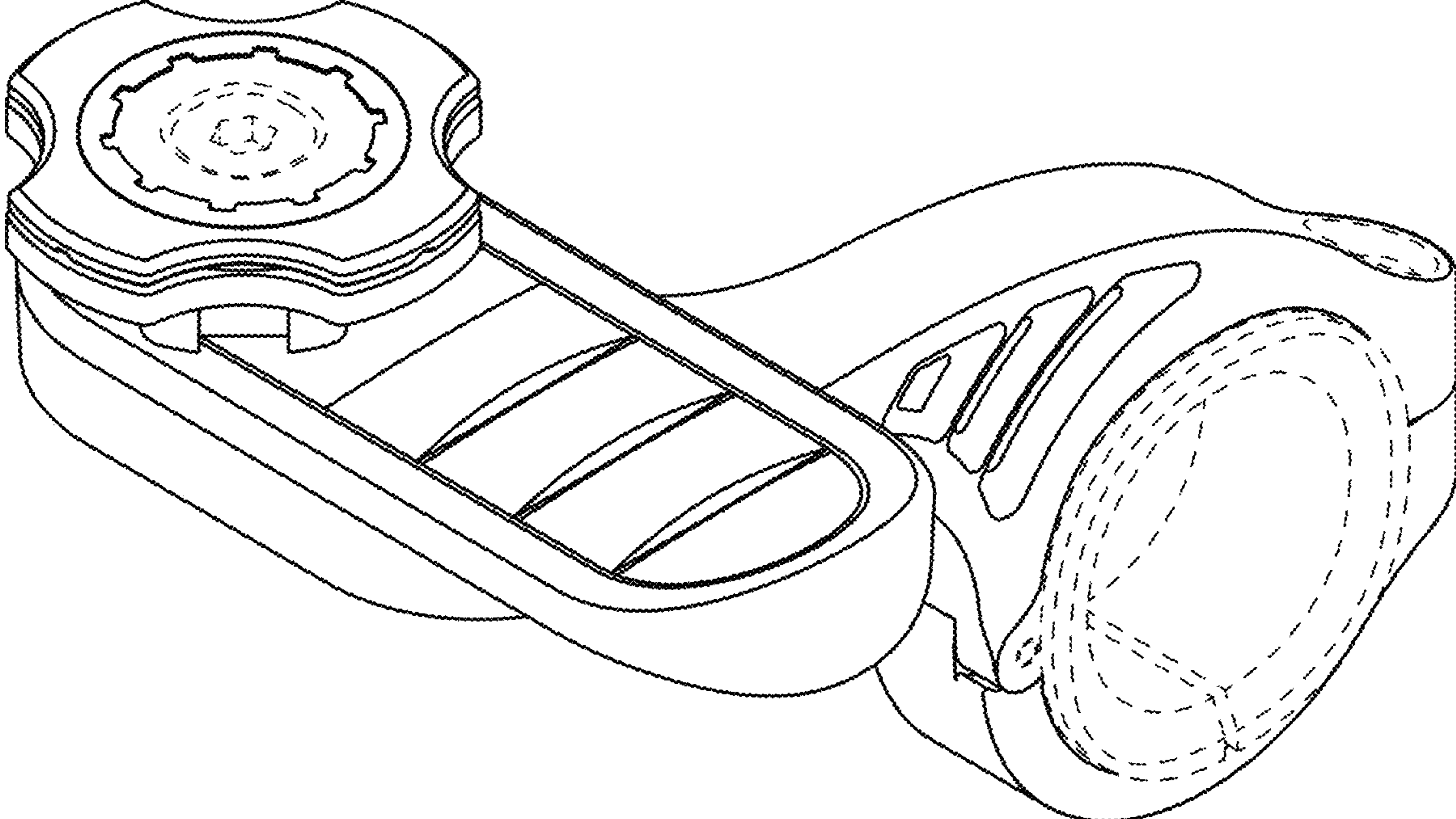

FIG. 3

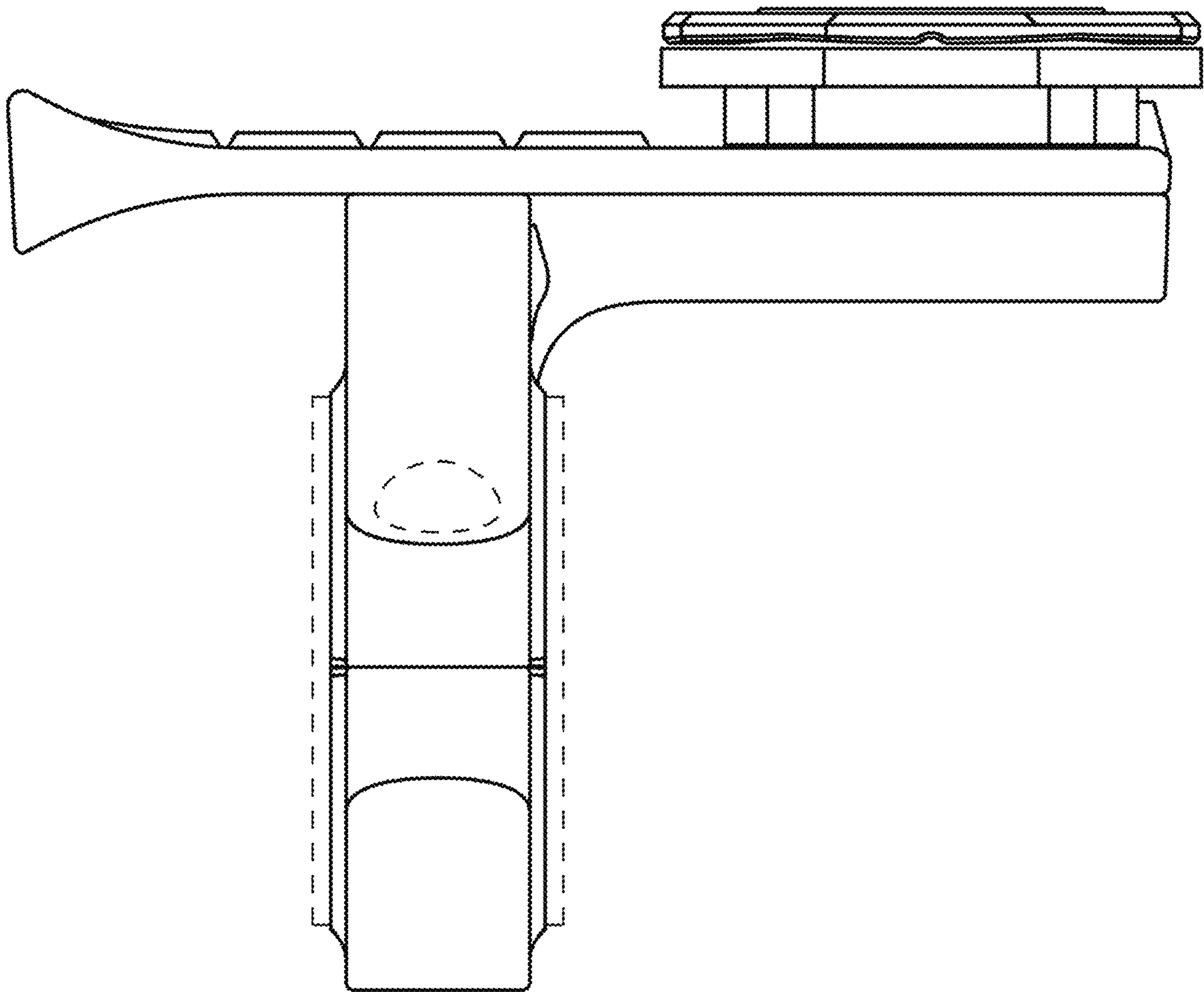

FIG. 4

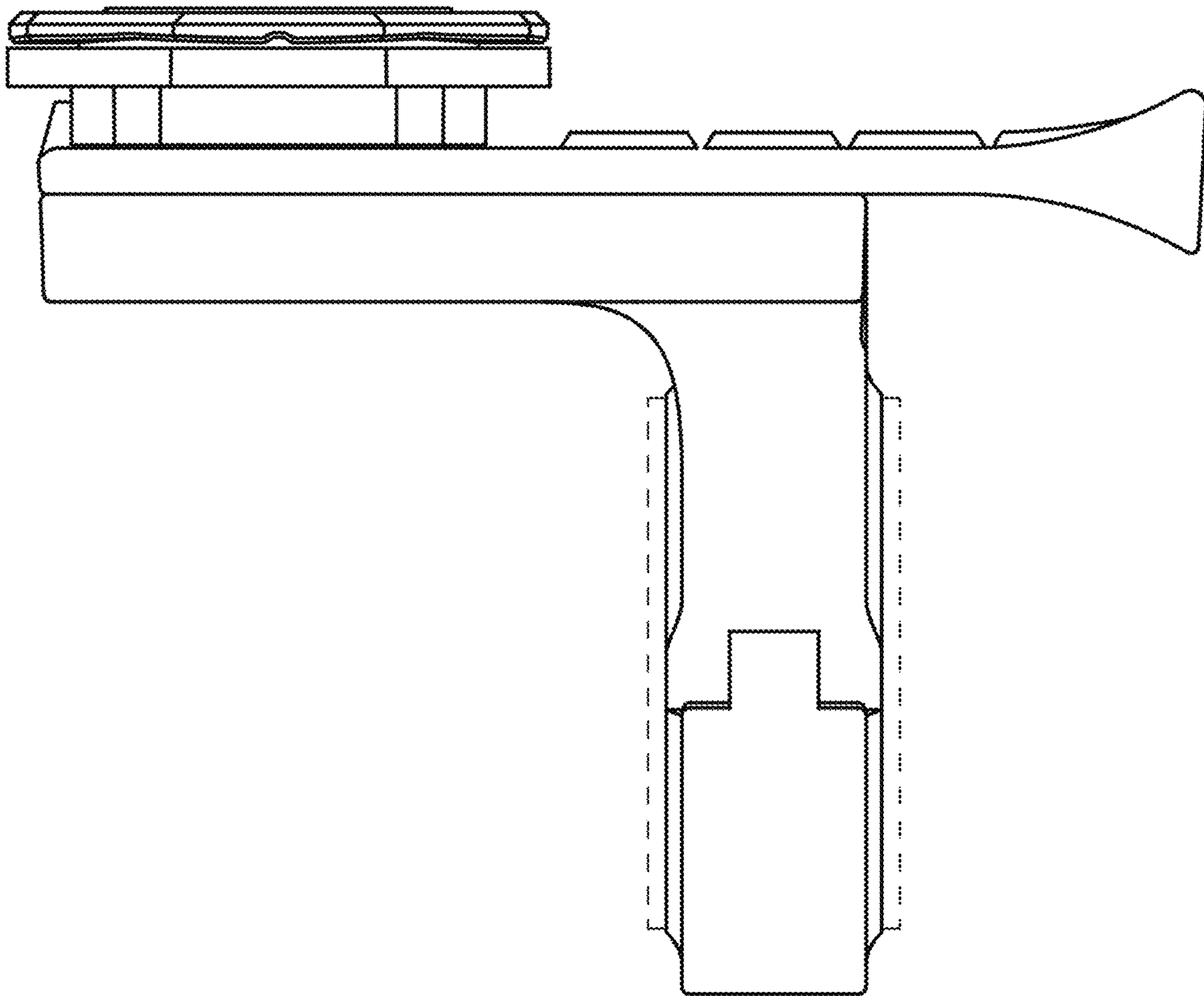

FIG. 5

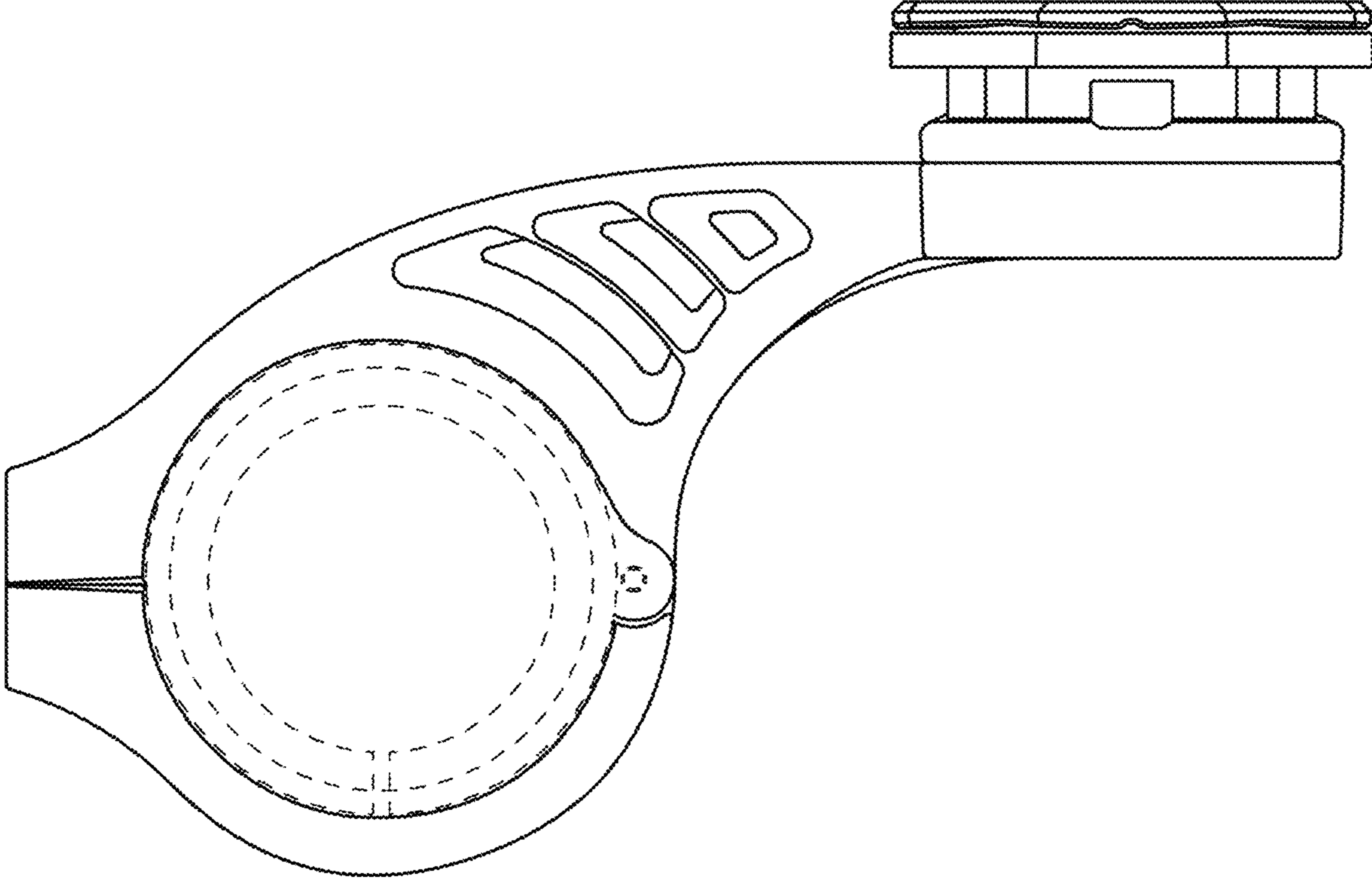

FIG. 6

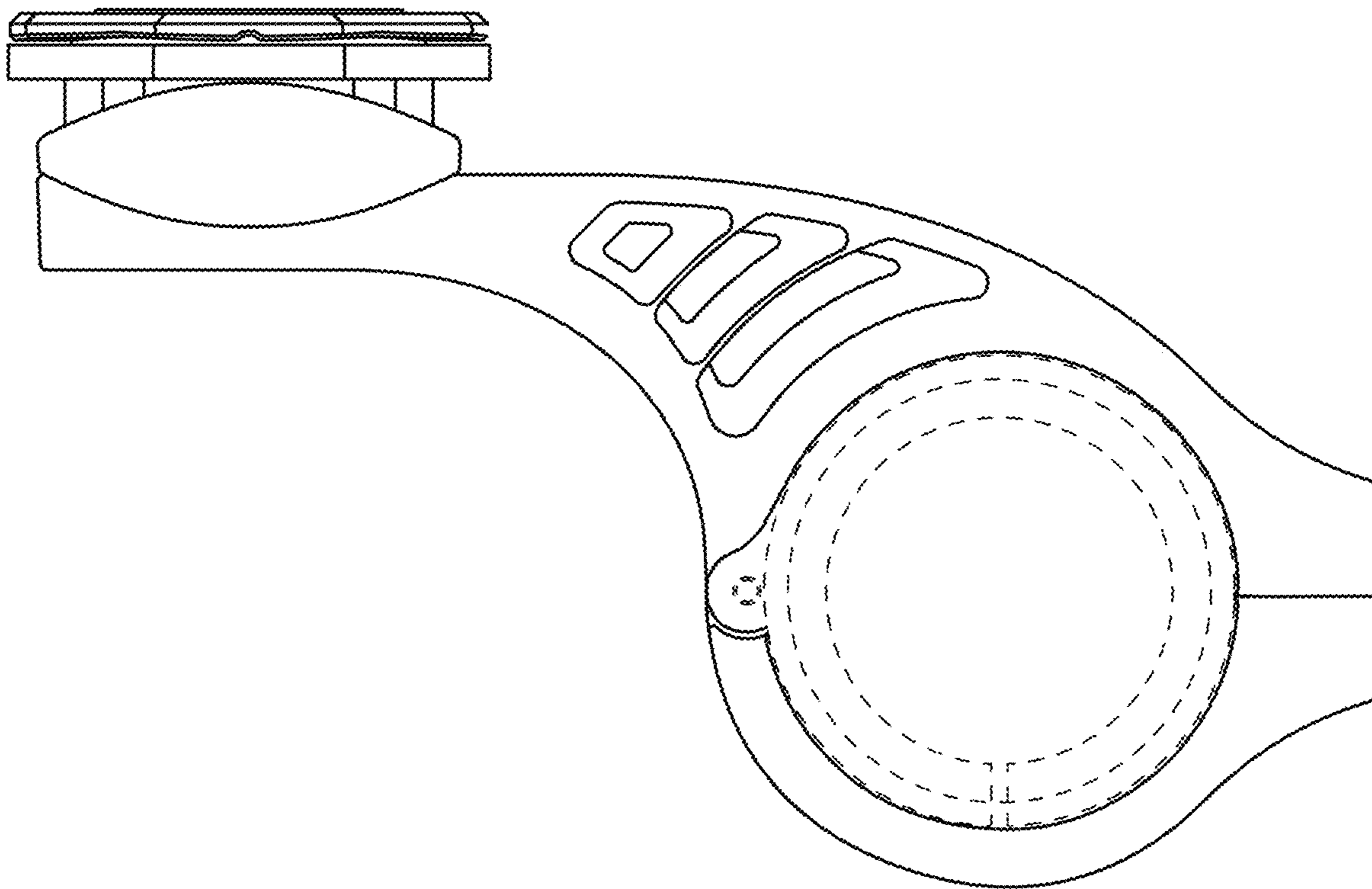

FIG. 7

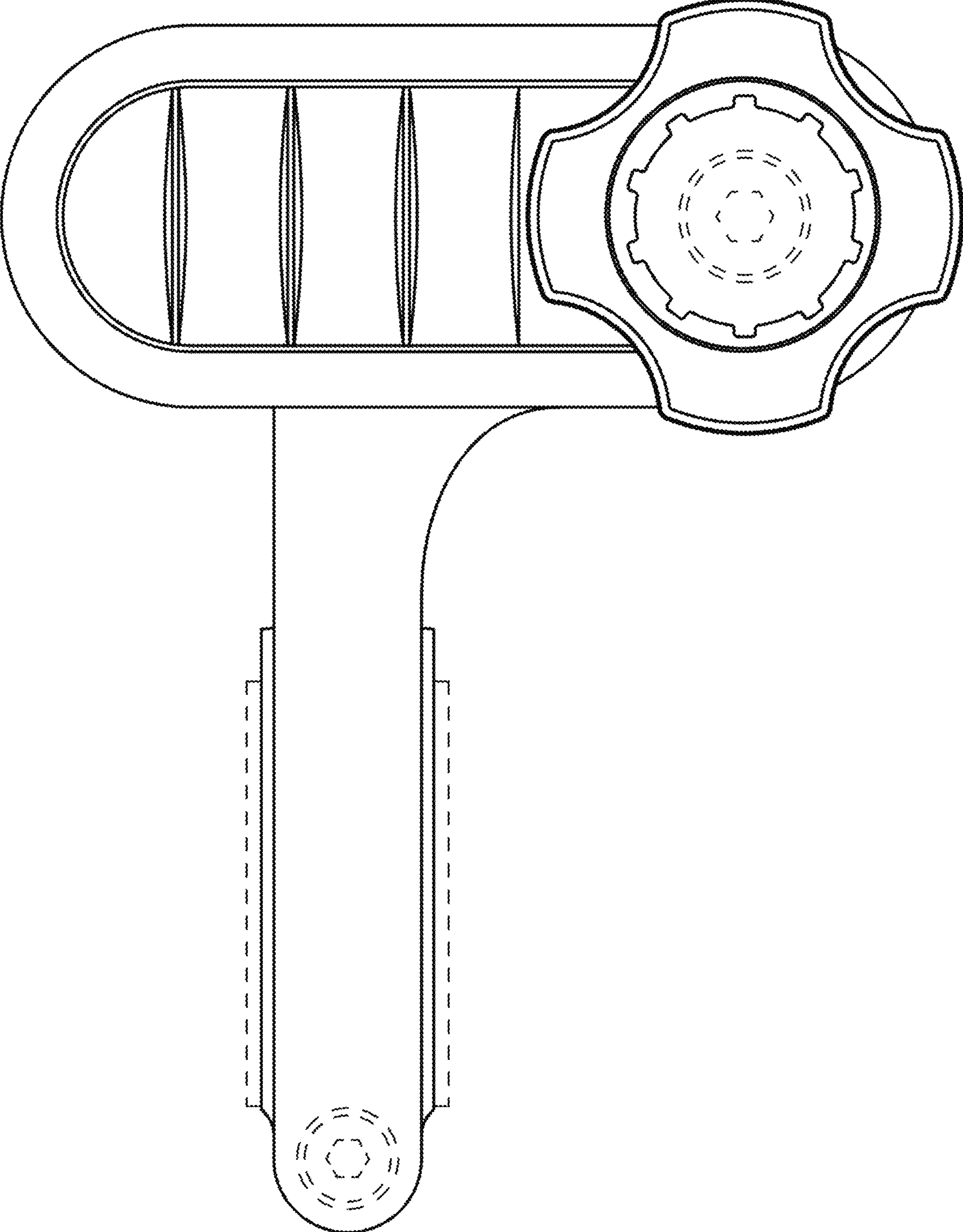

FIG. 8

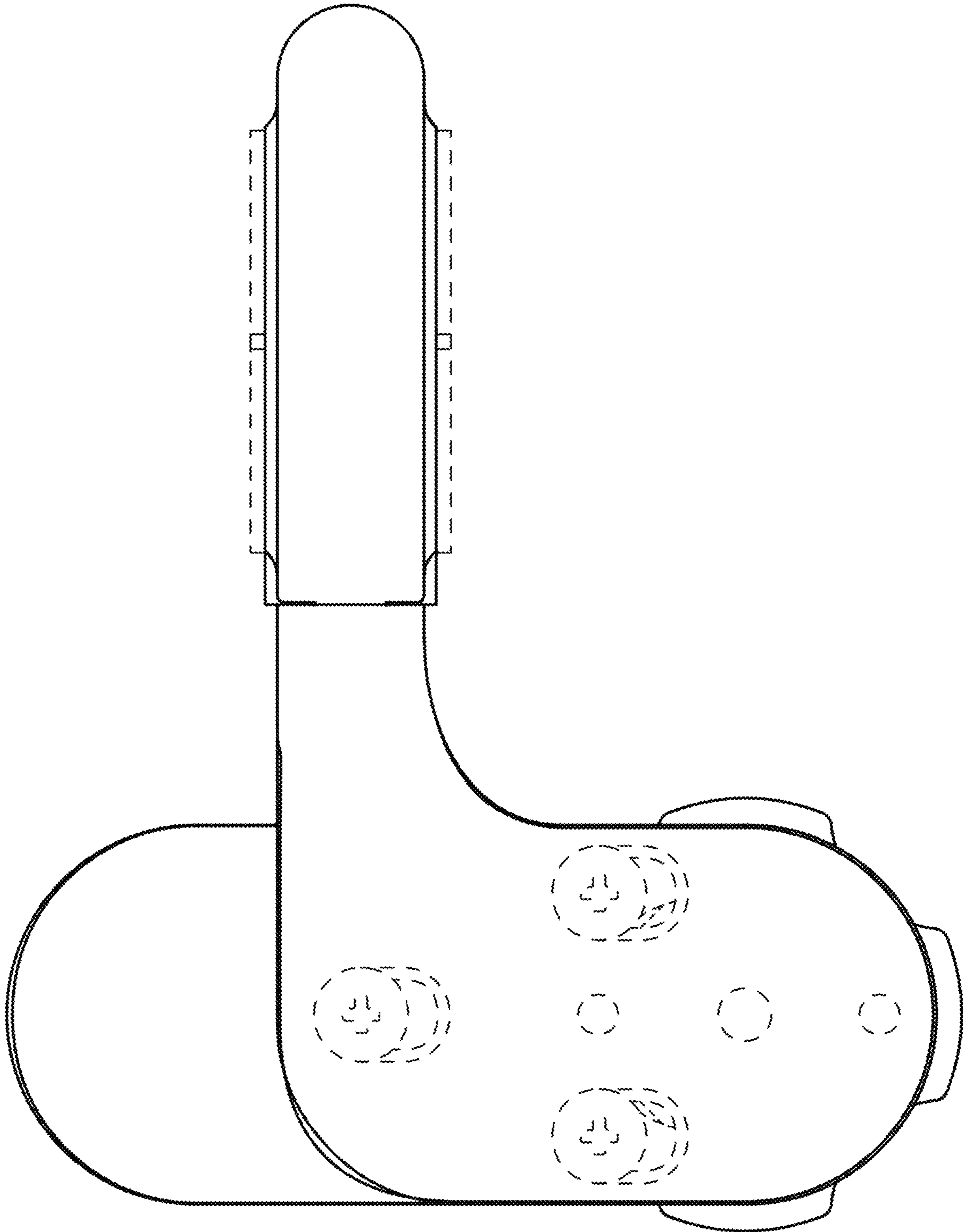

FIG. 9

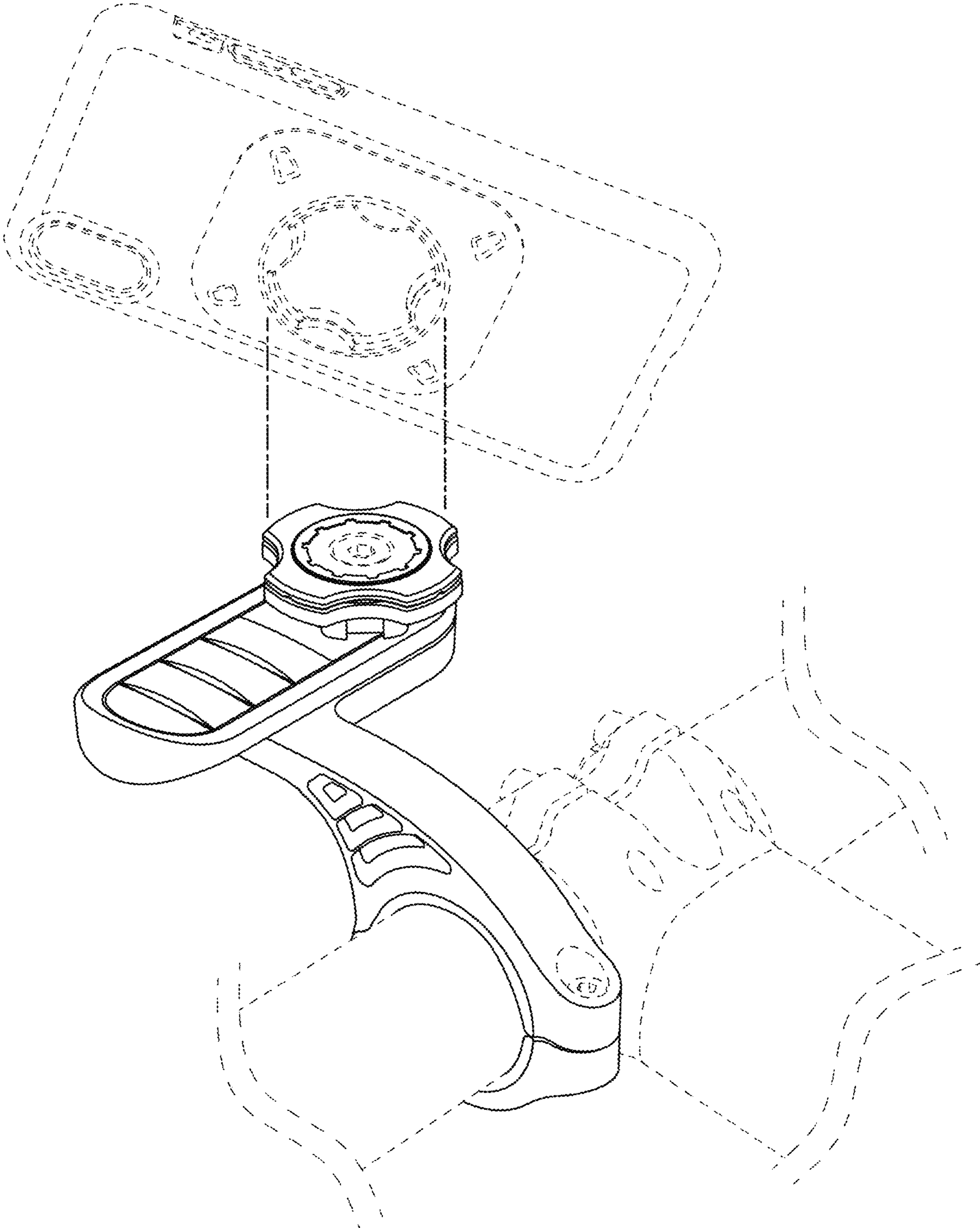

FIG. 10

