



US00D886694S

(12) **United States Design Patent** (10) **Patent No.:** **US D886,694 S**
Liu et al. (45) **Date of Patent:** **** Jun. 9, 2020**

(54) **AUTONOMOUS VEHICLE SENSOR HOUSING**

(71) Applicant: **Trifo, Inc.**, Santa Clara, CA (US)

(72) Inventors: **Shaoshan Liu**, Fremont, CA (US); **Zhe Zhang**, Sunnyvale, CA (US)

(73) Assignee: **TRIFO, INC.**, Santa Clara, CA (US)

(**) Term: **15 Years**

(21) Appl. No.: **29/613,672**

(22) Filed: **Aug. 11, 2017**

(51) **LOC (12) Cl.** **12-16**

(52) **U.S. Cl.**
USPC **D12/174**

(58) **Field of Classification Search**
USPC D12/174, 175, 176, 177, 179, 180, 187;
D14/230, 231, 232, 233, 234, 235, 236,
D14/237, 238, 238.1; D16/241, 242;
D24/127, 130, 133; D4/116; D6/681.1,
D6/681; D8/300, 301, 302, 306
CPC G06Q 30/0242; G01S 17/87; B60R 11/04;
G01C 21/165; H01Q 9/16
See application file for complete search history.

(56) **References Cited**

U.S. PATENT DOCUMENTS

D155,113 S *	9/1949	Trebules	343/805
D194,748 S *	3/1963	Rogers	D14/230
3,335,420 A *	8/1967	Silliman	H01Q 9/16 343/793
5,168,279 A *	12/1992	Knight	H01Q 9/16 324/95
D470,837 S *	2/2003	Tourres	D14/230
D506,749 S *	6/2005	Sullivan	D14/230
D527,605 S *	9/2006	Jackson	D8/107

D561,744 S *	2/2008	Whiteside	D14/230
D605,024 S *	12/2009	Cotton	D8/302
D632,157 S *	2/2011	Le	D8/306
D661,101 S *	6/2012	Du	D4/116
D738,868 S *	9/2015	Scott	D14/230
D773,866 S *	12/2016	Hogberg	D6/681
D785,788 S *	5/2017	Nguyen	D24/127
D815,074 S *	4/2018	Naweed	D14/230
D835,028 S *	12/2018	Ahn	D12/413
D838,704 S *	1/2019	Yang	D14/230
2017/0212529 A1 *	7/2017	Kumar	G01C 21/165
2018/0015886 A1 *	1/2018	Frank	B60R 11/04
2018/0086280 A1 *	3/2018	Nguyen	G01S 17/87
2018/0231979 A1 *	8/2018	Miller	G06Q 30/0242

* cited by examiner

Primary Examiner — Susan E Krakower

Assistant Examiner — Jerry Shiuan-Hua Hsu

(74) *Attorney, Agent, or Firm* — Haynes Beffel & Wolfeld, LLP; Ernest J. Beffel, Jr.; Paul A. Durdik

(57) **CLAIM**

The ornamental design for an autonomous vehicle sensor housing, as shown and described.

DESCRIPTION

FIG. 1 is a front, left, bottom perspective view of an autonomous vehicle sensor housing showing our new design;

FIG. 2 is a top plan view thereof;

FIG. 3 is a front elevation view thereof;

FIG. 4 is a right side elevation view thereof;

FIG. 5 is a left side elevation view thereof;

FIG. 6 is a rear elevation view thereof; and,

FIG. 7 is a bottom plan view thereof.

The broken lines shown in the drawings illustrate portions of the autonomous vehicle sensor housing that form no part of the claimed design.

1 Claim, 3 Drawing Sheets

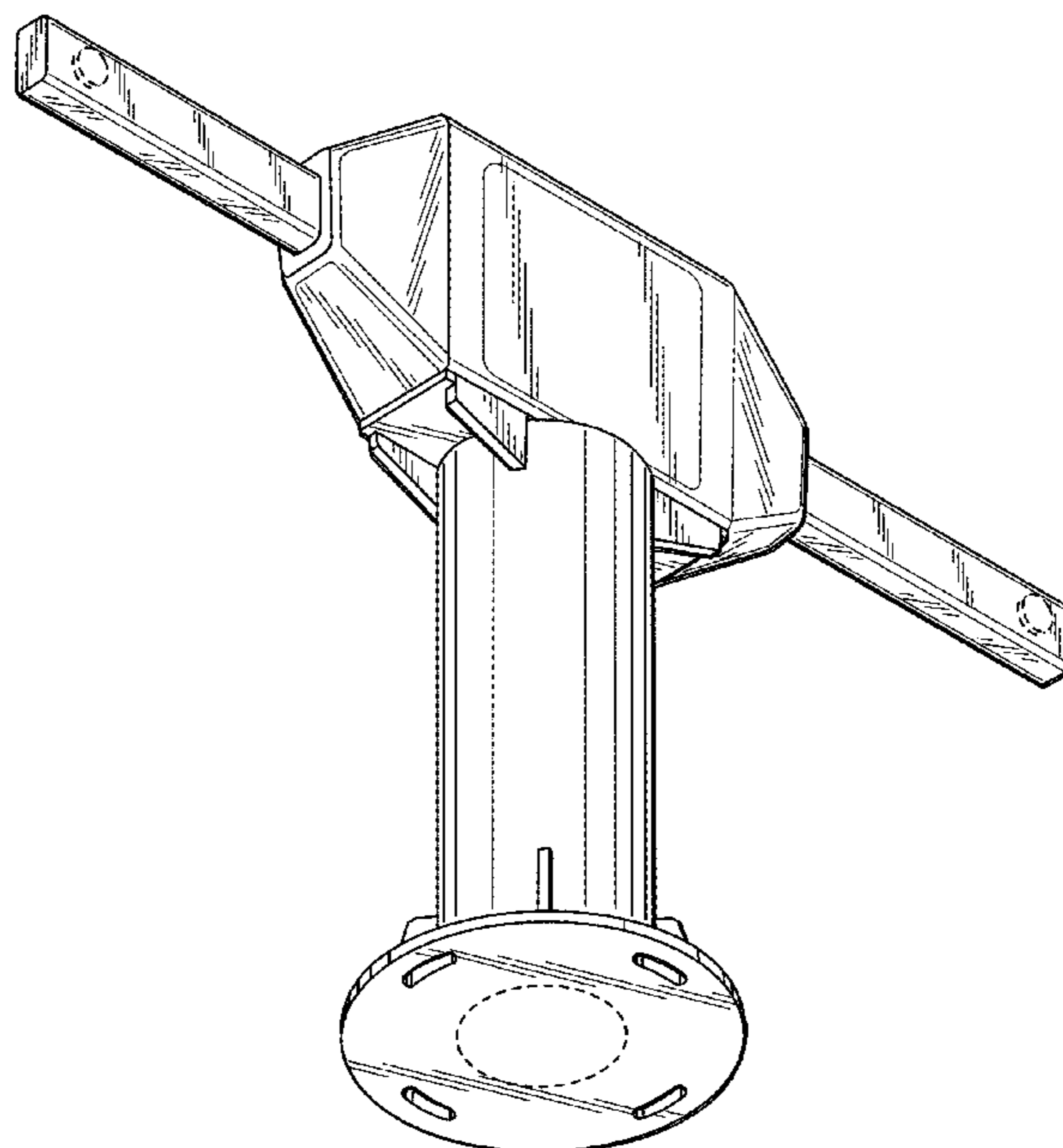

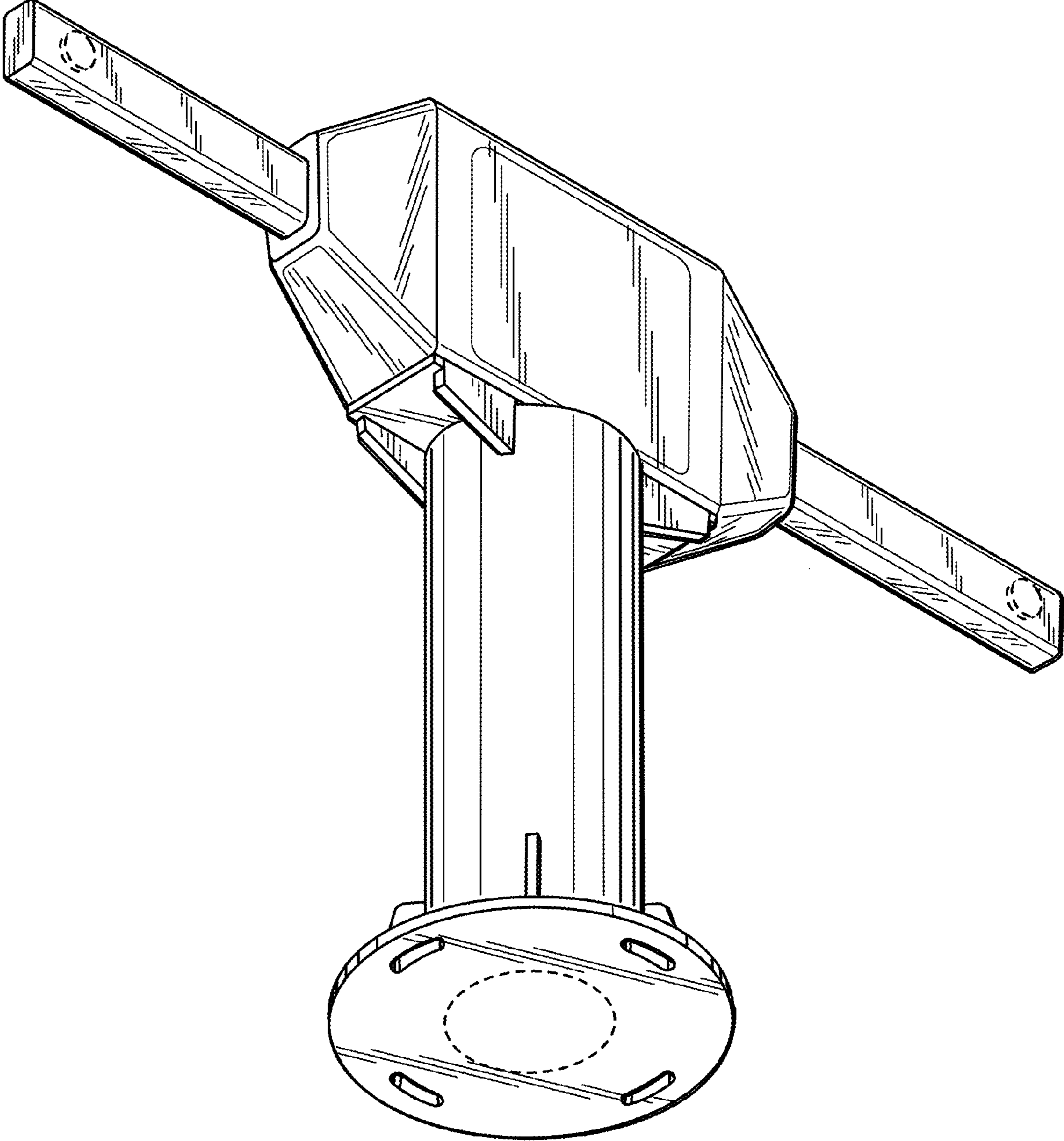

FIG. 1

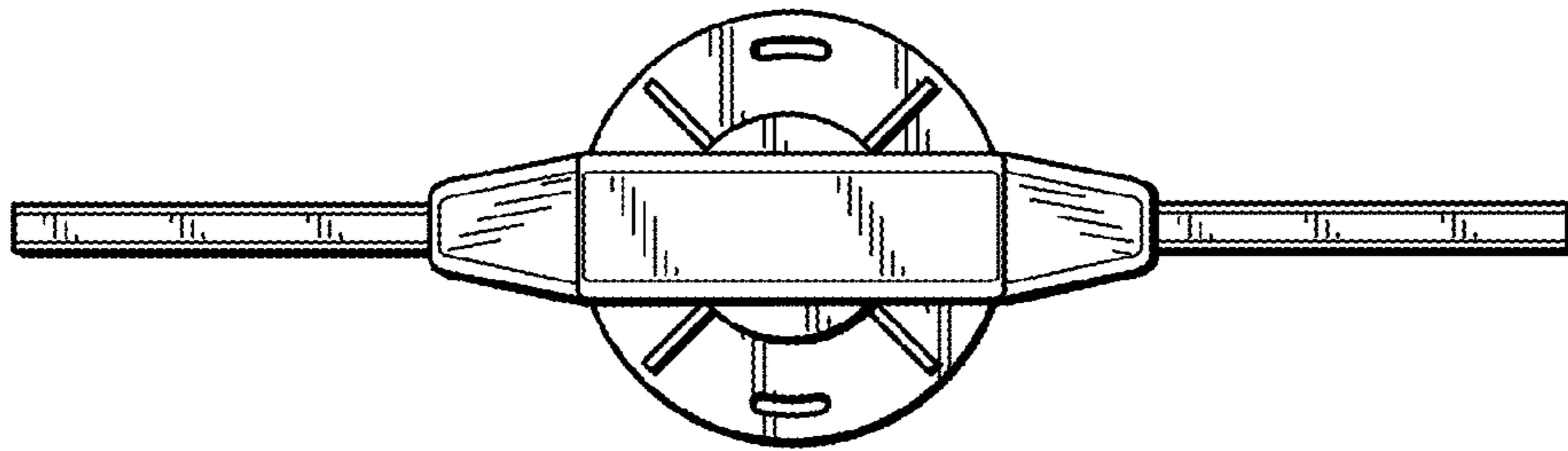

FIG. 2

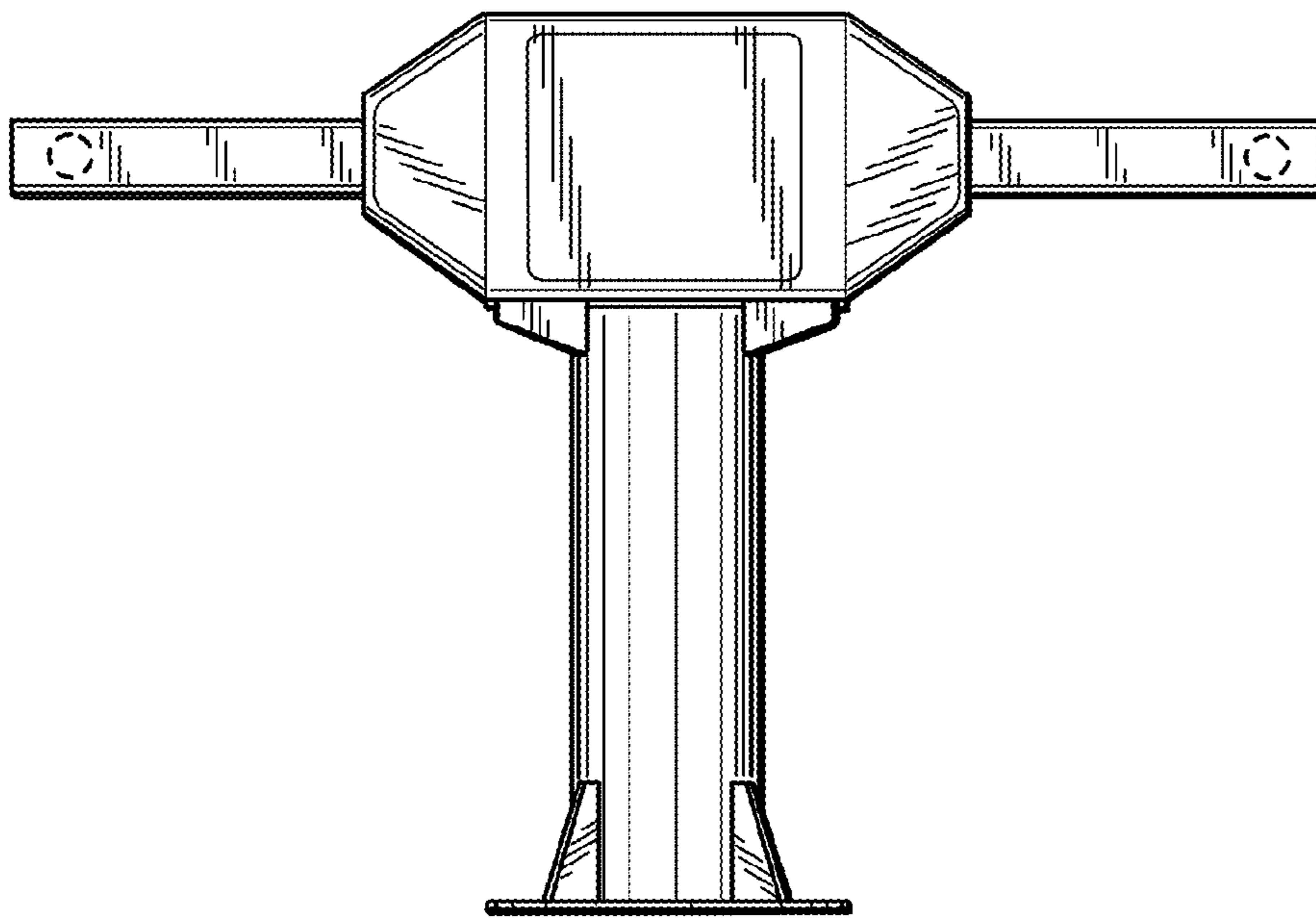

FIG. 3

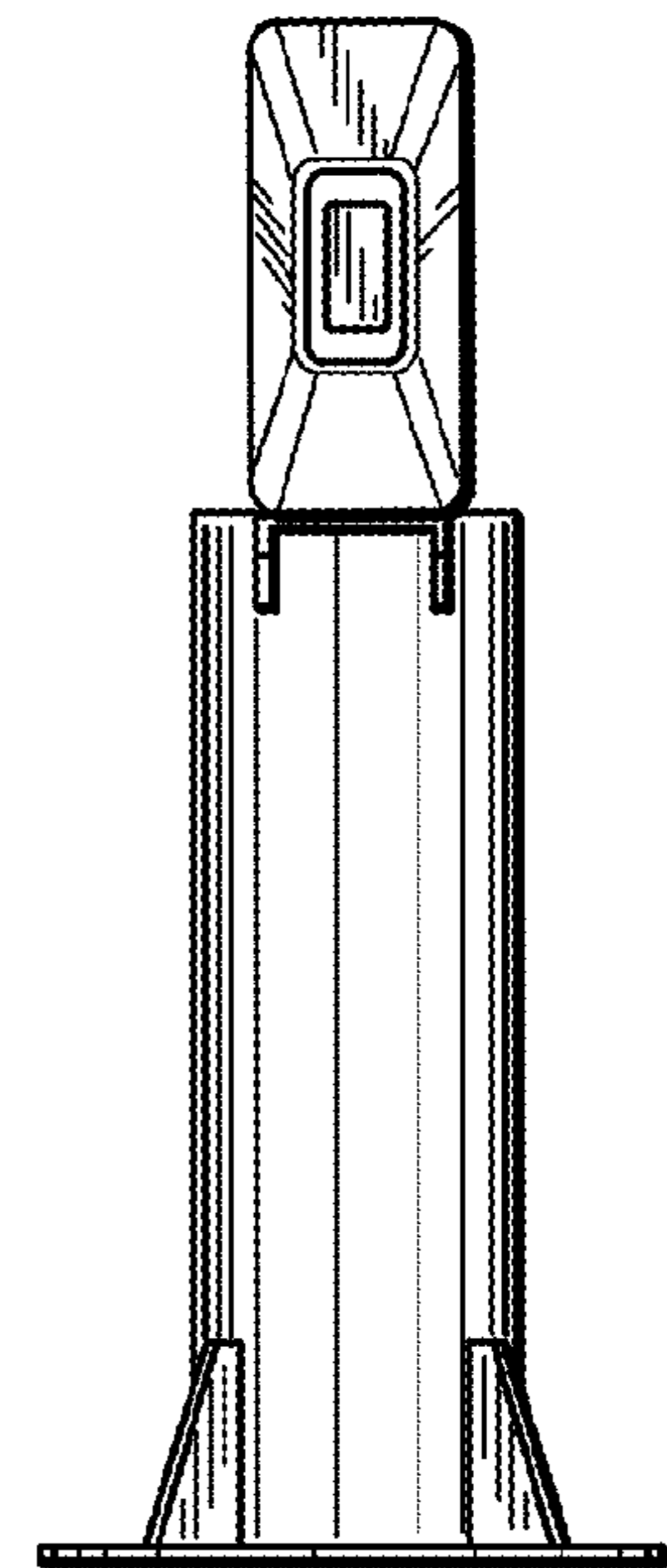

FIG. 4

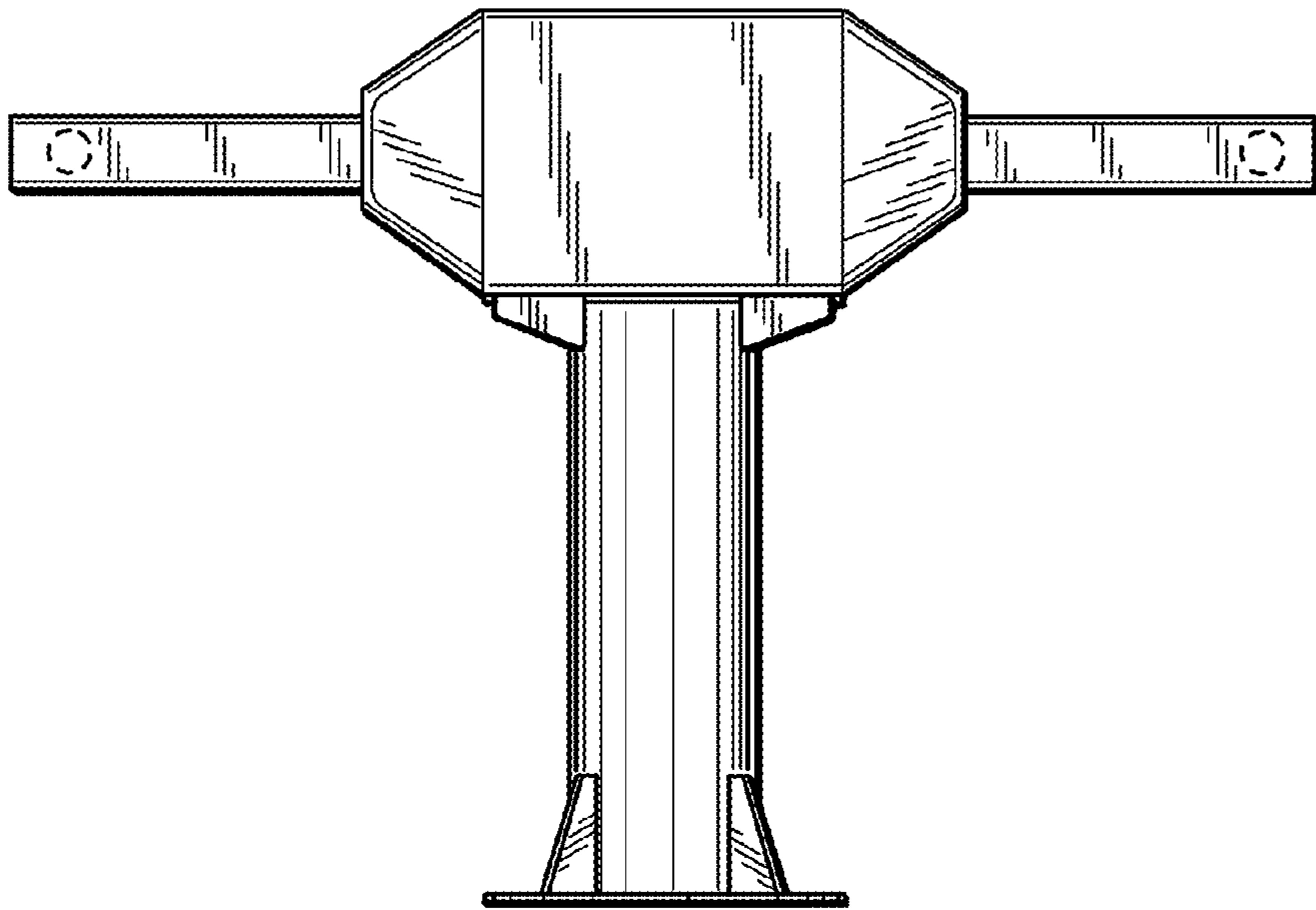

FIG. 6

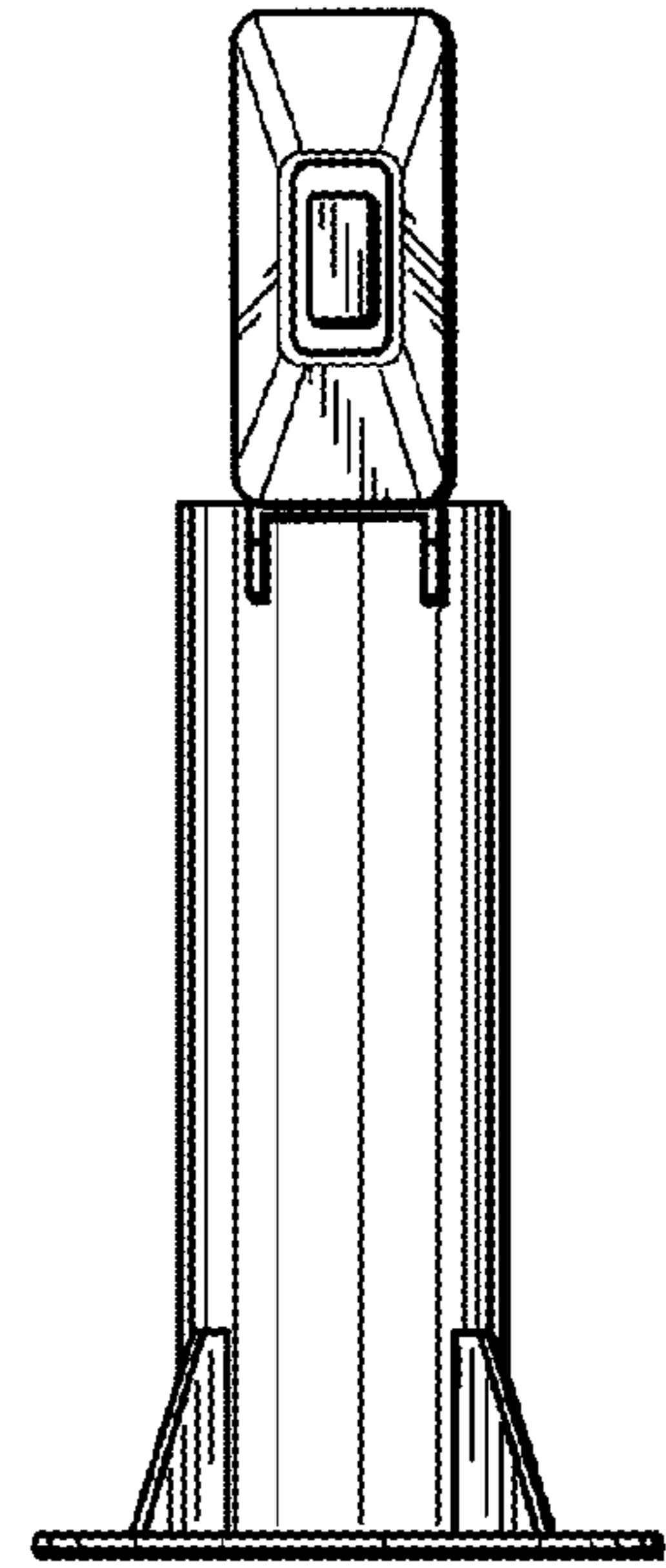

FIG. 5

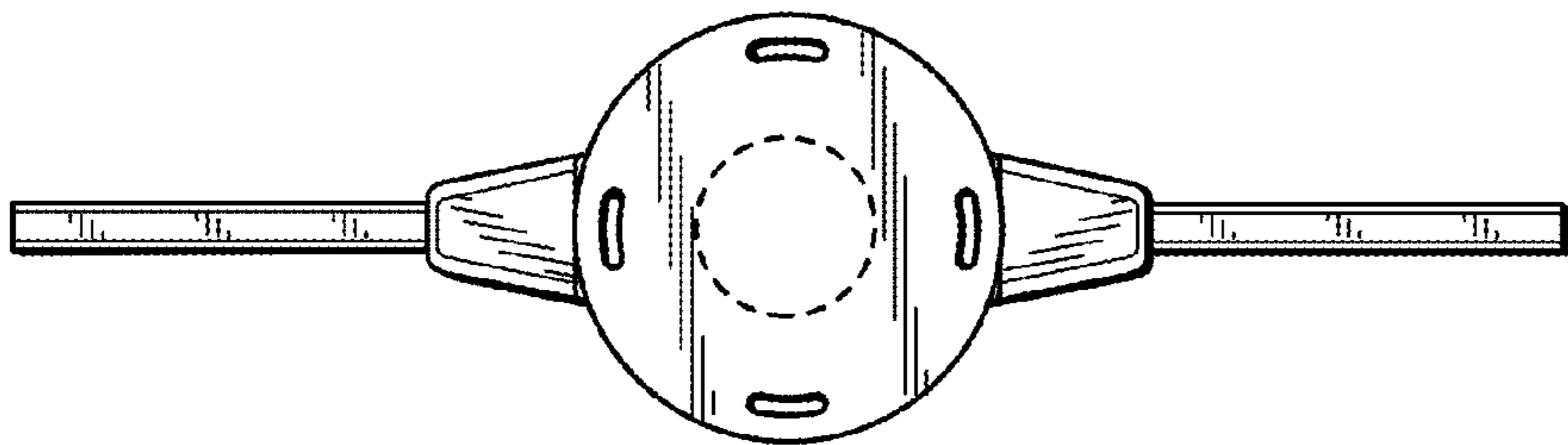

FIG. 7