



US00D884082S

(12) **United States Design Patent**  
**Fremgen et al.**

(10) **Patent No.:** **US D884,082 S**  
(45) **Date of Patent:** **\*\* May 12, 2020**

- (54) **CARD WITH SURFACE ORNAMENTATION**
- (71) Applicant: **SAP SE**, Walldorf (DE)
- (72) Inventors: **Leonie Fremgen**, Heidelberg (DE);  
**Alessandro Sposato**, Berlin (DE); **Vera Geier**, Walldorf (DE); **Karen Detken**, Heidelberg (DE)
- (73) Assignee: **SAP SE**, Walldorf (DE)
- (\*\*) Term: **15 Years**
- (21) Appl. No.: **29/638,696**
- (22) Filed: **Feb. 28, 2018**
- (51) **LOC (12) Cl.** ..... **21-01**
- (52) **U.S. Cl.**  
USPC ..... **D21/386**
- (58) **Field of Classification Search**  
USPC ..... D14/489, 490, 491, 492, 494, 495;  
D21/376, 377, 378, 379, 380, 381, 382,  
D21/383, 384, 386  
CPC ..... A63F 2001/0408; A63F 2001/0416; A63F  
2001/0425; A63F 2001/0433; A63F  
2001/0441; A63F 2001/045; A63F  
2001/0475; A63F 2001/0483; A63F  
2001/0491; A63F 1/02; A63F 1/04  
See application file for complete search history.

(56) **References Cited**

**U.S. PATENT DOCUMENTS**

- 1,362,318 A \* 12/1920 Hydes ..... A63F 9/20  
273/294
- 4,190,256 A \* 2/1980 Rudden, Jr. .... A63F 3/00097  
273/275
- 4,673,185 A \* 6/1987 Morley, Jr. .... A63F 9/20  
273/294
- 5,524,897 A \* 6/1996 Mastronunzio ..... A63F 3/00176  
273/236
- D454,164 S \* 3/2002 Allen ..... A63F 9/20  
D21/363
- D462,972 S \* 9/2002 Smyth ..... D14/478

- 6,866,266 B1 \* 3/2005 Thorne ..... A63F 9/20  
273/271
  - 6,938,899 B2 \* 9/2005 Kenney ..... A63F 3/00075  
273/146
  - D587,321 S \* 2/2009 Patel ..... A63F 3/00075  
D21/391
  - D660,373 S \* 5/2012 Fuchs ..... D21/363
  - 9,089,765 B1 \* 7/2015 Walsh ..... A63F 3/00694
- (Continued)

**OTHER PUBLICATIONS**

Sapapphaus, At #apphauspaloalto we challenge people to “Think Outside the Box.” Instagram.com, Jul. 11, 2016, Available at <<https://www.instagram.com/p/BHu4pu6jpzq/?taken-by=sapapphaus>>.

(Continued)

*Primary Examiner* — George D. Kirschbaum  
*Assistant Examiner* — Joseph J Kukella  
(74) *Attorney, Agent, or Firm* — Sterne, Kessler, Goldstein & Fox P.L.L.C.

(57) **CLAIM**

The ornamental design for a card with surface ornamentation, as shown and described.

**DESCRIPTION**

FIG. 1 is a rear perspective view of a card with surface ornamentation showing the claimed design; FIG. 2 is a rear view of the card with surface ornamentation of FIG. 1 in another position; FIG. 3 is a front view thereof; FIG. 4 is a right side view thereof; FIG. 5 is a left side view thereof; FIG. 6 is a top view thereof; and, FIG. 7 is a bottom view thereof. The broken lines in the figures show portions of the card with surface ornamentation that form no part of the claimed design.

**1 Claim, 4 Drawing Sheets**

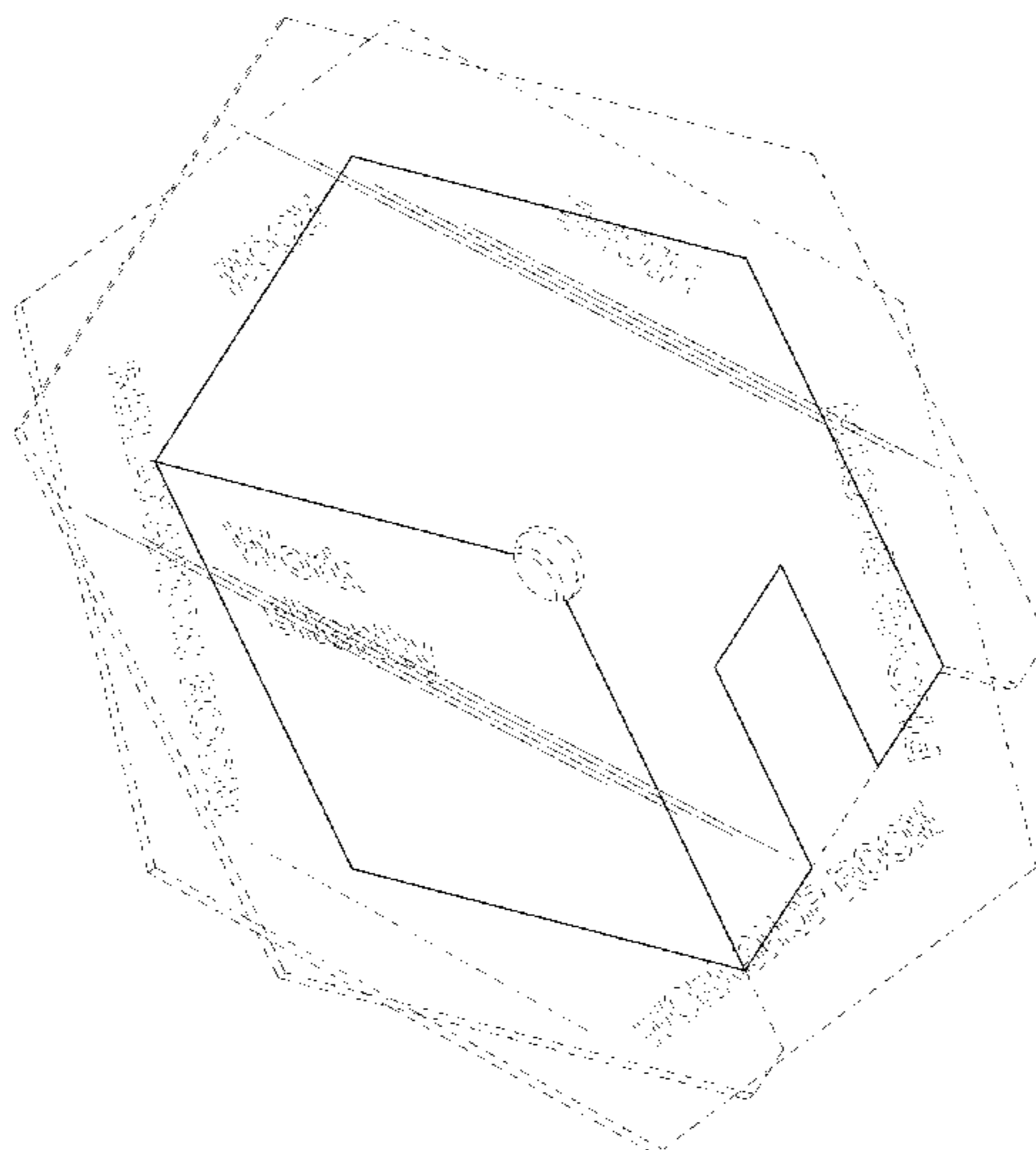

(56)

**References Cited**

U.S. PATENT DOCUMENTS

D760,844 S \* 7/2016 Phelan ..... D21/334  
D773,565 S \* 12/2016 Waldeck ..... D21/386

OTHER PUBLICATIONS

SAP UX Design Services, “Mosaic—Creative Spaces Toolkit by SAP Design” Vimeo.com, Sep. 14, 2017, Available at <<https://vimeo.com/233787592>>.

\* cited by examiner

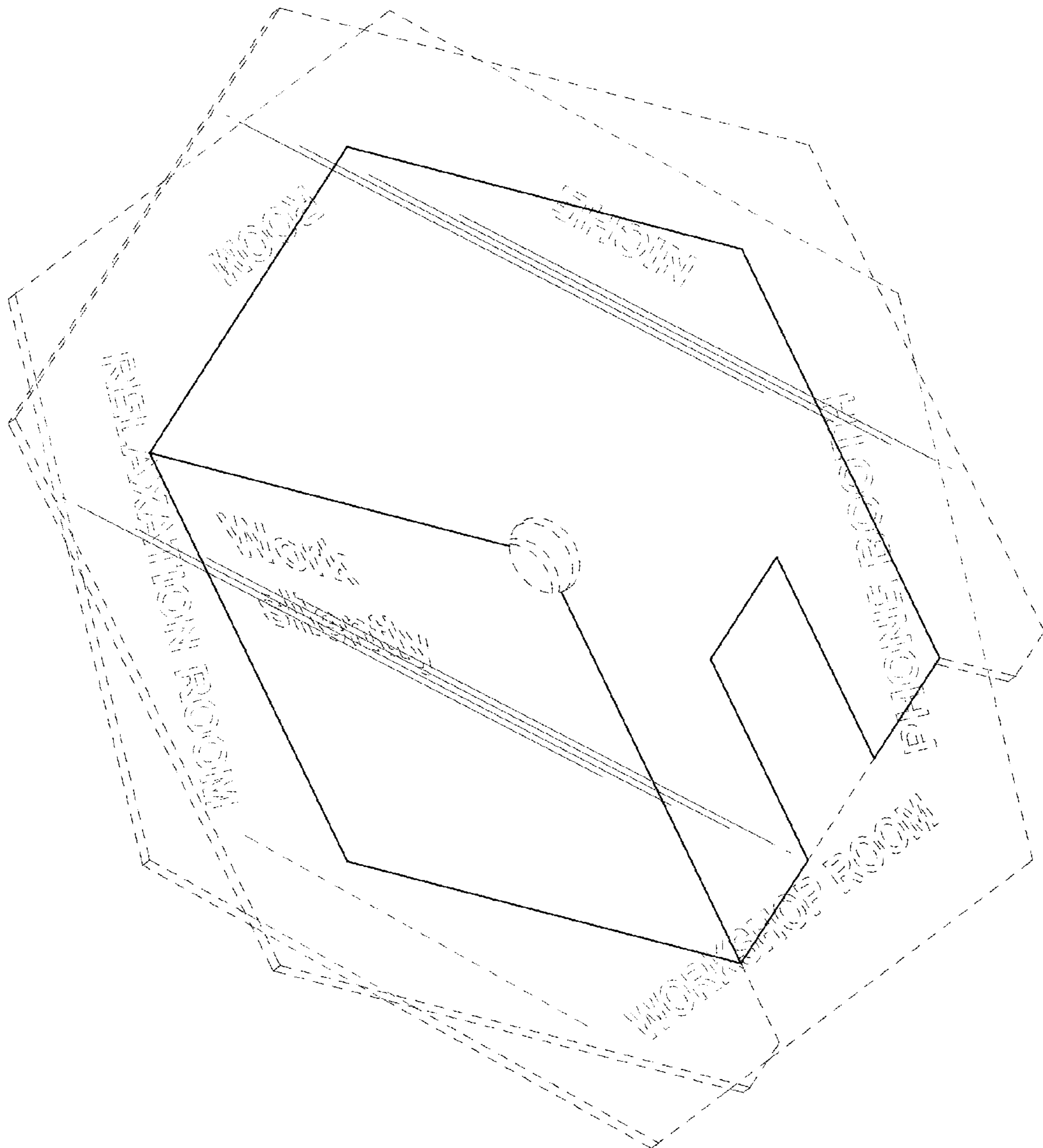

FIG. 1

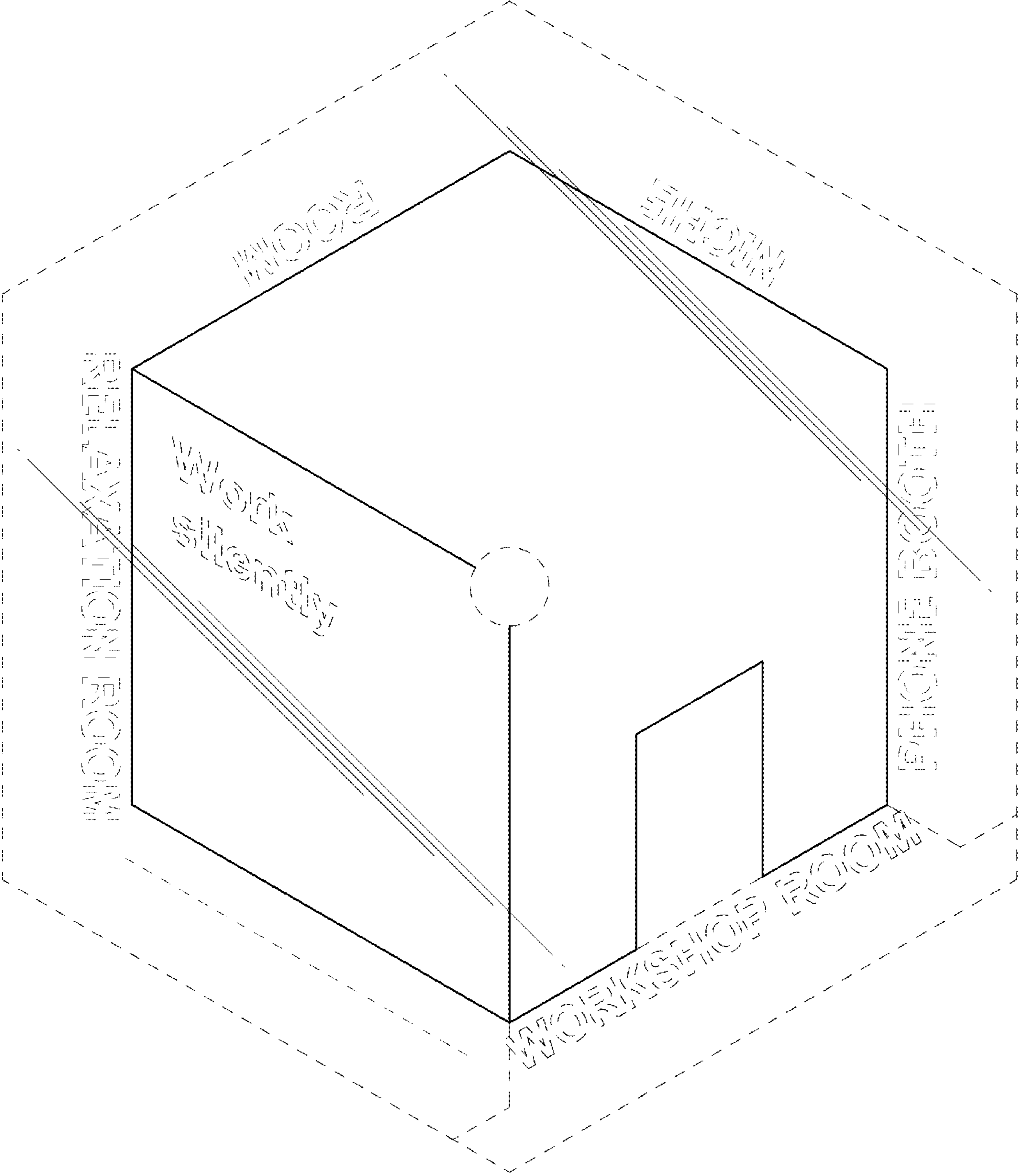

FIG. 2

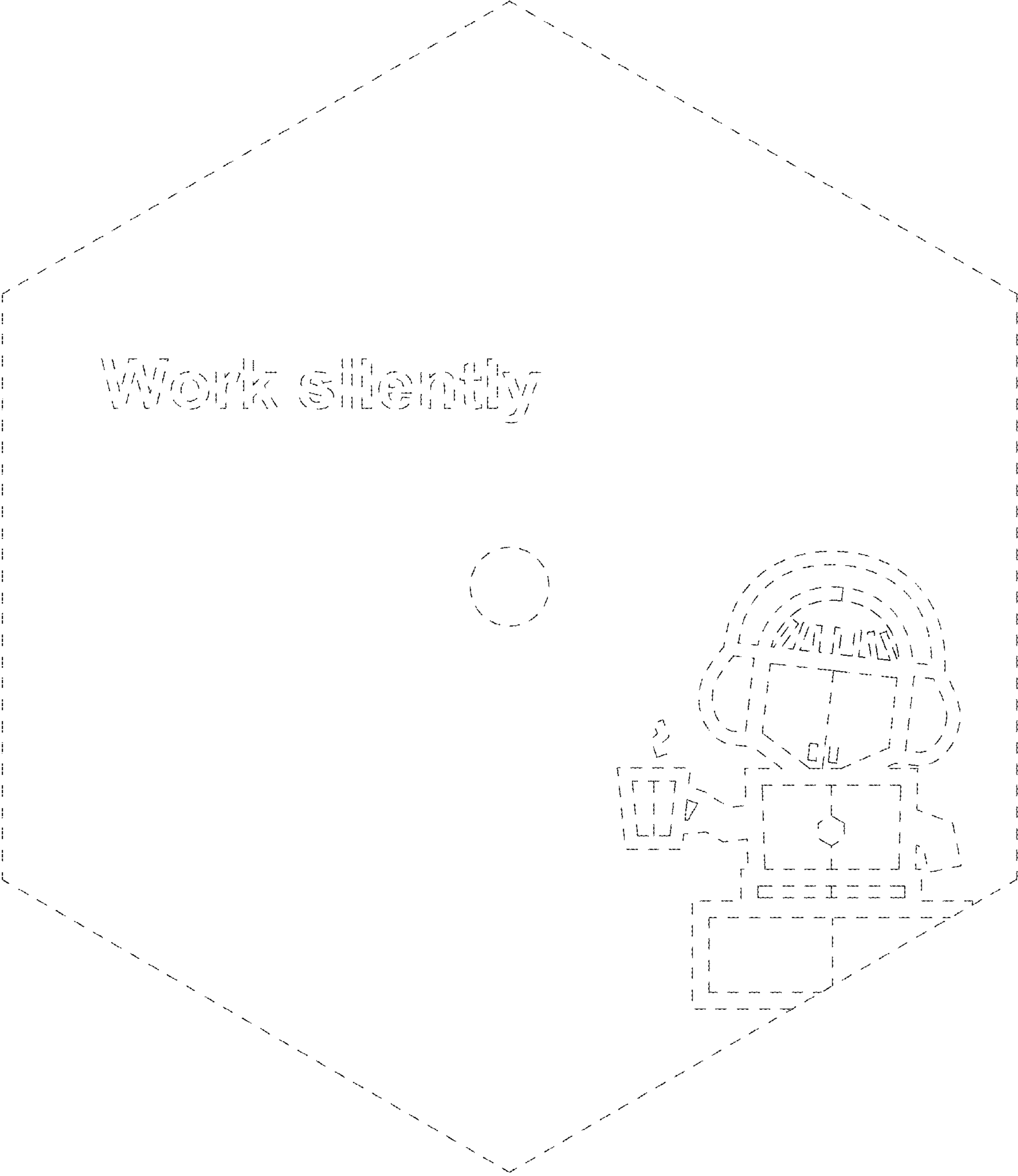
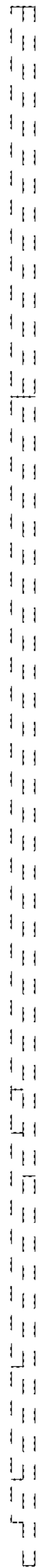
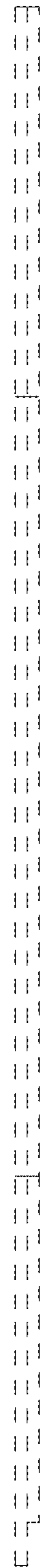

FIG. 3



**FIG. 4**



**FIG. 5**

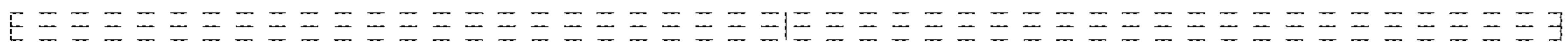

**FIG. 6**

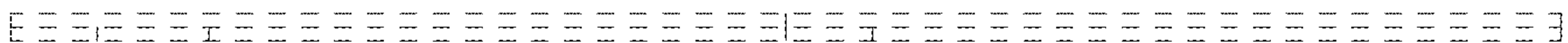

**FIG. 7**