



US00D883868S

(12) **United States Design Patent** (10) **Patent No.:** **US D883,868 S**
Hayashi et al. (45) **Date of Patent:** **** May 12, 2020**

(54) **REAR BUMPER FOR AN AUTOMOBILE**

(71) Applicants: **Hideki Hayashi**, Toyota (JP);
Masayuki Sugiura, Nagoya (JP)

(72) Inventors: **Hideki Hayashi**, Toyota (JP);
Masayuki Sugiura, Nagoya (JP)

(73) Assignee: **TOYOTA JIDOSHA KABUSHIKI KAISHA** (JP)

(**) Term: **15 Years**

(21) Appl. No.: **29/673,988**

(22) Filed: **Dec. 19, 2018**

(30) **Foreign Application Priority Data**

Jun. 21, 2018 (JP) 2018-013633

(51) **LOC (12) Cl.** **12-16**

(52) **U.S. Cl.**
USPC **D12/169**

(58) **Field of Classification Search**
USPC D12/169, 164, 196, 171, 163, 86, 90-92;
293/102, 113, 115, 117, 120; 296/180.1,
296/180.2
CPC B60R 19/02; B60R 19/04; B62D 25/08
See application file for complete search history.

(56) **References Cited**

U.S. PATENT DOCUMENTS

D721,306 S * 1/2015 George D12/169
D725,009 S * 3/2015 Hirai D12/169
D725,010 S * 3/2015 Takei D12/169
D736,125 S * 8/2015 Kamiura D12/169
D773,351 S * 12/2016 Munakata D12/169

D773,353 S * 12/2016 Munakata D12/169
D782,373 S * 3/2017 Curic D12/169
D792,291 S * 7/2017 Suga D12/169
D800,034 S * 10/2017 Kojima D12/169
D843,279 S * 3/2019 Jevremovic D12/169
D867,235 S * 11/2019 Kawashima D12/169

OTHER PUBLICATIONS

NETCARSHOW, Toyota Lexus RC F (2015) <https://www.netcarshow.com/lexus/2015-rc_f/>, available as early as Dec. 6, 2017.
Nissan HP, Nissan NOTE nismo (2017), <<https://www3.nissan.co.jp/vehicles/new/note/nismo.html>>, available as early as Dec. 12, 2018.

* cited by examiner

Primary Examiner — Melody N Brown

(74) *Attorney, Agent, or Firm* — Saidman DesignLaw Group, LLC

(57) **CLAIM**

The ornamental design for a rear bumper for an automobile, as shown and described.

DESCRIPTION

FIG. 1 is a perspective view of a rear bumper for an automobile showing our new design;
FIG. 2 is a front view thereof;
FIG. 3 is a rear view thereof;
FIG. 4 is a left side view thereof;
FIG. 5 is a right side view thereof;
FIG. 6 is a top view thereof; and,
FIG. 7 is a bottom view thereof.
The claimed design is indicated by the relatively dark portions in the figures. The relatively light portions form no part of the claimed design.

1 Claim, 7 Drawing Sheets



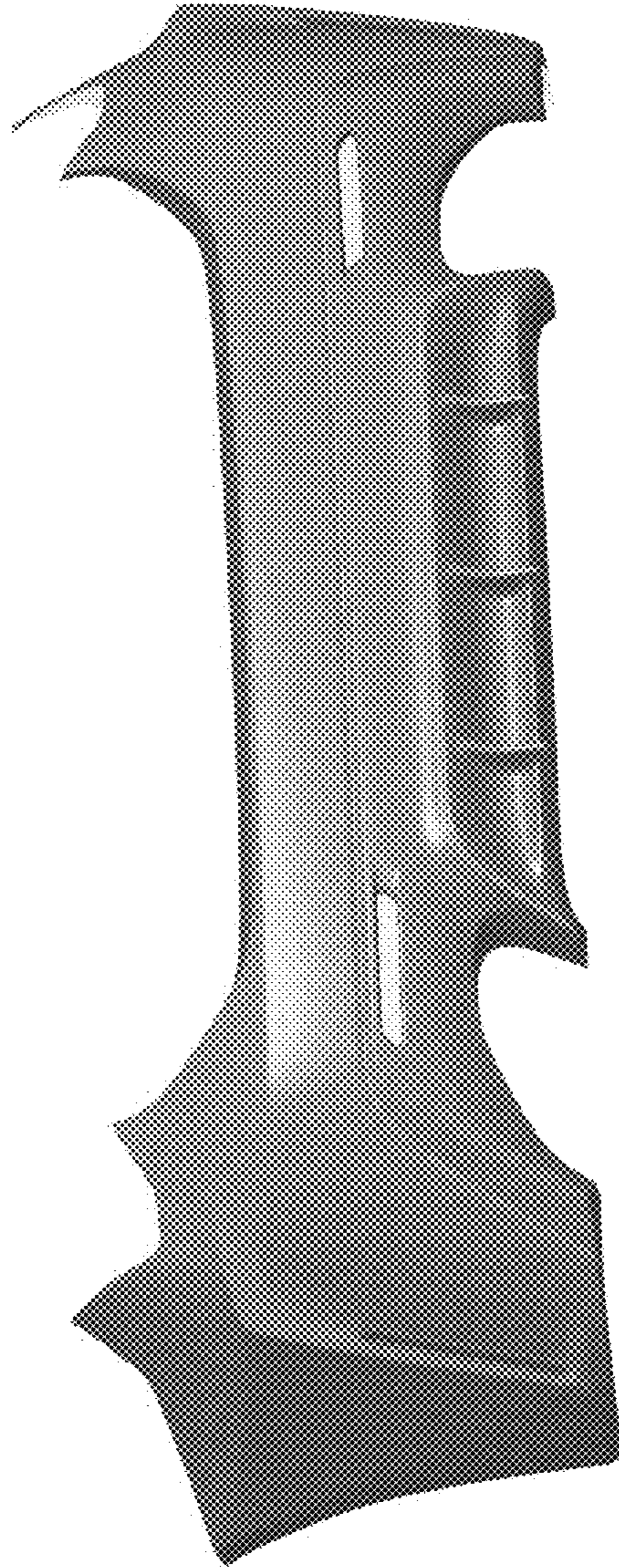

FIG. 1

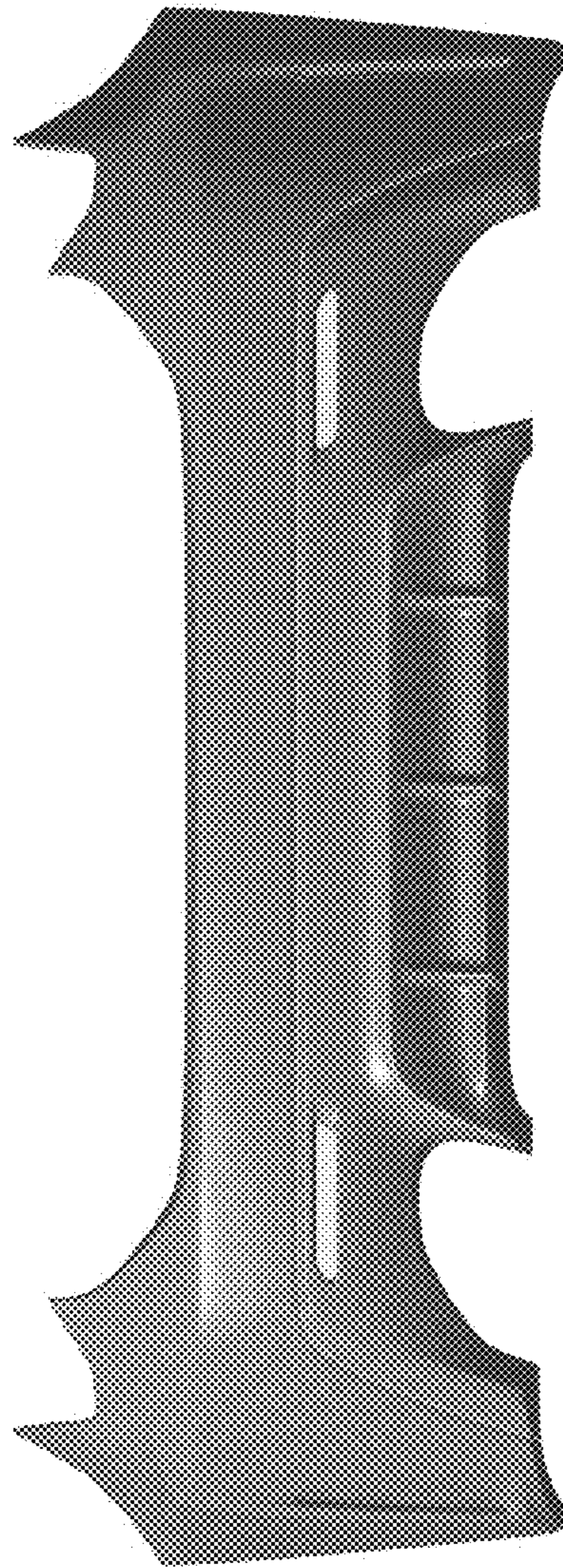

FIG. 2

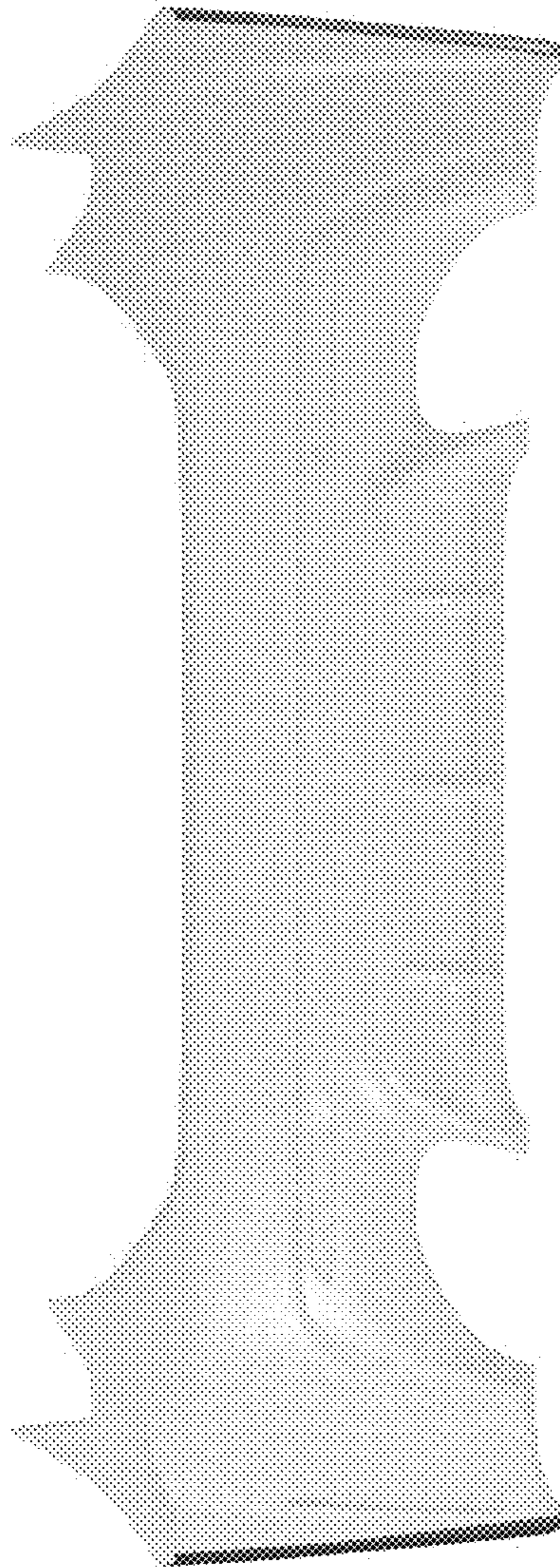

FIG. 3

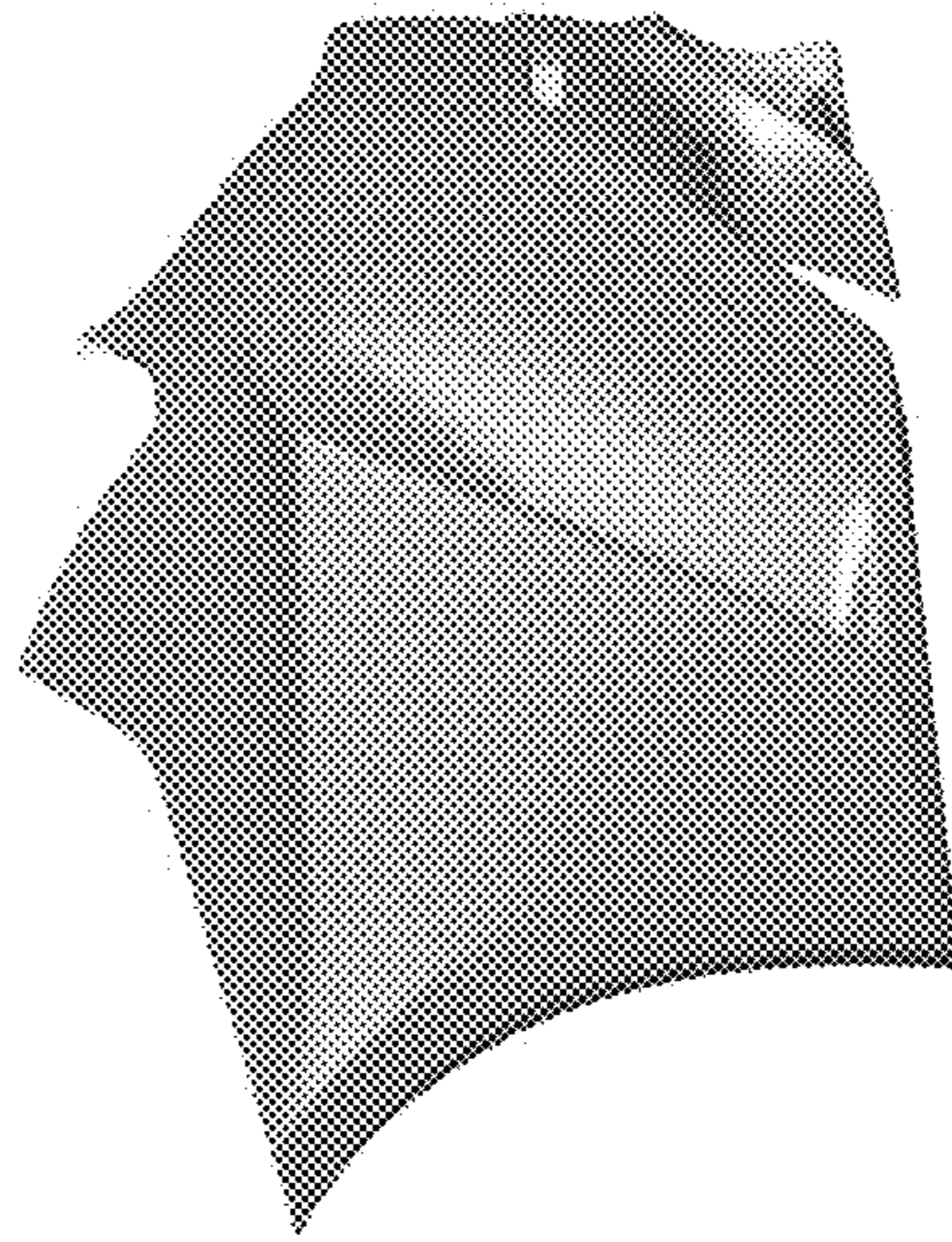

FIG. 4

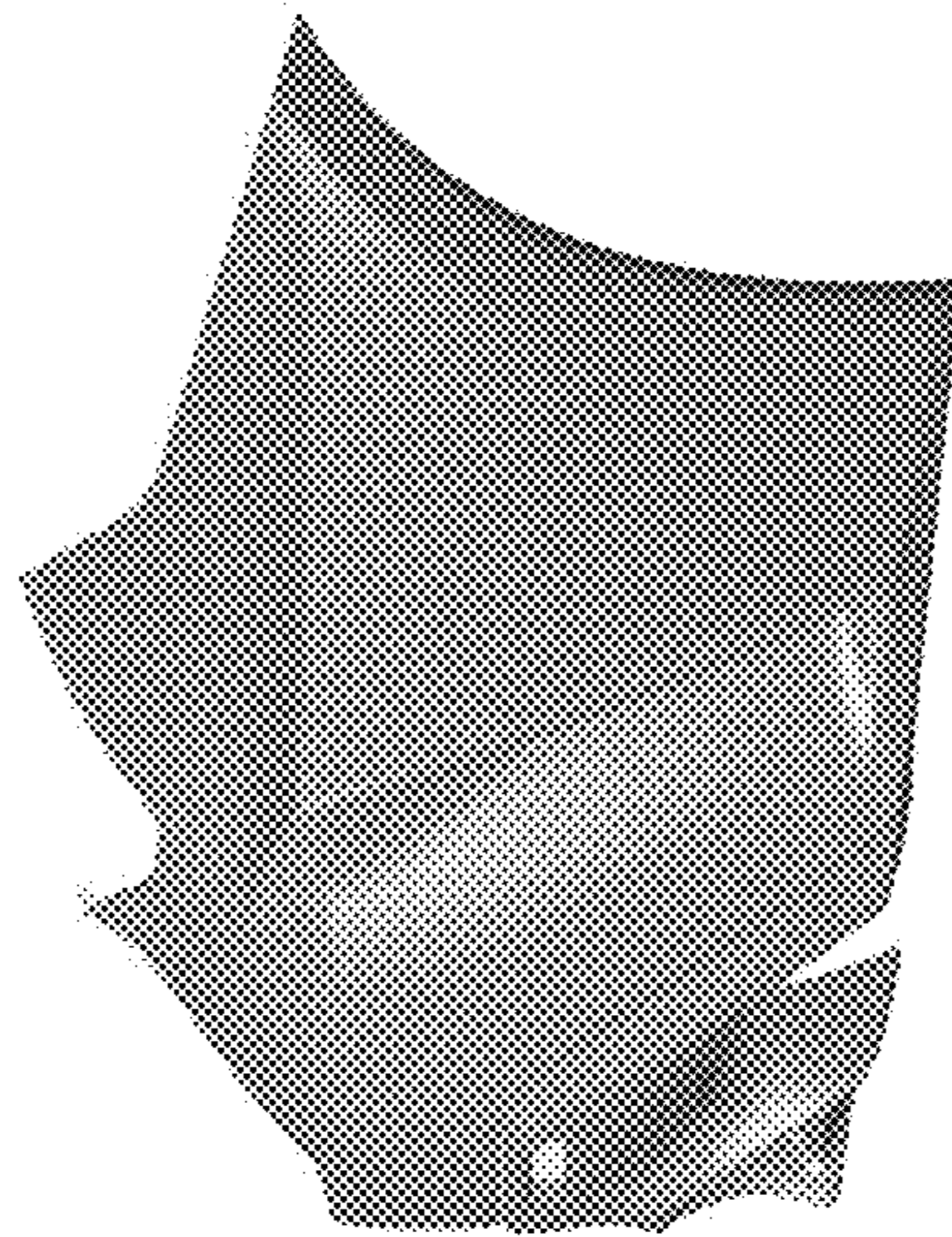

FIG. 5

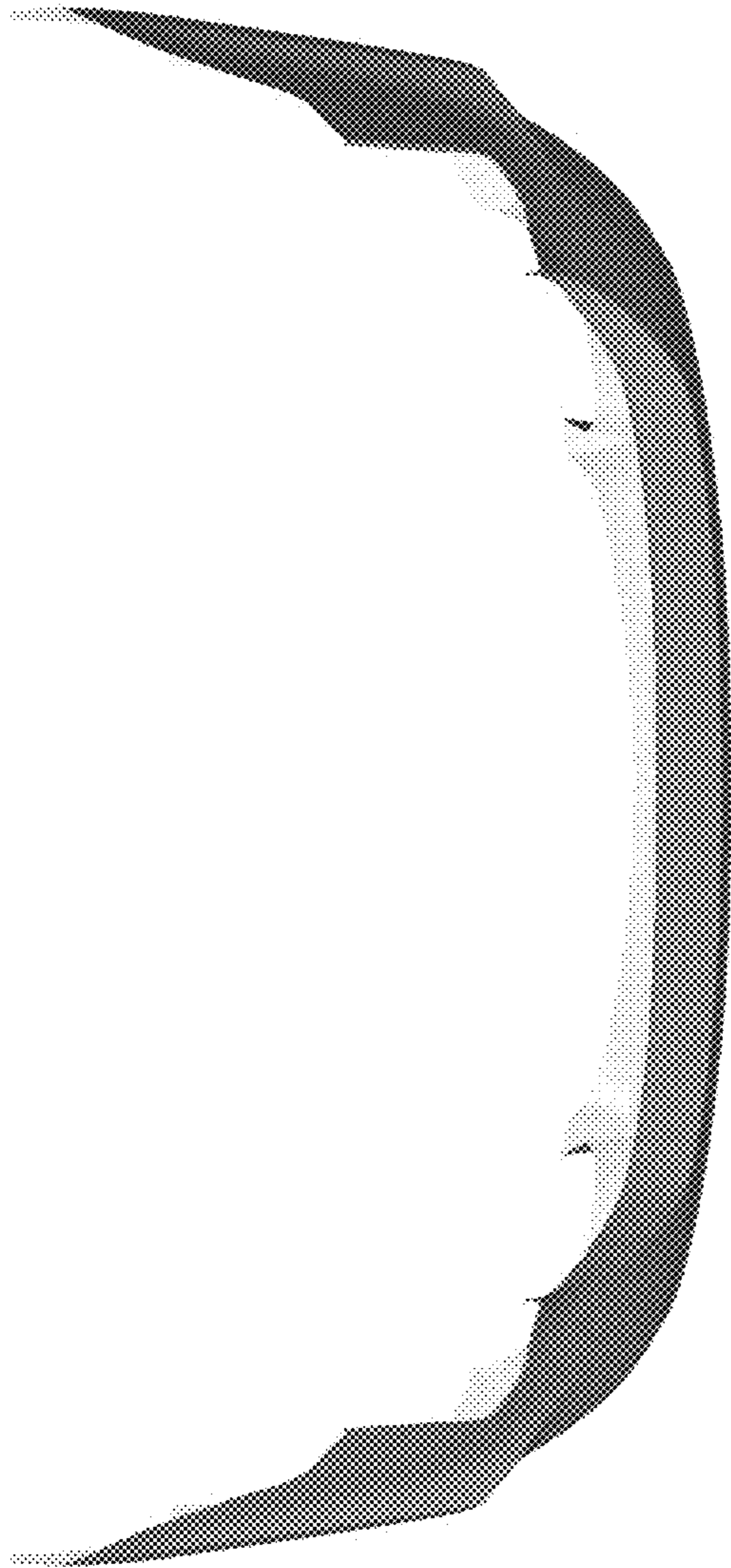

FIG. 6

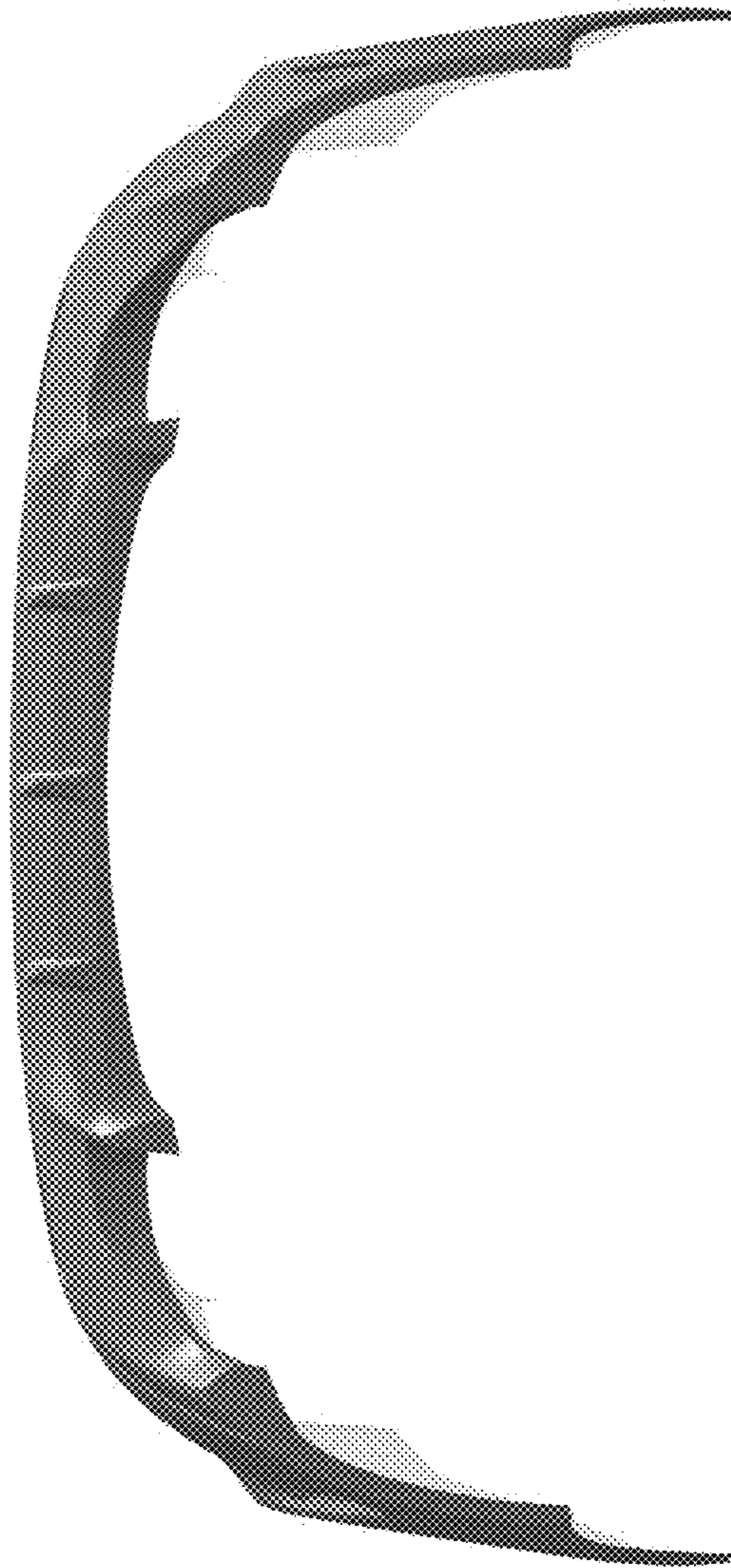

FIG. 7