



US00D882691S

(12) **United States Design Patent** (10) **Patent No.:** **US D882,691 S**
Tsuchiya et al. (45) **Date of Patent:** **** Apr. 28, 2020**

(54) **CONTROLLER FOR COMPUTER**

(71) Applicant: **NINTENDO CO., LTD.**, Kyoto (JP)

(72) Inventors: **Hitoshi Tsuchiya**, Kyoto (JP);
Fumiyoshi Suetake, Kyoto (JP); **Yui Ehara**, Kyoto (JP); **Yuko Zenri**, Kyoto (JP); **Junichiro Miyatake**, Kyoto (JP); **Tetsuya Akama**, Kyoto (JP)

(73) Assignee: **Nintendo Co., Ltd.**, Kyoto (JP)

(**) Term: **15 Years**

(21) Appl. No.: **29/645,665**

(22) Filed: **Apr. 27, 2018**

Related U.S. Application Data

(62) Division of application No. 29/595,214, filed on Feb. 27, 2017, now Pat. No. Des. 819,641.

Foreign Application Priority Data

Aug. 30, 2016 (JP) 2016-018401
Aug. 30, 2016 (JP) 2016-018402
Aug. 30, 2016 (JP) 2016-018403
Aug. 30, 2016 (JP) 2016-018404
Aug. 30, 2016 (JP) 2016-018405
Aug. 30, 2016 (JP) 2016-018406
Aug. 30, 2016 (JP) 2016-018407

(51) **LOC (12) Cl.** **21-01**

(52) **U.S. Cl.**
USPC **D21/333**

(58) **Field of Classification Search**
USPC D21/324, 332, 333-337, 566, 572-574,
D21/328, 725, 750, 753, 757; D14/217,
D14/218, 356, 387, 388, 389, 400, 401,
D14/415, 418, 426-431, 443, 447, 449,
D14/450, 454, 455, 471, 474, 483, 496,
D14/511; D13/103, 108; D34/12-27

(Continued)

(56) **References Cited**

U.S. PATENT DOCUMENTS

D362,030 S 9/1995 Chan
5,551,693 A 9/1996 Goto

(Continued)

OTHER PUBLICATIONS

Design U.S. Appl. No. 29/595,214, filed Feb. 27, 2017, Tsuchiya et al.

(Continued)

Primary Examiner — Sandra S Snapp

Assistant Examiner — Mehri F Bajoul

(74) *Attorney, Agent, or Firm* — Nixon & Vanderhye PC

(57) **CLAIM**

The ornamental design for a controller for computer, as shown and described.

DESCRIPTION

FIG. 1 is a front side perspective view of a controller for computer showing our new design;
FIG. 2 is a back side perspective view thereof;
FIG. 3 is a front view thereof;
FIG. 4 is a back view thereof;
FIG. 5 is a top view thereof;
FIG. 6 is a bottom view thereof;
FIG. 7 is a right view thereof;
FIG. 8 is a left view thereof; and,
FIG. 9 is an enlarged sectional view thereof indicated in FIG. 6, but the controller body is not shown for ease of illustration.
The broken lines shown in the drawings depict portions of the controller for computer that form no part of the claimed design.

1 Claim, 9 Drawing Sheets

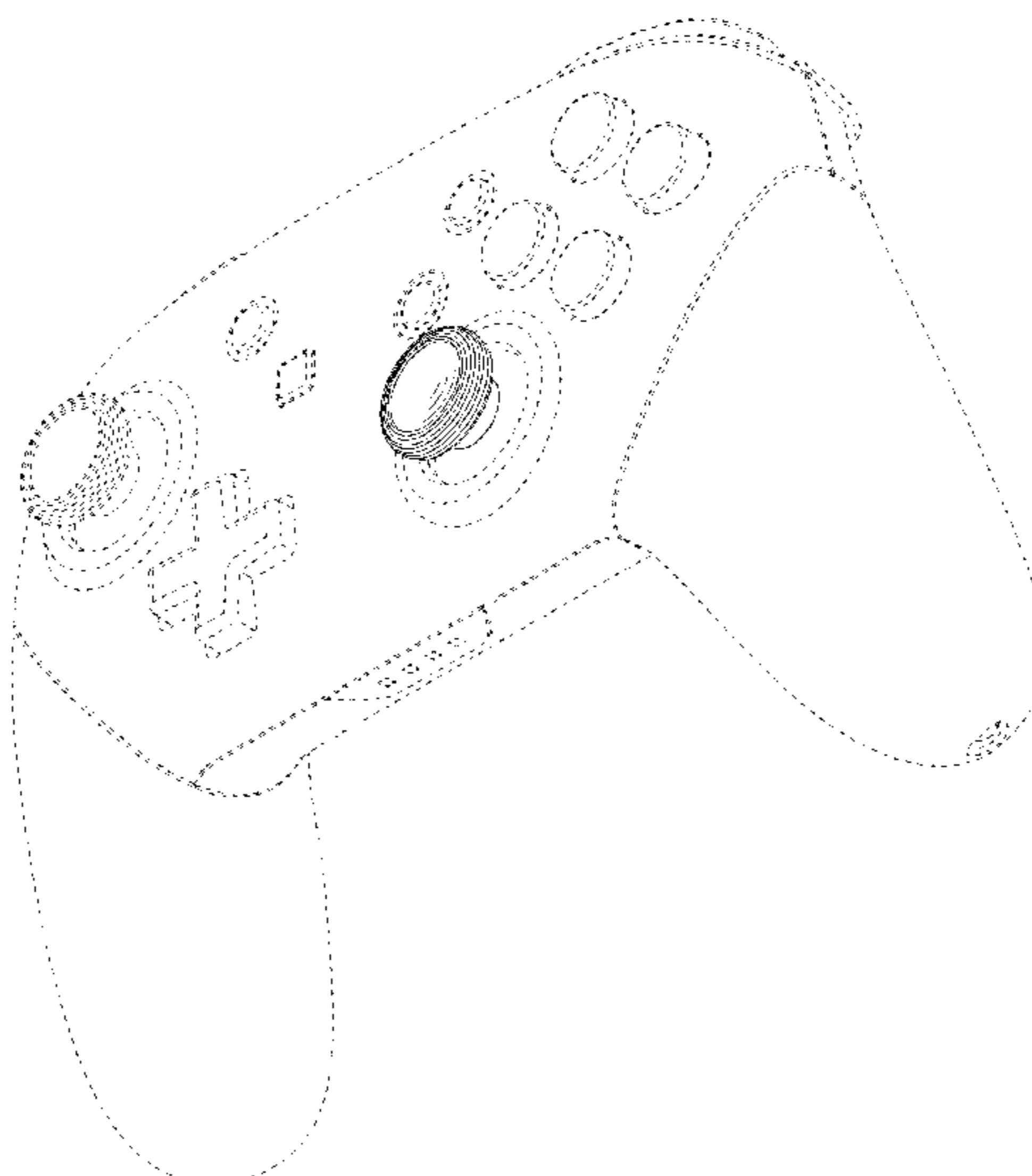

(58) **Field of Classification Search**
 CPC A63F 13/00; A63F 13/98; A63F 13/24;
 A63F 9/24; A63F 9/0291; A63F 9/00;
 A63F 2300/00; A63F 11/00; G06F 19/00
 See application file for complete search history.

(56) **References Cited**

U.S. PATENT DOCUMENTS

D409,692 S 5/1999 Deangelis
 5,923,317 A 7/1999 Sayler
 D445,859 S * 7/2001 Pitsenberger D21/725
 D487,466 S 3/2004 Yokota
 D521,015 S 5/2006 Hayes
 D523,105 S * 6/2006 Bernacchi D21/725
 D538,998 S * 3/2007 Henry D34/23
 7,235,017 B2 6/2007 Clemm
 D563,480 S 3/2008 Blaseflug
 D565,668 S 4/2008 Baseflug
 D568,546 S * 5/2008 Mehrabani D29/117.2
 D570,349 S 6/2008 Ashida
 D571,368 S 6/2008 Salter
 D571,806 S * 6/2008 Goto D14/401
 D581,422 S 11/2008 Hayes
 D590,900 S * 4/2009 Sass D21/725
 D594,515 S * 6/2009 Giblin D21/725
 D600,758 S * 9/2009 Sutherland D21/725
 D620,940 S * 8/2010 Claussen D14/401
 7,767,553 B2 8/2010 Tanaka
 D642,067 S * 7/2011 Azar D21/725
 D646,275 S 10/2011 Ikeda
 D652,463 S * 1/2012 Hoff D21/725
 D652,879 S * 1/2012 Vigness D21/725
 D658,179 S 4/2012 Ikeda
 D664,616 S * 7/2012 Page D21/725
 D668,307 S * 10/2012 Grimm D21/725
 D692,000 S 10/2013 Ibuki
 D692,001 S 10/2013 Ibuki
 D692,887 S 11/2013 Ibuki
 D693,345 S 11/2013 Ibuki
 D694,830 S 12/2013 Crowley
 D700,182 S 2/2014 Kidakarn
 D708,615 S 7/2014 Delrue
 D709,498 S 7/2014 Morris
 D709,499 S 7/2014 Morris
 D709,882 S 7/2014 Morris
 D711,880 S 8/2014 Bellinghausen
 D712,972 S 9/2014 Sumii
 D715,362 S * 10/2014 He D14/401
 D715,865 S 10/2014 Morris
 D726,726 S 4/2015 Bellinghausen
 D727,430 S 4/2015 Sumii
 9,017,168 B2 4/2015 Lee
 D733,140 S 6/2015 Sumii
 D740,825 S * 10/2015 Bellinghausen D14/401
 D745,607 S 12/2015 Jones
 D750,082 S 2/2016 Mar
 D754,128 S 4/2016 Bellinghausen
 D764,597 S * 8/2016 Kujawski D14/401
 D765,790 S 9/2016 Chatterjee
 D765,792 S 9/2016 Chatterjee

D766,376 S 9/2016 Kujawski
 D766,902 S 9/2016 Bellinghausen
 D767,038 S 9/2016 Kujawski
 D767,682 S 9/2016 Bellinghausen
 D768,785 S 10/2016 Kim
 D768,786 S 10/2016 Seflic
 D769,964 S 10/2016 Lu
 D773,561 S * 12/2016 Kujawski D14/401
 D777,843 S 1/2017 Kujawski
 D783,722 S 4/2017 Peng
 D784,987 S 4/2017 Kujawski
 D786,980 S 5/2017 Strahle
 D787,606 S 5/2017 Coe
 D794,129 S 8/2017 Kujawski
 D794,717 S 8/2017 Kujawski
 D795,350 S 8/2017 Chatterjee
 D795,961 S 8/2017 Chatterjee
 9,764,230 B2 9/2017 Gassoway
 D798,864 S 10/2017 Chen
 D798,954 S 10/2017 Chatterjee
 D799,599 S 10/2017 Kujawski
 D803,946 S * 11/2017 Matsuda D21/333
 D806,078 S 12/2017 Goldman
 D815,209 S * 4/2018 Chen D21/333
 D816,083 S 4/2018 Wu
 D816,170 S 4/2018 Chatterjee
 D816,674 S * 5/2018 Wu D14/401
 D819,641 S 6/2018 Tsuchiya
 D819,642 S * 6/2018 Ehara D14/401
 D823,945 S 7/2018 Falc
 D832,382 S * 10/2018 Van Nguyen D21/753
 D837,320 S * 1/2019 Griffith D21/757
 D839,361 S 1/2019 Lederer
 D845,395 S 4/2019 Strahle
 D847,265 S 4/2019 Chatterjee
 D847,903 S 5/2019 Chatterjee
 D847,904 S * 5/2019 Chatterjee D21/333
 D849,147 S 5/2019 Strahle
 D850,447 S 6/2019 Fulghum
 D853,384 S 7/2019 Fulghum
 D854,619 S 7/2019 Konishi
 D855,703 S 8/2019 Chatterjee
 2010/0298053 A1 11/2010 Kotkin

OTHER PUBLICATIONS

Design U.S. Appl. No. 29/645,660, filed Apr. 27, 2018, Tsuchiya et al.
 Design U.S. Appl. No. 29/645,664, filed Apr. 27, 2018, Tsuchiya et al.
 Design U.S. Appl. No. 29/645,669, filed Apr. 27, 2018, Tsuchiya et al.
 Design U.S. Appl. No. 29/645,672, filed Apr. 27, 2018, Tsuchiya et al.
 Design U.S. Appl. No. 29/645,674, filed Apr. 27, 2018, Tsuchiya et al.
 “Nintendo Switch Pro Controller”, posted Feb. 21, 2017 [online], [retrieved Sep. 27, 2019], 1 page. <https://www.youtube.com/watch?v=e-QV9puFbvo>.

* cited by examiner

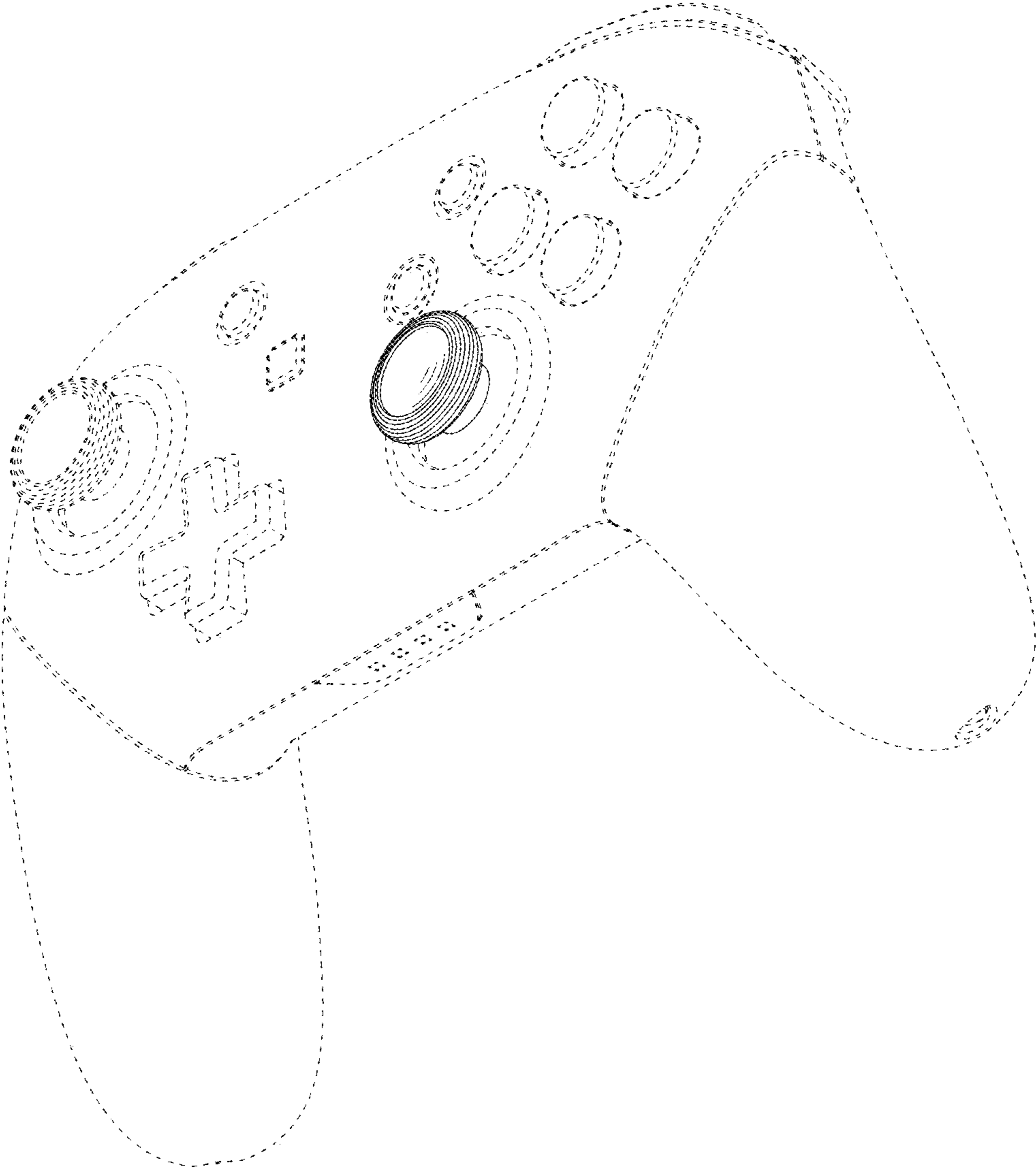

Fig. 1

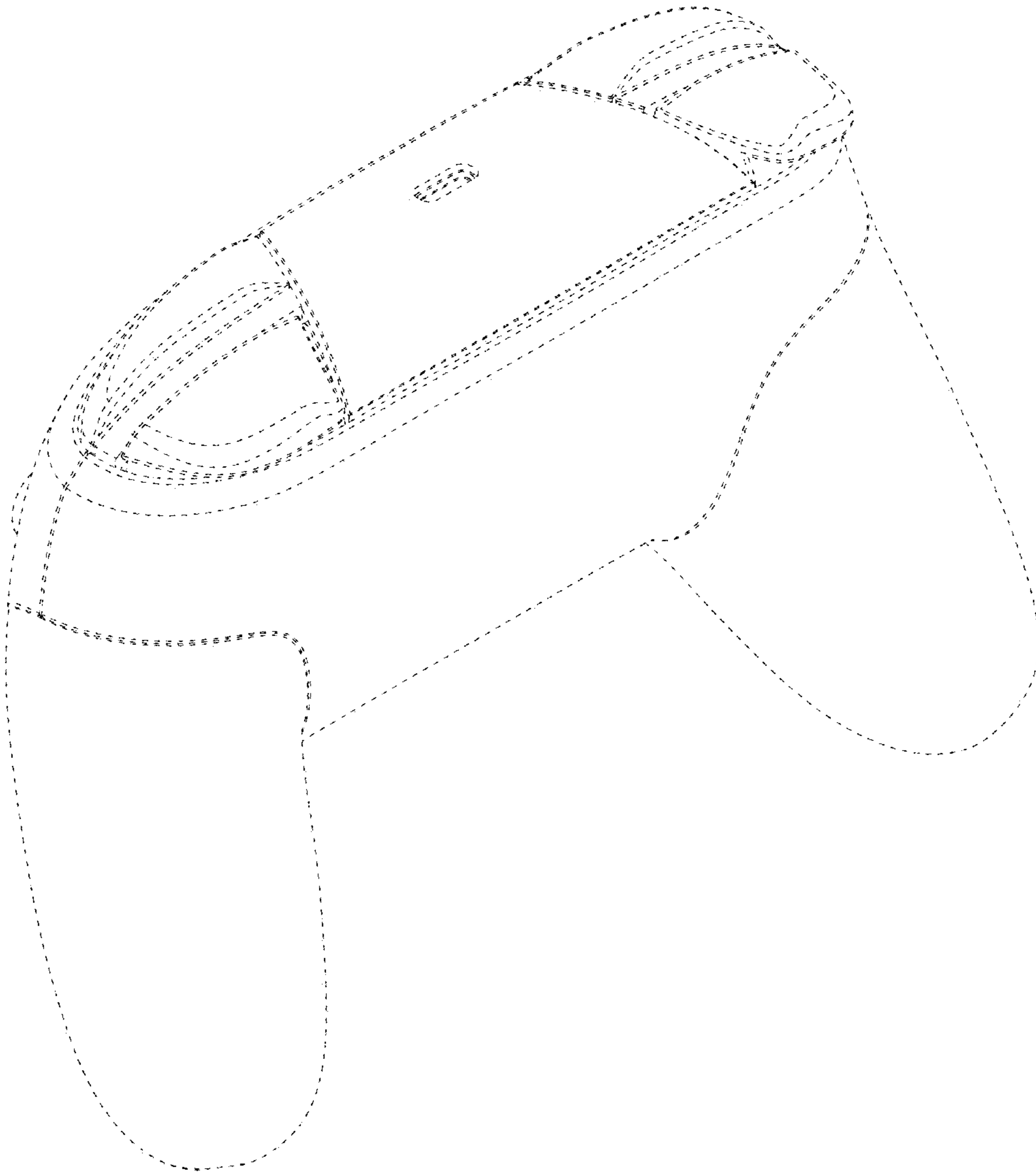

Fig. 2

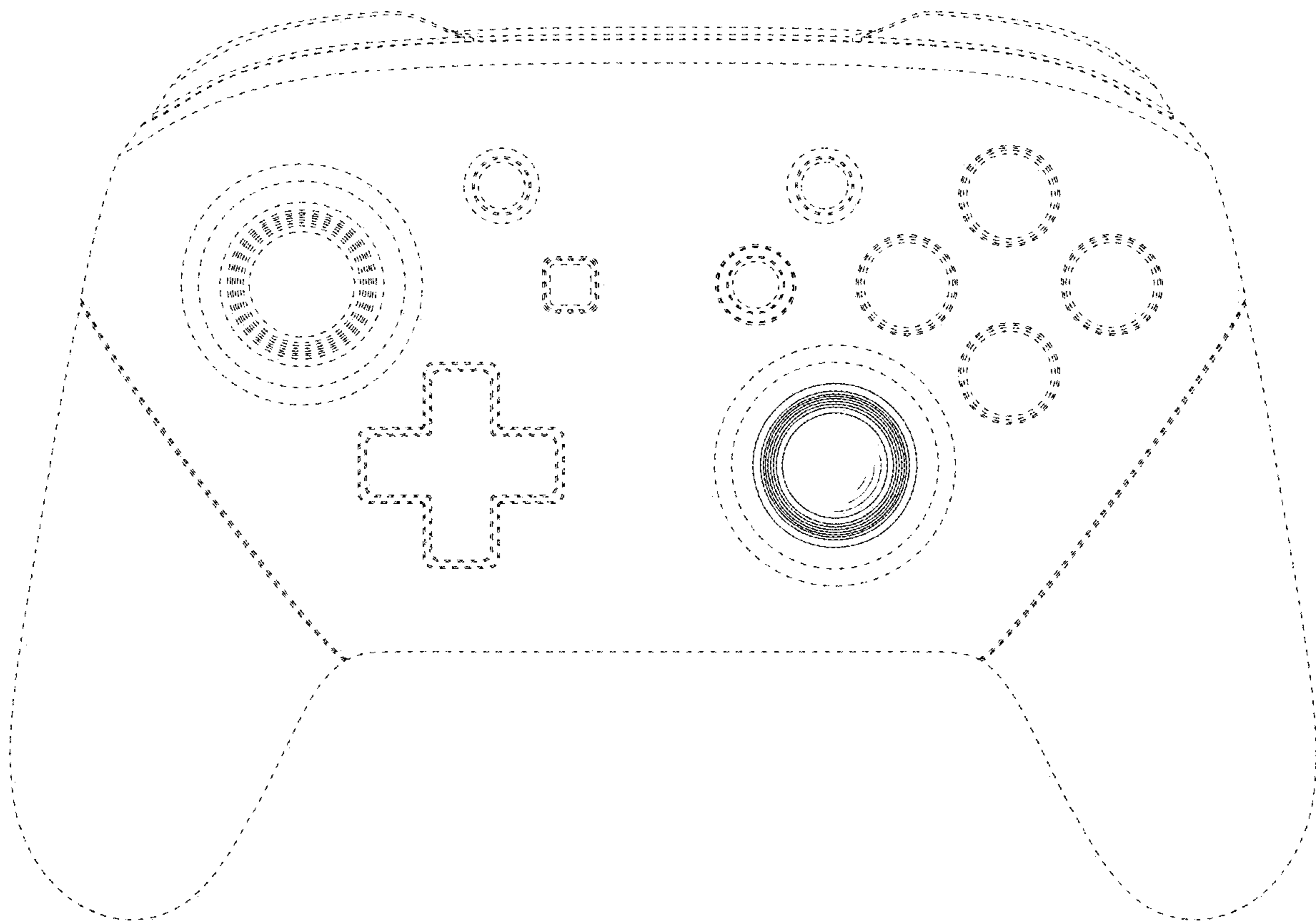

Fig. 3

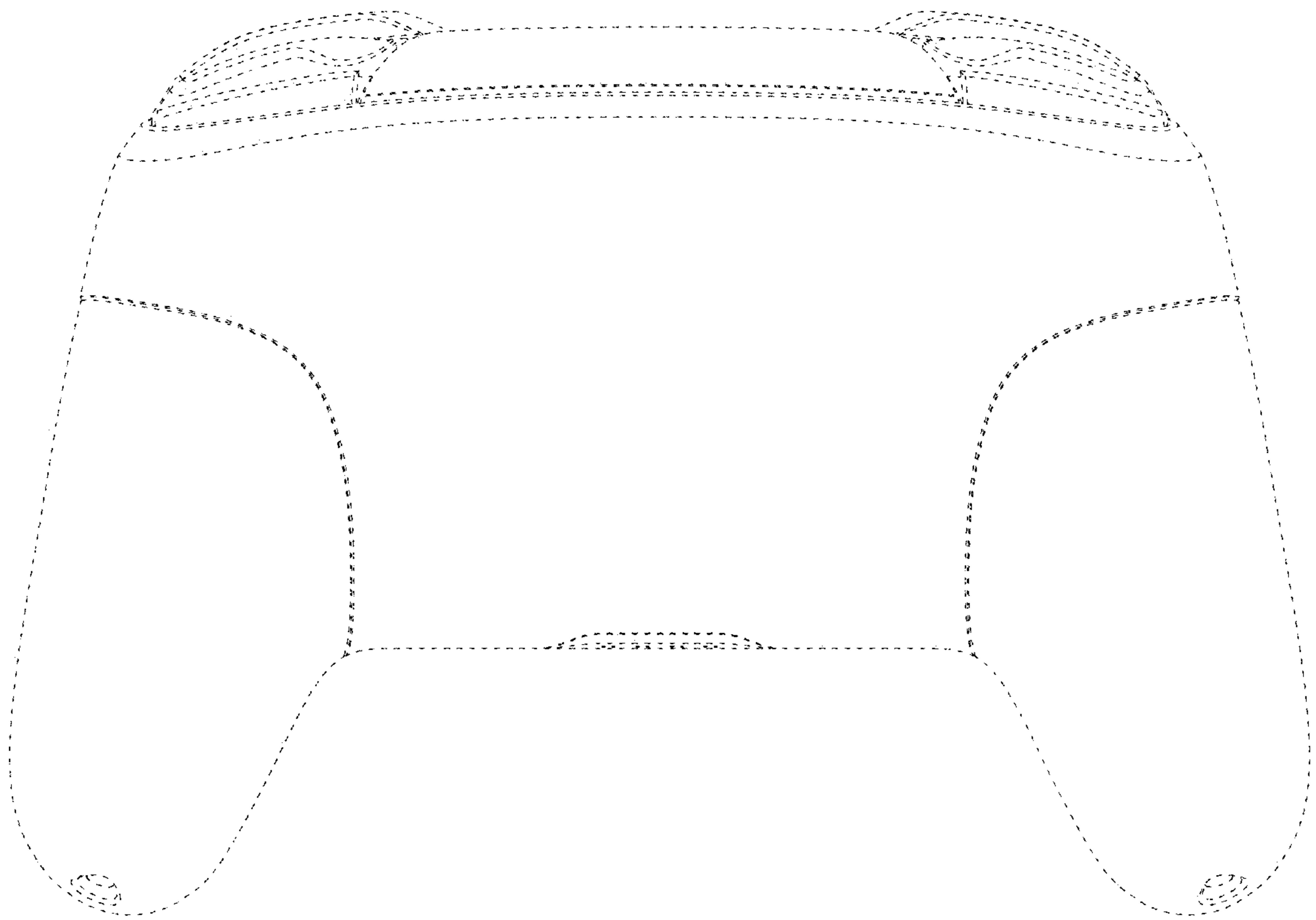

Fig. 4

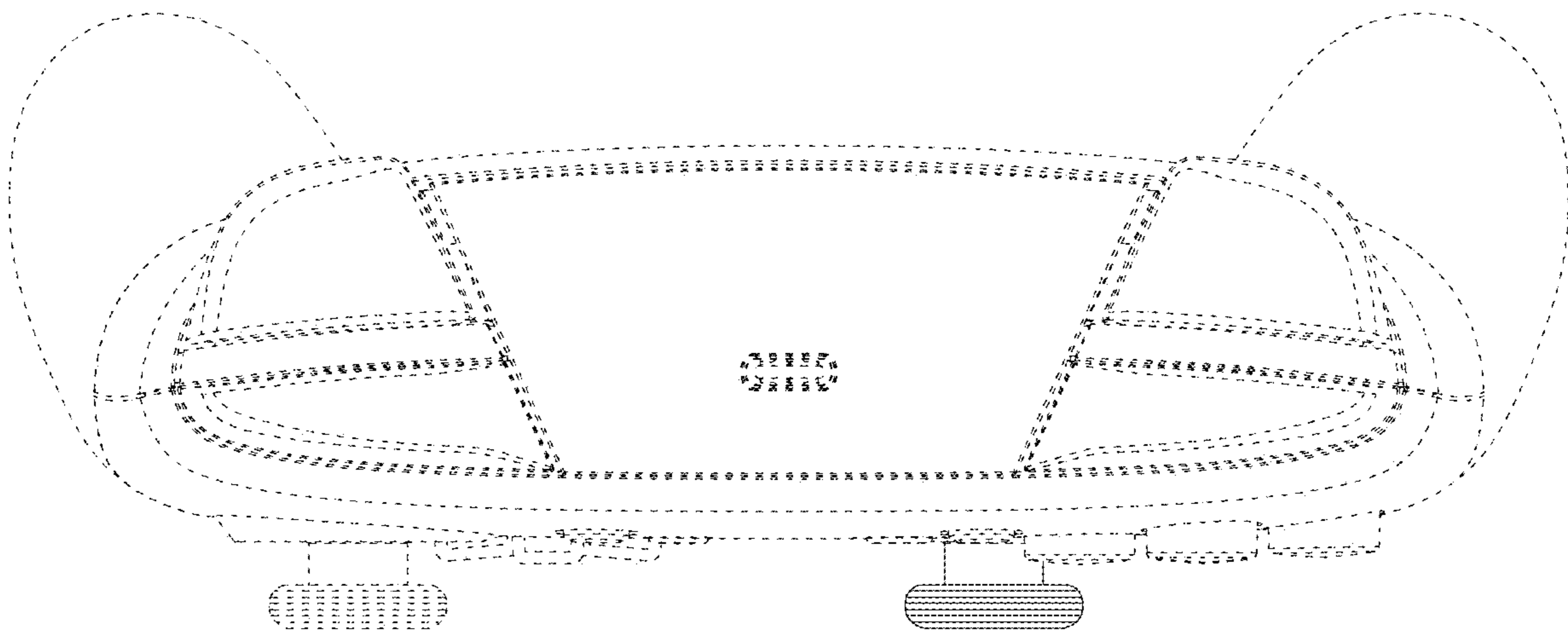

Fig. 5

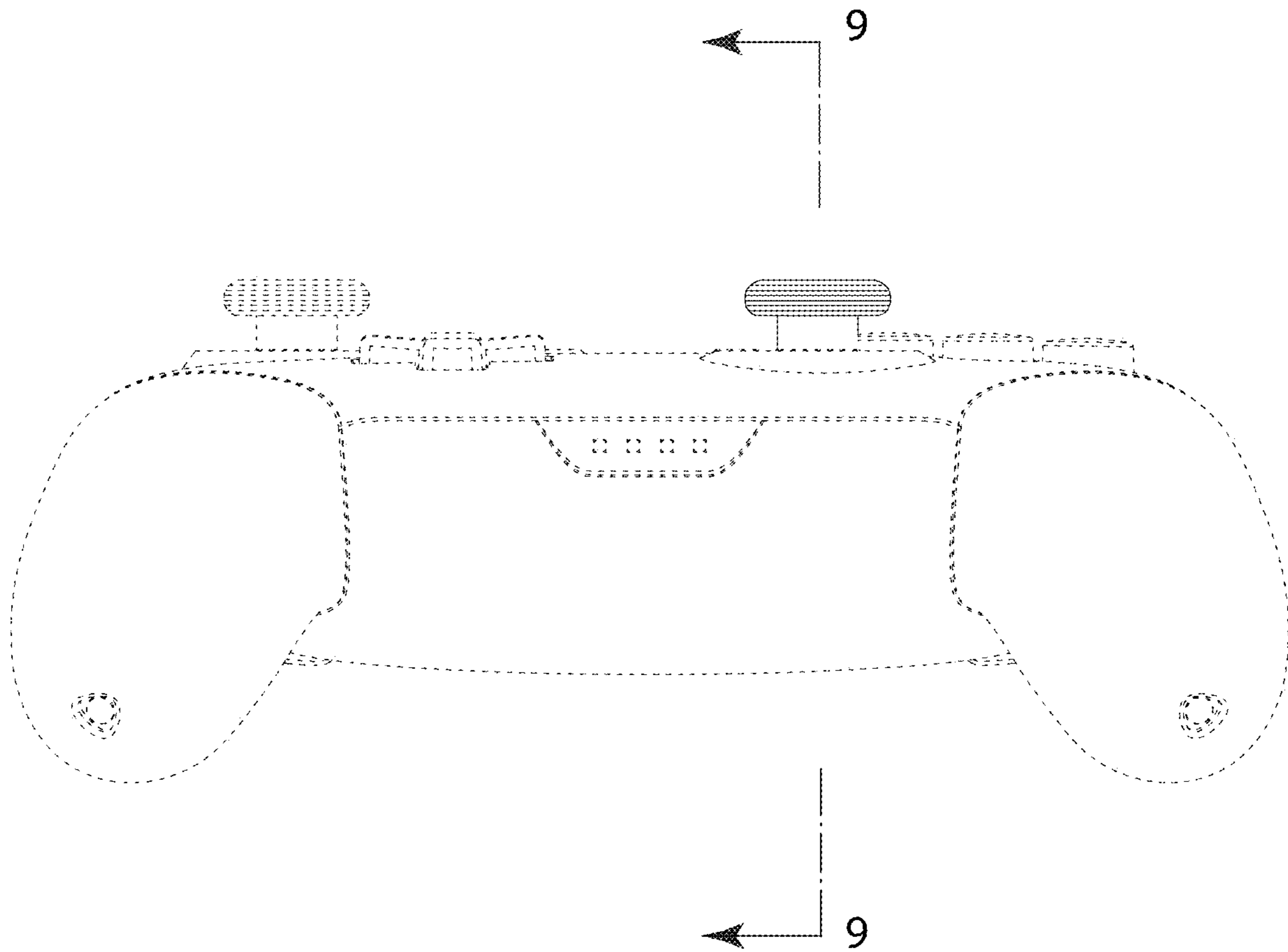

Fig. 6

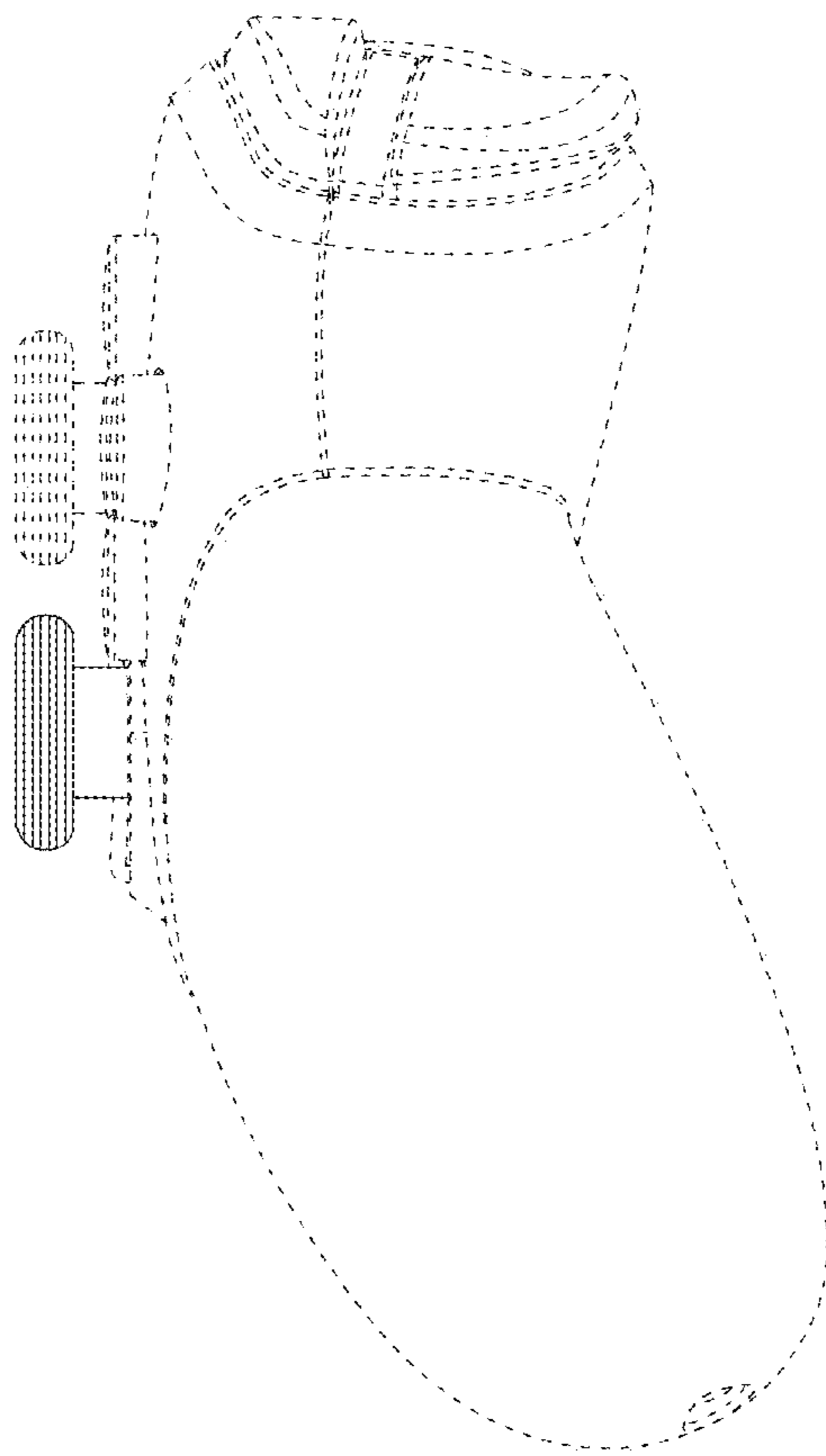

Fig. 7

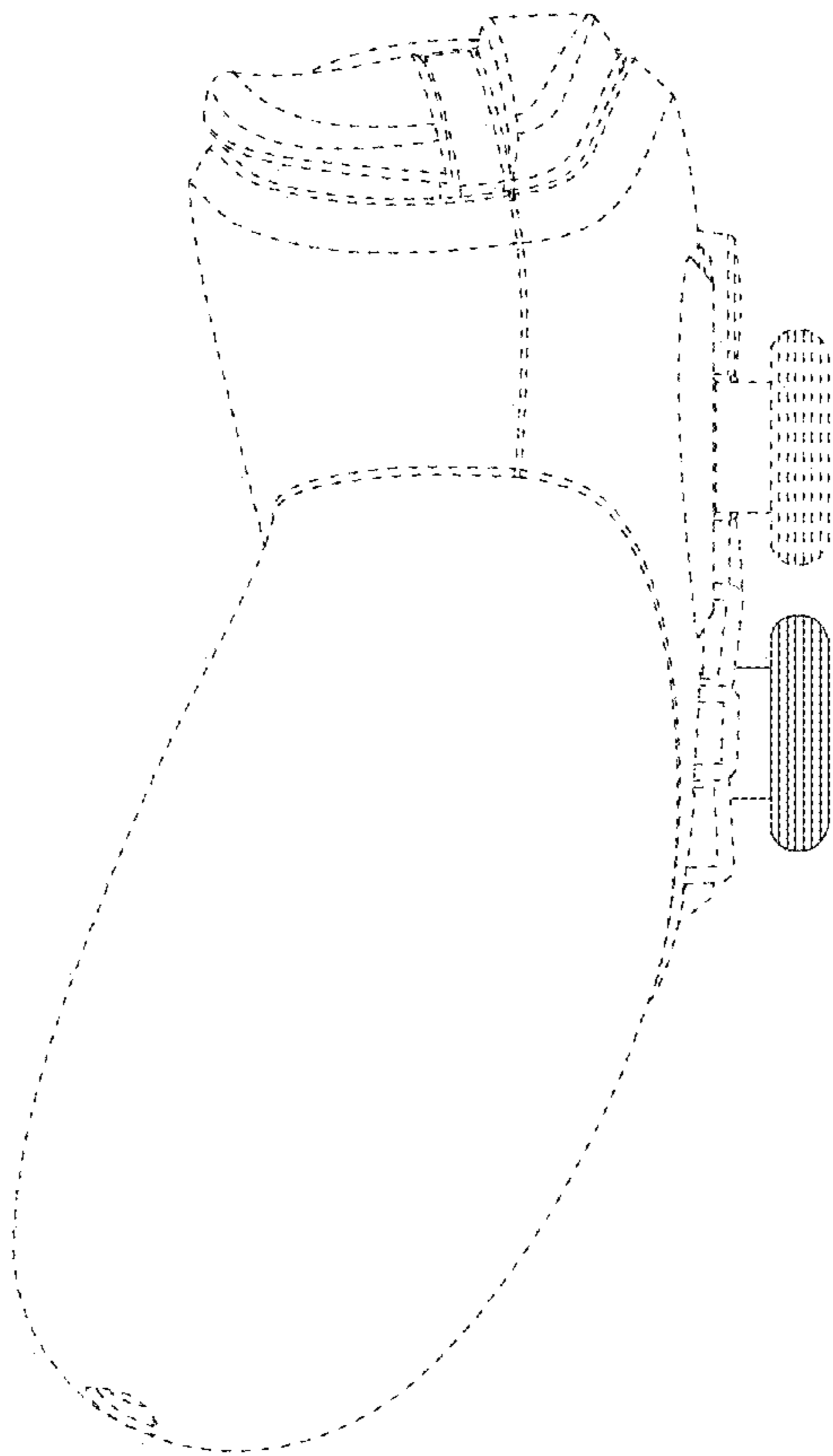

Fig. 8

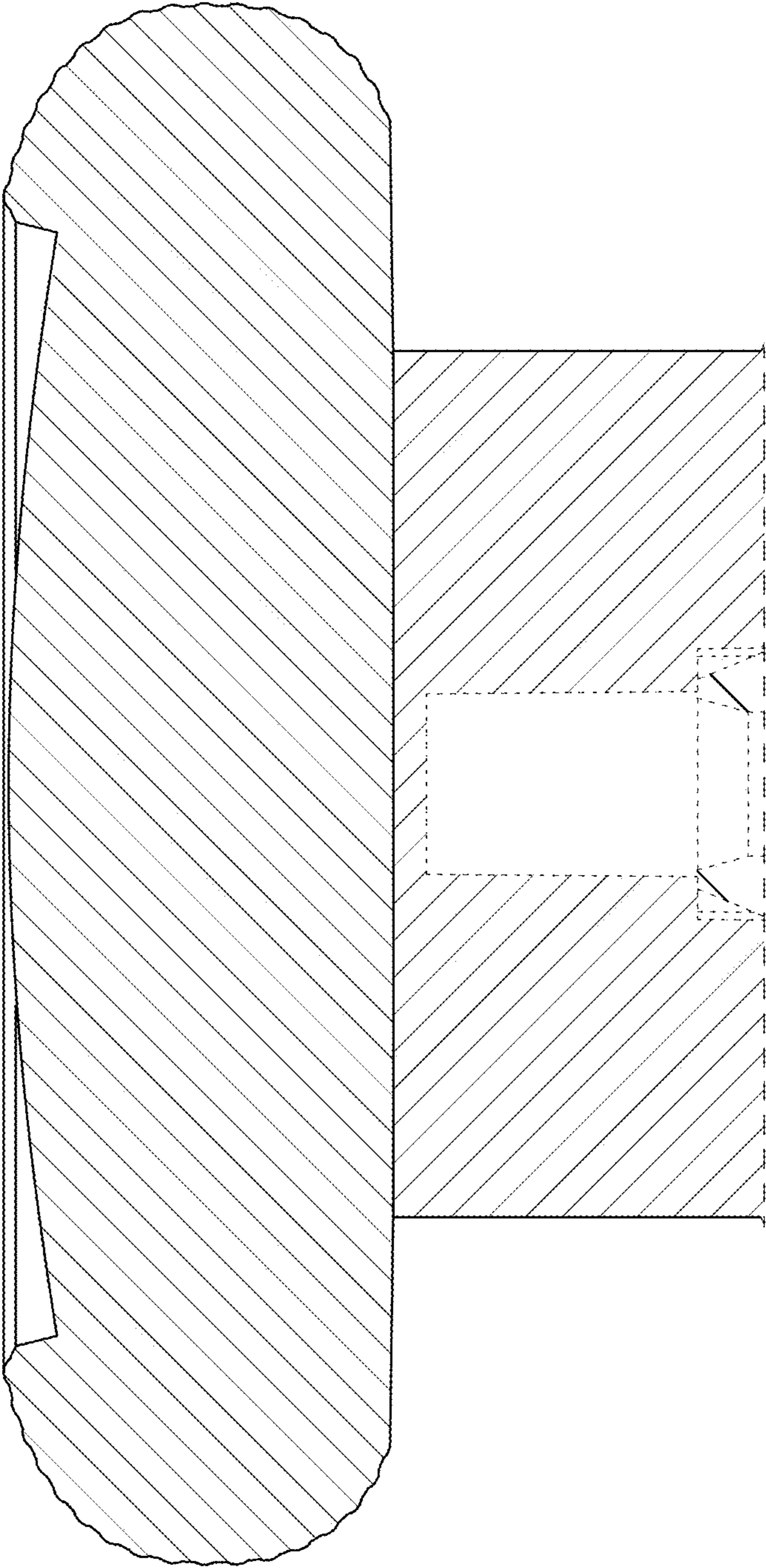

Fig. 9