



US00D882640S

(12) **United States Design Patent**
Estey

(10) **Patent No.:** **US D882,640 S**

(45) **Date of Patent:** **** Apr. 28, 2020**

(54) **ROBOTIC WEED EATER WHEEL**

D770,539 S * 11/2016 Mast D12/501
D782,391 S * 3/2017 Schaedler B60C 11/0311

(71) Applicant: **HUSQVARNA AB**, Huskvarna (SE)

D12/501
D792,333 S * 7/2017 Schaedler D12/501

(72) Inventor: **David Estey**, Huntersville, NC (US)

* cited by examiner

(73) Assignee: **Husqvarna AB**, Huskvarna (SE)

Primary Examiner — Mark A Goodwin

(**) Term: **15 Years**

(74) *Attorney, Agent, or Firm* — Burr & Forman LLP

(21) Appl. No.: **29/643,195**

(57) **CLAIM**

The ornamental design for the robotic weed eater wheel, as shown and described.

(22) Filed: **Apr. 5, 2018**

DESCRIPTION

(51) **LOC (12) Cl.** **15-03**

(52) **U.S. Cl.**

USPC **D15/17**; D12/204

(58) **Field of Classification Search**

USPC D15/10-31; D12/204, 207, 208-212, 400

CPC B60B 7/04; B60B 7/01; B60B 7/06; B60B

7/00; B60B 7/02; B60B 3/02; B60B 3/04;

B60B 3/06; B60B 3/10; B60B 1/00;

B60B 1/08; B60B 1/10; B60B 1/12

See application file for complete search history.

FIG. 1 is a perspective view of a robotic weed eater wheel in accordance with an embodiment of the present invention; FIG. 2 is a left side view of the robotic weed eater wheel of FIG. 1;

FIG. 3 is a right side view of the robotic weed eater wheel of FIG. 1;

FIG. 4 is a front view of the robotic weed eater wheel of FIG. 1;

FIG. 5 is a rear view of the robotic weed eater wheel of FIG. 1;

FIG. 6 is a top view of the robotic weed eater wheel of FIG. 1;

FIG. 7 is a bottom view of the robotic weed eater wheel of FIG. 1;

FIG. 8 is a view of the robotic weed eater wheel of FIGS. 2 and 3 in isolation; and,

FIG. 9 is a perspective view of the robotic weed eater wheel of FIGS. 2 and 3 in isolation.

The broken lines of the robotic weed eater wheel in FIGS. 1-9 are illustrative of the visible environmental structure of the robotic weed eater wheel and form no part of the claimed design.

(56) **References Cited**

U.S. PATENT DOCUMENTS

D225,989 S *	1/1973	Chadwick	D12/207
D325,011 S *	3/1992	Markling	D12/210
D328,053 S *	7/1992	Markling	D12/501
D414,724 S *	10/1999	Lu	D12/501
D466,962 S *	12/2002	Chen	D21/779
D530,726 S *	10/2006	Martin	D15/17
D679,294 S *	4/2013	Tajik	D15/14
D679,295 S *	4/2013	Tajik	D15/14
D688,276 S *	8/2013	Naslund	D15/14
D745,897 S *	12/2015	Mehra	D15/14
D758,455 S *	6/2016	Maibach	D15/14
D760,806 S *	7/2016	Cmich	D15/14

1 Claim, 8 Drawing Sheets

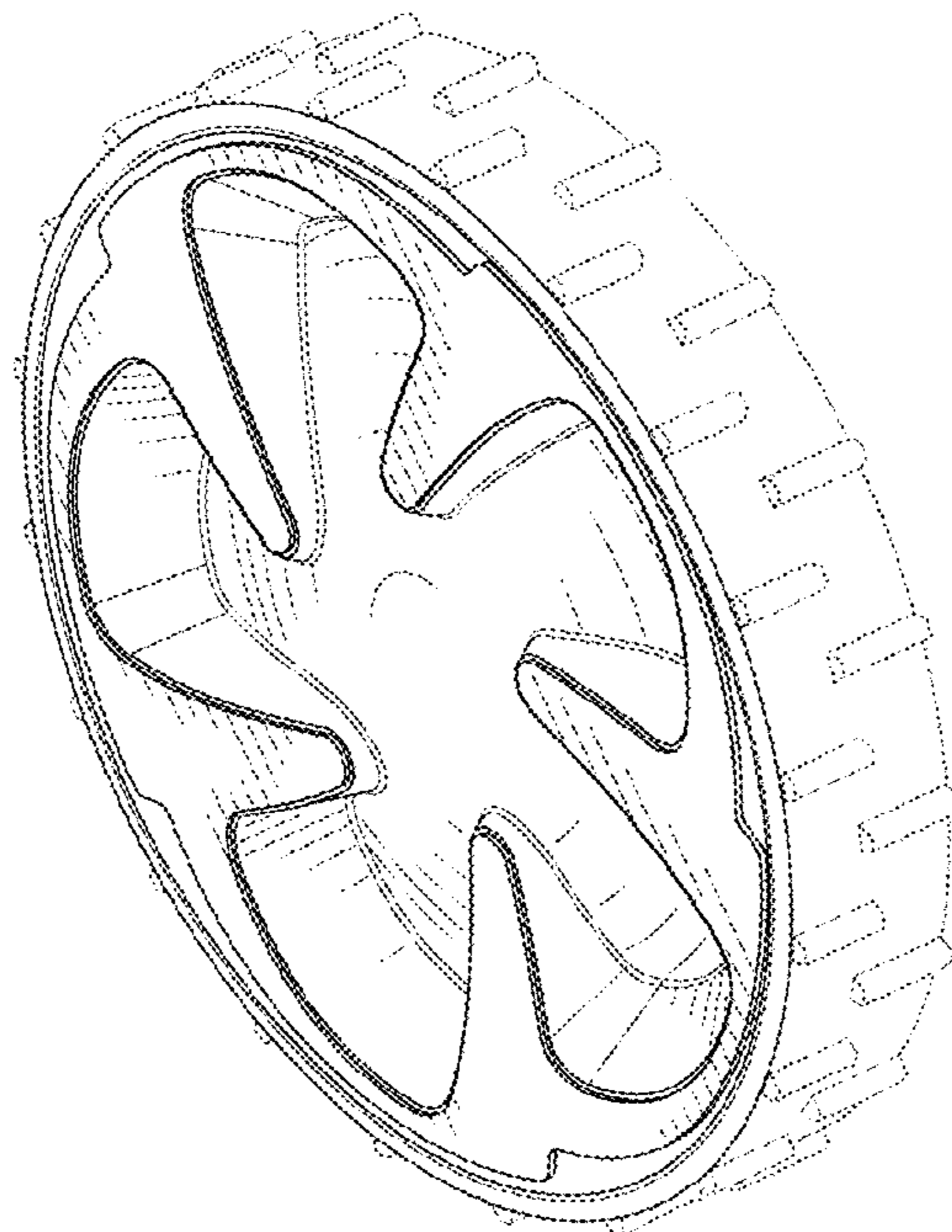



FIG. 1

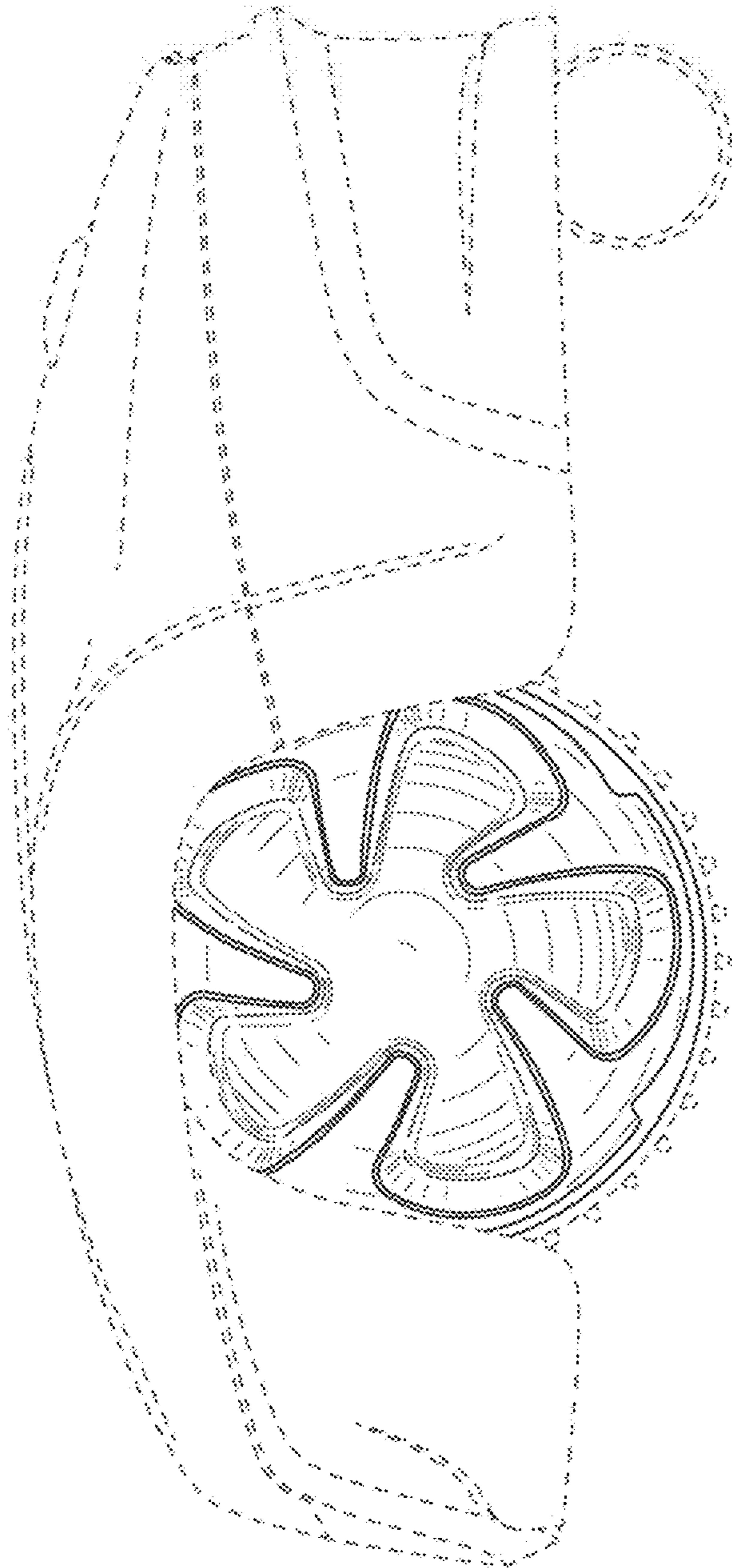

FIG. 2

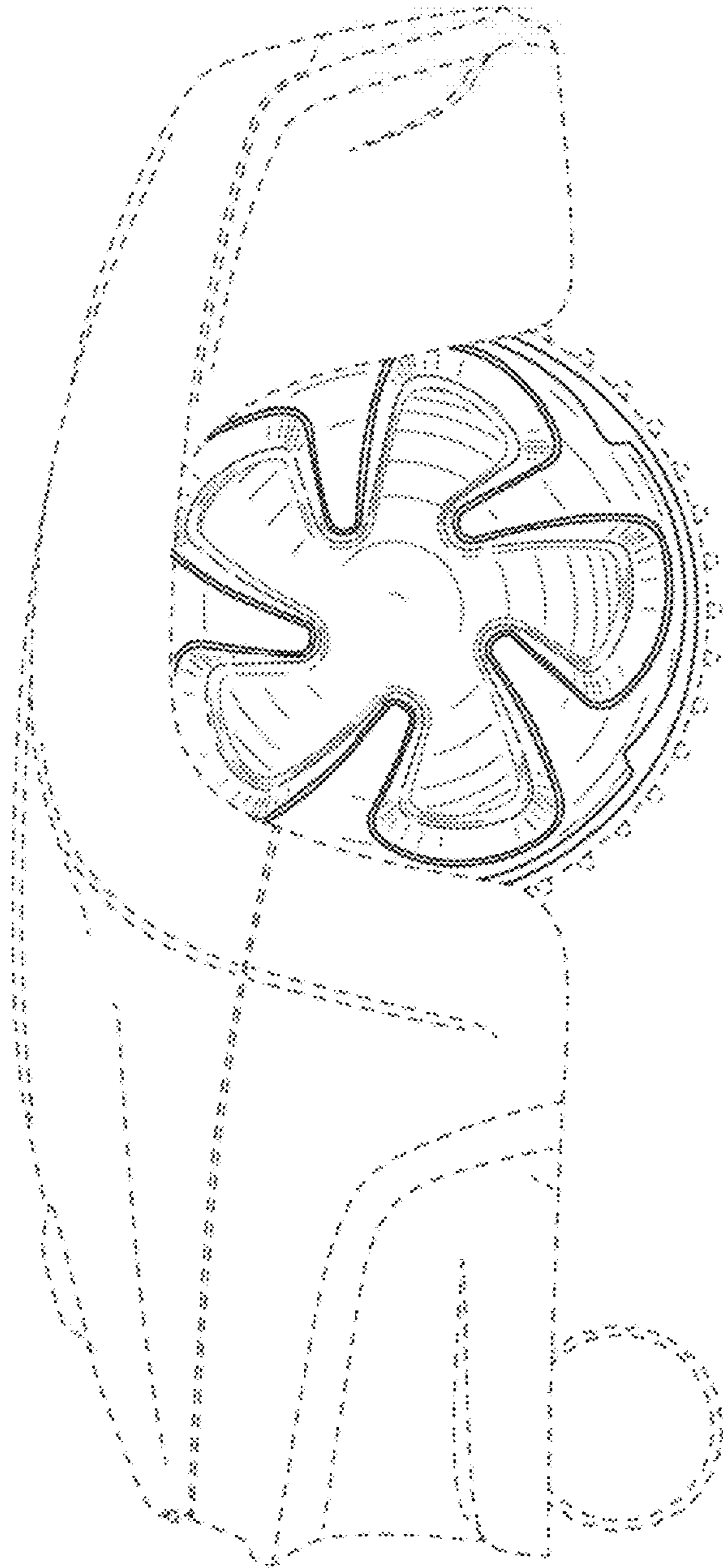

FIG. 3

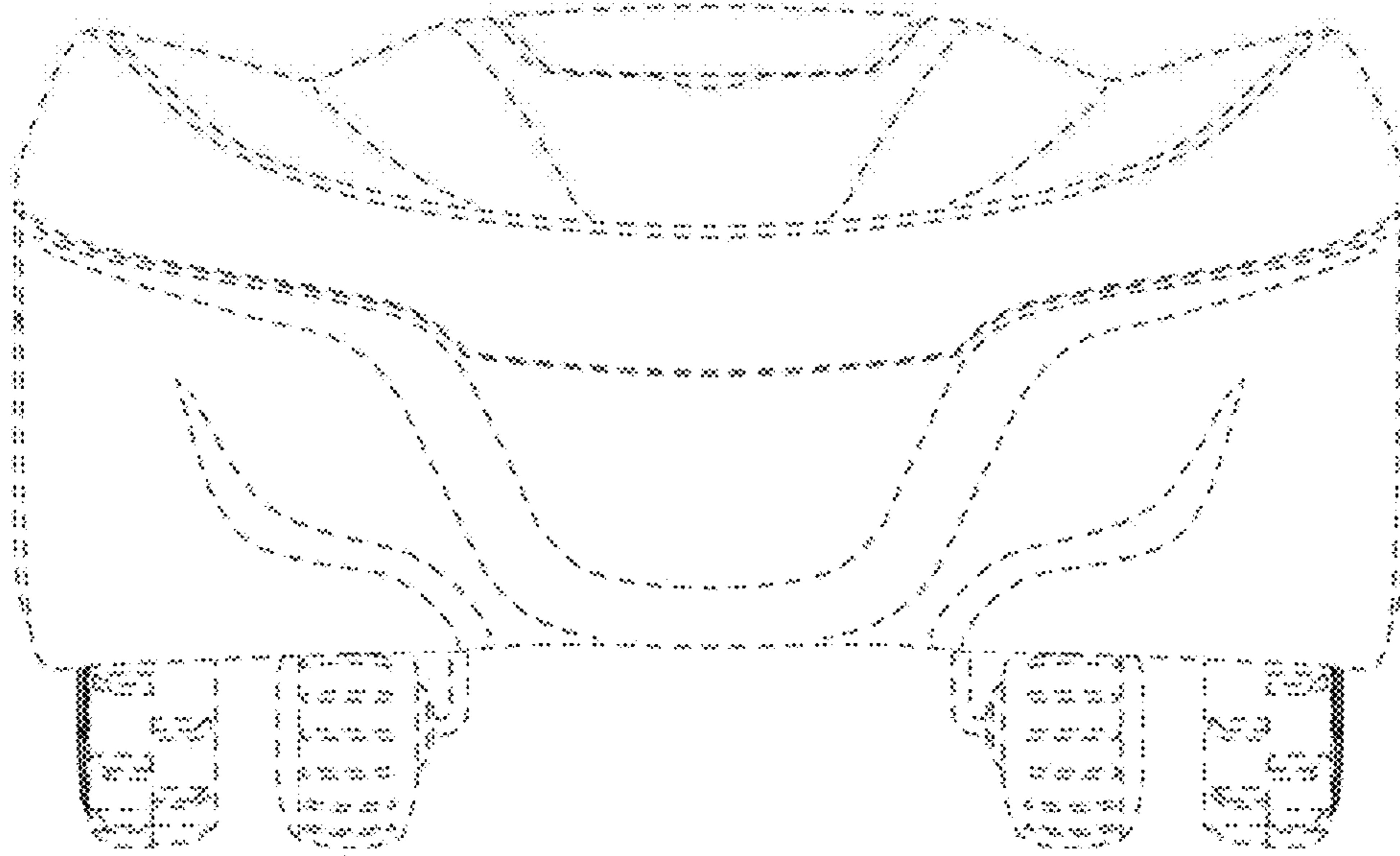

FIG. 4

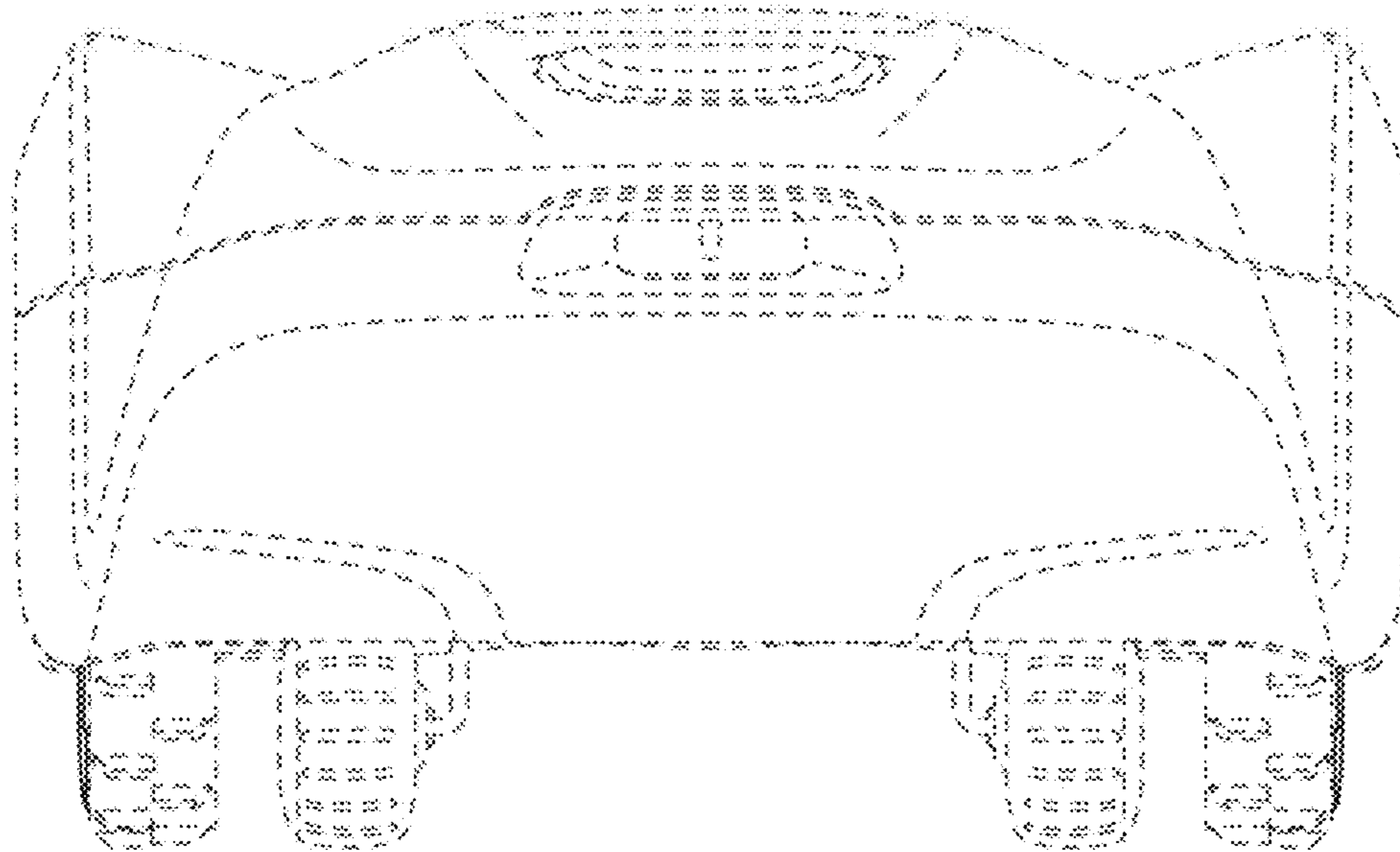

FIG. 5

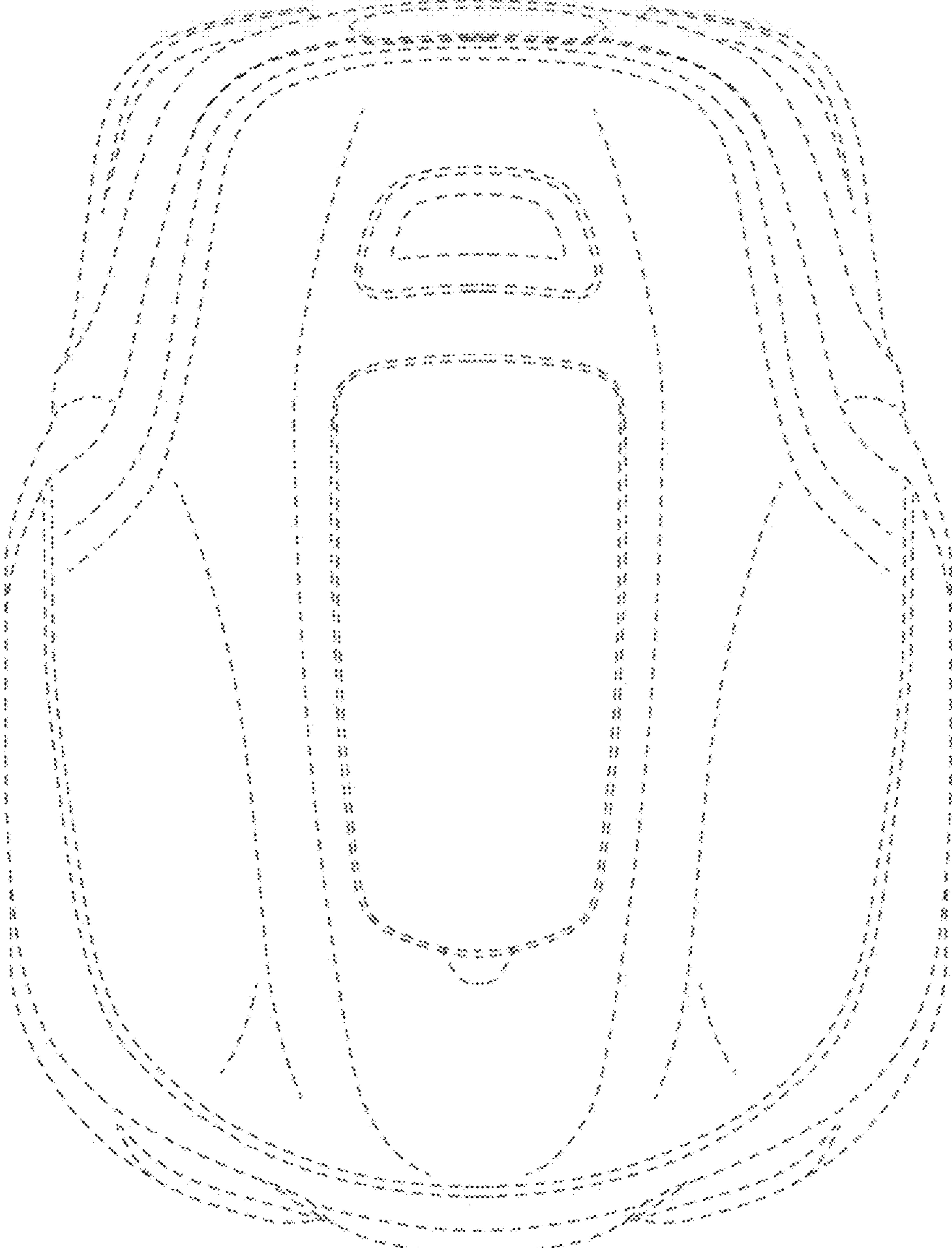

FIG. 6

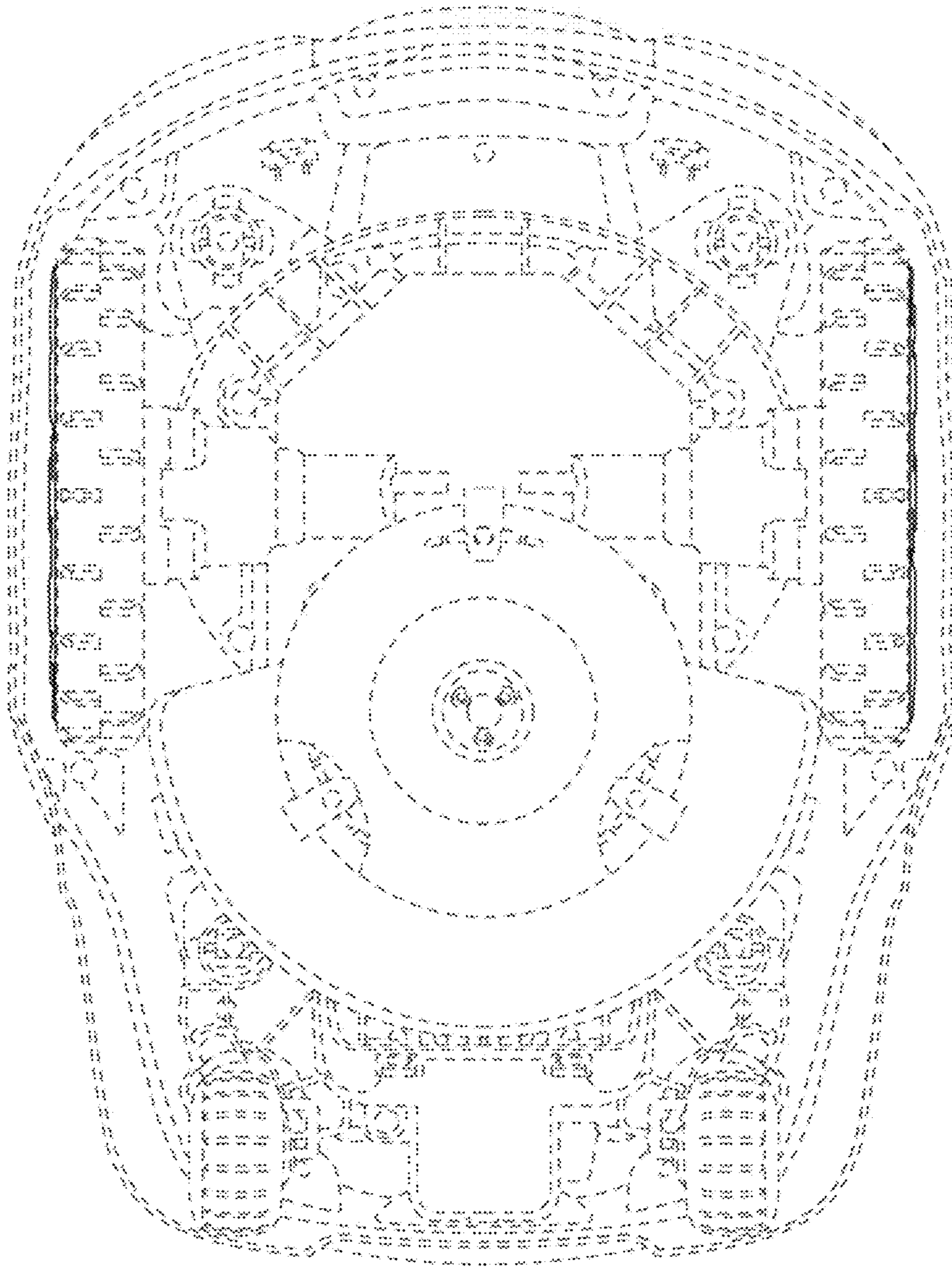

FIG. 7

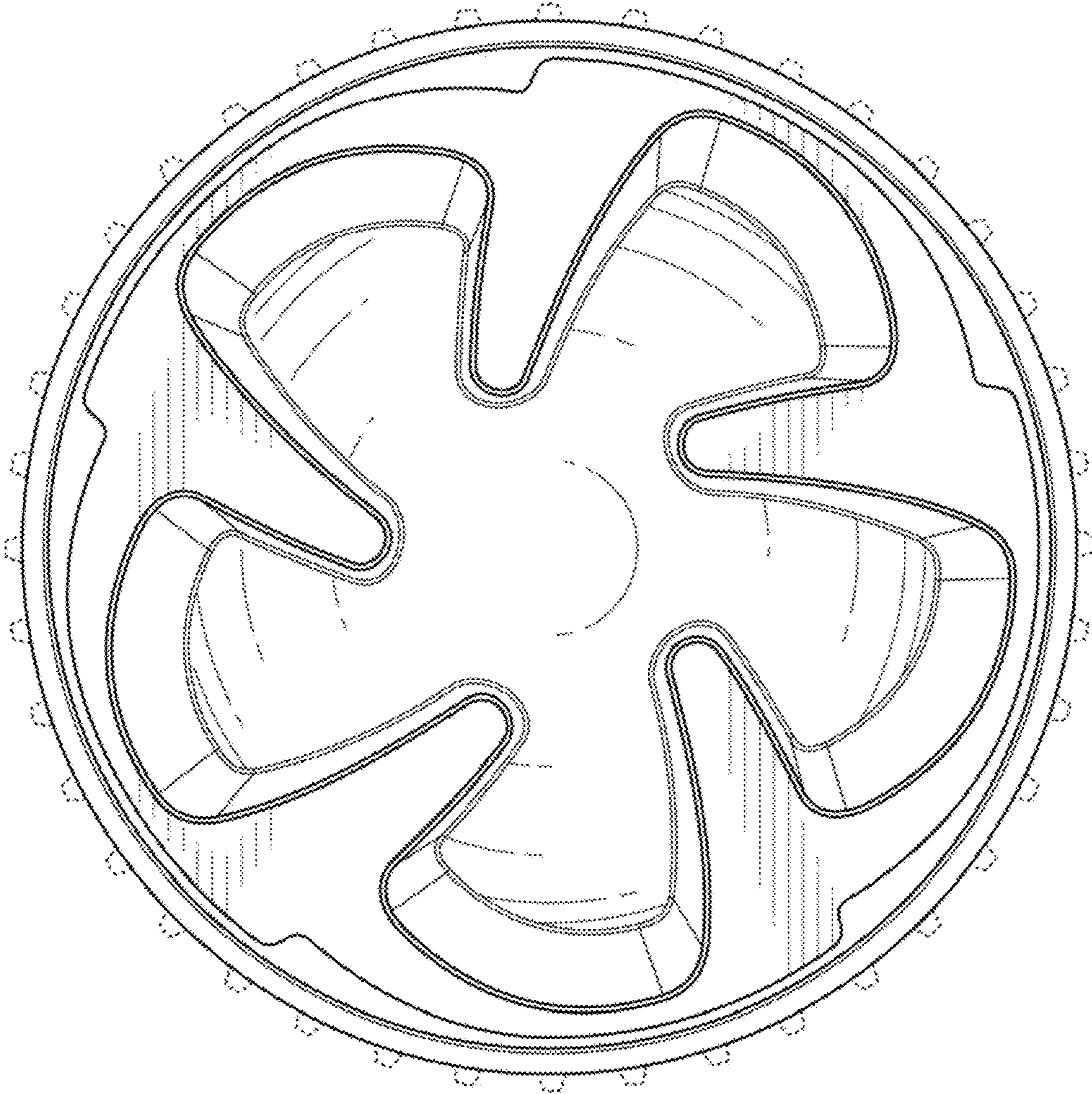

FIG. 8

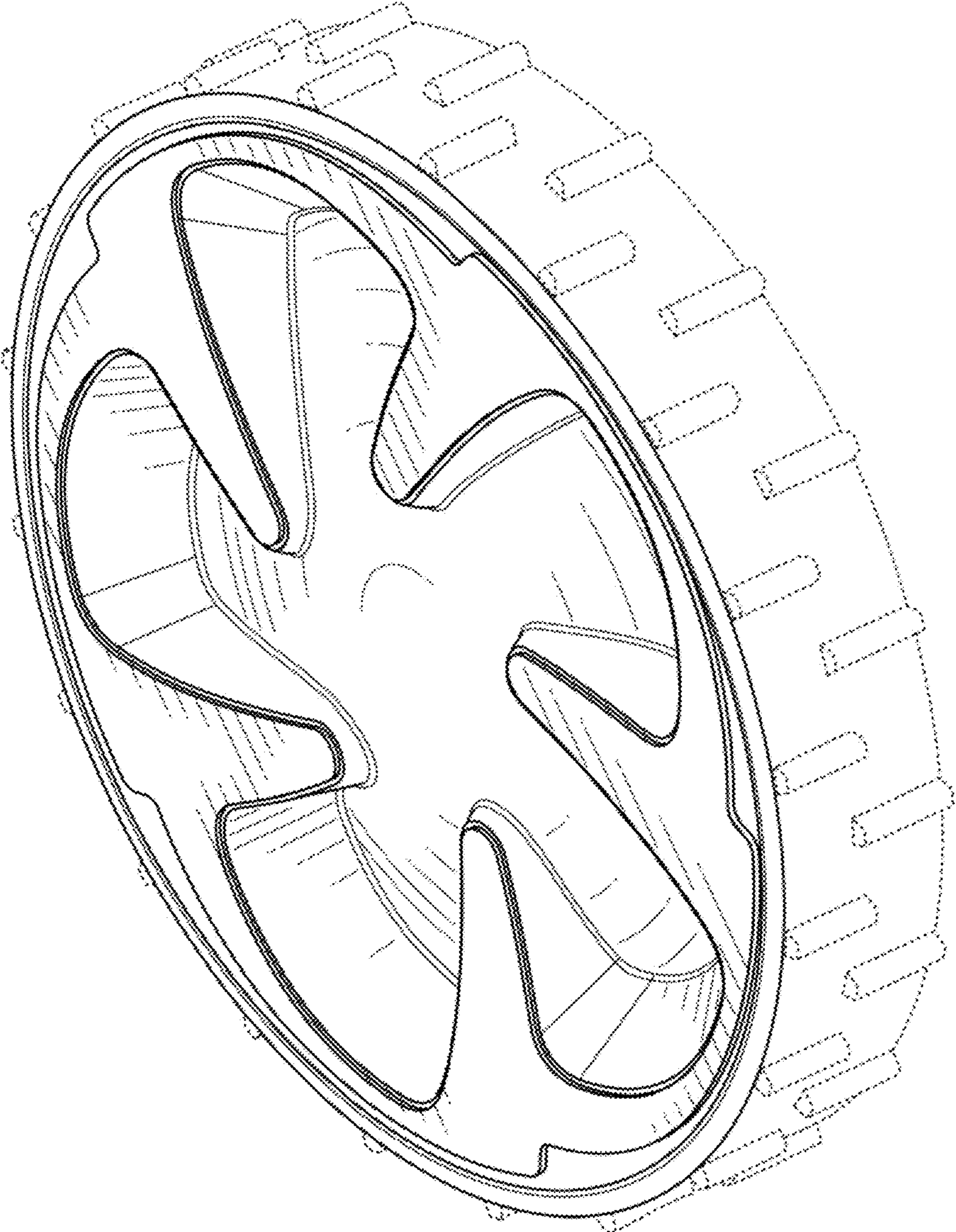

FIG. 9