



US00D882196S

(12) **United States Design Patent**
Lee et al.

(10) **Patent No.:** **US D882,196 S**
(45) **Date of Patent:** **** Apr. 21, 2020**

(54) **BRUSH FOR CLEANER**

D796,136 S * 8/2017 Reynolds D32/33
D828,968 S * 9/2018 Tokoi D32/32
D846,821 S * 4/2019 Palladino D32/32

(71) Applicant: **Samsung Electronics Co., Ltd.**,
Suwon-si (KR)

FOREIGN PATENT DOCUMENTS

(72) Inventors: **Hwandong Lee**, Seoul (KR);
Hyungsub Choi, Goyang-si (KR)

CN 304572369 4/2018
EM 0029045080016 7/2016
KR 300958504 5/2018
KR 3009617790005 7/2018

(73) Assignee: **SAMSUNG ELECTRONICS CO., LTD.**, Gyeonggi-Do (KR)

OTHER PUBLICATIONS

(**) Term: **15 Years**

Internet Newspaper, Posted Apr. 3, 2018, pp. 1-3, Retrieved from the Internet Sep. 10, 2018 <URL:http://www.ekn.kr/news/article_print.html?no=353392>.

(21) Appl. No.: **29/675,194**

* cited by examiner

(22) Filed: **Dec. 28, 2018**

(30) **Foreign Application Priority Data**

Primary Examiner — Ruth McInroy

Aug. 29, 2018 (KR) 30-2018-0040344

(74) *Attorney, Agent, or Firm* — Cantor Colburn LLP

(51) **LOC (12) Cl.** **15-05**

(57) **CLAIM**

(52) **U.S. Cl.**
USPC **D32/33**

The ornamental design for a brush for cleaner, as shown and described.

(58) **Field of Classification Search**

DESCRIPTION

USPC D32/17, 31-34, 19-20, 22, 25, 40, 50
CPC . A47L 9/02; A47L 9/04; A47L 9/0461; A47L
5/26; A47L 5/28; A47L 11/4044
See application file for complete search history.

FIG. 1 is a front perspective view of a brush for cleaner, showing our new design;
FIG. 2 is a front view thereof;
FIG. 3 is a rear view thereof;
FIG. 4 is a left-side view thereof;
FIG. 5 is a right-side view thereof;
FIG. 6 is a top view thereof; and,
FIG. 7 is a bottom view thereof.

(56) **References Cited**

The dot-dash broken lines in the figures represent a boundary of the claimed design and form no part of the claimed design. The broken lines illustrating portions of the brush for cleaner form no part of the claimed design.

U.S. PATENT DOCUMENTS

D585,167 S 1/2009 Wishney
D649,725 S * 11/2011 Fjellman D32/32
D686,379 S * 7/2013 Kim D32/32
D762,031 S * 7/2016 Niedzwecki D32/32
D770,711 S * 11/2016 Okada D32/32
D775,443 S * 12/2016 Kwon D32/33
D779,752 S * 2/2017 Johnson D32/32

1 Claim, 5 Drawing Sheets

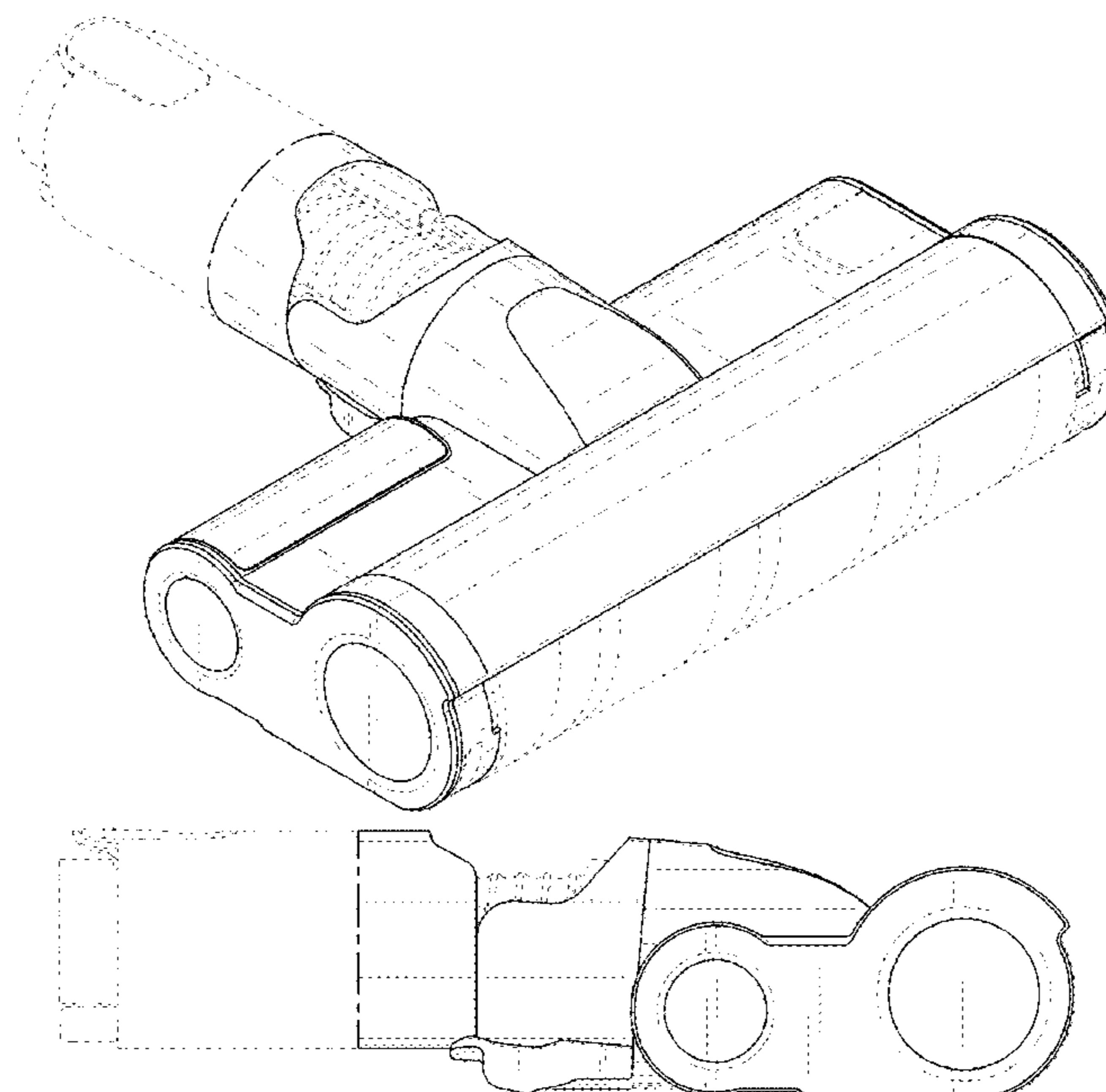

FIG. 1

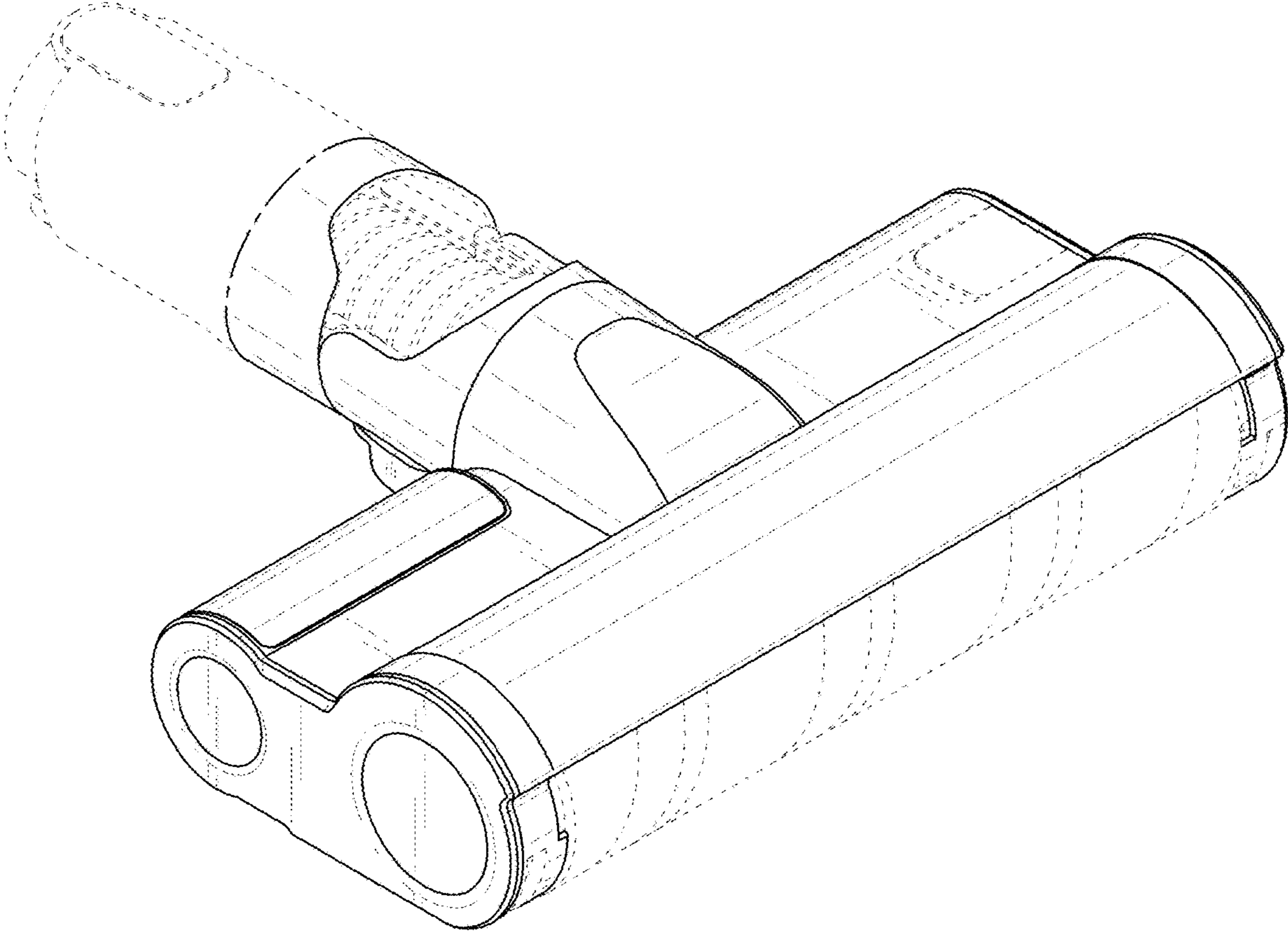

FIG. 2

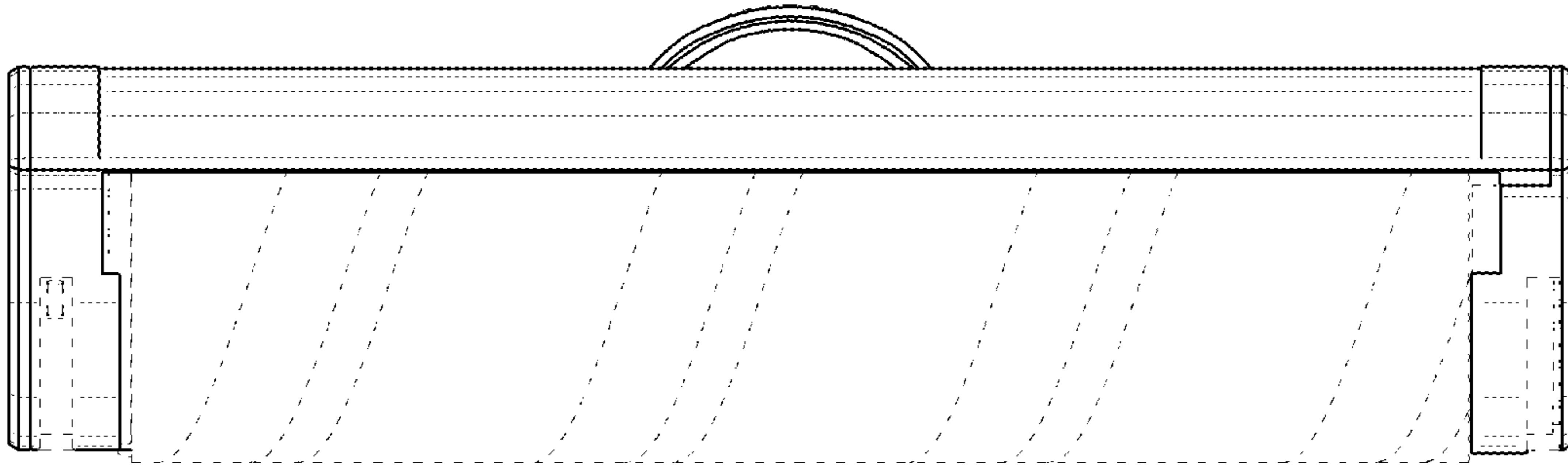

FIG. 3

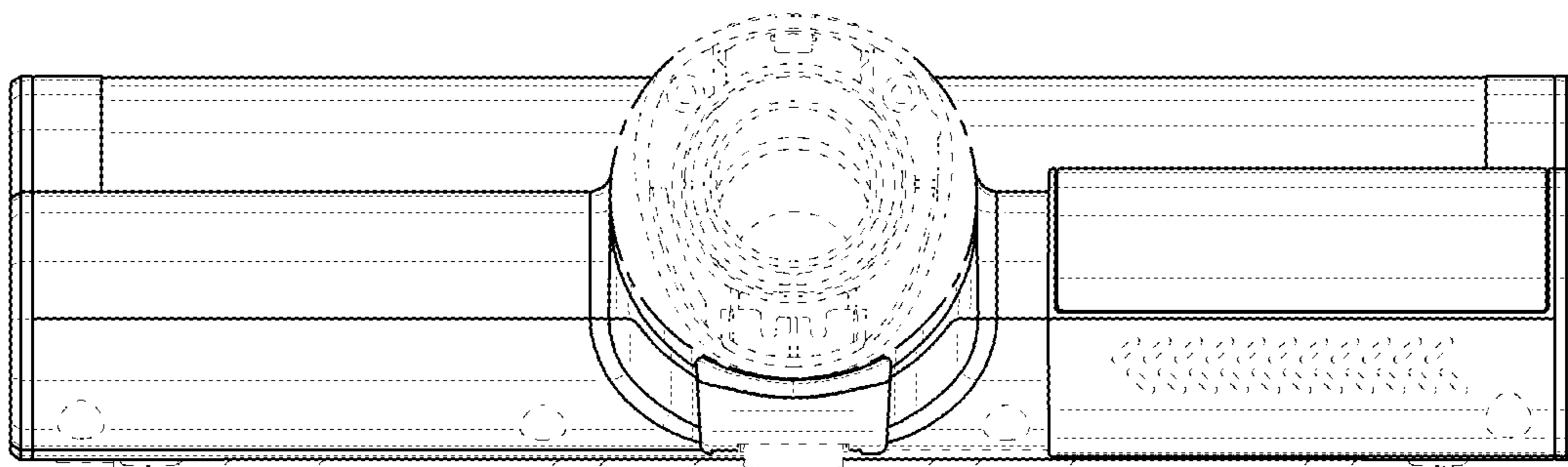

FIG. 4

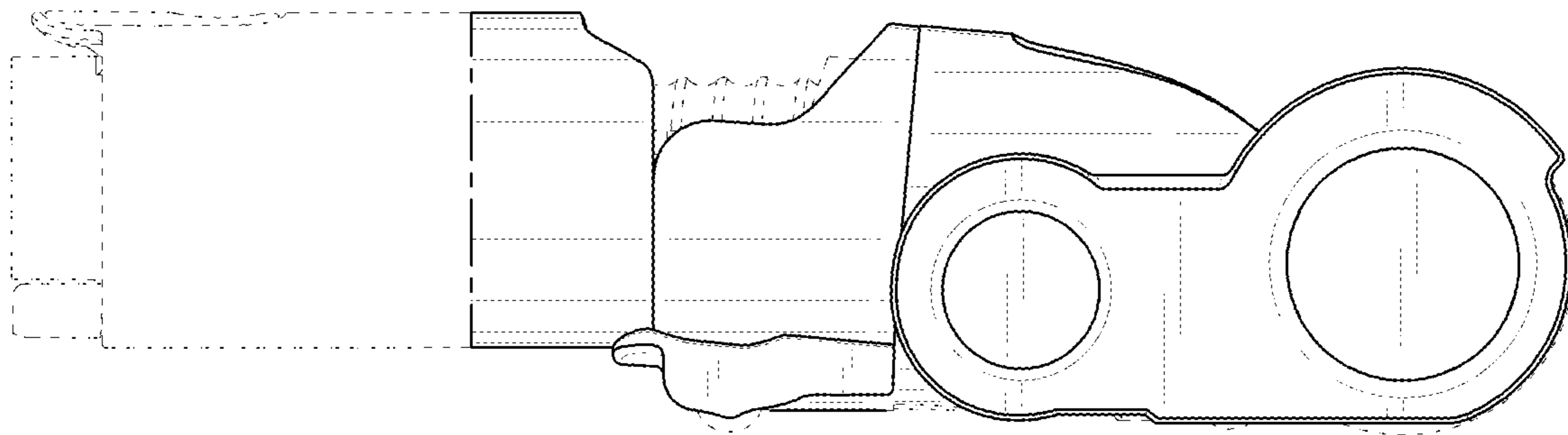

FIG. 5

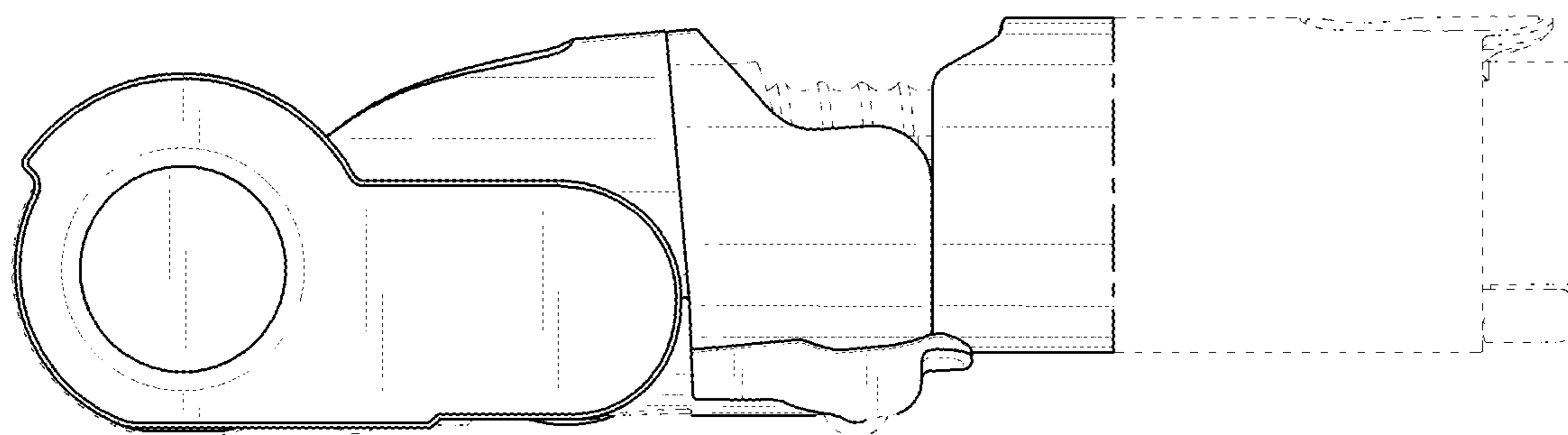

FIG. 6

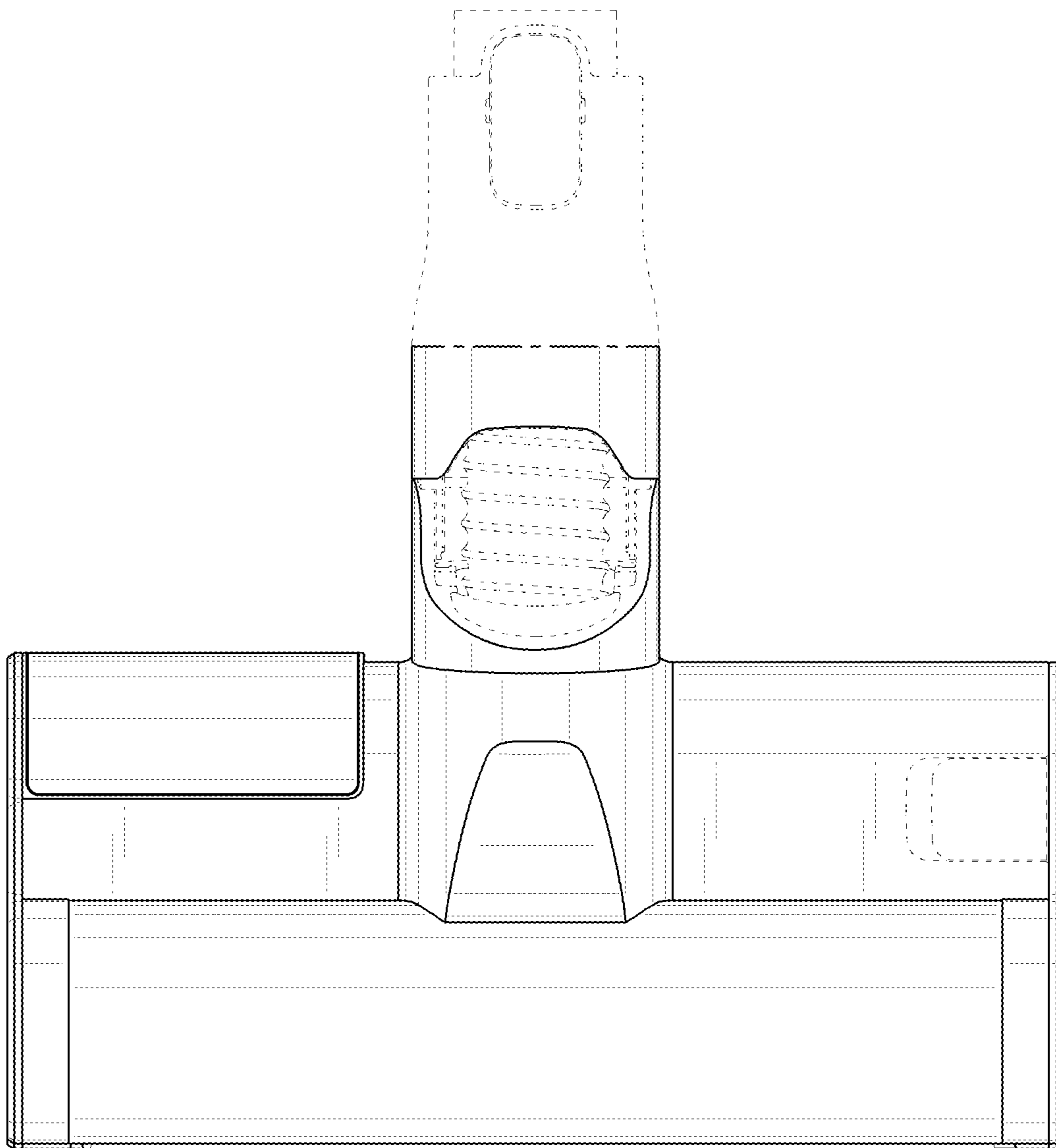

FIG. 7

