



US00D881413S

(12) **United States Design Patent**
Gill et al.

(10) **Patent No.:** **US D881,413 S**
(45) **Date of Patent:** **** Apr. 14, 2020**

(54) **CORROSION CONTROL FACILITY**

FOREIGN PATENT DOCUMENTS

(71) Applicant: **KwikSpace Guam, Inc.**, Hagatna, GU (US)

CN 102003082 * 4/2011 E04B 1/3483
DE 102014118561 A1 * 6/2016 E04H 1/1244

(72) Inventors: **Peter E. Gill**, Tamuning, GU (US);
Peter E. Gill, III, Tamuning, GU (US)

OTHER PUBLICATIONS

(73) Assignee: **KWIKSPACE GUAM**, Hagatna, GU (US)

Tafline Layline, The Farmery is a Farm and Market Set in Four Recycled Shipping Containers in North Carolina, Oct. 17, 2012, inhabit.com, <https://inhabitat.com/the-farmery-is-a-farm-and-market-in-four-recycled-shipping-containers-in-north-carolina/> (Year: 2012).*

(**) Term: **15 Years**

* cited by examiner

(21) Appl. No.: **29/658,553**

Primary Examiner — Brett Miller

(22) Filed: **Aug. 1, 2018**

(74) *Attorney, Agent, or Firm* — Donald J. Ersler

(51) **LOC (12) Cl.** **25-03**

(52) **U.S. Cl.**
USPC **D25/33**

(57) **CLAIM**

(58) **Field of Classification Search**
USPC D25/1, 3-35, 56, 58, 59, 61
CPC E04H 1/00-06; E04H 3/00-10; E04H 1/12-1277; E04H 1/005; E04B 1/348; E04B 1/3483

The ornamental design for a corrosion control facility, as shown and described.

See application file for complete search history.

DESCRIPTION

(56) **References Cited**

U.S. PATENT DOCUMENTS

3,438,162	A *	4/1969	Graham	E04H 1/04 52/175
D216,252	S *	12/1969	Goodrich	D25/4
4,807,407	A *	2/1989	Horn	E04H 1/005 52/125.2
9,725,895	B1 *	8/2017	Gill	E04H 9/14
10,309,119	B2 *	6/2019	Klein	E04B 1/34331
10,352,034	B2 *	7/2019	Boyle	E04H 1/005
2002/0166293	A1 *	11/2002	Zeik	E04H 1/125 52/79.1
2006/0207193	A1 *	9/2006	Lilke	E04B 1/3483 52/79.7
2016/0130795	A1 *	5/2016	Downey	E04H 1/005 52/79.1
2019/0257073	A1 *	8/2019	Ledoux	E04B 1/3483

FIG. 1 is a top perspective view of a corrosion control facility incorporating our new design;
FIG. 2 is a rear perspective view thereof;
FIG. 3 is a bottom perspective view thereof;
FIG. 4 is a top plan view thereof;
FIG. 5 is a bottom plan view thereof;
FIG. 6 is a left side view thereof;
FIG. 7 is a right side view thereof;
FIG. 8 is a front view thereof; and,
FIG. 9 is a rear view thereof.

Any surface with an inner broken line perimeter inside an outer solid line perimeter are part of the claimed invention. The broken lines shown in the drawings illustrate portions of the corrosion control facility that form no part of the claimed invention.

1 Claim, 7 Drawing Sheets

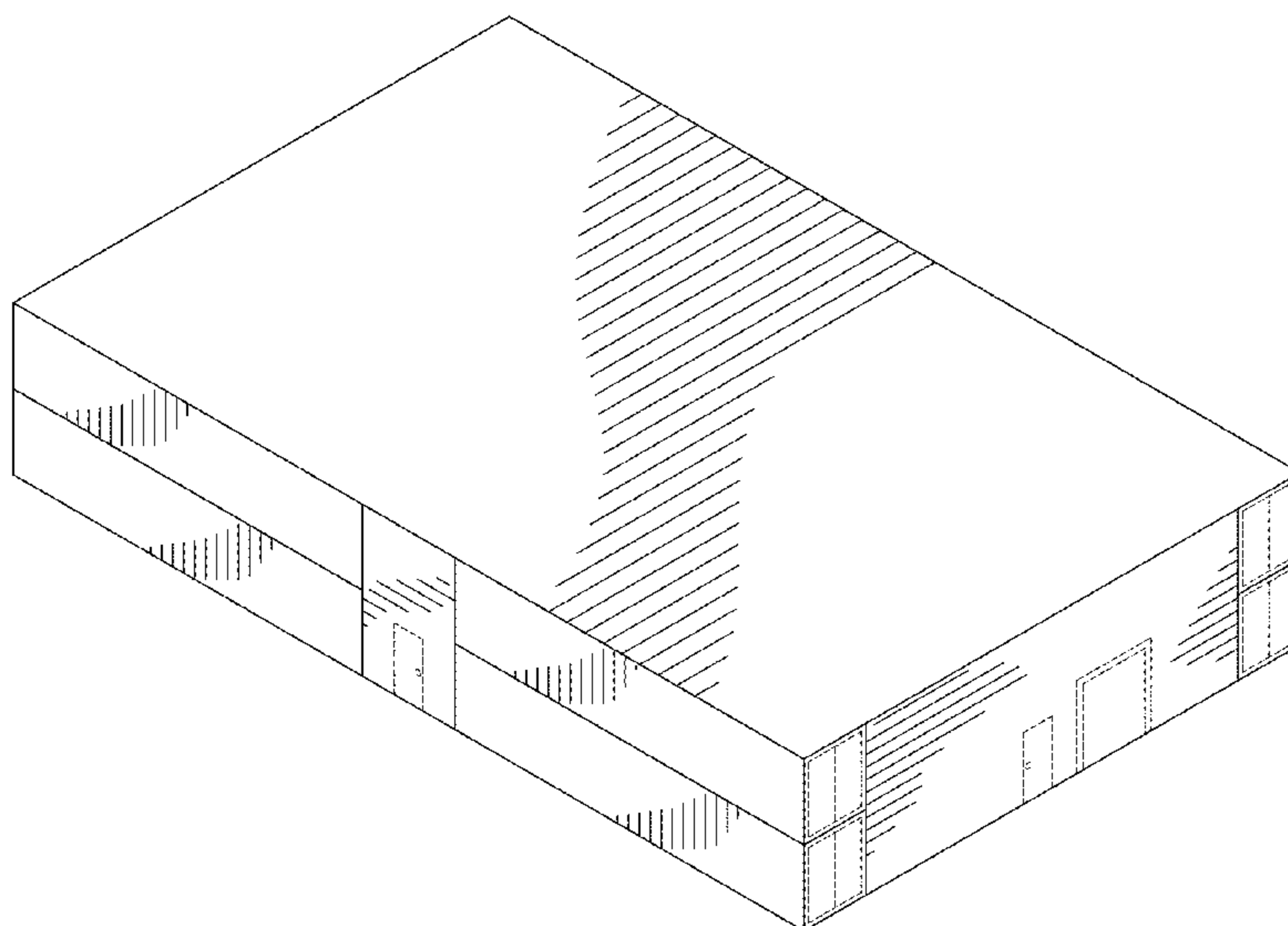

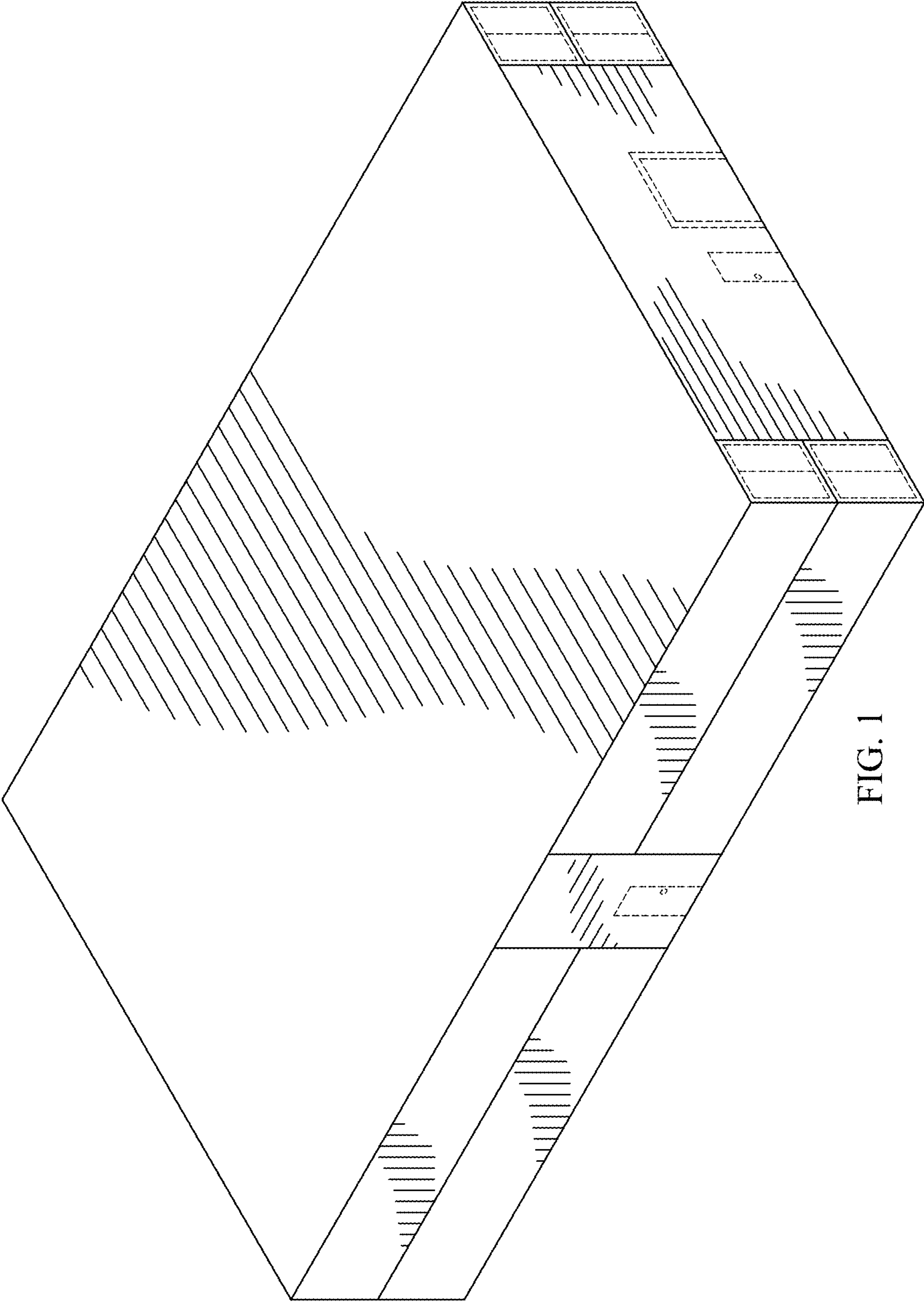

FIG. 1

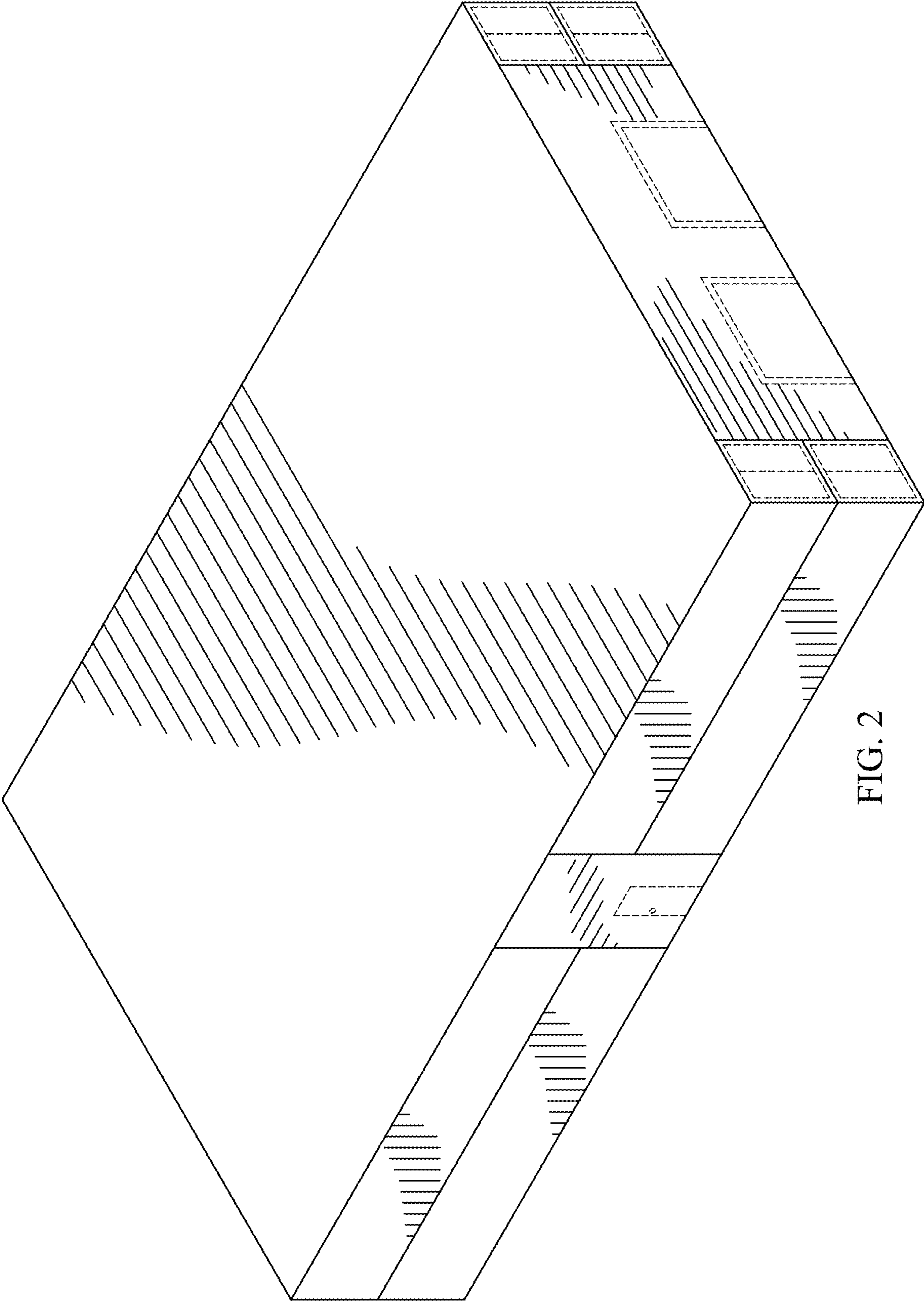

FIG. 2

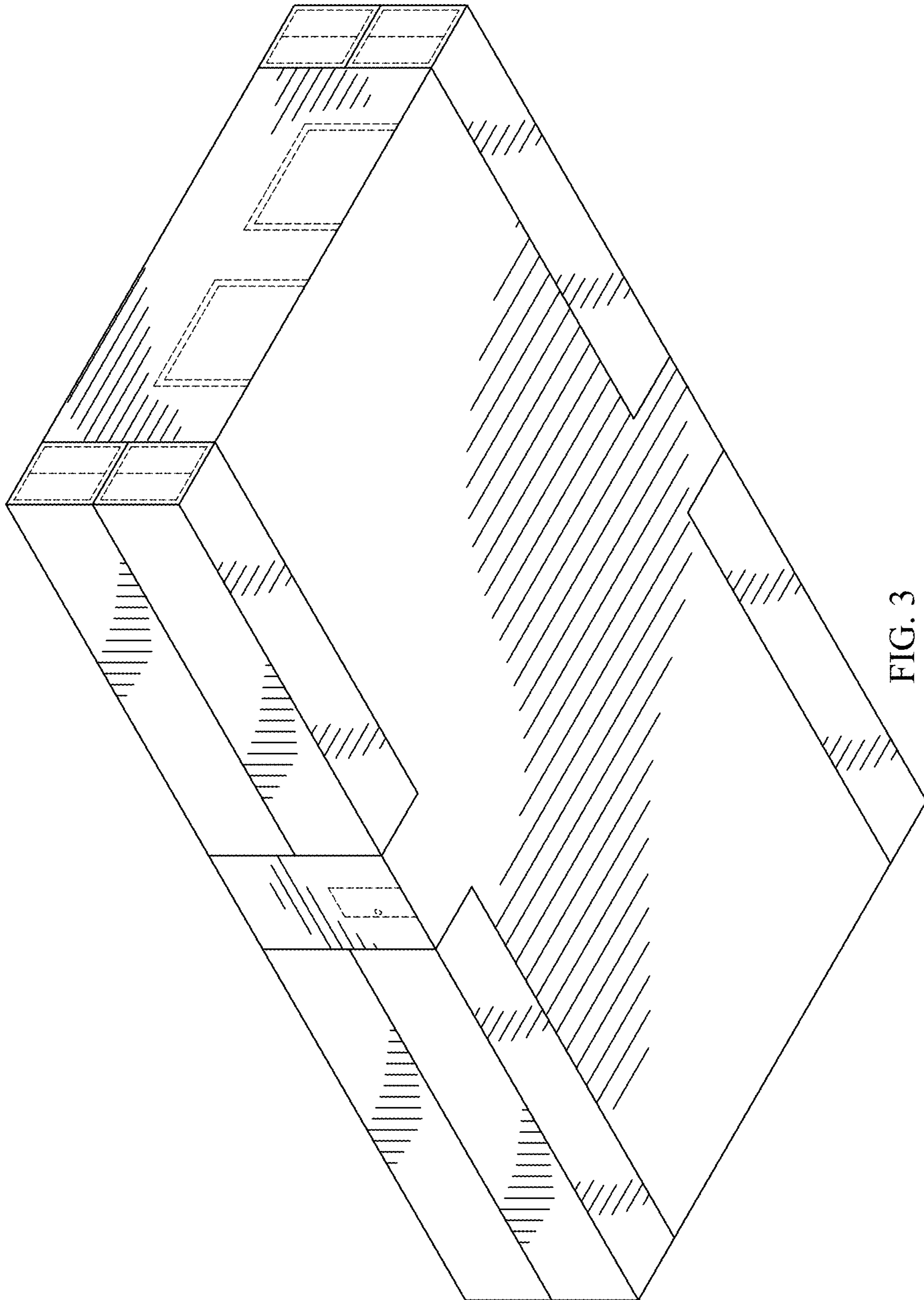

FIG. 3

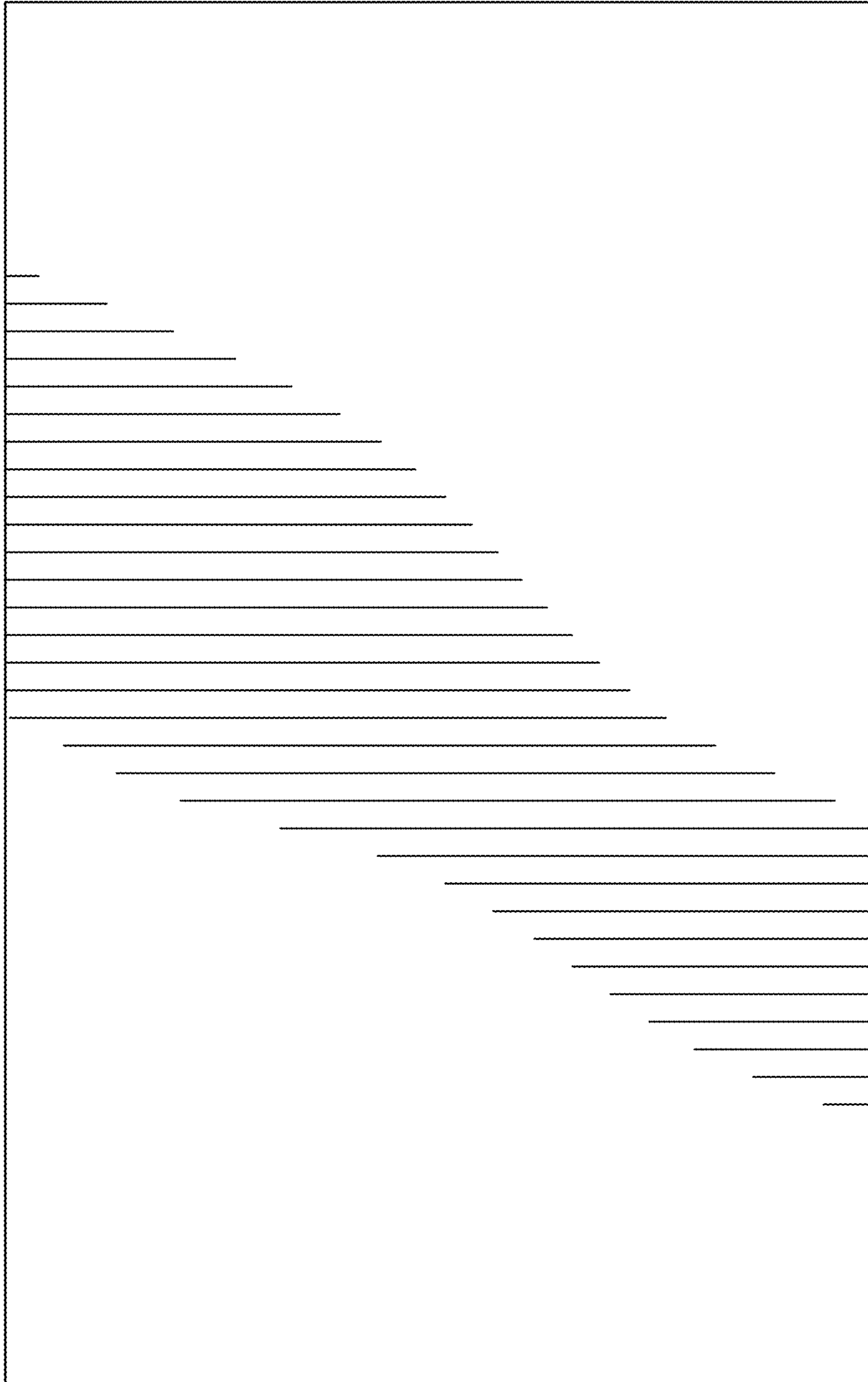

FIG. 4

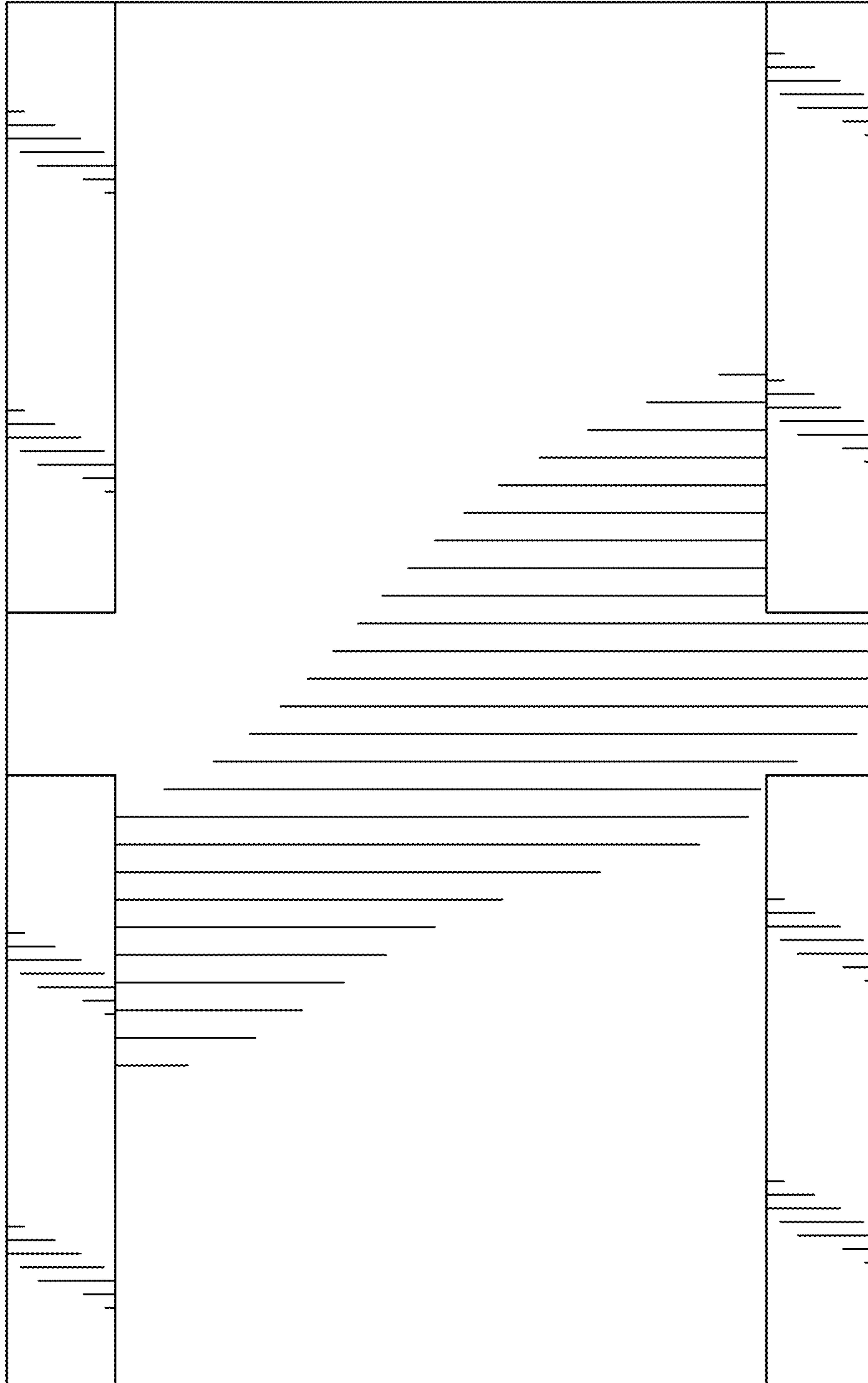

FIG. 5

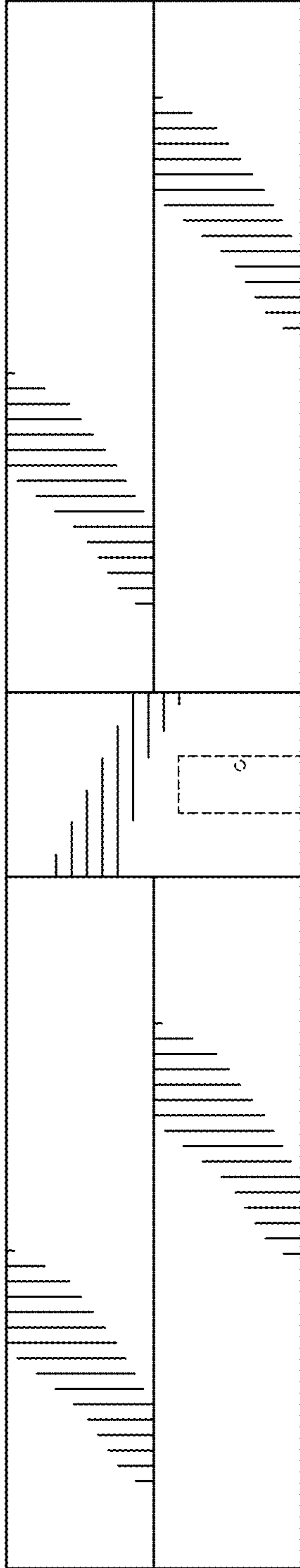

FIG. 6

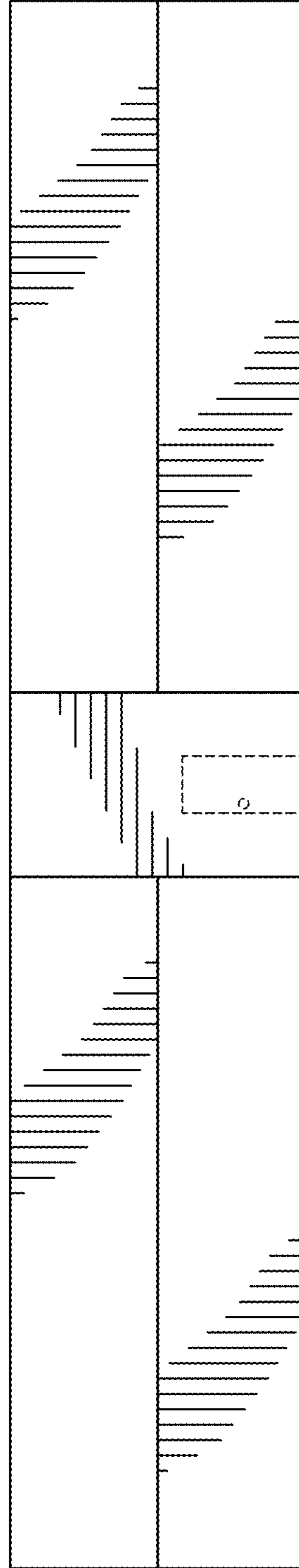

FIG. 7

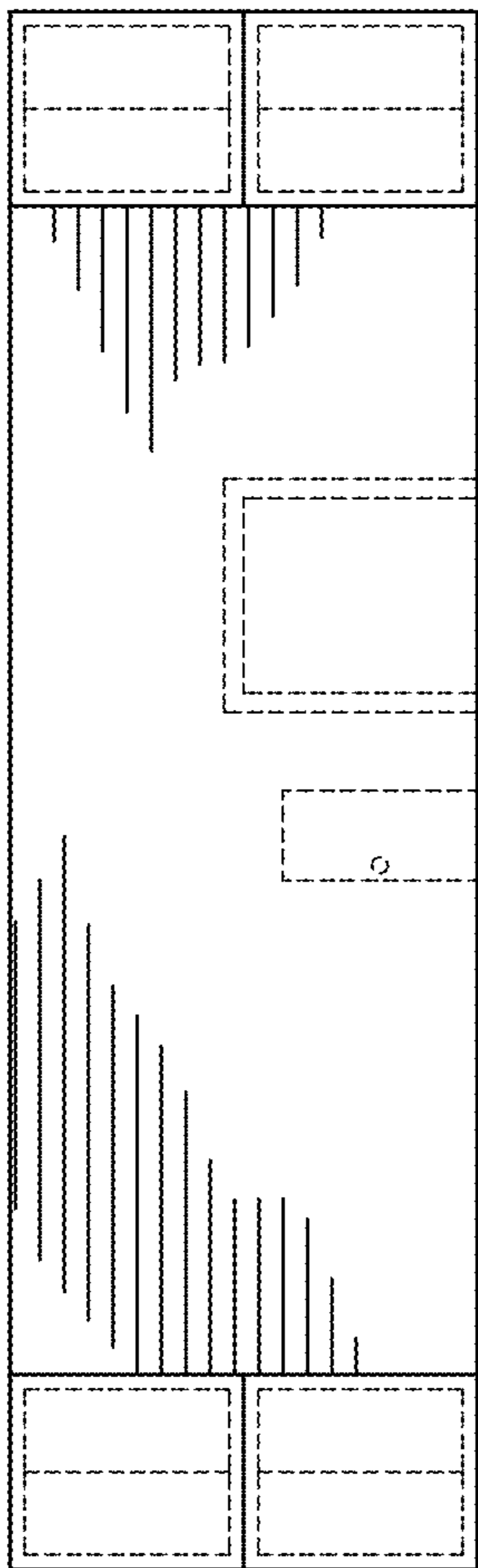

FIG. 8

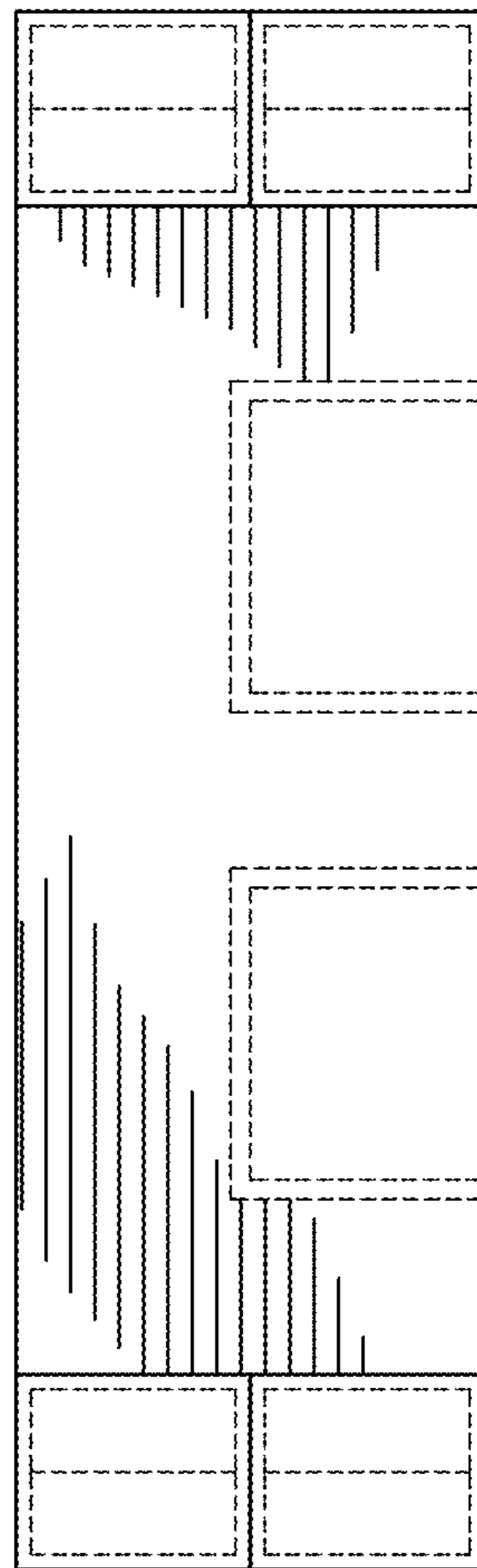

FIG. 9