



US00D881381S

(12) **United States Design Patent**
Lee et al.

(10) **Patent No.:** **US D881,381 S**
(45) **Date of Patent:** **** Apr. 14, 2020**

- (54) **NASAL MASK**
- (71) Applicant: **GaleMed Corporation**, Yilan County (TW)
- (72) Inventors: **Gary C. J. Lee**, Yilan County (TW); **Thomas C. Loescher**, Yilan County (TW); **Yu-Chien Yen**, Yilan County (TW)
- (73) Assignee: **GALEMED CORPORATION**, Yilan County (TW)
- (**) Term: **15 Years**
- (21) Appl. No.: **29/687,223**
- (22) Filed: **Apr. 11, 2019**
- (30) **Foreign Application Priority Data**
Feb. 20, 2019 (TW) 108300969
- (51) **LOC (12) Cl.** **29-02**
- (52) **U.S. Cl.**
USPC **D24/110.4**
- (58) **Field of Classification Search**
USPC D24/108, 110, 110.5, 111, 112, 128, D24/110.4, 110.1, 127, 129
CPC A61M 16/0666; A61M 16/0672; A61M 2202/0208; A61M 16/0683; A61M 16/06; A61M 2210/0618; A61M 16/0616; A61M 16/0622; A61M 16/0633; A61M 16/00
See application file for complete search history.

- (56) **References Cited**
U.S. PATENT DOCUMENTS
1,206,045 A * 11/1916 Smith A61M 16/06 128/206.24
D118,142 S * 12/1939 Willhelmy D24/110.4
D171,482 S * 2/1954 Bickel D24/110.4

- 4,248,218 A * 2/1981 Fischer A61M 16/009 128/204.18
- 4,458,679 A * 7/1984 Ward A61M 16/06 128/201.13
- D398,987 S * 9/1998 Cotner D24/110.4
- 6,019,101 A * 2/2000 Cotner A61M 16/06 128/206.18
- 6,044,844 A * 4/2000 Kwok A61M 16/06 128/207.11
- 6,135,109 A * 10/2000 Blasdell A61M 16/06 128/206.21
- D535,742 S * 1/2007 VonDohlen D24/110.4
- D780,304 S * 2/2017 Veliss D24/110.4
- 9,981,102 B2 * 5/2018 Veliss A61M 16/0616
- D835,776 S * 12/2018 Veliss D24/110.1
- 10,300,235 B2 * 5/2019 Romagnoli A61M 16/0605
- 10,363,386 B2 * 7/2019 Matula, Jr. A61M 16/0816
- D867,578 S * 11/2019 Blasdell D24/110.4

(Continued)

Primary Examiner — Lilyana Bekic
(74) *Attorney, Agent, or Firm* — Chung-Ming Shih;
HDLS IPR Services

(57) **CLAIM**

The ornamental design for a nasal mask, as shown and described.

DESCRIPTION

FIG. 1 is a perspective view of a nasal mask showing our new design;
FIG. 2 is a front view thereof;
FIG. 3 is a rear view thereof;
FIG. 4 is a left side view thereof;
FIG. 5 is a right side view thereof;
FIG. 6 is a top view thereof;
FIG. 7 is a bottom view thereof; and,
FIG. 8 is a second perspective view showing the nasal mask.
The broken lines in the drawings illustrate portions of the nasal mask that form part of the claimed design.

1 Claim, 8 Drawing Sheets

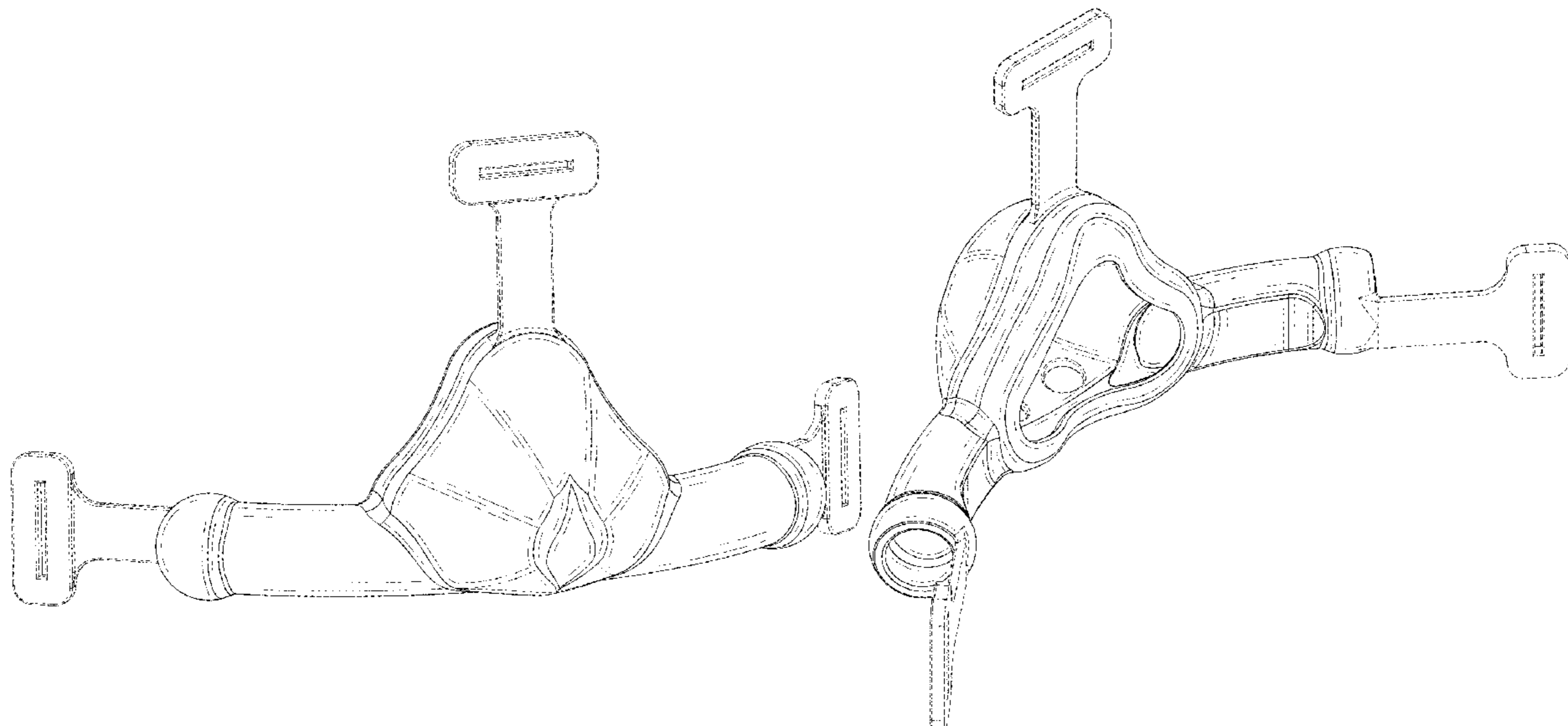

(56)

References Cited

U.S. PATENT DOCUMENTS

2013/0109992 A1* 5/2013 Guyette A61M 16/06
600/532
2016/0361510 A1* 12/2016 Alphonse A61M 16/06
2017/0259018 A1* 9/2017 Blasdel A61M 16/208
2017/0361057 A1* 12/2017 Blasdel A61M 16/0611

* cited by examiner

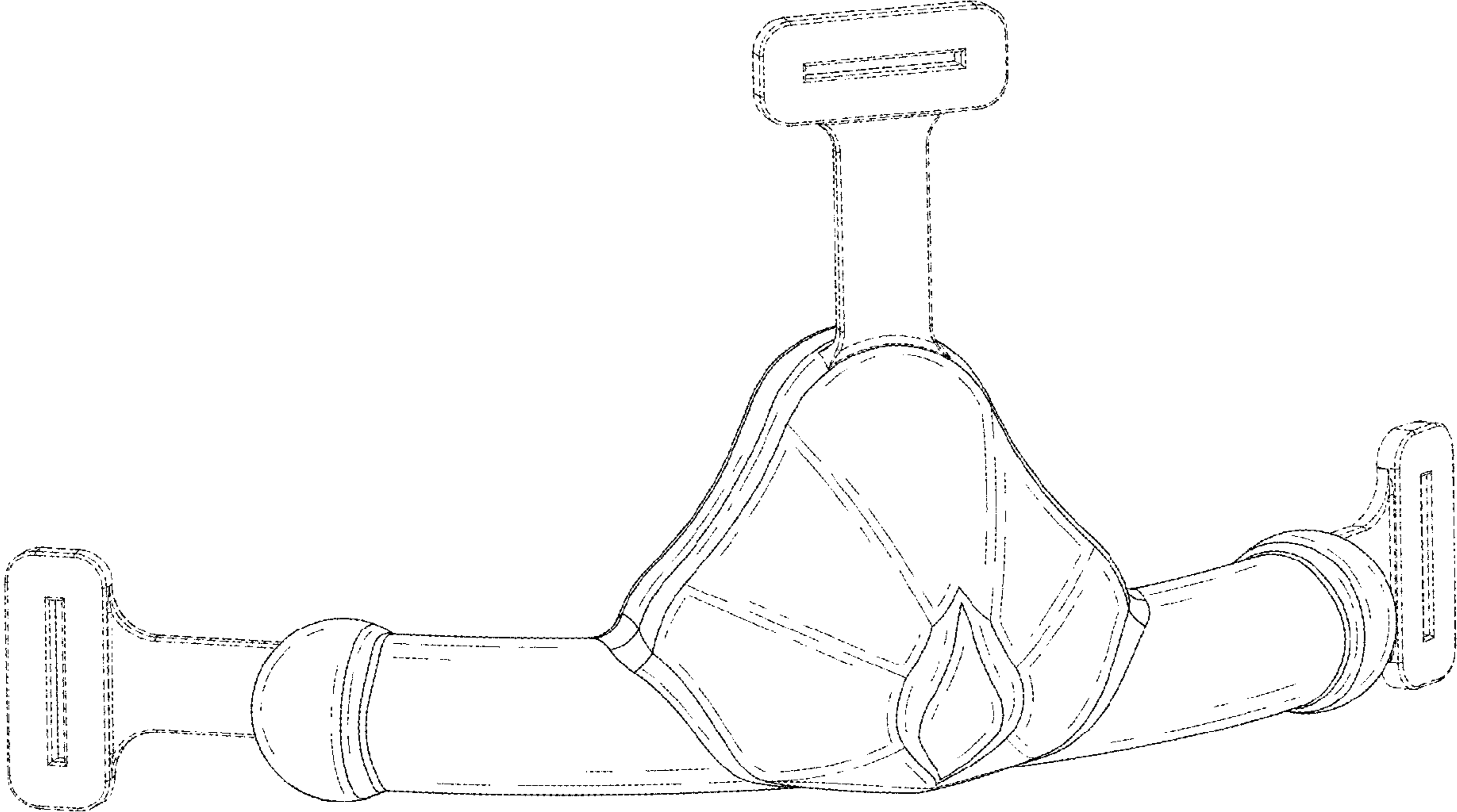

FIG.1

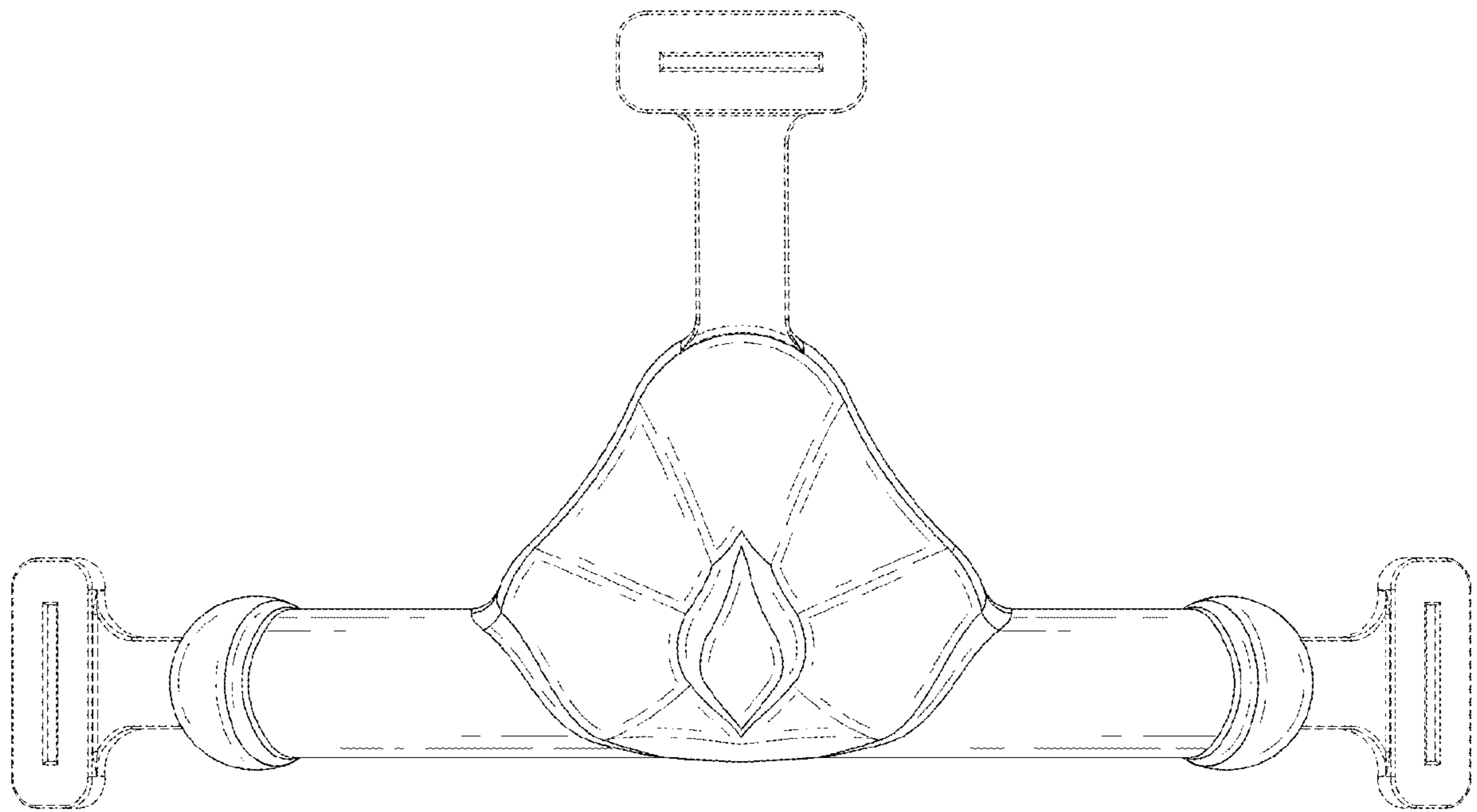

FIG.2

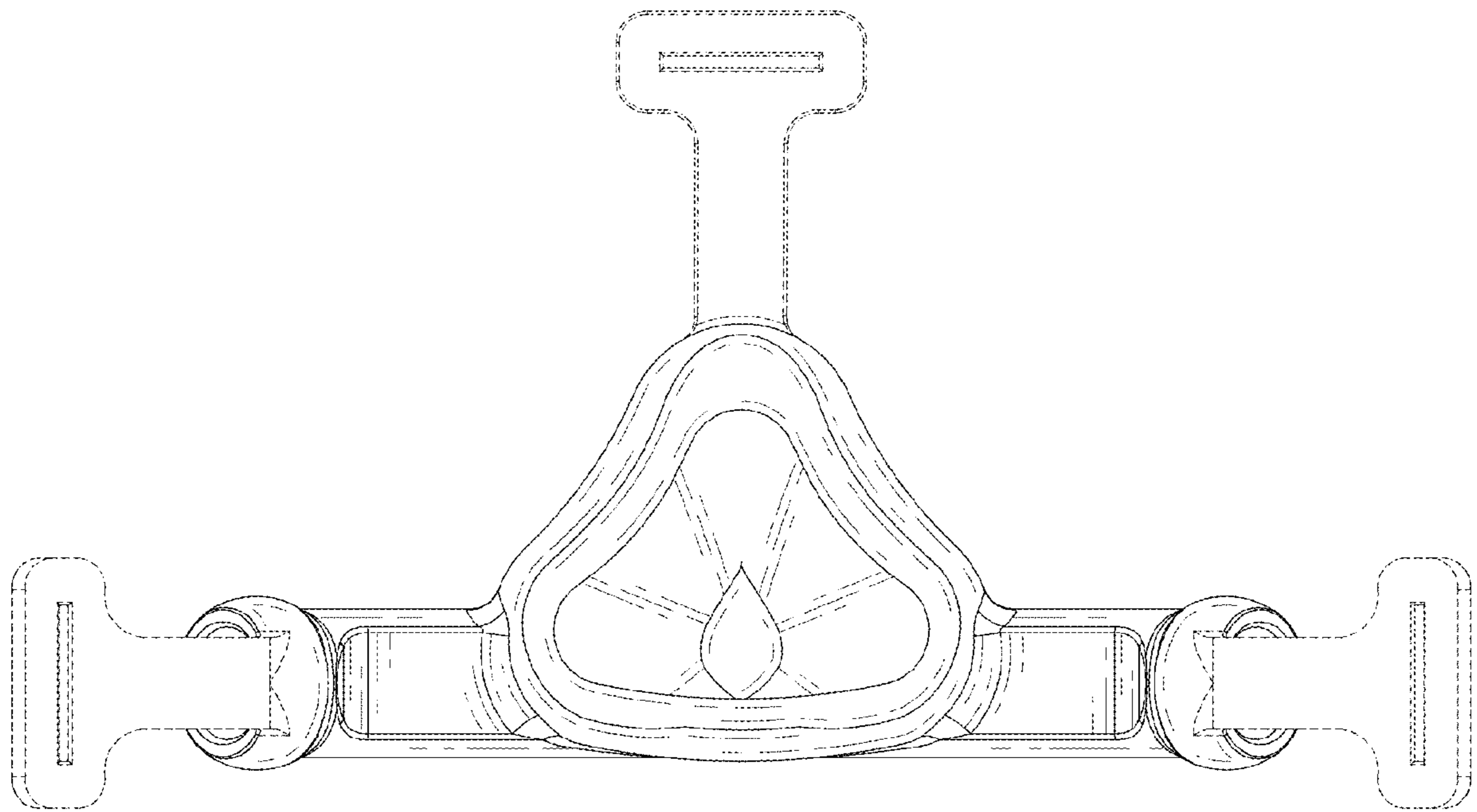

FIG.3

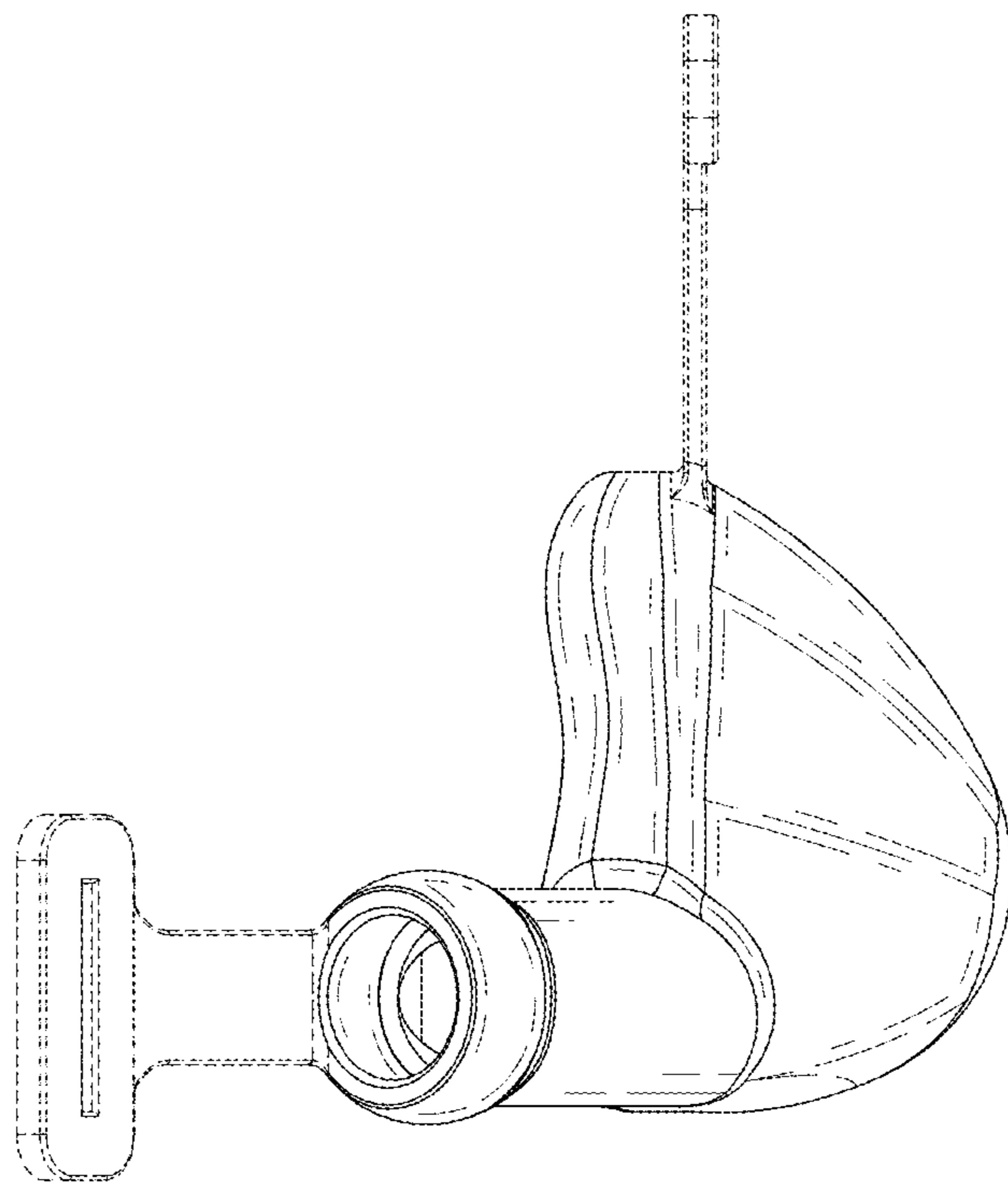

FIG.4

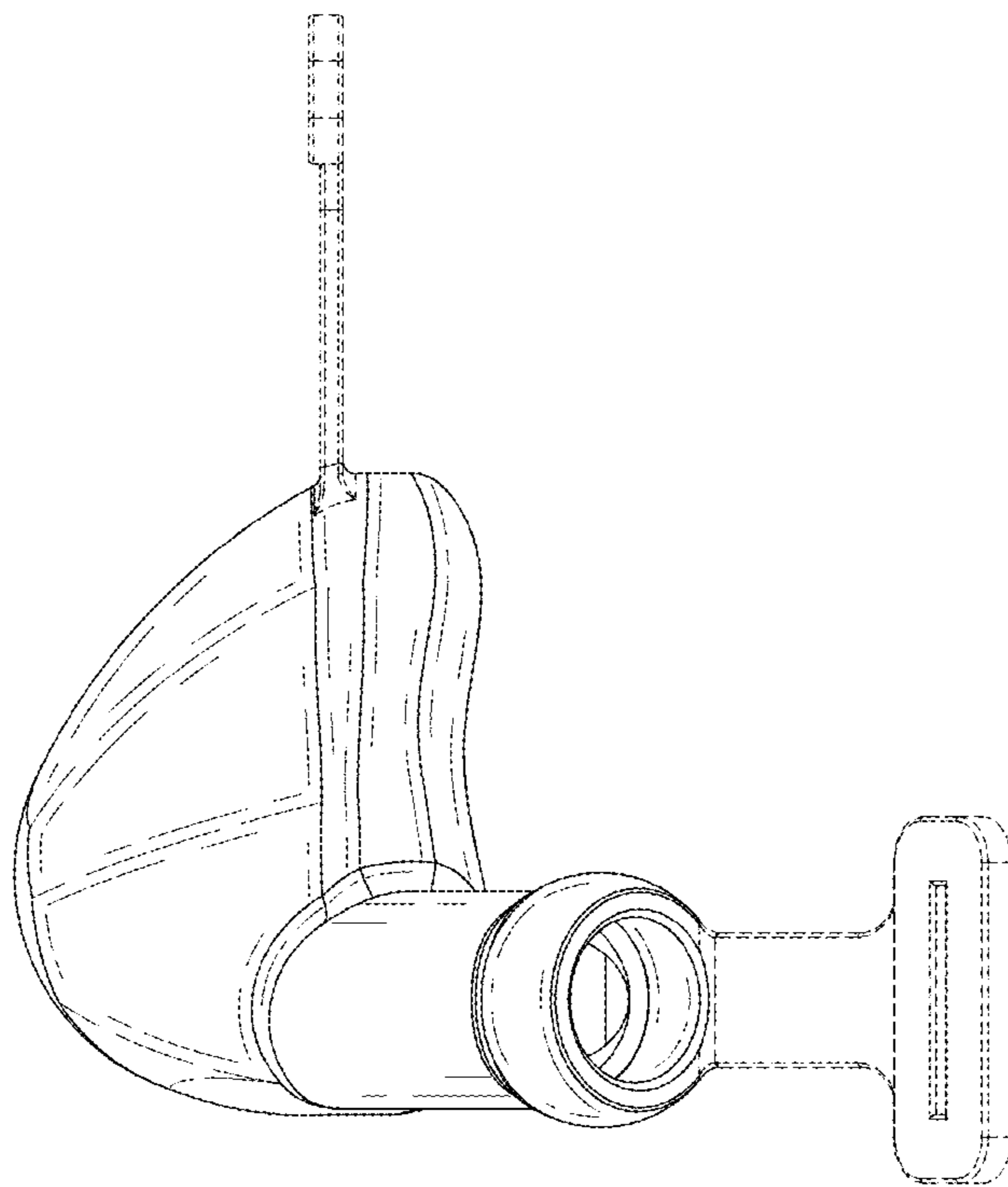

FIG.5

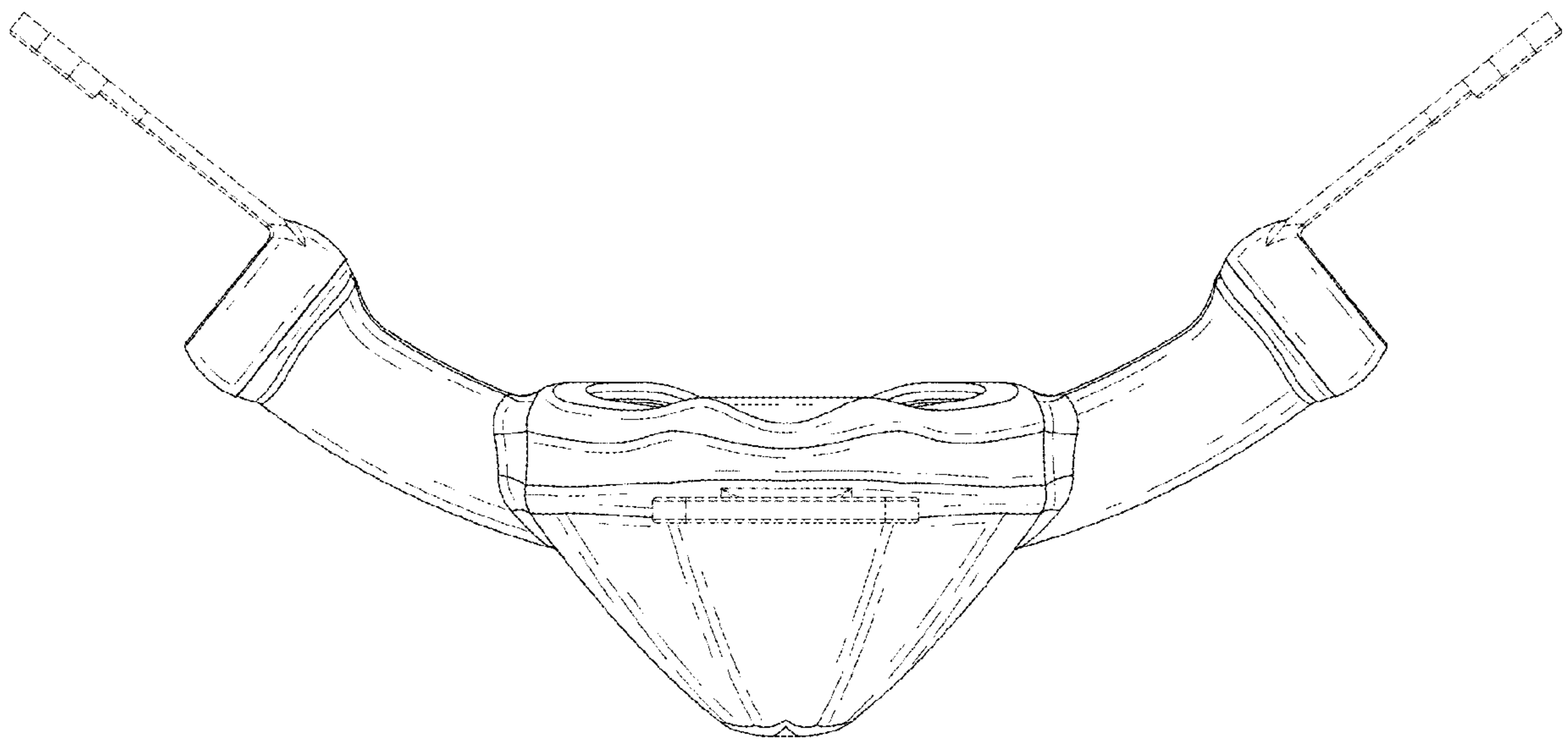

FIG.6

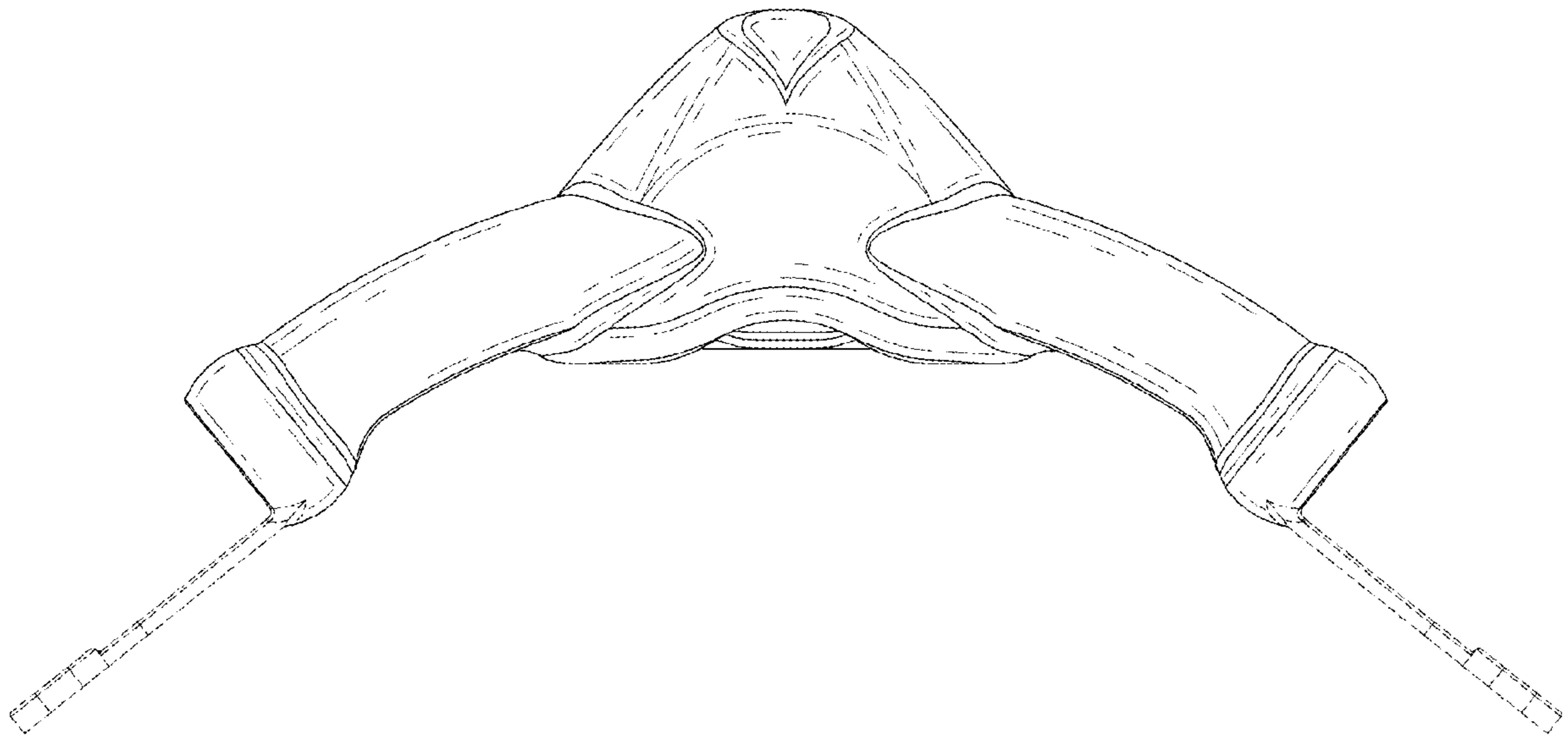

FIG.7

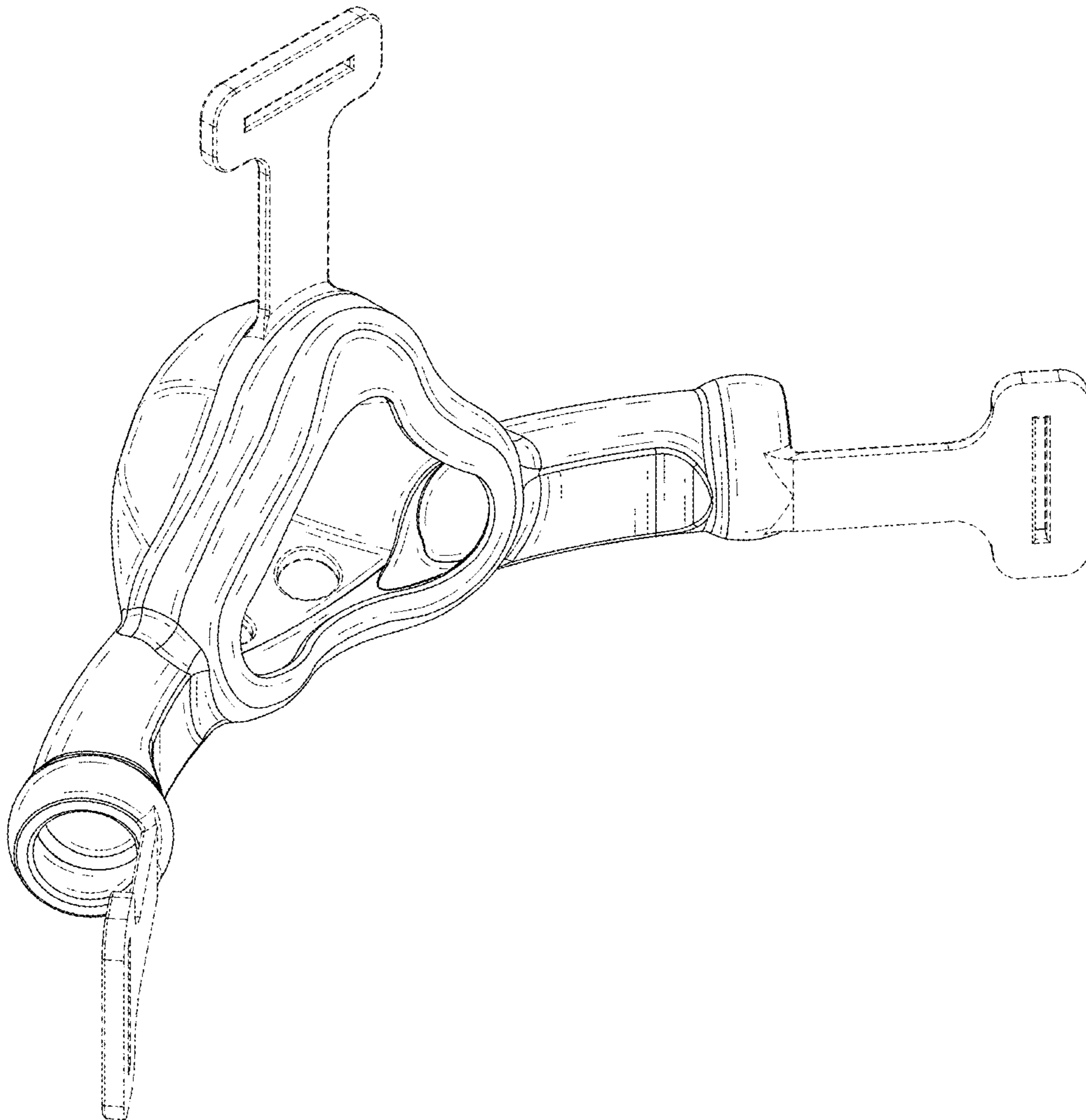

FIG.8