



US00D878390S

(12) **United States Design Patent**
Zeng et al.

(10) **Patent No.:** **US D878,390 S**
(45) **Date of Patent:** **** Mar. 17, 2020**

- (54) **SMART WATCH DISPLAY SCREEN WITH GRAPHICAL USER INTERFACE**
- (71) Applicant: **BEIJING SOGOU TECHNOLOGY DEVELOPMENT CO., LTD.**, Beijing (CN)
- (72) Inventors: **Beiwen Zeng**, Beijing (CN); **Ying Wang**, Beijing (CN); **Jiantao Li**, Beijing (CN)
- (73) Assignee: **BEIJING SOGOU TECHNOLOGY DEVELOPMENT CO., LTD.**, Beijing (CN)

7,890,881	B1 *	2/2011	Skidgel	G06F 17/212	715/243
D656,946	S *	4/2012	Judy	D14/486	
D662,507	S *	6/2012	Mori	D14/486	
D699,734	S *	2/2014	Shia	D14/486	
D714,339	S *	9/2014	Hendrickson	D14/487	
D720,765	S *	1/2015	Xie	D14/486	
D737,306	S *	8/2015	Scazafavo	D14/486	
D746,845	S *	1/2016	Archer	D14/486	
D748,126	S *	1/2016	Sarukkai	D14/486	
D762,232	S *	7/2016	Howard	D14/486	
D763,293	S *	8/2016	Lee	D14/486	

(Continued)

Primary Examiner — Daniel J Domino

(74) *Attorney, Agent, or Firm* — Bayramoglu Law Offices LLC

- (**) Term: **15 Years**
- (21) Appl. No.: **29/624,899**
- (22) Filed: **Nov. 6, 2017**

(30) **Foreign Application Priority Data**

May 8, 2017 (CN) 2017 3 0165173

- (51) **LOC (12) Cl.** **14-04**
- (52) **U.S. Cl.**
USPC **D14/485**
- (58) **Field of Classification Search**
USPC D14/485-495
CPC G06F 3/048; G06F 3/0481; G06F 3/0482; G06F 3/04842; G06F 3/04847; G06F 3/0485; G06F 1/1692; G06F 2203/04806
See application file for complete search history.

(56) **References Cited**

U.S. PATENT DOCUMENTS

D403,313	S *	12/1998	Peppel	D14/486
D602,029	S *	10/2009	Lloyd	D14/485
D607,466	S *	1/2010	Prater	D14/486
D607,894	S *	1/2010	Prater	D14/486
D625,322	S *	10/2010	Guntaur	D14/486

(57) **CLAIM**

The ornamental design for a smart watch display screen with graphical user interface, as shown and described.

DESCRIPTION

FIG. 1 is a front view of a first image in a sequence for a smart watch display screen with graphical user interface; FIG. 2 is a second image thereof; FIG. 3 is a third image thereof; FIG. 4 is a fourth image thereof; and, FIG. 5 is a fifth image thereof.

The subject matter in this patent application includes a process or period in which the appearance of the graphical user interface transitions sequentially between the images shown in FIGS. 1-5. The process or period in which one image transitions to another forms no part of the claimed design.

The broken lines showing a smart watch illustrate environmental subject matter, whereas the broken lines showing elements of the graphical user interface illustrate portions of the article. None of the broken lines form part of the claimed design.

1 Claim, 5 Drawing Sheets

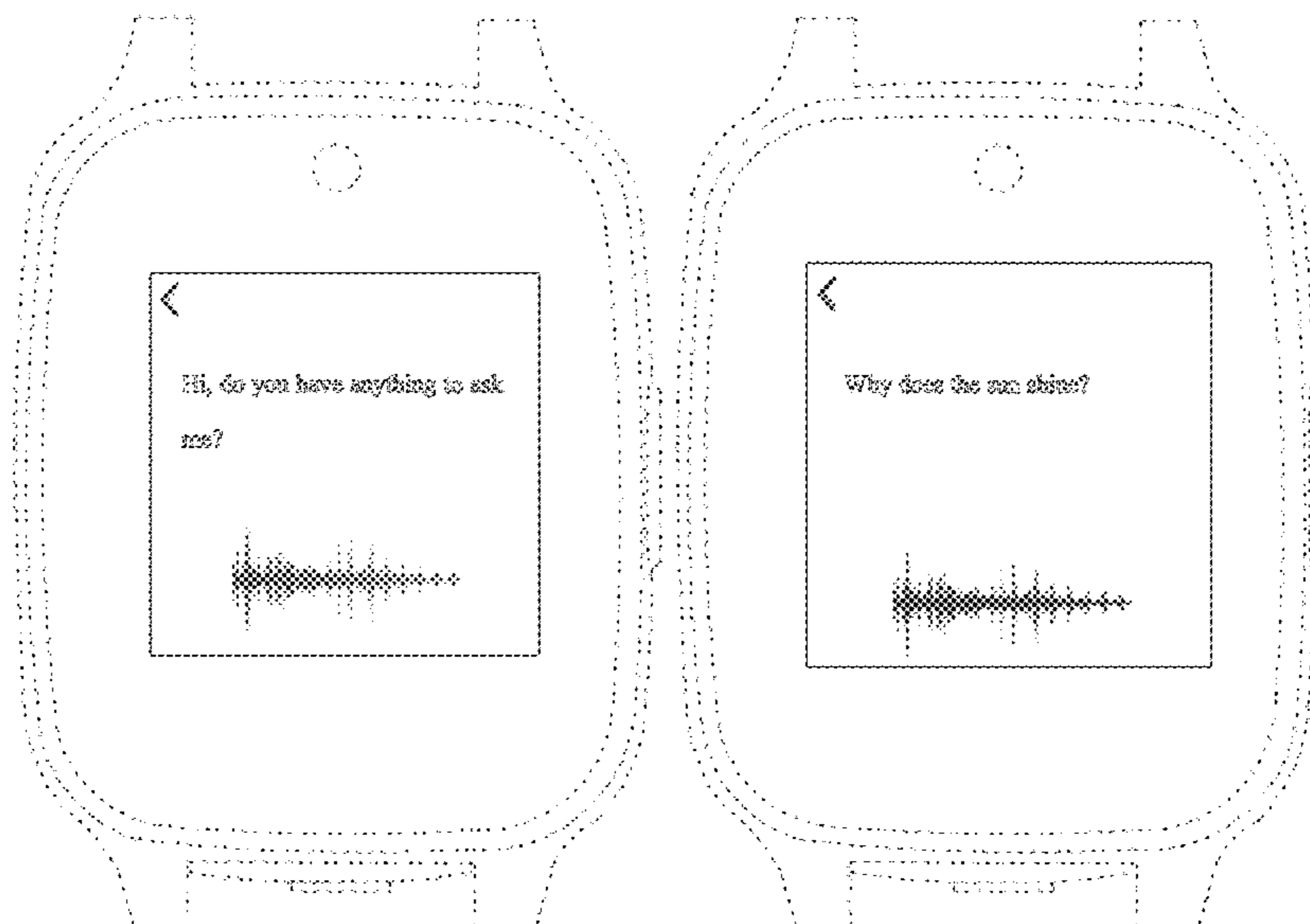

(56)

References Cited

U.S. PATENT DOCUMENTS

D765,110 S * 8/2016 Liang D14/486
 D766,286 S * 9/2016 Lee D14/486
 D770,507 S * 11/2016 Umezawa D14/486
 D771,692 S * 11/2016 Rodriguez D14/486
 D773,478 S * 12/2016 Wesley D14/485
 D779,514 S * 2/2017 Baris D14/486
 D781,325 S * 3/2017 Perry D14/486
 D785,009 S * 4/2017 Lim D14/485
 D787,529 S * 5/2017 Huang D14/485
 D791,151 S * 7/2017 Noack D14/486
 D792,432 S * 7/2017 Hoang D14/486
 D792,443 S * 7/2017 Hoang D14/487
 D800,748 S * 10/2017 Jungmann D14/486
 D801,989 S * 11/2017 Iketsuki D14/485
 D804,493 S * 12/2017 Daniel H04L 51/046
 D14/485
 D806,101 S * 12/2017 Frick D14/486
 D808,996 S * 1/2018 Ambielli B33Y 40/00
 D14/486
 D809,530 S * 2/2018 Matheson D14/485
 D812,081 S * 3/2018 Saneii D14/486
 D816,715 S * 5/2018 Martin D14/492
 D818,475 S * 5/2018 Yepez D14/485
 D819,657 S * 6/2018 Muller D14/485
 D820,288 S * 6/2018 Howell D14/486

D820,879 S * 6/2018 Jones D14/488
 D822,034 S * 7/2018 Clymer D14/485
 D822,035 S * 7/2018 Wu D14/485
 D822,050 S * 7/2018 Gandhi D14/486
 D822,678 S * 7/2018 Wu D14/485
 D823,860 S * 7/2018 Wiffen D14/485
 D830,382 S * 10/2018 Marohn D14/486
 D833,461 S * 11/2018 Dieken D14/485
 D834,053 S * 11/2018 Wang D14/486
 D835,631 S * 12/2018 Yepez D14/485
 D835,663 S * 12/2018 Ho D14/487
 D836,652 S * 12/2018 Fowler D14/486
 D837,240 S * 1/2019 Van Tricht D14/486
 D839,301 S * 1/2019 Baber D14/488
 D840,421 S * 2/2019 Chalker D14/485
 D841,030 S * 2/2019 Bradley-Pollack D14/486
 D842,313 S * 3/2019 Kagan D14/485
 D842,314 S * 3/2019 Govindan Sankar Selvan
 D14/485
 D843,387 S * 3/2019 Yuguchi D14/485
 D844,649 S * 4/2019 Besette D14/486
 D846,583 S * 4/2019 Martin D14/486
 D847,165 S * 4/2019 Kolbenheyer D14/486
 D849,029 S * 5/2019 Cooperman D14/486
 D850,461 S * 6/2019 Hoffman D14/485
 D850,472 S * 6/2019 Maguire G16H 50/80
 D14/485
 D851,660 S * 6/2019 Chalker D14/485

* cited by examiner

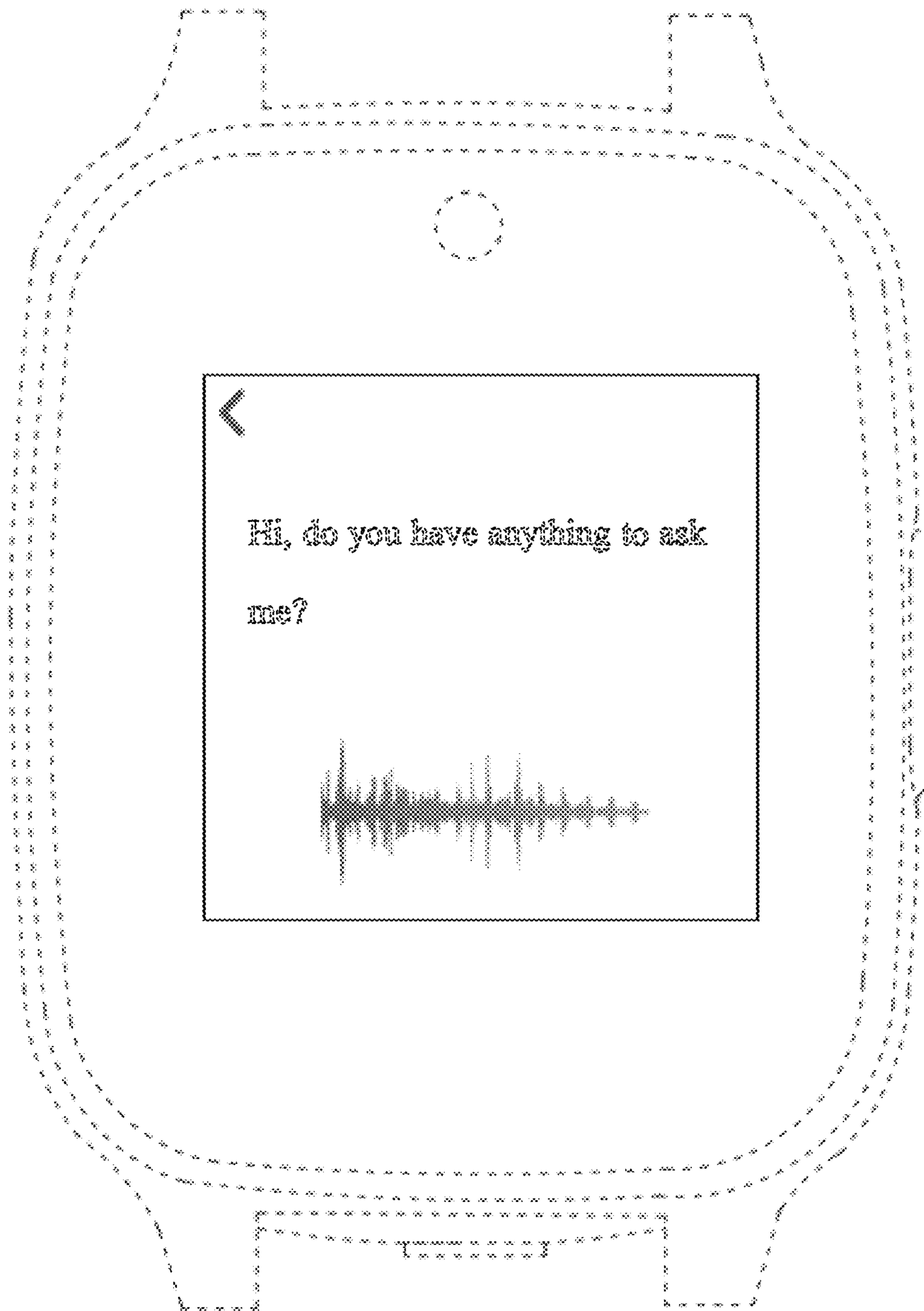

FIG.1

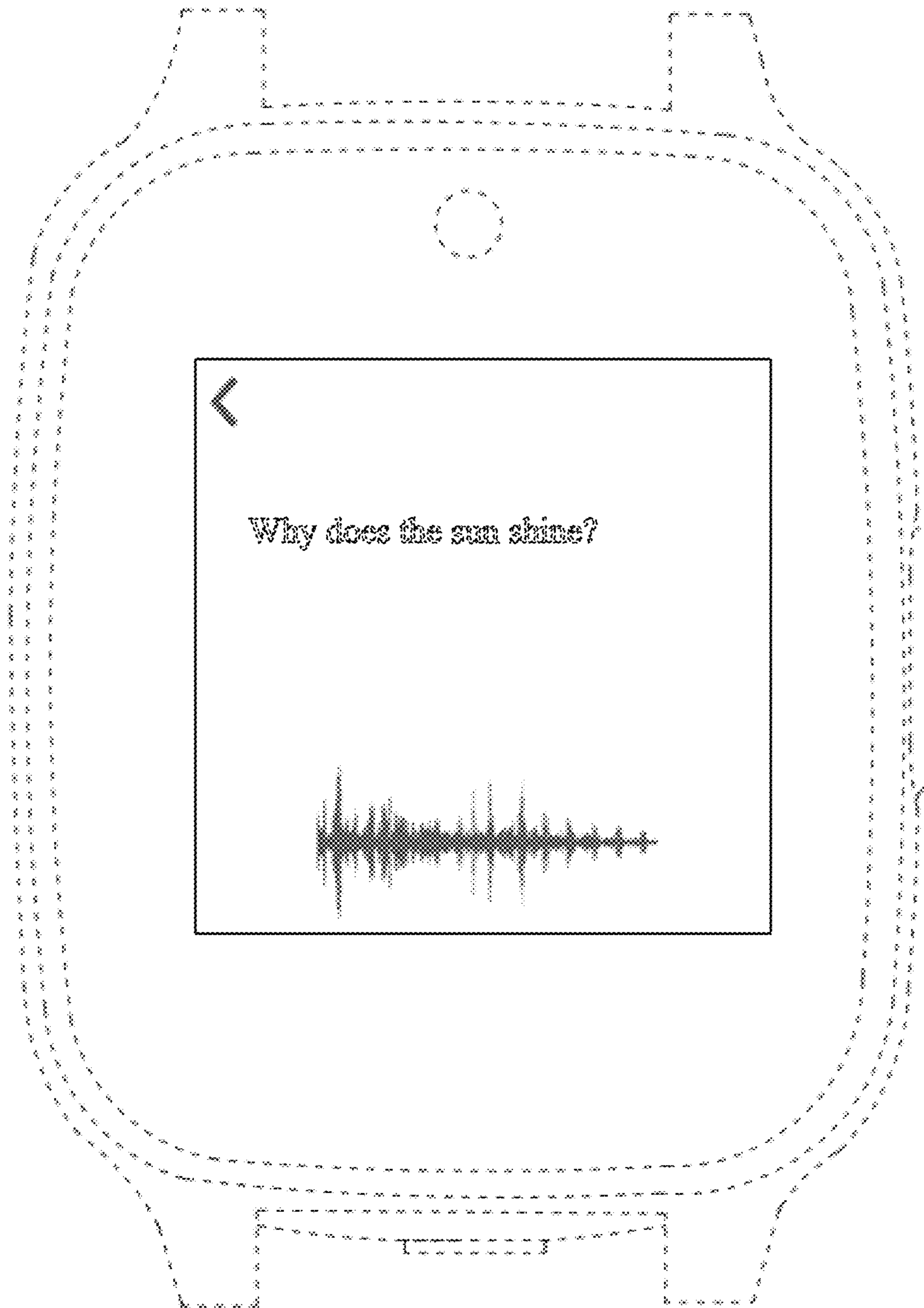

FIG.2

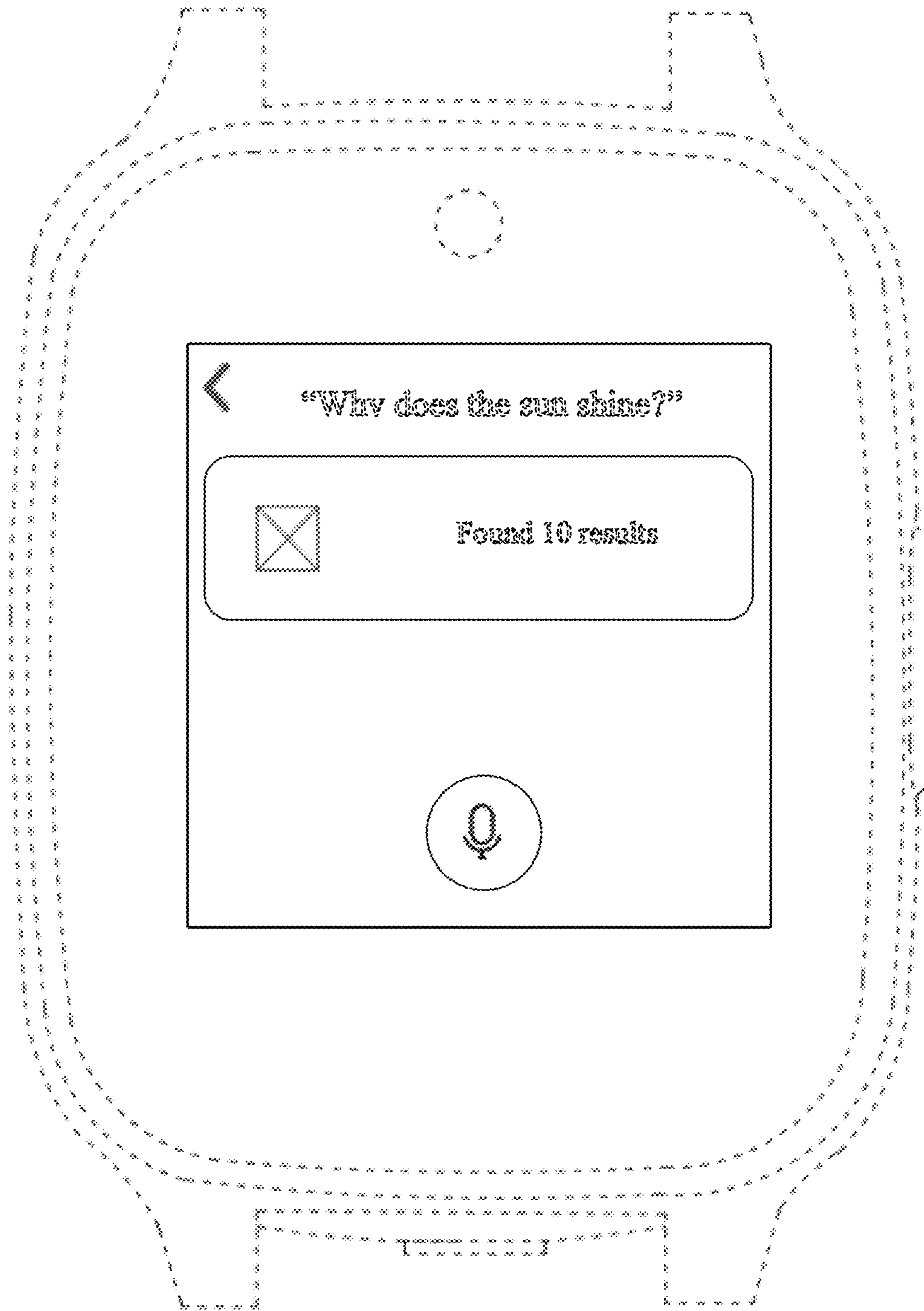

FIG.3

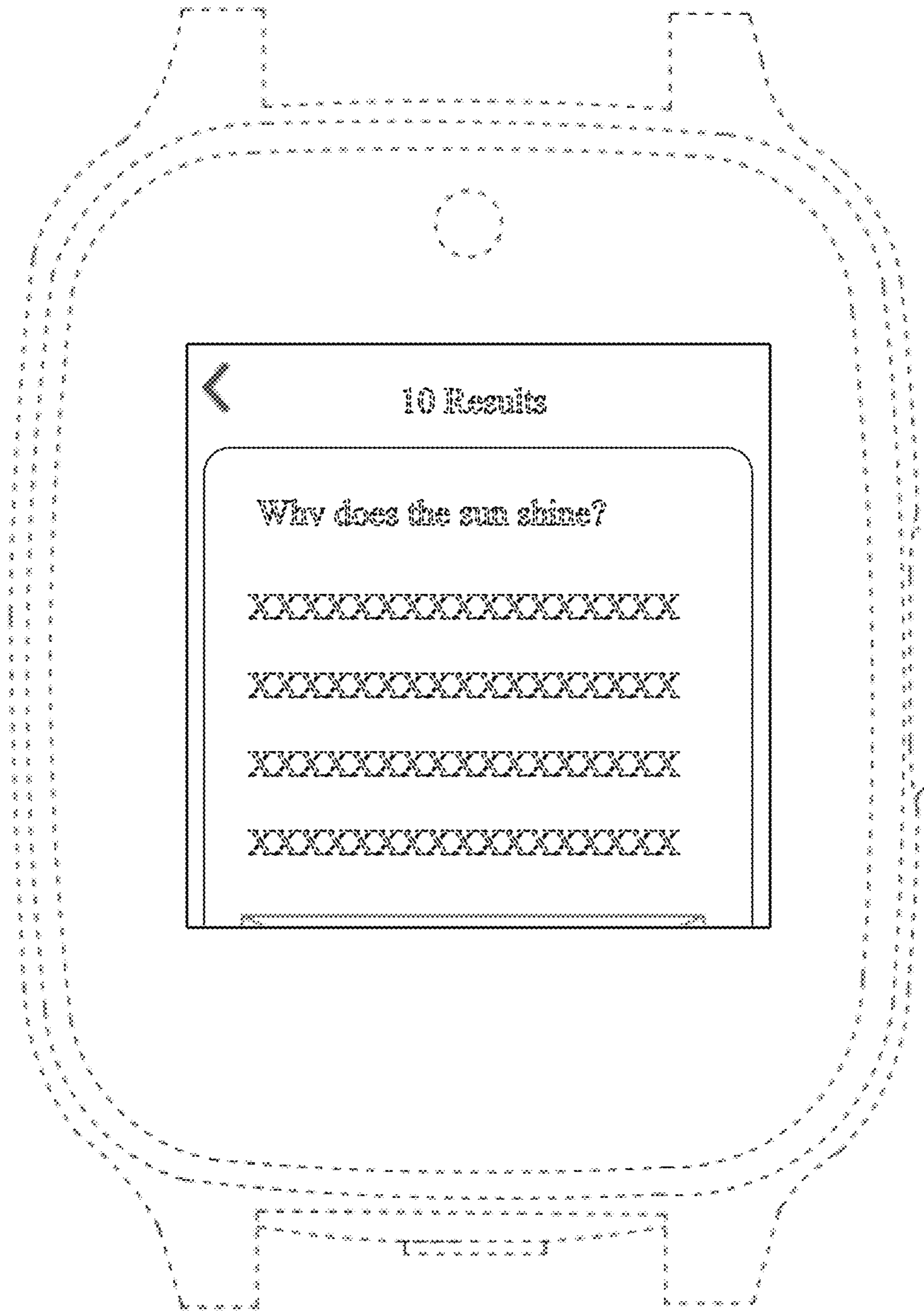

FIG.4

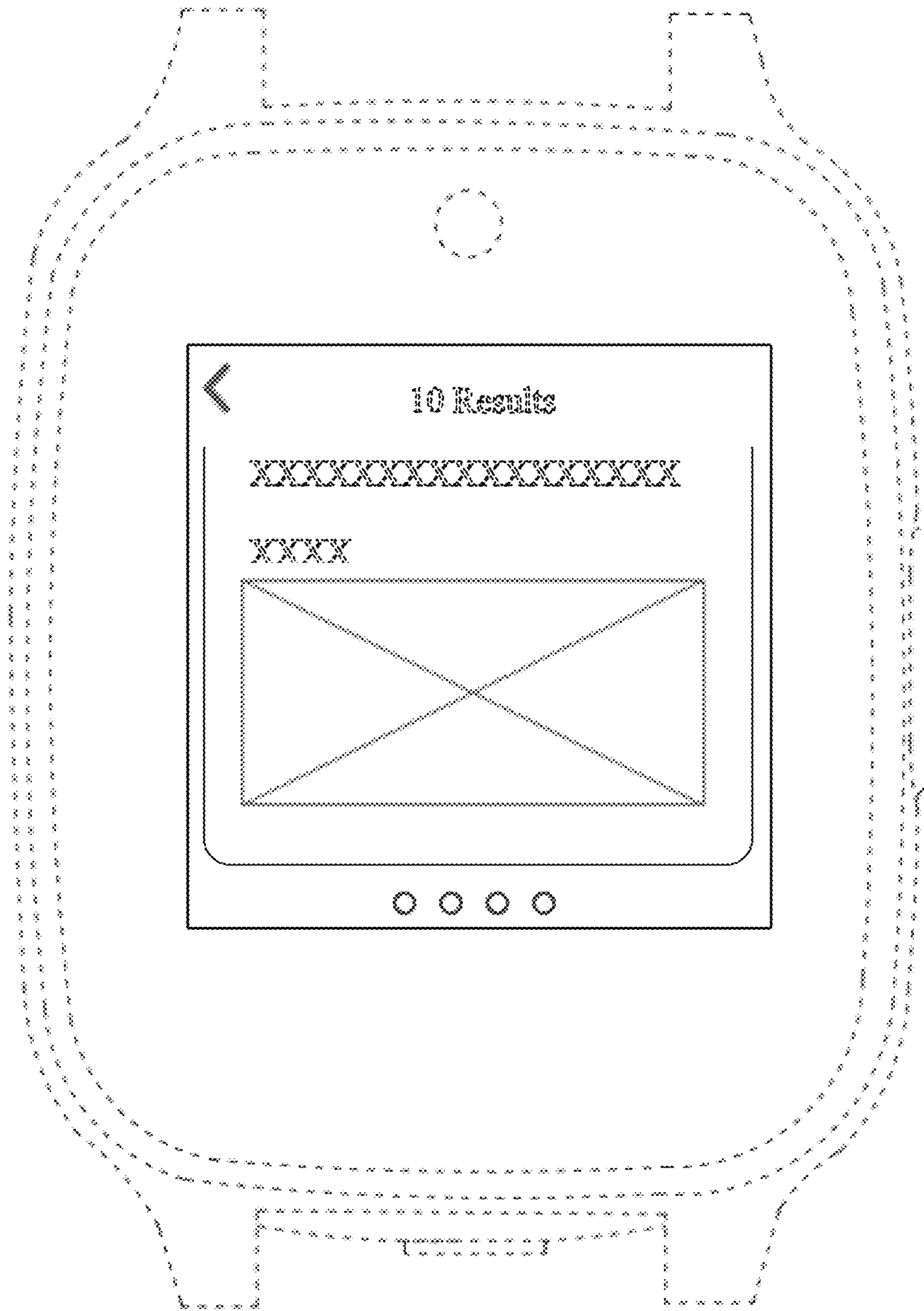

FIG.5