



US00D878151S

(12) **United States Design Patent** (10) **Patent No.:** **US D878,151 S**
Tomlinson (45) **Date of Patent:** **** Mar. 17, 2020**

- (54) **WINE GLASS STEM**
- (71) Applicant: **Natasha Tomlinson**, West Palm Beach, FL (US)
- (72) Inventor: **Natasha Tomlinson**, West Palm Beach, FL (US)
- (**) Term: **15 Years**
- (21) Appl. No.: **29/690,168**
- (22) Filed: **May 6, 2019**
- (51) **LOC (12) Cl.** **07-01**
- (52) **U.S. Cl.**
USPC **D7/396.6; D7/524; D7/396.2; D7/515**
- (58) **Field of Classification Search**
USPC D7/387, 392.1, 396.2, 393, 394, 397, D7/398, 213, 900, 507, 523, 532, 510, D7/511, 529, 533, 536, 534, 524, 537, D7/514, 515, 522, 412, 376, 309, 317, D7/305, 665, 300.1, 300.2, 301, 396.6; D9/435, 436, 443, 442, 444, 449, 450, D9/437; D24/197
CPC A47G 19/2205; A47G 19/22; A47J 43/27; A47J 41/02; A47J 41/0077; A47J 41/0088; A47J 41/028; A47J 31/407; A47J 31/40; A45F 3/16; B65D 85/804; B65D 41/04
See application file for complete search history.

- D471,061 S 3/2003 Kerman
- 6,530,126 B2 3/2003 Caveney et al.
- D471,065 S 4/2003 Kerman
- D473,424 S * 4/2003 Kerman D7/396.2
- D476,526 S 7/2003 Kerman
- D489,572 S 5/2004 Bastianich
- D506,355 S 6/2005 Donnellan
- D554,856 S 11/2007 Clanton
- D555,033 S * 11/2007 Perkins D11/117
- D576,789 S * 9/2008 Mayer D3/215
- D590,885 S * 4/2009 Love D19/65
- D593,245 S * 5/2009 Kasatshko D26/73

(Continued)

OTHER PUBLICATIONS

<https://www.etsy.com/listing/517622400/set-of-ten-breast-cancer-ribbon-party> (Year: 2019).*

(Continued)

Primary Examiner — Jae Liang
(74) *Attorney, Agent, or Firm* — Mark D. Bowen; Malin Haley DiMaggio & Bowen, P.A.

(57) **CLAIM**

The ornamental design for a wine glass stem, as shown and described.

DESCRIPTION

FIG. 1 is a top perspective view of a wine glass stem in accordance with the present invention; FIG. 2 is a side elevational view thereof, with the opposite side view being identical; FIG. 3 is a front view thereof, with the rear view being identical; FIG. 4 is a bottom perspective view thereof; FIG. 5 is a top view thereof; and, FIG. 6 is a bottom view thereof. The broken lines in FIGS. 1-6 illustrating the glass and the foot are for environmental purposes only and form no part of the claimed design.

1 Claim, 6 Drawing Sheets

- (56) **References Cited**
U.S. PATENT DOCUMENTS
- D35,362 S 12/1901 Pick
- D48,809 S 4/1916 Baldwin
- D164,618 S 9/1951 Yuchtman
- D271,653 S 12/1983 Boehm
- D283,660 S 5/1986 Blake
- D345,082 S * 3/1994 Wenzl D7/387
- D442,825 S 5/2001 Svestkova
- D453,282 S 2/2002 Achenbach
- D459,632 S 7/2002 Kerman



(56)

References Cited

U.S. PATENT DOCUMENTS

D609,049 S 2/2010 Solhendler
D609,529 S * 2/2010 Tamale D7/525
D639,700 S * 6/2011 Adams D11/95
D644,873 S 9/2011 Lizarazu
D646,949 S * 10/2011 Zaksenberg D8/103
D666,938 S * 9/2012 Dunn D11/184
D672,608 S * 12/2012 Goldwire D7/396.2
D677,332 S * 3/2013 Kent D19/69
D679,945 S * 4/2013 Romley D7/524
D687,737 S * 8/2013 Japel D11/96
D700,731 S * 3/2014 Schwartz D26/68
D717,604 S 11/2014 Klinge
D723,967 S * 3/2015 Youkhana D11/14
D764,307 S * 8/2016 Evans D9/535
D824,801 S * 8/2018 Spencer D11/200
2007/0257048 A1 11/2007 Towery
2013/0206781 A1 8/2013 MacCormick
2016/0143465 A1 5/2016 Anderson

OTHER PUBLICATIONS

https://www.orientaltrading.com/pink-ribbon-jewels-a2-41_1258.fltr?keyword=Pink+Ribbon+Jewels (Year: 2017).*
<https://www.thingiverse.com/thing:1805118> (Year: 2016).*

* cited by examiner

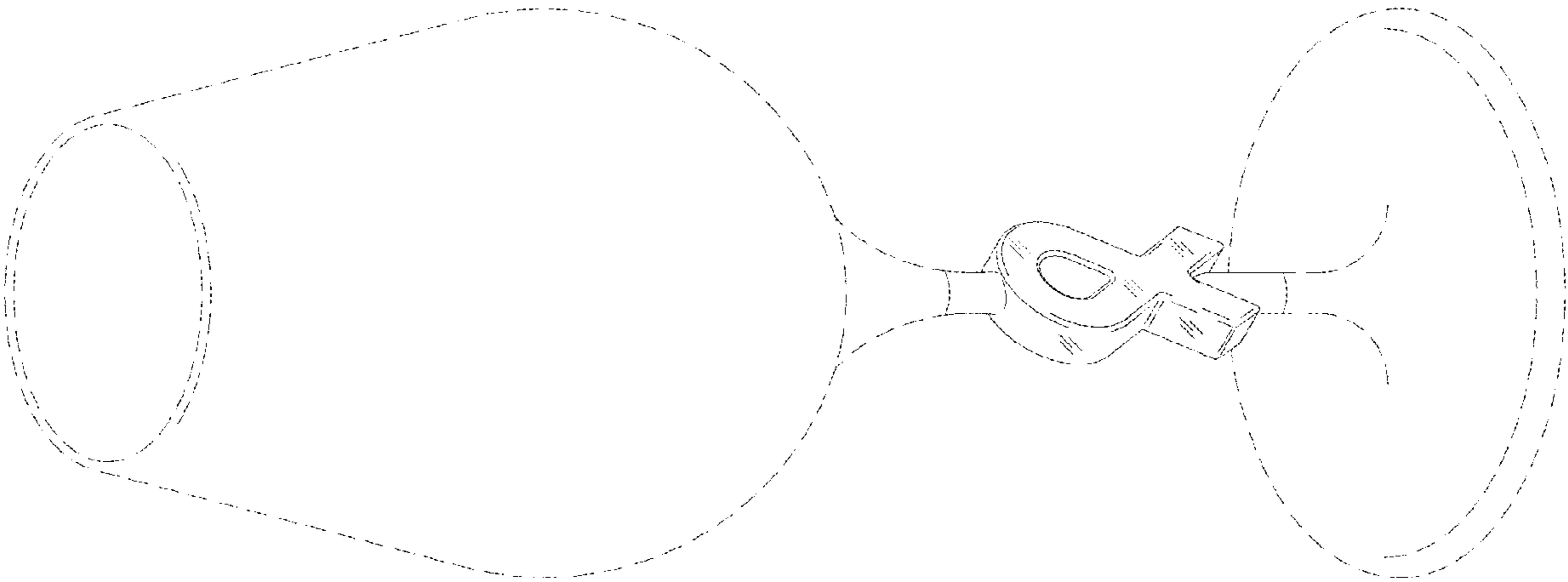

FIG. 1

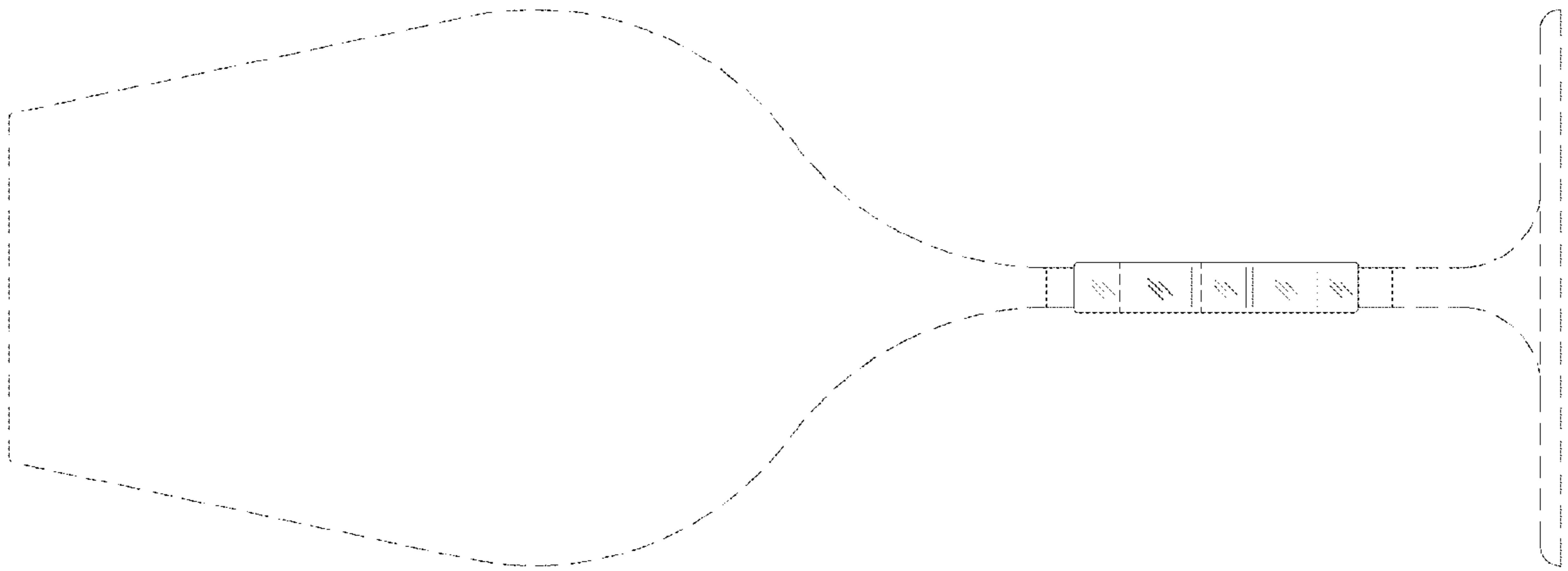

FIG. 2

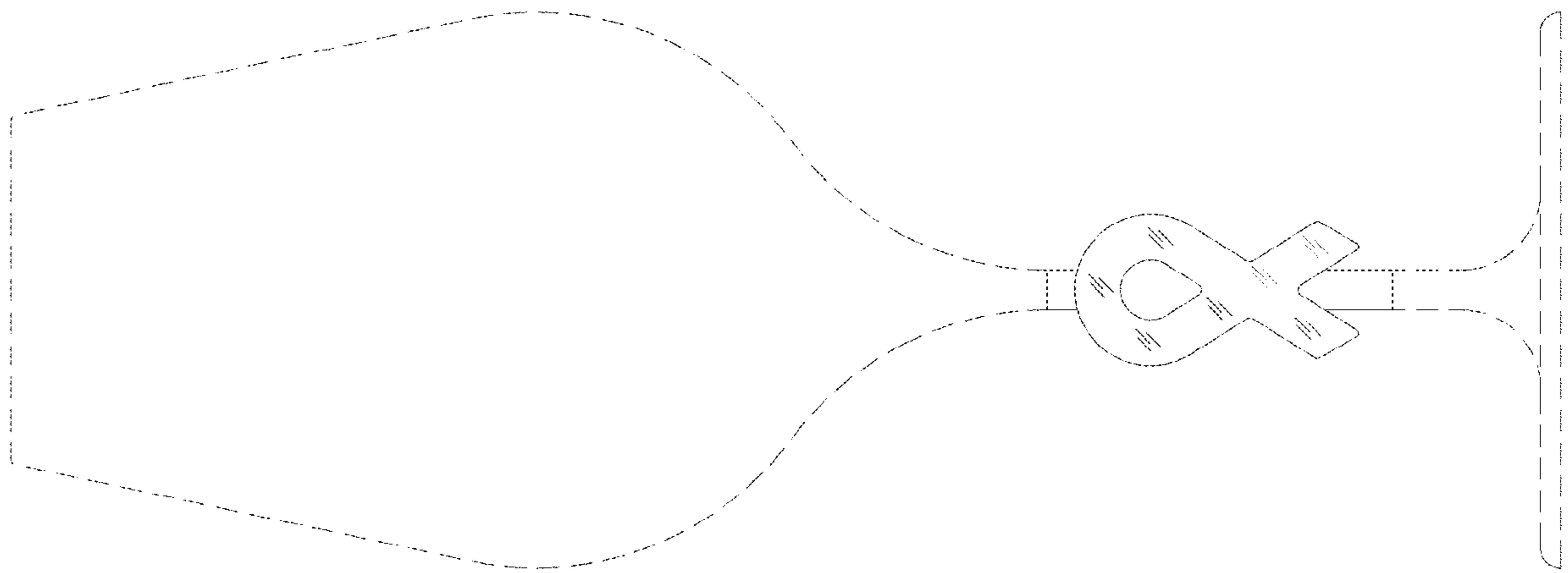

FIG. 3

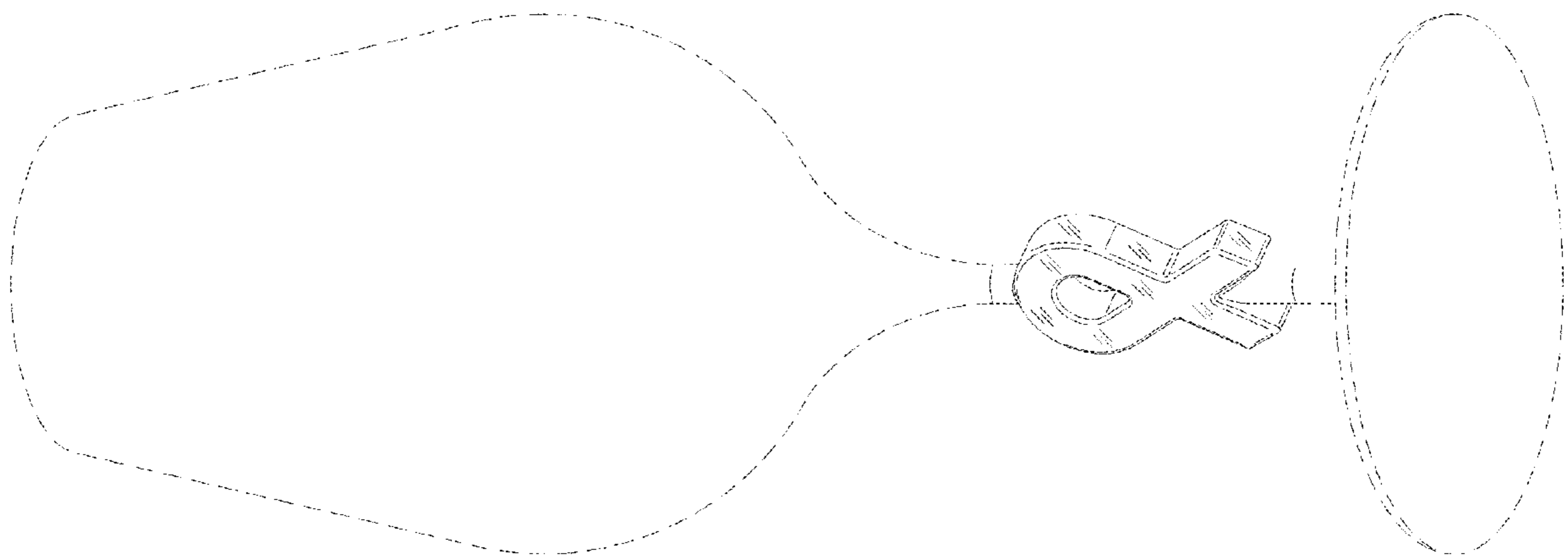

FIG. 4

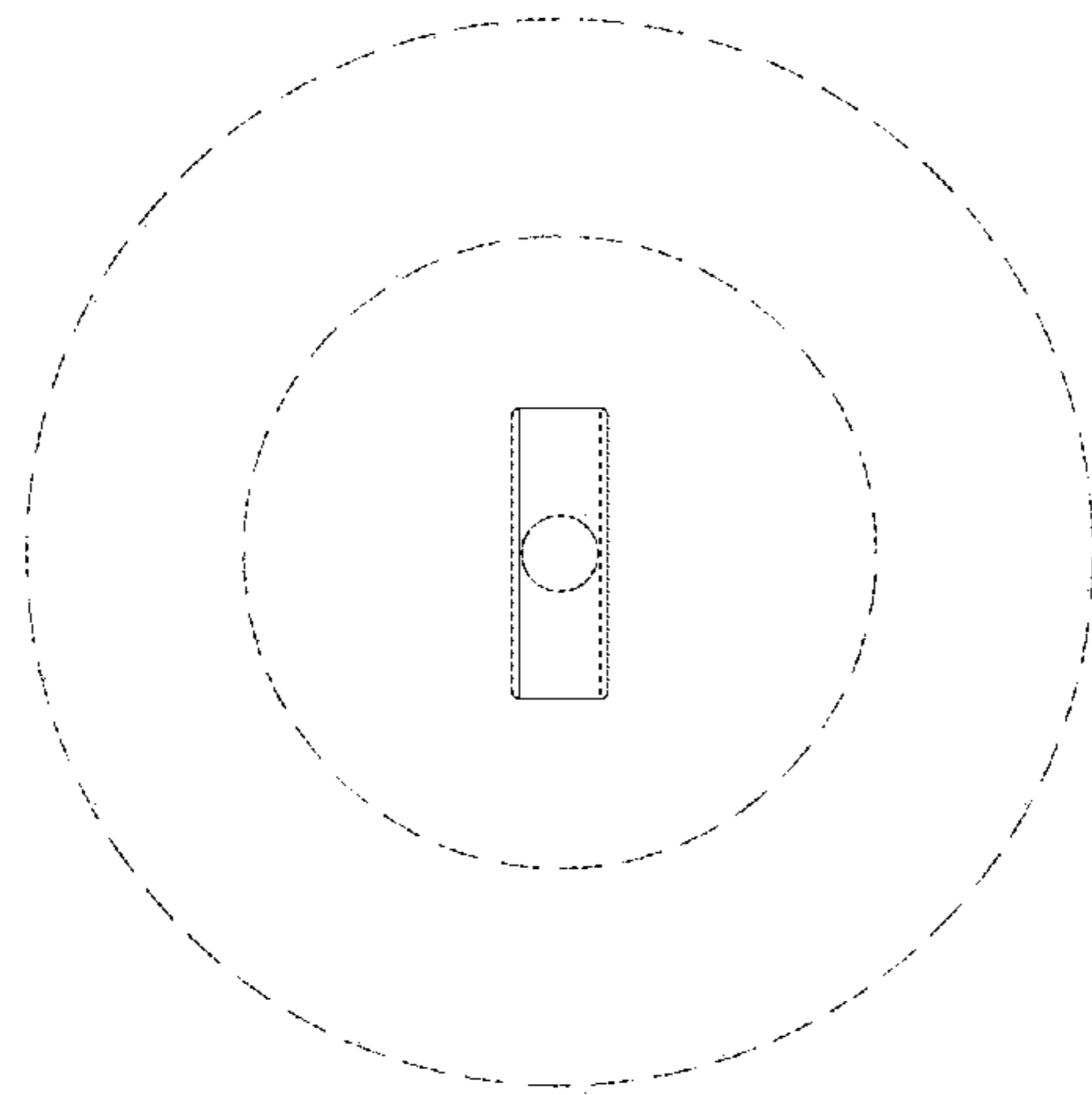

FIG. 5

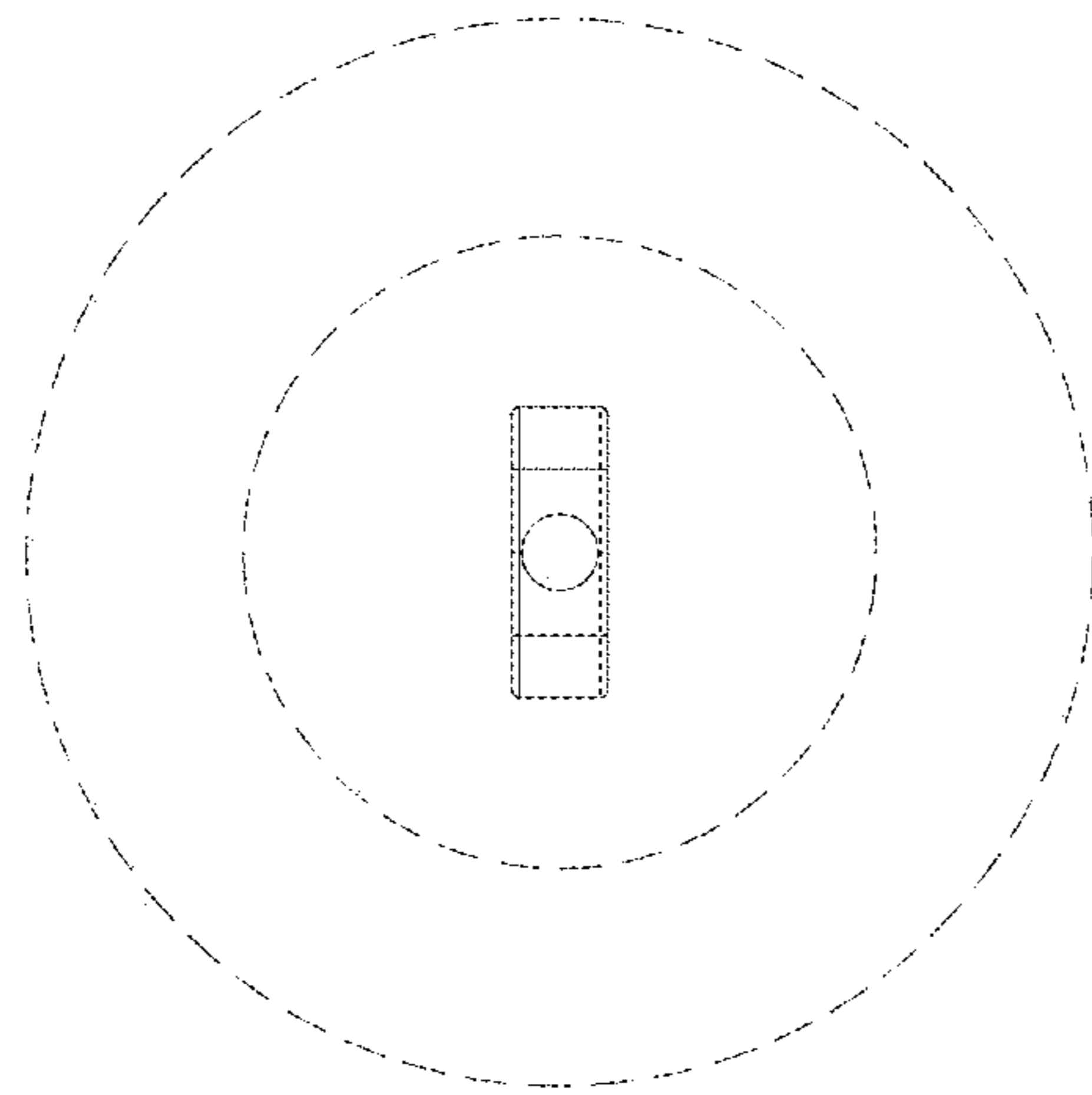

FIG. 6