



US00D877582S

(12) **United States Design Patent**  
**Tamura**

(10) **Patent No.:** **US D877,582 S**

(45) **Date of Patent:** **\*\* Mar. 10, 2020**

(54) **SOCKET WRENCH**

(71) Applicant: **ZAMA JAPAN KABUSHIKI  
KAISHA**, Iwate (JP)

(72) Inventor: **Mineyuki Tamura**, Iwate (JP)

(73) Assignee: **ZAMA JAPAN KABUSHIKI  
KAISHA**, Iwate (JP)

(\*\*) Term: **15 Years**

(21) Appl. No.: **29/592,360**

(22) Filed: **Jan. 30, 2017**

(51) **LOC (12) Cl.** ..... **08-05**

(52) **U.S. Cl.**  
USPC ..... **D8/29; D8/85**

(58) **Field of Classification Search**  
USPC ..... D8/29, 85, 86; 81/60, 177.1, 177.85,  
81/121.1, 124.3, 165-170, 110.1, 176.2,  
81/124.6, 176.1, 176.15, 177.2, 186;  
16/110.1  
CPC ..... B25B 13/06; B25B 13/065  
See application file for complete search history.

(56) **References Cited**

**U.S. PATENT DOCUMENTS**

4,930,378	A *	6/1990	Colvin	.....	B25B 13/065 411/403
5,012,706	A *	5/1991	Wright	.....	B25B 13/065 411/403
5,284,073	A *	2/1994	Wright	.....	B25B 13/065 81/121.1
5,595,096	A *	1/1997	Coffman	.....	B25B 13/04 81/121.1
5,617,624	A *	4/1997	Walker	.....	B25B 13/06 29/245

D523,305	S *	6/2006	Dexter	.....	D8/29
D570,657	S *	6/2008	Hsieh	.....	D8/29
D637,051	S *	5/2011	Li	.....	D8/29
8,333,134	B1 *	12/2012	Duffy	.....	B25B 13/06 81/121.1
D750,457	S *	3/2016	Li	.....	D8/29

\* cited by examiner

*Primary Examiner* — Randall H Gholson

(74) *Attorney, Agent, or Firm* — One LLP

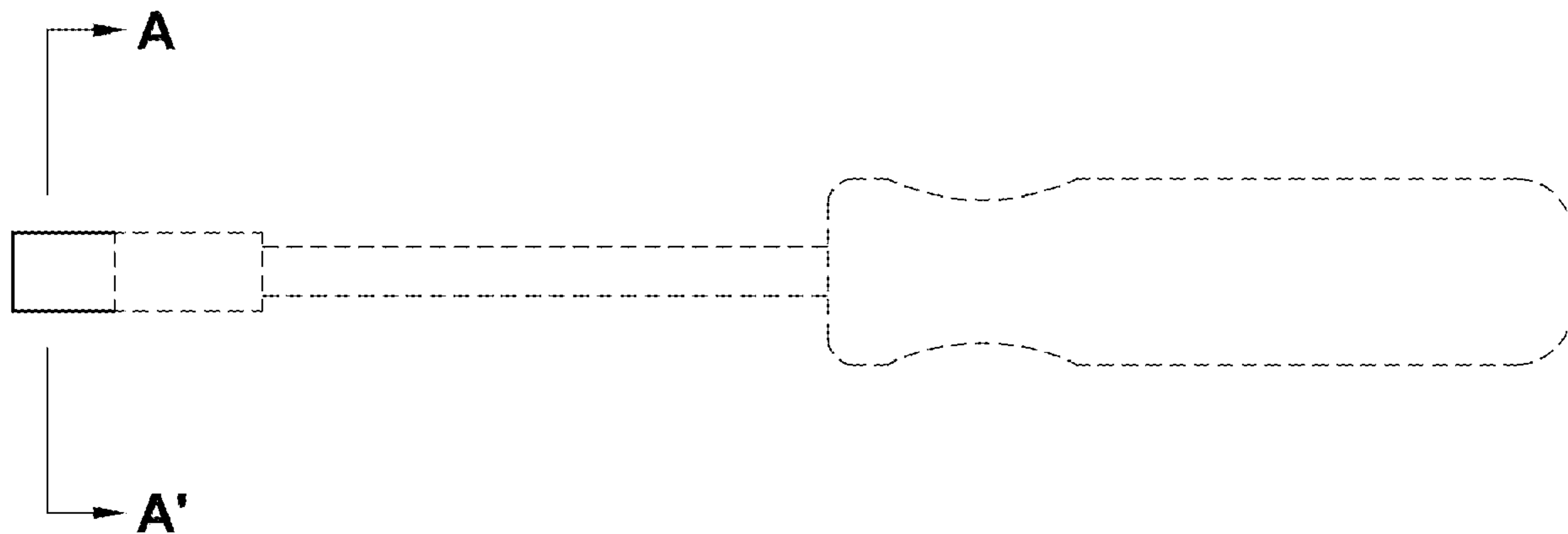
(57) **CLAIM**

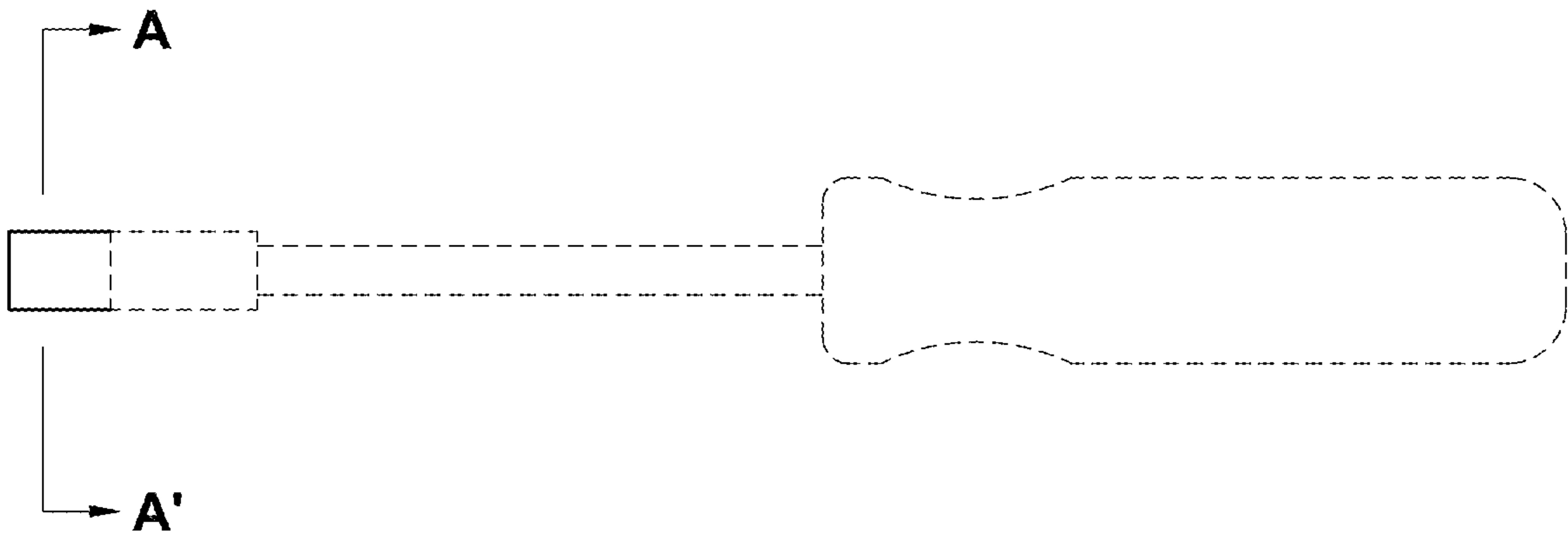
The ornamental design for a socket wrench, as shown and described.

**DESCRIPTION**

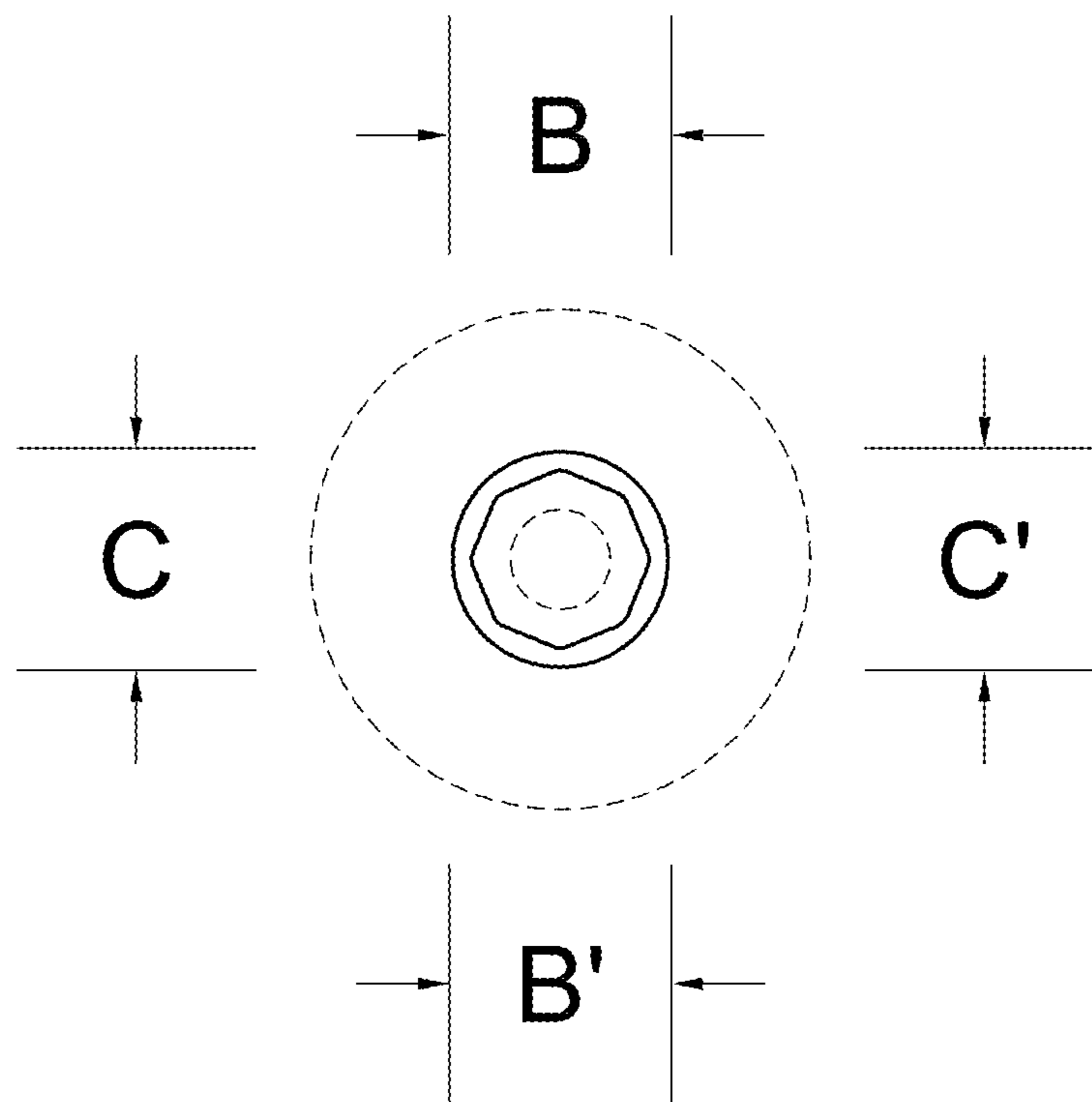
FIG. 1 is a front, plan view of the socket wrench, showing the new design;  
 FIG. 2 is a left side, end elevation view of the socket wrench from FIG. 1;  
 FIG. 3 is a right side, end elevation view of the socket wrench from FIG. 1;  
 FIG. 4 is a cross-sectional view of the socket wrench from FIG. 1 taken along line A-A';  
 FIG. 5 is a detail view of the socket wrench from FIG. 2 taken along lines B-B' and C-C';  
 FIG. 6 is a cross-sectional view of the socket wrench from FIG. 5 taken along line D-D'; and,  
 FIG. 7 is an exploded assembly perspective view thereof, showing the new design in a state of use with a needle valve for carburetors.  
 The broken lines shown in the drawings show unclaimed subject matter and environment only and form no part of the claimed design.

**1 Claim, 5 Drawing Sheets**

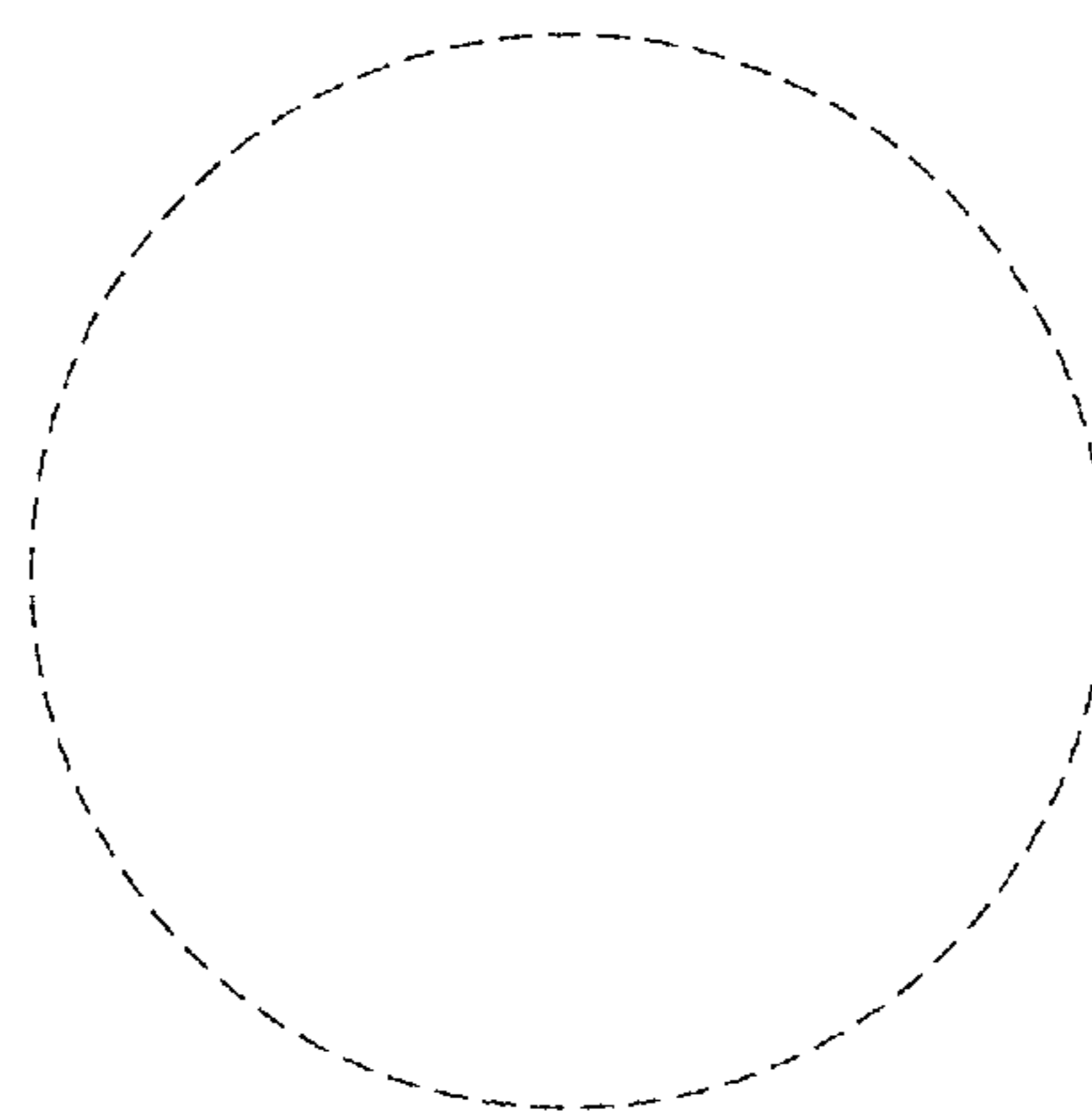




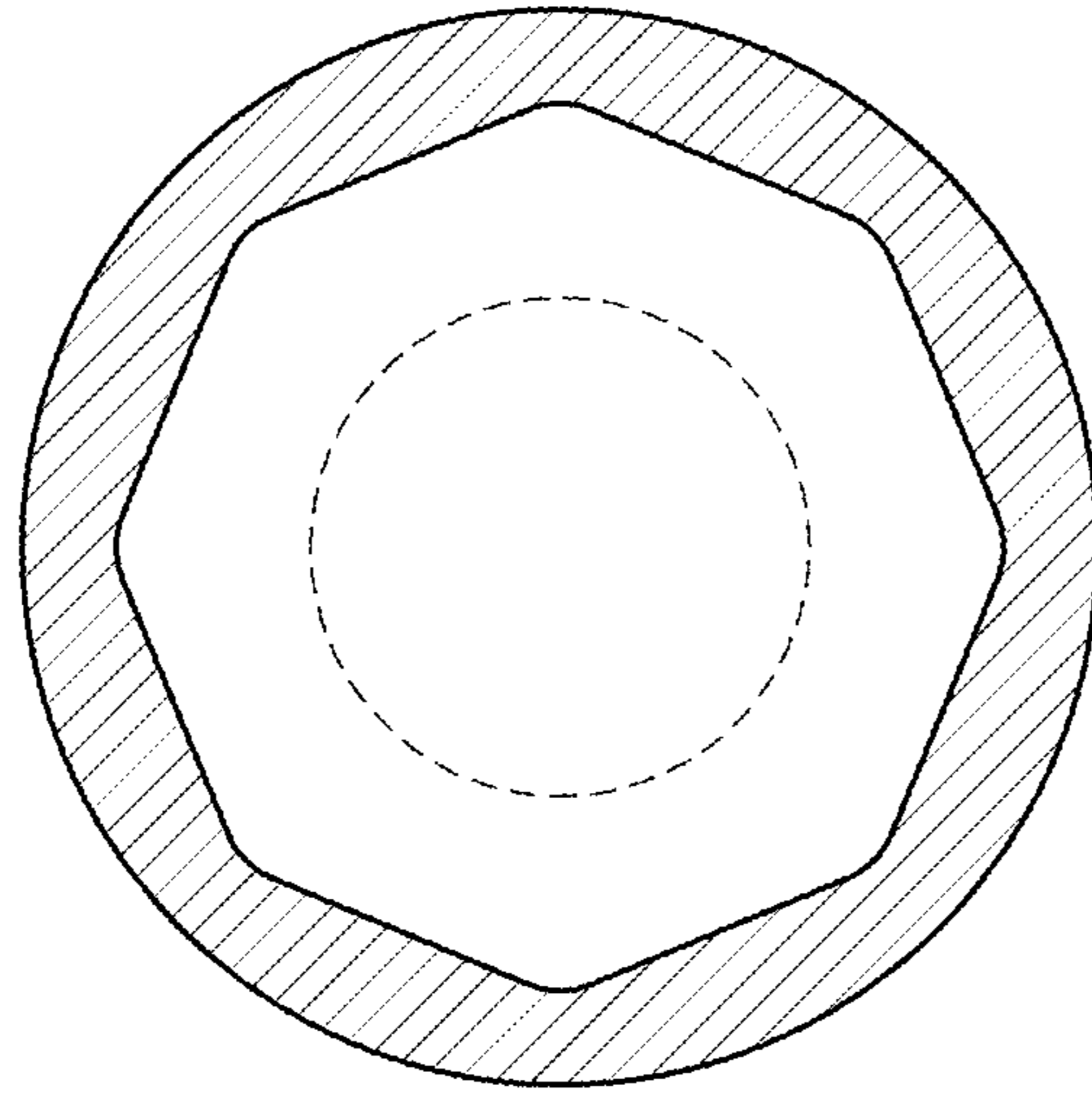
**FIG. 1**



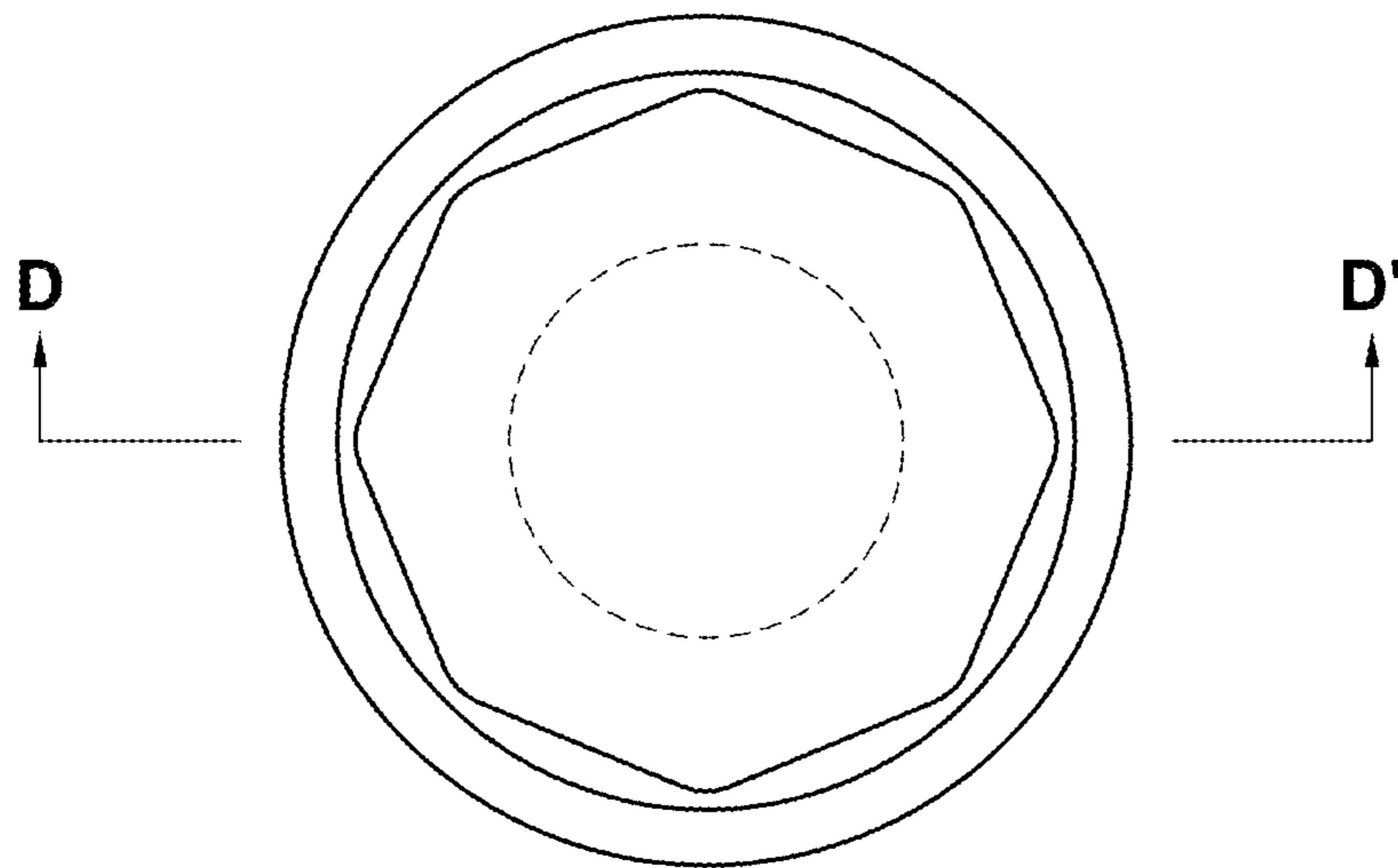
**FIG. 2**



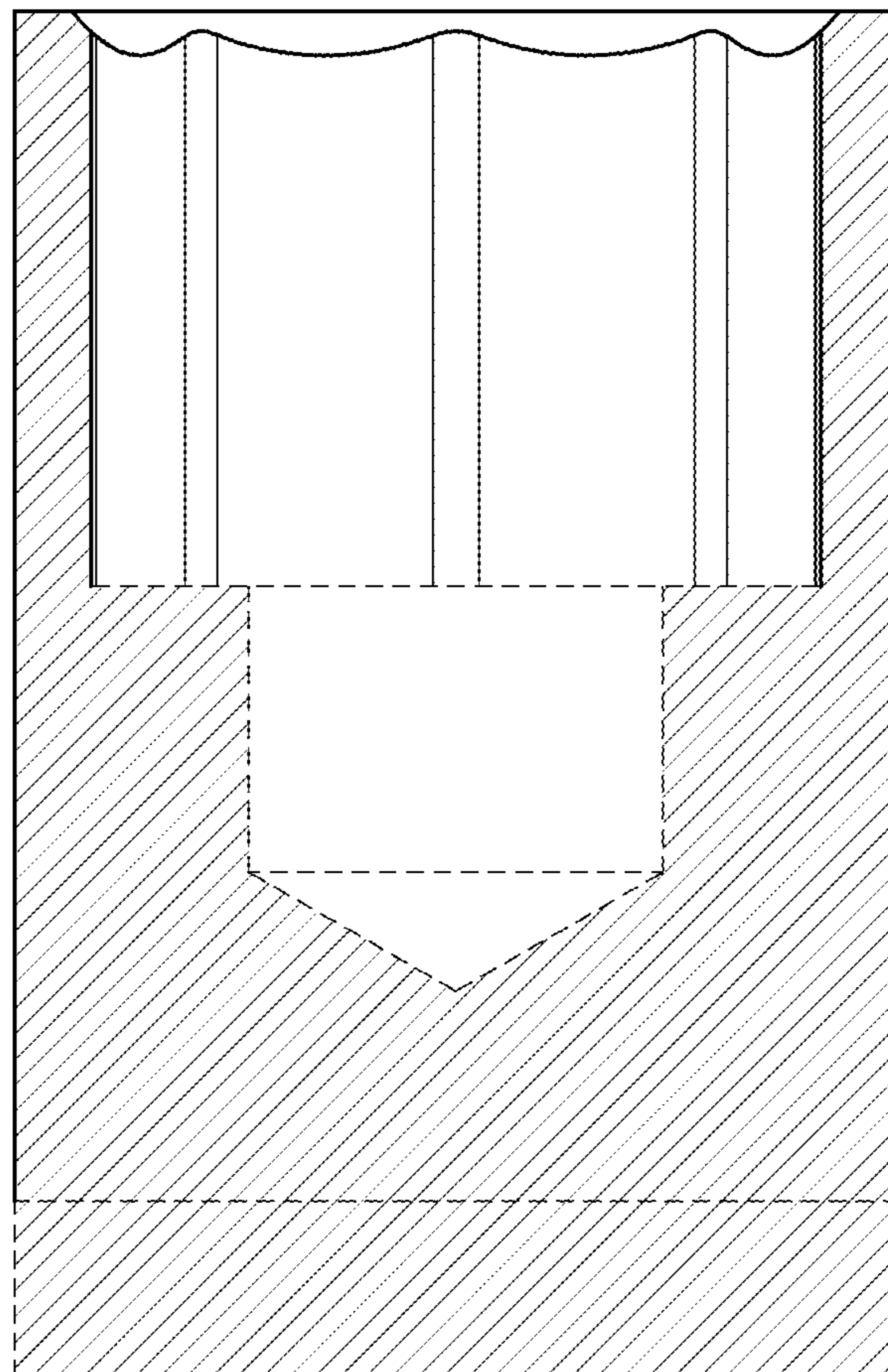
**FIG. 3**



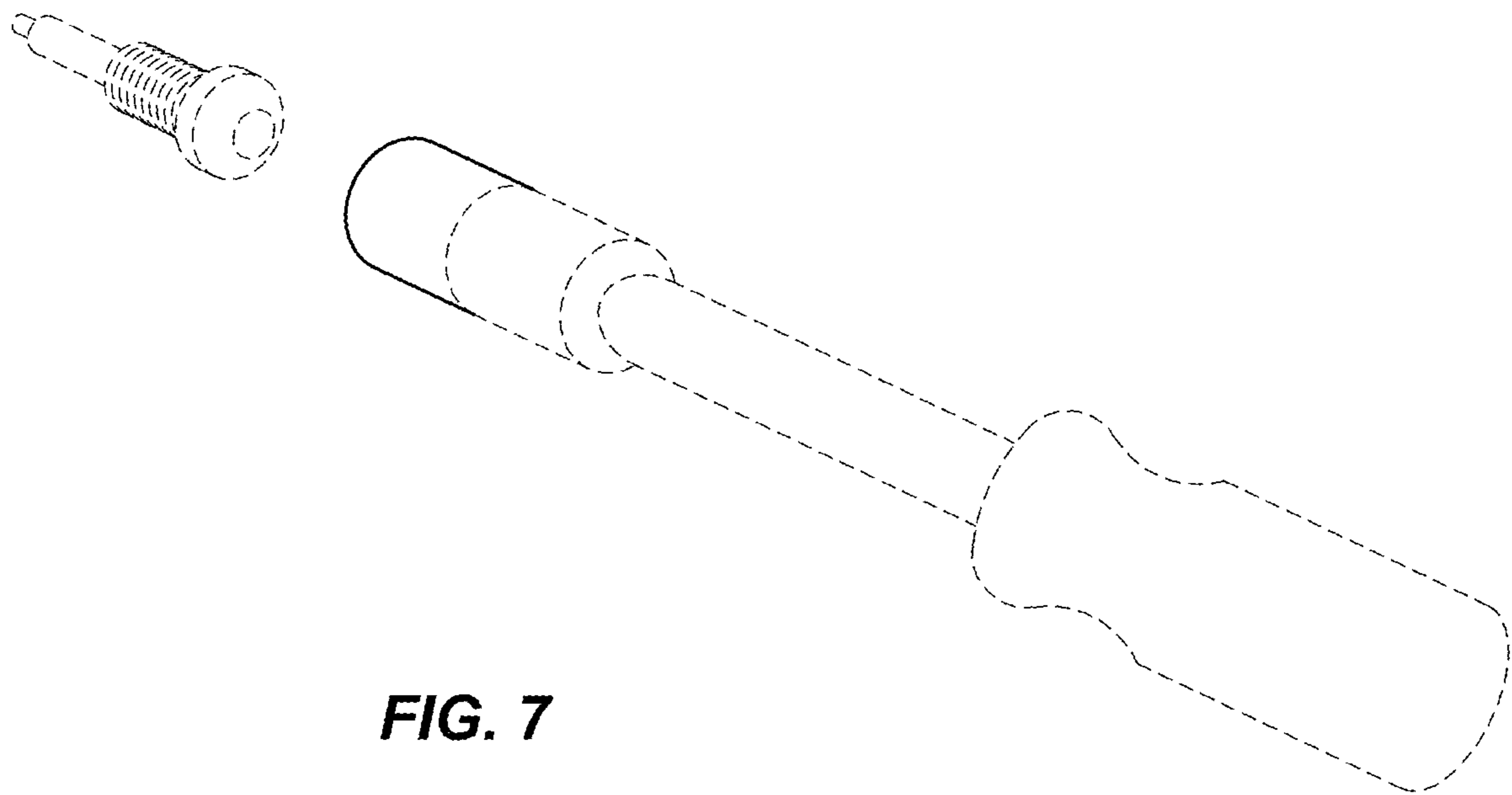
**FIG. 4**



**FIG. 5**



**FIG. 6**



**FIG. 7**