



US00D877015S

(12) **United States Design Patent**
Chen et al.

(10) **Patent No.:** **US D877,015 S**
(45) **Date of Patent:** **** Mar. 3, 2020**

(54) **CENTERLOCK WHEEL ASSEMBLY**

(71) Applicant: **Revel Wheels, LLC**, Baldwin Park, CA (US)

(72) Inventors: **Billy Chen**, Baldwin Park, CA (US);
Paul Yang, Baldwin Park, CA (US);
David Tran, Baldwin Park, CA (US)

(73) Assignee: **Revel Wheels, L.L.C.**, Baldwin Park, CA (US)

(**) Term: **15 Years**

(21) Appl. No.: **29/626,641**

(22) Filed: **Nov. 17, 2017**

(51) **LOC (12) Cl.** **12-16**

(52) **U.S. Cl.**
USPC **D12/207**

(58) **Field of Classification Search**
USPC D12/207, 180, 204, 213
CPC B60B 3/142
See application file for complete search history.

(56) **References Cited**

U.S. PATENT DOCUMENTS

| | | | | | |
|-----------|-----|---------|---------------|-------|-------------------------|
| 3,425,760 | A * | 2/1969 | Gordon | | F16C 35/061 384/563 |
| 4,138,160 | A * | 2/1979 | Lohmeyer | | B60B 7/14 301/108.4 |
| 4,478,458 | A * | 10/1984 | Flexman | | B60B 3/14 301/35.57 |
| 5,352,026 | A * | 10/1994 | Snook | | B60B 1/042 301/105.1 |
| 5,492,391 | A * | 2/1996 | Snook | | B60B 1/042 301/105.1 |
| 5,533,794 | A * | 7/1996 | Faison | | B60B 27/00 301/105.1 |
| 5,820,224 | A * | 10/1998 | Dimatteo, Jr. | | B60B 1/042 301/35.58 |
| 5,887,952 | A * | 3/1999 | Gandellini | | B60B 3/02 301/35.58 |

(Continued)

Primary Examiner — Kevin K Rudzinski

(74) *Attorney, Agent, or Firm* — Rutan & Tucker LLP;
Hami Z. Sayed

(57) **CLAIM**

The ornamental design for centerlock wheel assembly, as shown and described.

DESCRIPTION

FIG. 1—Top, front, right side perspective view of the tool, cap, nut, hub assembly of the centerlock wheel assembly;
 FIG. 2—Cross-section view taken along line 2-2 of FIG. 1;
 FIG. 3—Top, front, right side exploded perspective view of the assembly of FIG. 1;
 FIG. 4—Front elevation view of the tool of FIG. 3;
 FIG. 5—Rear elevation view of the tool of FIG. 3;
 FIG. 6—Right side elevation view of the tool of FIG. 3;
 FIG. 7—Cross-section view taken along line 7-7 of FIG. 4;
 FIG. 8—Front elevation view of the cap of FIG. 3;
 FIG. 9—Rear elevation view of the cap of FIG. 3;
 FIG. 10—Right side elevation view of the cap of FIG. 3;
 FIG. 11—Cross-section view taken along line 11-11 of FIG. 8;
 FIG. 12—Front elevation view of the nut of FIG. 3;
 FIG. 13—Rear elevation view of the nut of FIG. 3;
 FIG. 14—Right side elevation view of the nut of FIG. 3;
 FIG. 15—Cross-section view taken along line 15-15 of FIG. 12;
 FIG. 16—Front elevation view of the hub of FIG. 3;
 FIG. 17—Rear elevation view of the hub of FIG. 3;
 FIG. 18—Right side elevation view of the hub of FIG. 3;
 and,
 FIG. 19—Cross-section view taken along line 19-19 of FIG. 16.

1 Claim, 8 Drawing Sheets

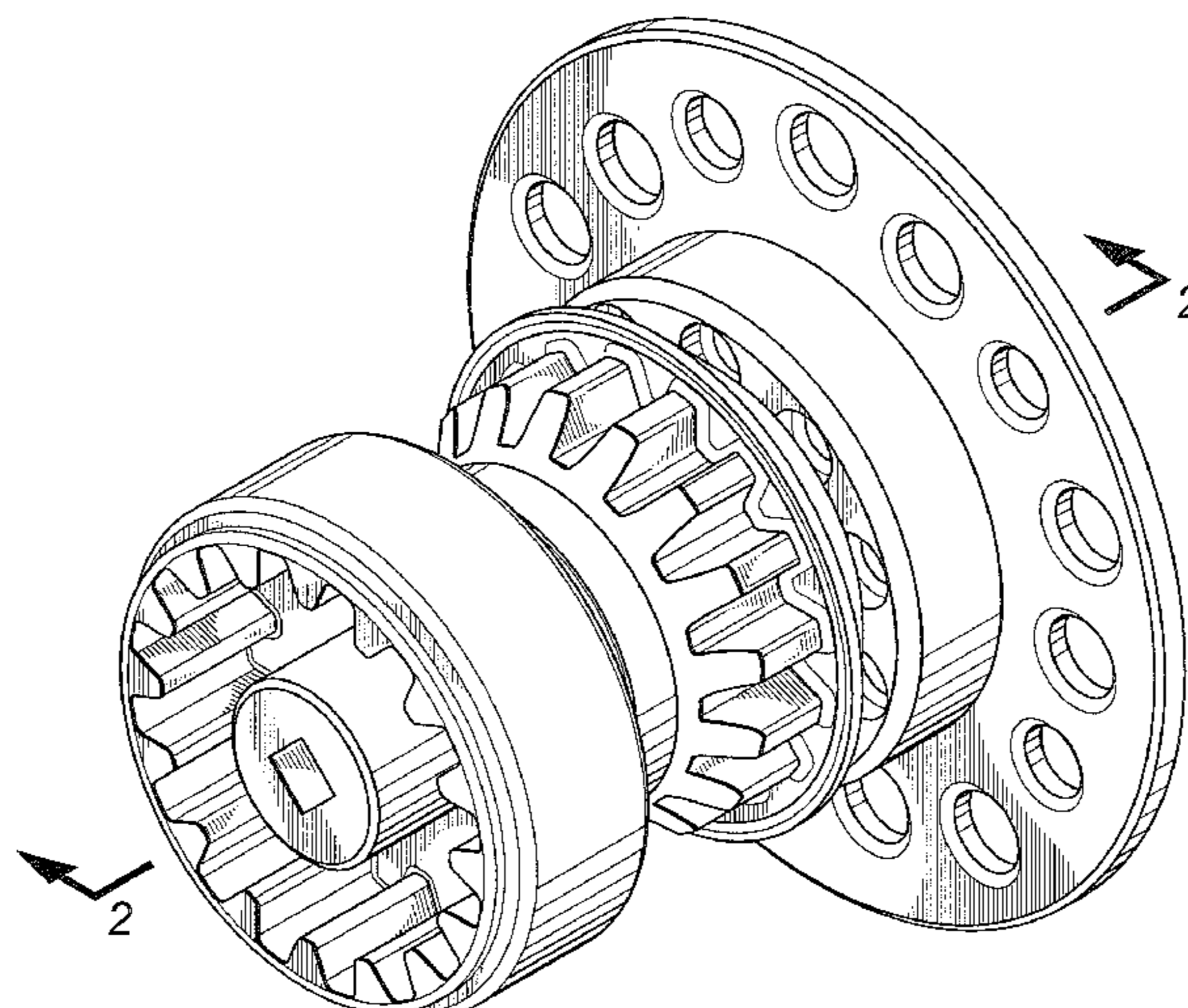

(56)

References Cited

U.S. PATENT DOCUMENTS

| | | | | | |
|--------------|------|---------|---------|-------|--------------|
| 6,116,700 | A * | 9/2000 | Herrera | | B60B 3/142 |
| | | | | | 301/111.02 |
| 6,322,158 | B1 * | 11/2001 | Herrera | | B60B 3/14 |
| | | | | | 301/111.04 |
| 6,398,311 | B1 * | 6/2002 | Necaise | | B60B 3/16 |
| | | | | | 301/108.4 |
| D662,869 | S * | 7/2012 | Ballard | | D12/213 |
| 8,739,585 | B2 * | 6/2014 | Sims | | B60B 3/165 |
| | | | | | 301/37.21 |
| D776,038 | S * | 1/2017 | Hensel | | D12/207 |
| 9,897,154 | B2 * | 2/2018 | Root | | B60B 27/0052 |
| D823,212 | S * | 7/2018 | Prasad | | D12/207 |
| 10,112,436 | B2 * | 10/2018 | Denmead | | B60B 3/14 |
| 2007/0096546 | A1 * | 5/2007 | Thomas | | B60B 3/142 |
| | | | | | 301/108.5 |
| 2009/0267405 | A1 * | 10/2009 | Ballard | | B60B 3/08 |
| | | | | | 301/105.1 |

* cited by examiner

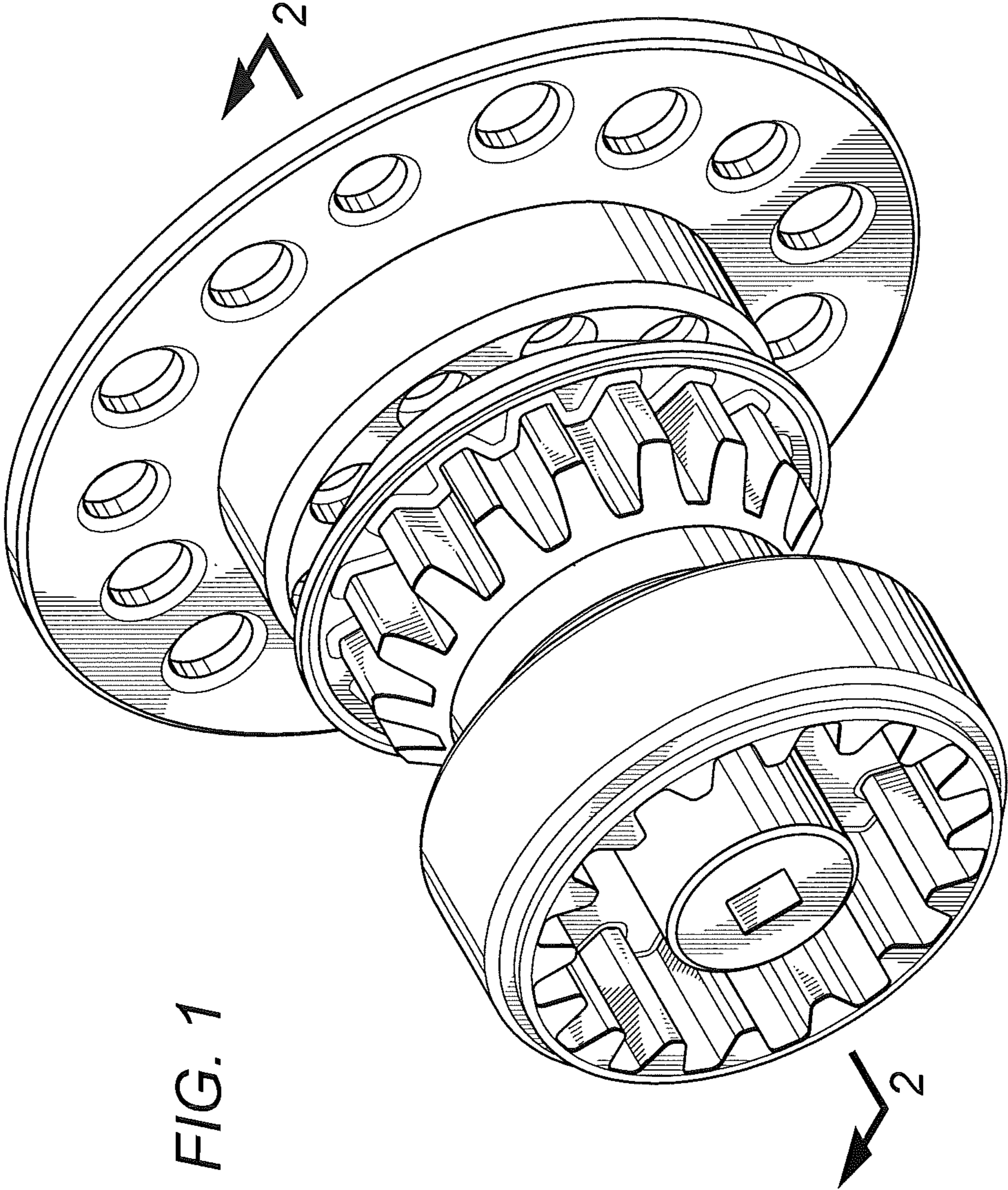

FIG. 1

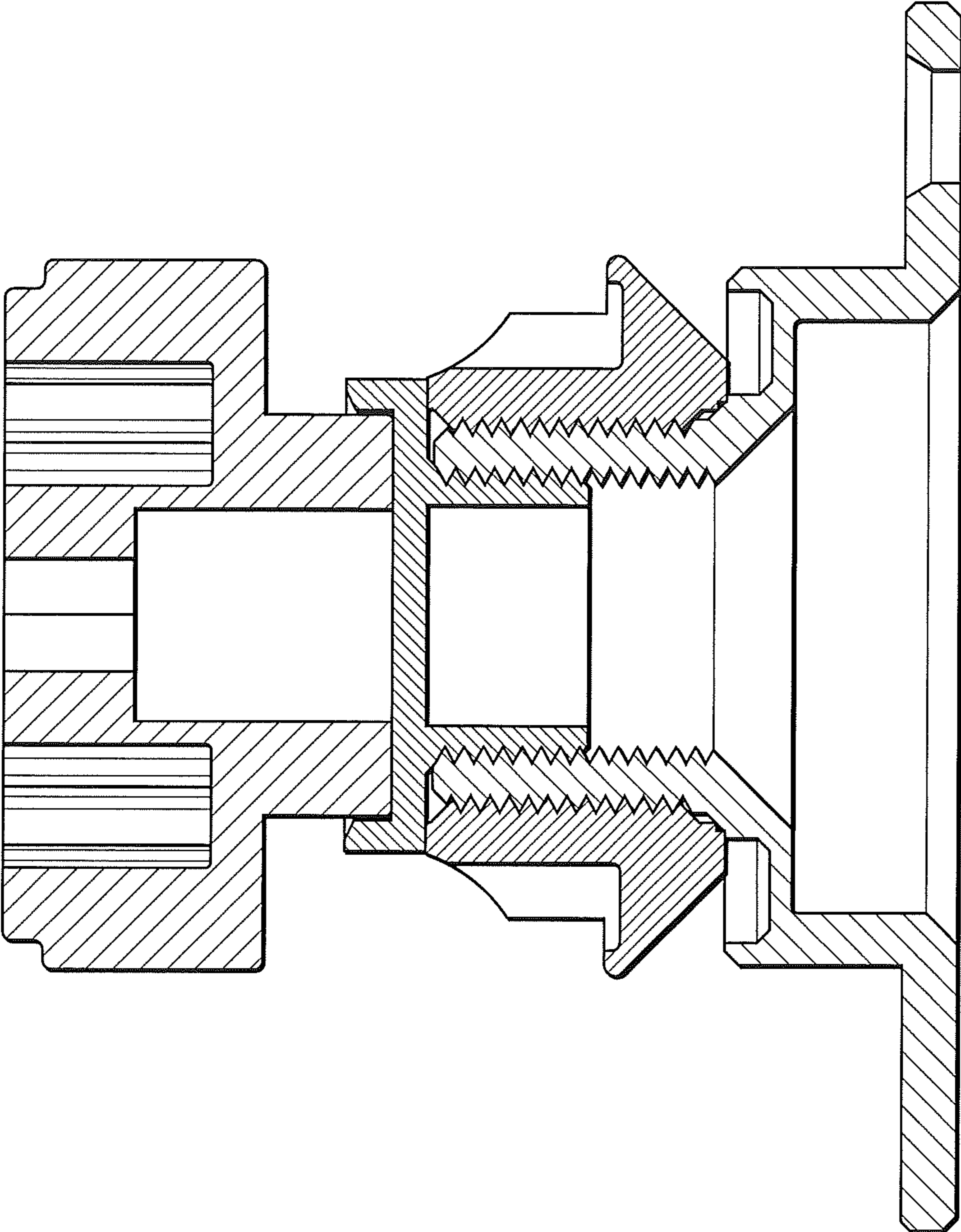

FIG. 2

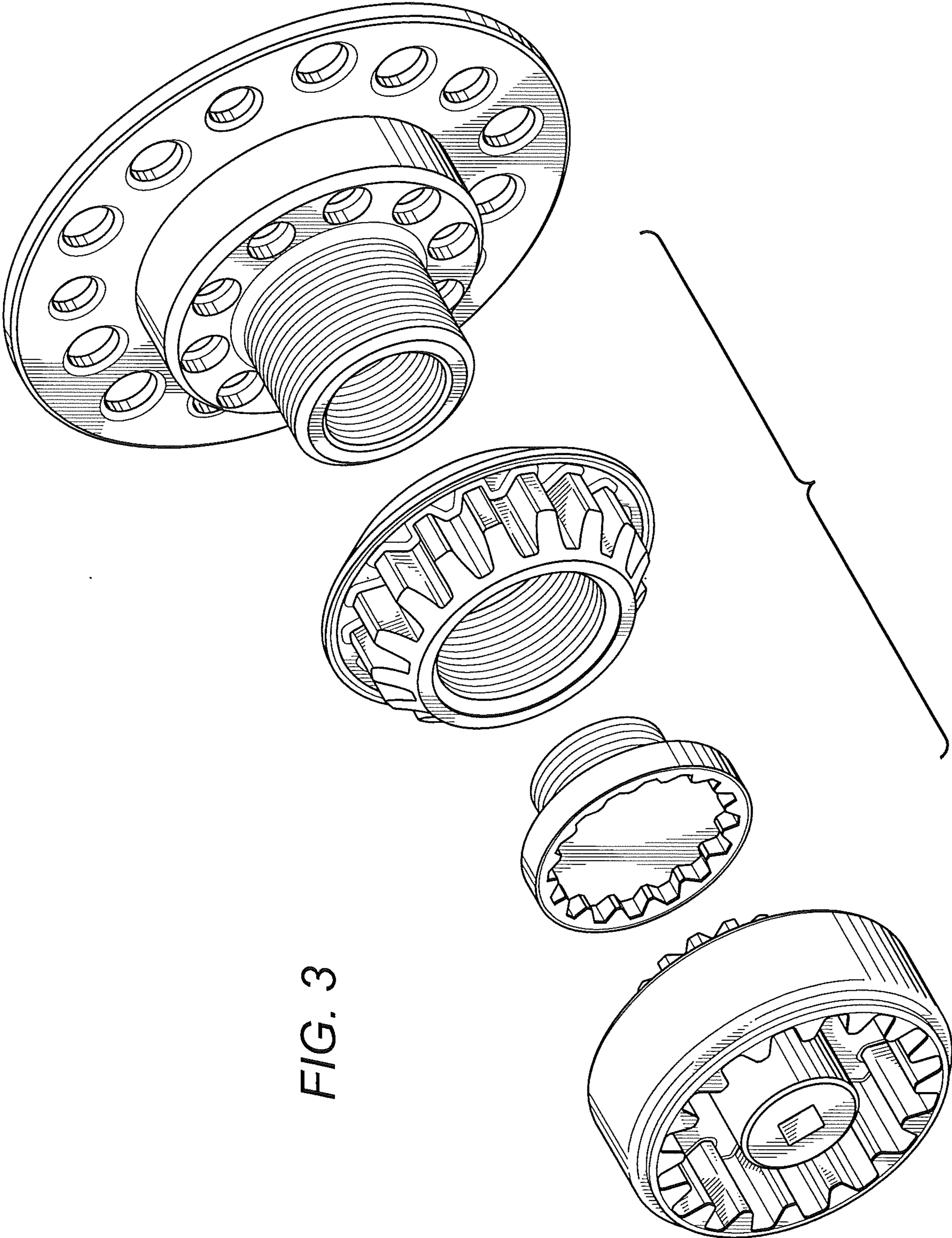

FIG. 3

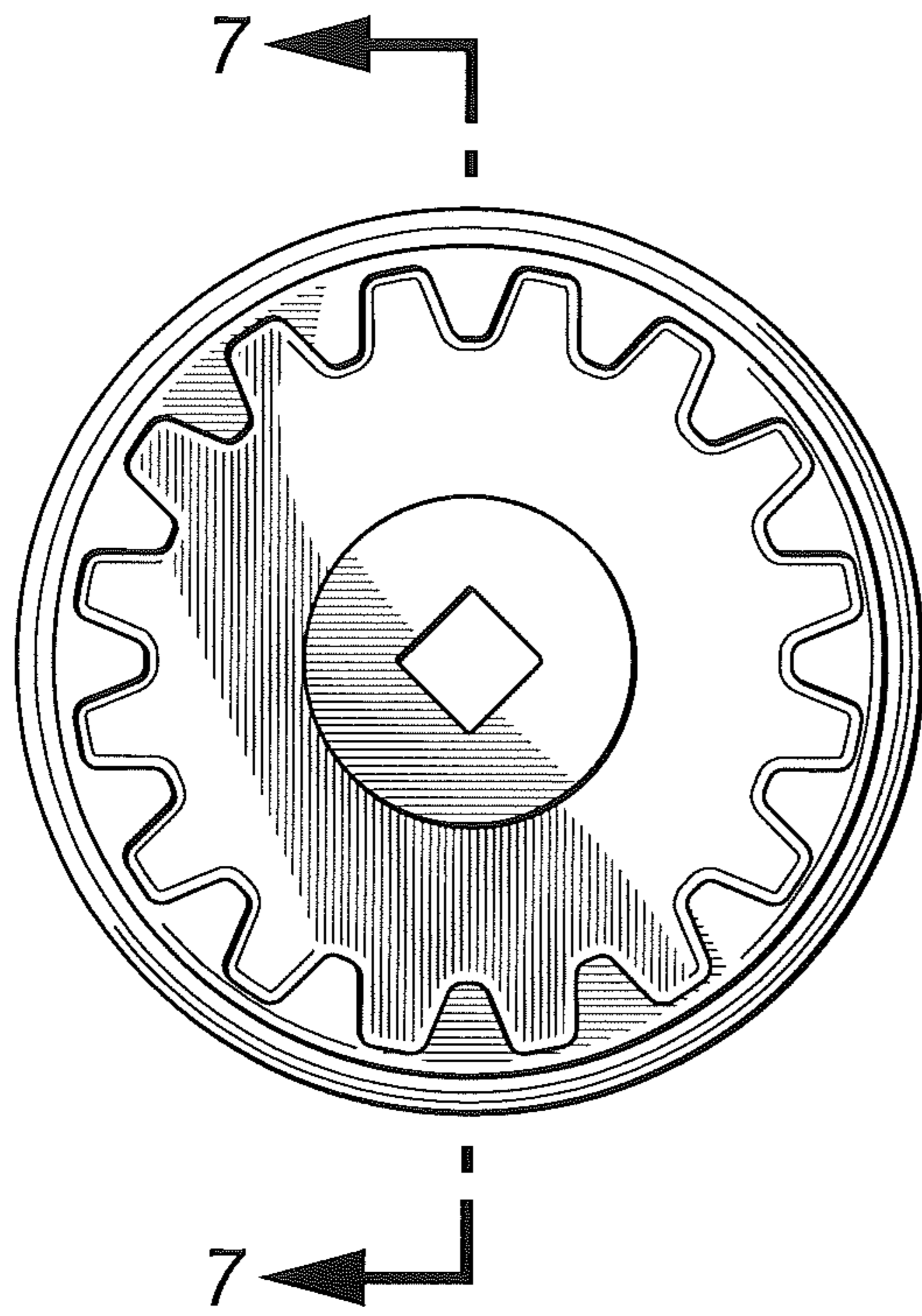

FIG. 4

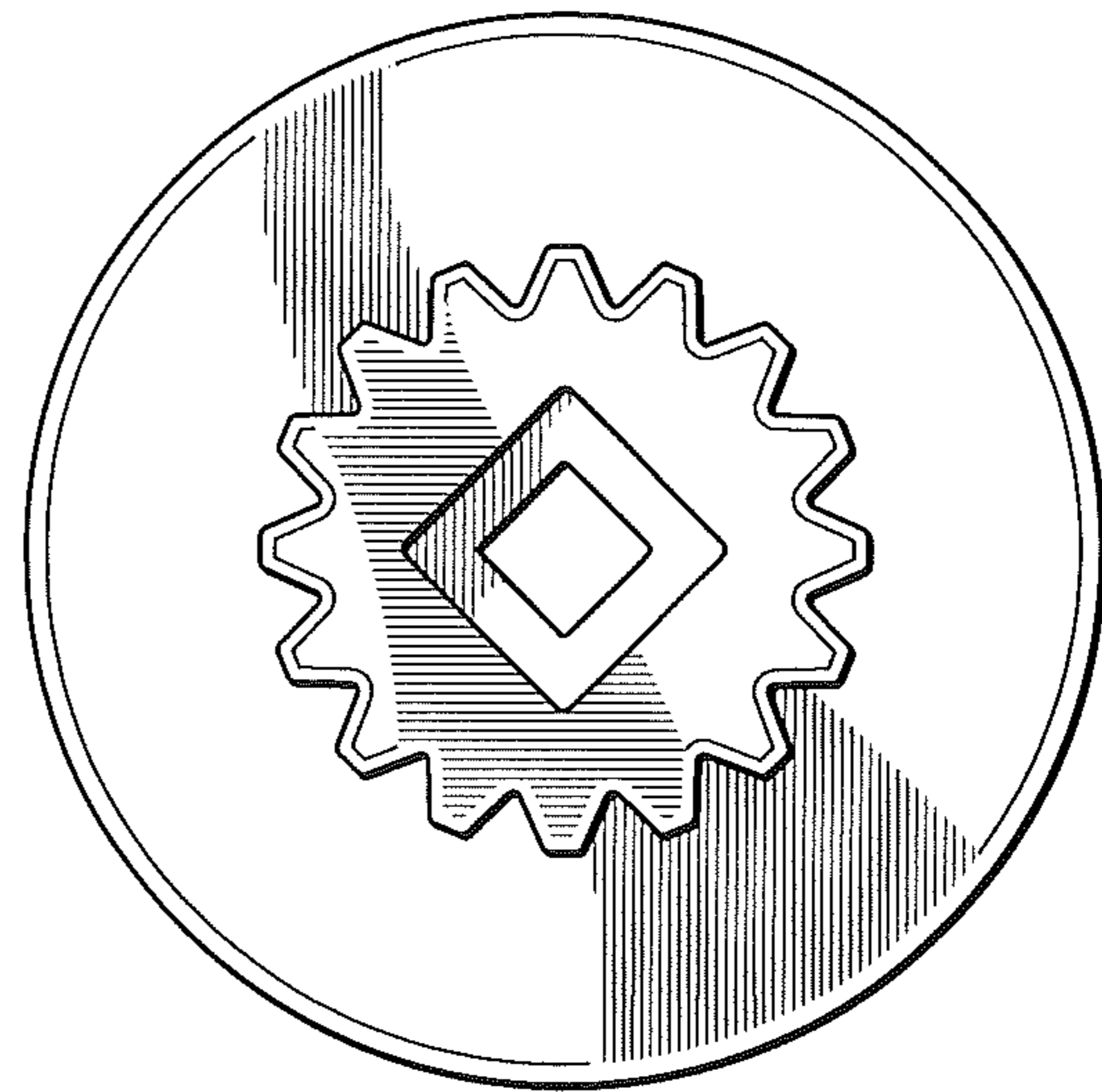

FIG. 5

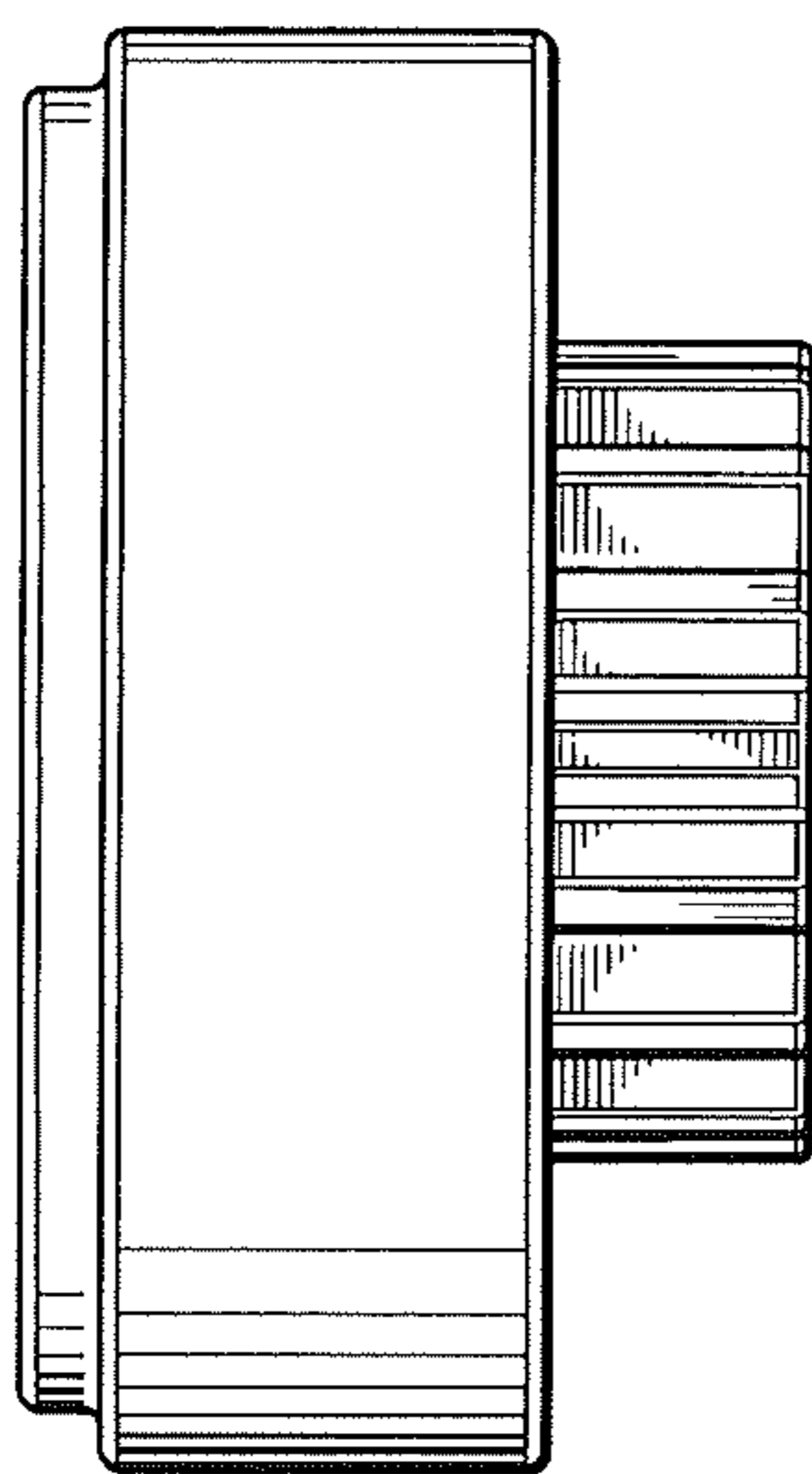

FIG. 6

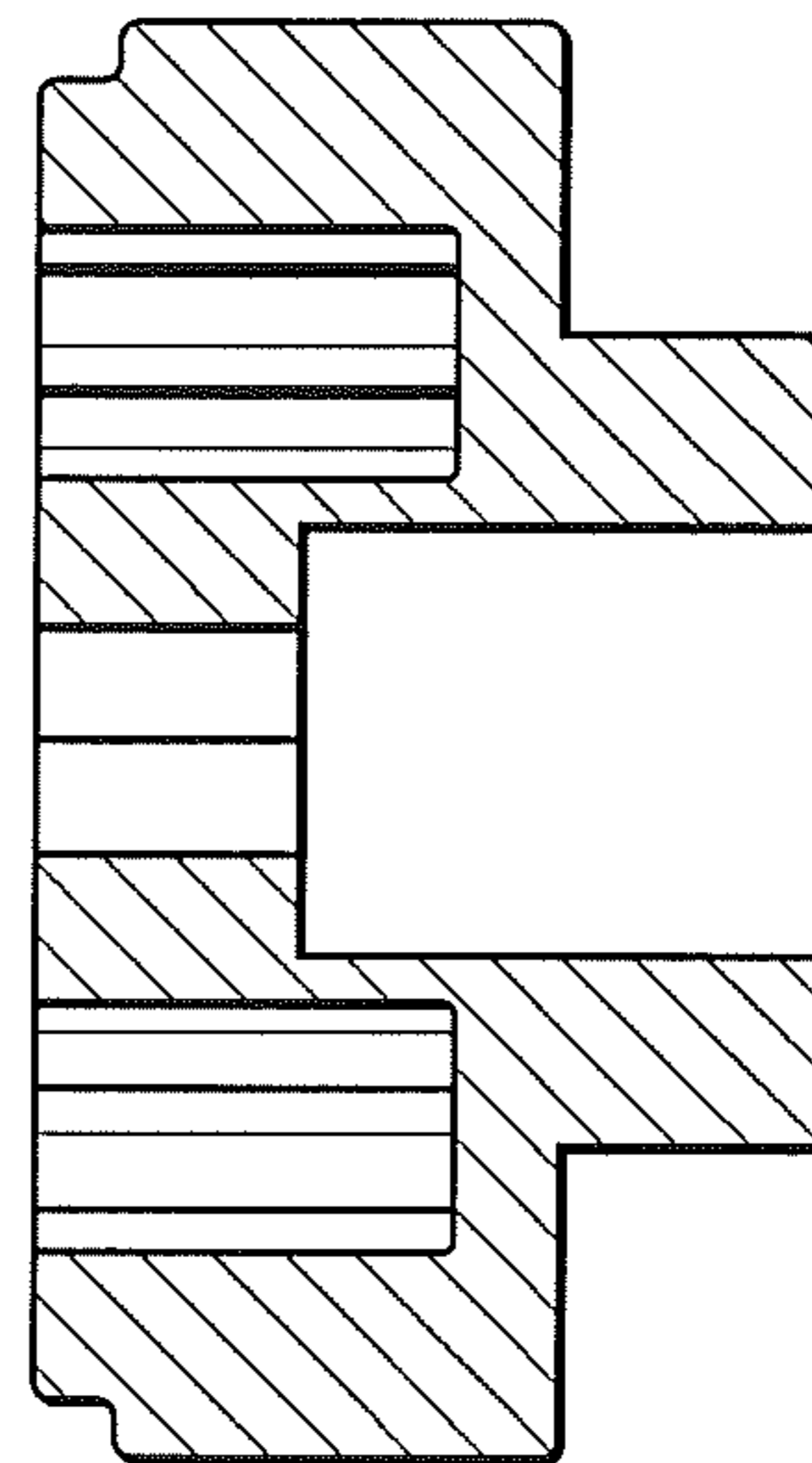

FIG. 7

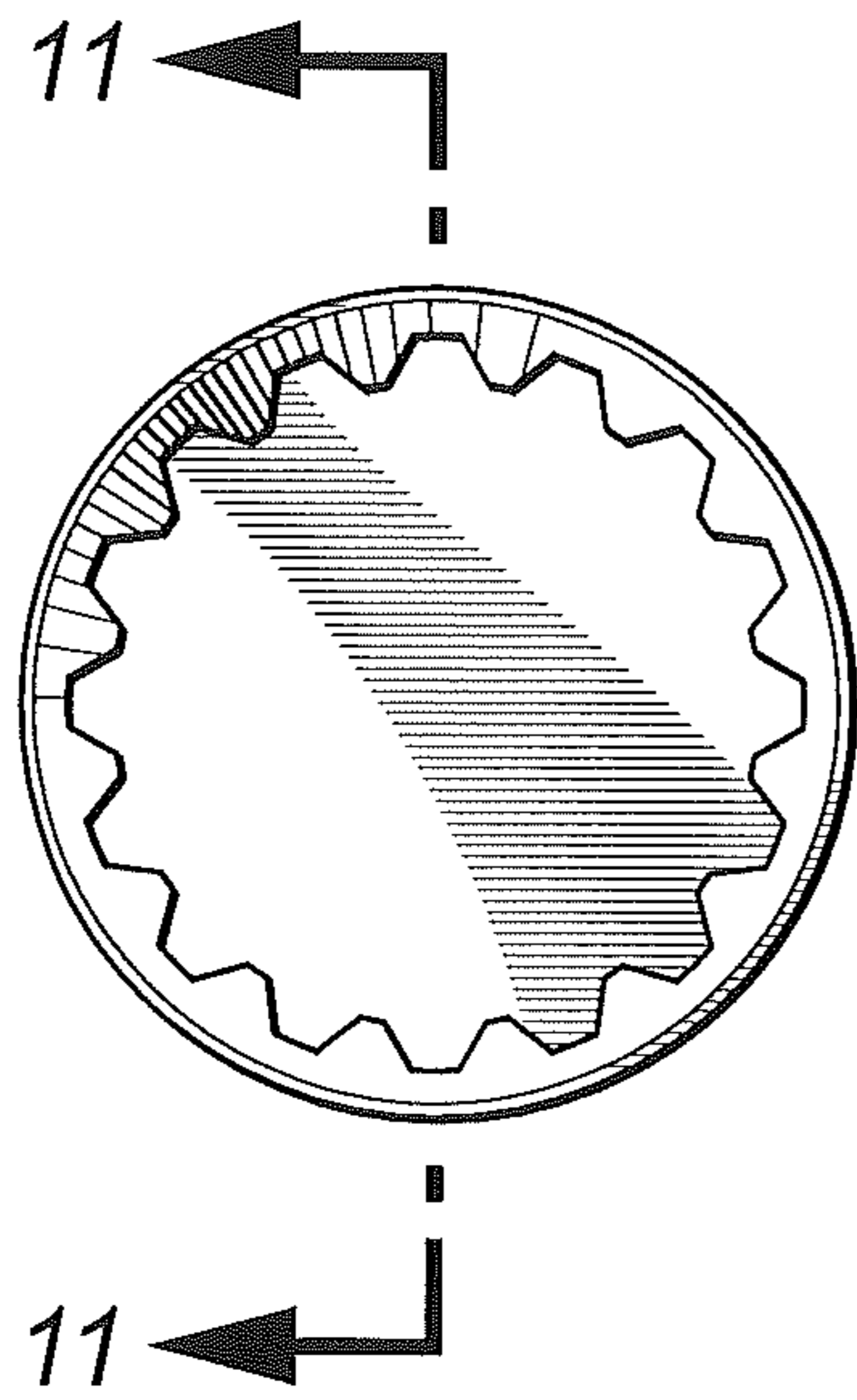

FIG. 8

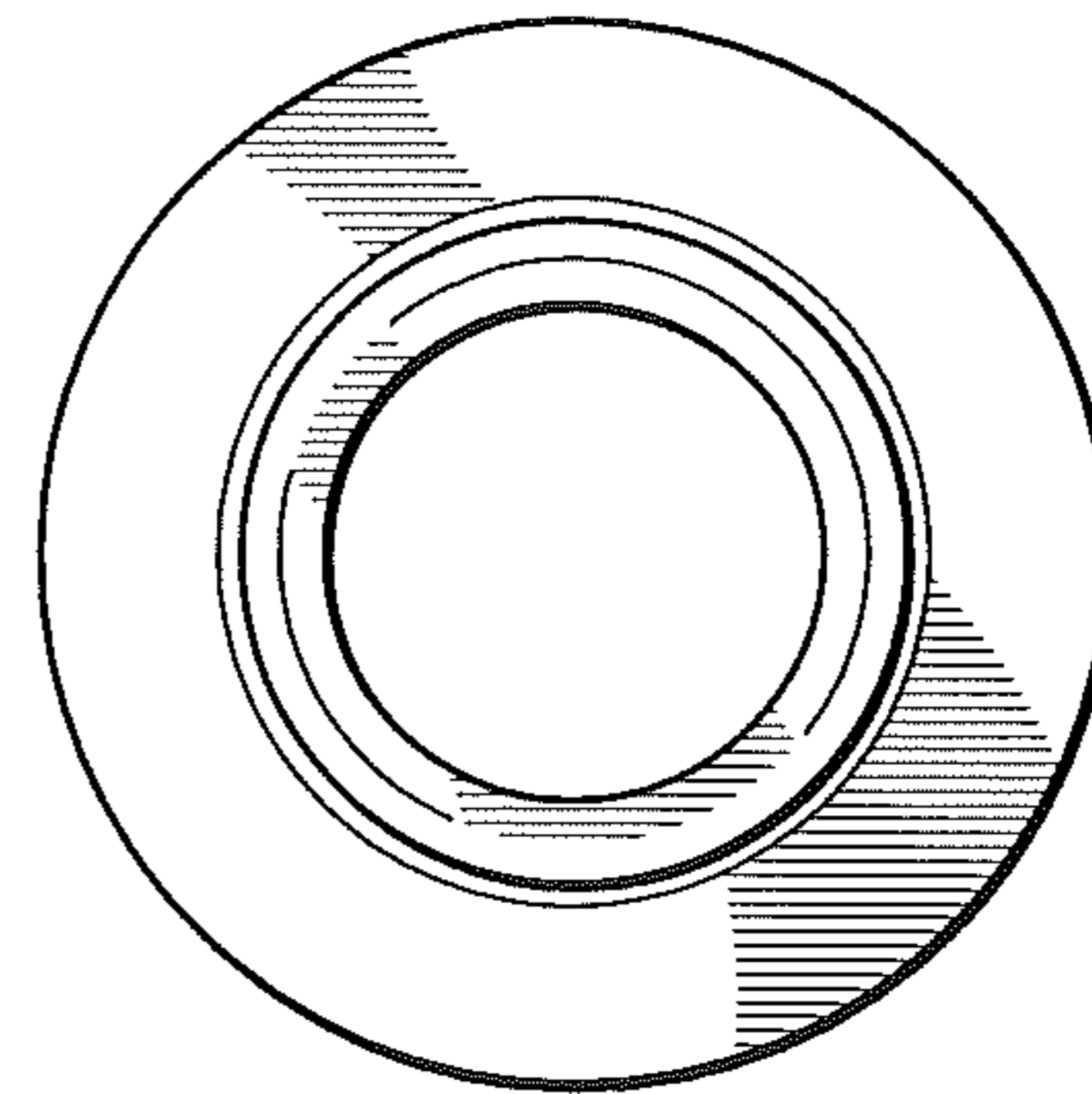

FIG. 9

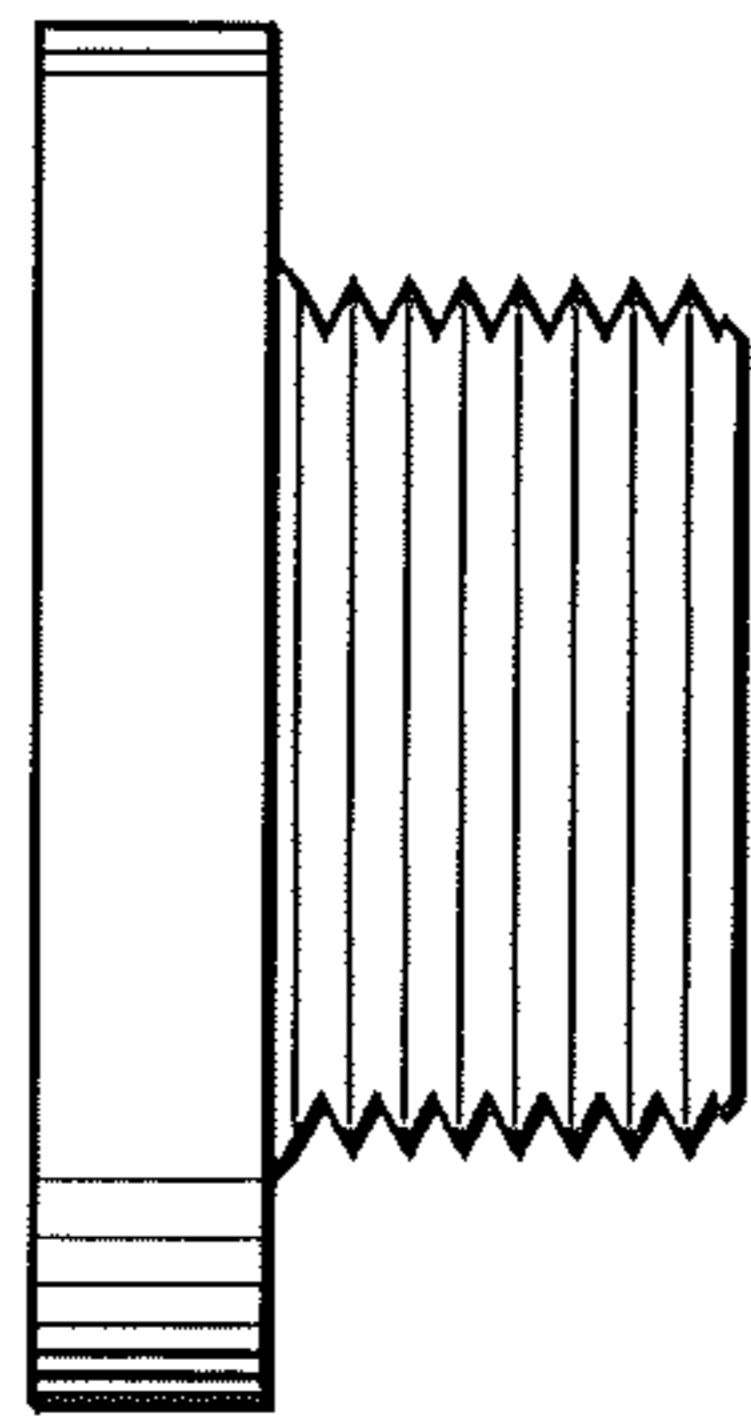

FIG. 10

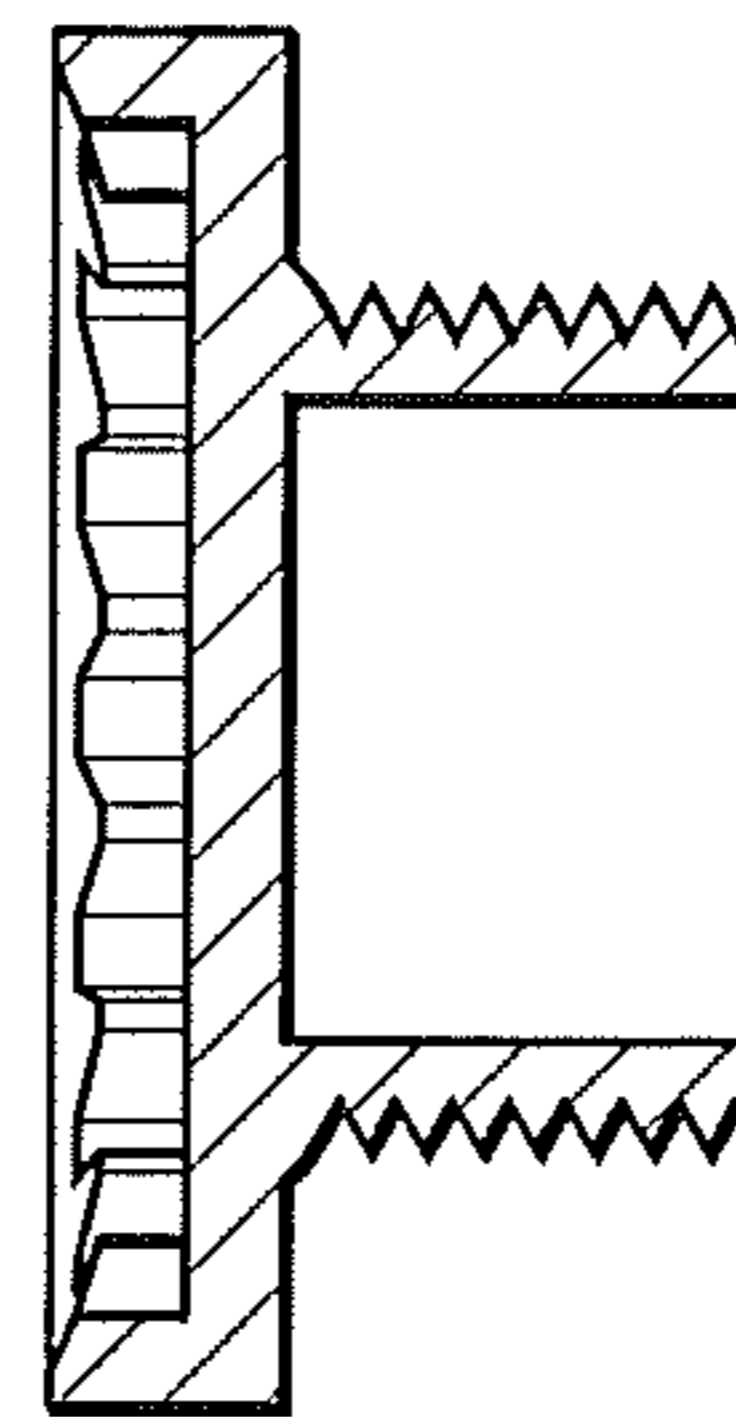

FIG. 11

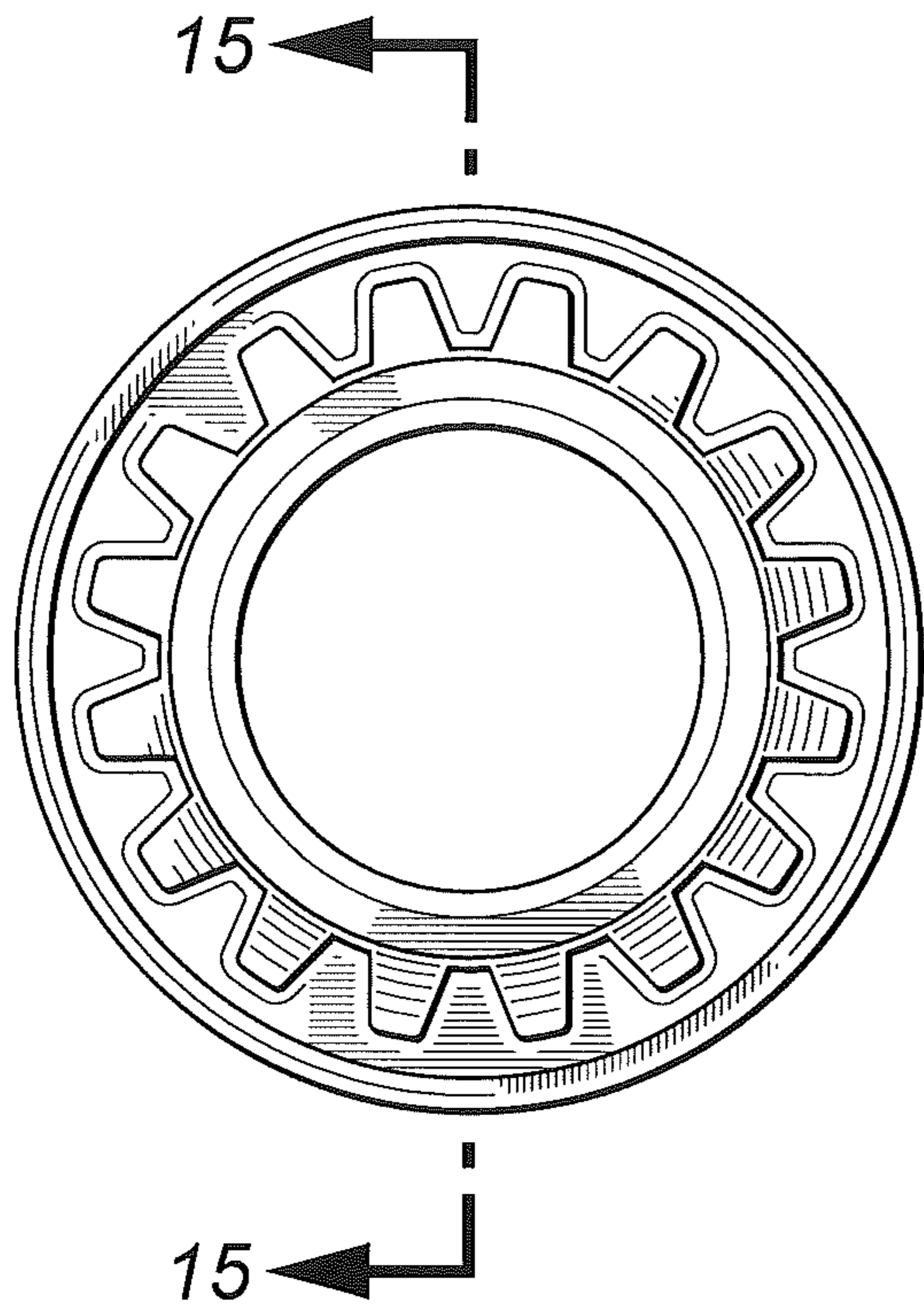

FIG. 12

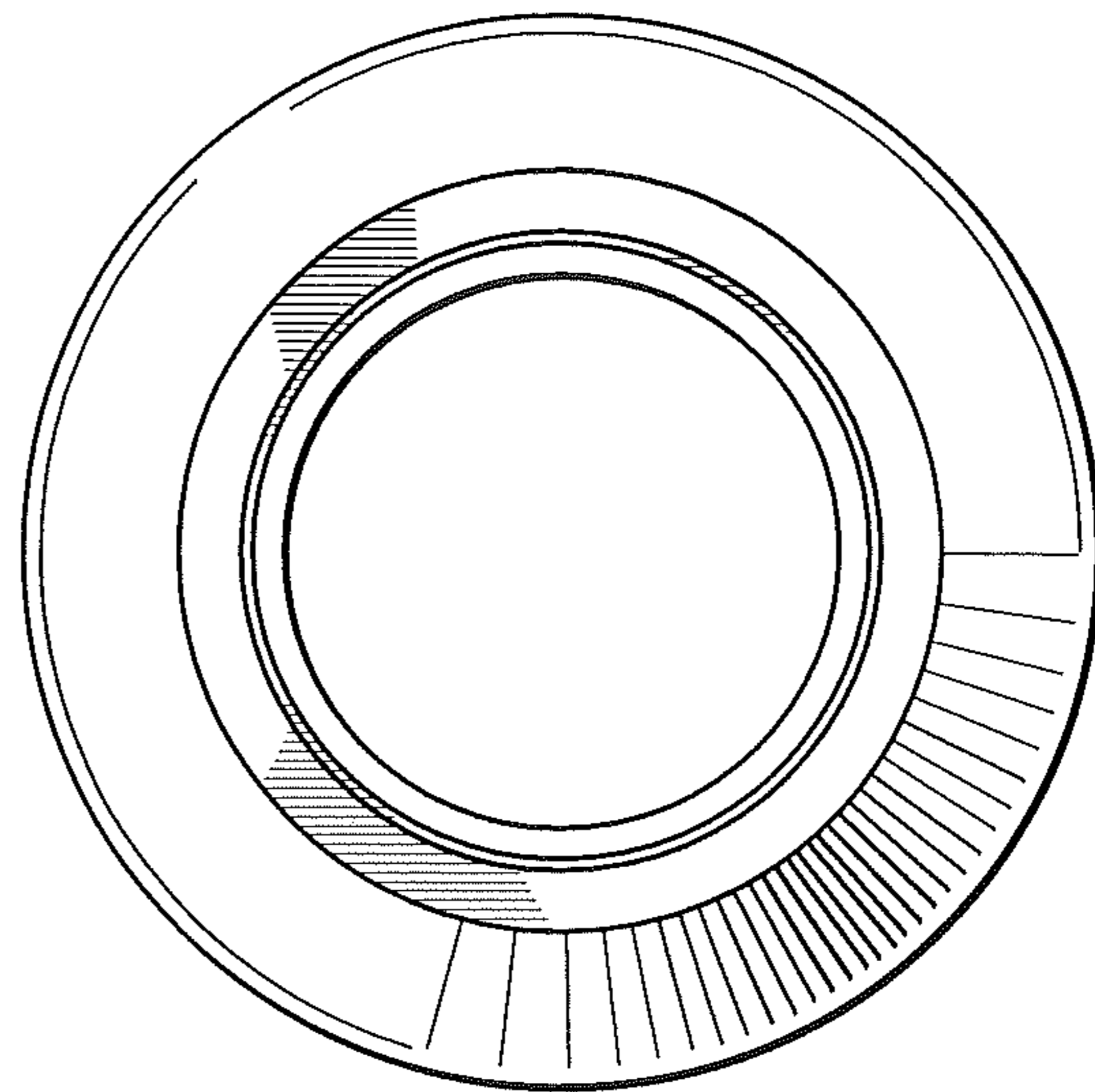

FIG. 13

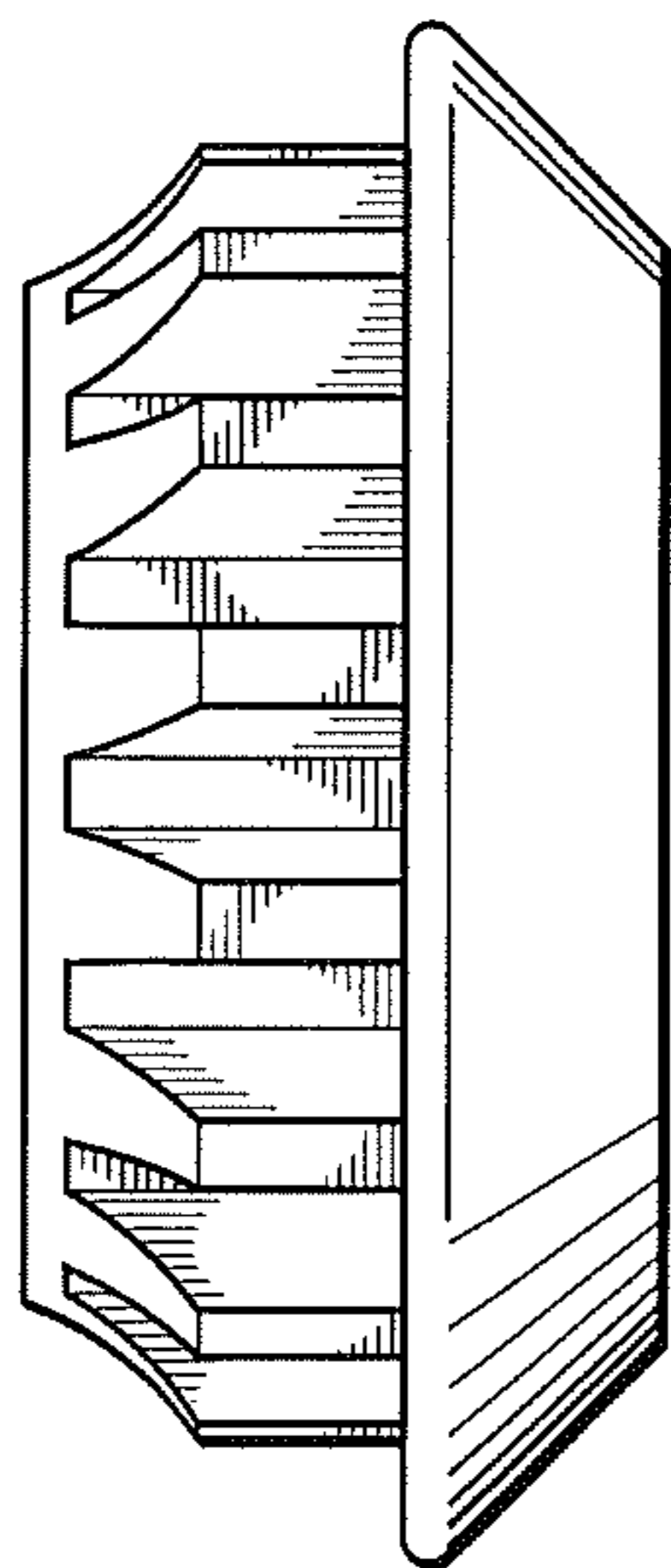

FIG. 14

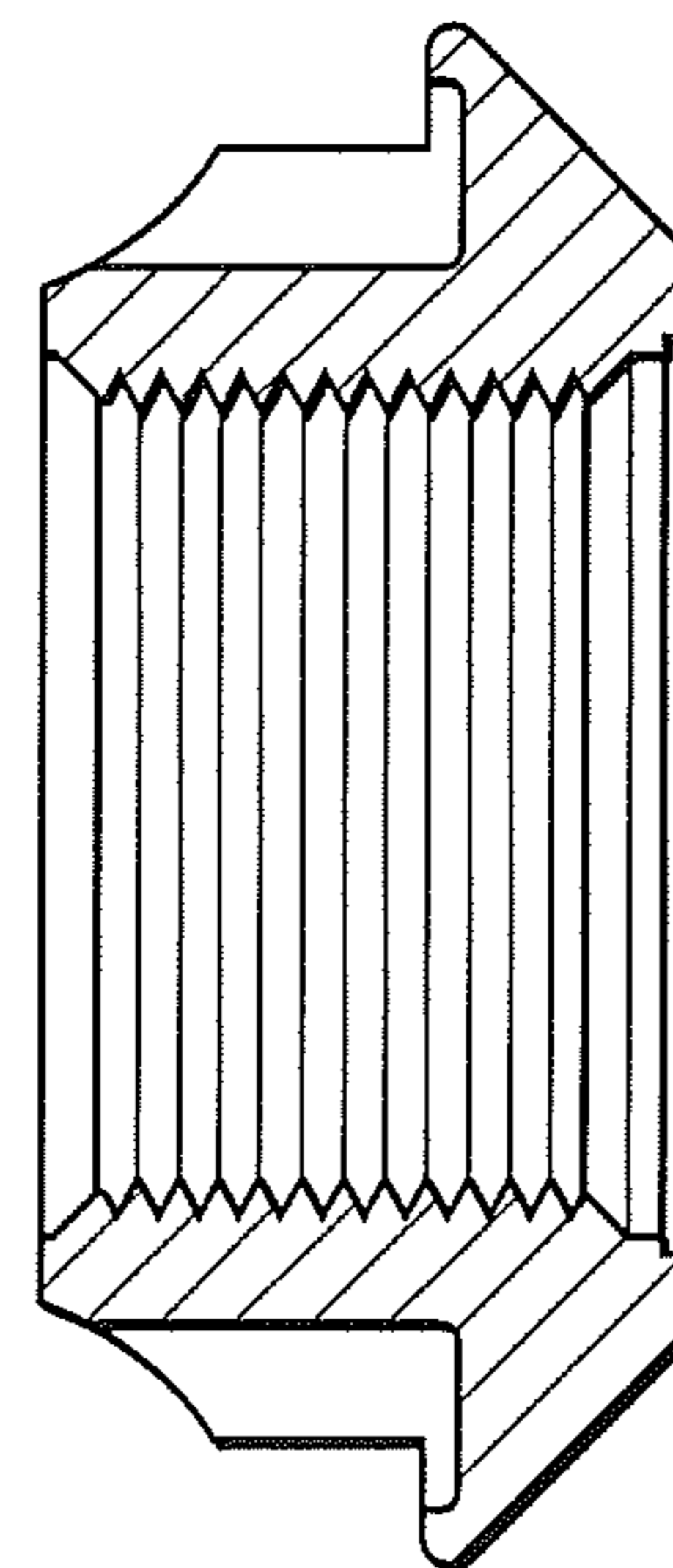

FIG. 15

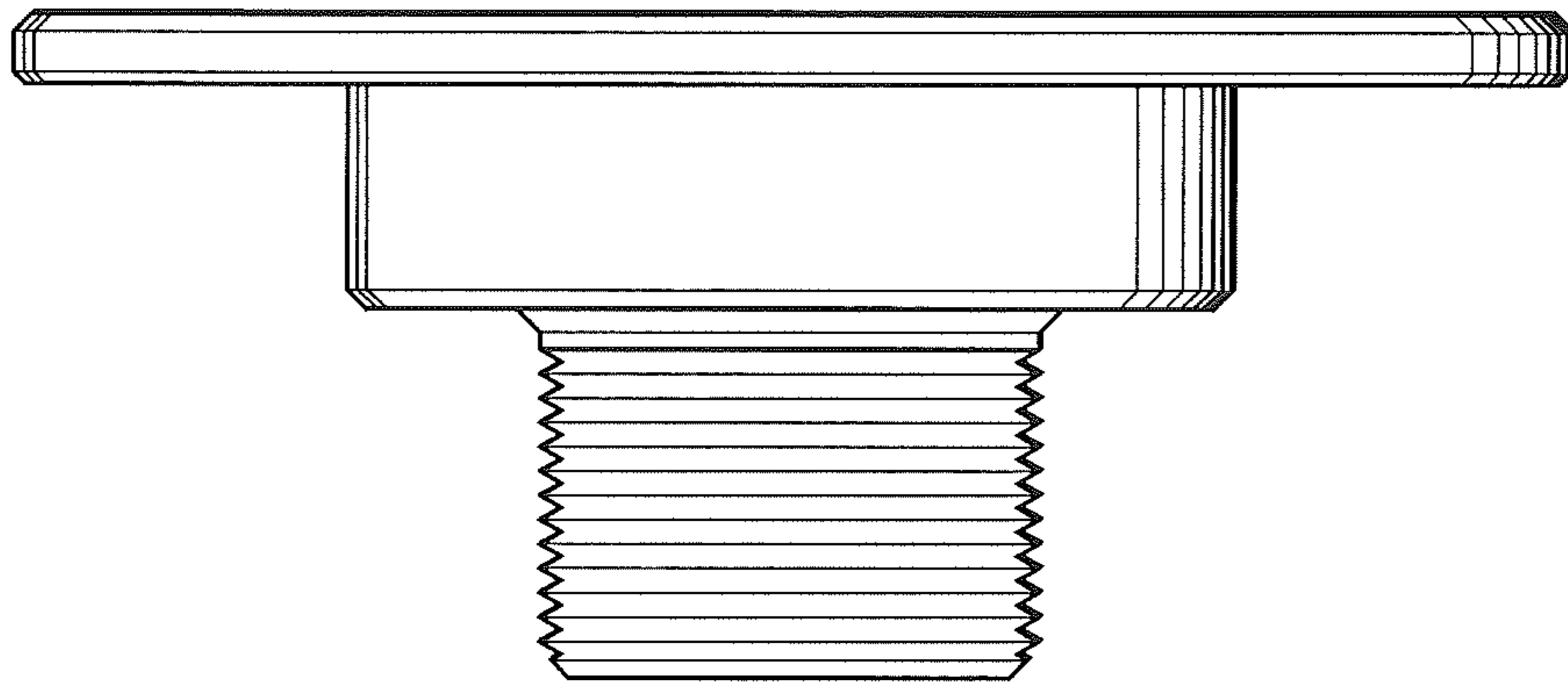

FIG. 18

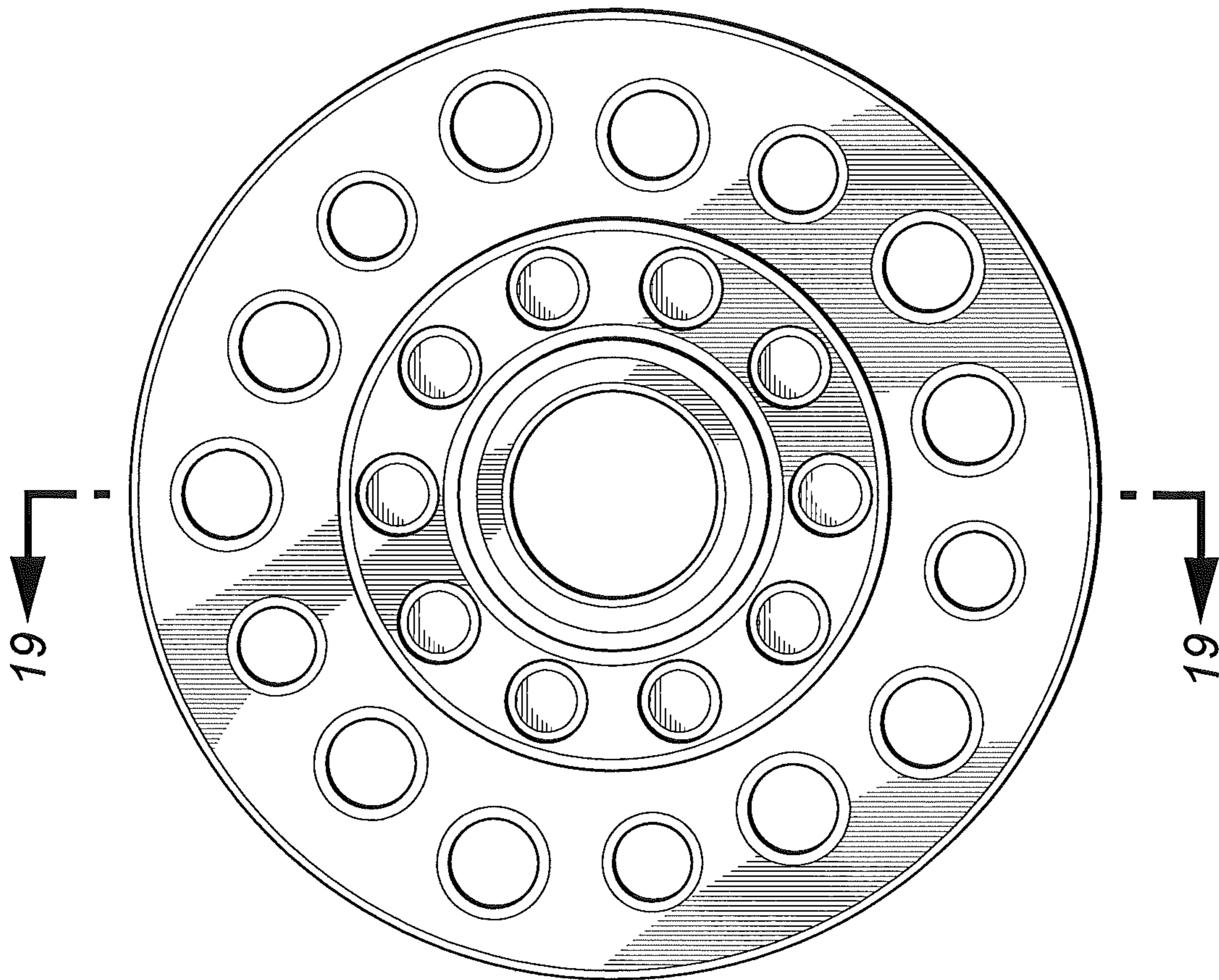

FIG. 16

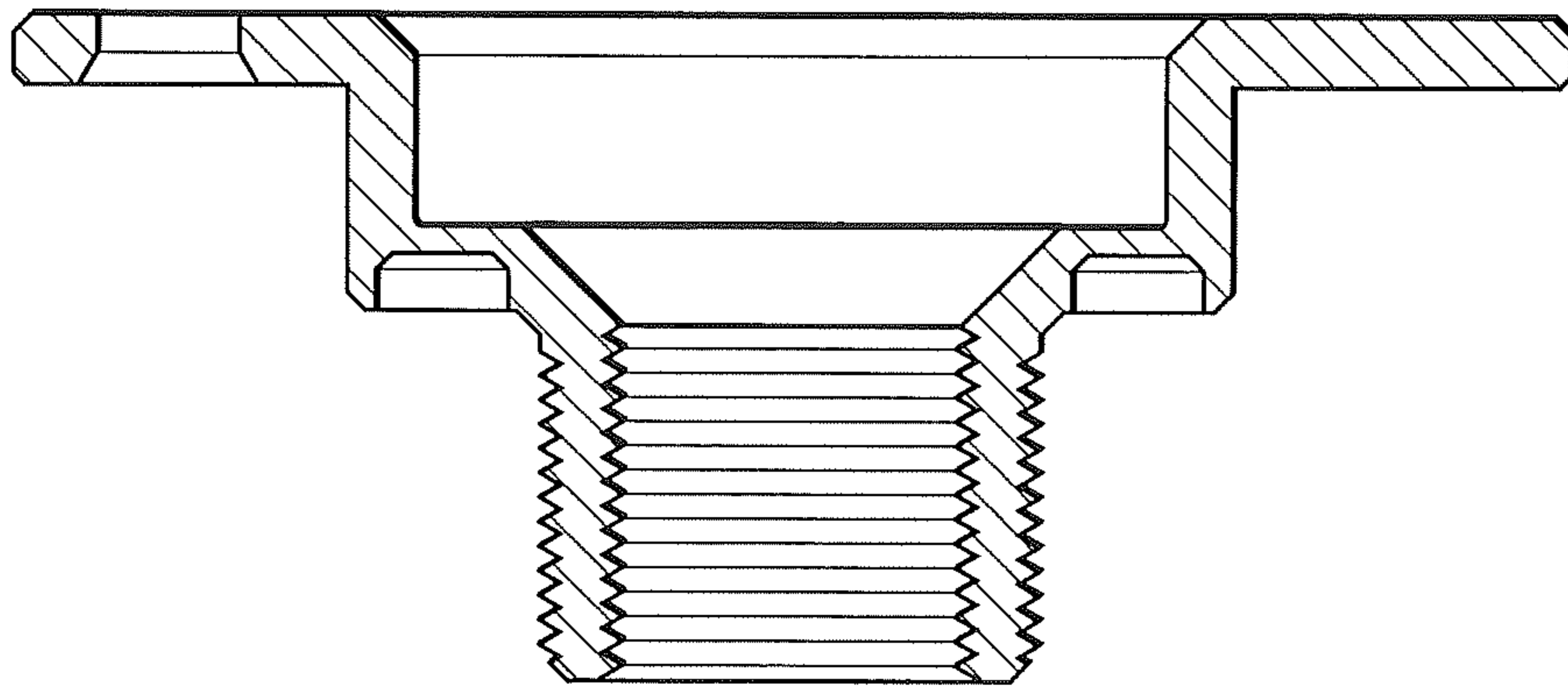

FIG. 19

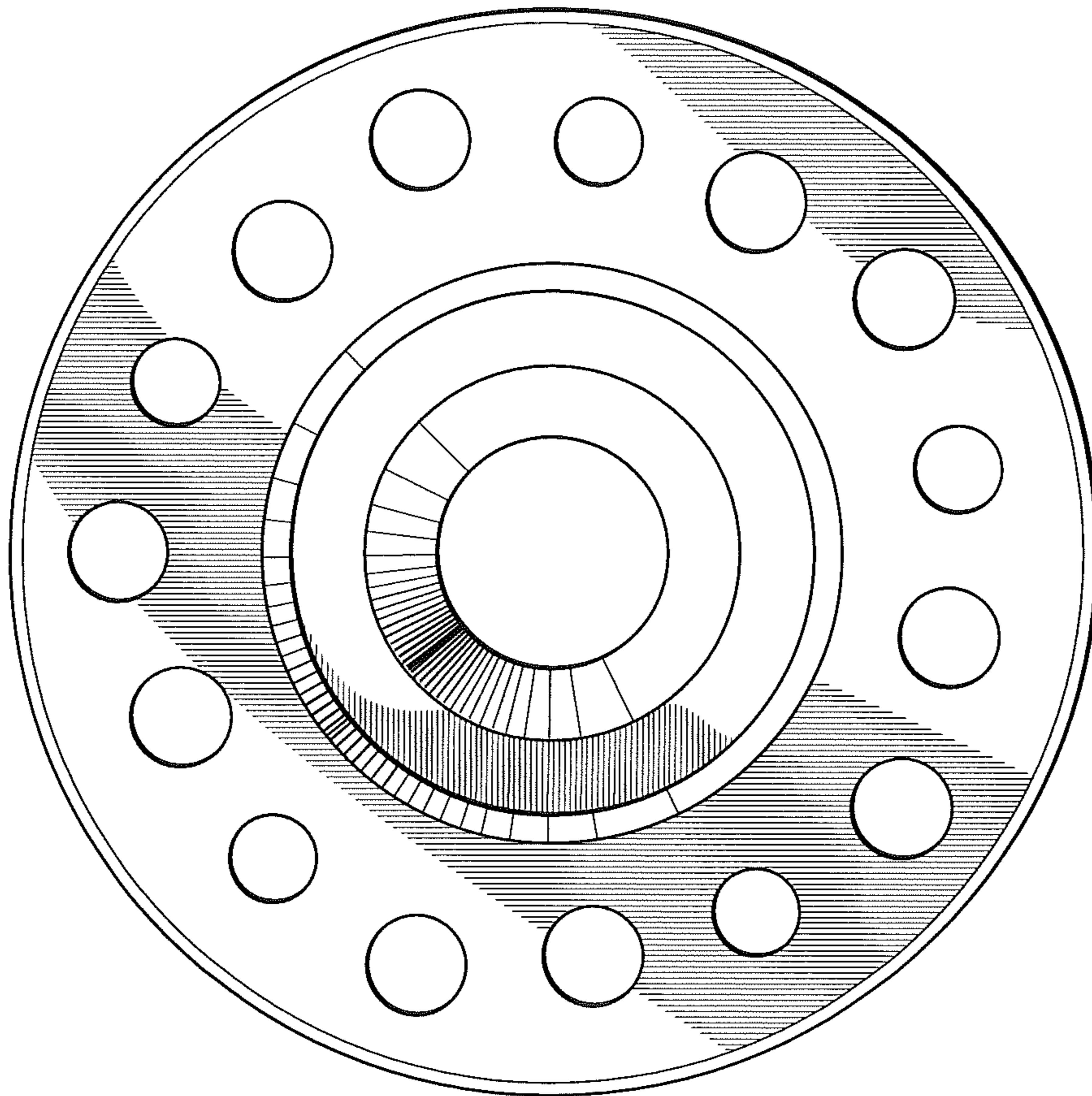

FIG. 17