



US00D877012S

(12) **United States Design Patent** (10) **Patent No.:** **US D877,012 S**  
**Ali et al.** (45) **Date of Patent:** **\*\* Mar. 3, 2020**

(54) **INSTRUMENT PANEL**  
(71) Applicant: **Rivian IP Holdings, LLC**, Plymouth, MI (US)  
(72) Inventors: **Zulfiquar Ali**, West Bloomfield, MI (US); **Roman Mistiuk**, Westland, MI (US)  
(73) Assignee: **Rivian IP Holdings, LLC**, Plymouth, MI (US)  
(\*\*) Term: **15 Years**  
(21) Appl. No.: **29/669,976**  
(22) Filed: **Nov. 13, 2018**  
(51) **LOC (12) Cl.** ..... **12-16**  
(52) **U.S. Cl.**  
USPC ..... **D12/192**  
(58) **Field of Classification Search**  
USPC ..... D12/192, 415, 114, 345; D15/17, 28; D10/46, 98, 102-103, 122-127; D23/324  
CPC ..... B60H 1/34; B60H 1/3407; B60H 1/3414; B60H 1/3421; B60H 1/3428; B60H 1/3435; B60H 1/3442; B60H 1/345; B60H 1/3457; B60H 2001/3464; B60H 2001/3471; B60H 2001/3478; B60H 2001/3485  
See application file for complete search history.

D826,122 S \* 8/2018 Yamamoto ..... D12/192  
D826,814 S \* 8/2018 Von Holzhausen ..... D12/192  
D830,927 S \* 10/2018 Tanaka ..... D12/192  
D847,057 S \* 4/2019 Kono ..... D12/192  
D849,621 S \* 5/2019 Iwao ..... D12/192  
D853,919 S \* 7/2019 Hazumi ..... D12/192  
D858,390 S \* 9/2019 Kato ..... D12/192  
D860,892 S \* 9/2019 Ohmori ..... D12/192  
D863,167 S \* 10/2019 Moir ..... D12/192

\* cited by examiner

*Primary Examiner* — Katrina A Betton

(74) *Attorney, Agent, or Firm* — Haley Guiliano LLP

(57) **CLAIM**

The ornamental design for an instrument panel, as shown and described.

**DESCRIPTION**

FIG. 1 is a front view of an instrument panel showing the claimed design;  
FIG. 2 is a bottom view of the instrument panel;  
FIG. 3 is a left-side view of the instrument panel;  
FIG. 4 is a right-side view of the instrument panel;  
FIG. 5 is a front left corner perspective view of the instrument panel;  
FIG. 6 is a front right corner perspective view of the instrument panel;  
FIG. 7 is a higher front left corner perspective view of the instrument panel;  
FIG. 8 is a higher front right corner perspective view of the instrument panel; and,  
FIG. 9 is a front perspective view of the instrument panel.

**1 Claim, 9 Drawing Sheets**

(56) **References Cited**  
U.S. PATENT DOCUMENTS  
D218,770 S \* 9/1970 Kelly ..... D7/395  
D378,910 S \* 4/1997 Black ..... D12/192

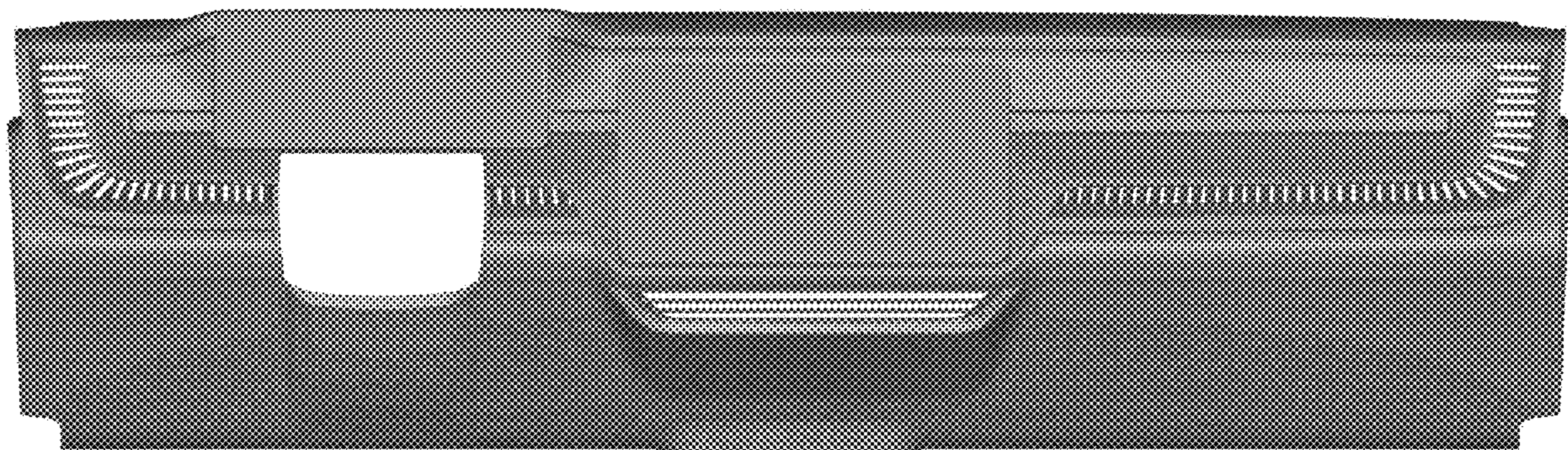

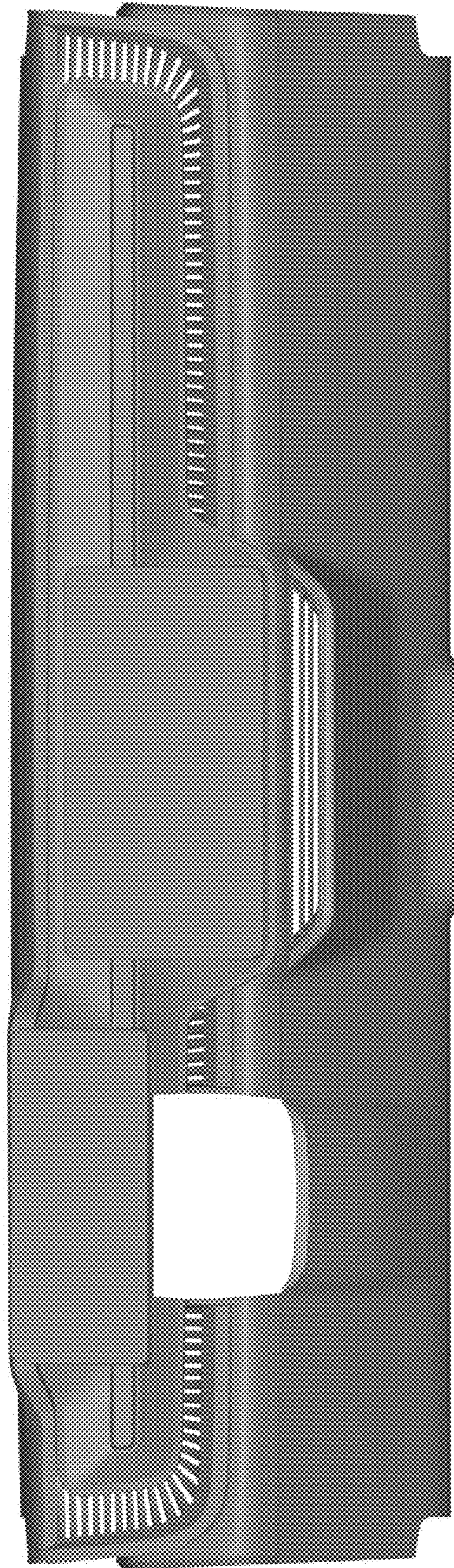

FIG. 1

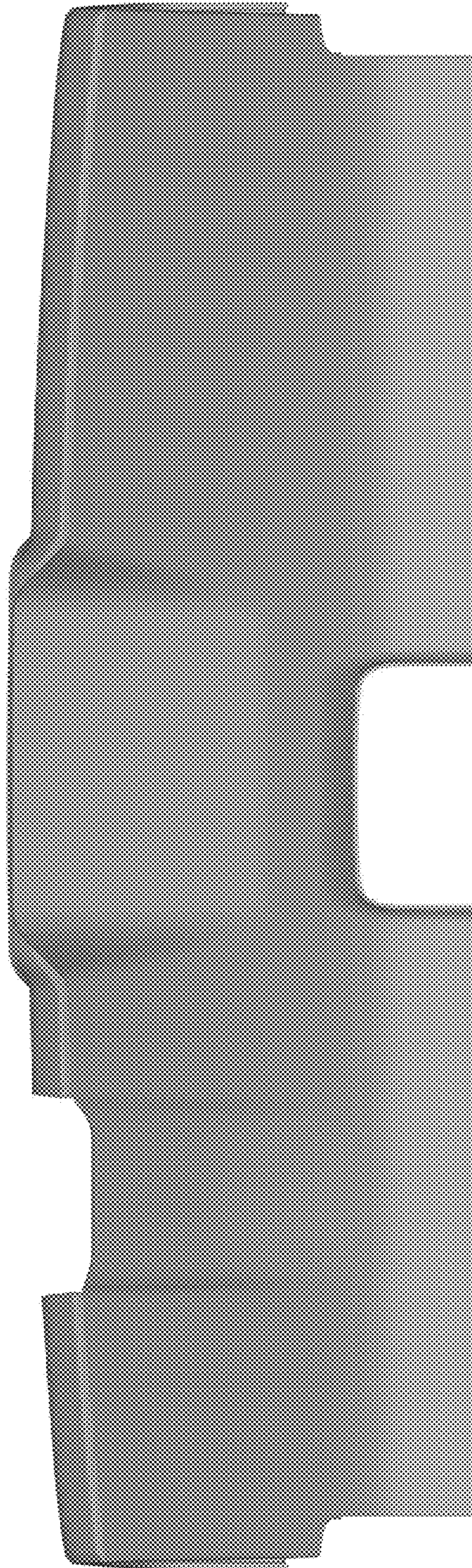

FIG. 2

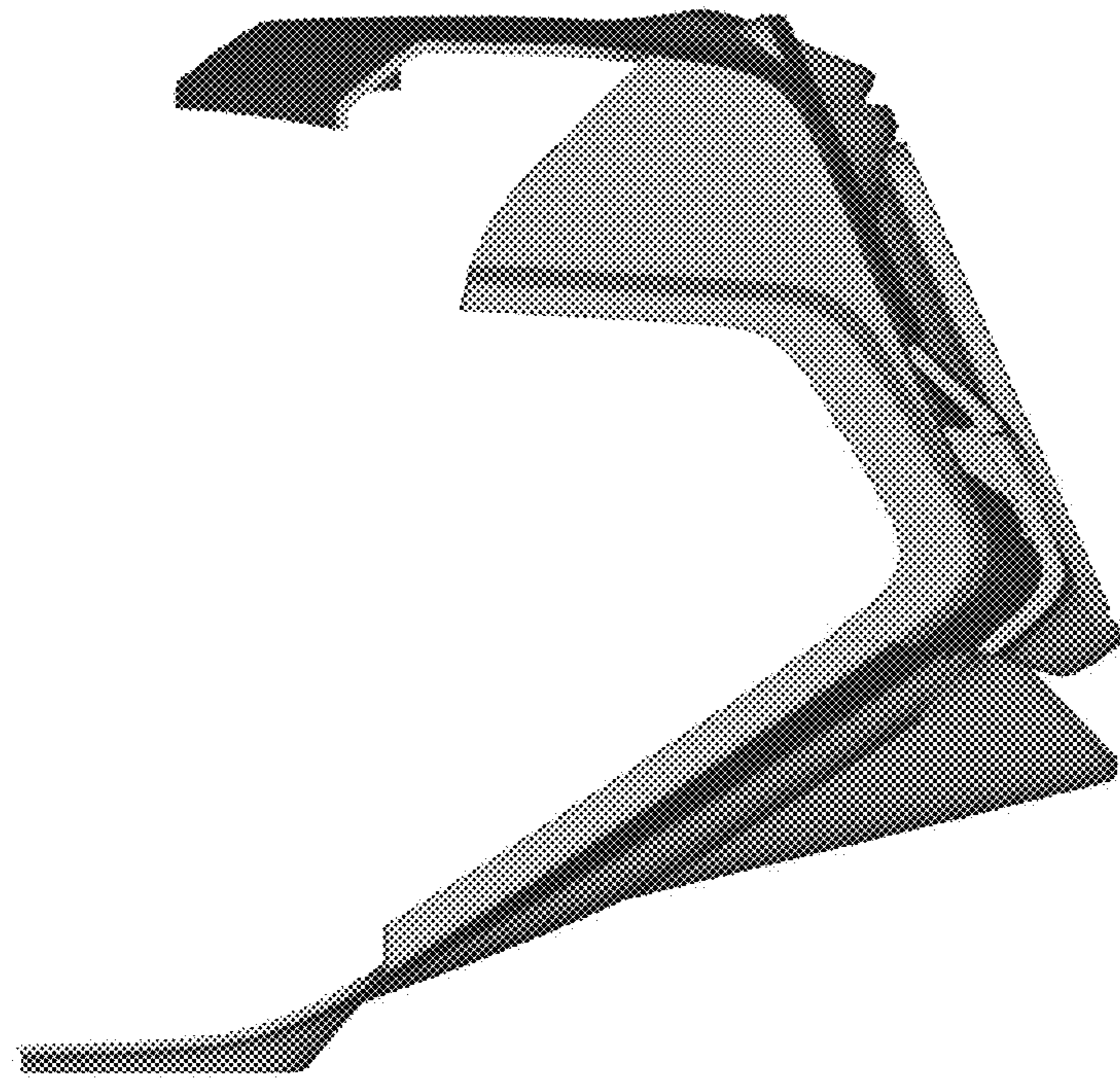

FIG. 3

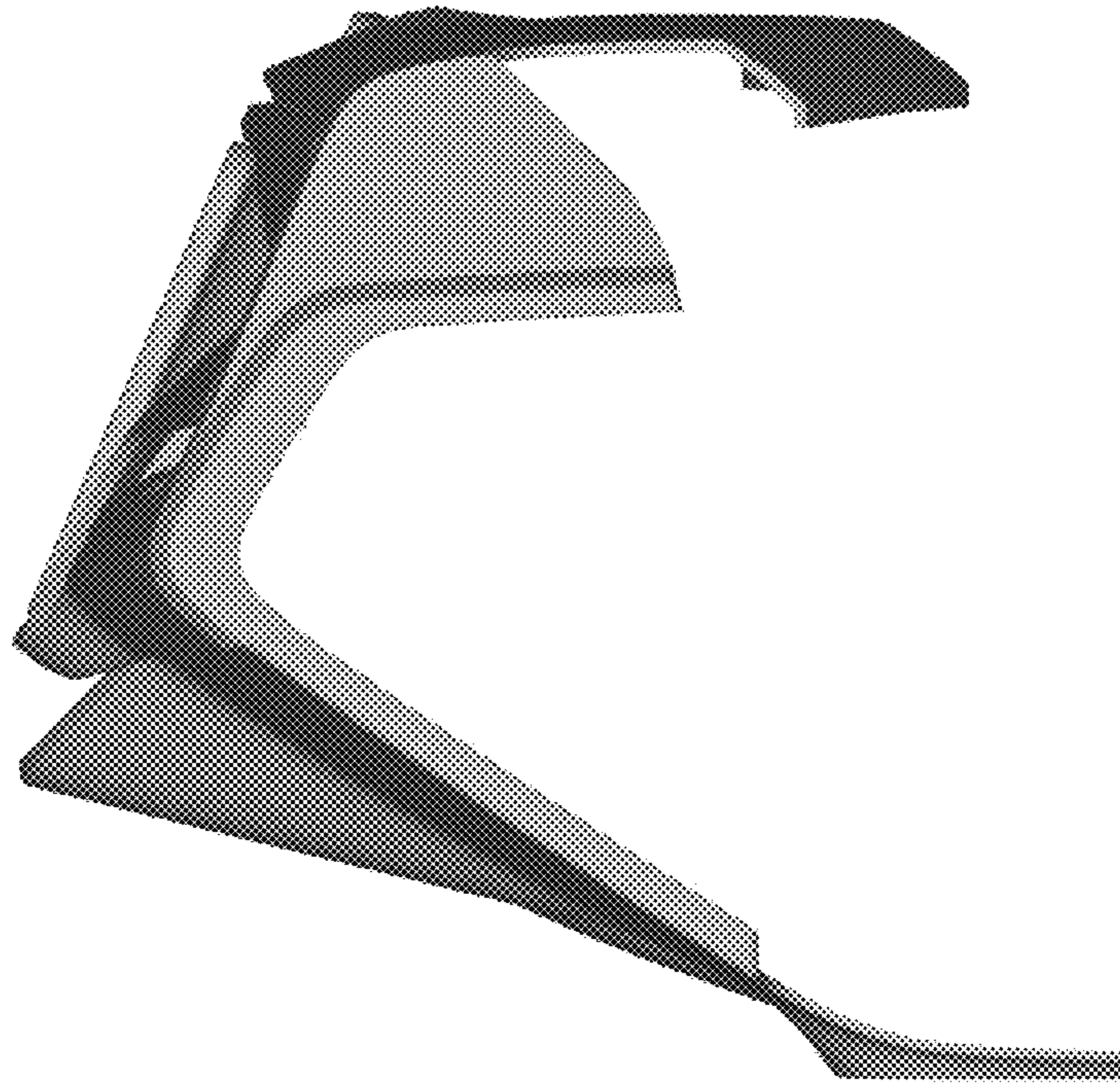

FIG. 4

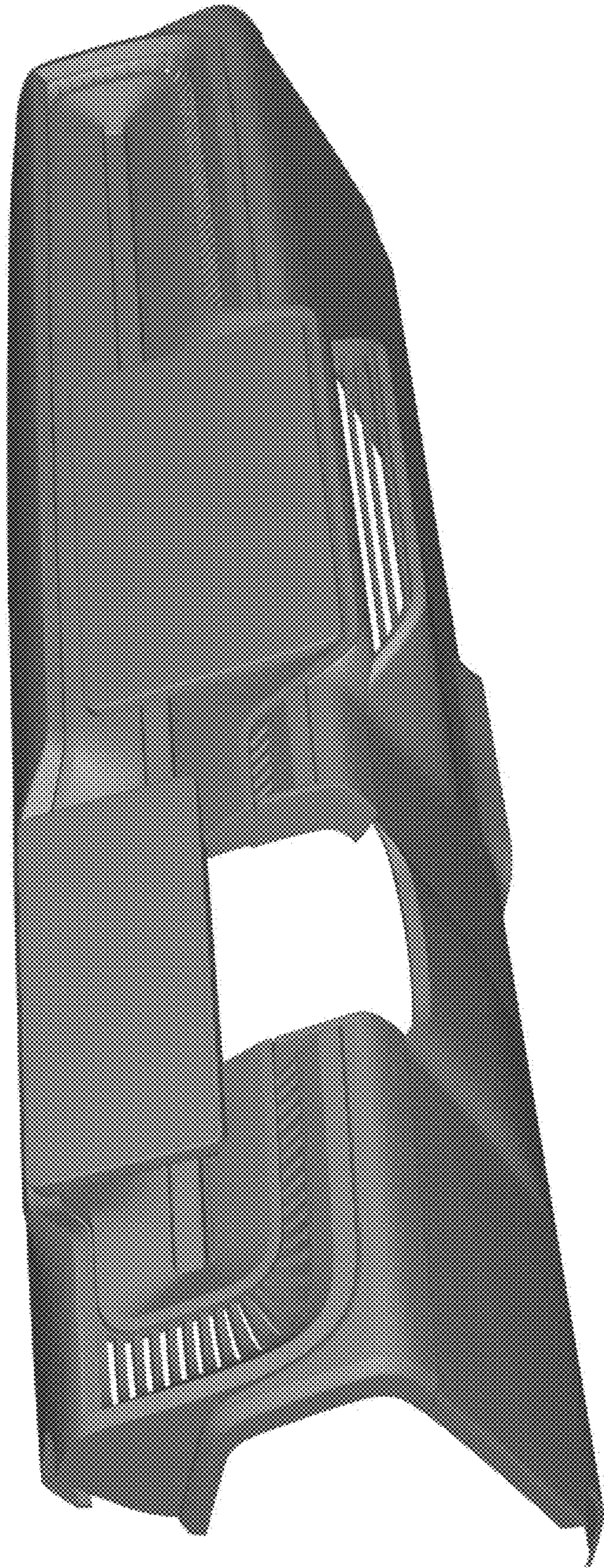

FIG. 5

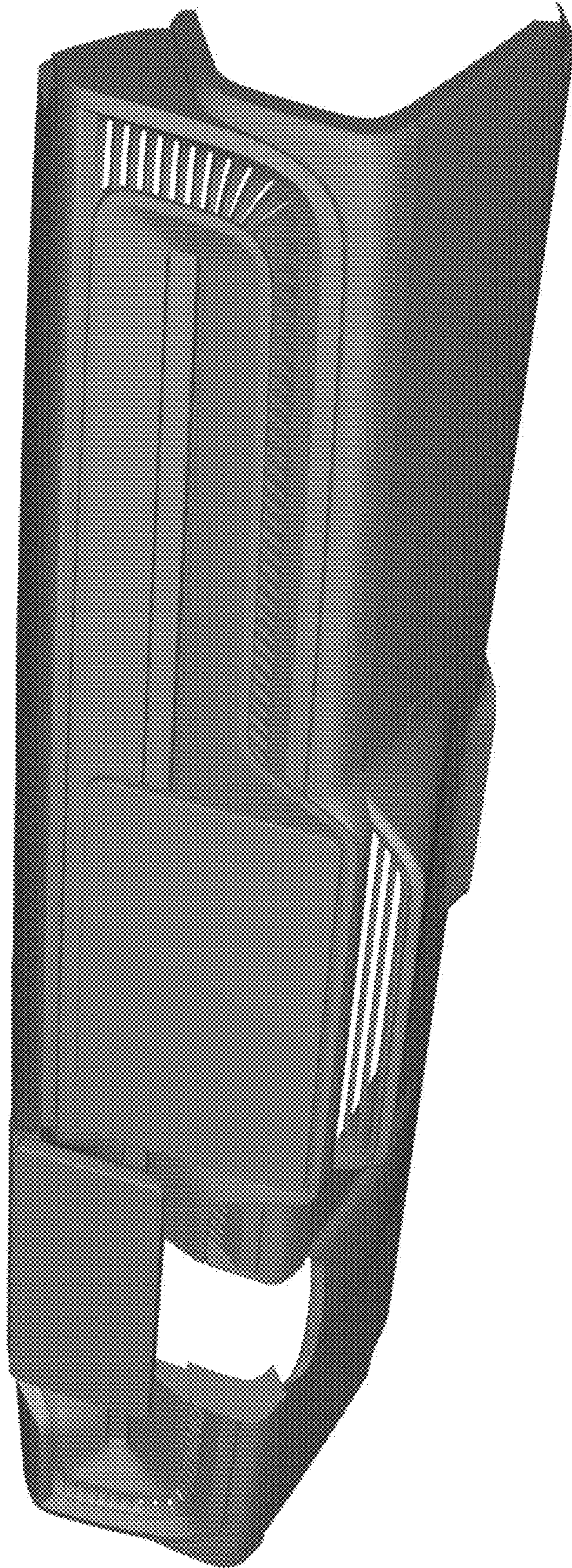

FIG. 6

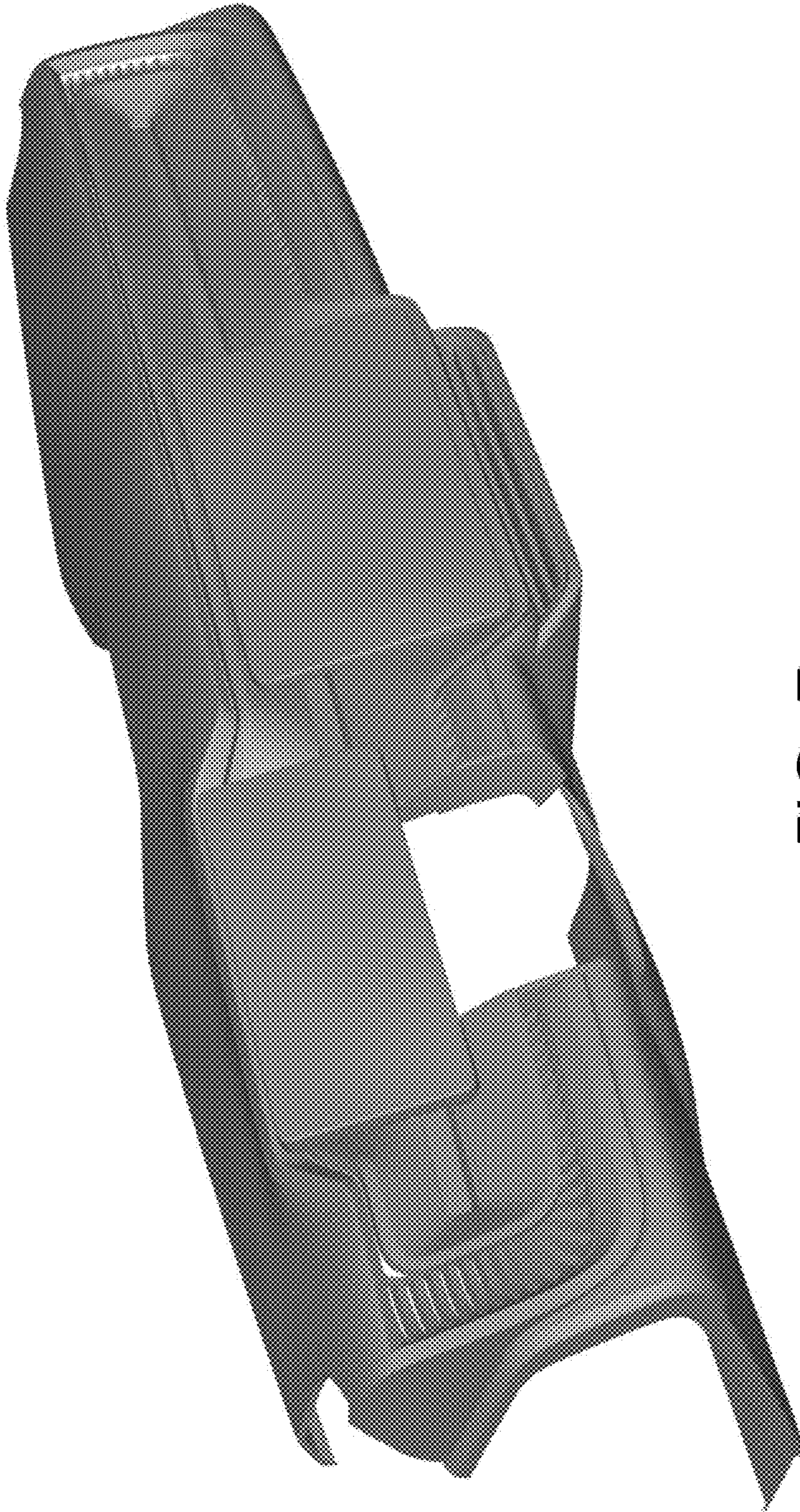

FIG. 7



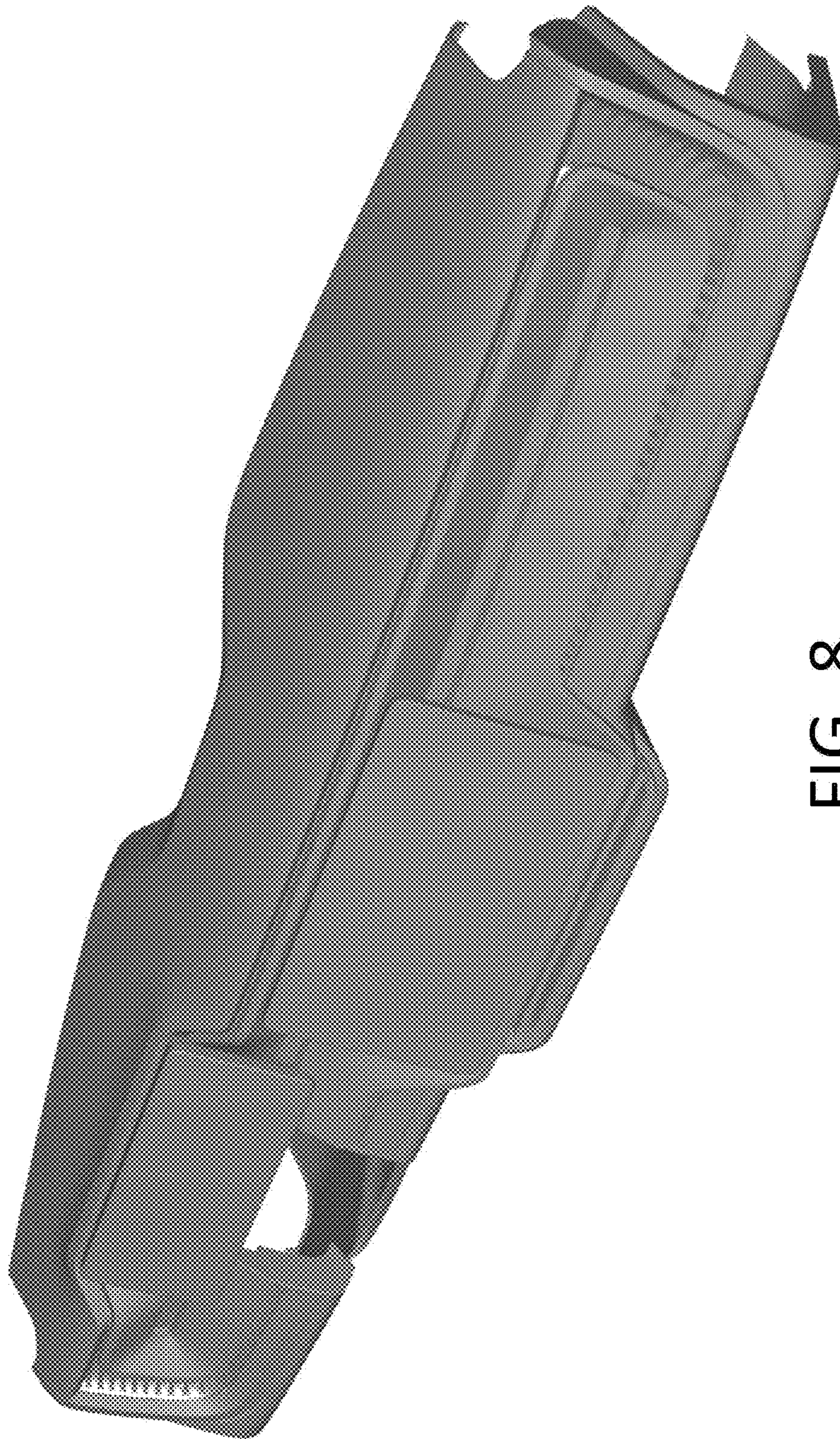

FIG. 8

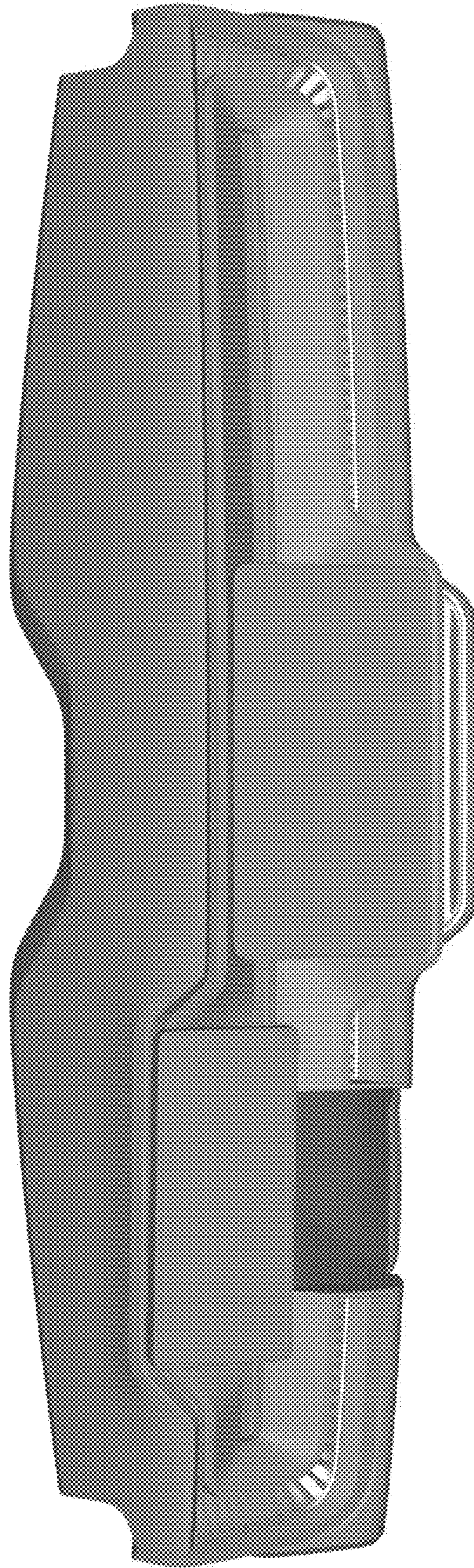

FIG. 9