



US00D876689S

(12) **United States Design Patent** (10) **Patent No.:** **US D876,689 S**
Thomas (45) **Date of Patent:** **** Feb. 25, 2020**

(54) **TAIL LIGHT**

(71) Applicant: **Jaguar Land Rover Limited**, Whitley, Coventry (GB)

(72) Inventor: **Gareth Thomas**, Coventry (GB)

(73) Assignee: **Jaguar Land Rover Limited**, Whitley, Coventry (GB)

(**) Term: **15 Years**

(21) Appl. No.: **29/687,052**

(22) Filed: **Apr. 10, 2019**

Related U.S. Application Data

(62) Division of application No. 29/591,541, filed on Jan. 20, 2017, now Pat. No. Des. 846,163.

(30) **Foreign Application Priority Data**

Jul. 20, 2016 (EM) 003313444-0001
Jul. 20, 2016 (EM) 003313444-0002

(Continued)

(51) **LOC (12) Cl.** **26-06**

(52) **U.S. Cl.**
USPC **D26/28**

(58) **Field of Classification Search**
USPC D26/28-36, 139

(Continued)

(56) **References Cited**

U.S. PATENT DOCUMENTS

D516,233 S * 2/2006 Ikeda D26/28
D605,793 S * 12/2009 Weil D26/28
D721,840 S * 1/2015 Futschik D26/28

* cited by examiner

Primary Examiner — Marcus A Jackson

(74) *Attorney, Agent, or Firm* — Wood Herron & Evans LLP

(57) **CLAIM**

The ornamental design for a tail light, as shown and described.

DESCRIPTION

FIG. 1 is a front view of a tail light for a vehicle according to the present invention.

FIG. 2 is a rear view of the tail light shown in FIG. 1.

FIG. 3 is a right side view thereof.

FIG. 4 is a left side view thereof.

FIG. 5 is a top view thereof.

FIG. 6 is a front right perspective view thereof.

FIG. 7 is a rear right perspective view thereof.

FIG. 8 is a front left perspective view thereof.

FIG. 9 is a rear left perspective view thereof.

FIG. 10 is a front right perspective view of the tail light shown in FIGS. 1-9, with the tail light mounted on a vehicle shown in de-emphasized and half-tone portions so as to illustrate environmental structure. These portions form no part of the claimed design. More particularly, in FIG. 10, the inventive tail light is shown within the broken line, and any elements shown outside the broken line form no part of the claimed design, but are instead included to show environmental aspects thereof.

FIG. 11 is a front view of a tail light for a vehicle according to an alternative embodiment of the present invention.

FIG. 12 is a right side view of the tail light shown in FIG. 11.

FIG. 13 is a rear right perspective view thereof.

FIG. 14 is a top view thereof.

FIG. 15 is a front right perspective view of the tail light shown in FIGS. 11-14, with the tail light mounted on a vehicle shown in de-emphasized and half-tone portions so as to illustrate environmental structure. These portions form no part of the claimed design. More particularly, in FIG. 15, the inventive tail light is shown within the broken line, and any elements shown outside the broken line form no part of the claimed design, but are instead included to show environmental aspects thereof.

(Continued)

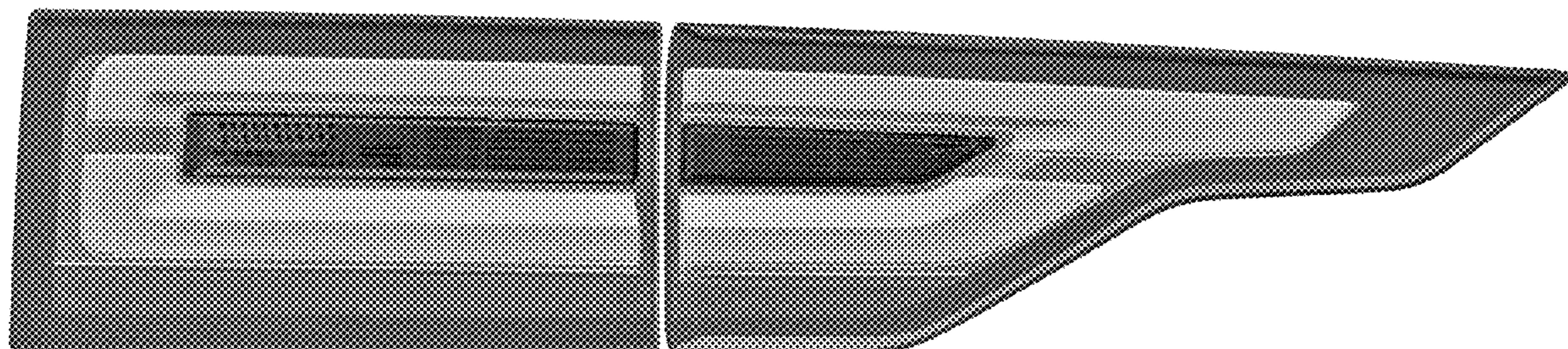

FIG. 16 is a front view of a tail light for a vehicle according to another alternative embodiment of the present invention. FIG. 17 is a rear view of the tail light shown in FIG. 16. FIG. 18 is a right side view thereof. FIG. 19 is a left side view thereof. FIG. 20 is a top view thereof. FIG. 21 is a front right perspective view thereof. FIG. 22 is a rear right perspective view thereof. FIG. 23 is a front left perspective view thereof. FIG. 24 is a rear left perspective view thereof; and, FIG. 25 is a front right perspective view of the tail light shown in FIGS. 16-24, with the tail light mounted on a vehicle shown in de-emphasized and half-tone portions so as to illustrate environmental structure. These portions form no part of the claimed design. More particularly, in FIG. 25, the inventive tail light is shown within the broken line, and any elements shown outside the broken line form no part of the claimed design, but are instead included to show environmental aspects thereof.

The broken lines shown in FIGS. 11, 13, and 14 form no part of the claimed design, but are instead included for the purpose of illustrating environment.

1 Claim, 20 Drawing Sheets

(30) **Foreign Application Priority Data**

Aug. 18, 2016 (EM) 003345610-0005
Aug. 18, 2016 (EM) 003345610-0006
Dec. 1, 2016 (EM) 003494392-0002
Dec. 1, 2016 (EM) 003494392-0003

(58) **Field of Classification Search**

CPC F21S 48/00; F21S 48/10; F21S 48/115;
F21S 48/225; F21S 48/1233; F21S
48/1266; F21S 48/1388; F21S 48/2268;
F21V 21/04; B60Q 9/13; B60Q 9/135;
B60Q 9/1375

See application file for complete search history.

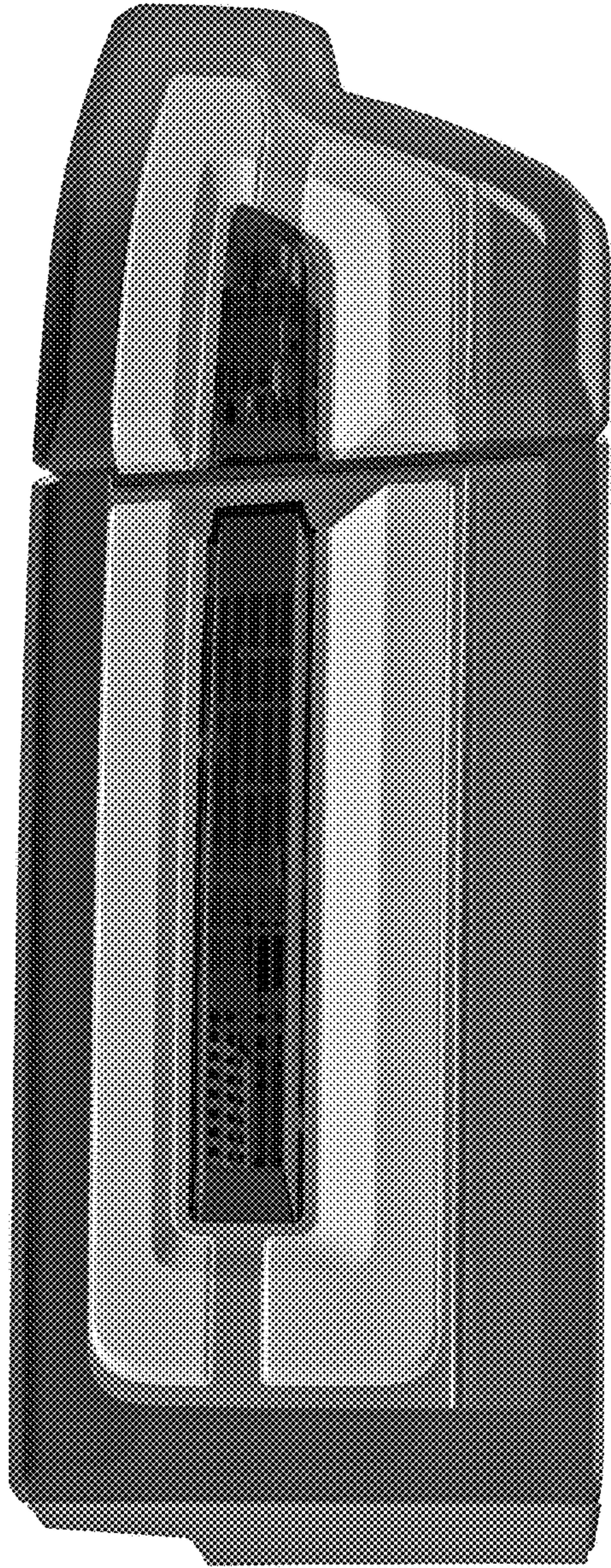

FIG. 1

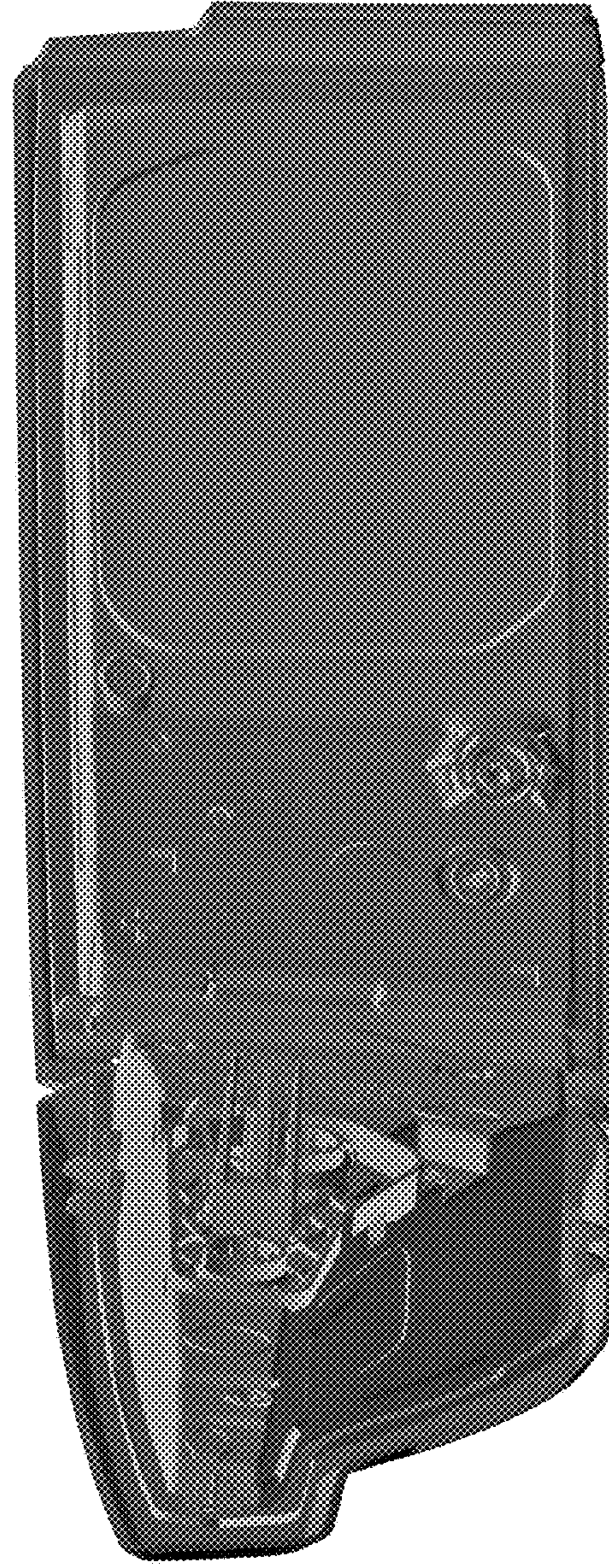

FIG. 2

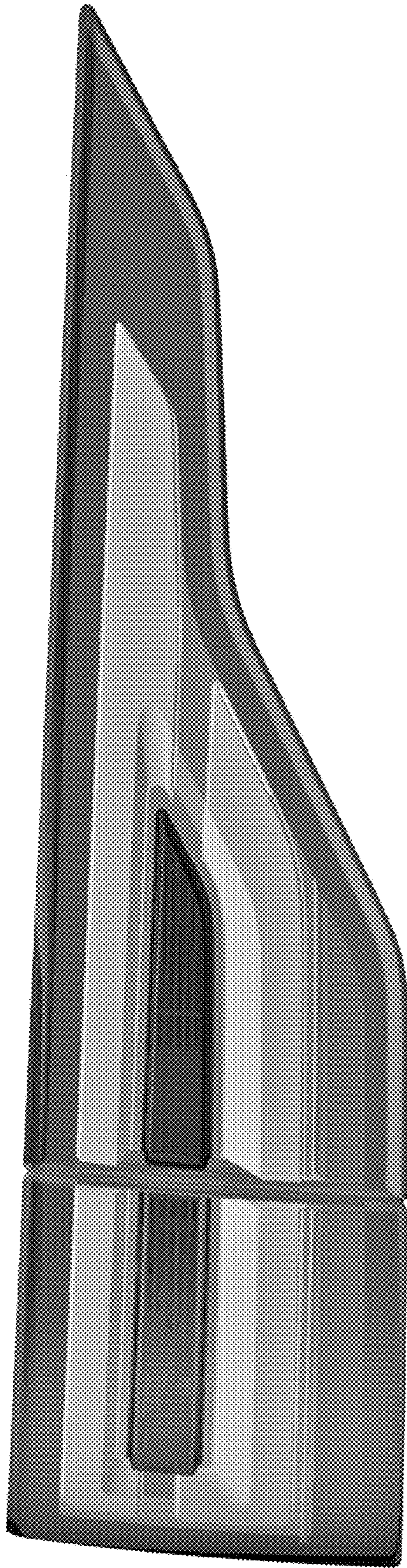

FIG. 3

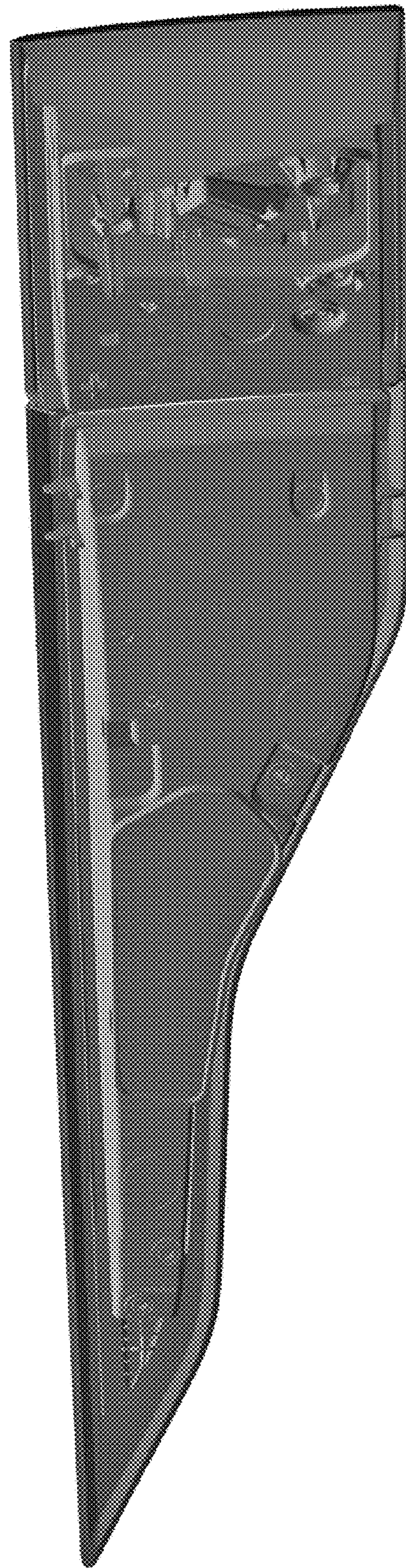

FIG. 4

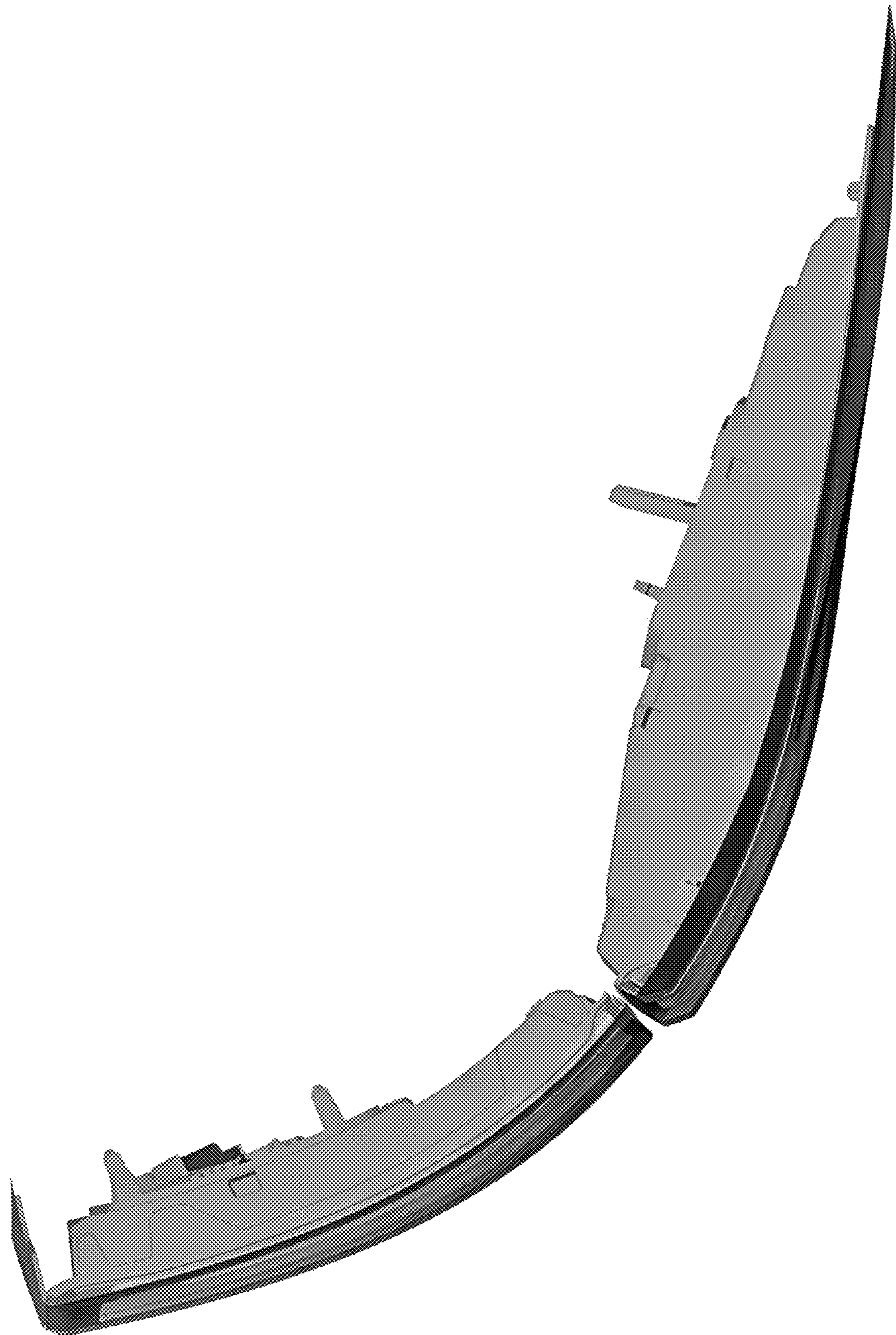

FIG. 5

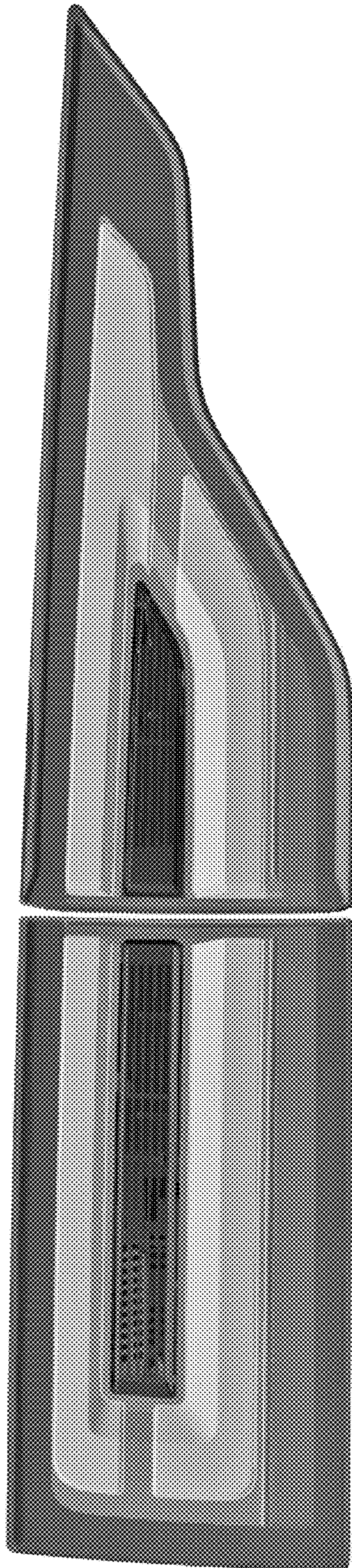

FIG. 6

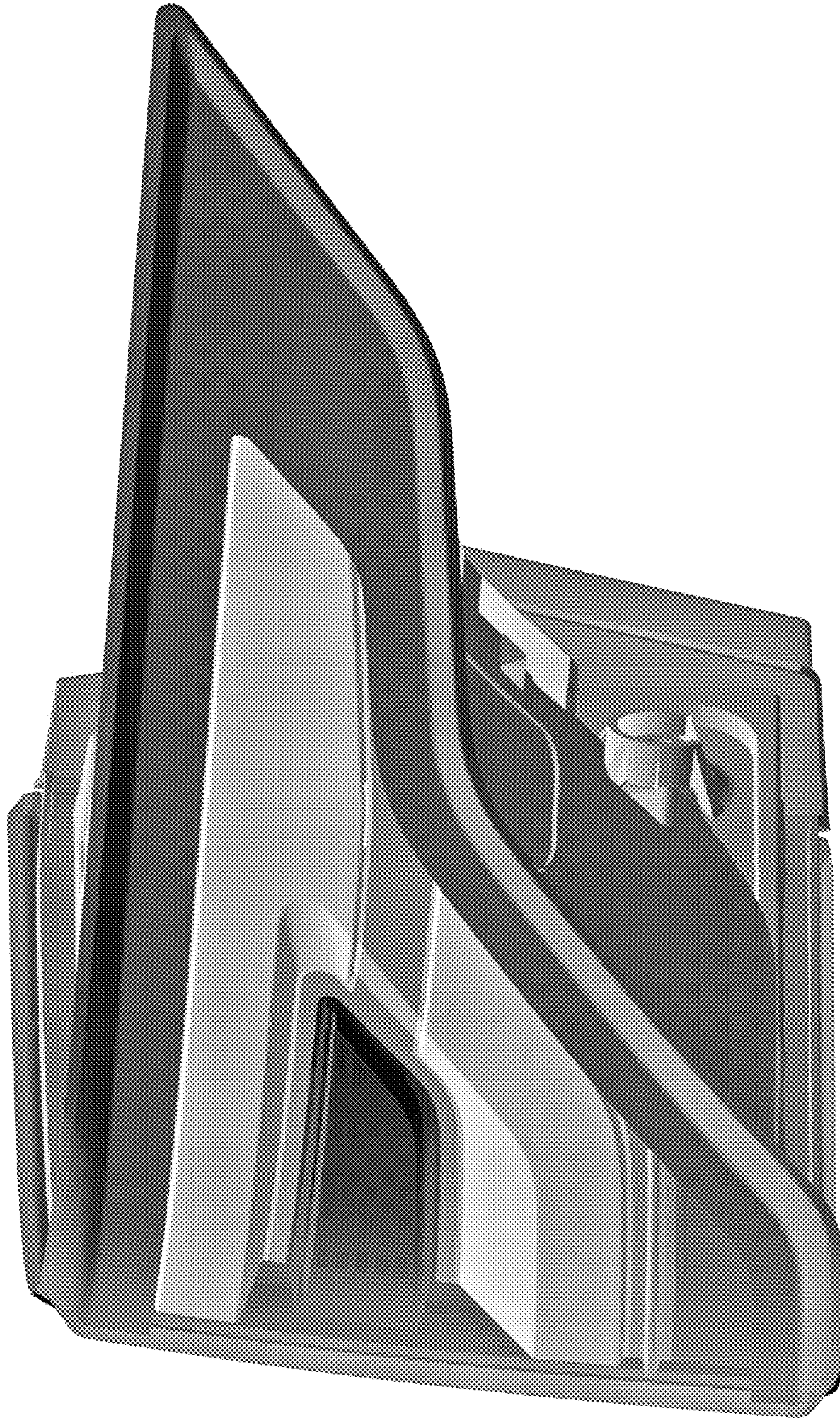

FIG. 7

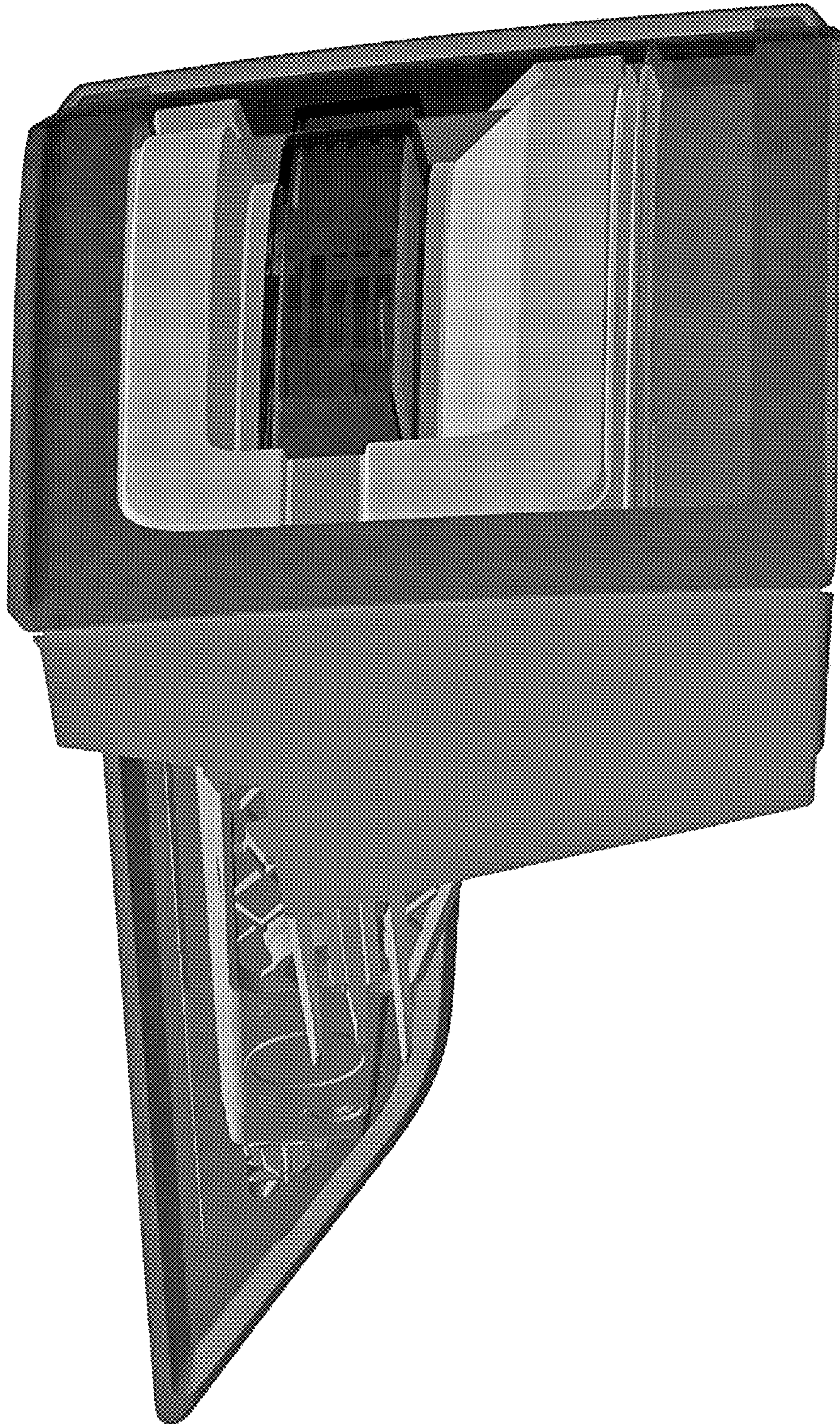

FIG. 8

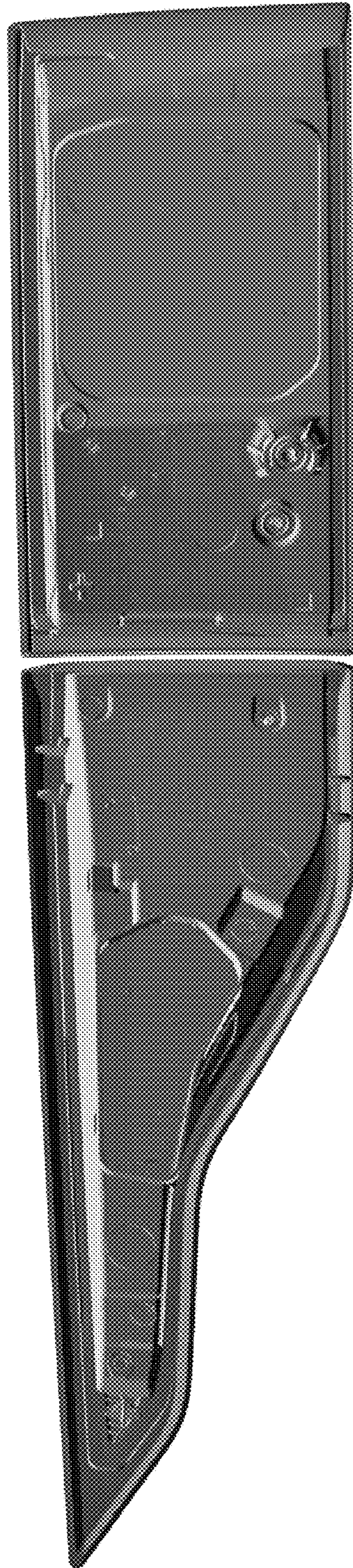

FIG. 9

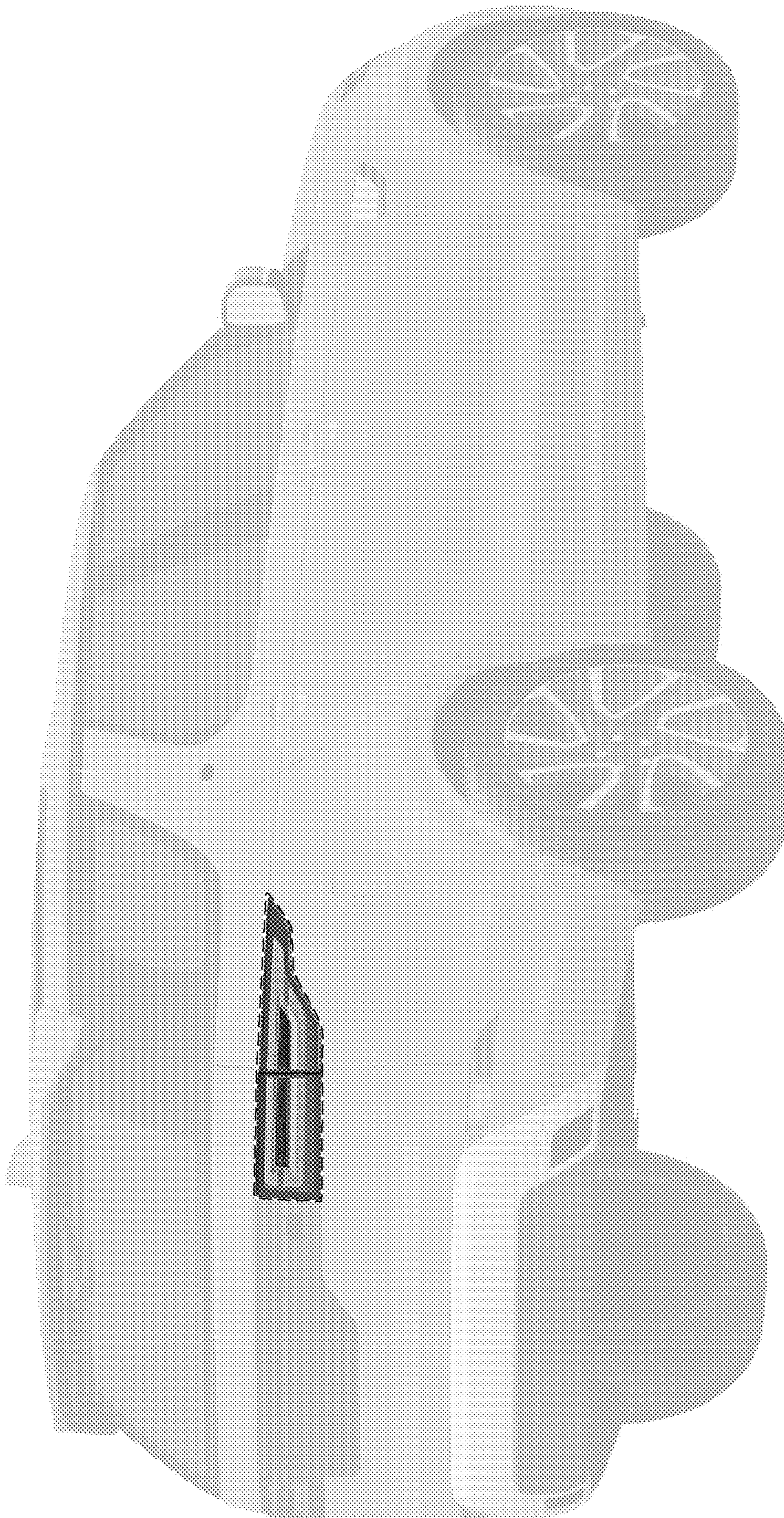

FIG. 10

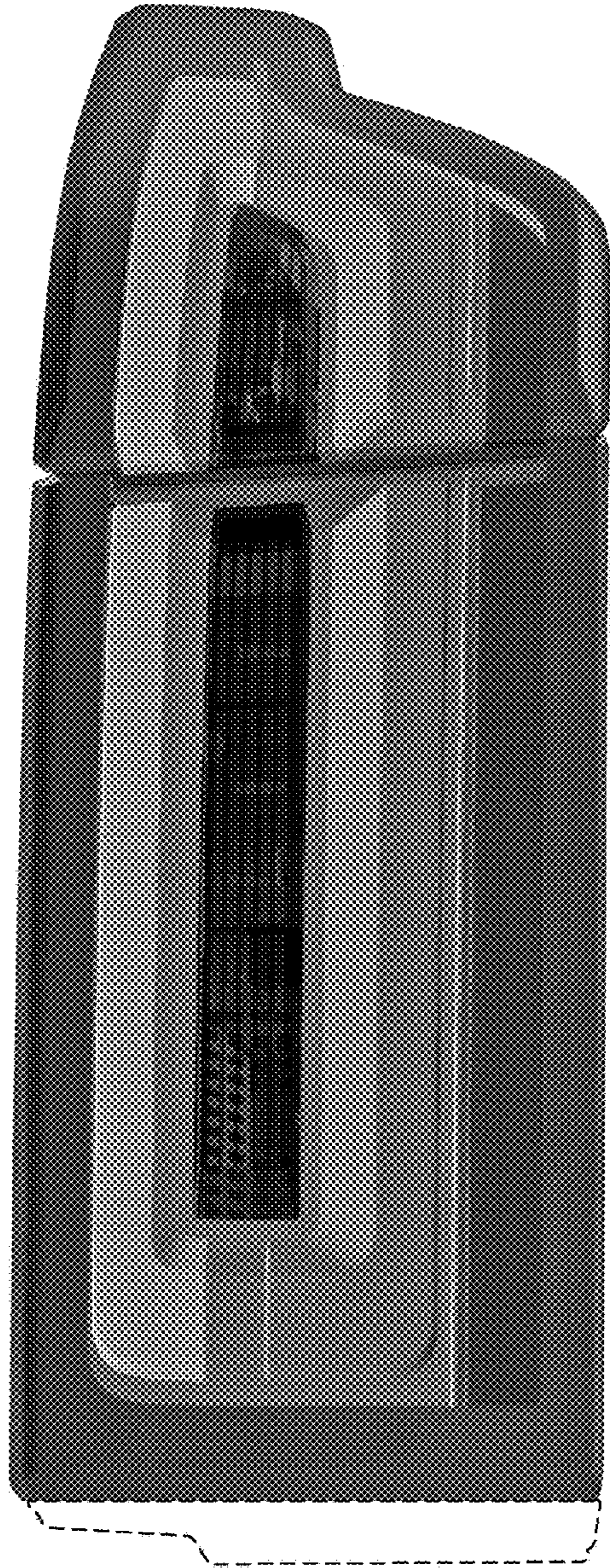

FIG. 11

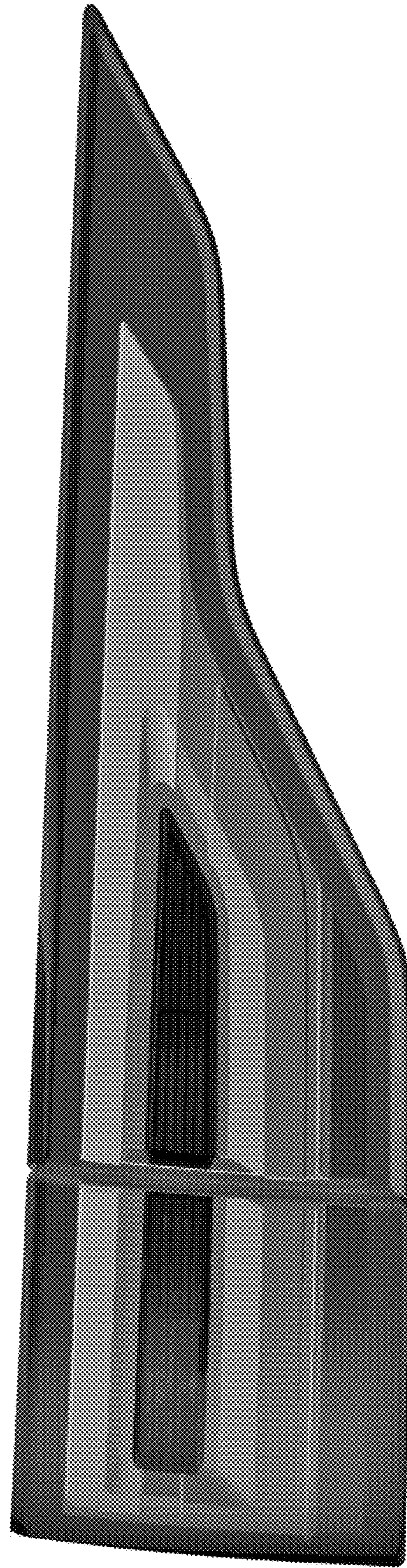

FIG. 12

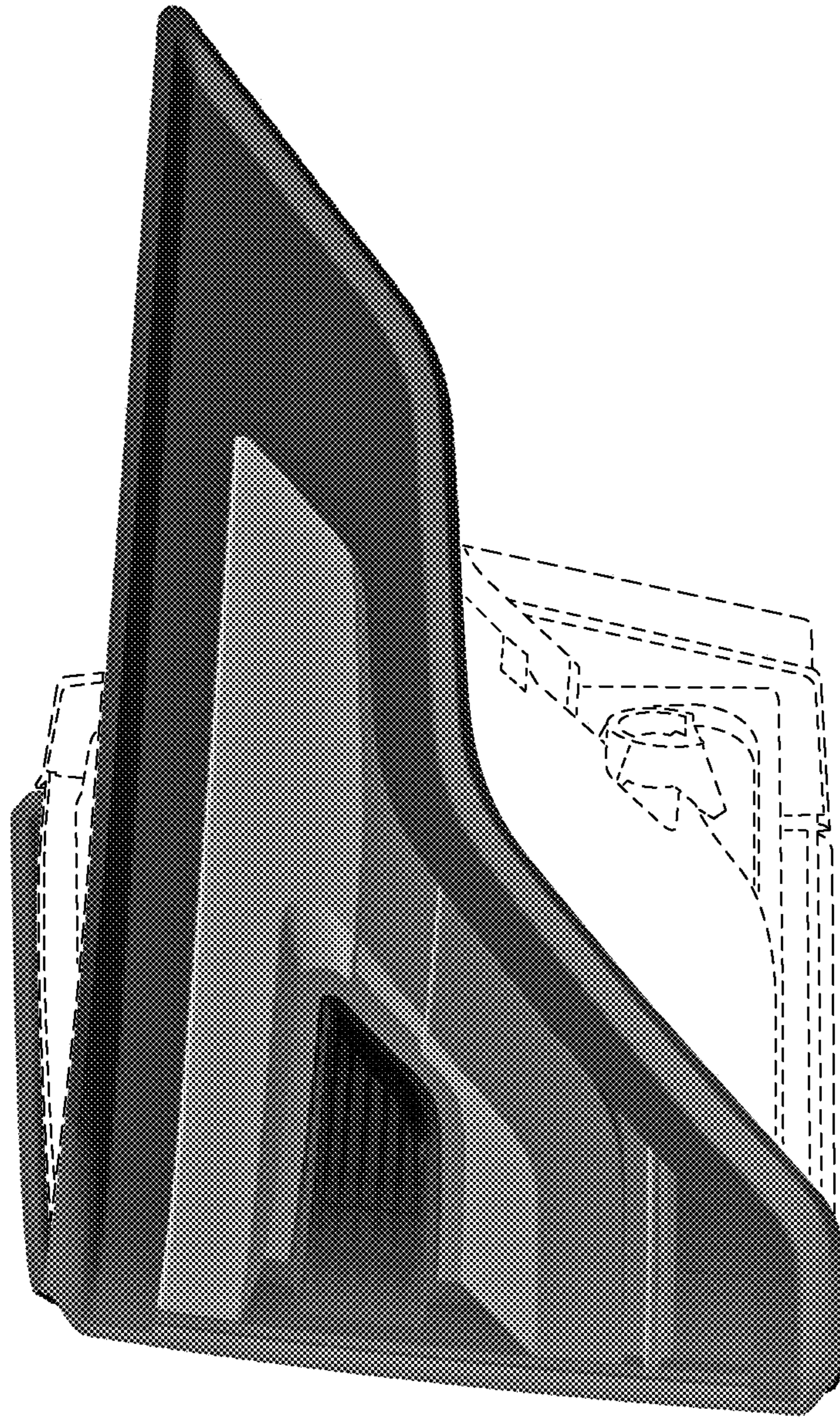

FIG. 13

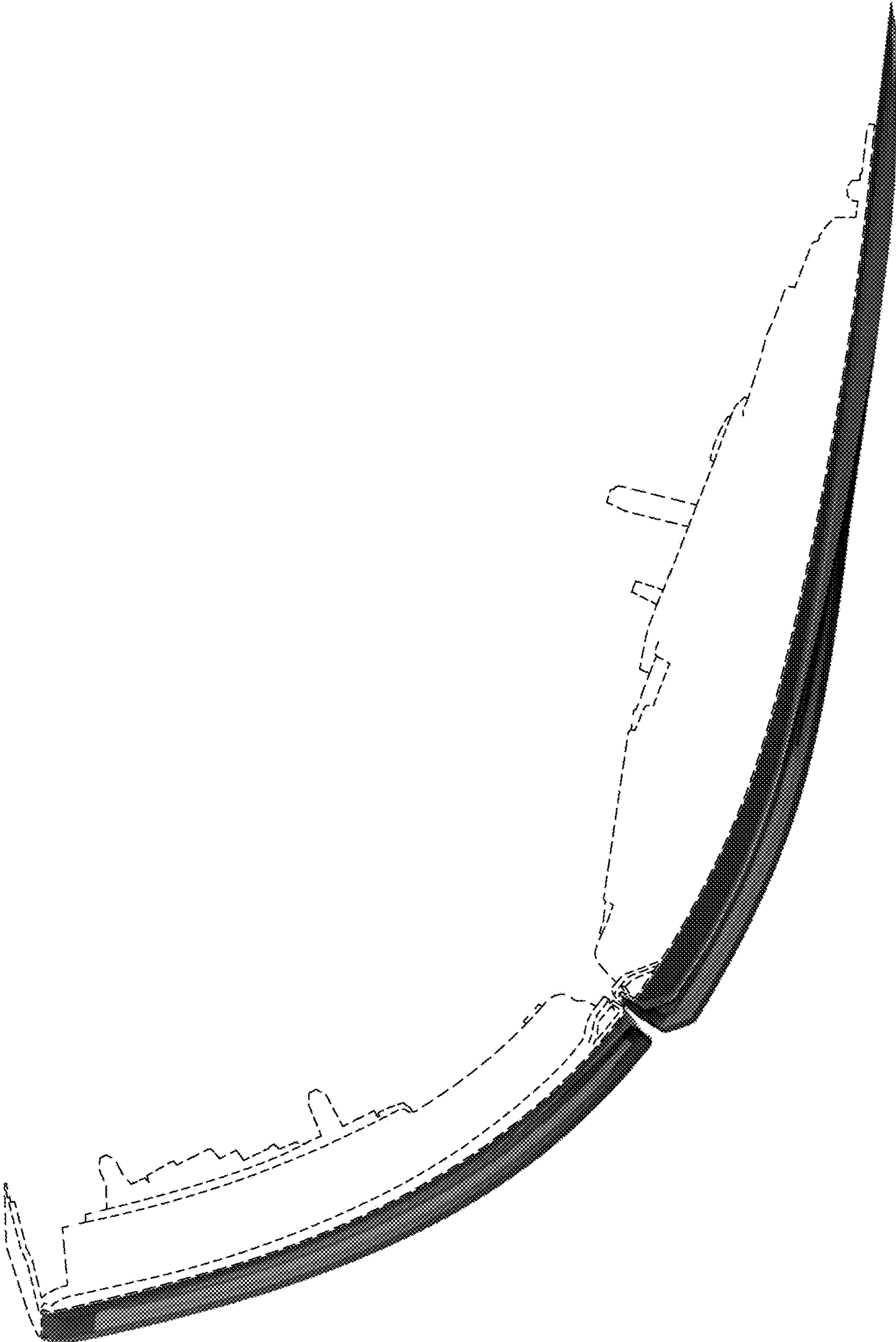

FIG. 14

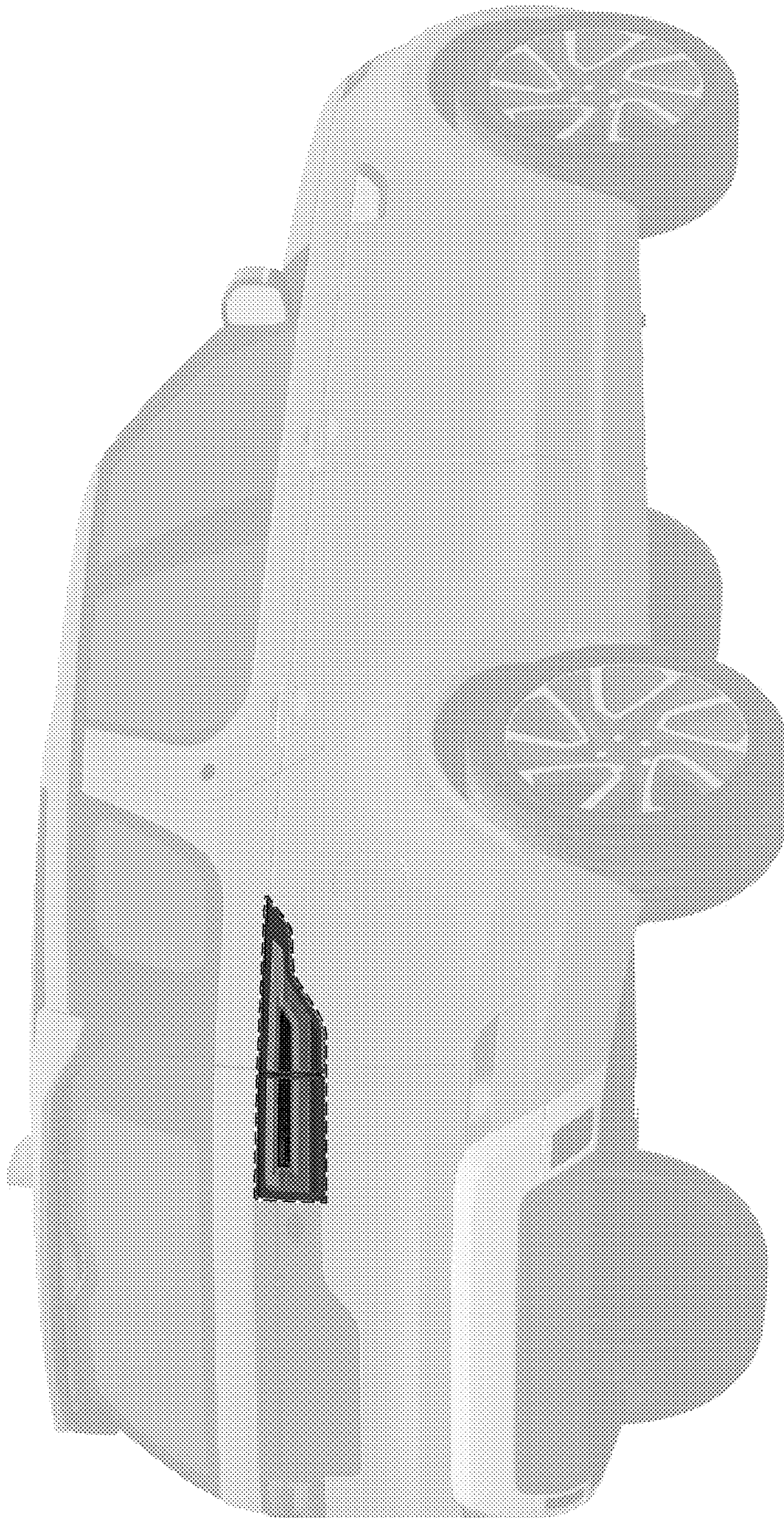

FIG. 15

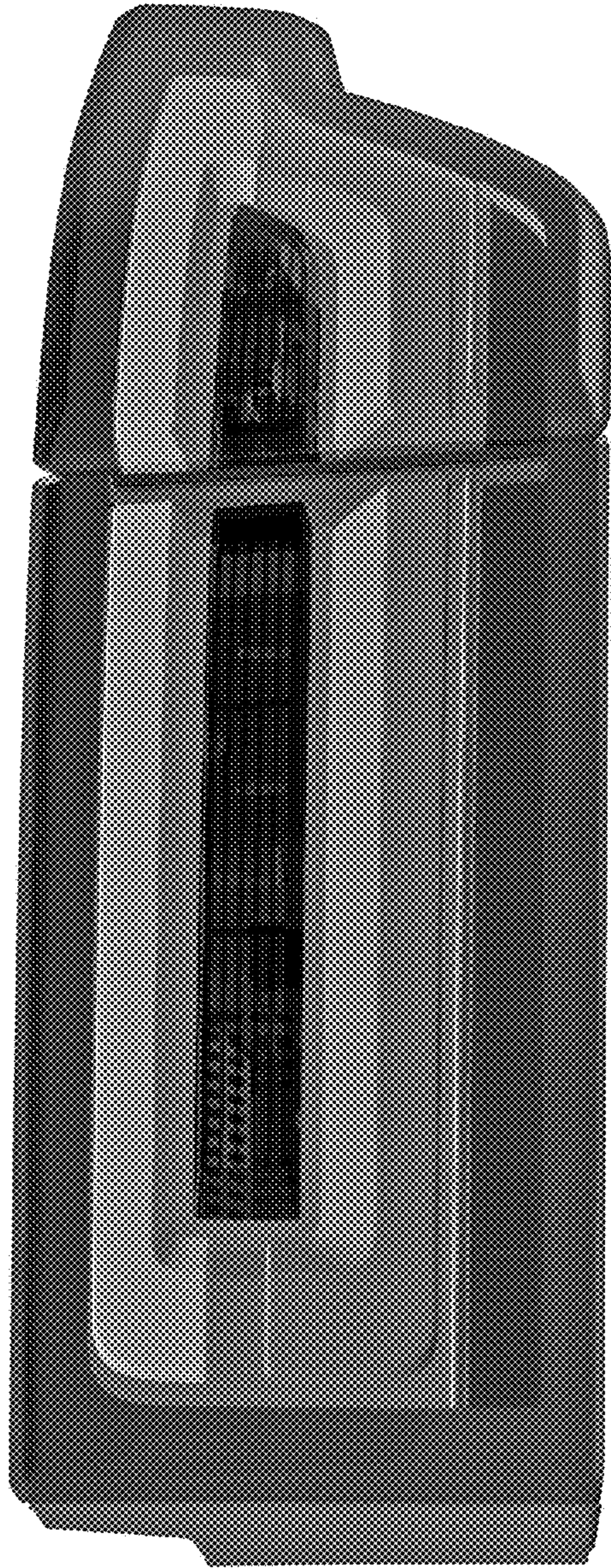

FIG. 16

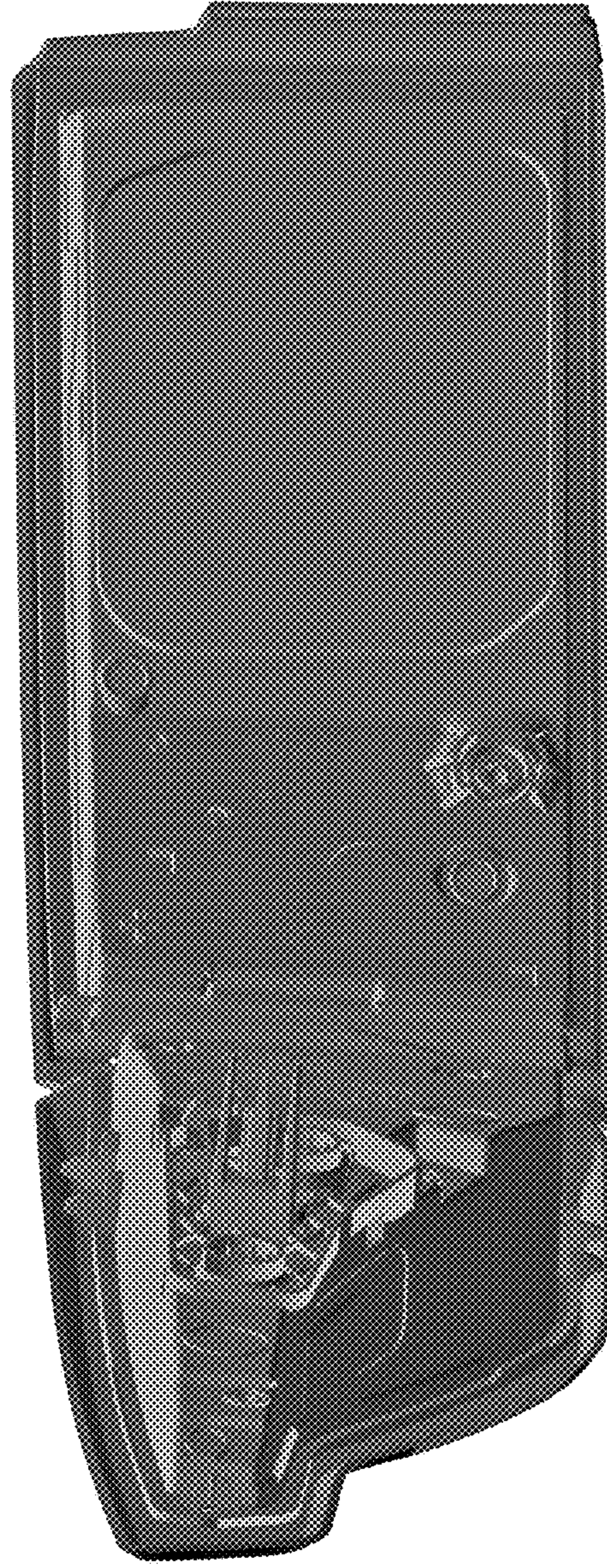

FIG. 17

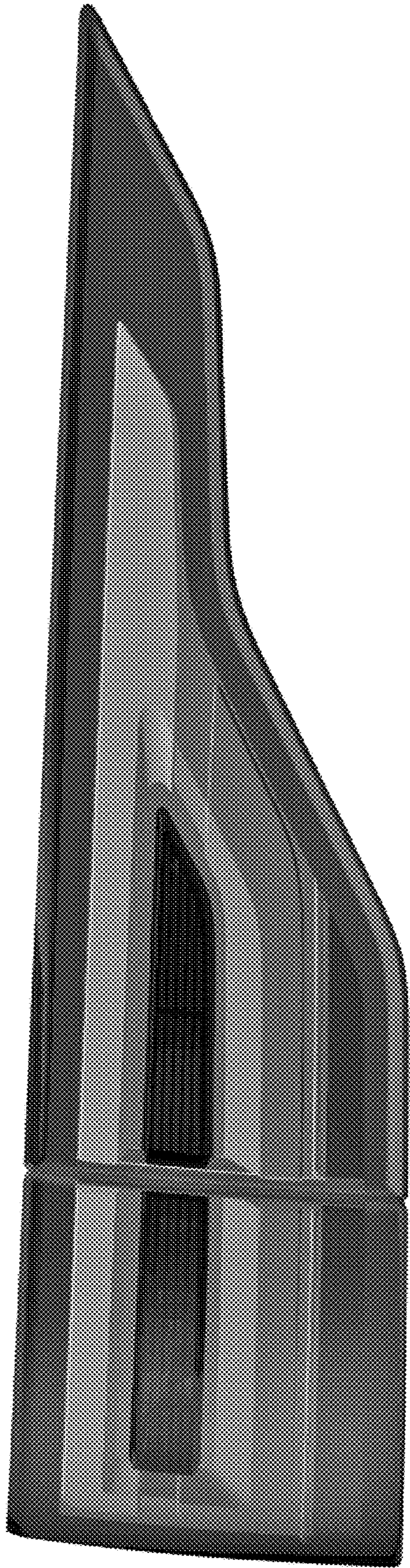

FIG. 18

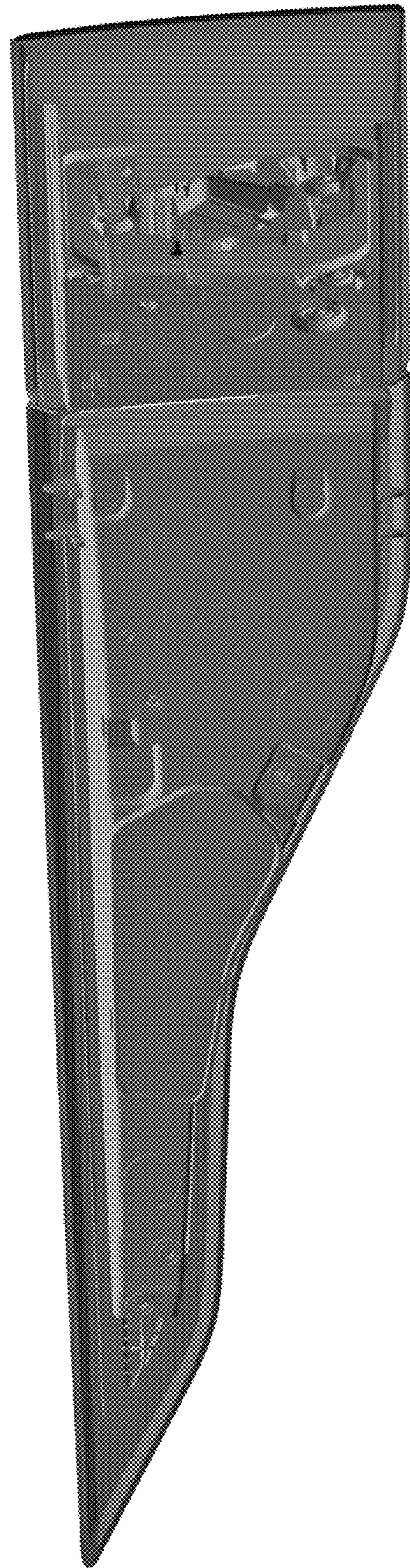

FIG. 19

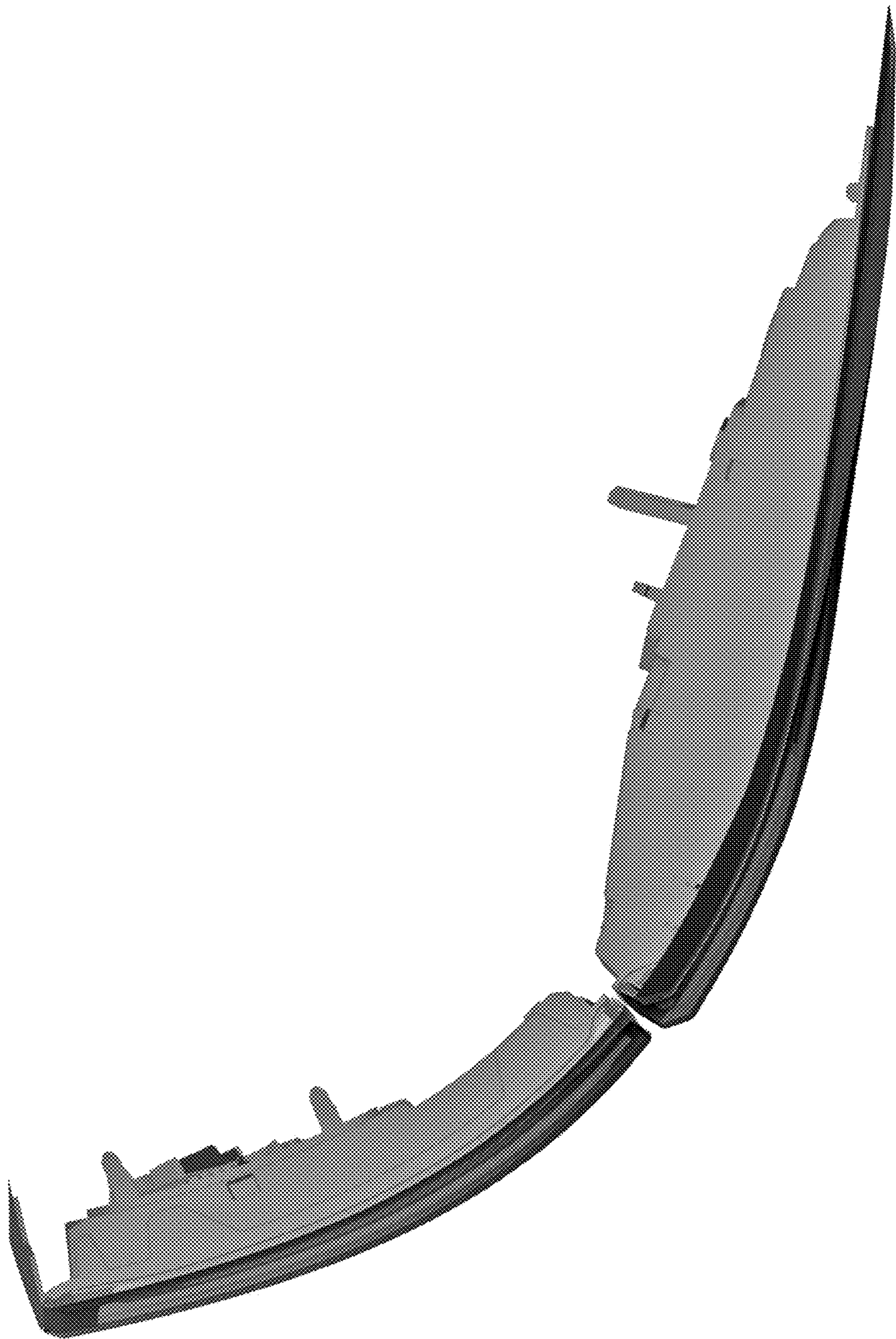

FIG. 20

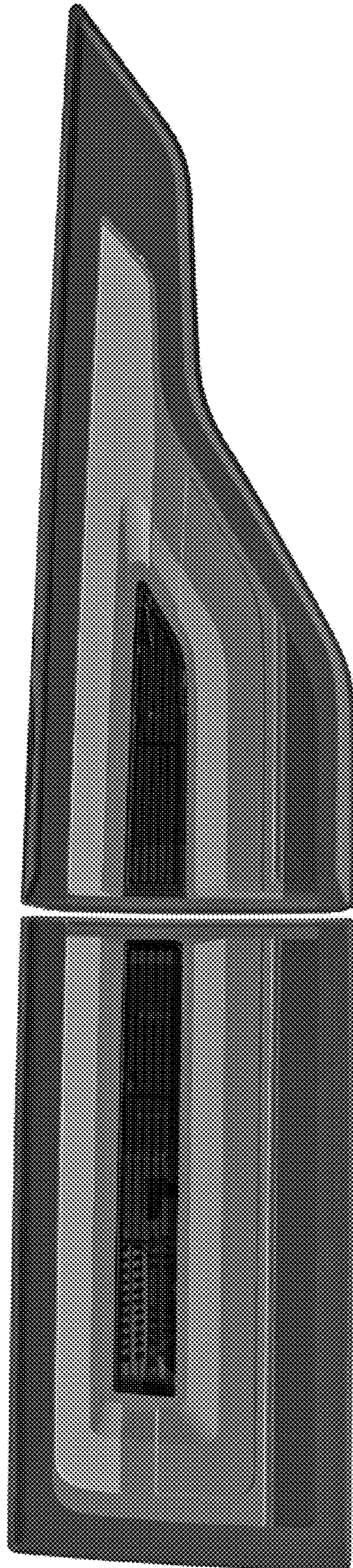

FIG. 21

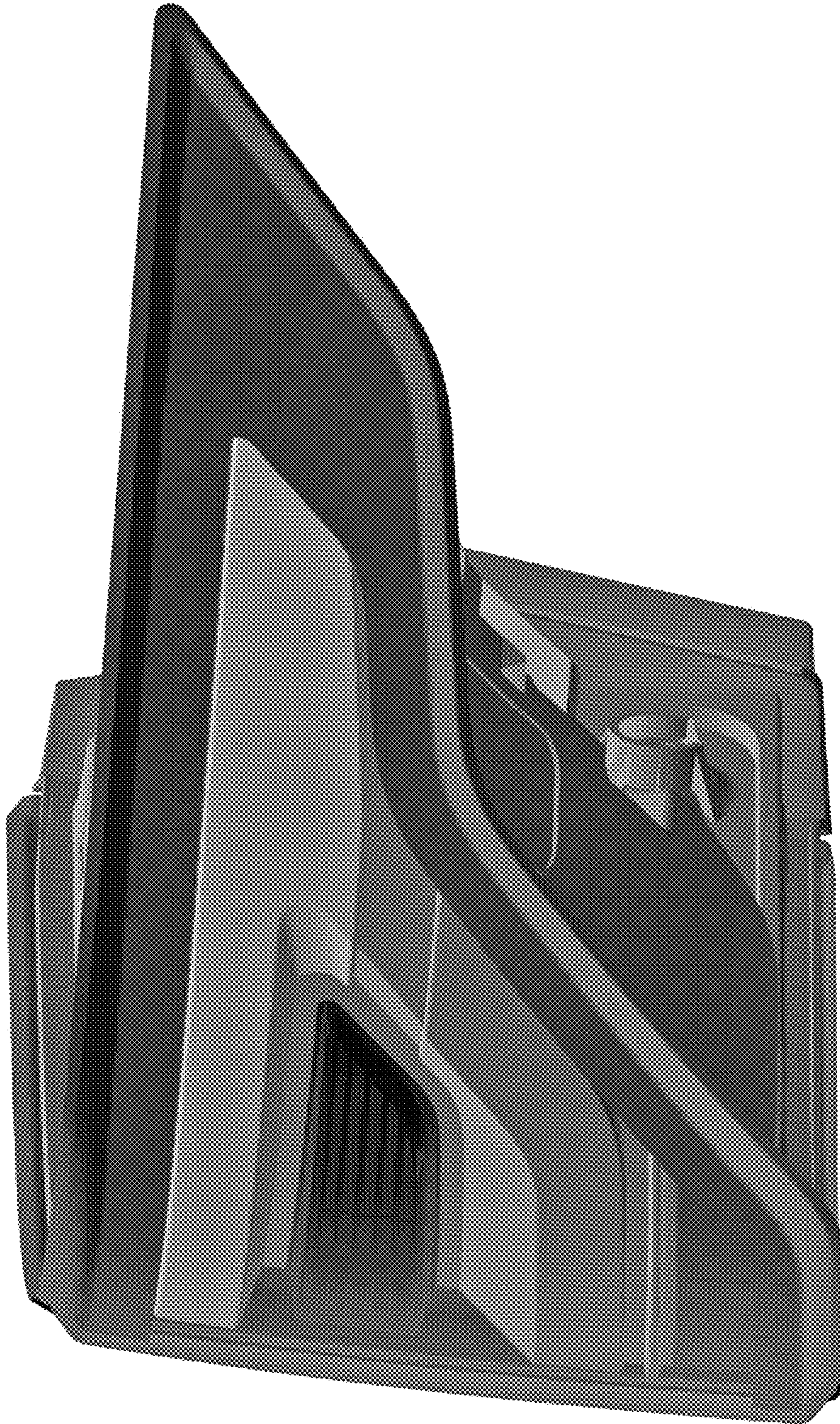

FIG. 22



FIG. 23

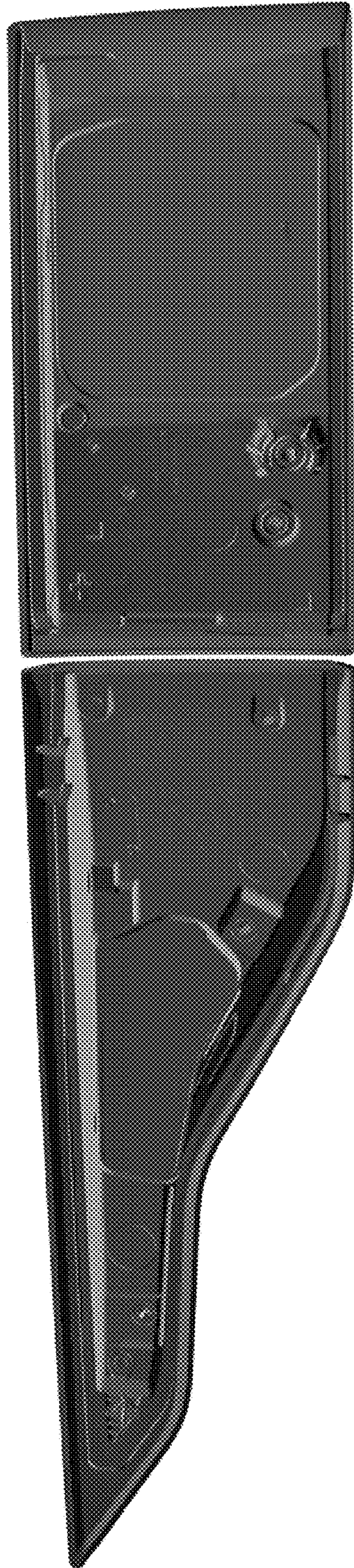

FIG. 24

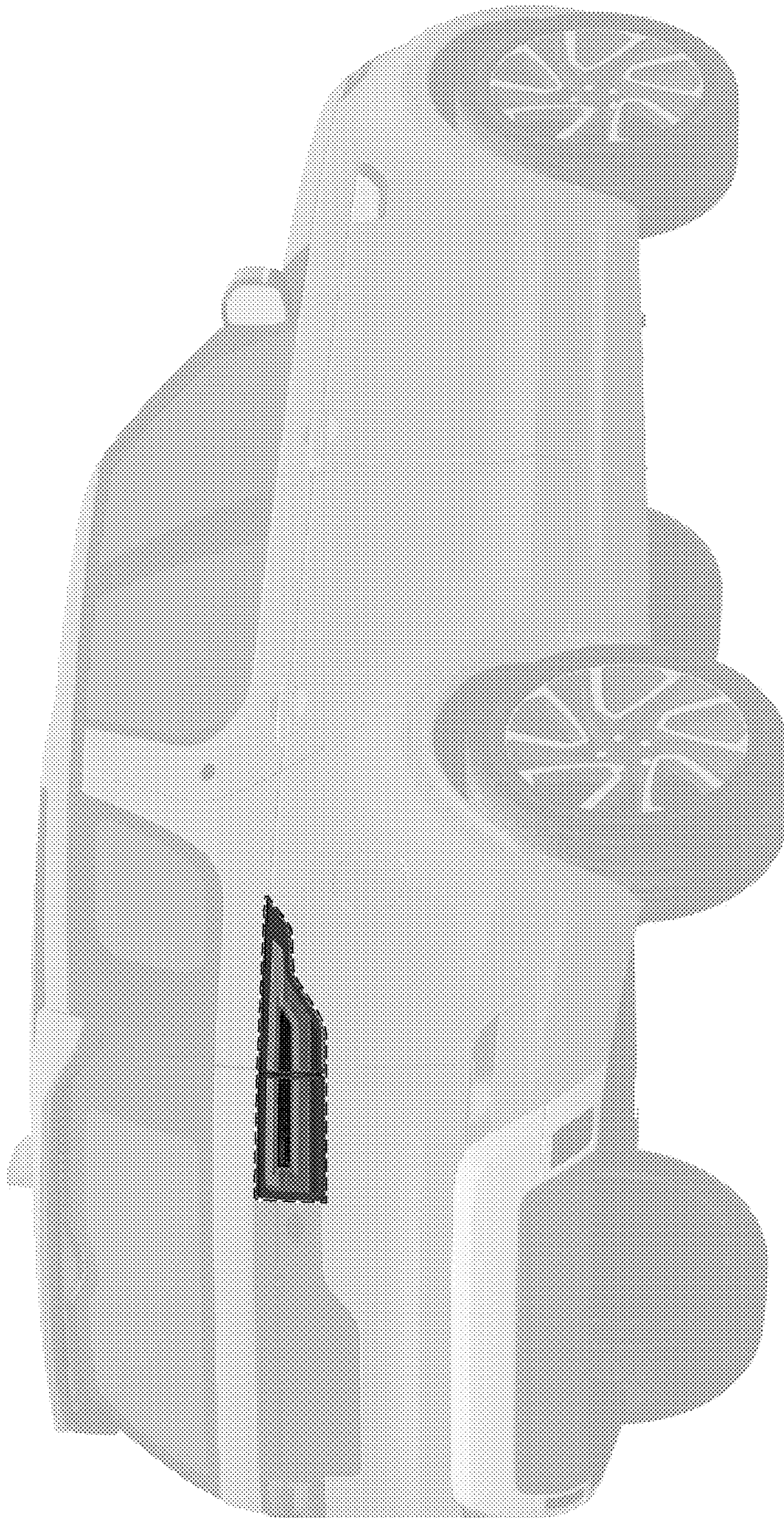

FIG. 25