



US00D876359S

(12) **United States Design Patent**
Ishiguro et al.

(10) **Patent No.:** **US D876,359 S**

(45) **Date of Patent:** **** Feb. 25, 2020**

(54) **CONNECTOR**

(71) Applicant: **Japan Aviation Electronics Industry, Limited**, Tokyo (JP)

(72) Inventors: **Masaki Ishiguro**, Tokyo (JP); **Yuichi Koreeda**, Tokyo (JP); **Hideto Shimazu**, Tokyo (JP)

(73) Assignee: **JAPAN AVIATION ELECTRONICS INDUSTRY, LIMITED**, Tokyo (JP)

(**) Term: **15 Years**

(21) Appl. No.: **29/673,120**

(22) Filed: **Dec. 12, 2018**

(30) **Foreign Application Priority Data**

Jun. 20, 2018 (JP) 2018-013555

(51) **LOC (12) Cl.** **13-03**

(52) **U.S. Cl.**
USPC **D13/133**

(58) **Field of Classification Search**
USPC D13/110, 118, 120, 123, 133, 146, 147, D13/149, 151, 154, 173, 184, 199
CPC G02B 6/36; G02B 6/38; G02B 6/3869; G02B 6/389; H01R 13/504; H01R 13/52; H01R 13/62; H01R 13/627; H01R 13/629; H01R 13/639; H01R 24/40; H01R 24/66
See application file for complete search history.

(56) **References Cited**

U.S. PATENT DOCUMENTS

D251,491 S * 4/1979 Snyder, Jr. D13/146
D597,947 S * 8/2009 Ono D13/133
D698,730 S * 2/2014 Hori D13/146
D744,954 S * 12/2015 Ishiguro D13/147
D780,123 S * 2/2017 Zetterqvist D13/146
D803,158 S * 11/2017 Smajda D13/138.1

D820,788 S * 6/2018 Smajda D13/138.1
D821,327 S * 6/2018 Smajda D13/138.1
D860,137 S * 9/2019 Ishiguro D13/133
2013/0301993 A1 * 11/2013 Toda G02B 6/36
385/76
2015/0194765 A1 * 7/2015 Yu H01R 13/629
439/372

(Continued)

FOREIGN PATENT DOCUMENTS

JP 2016176975 A * 10/2016 G02B 6/44
JP 2017111228 A * 6/2017 H01R 13/639

Primary Examiner — Angela J Lee

Assistant Examiner — Shawn T Gingrich

(74) *Attorney, Agent, or Firm* — Manabu Kanesaka

(57) **CLAIM**

The ornamental design for a connector, as shown and described.

DESCRIPTION

FIG. 1 is a front elevational view of a connector showing our new design;
FIG. 2 is a rear elevational view thereof;
FIG. 3 is a right side elevational view thereof;
FIG. 4 is a left side elevational view thereof;
FIG. 5 is a top plan view thereof;
FIG. 6 is a bottom plan view thereof;
FIG. 7 is a perspective view showing a front, top and right side thereof;
FIG. 8 is a perspective view showing a rear, bottom and left side thereof;
FIG. 9 is a perspective view showing a front, right and bottom side thereof; and,
FIG. 10 is a perspective view showing a rear, left and top side thereof.

The broken line showing of the connector is for the purpose of illustrating portions of the article and forms no part of the claimed design.

1 Claim, 5 Drawing Sheets

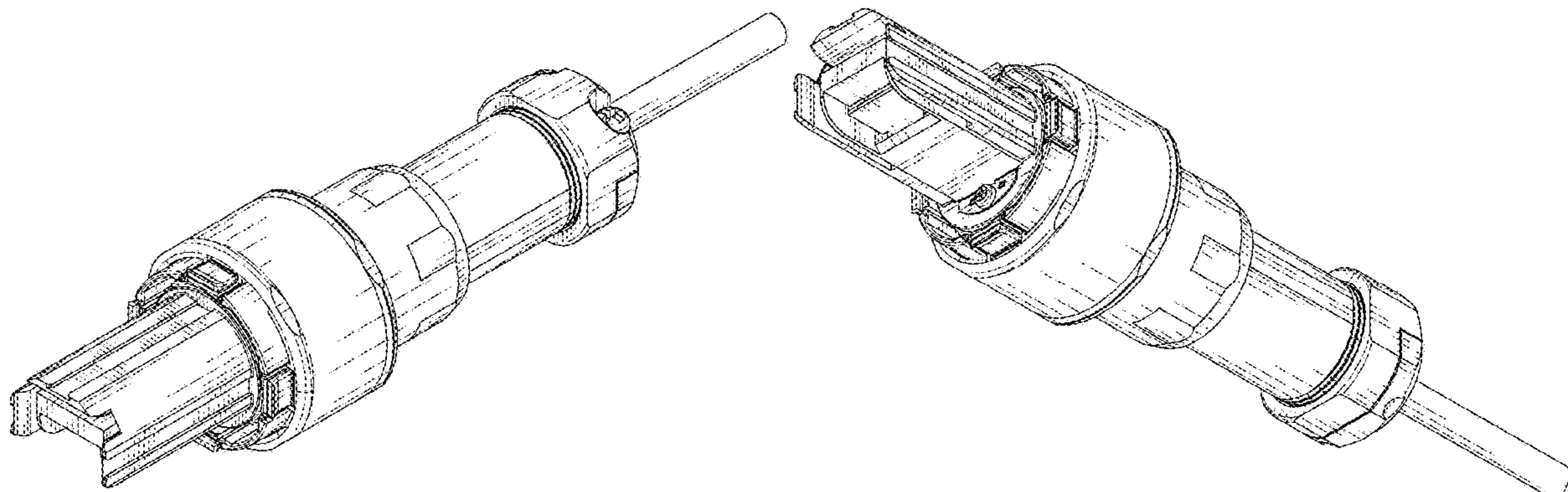

(56)

References Cited

U.S. PATENT DOCUMENTS

2015/0301294 A1* 10/2015 Chang G02B 6/3887
385/87
2016/0266326 A1* 9/2016 Gniadek H01R 13/625
2016/0322739 A1* 11/2016 Taylor E21B 17/20
2017/0299817 A1* 10/2017 Huang G02B 6/36

* cited by examiner

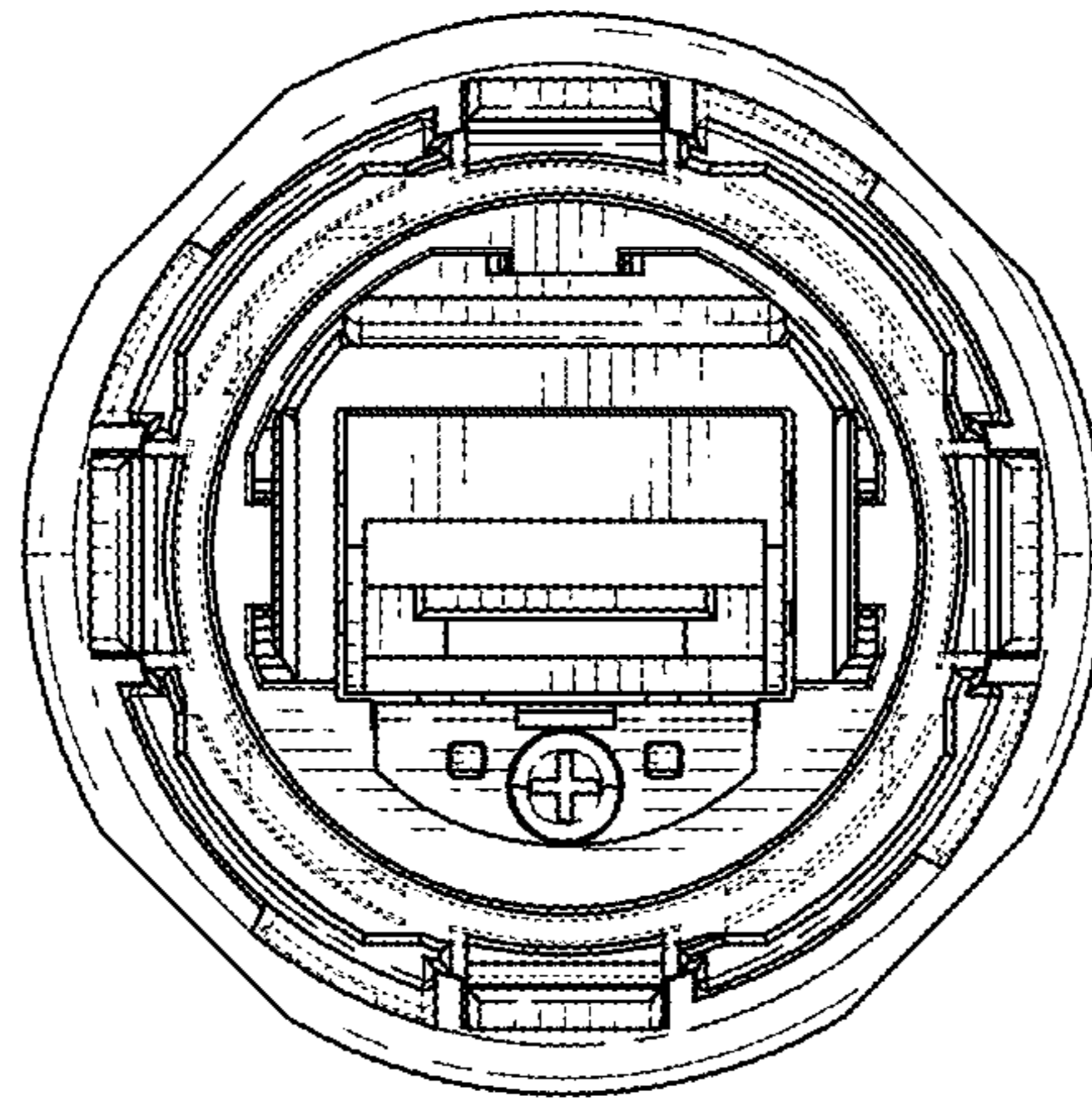

FIG. 1

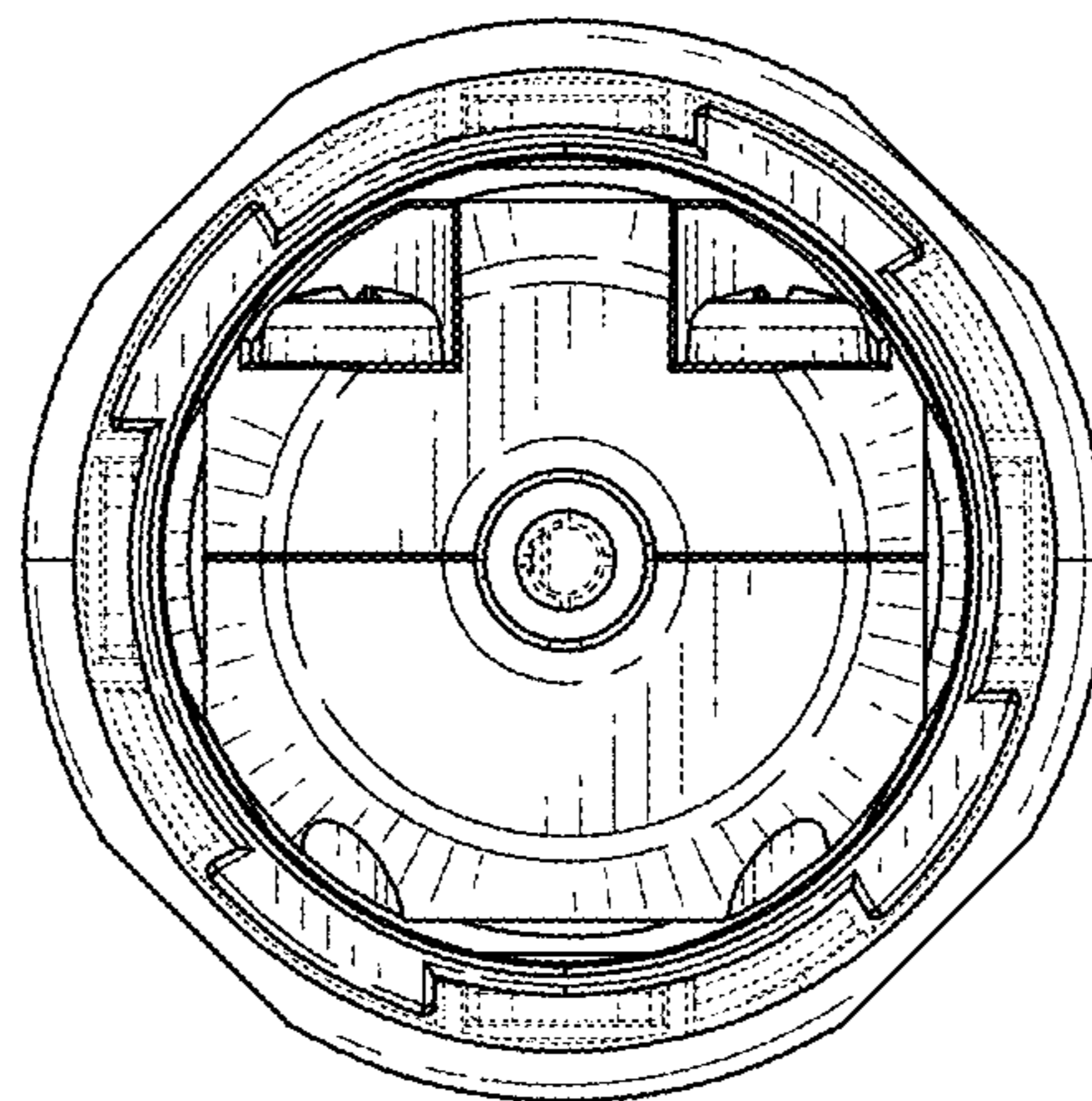

FIG. 2

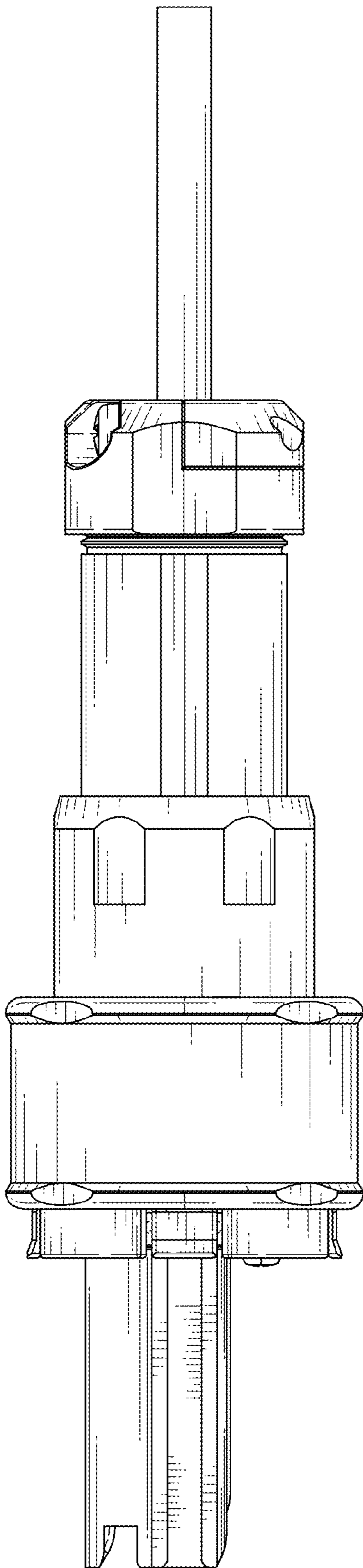

FIG. 3

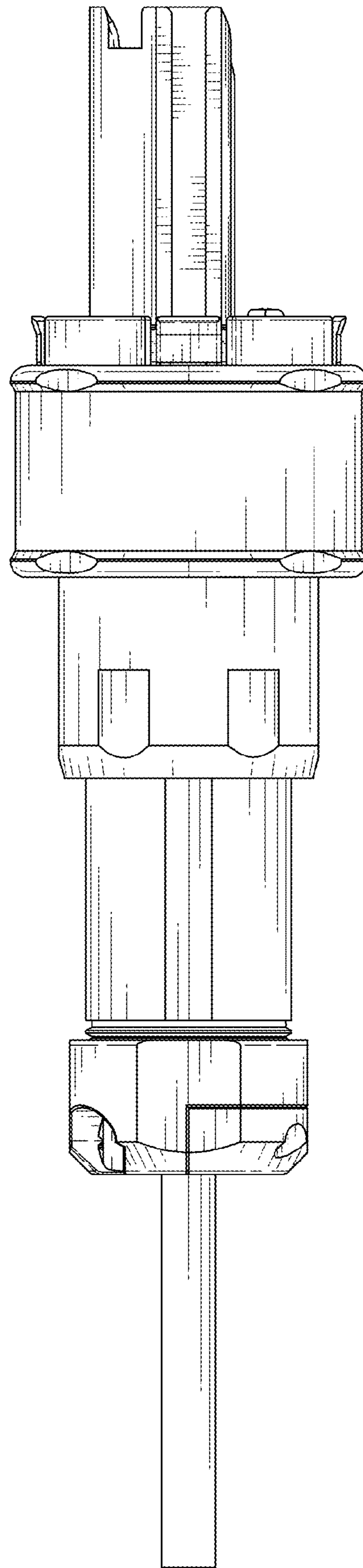

FIG. 4

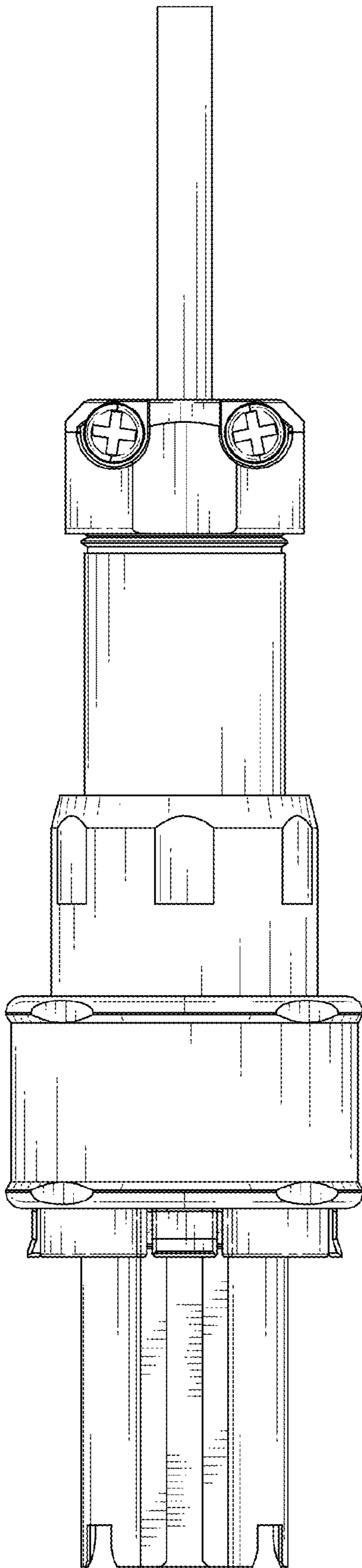

FIG. 5

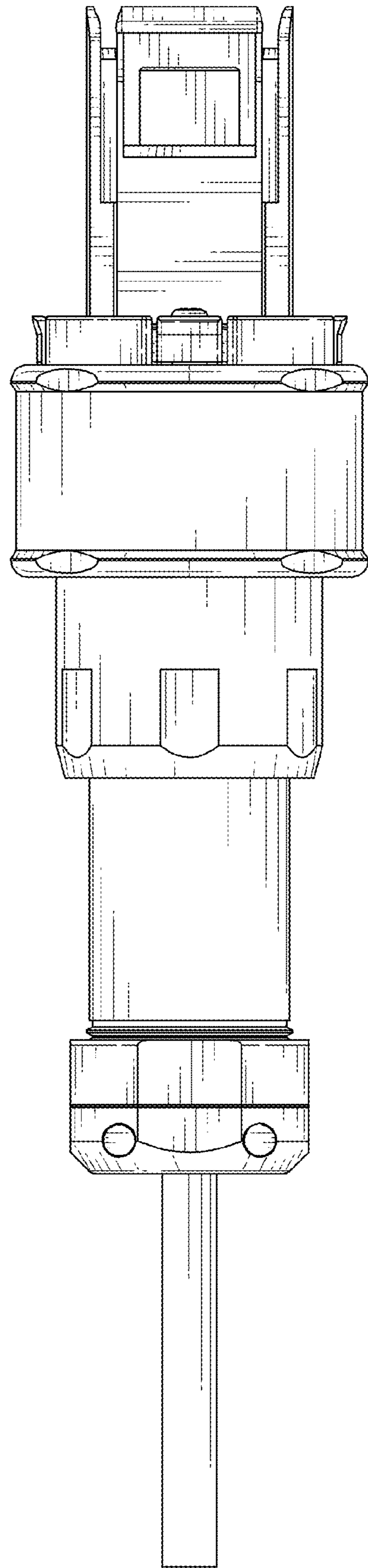

FIG. 6

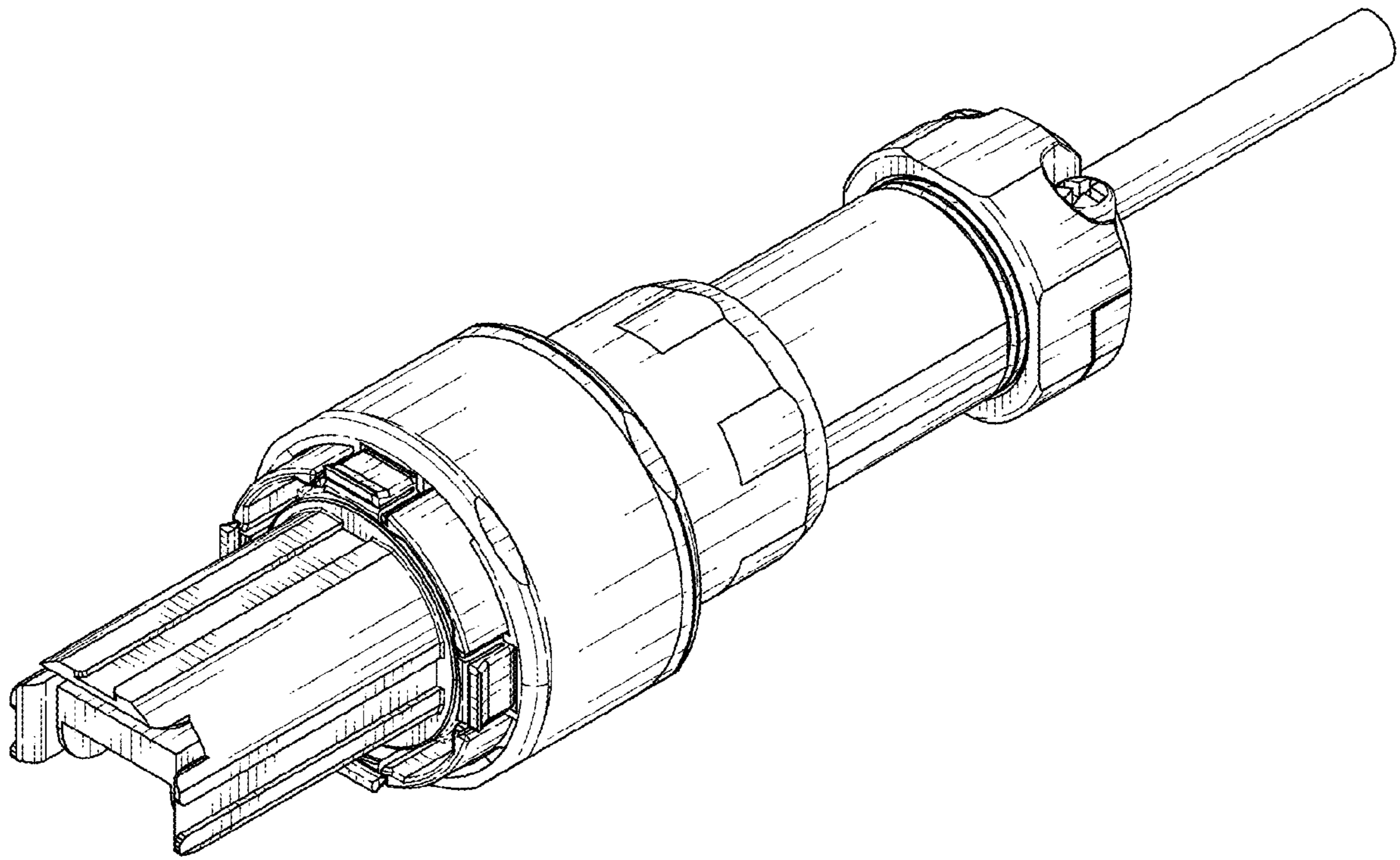

FIG. 7

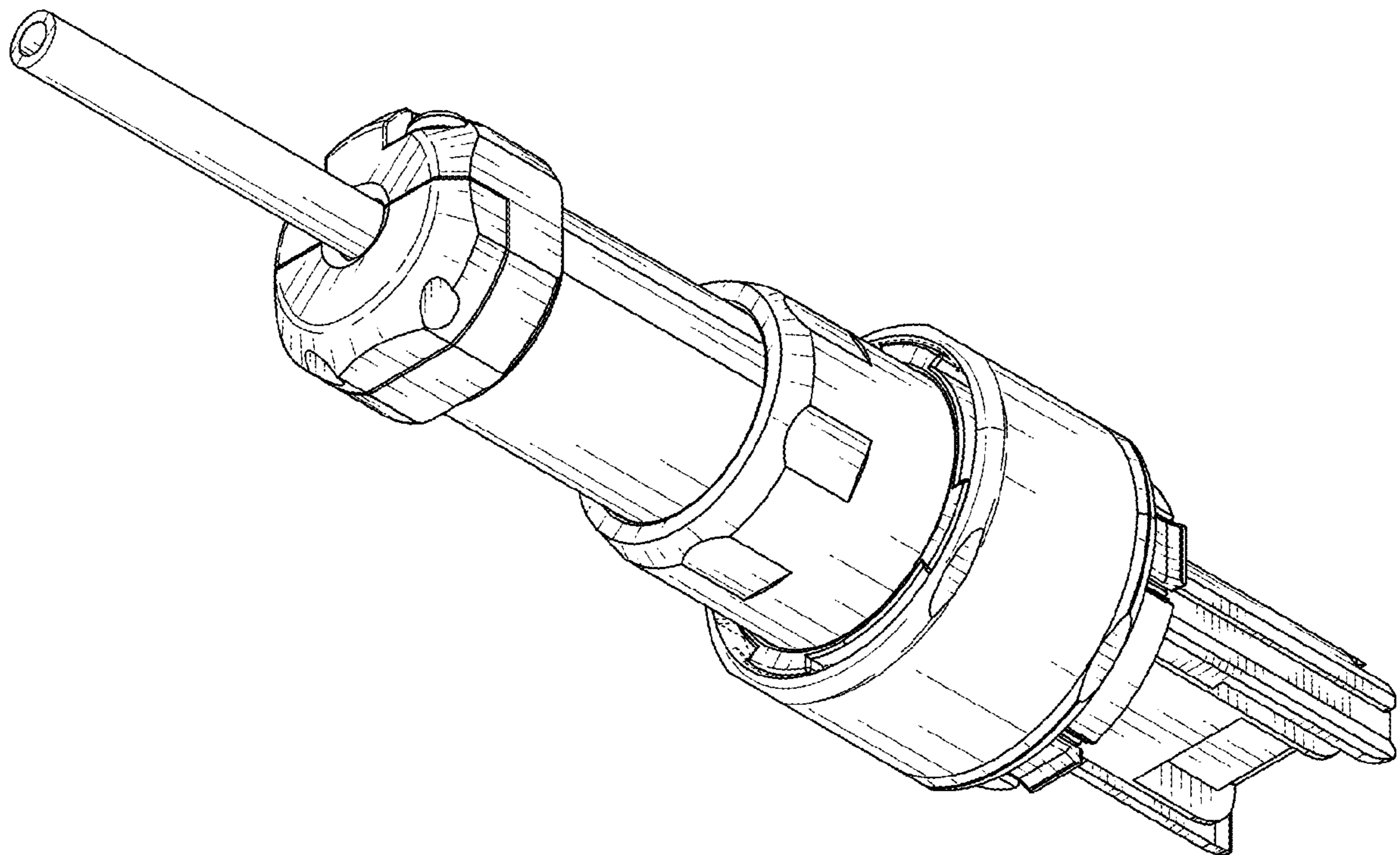

FIG. 8

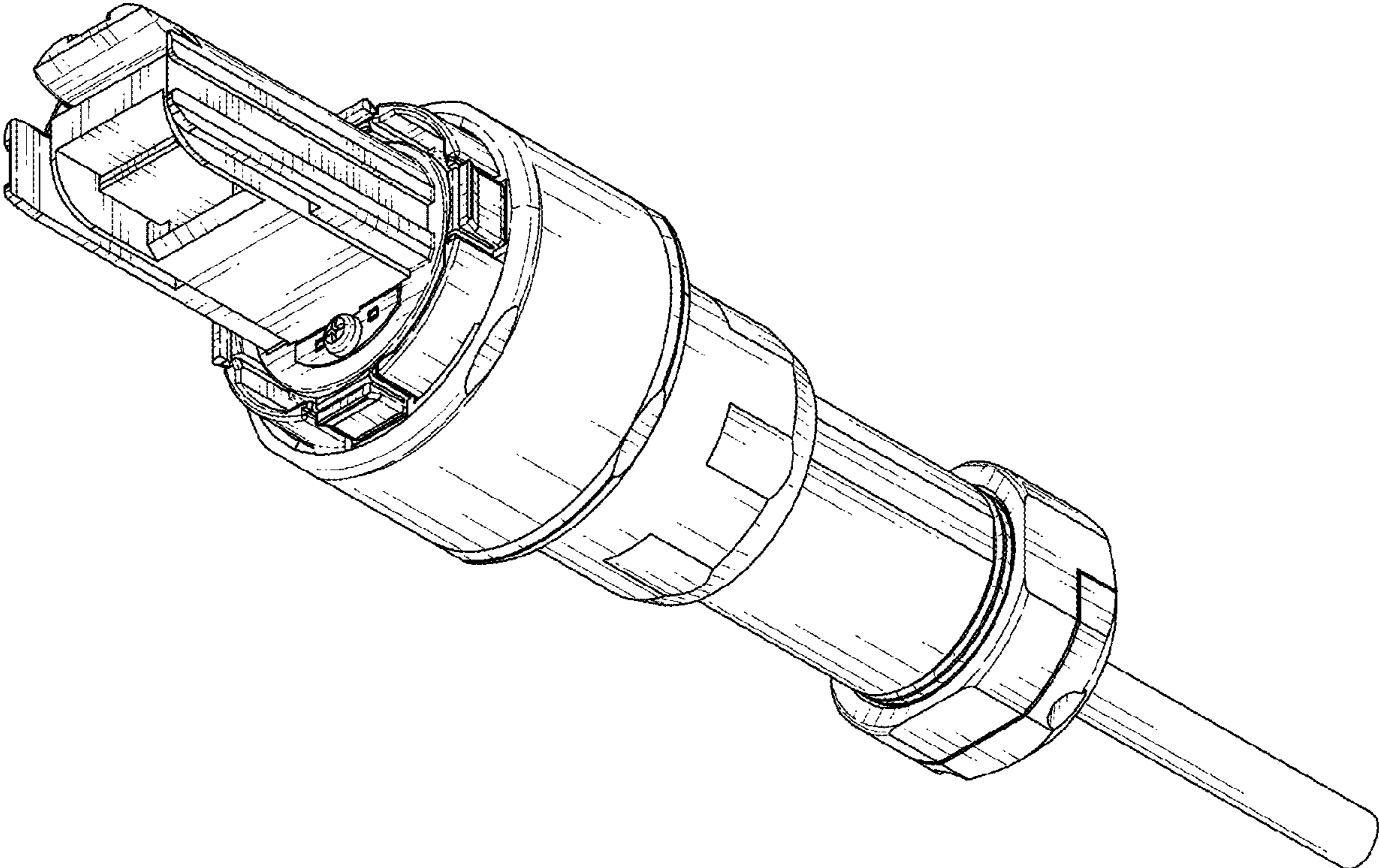

FIG. 9

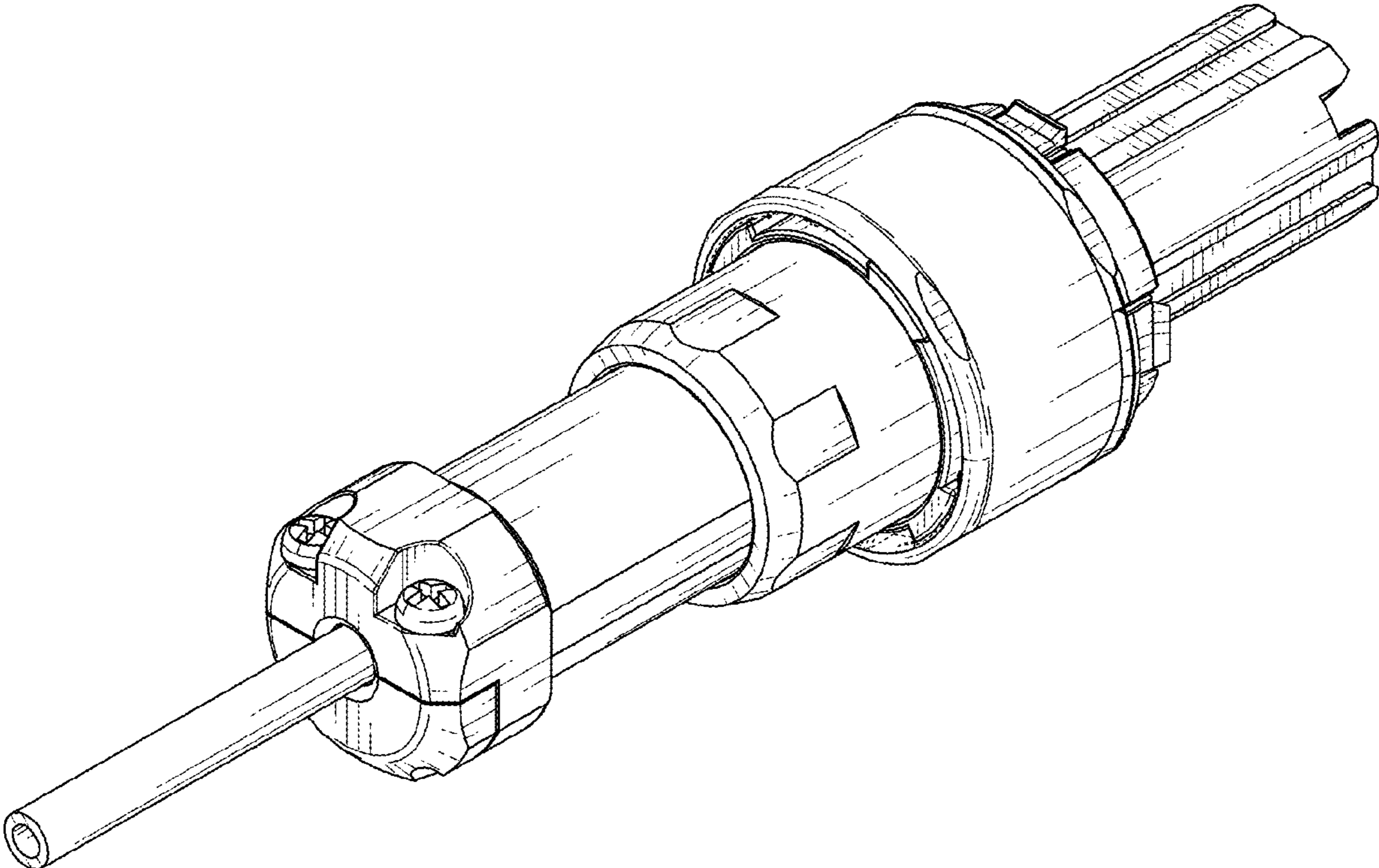

FIG. 10