



US00D874563S

(12) **United States Design Patent**
Suzuki et al.

(10) **Patent No.:** **US D874,563 S**
(45) **Date of Patent:** **** Feb. 4, 2020**

(54) **IMAGE DRUM CARTRIDGE**
(71) Applicant: **OKI DATA CORPORATION**, Tokyo (JP)

D599,846 S * 9/2009 Yasui D18/43
D601,184 S * 9/2009 Ogasawara D18/43
D647,956 S * 11/2011 Kweon D18/43
(Continued)

(72) Inventors: **Masayuki Suzuki**, Tokyo (JP);
Mitsuhiro Kawata, Tokyo (JP);
Junichi Ito, Tokyo (JP); **Hisatoshi Saito**, Tokyo (JP)

FOREIGN PATENT DOCUMENTS

GB 1031659 * 7/1986
GB 2094647 * 8/2000
JP D1351995 * 2/2009

(73) Assignee: **OKI DATA CORPORATION**, Tokyo (JP)

OTHER PUBLICATIONS

(**) Term: **15 Years**

Amazon. <URL: [\(21\) Appl. No.: **29/598,909**](https://www.amazon.com/Canon-Original-104-Toner-Cartridge/dp/B000B02BEM/ref=pd_sim_229_4?encoding=UTF8&pd_rd_i=B000B02BEM&pd_rd_r=KWFG6K79JEWJDWZ3QR5B&pd_rd_w=36lol&pd_rd_wg=fTlCg&psc=1&refRID=KWFG6K79JEWJDWZ3QR5B.> Jun. 17, 2003. Canon Toner Cartridge.*</p></div>
<div data-bbox=)

(22) Filed: **Mar. 29, 2017**

Primary Examiner — Susan Bennett Hattan
Assistant Examiner — Lauren D McVey
(74) *Attorney, Agent, or Firm* — Ladas & Parry LLP

(30) **Foreign Application Priority Data**

Sep. 30, 2016 (JP) 2016-021119

(51) **LOC (12) Cl.** **16-03**

(52) **U.S. Cl.**
USPC **D18/43**

(58) **Field of Classification Search**
USPC D18/40–45, 56
CPC G03G 15/0894; G03G 15/0896; G03G 15/0898; G03G 21/1661; G03G 21/1666; G03G 21/1671; G03G 21/1676; G03G 21/168; G03G 21/1685; G03G 21/169; G03G 21/1695; G03G 21/18; G03G 21/1803; G03G 21/1807; G03G 15/0868; G03G 15/087; G03G 15/0872; G03G 15/0874; G03G 15/0875; G03G 15/0877
See application file for complete search history.

(57) **CLAIM**

We claim the ornamental design for an image drum cartridge, as shown and described.

(56) **References Cited**

U.S. PATENT DOCUMENTS

D450,344 S * 11/2001 Ito D18/40
D501,020 S * 1/2005 Otani D18/40
D581,974 S * 12/2008 Mekada D18/43
D588,633 S * 3/2009 Oda D18/43
D596,663 S * 7/2009 Kamimura D18/43

DESCRIPTION

FIG. 1 is a front elevation view of an image drum cartridge, showing our new design;
FIG. 2 is a rear elevation view thereof;
FIG. 3 is a right-side elevation view thereof;
FIG. 4 is a left-side elevation view thereof;
FIG. 5 is a top plan view thereof;
FIG. 6 is a bottom plan view thereof;
FIG. 7 is a top perspective view thereof; and,
FIG. 8 is a bottom perspective view thereof.
The broken line showing of the image drum cartridge is for the purpose of illustrating portions of the “article” and forms no part of the claimed design.

(Continued)

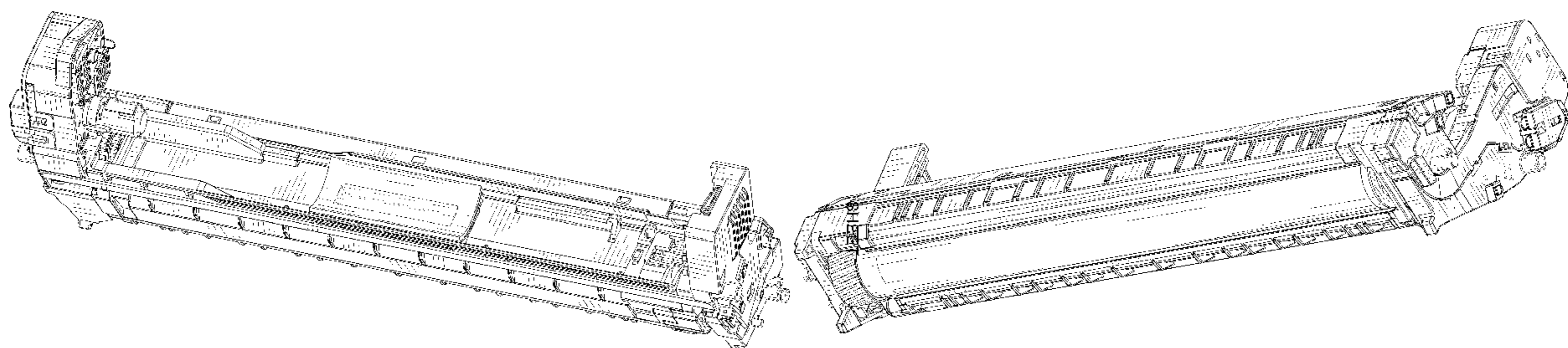

The wire frame lines shown throughout the views at the edges are intended to indicate surface contour.

1 Claim, 8 Drawing Sheets

(56) **References Cited**

U.S. PATENT DOCUMENTS

D718,378 S *	11/2014	Itabashi	D18/43
D722,336 S *	2/2015	Suzuki	D18/43
2008/0175631 A1 *	7/2008	Mimura	G03G 15/0813
			399/286
2008/0213005 A1 *	9/2008	Kobayashi	G03G 15/0875
			399/262
2012/0274992 A1 *	11/2012	Suzuki	G03G 21/1657
			358/474

* cited by examiner

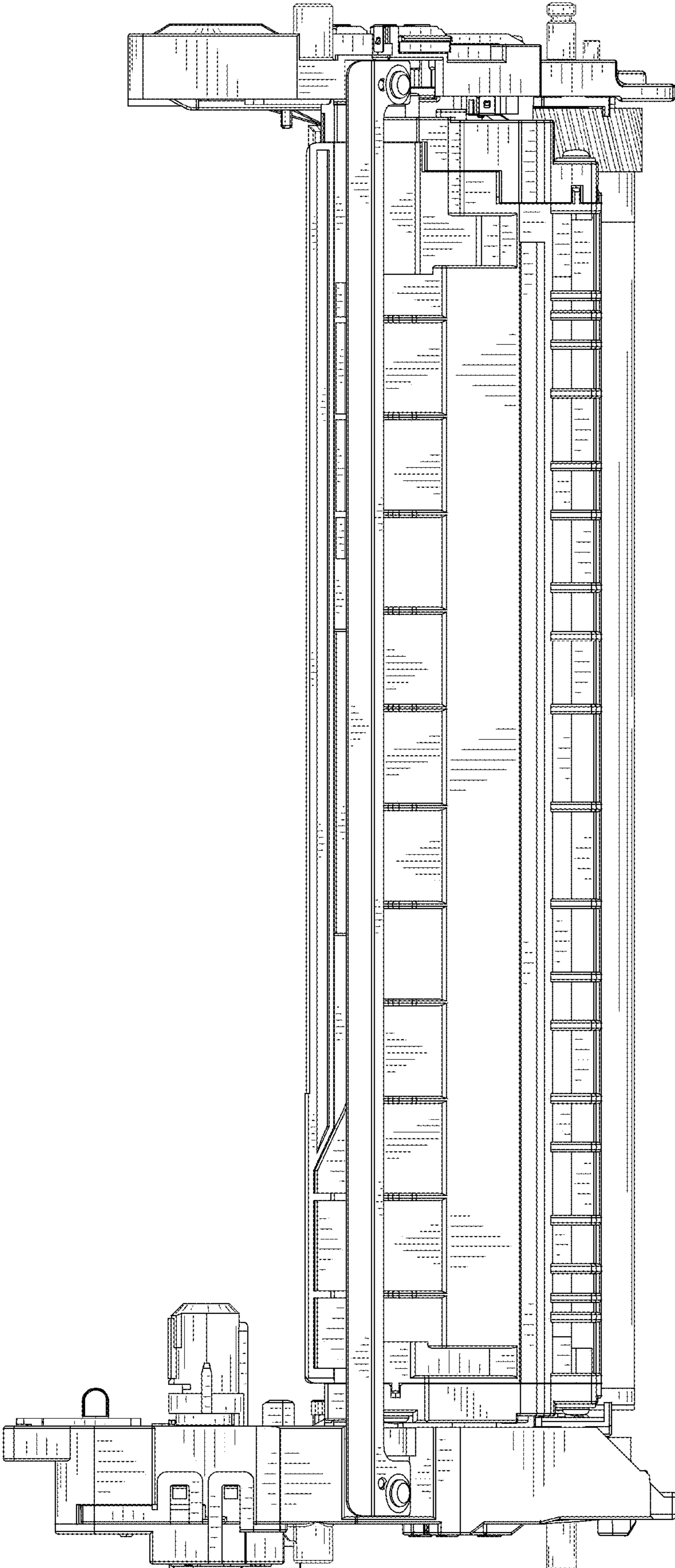

FIG. 1

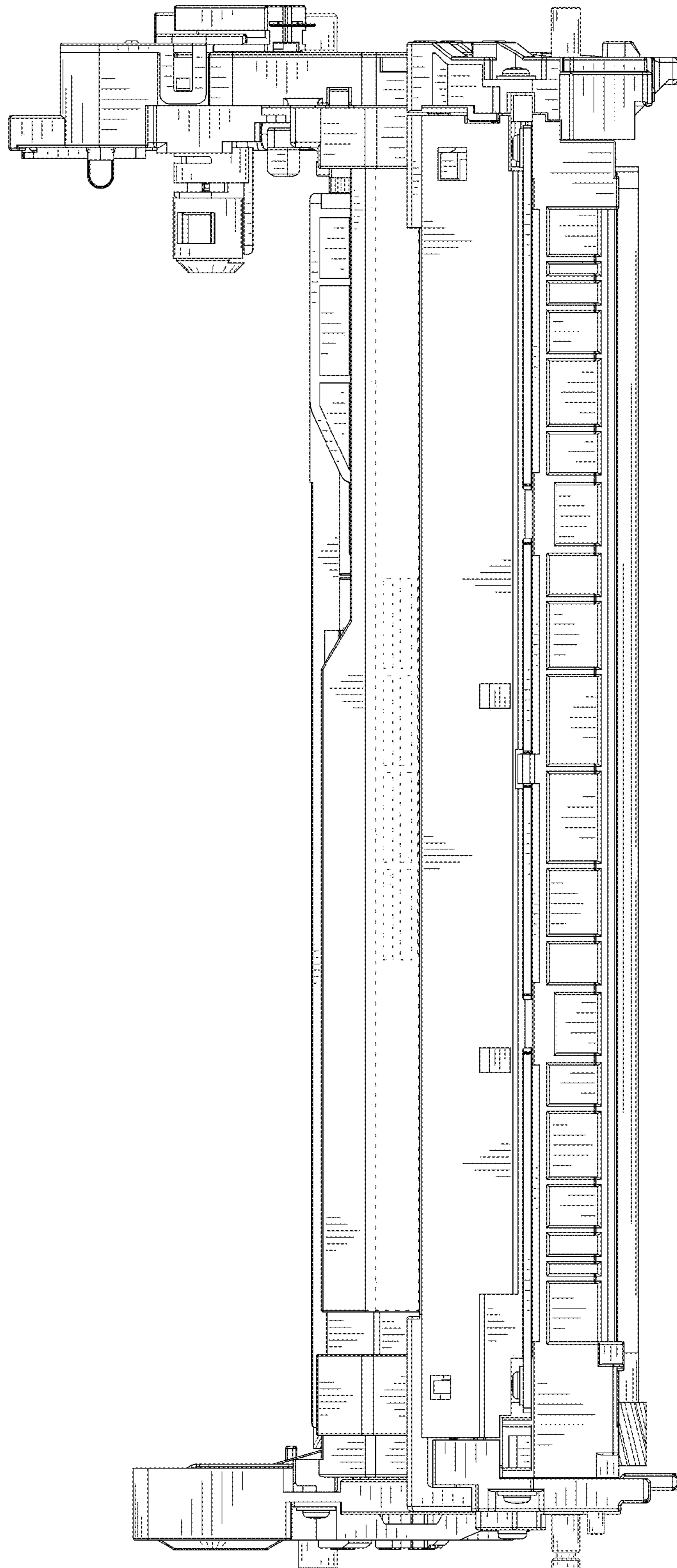

FIG. 2

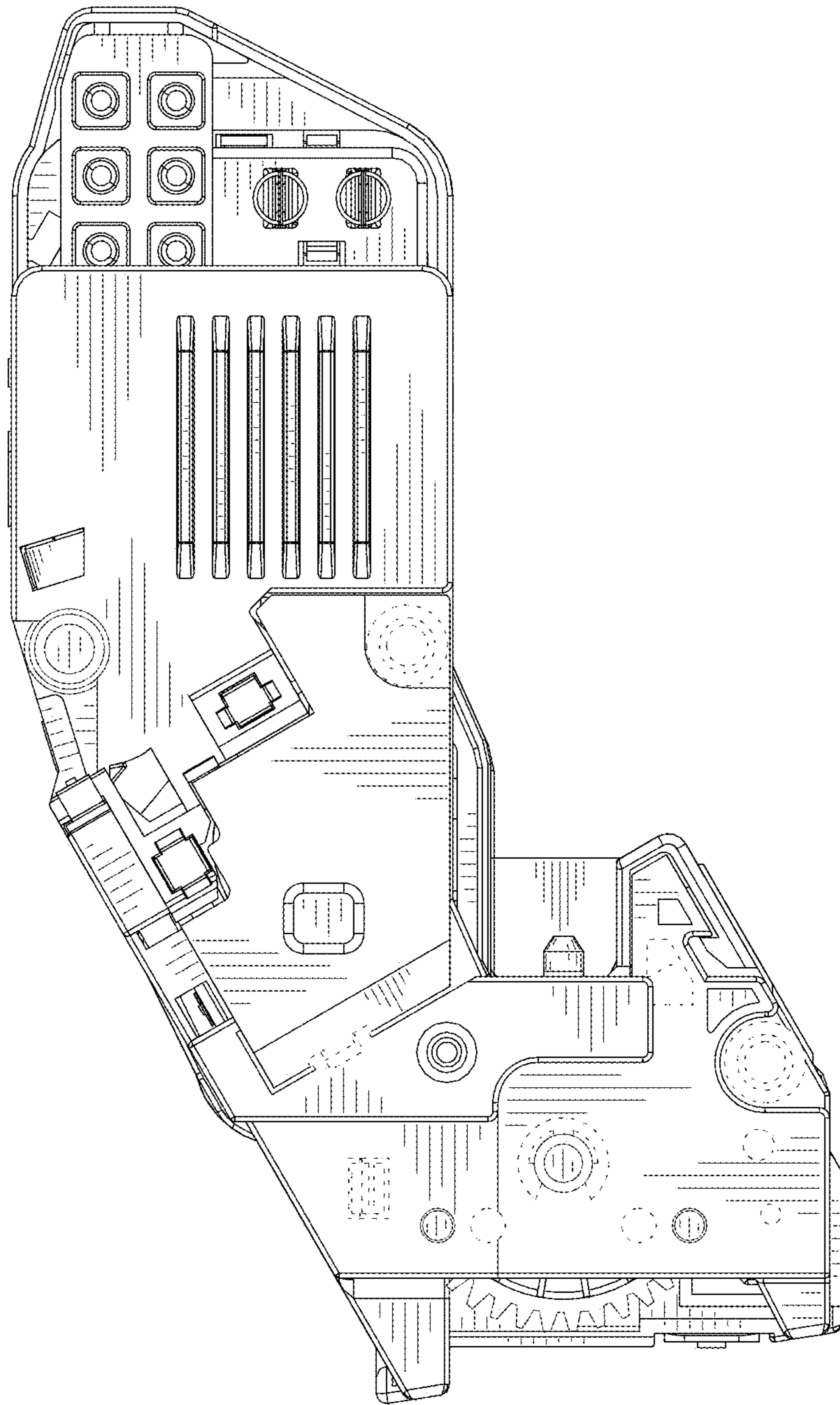

FIG. 3

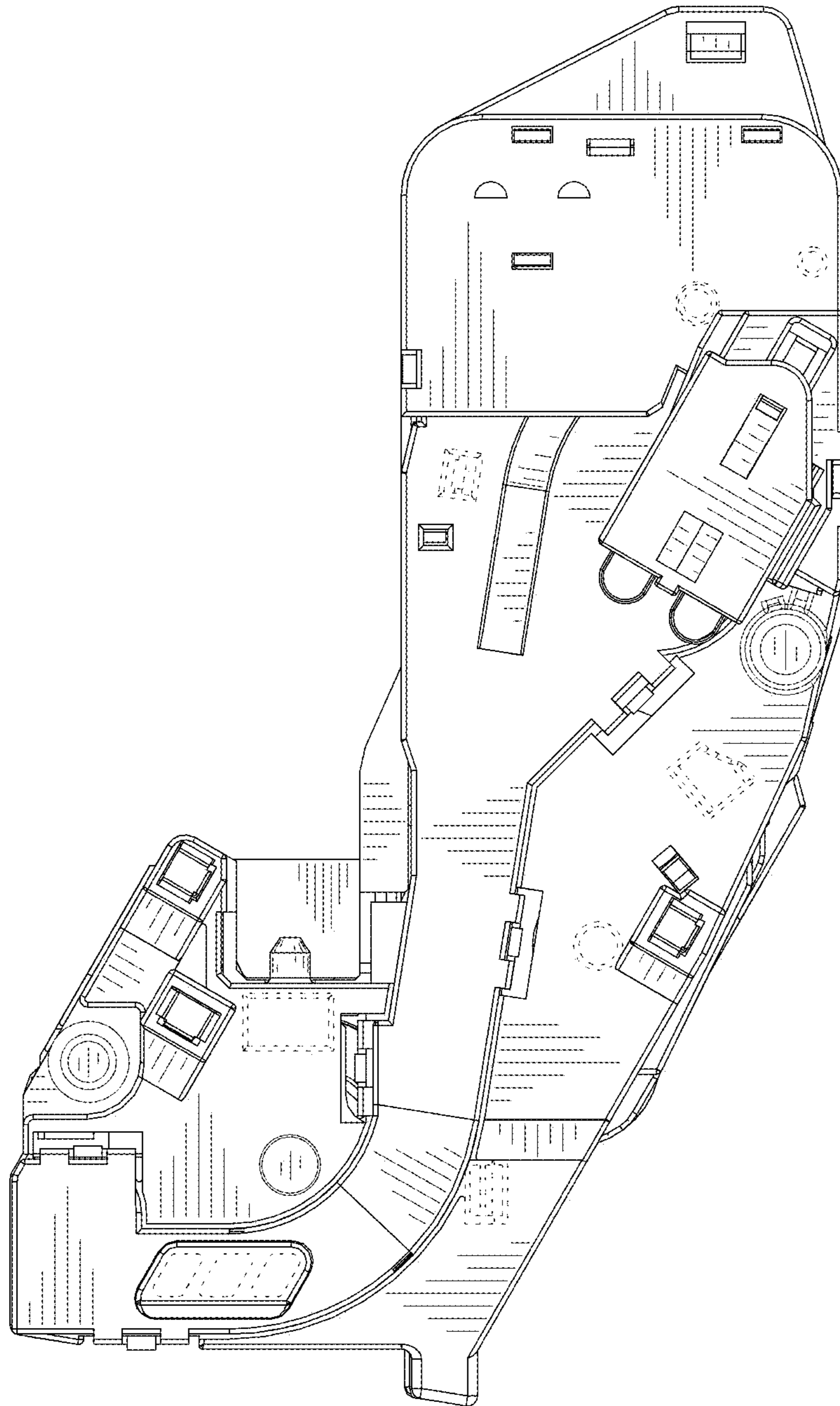

FIG. 4

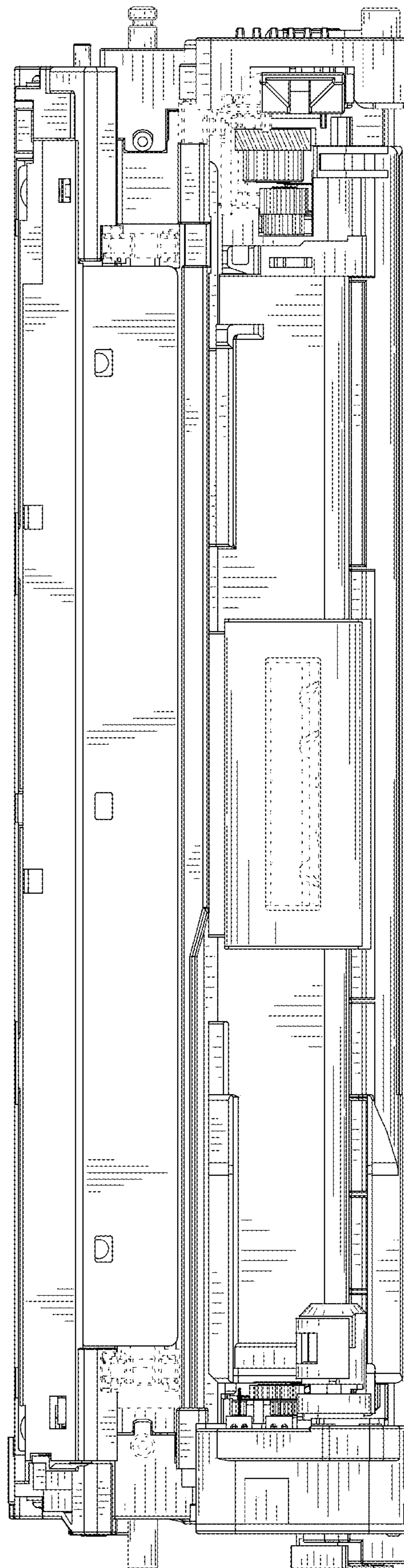

FIG. 5

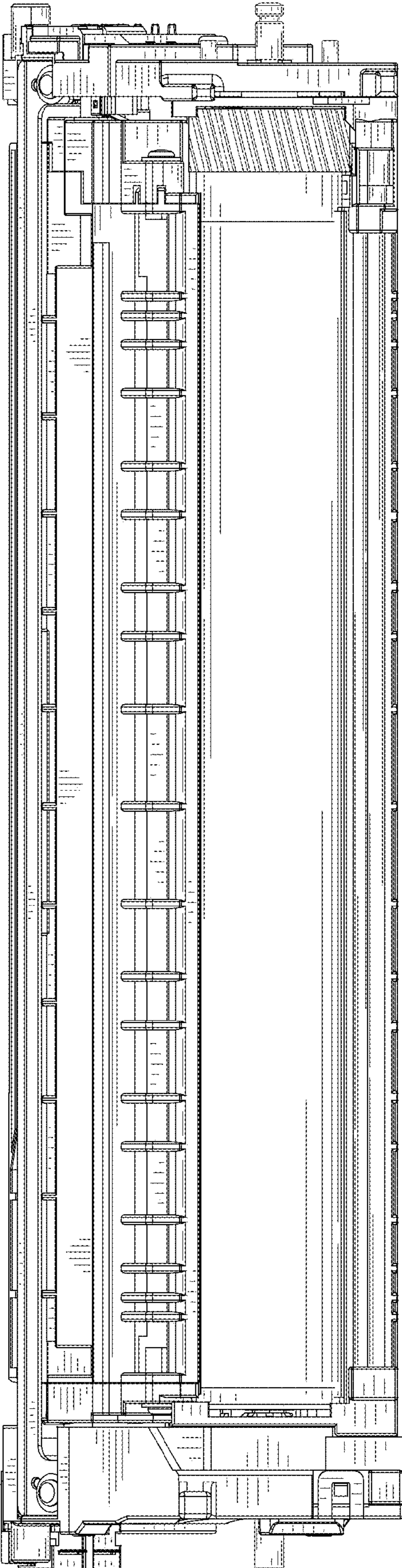

FIG. 6

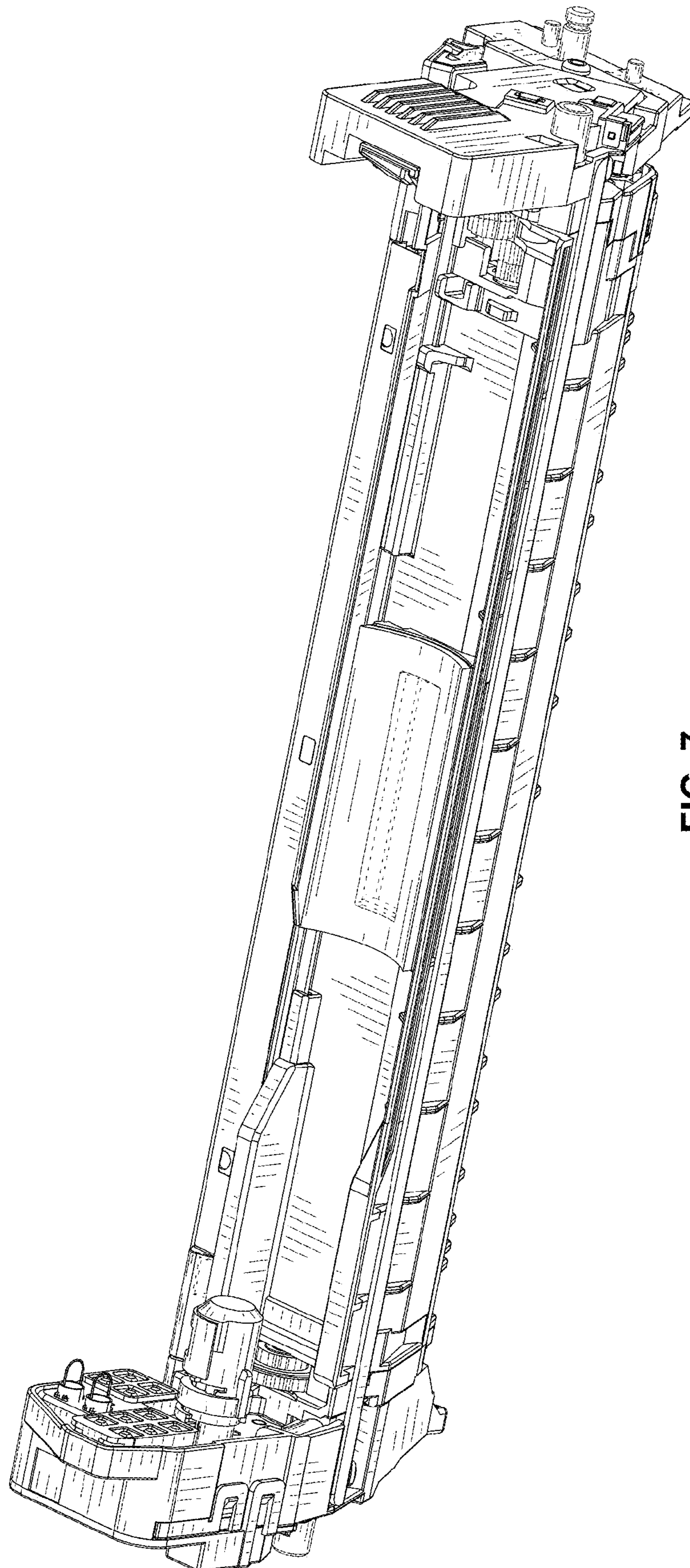

FIG. 7

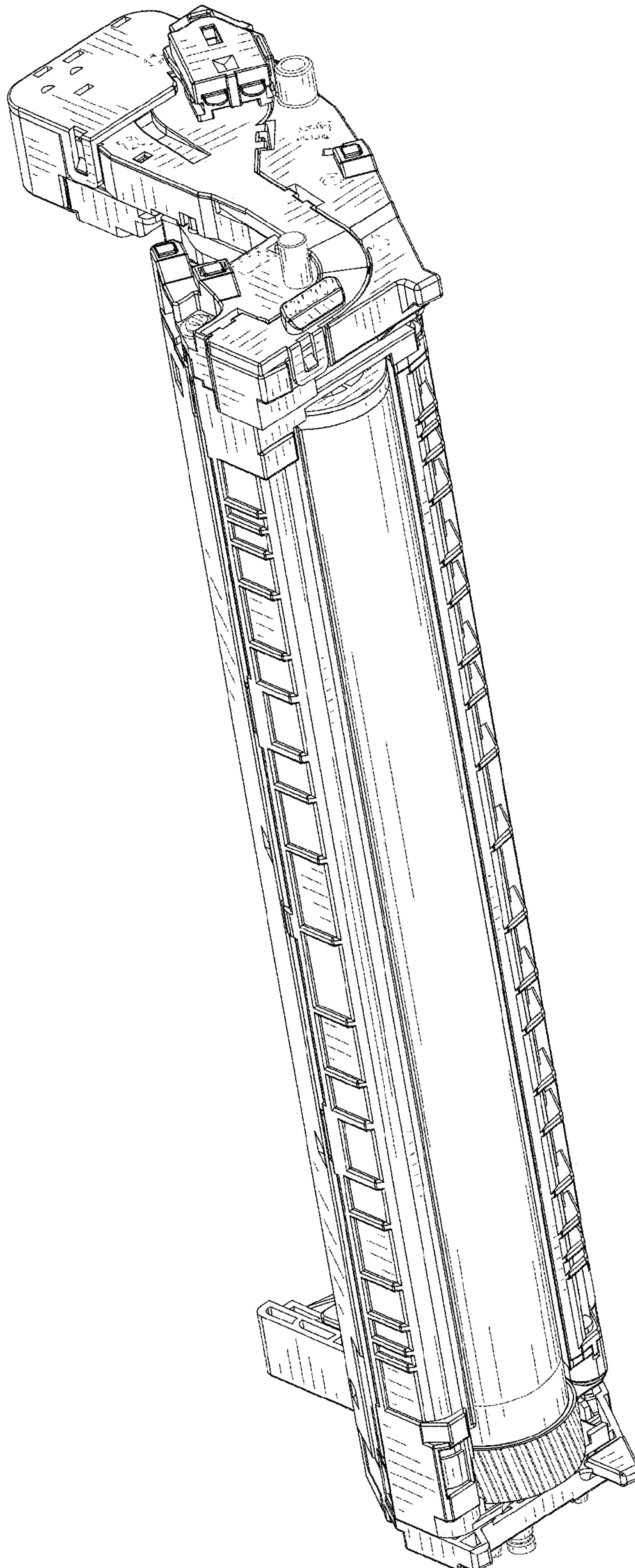

FIG. 8