



US00D873844S

(12) **United States Design Patent**
Martell

(10) **Patent No.:** **US D873,844 S**

(45) **Date of Patent:** **** Jan. 28, 2020**

(54) **DISPLAY SCREEN WITH TRANSITIONAL GRAPHICAL USER INTERFACE**

(71) Applicant: **Martell Broadcasting Systems, Inc.**,
Brooklyn, NY (US)

(72) Inventor: **Carey Ray Martell**, San Marcos, TX
(US)

(73) Assignee: **Martell Broadcasting Systems, Inc.**,
Brooklyn, NY (US)

(**) Term: **15 Years**

(21) Appl. No.: **29/644,108**

(22) Filed: **Apr. 13, 2018**

(51) **LOC (12) Cl.** **14-04**

(52) **U.S. Cl.**
USPC **D14/486; D14/488**

(58) **Field of Classification Search**
USPC D14/485-488
CPC H04H 60/72; H04N 5/44543
See application file for complete search history.

(56) **References Cited**

U.S. PATENT DOCUMENTS

6,628,303	B1 *	9/2003	Foreman	G06F 3/0483 375/E7.026
D593,576	S *	6/2009	Ball	D14/486
D593,578	S *	6/2009	Ball	D14/488
D660,860	S *	5/2012	Louch	D14/485
D735,227	S *	7/2015	Jeong	D14/486
D746,305	S *	12/2015	Gray	D14/485
D771,677	S *	11/2016	Binder	D14/486
D774,066	S *	12/2016	Kas	D14/486
D774,072	S *	12/2016	Haskins	D14/486
D785,028	S *	4/2017	Federighi	D14/486

D791,166	S *	7/2017	Sandhu	D14/487
D796,538	S *	9/2017	Yoshida	D14/486
D822,045	S *	7/2018	Kinoshita	D14/486
D822,049	S *	7/2018	Mok	D14/486
D831,047	S *	10/2018	Hontz, Jr.	D14/486
D835,646	S *	12/2018	Einspahr	D14/486
2014/0033039	A1 *	1/2014	Kandekar	H04N 7/17318 715/719
2014/0033040	A1 *	1/2014	Thomas	G06F 3/0488 715/721
2014/0068434	A1 *	3/2014	Filev	G06F 3/165 715/716

* cited by examiner

Primary Examiner — Darlington Ly

Assistant Examiner — Katherine A Holbrow

(74) *Attorney, Agent, or Firm* — Lynch LLP

(57) **CLAIM**

The ornamental design of a display screen with transitional graphical user interface, as shown and described.

DESCRIPTION

FIG. 1 is a front view of a first image of the display screen with transitional graphical user interface of the new design; and,

FIG. 2 is a front view of a second image thereof.

The outermost broken line rectangle shows the display screen and forms no part of the claimed design. All other broken lines show portions of the graphical user interface and form no part of the claimed design.

The graphical user interface transitions sequentially between the two images shown in FIGS. 1 and 2, respectively. The process or period in which one image transitions to another forms no part of the claimed design.

1 Claim, 2 Drawing Sheets

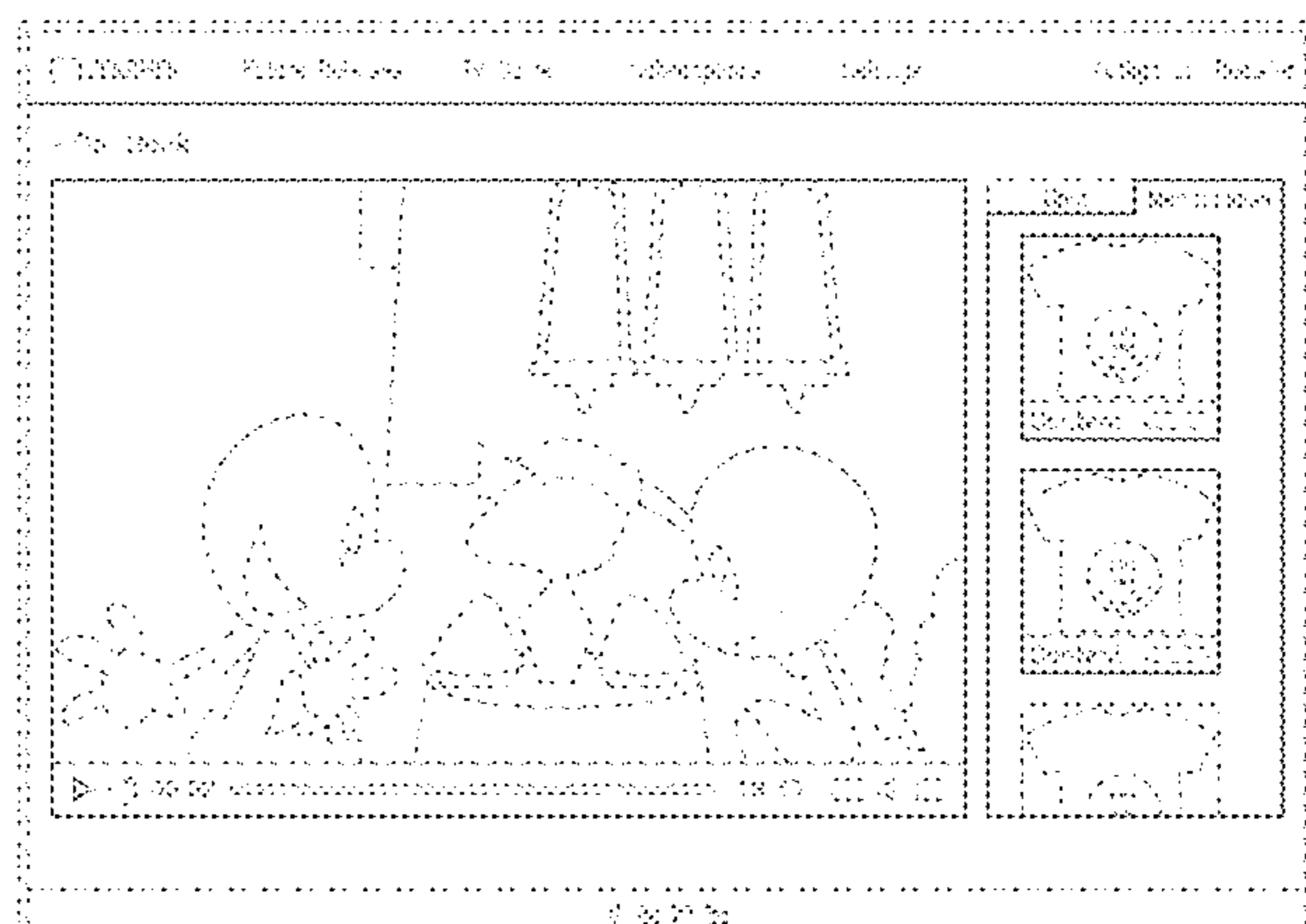
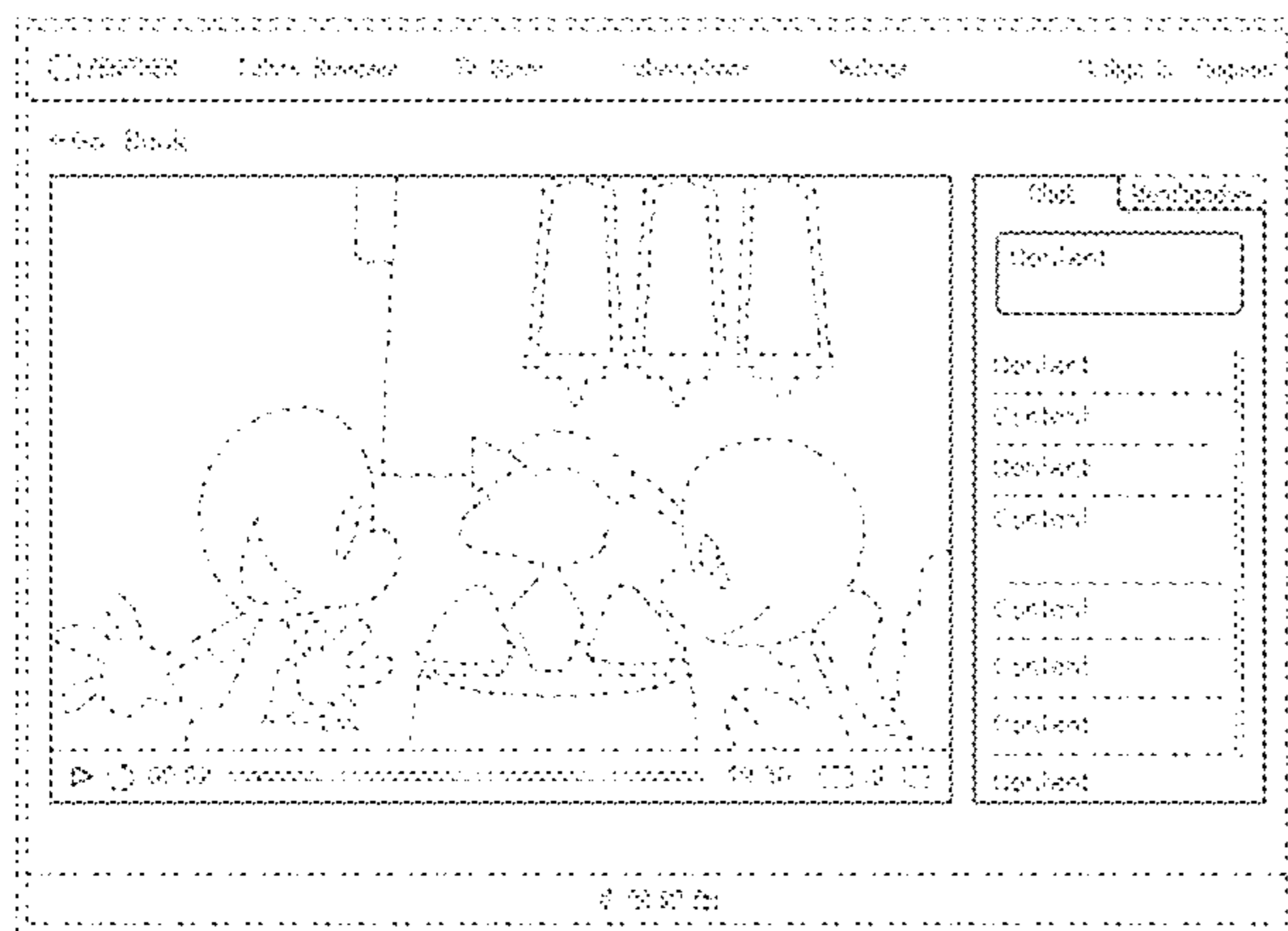

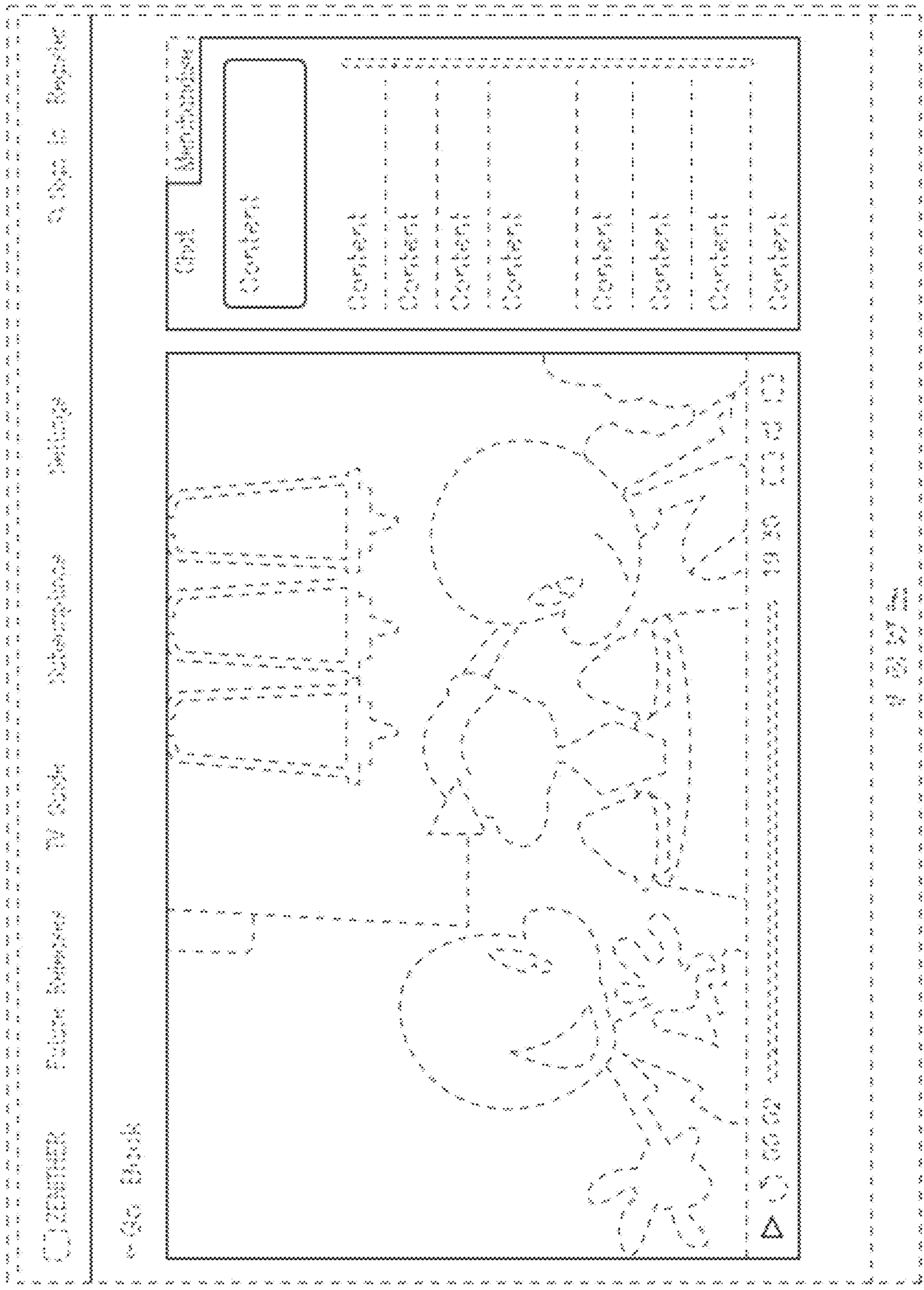

FIG. 1

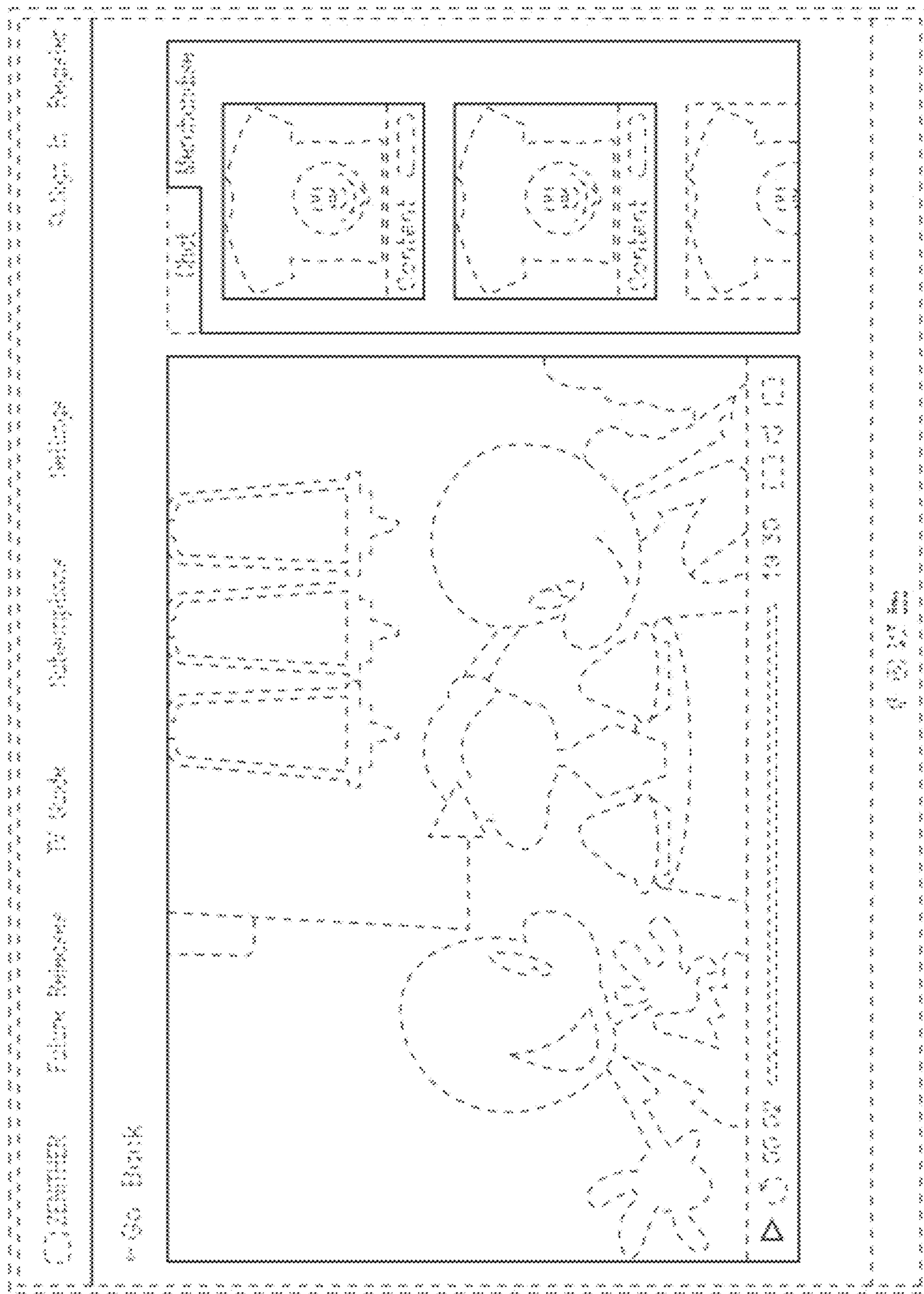

FIG. 2