



US00D873105S

(12) **United States Design Patent** (10) **Patent No.:** **US D873,105 S**
Concari (45) **Date of Patent:** **** Jan. 21, 2020**

(54) **CORDLESS NAILER** 6,913,180 B2 * 7/2005 Schuster B25C 1/005
 227/109
 (71) Applicant: **BLACK & DECKER INC.**, New Britain, CT (US) D512,620 S * 12/2005 Thomas D8/69
 D514,911 S * 2/2006 Thomas D8/69
 D532,668 S * 11/2006 Wen D8/69
 (72) Inventor: **Gabriel E. Concari**, Eldersburg, MD D660,122 S * 5/2012 Hotta D8/69
 (US) D699,535 S * 2/2014 Albrecht D8/68
 D713,704 S * 9/2014 Wang D8/68
 D724,404 S * 3/2015 Fischer-Zernin D8/68
 D787,290 S * 5/2017 Meyer D8/68
 (73) Assignee: **Black & Decker, Inc.**, New Britain, CT 2005/0001007 A1 * 1/2005 Butzen B25C 1/005
 (US) 227/130
 (**) Term: **15 Years** 2012/0292472 A1 * 11/2012 Segura B25F 5/02
 248/225.21

(21) Appl. No.: **29/603,047**
 (22) Filed: **May 5, 2017**

* cited by examiner
Primary Examiner — Darlington Ly
 (74) *Attorney, Agent, or Firm* — Rhonda L. Barton

Related U.S. Application Data

(63) Continuation-in-part of application No. 29/620,368, filed on Nov. 7, 2016, now Pat. No. Des. 817,734.
 (51) **LOC (12) Cl.** **08-05**
 (52) **U.S. Cl.**
 USPC **D8/68**
 (58) **Field of Classification Search**
 USPC D8/61-70
 CPC .. B25C 1/001; B25C 1/04; B25C 1/06; B25C 1/041; B25C 1/047
 See application file for complete search history.

References Cited

U.S. PATENT DOCUMENTS
 D353,664 S * 12/1994 Eminger D8/69
 D483,240 S * 12/2003 Garvis D8/68
 D484,383 S * 12/2003 Yang D8/68
 D484,765 S * 1/2004 Yang D8/68
 D500,655 S * 1/2005 Leasure D8/69

(57) **CLAIM**
 The ornamental design for a cordless nailer, as shown and described.

DESCRIPTION

FIG. 1 is a top and right-side perspective view of a first embodiment of a cordless nailer showing our new design; FIG. 2 is a top and left-side perspective view of the design of FIG. 1; FIG. 3 is a right-side elevation view thereof; FIG. 4 is a left-side elevation view thereof; FIG. 5 is a front elevation view thereof; FIG. 6 is a rear elevation view thereof; FIG. 7 is a top plan view thereof; and, FIG. 8 is a bottom plan view thereof. The broken lines in the drawings illustrate portions of the cordless nailer that form no part of the claimed design.

1 Claim, 8 Drawing Sheets

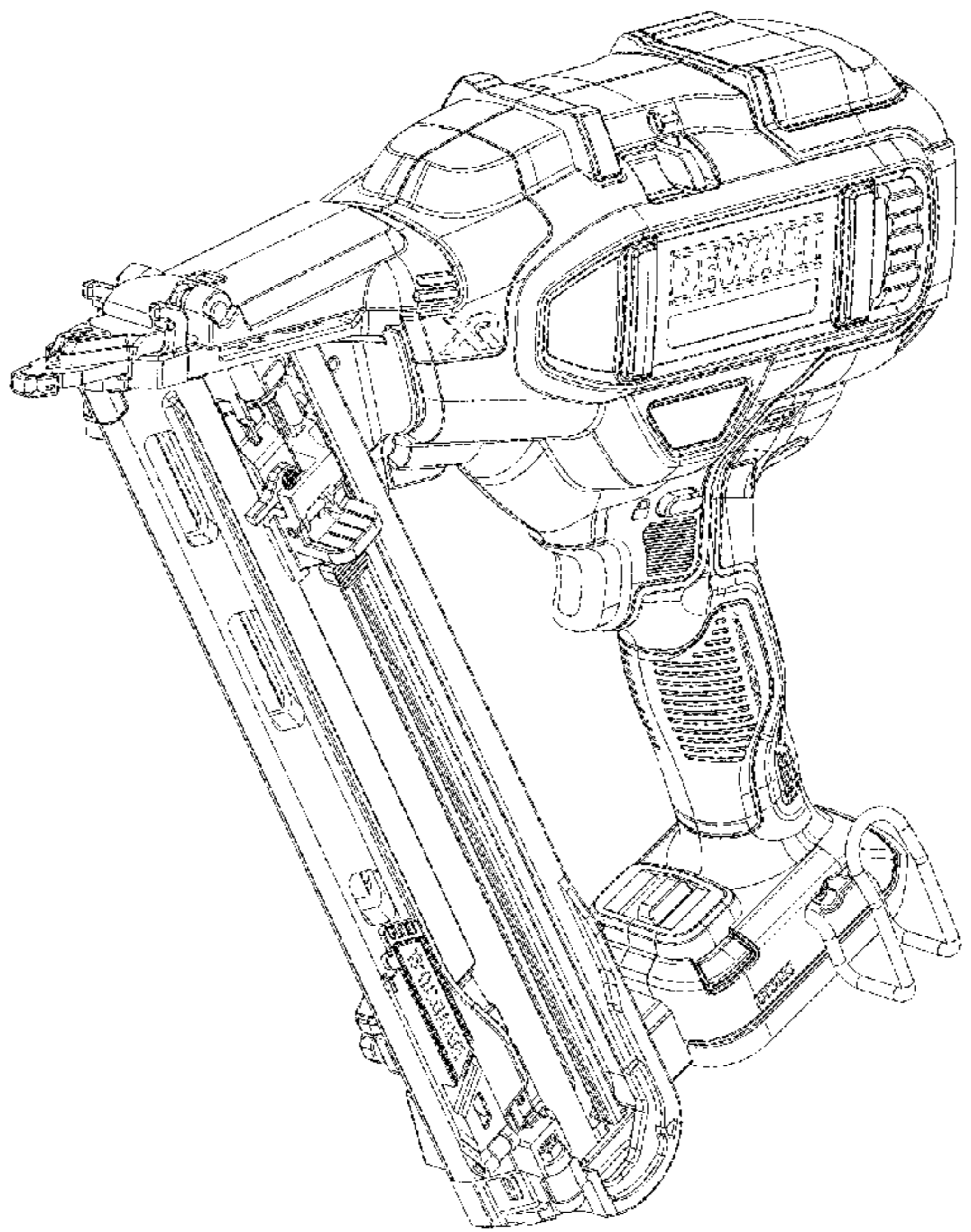

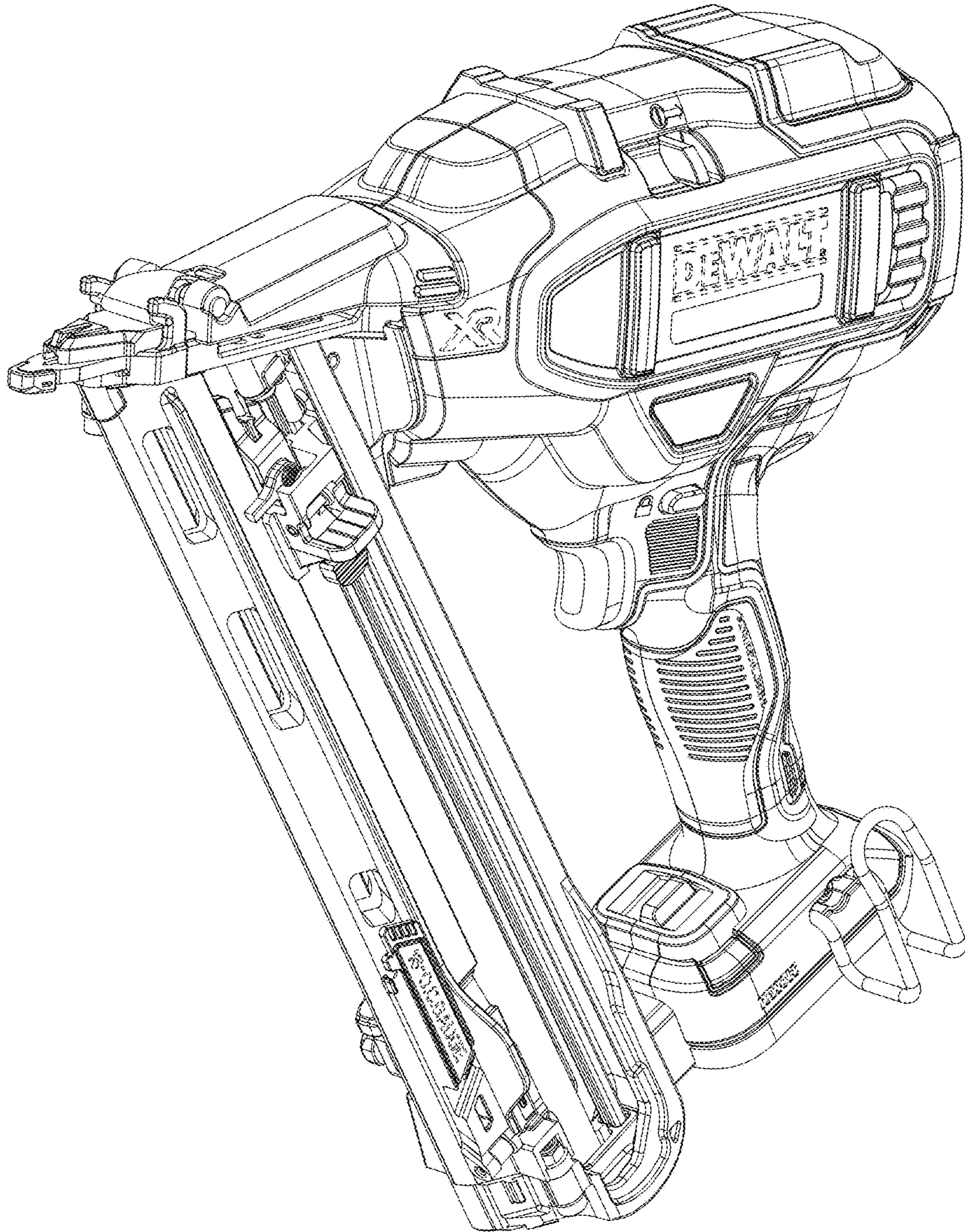

FIG. 1

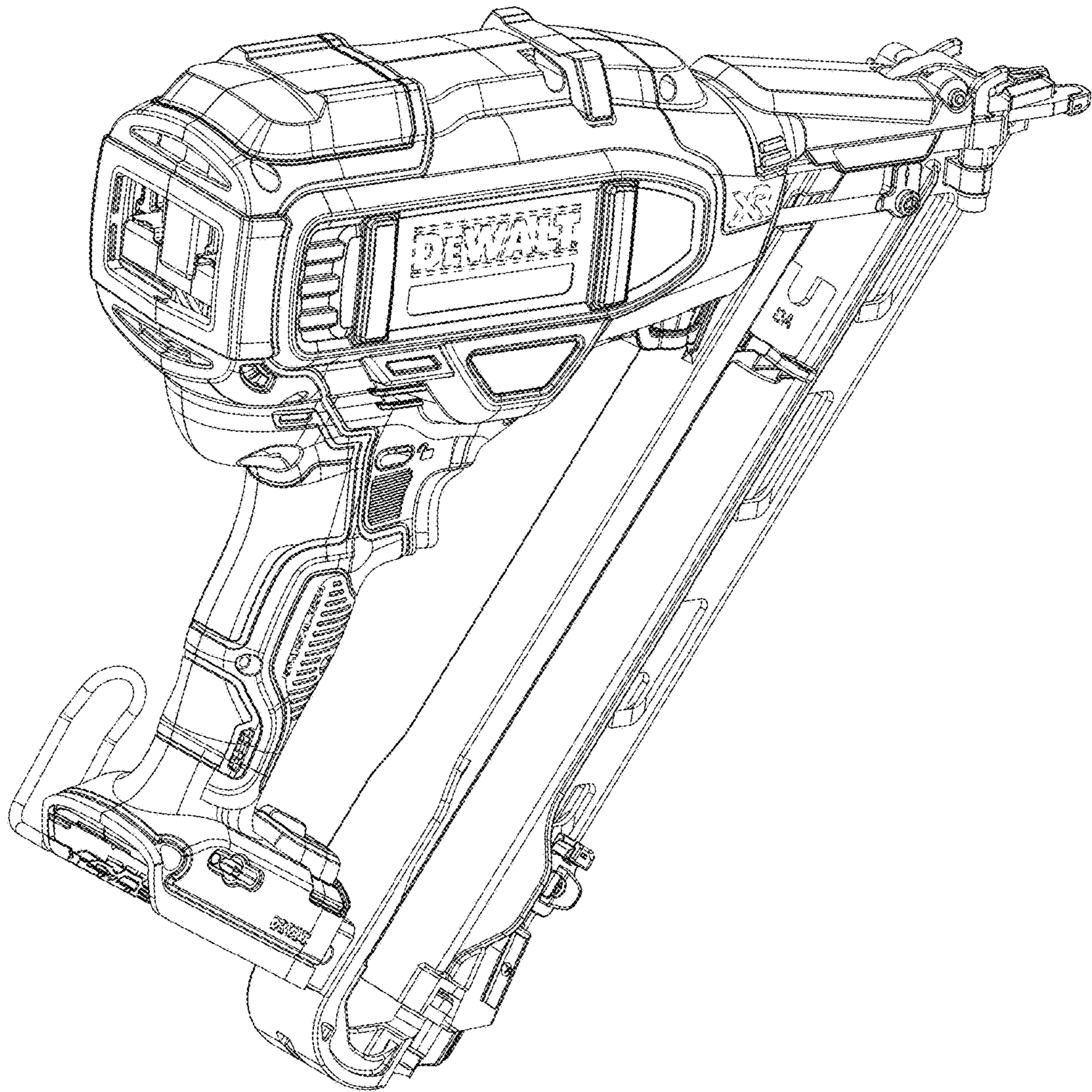

FIG. 2

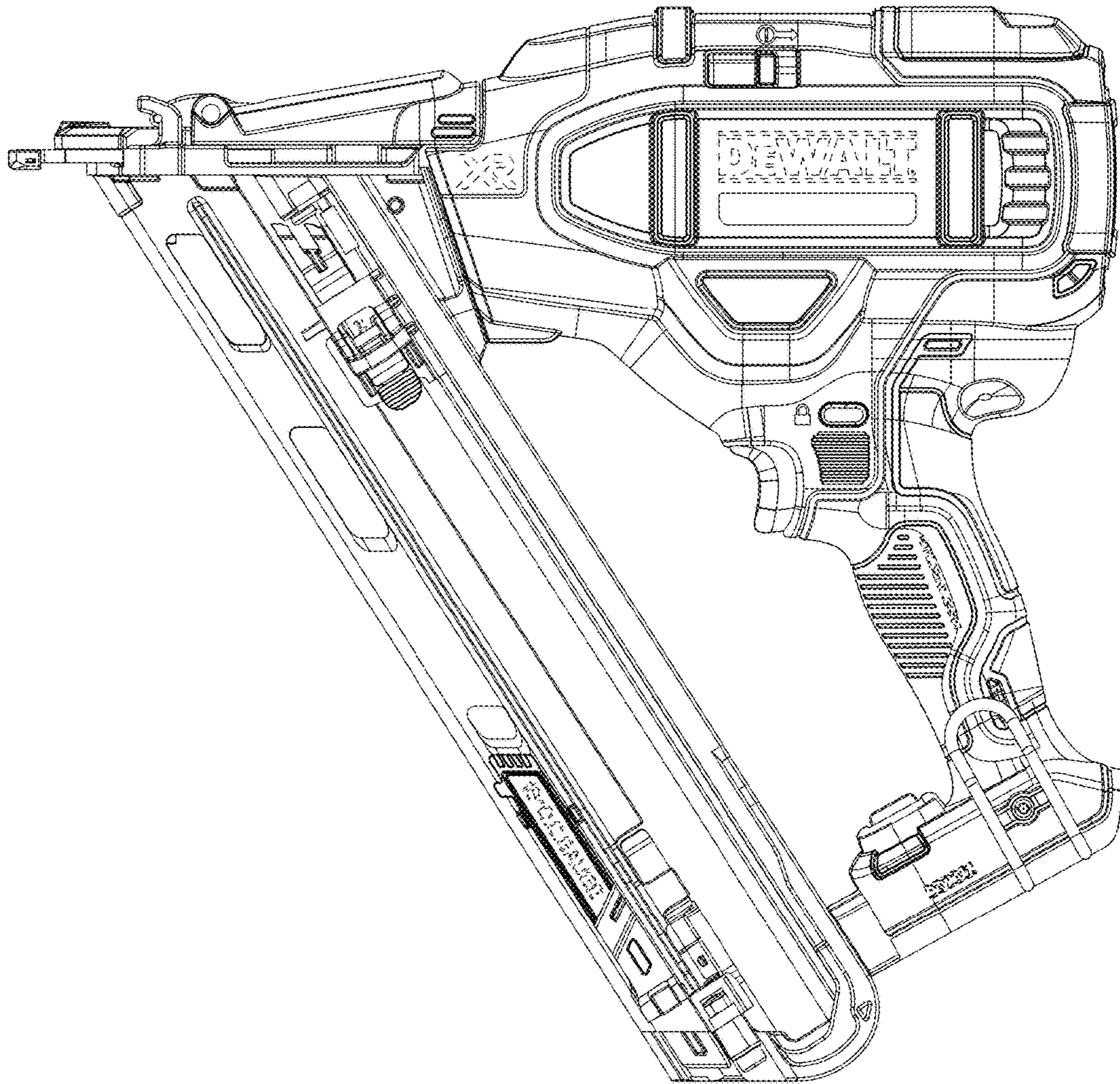

FIG. 3

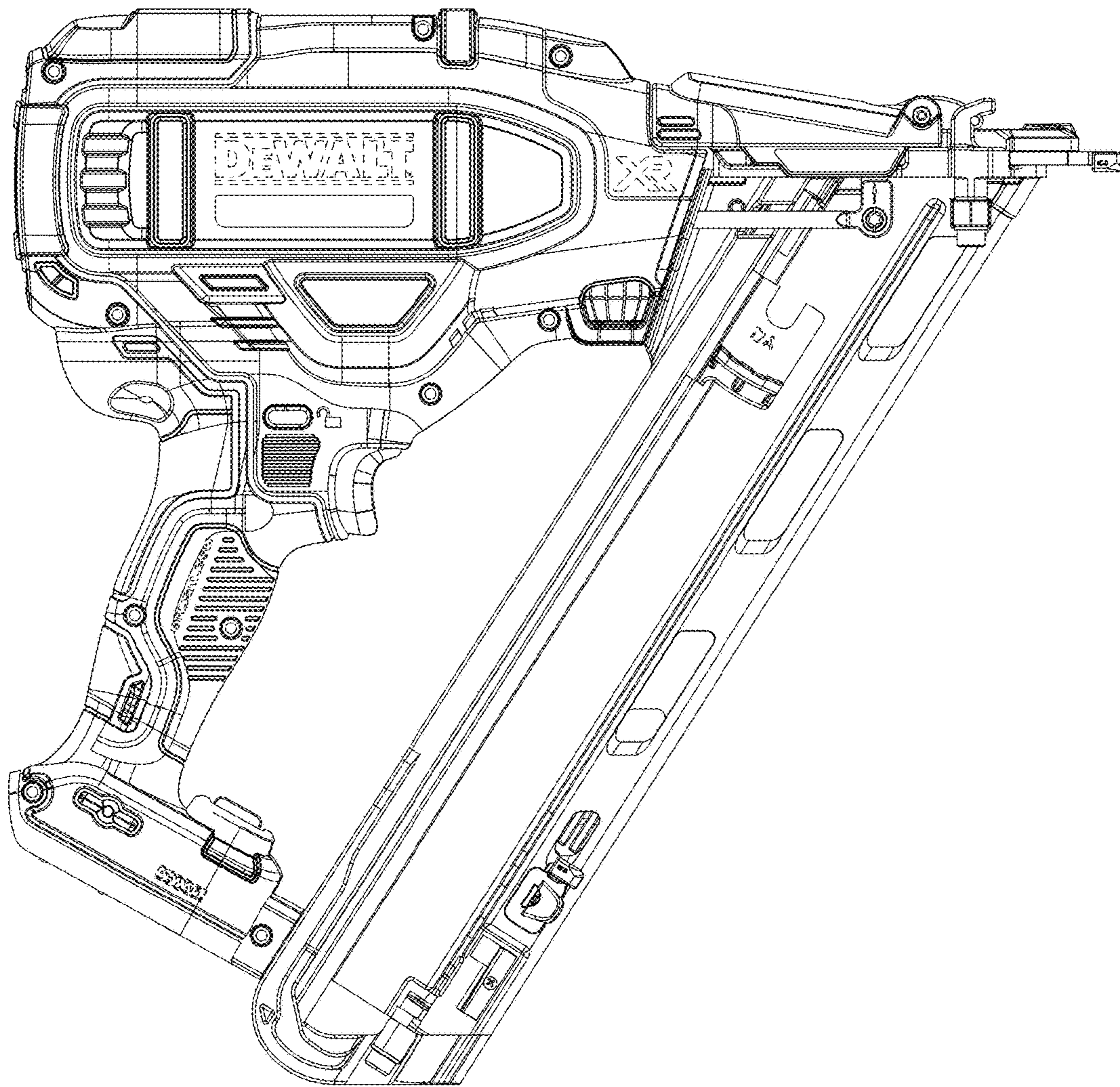

FIG. 4

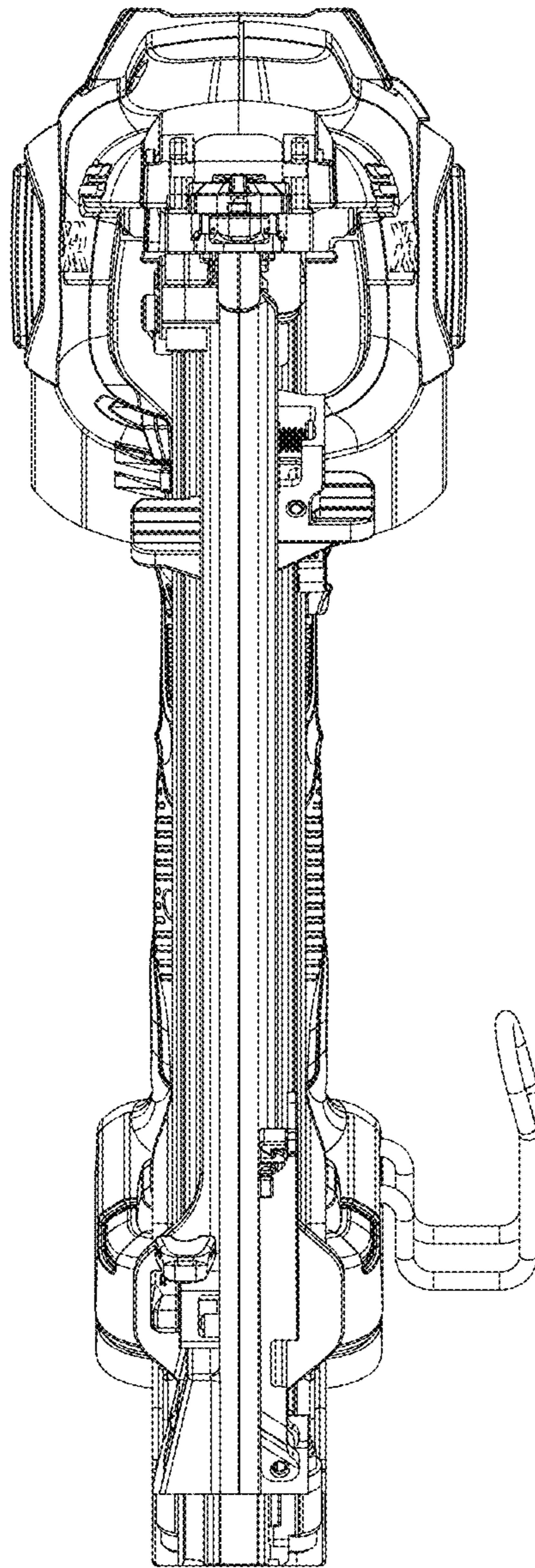

FIG. 5

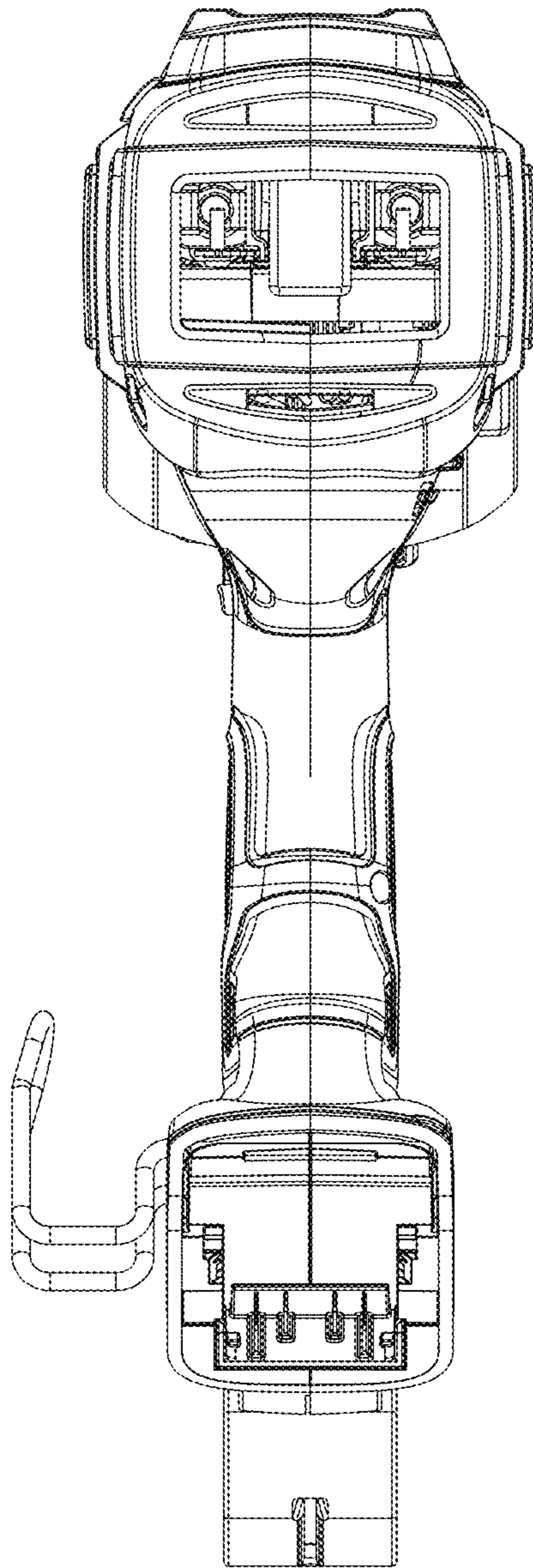

FIG. 6

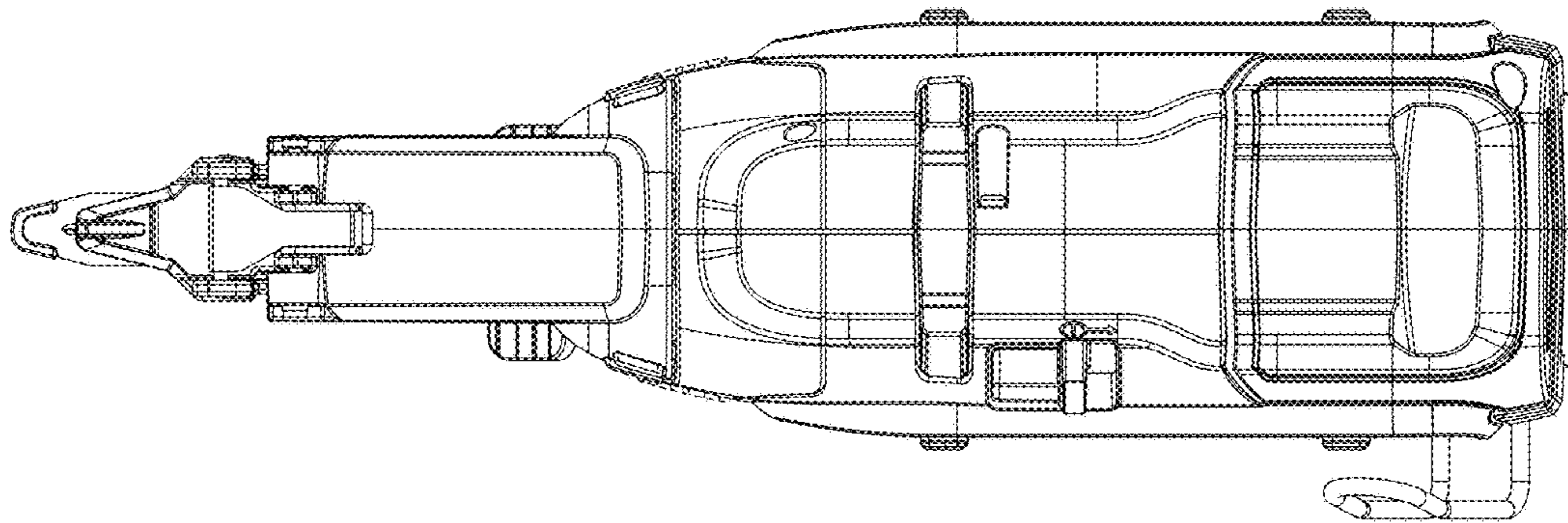

FIG. 7

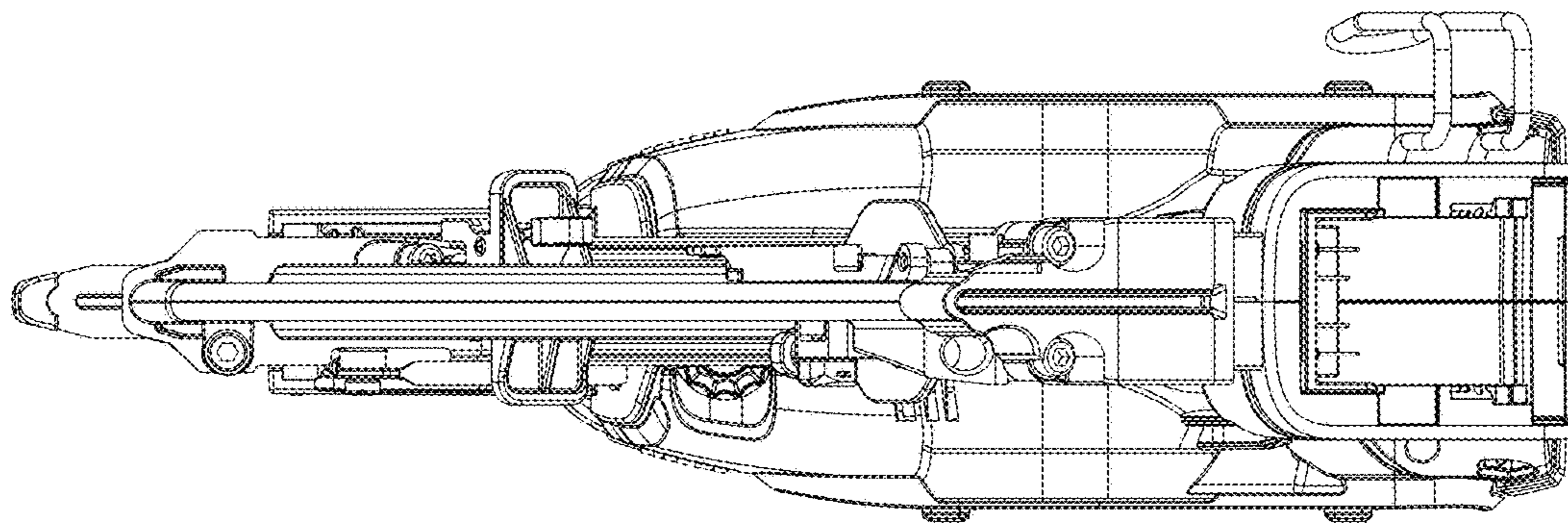

FIG. 8