



US00D873049S

(12) **United States Design Patent**
Sullins

(10) **Patent No.:** **US D873,049 S**

(45) **Date of Patent:** **** Jan. 21, 2020**

(54) **BED TRAY ELECTRONICS PROP**

(71) Applicant: **Patrick Hogan Sullins**, Arlington, TX
(US)

(72) Inventor: **Patrick Hogan Sullins**, Arlington, TX
(US)

(73) Assignee: **Creative Manufacturing, LLC**,
Arlington, TX (US)

(**) Term: **15 Years**

(21) Appl. No.: **29/625,420**

(22) Filed: **Nov. 9, 2017**

(51) **LOC (12) Cl.** **06-03**

(52) **U.S. Cl.**
USPC **D6/406.3**

(58) **Field of Classification Search**
USPC D6/512, 685–686, 691, 704, 707.19,
D6/406.1, 406.2, 406.3, 406.4, 406.5,
D6/406.6; D7/545, 550.1, 552.2, 554.3
CPC A47G 23/06; A47G 23/08; A47G 23/0608;
A47B 19/08; A47B 23/00; A47B 23/001;
Y10S 248/918; F16M 2200/08
See application file for complete search history.

(56) **References Cited**

U.S. PATENT DOCUMENTS

4,117,969	A	*	10/1978	Fukuba	H01M 2/206 228/140
D266,425	S	*	10/1982	Reaume	D14/447
6,020,086	A	*	2/2000	Van Lerberghe	...	H01M 2/0207 429/163
D438,543	S	*	3/2001	Goto	D14/447
D441,759	S	*	5/2001	Goto	D14/447
D465,785	S	*	11/2002	Goto	D14/447
D472,403	S	*	4/2003	Bogish	D6/675

D574,088	S	*	7/2008	Kercher, III	D25/164
D641,024	S	*	7/2011	Zenri	D14/447
D649,137	S	*	11/2011	DeVesto	D13/108
D661,308	S	*	6/2012	Capozzoli, II	D14/447
D665,513	S	*	8/2012	Engel	D25/113
D701,213	S	*	3/2014	Pajic	D14/447
D722,061	S	*	2/2015	Byrne	D14/447
D728,582	S	*	5/2015	Kim	D14/451
D774,650	S	*	12/2016	Williams	D24/185
D797,109	S	*	9/2017	Pisapia	D14/447
D799,851	S	*	10/2017	Waxman	D6/406.6
D845,278	S	*	4/2019	Christie	D14/217

* cited by examiner

Primary Examiner — Kelley A Donnelly

(74) *Attorney, Agent, or Firm* — Guy V. Manning

(57) **CLAIM**

The ornamental design for a bed tray electronics prop, as shown and described.

DESCRIPTION

FIG. 1 is a left, elevated, quartering perspective view of the new design for a bed tray electronics prop of the present invention, shown in context.

FIG. 2 is a top plan view of the bed tray electronics prop shown in FIG. 1;

FIG. 3 is a left side elevation view taken in section as shown in FIG. 2 of the bed tray electronics prop shown in FIG. 1, the right side elevational view being the mirror image thereof;

FIG. 4 is a rear elevational view taken as shown in FIG. 2 of the bed tray electronics prop shown in FIG. 1;

FIG. 5 is a front elevational view taken as shown in FIG. 2 of the bed tray electronics prop shown in FIG. 1; and,

FIG. 6 is a bottom plan view taken in section as shown in FIG. 5 of the bed tray electronics prop shown in FIG. 1.

1 Claim, 4 Drawing Sheets

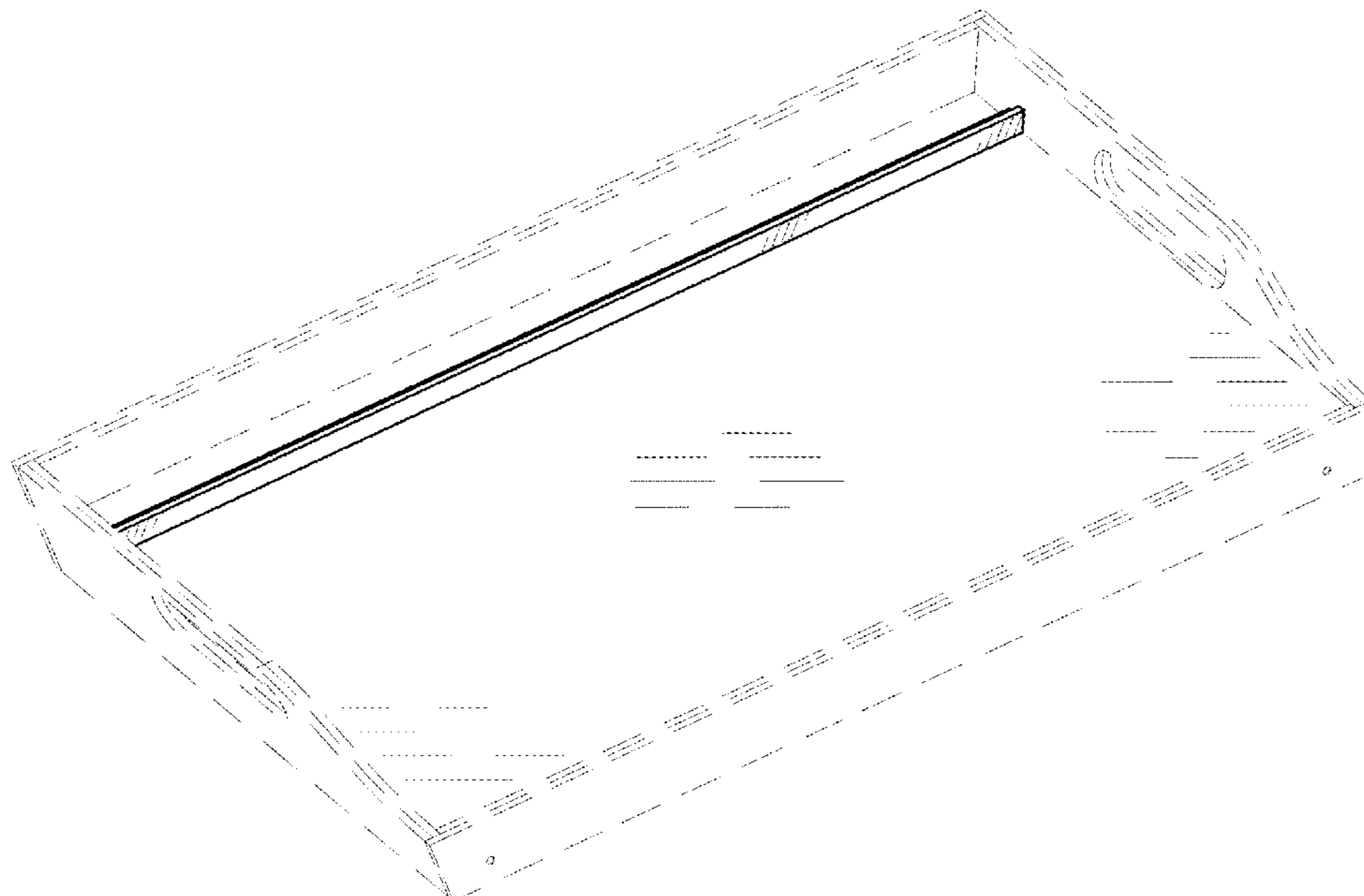

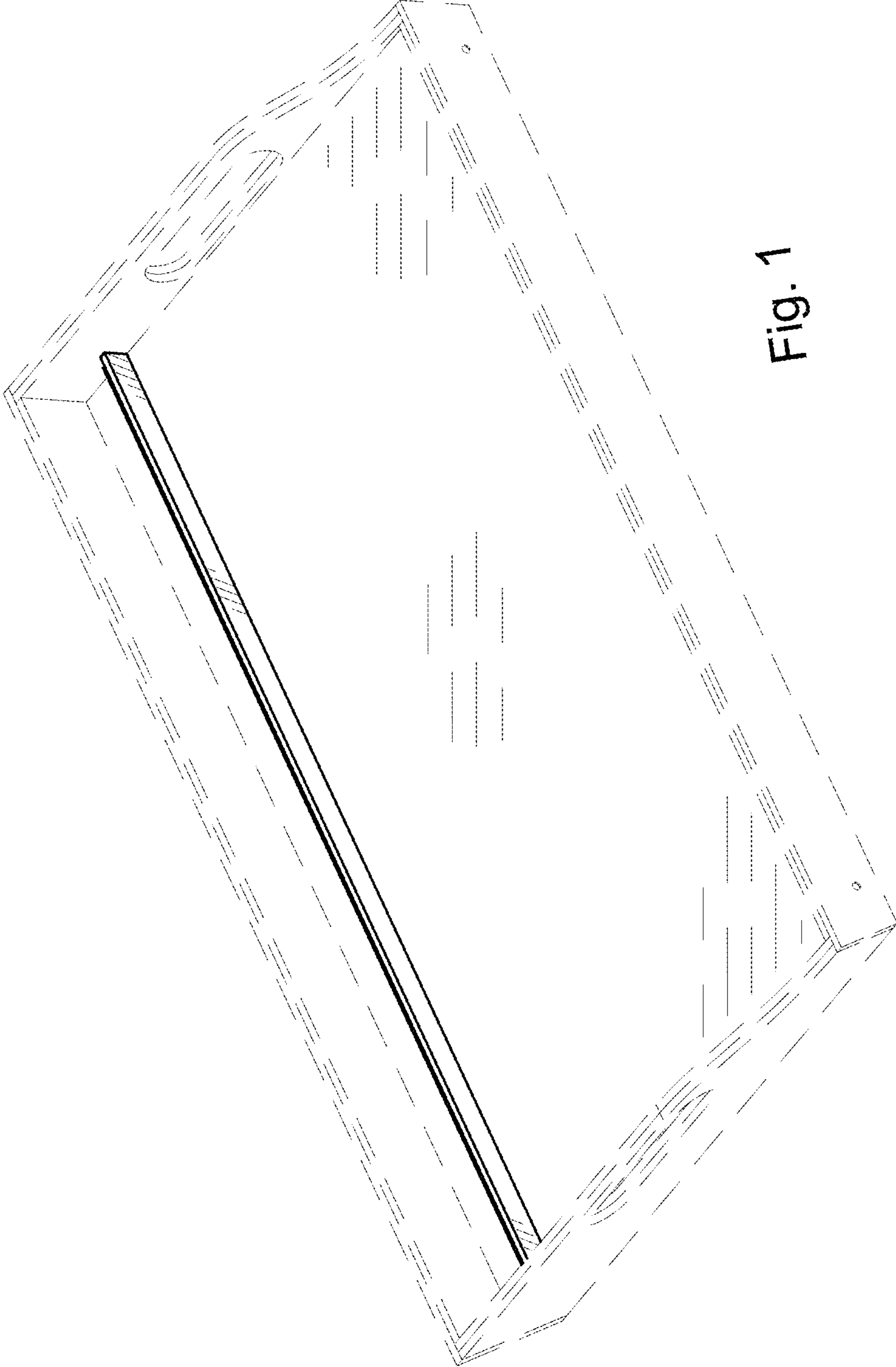

Fig. 1

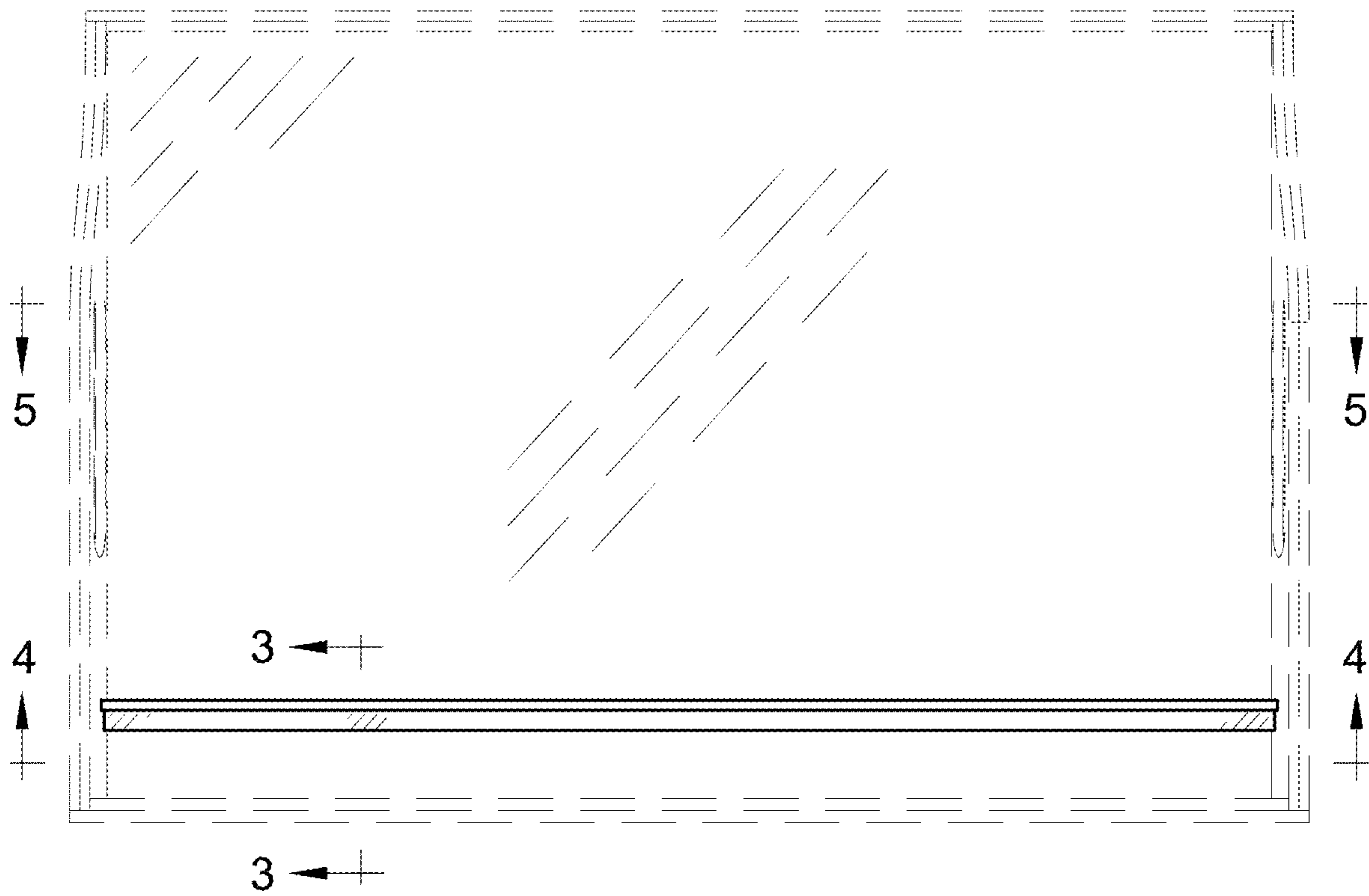
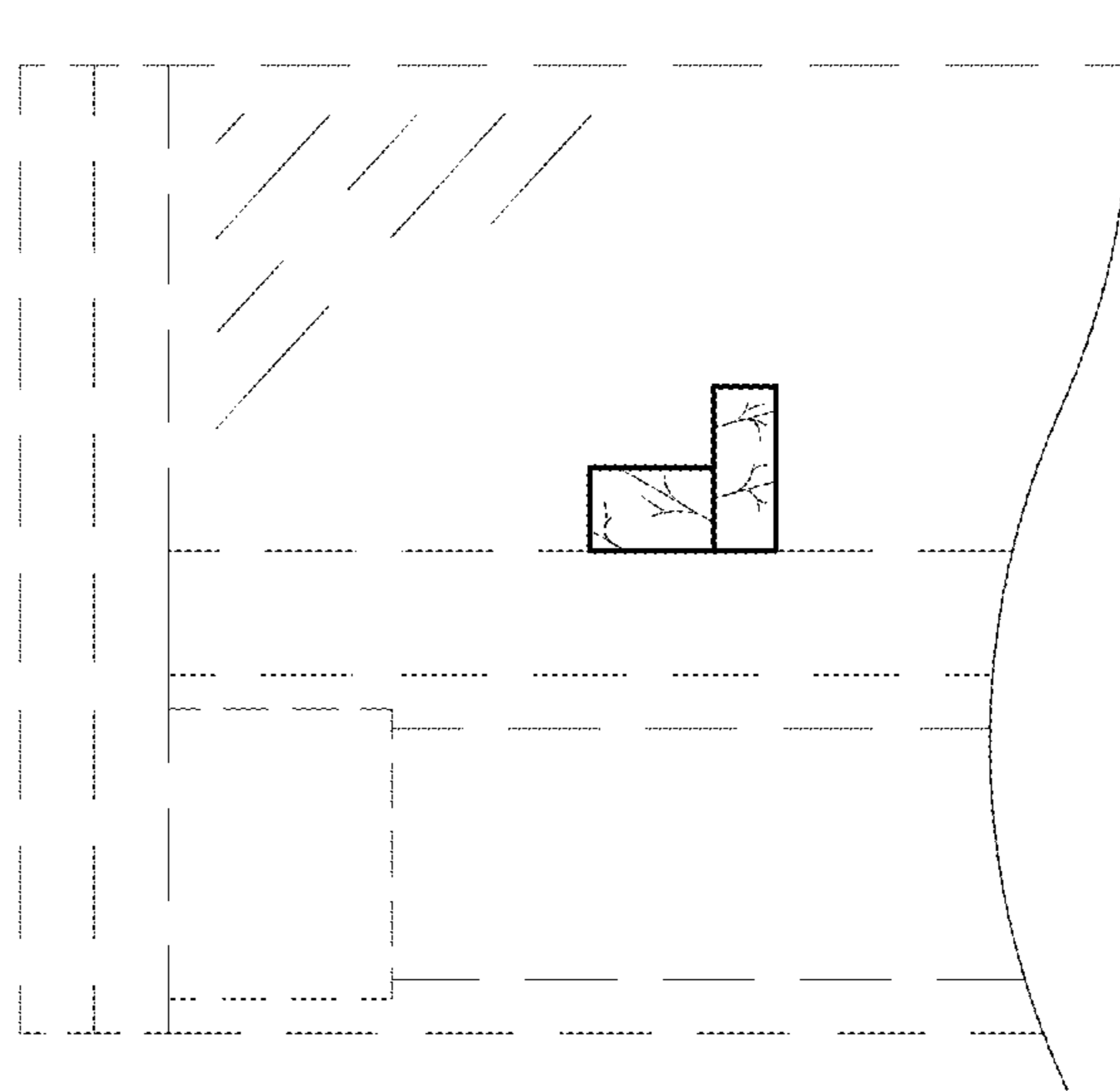

Fig. 2

Fig. 3



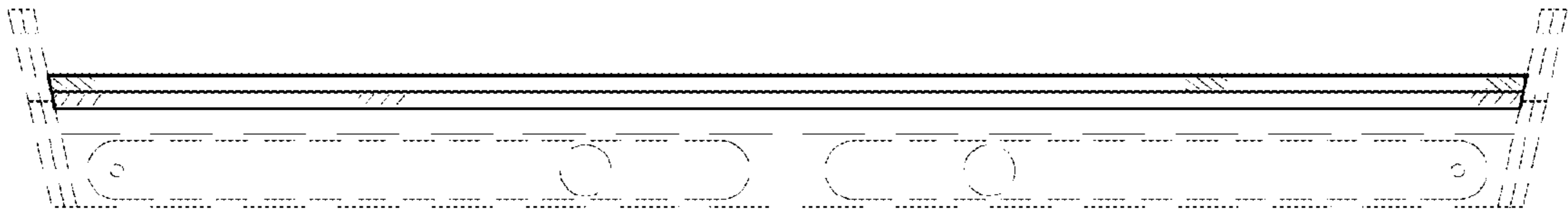

Fig. 4

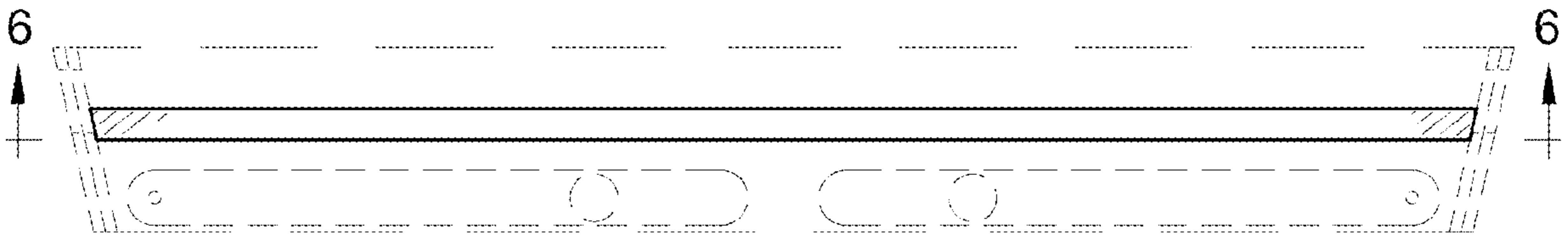

Fig. 5

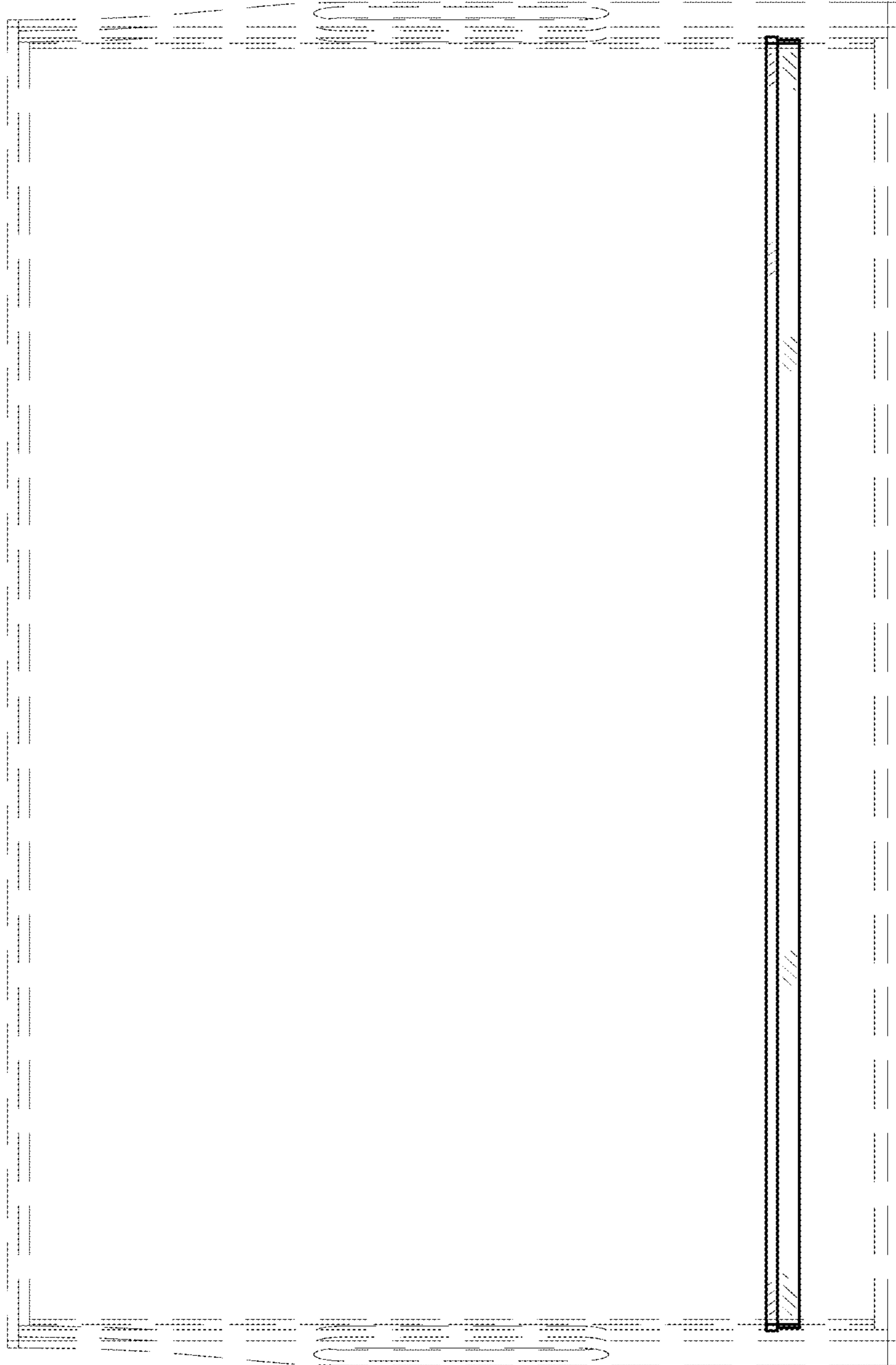

Fig. 6