



US00D872716S

(12) **United States Design Patent**
Wang et al.

(10) **Patent No.:** **US D872,716 S**
(45) **Date of Patent:** **** Jan. 14, 2020**

- (54) **ANTENNA**
- (71) Applicant: **Airgain Incorporated**, San Diego, CA (US)
- (72) Inventors: **Qilong Wang**, Zhang Jia Gang (CN); **Geoff Schulteis**, San Diego, CA (US); **Ziming He**, Irvine, CA (US)
- (73) Assignee: **Airgain Incorporated**, San Diego, CA (US)
- (**) Term: **15 Years**
- (21) Appl. No.: **29/701,019**
- (22) Filed: **Aug. 7, 2019**

D792,870 S *	7/2017	Zheng	D14/230
D795,846 S *	8/2017	Chang	D14/230
D799,457 S *	10/2017	Chang	D14/230
D799,458 S *	10/2017	Chang	D14/230
D815,072 S *	4/2018	Chang	D14/230
D826,911 S *	8/2018	Wang	D14/230
D838,260 S *	1/2019	Chang	D14/230
2011/0012789 A1 *	1/2011	Yang	H01Q 1/38 343/700 MS

* cited by examiner

Primary Examiner — Khawaja Anwar

Assistant Examiner — Mojtaba Tehrani

(74) *Attorney, Agent, or Firm* — Clause Eight IPS; Michael Catania

Related U.S. Application Data

- (62) Division of application No. 29/661,243, filed on Aug. 26, 2018, which is a division of application No. 29/618,574, filed on Sep. 21, 2017, now Pat. No. Des. 826,911.
- (51) **LOC (12) Cl.** **14-03**
- (52) **U.S. Cl.**
USPC **D14/230**
- (58) **Field of Classification Search**
USPC D14/230, 232, 233, 234, 235, 236, 237, D14/238, 238.1, 299, 358; D13/182
CPC H01Q 1/088; H01Q 3/10; H01Q 21/00; H04B 7/0608; A61B 2018/1892
See application file for complete search history.

References Cited

U.S. PATENT DOCUMENTS

D779,463 S *	2/2017	Zheng	D14/230
D784,303 S *	4/2017	Zheng	D14/230

(57) **CLAIM**

The ornamental design for an antenna, as shown and described.

DESCRIPTION

FIG. 1 is a top plan view of an antenna, showing our new design;
 FIG. 2 is a front elevation view thereof;
 FIG. 3 is a bottom plan view thereof;
 FIG. 4 is a top perspective view thereof;
 FIG. 5 is a top plan view thereof, with the unclaimed environment not shown; and,
 FIG. 6 is a front elevation view thereof, with the unclaimed environment not shown.
 The broken lines show unclaimed environment only and form no part of the claimed design.

1 Claim, 4 Drawing Sheets

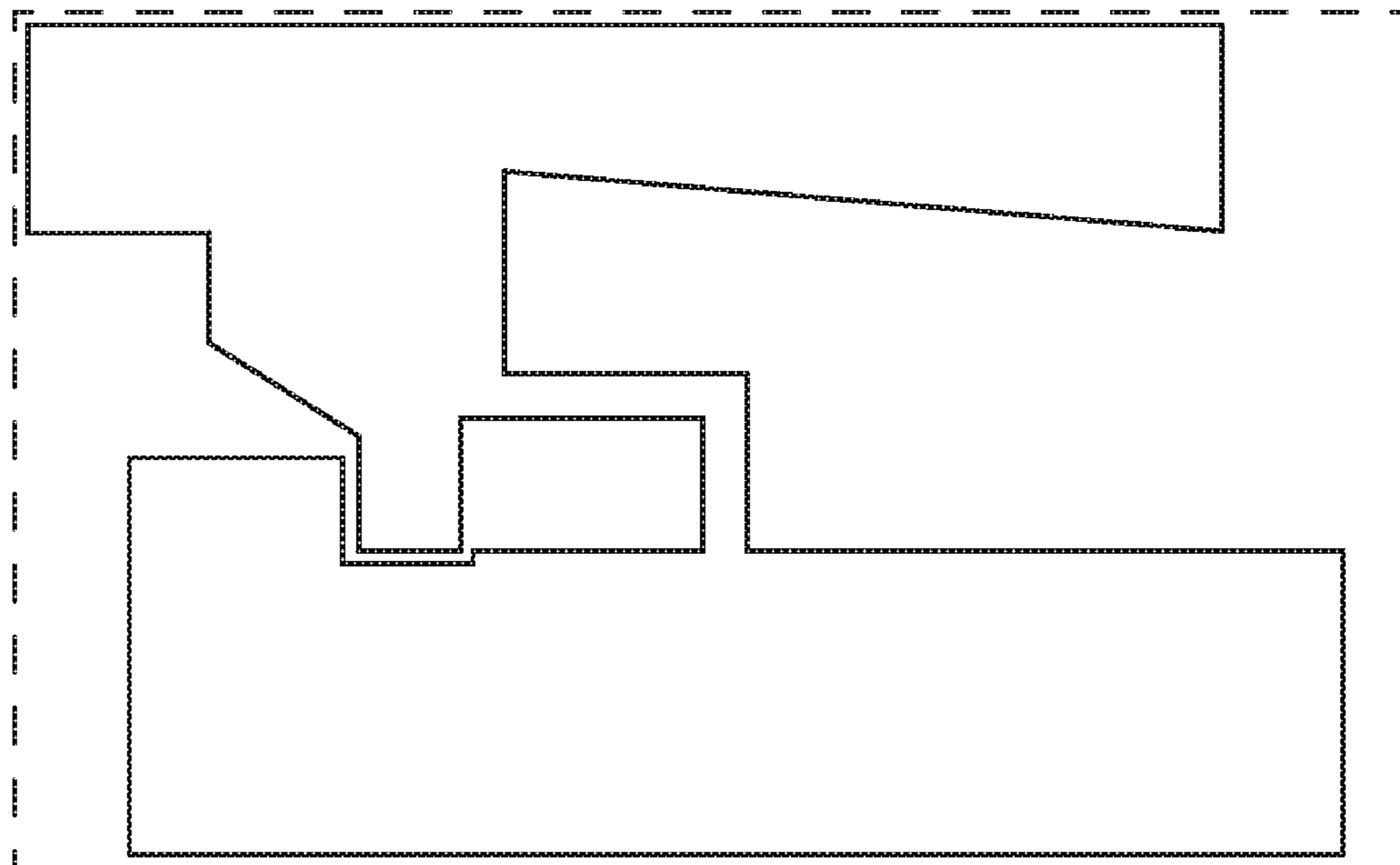

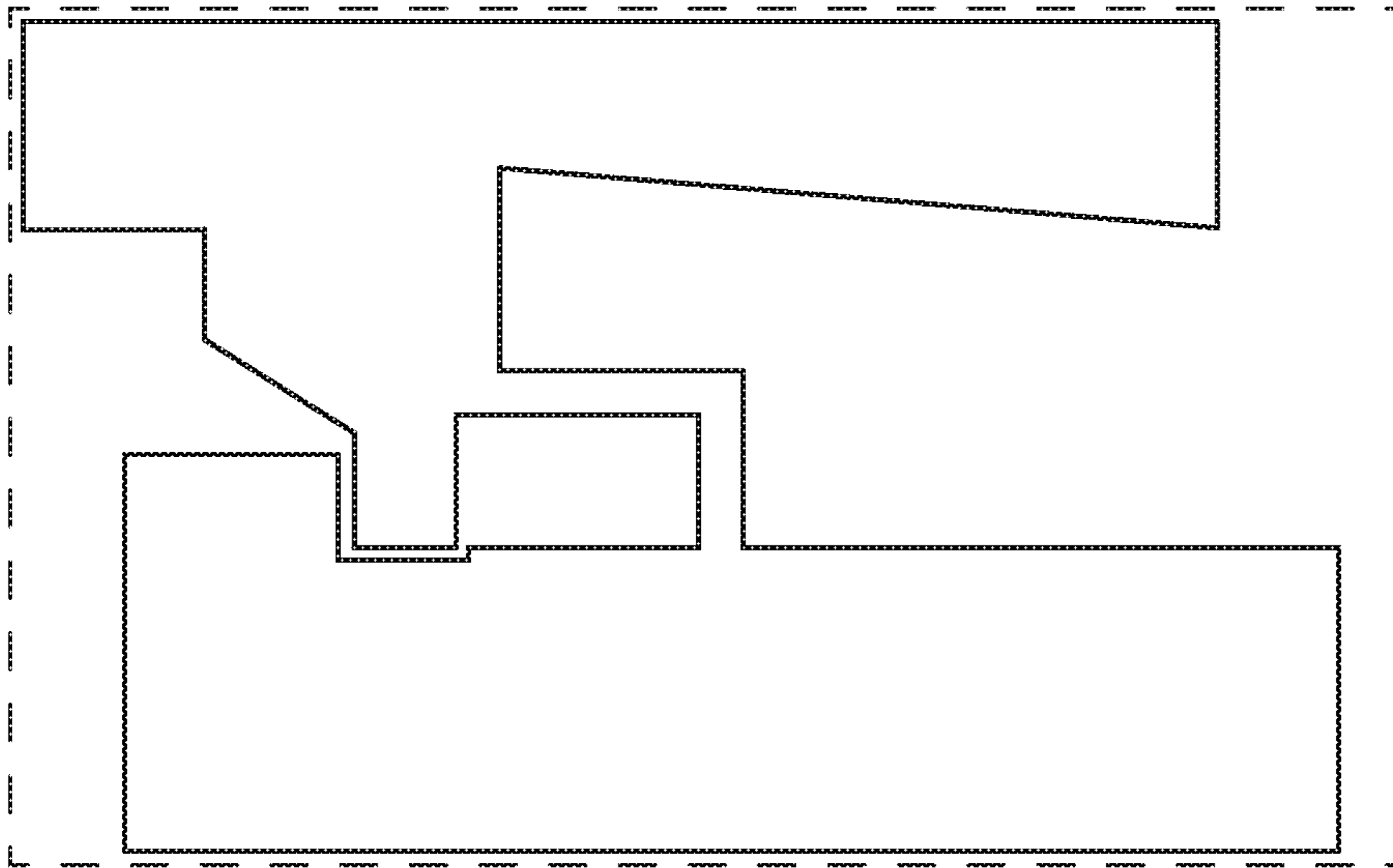

FIG. 1



FIG. 2

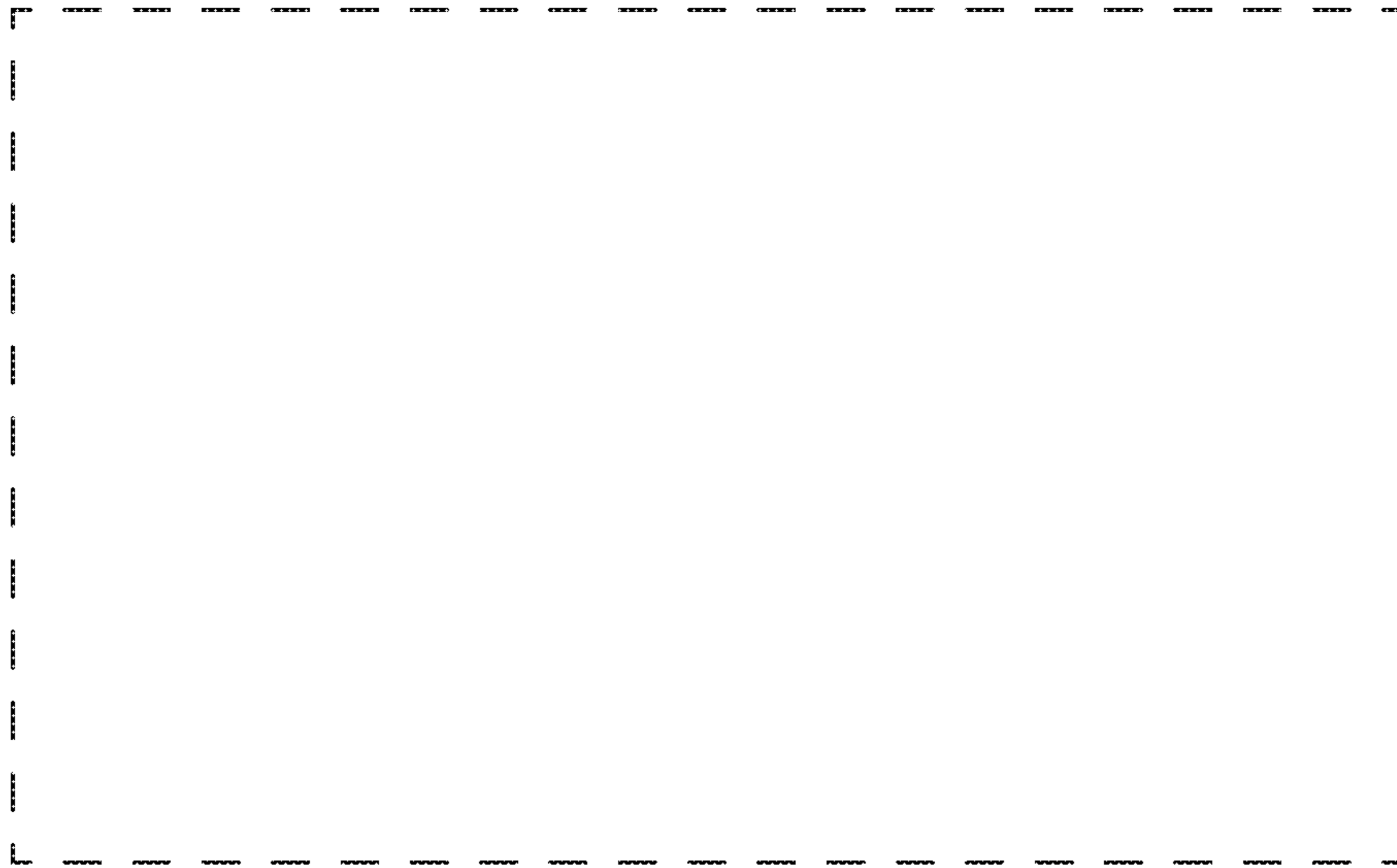

FIG. 3

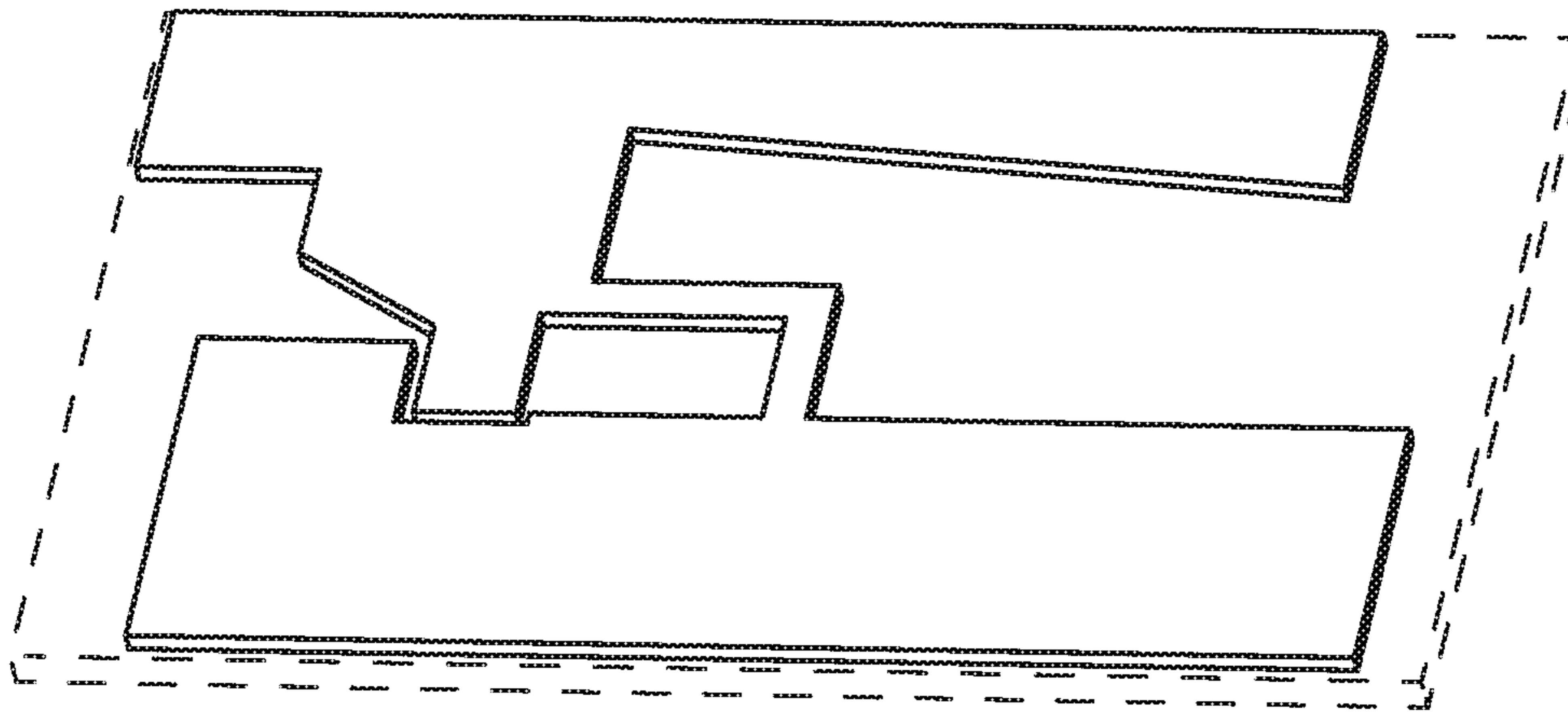

FIG. 4

