

US00D869620S

(12) **United States Design Patent** (10) **Patent No.:** **US D869,620 S**
Kergoët (45) **Date of Patent:** **** Dec. 10, 2019**

(54) **LAVATORY**
 (71) Applicant: **Kohler Co.**, Kohler, WI (US)
 (72) Inventor: **François Kergoët**, Malakoff (FR)
 (73) Assignee: **KOHLER CO.**, Kohler, WI (US)
 (**) Term: **15 Years**
 (21) Appl. No.: **29/648,015**
 (22) Filed: **May 17, 2018**
 (51) **LOC (12) Cl.** **23-01**
 (52) **U.S. Cl.**
 USPC **D23/288**
 (58) **Field of Classification Search**
 USPC D23/284, 288, 290, 308, 201
 See application file for complete search history.

D530,406 S 10/2006 Soulier
 D571,900 S * 6/2008 Daikubara D23/277
 D610,660 S * 2/2010 Slothower D23/293.1
 D634,408 S * 3/2011 Thomas D23/284
 D663,017 S * 7/2012 Slothower D23/308

* cited by examiner

Primary Examiner — Robert A Delehanty
 (74) *Attorney, Agent, or Firm* — Foley & Larnder LLP

(57) **CLAIM**

I claim the ornamental design for a lavatory, as shown and described.

DESCRIPTION

FIG. 1 is a perspective view of an embodiment of the claimed design;
 FIG. 2 is a top view of the embodiment of FIG. 1;
 FIG. 3 is a bottom view of the embodiment of FIG. 1;
 FIG. 4 is a front view of the embodiment of FIG. 1;
 FIG. 5 is a rear view of the embodiment of FIG. 1;
 FIG. 6 is a side view of the embodiment of FIG. 1; and,
 FIG. 7 is another side view of the embodiment of FIG. 1.
 The ornamental design which is claimed is shown in solid lines in the drawings. The broken lines in the drawings are for illustrative purposes only and form no part of the claimed design. Broken lines formed of unequal length dashes (i.e., dash-dot) define bounds of the claimed design.

1 Claim, 4 Drawing Sheets

(56) **References Cited**
 U.S. PATENT DOCUMENTS
 D116,564 S * 9/1939 Love D23/290
 D127,274 S 3/1941 Kohler
 D202,411 S * 9/1965 Niemann D23/293.1
 D318,522 S 7/1991 Yvetot
 D328,338 S * 7/1992 Ragonot D23/284
 D366,102 S 1/1996 Bonnell
 D366,311 S 1/1996 Bonnell
 D369,855 S * 5/1996 Reid D23/293.1
 D394,308 S * 5/1998 Bertoli D23/293.1
 D529,147 S * 9/2006 Sutopo D23/284

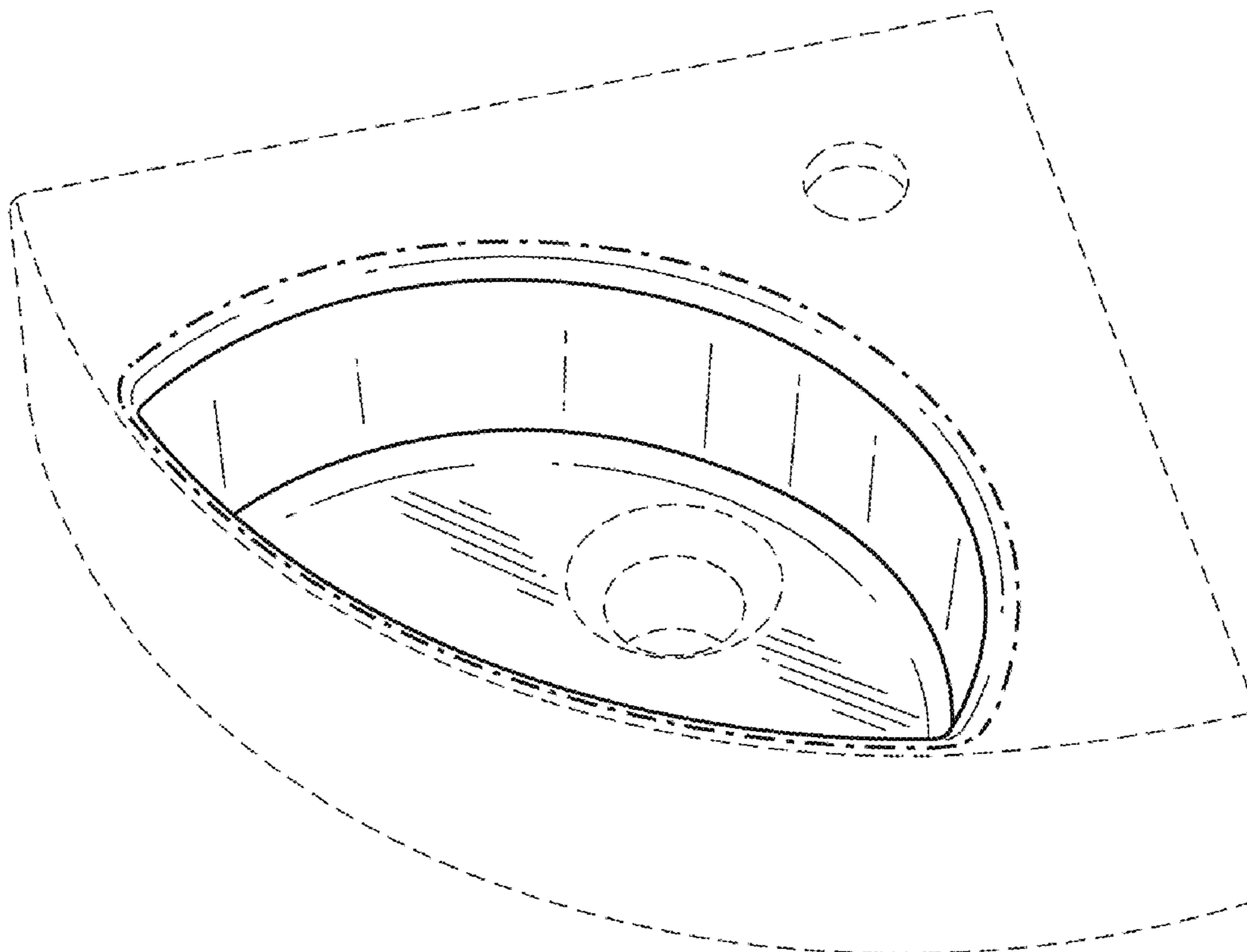

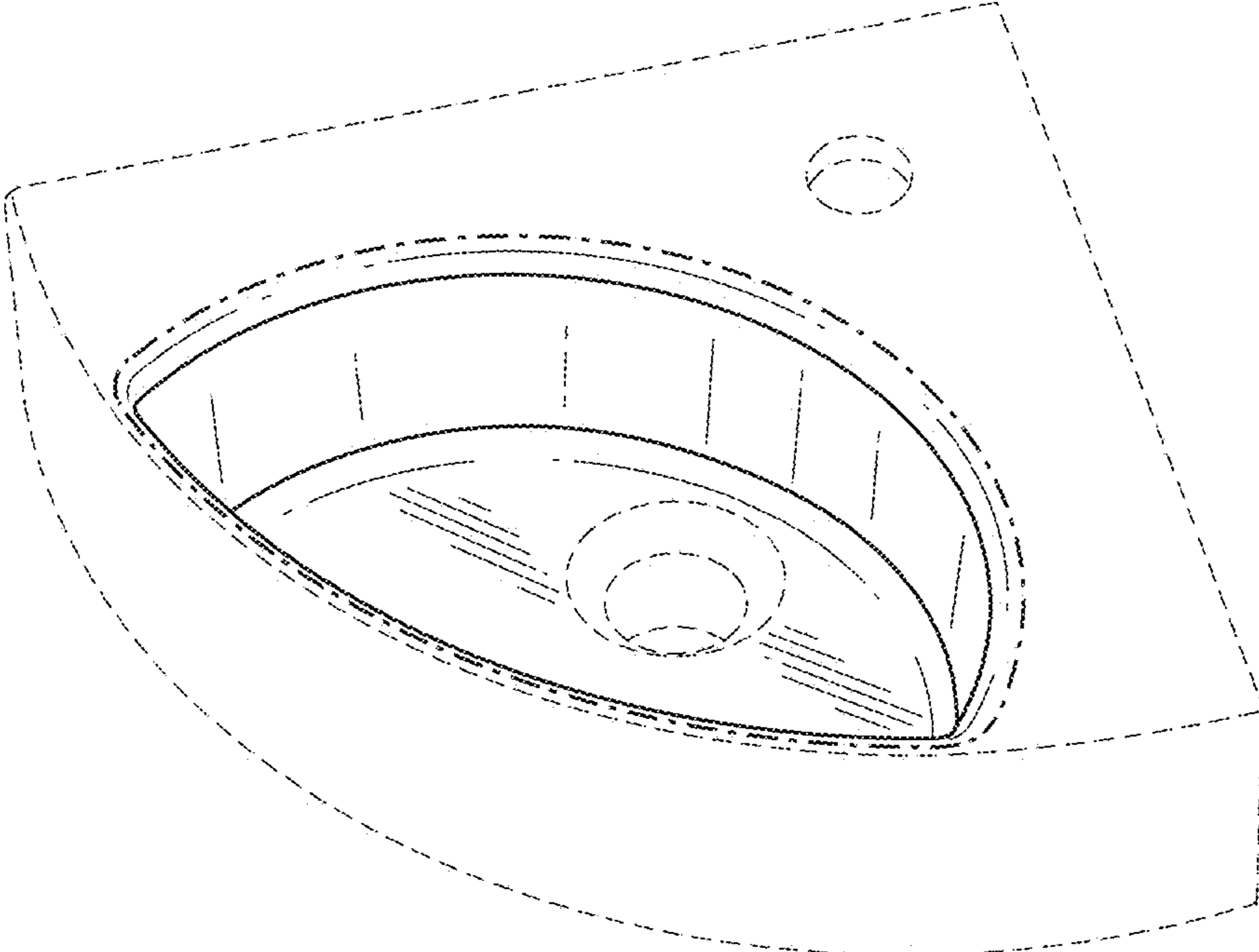

FIG. 1

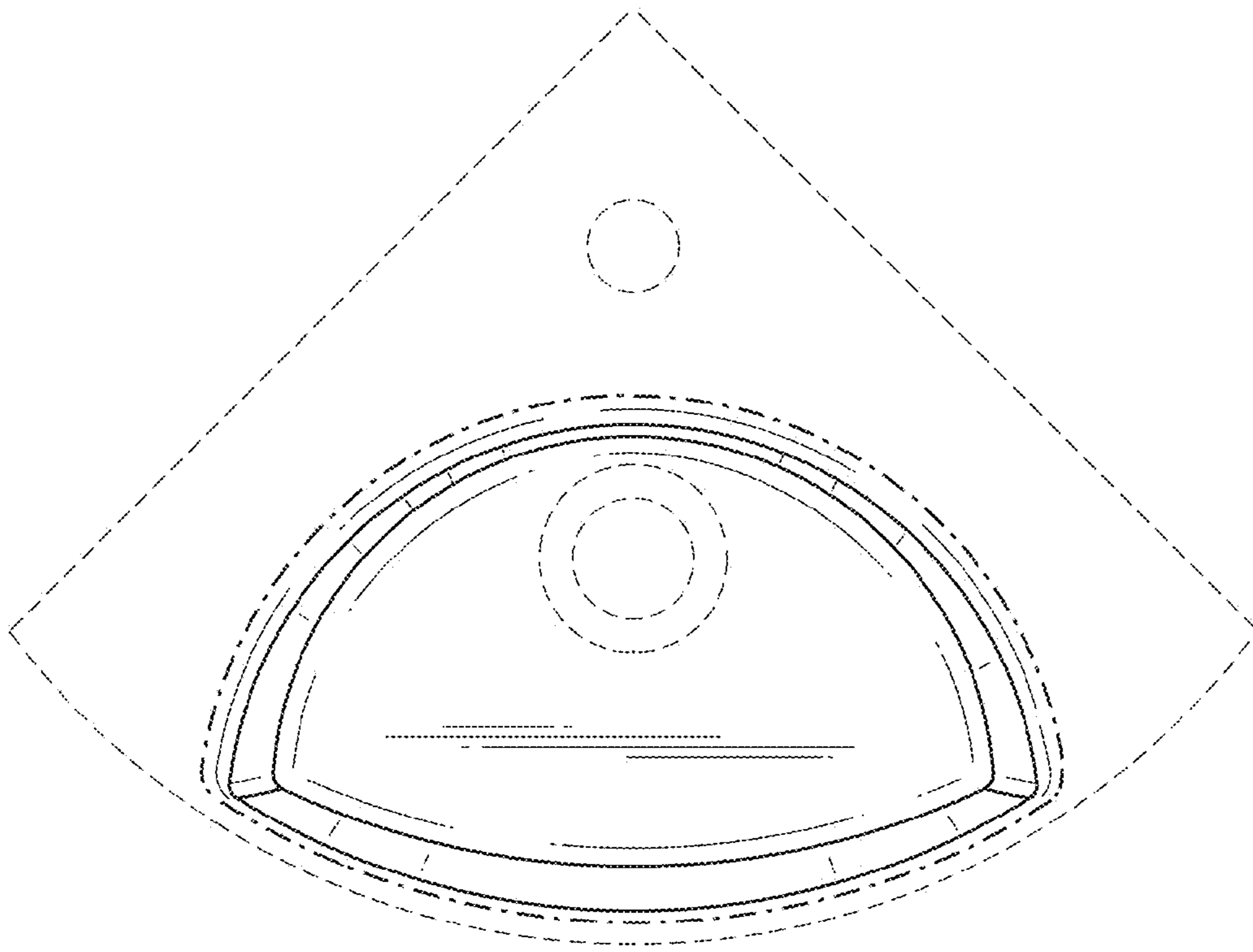

FIG. 2

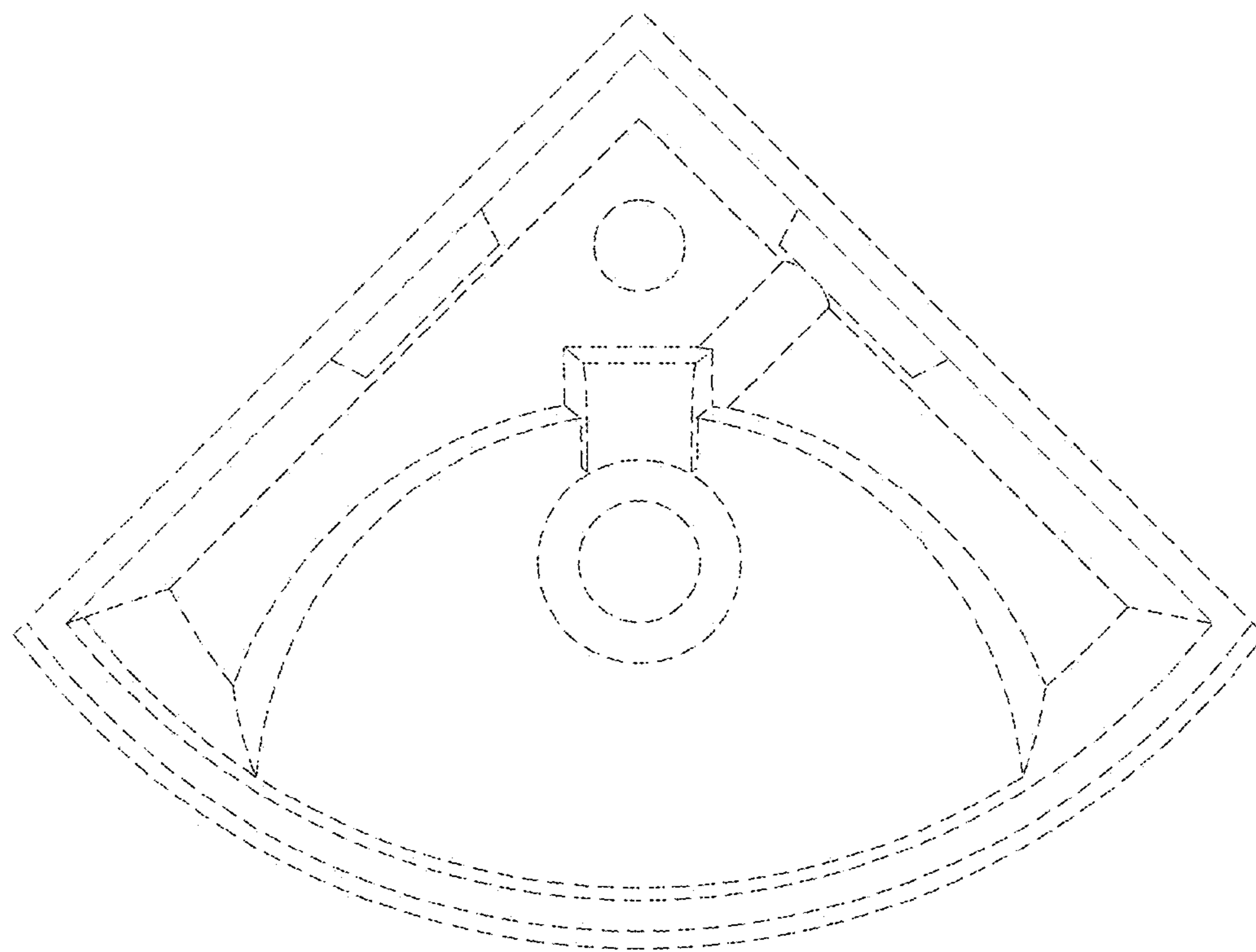

FIG. 3

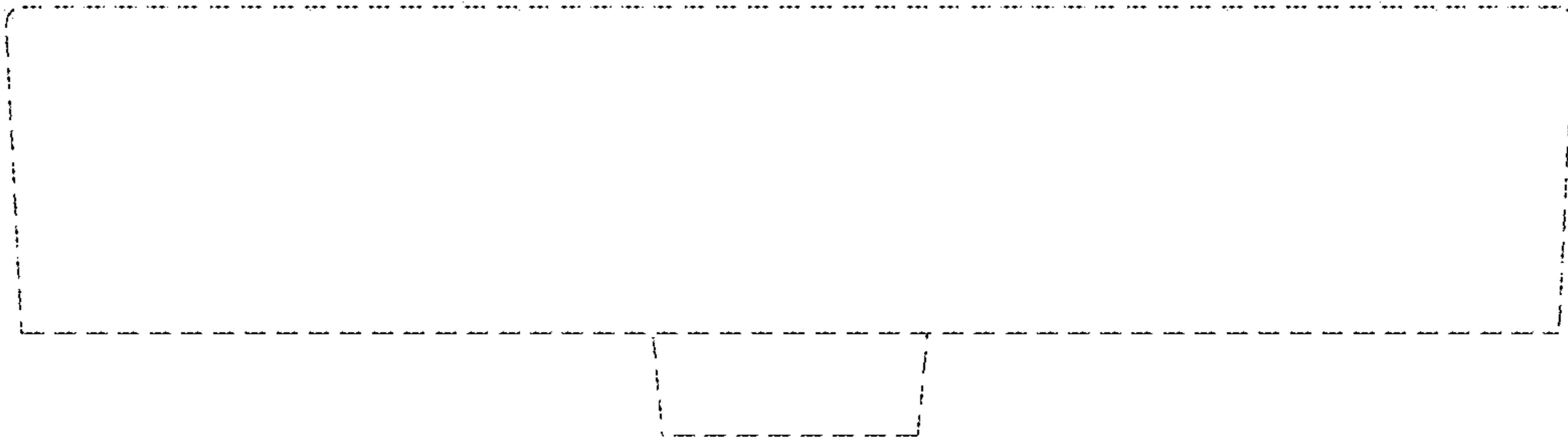

FIG. 4

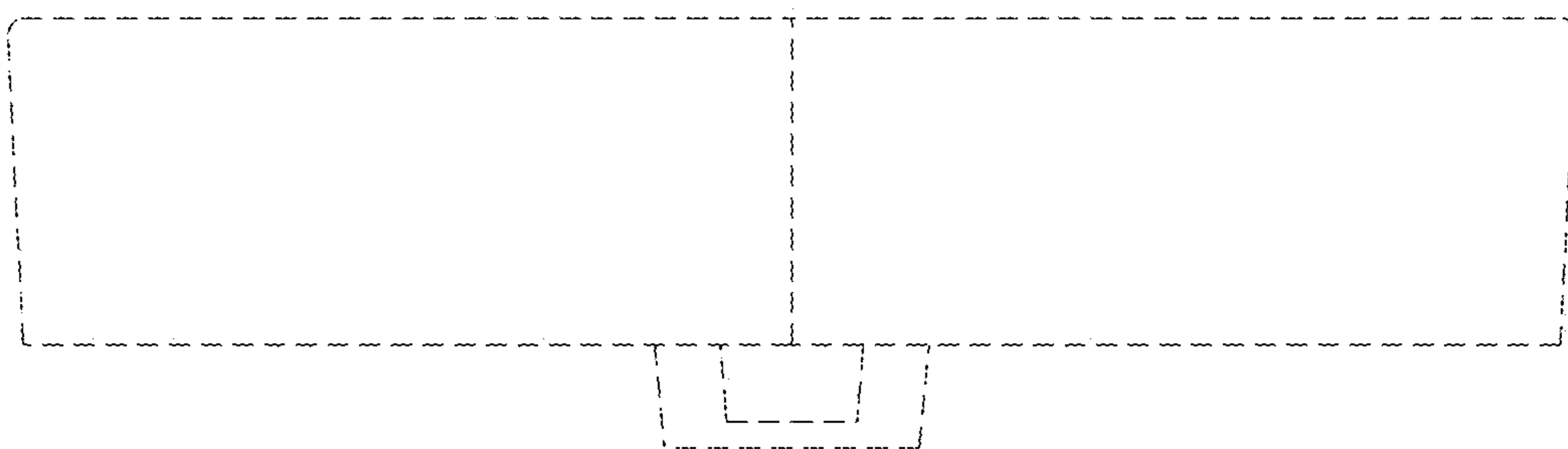

FIG. 5

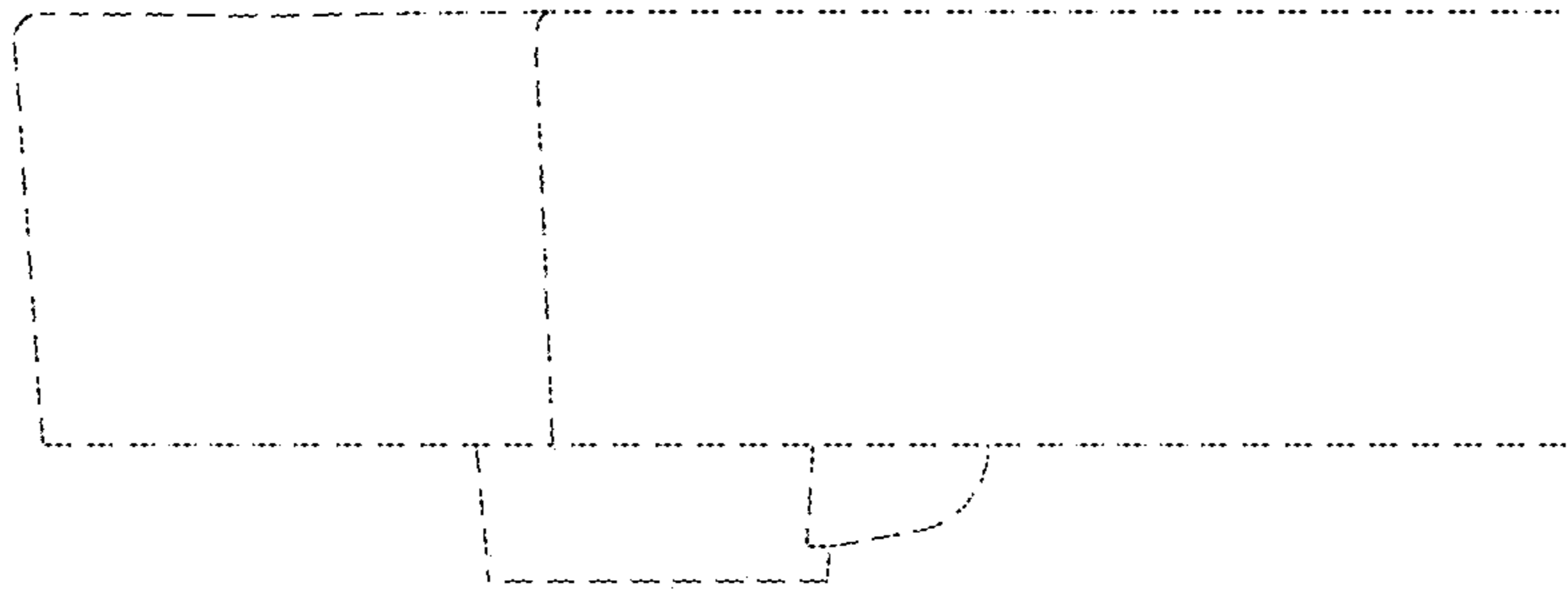

FIG. 6

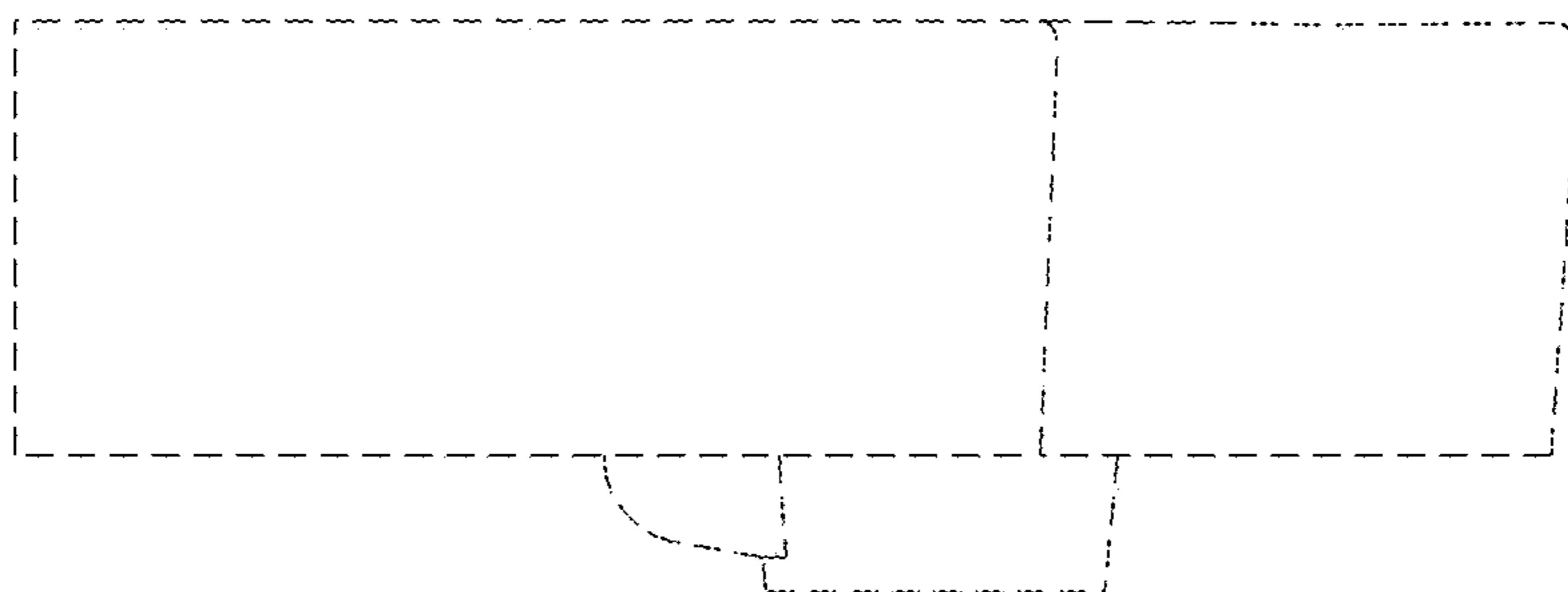

FIG. 7