



US00D869413S

(12) **United States Design Patent** (10) **Patent No.:** **US D869,413 S**
Spencer et al. (45) **Date of Patent:** **** Dec. 10, 2019**

(54) **DUAL SCREEN DIGITAL OUTDOOR DISPLAY**

(71) Applicant: **Melitron Corporation**, Guelph (CA)

(72) Inventors: **Sean Spencer**, Guelph (CA); **Matthew Robertson**, Guelph (CA); **Michael Turner**, Guelph (CA)

(73) Assignee: **Melitron Corporation**, Guelph, Ontario (CA)

(**) Term: **15 Years**

(21) Appl. No.: **29/664,071**

(22) Filed: **Sep. 21, 2018**

(51) **LOC (12) Cl.** **14-03**

(52) **U.S. Cl.**

USPC **D14/126**

(58) **Field of Classification Search**

USPC D14/125-134, 239, 371, 136, 374-377, D14/440, 450, 448, 336, 342, 159; 312/7.2; 348/836, 838, 180, 184, 325, 348/739; 248/917-924, 465; 345/104, 345/133, 156, 168, 87, 173; D21/329, D21/515, 577, 622, 333, 433, 448, 452, D21/450, 331, 505; D10/15, 26; 446/484, 175, 356; D6/477, 479, 300; D24/185; D34/14

CPC ... G06F 1/1601; G06F 1/1643; H05K 5/0004; H05K 5/0017; H05K 5/02; H05K 5/0217

See application file for complete search history.

(56) **References Cited**

U.S. PATENT DOCUMENTS

D395,298 S * 6/1998 Rosen D14/127
D472,223 S * 3/2003 Wilmotte D14/126

D600,046 S * 9/2009 Kelsen D6/681.1
D661,123 S * 6/2012 Curbbun D20/10
D723,026 S * 2/2015 Birgeoglu D14/307
D734,965 S * 7/2015 Tio D6/675
D758,765 S * 6/2016 Barho D6/660
D813,954 S * 3/2018 Calhoun D21/369

* cited by examiner

Primary Examiner — Randall H Gholson

(57) **CLAIM**

The ornamental design for a dual screen digital outdoor display, as shown and described.

DESCRIPTION

FIG. 1 is a perspective view of a first embodiment thereof; FIG. 2 is a front view thereof; FIG. 3 is a first side view thereof; FIG. 4 is a back view thereof; FIG. 5 is a top view thereof; FIG. 6 is a second side view thereof; FIG. 7 is a bottom view thereof; FIG. 8 is a perspective view of an alternative embodiment thereof; FIG. 9 is a front view of the embodiment of FIG. 8; FIG. 10 is a first side view of the embodiment of FIG. 8; FIG. 11 is a back view of the embodiment of FIG. 8; FIG. 12 is a top view of the embodiment of FIG. 8; FIG. 13 is a second side view of the embodiment of FIG. 8; and, FIG. 14 is a bottom view of the embodiment of FIG. 8.

1 Claim, 14 Drawing Sheets

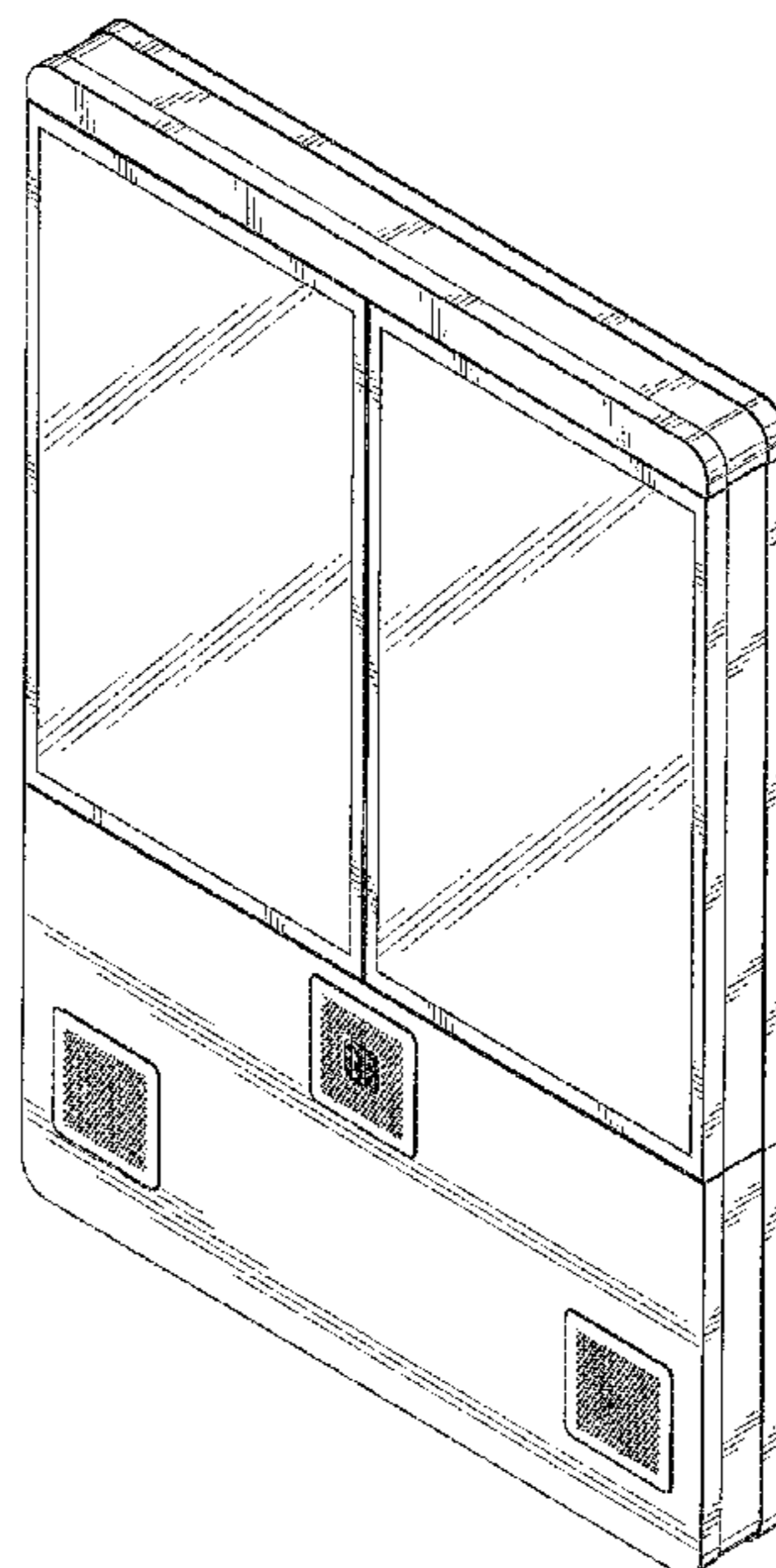

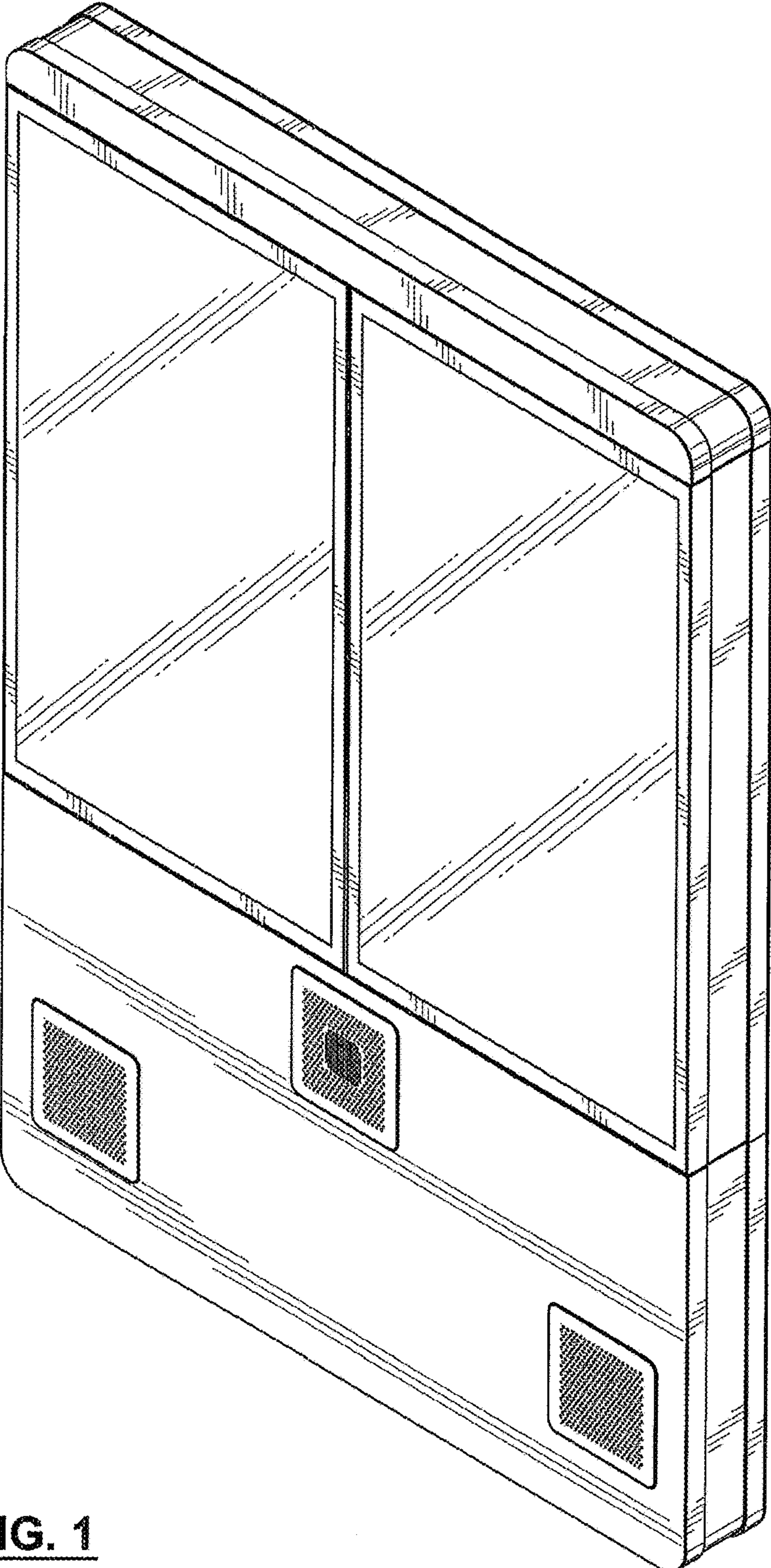

FIG. 1

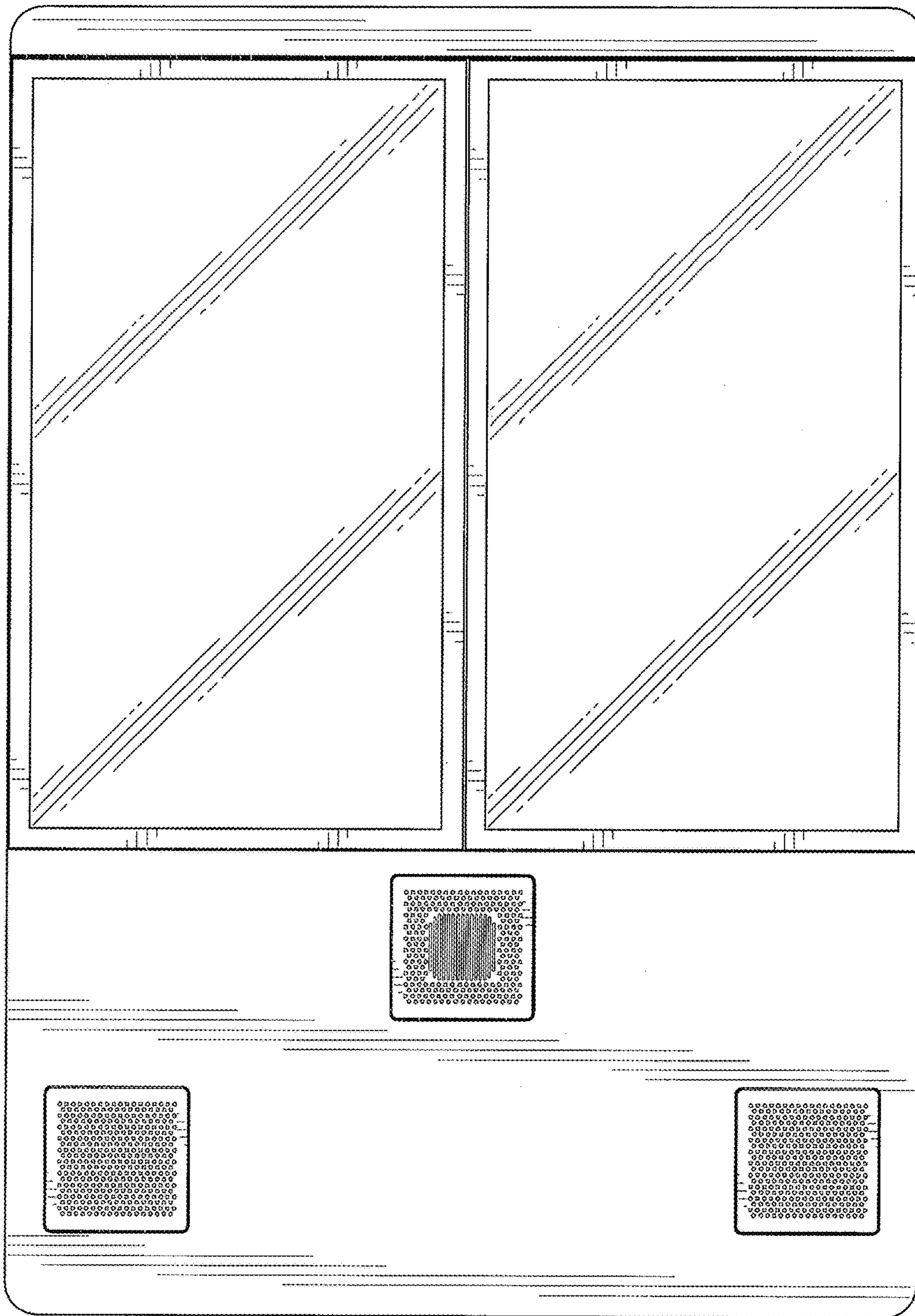

FIG. 2

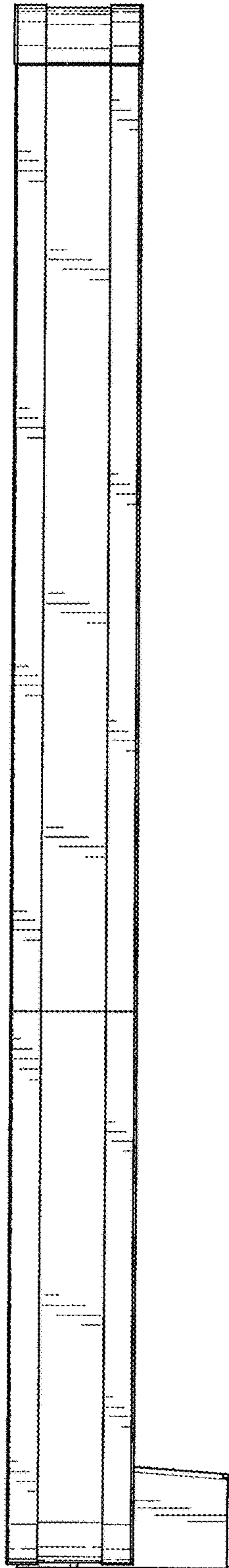

FIG. 3

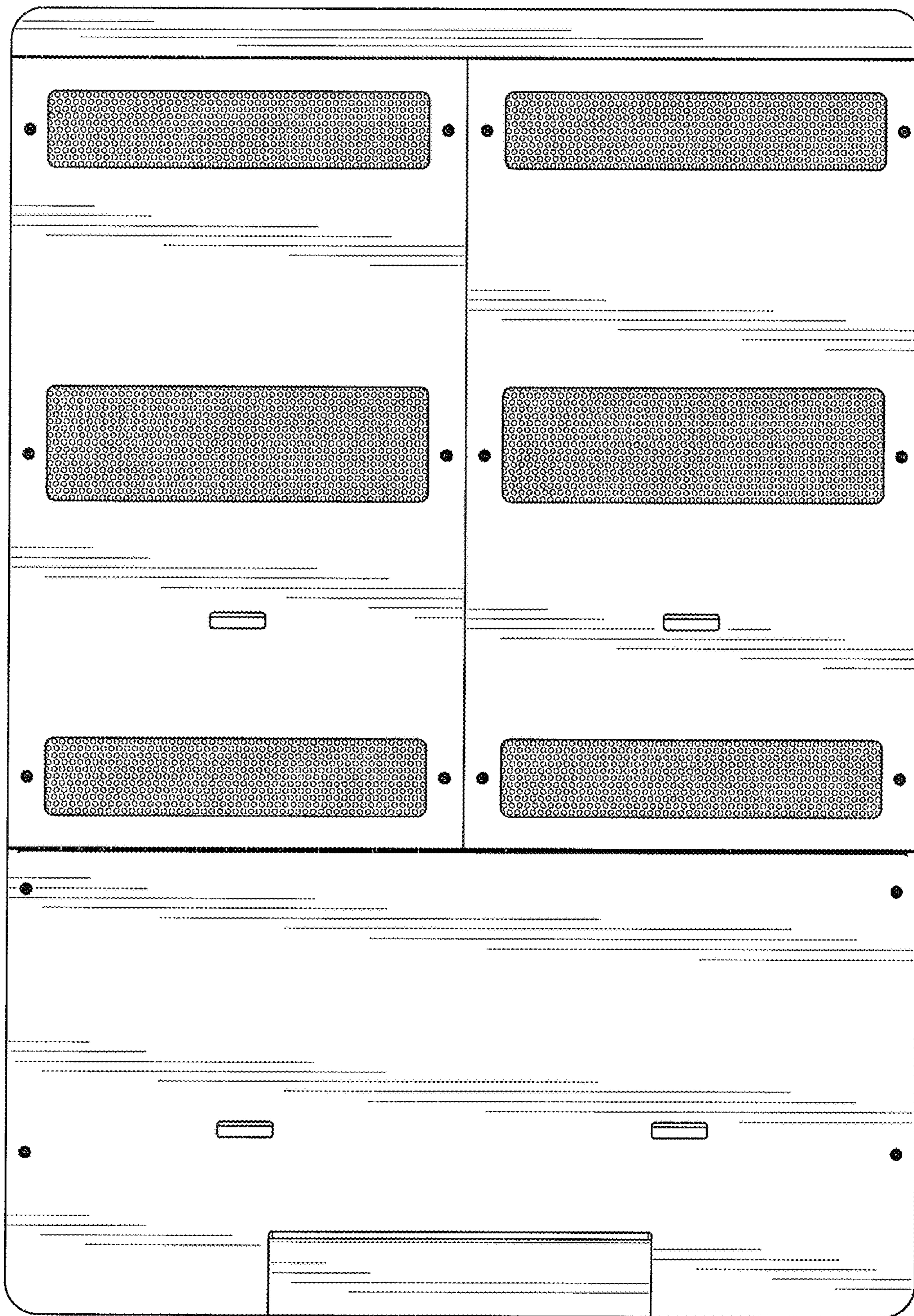

FIG. 4

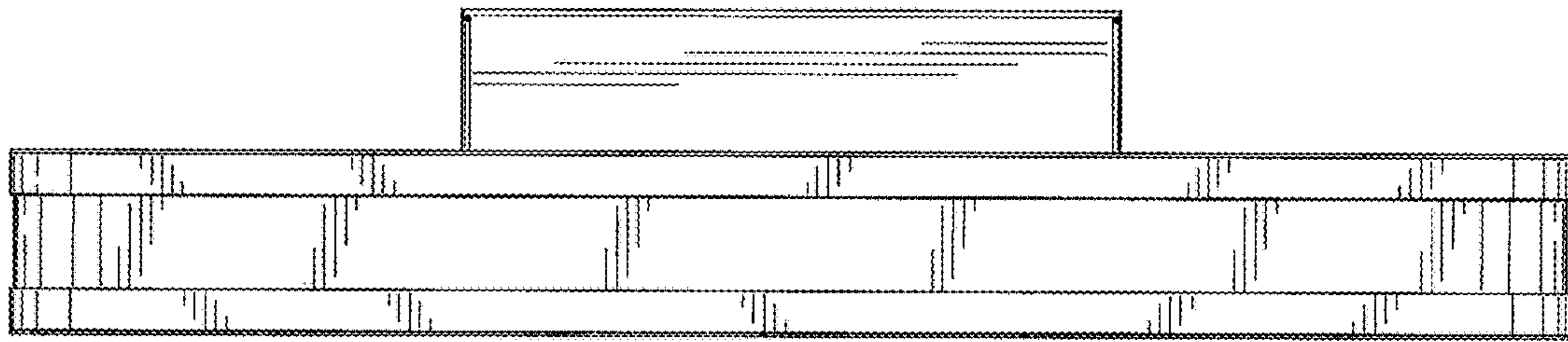

FIG. 5

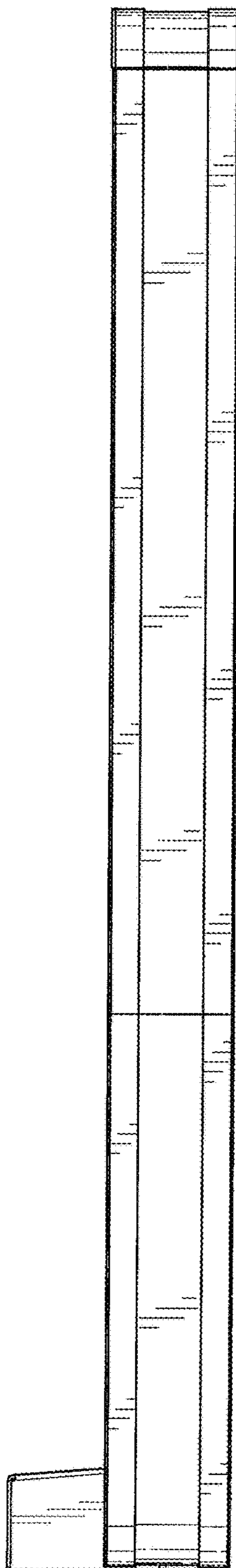

FIG. 6

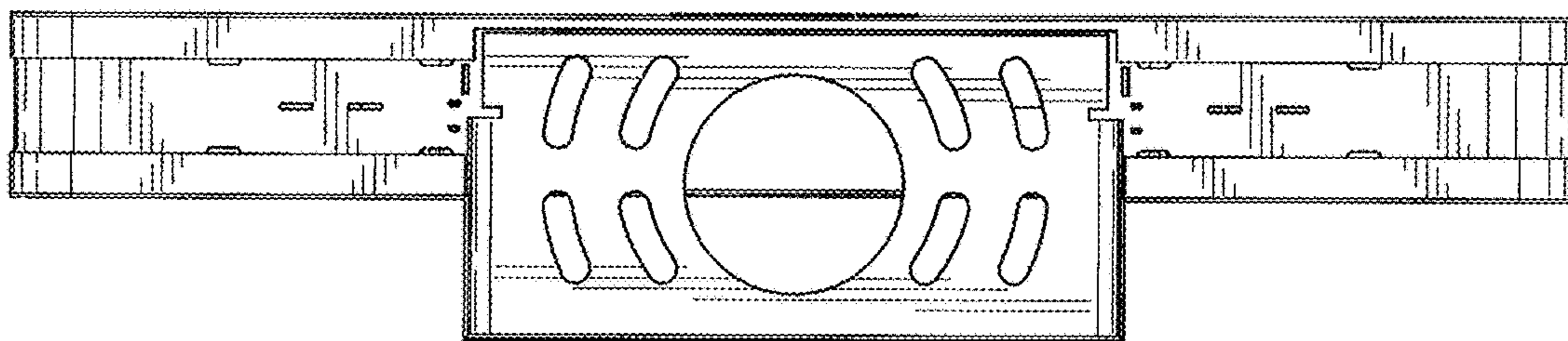

FIG. 7

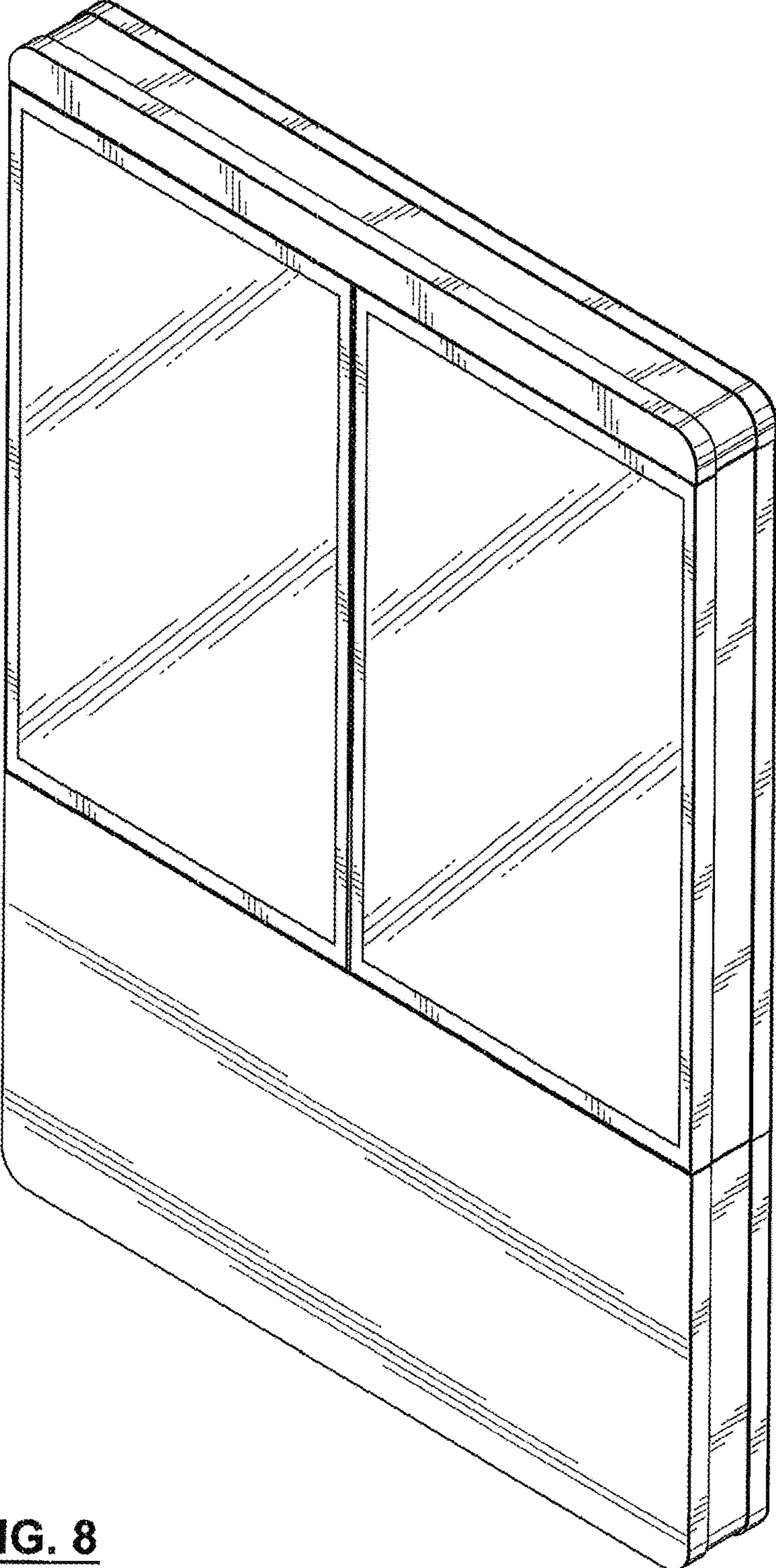

FIG. 8

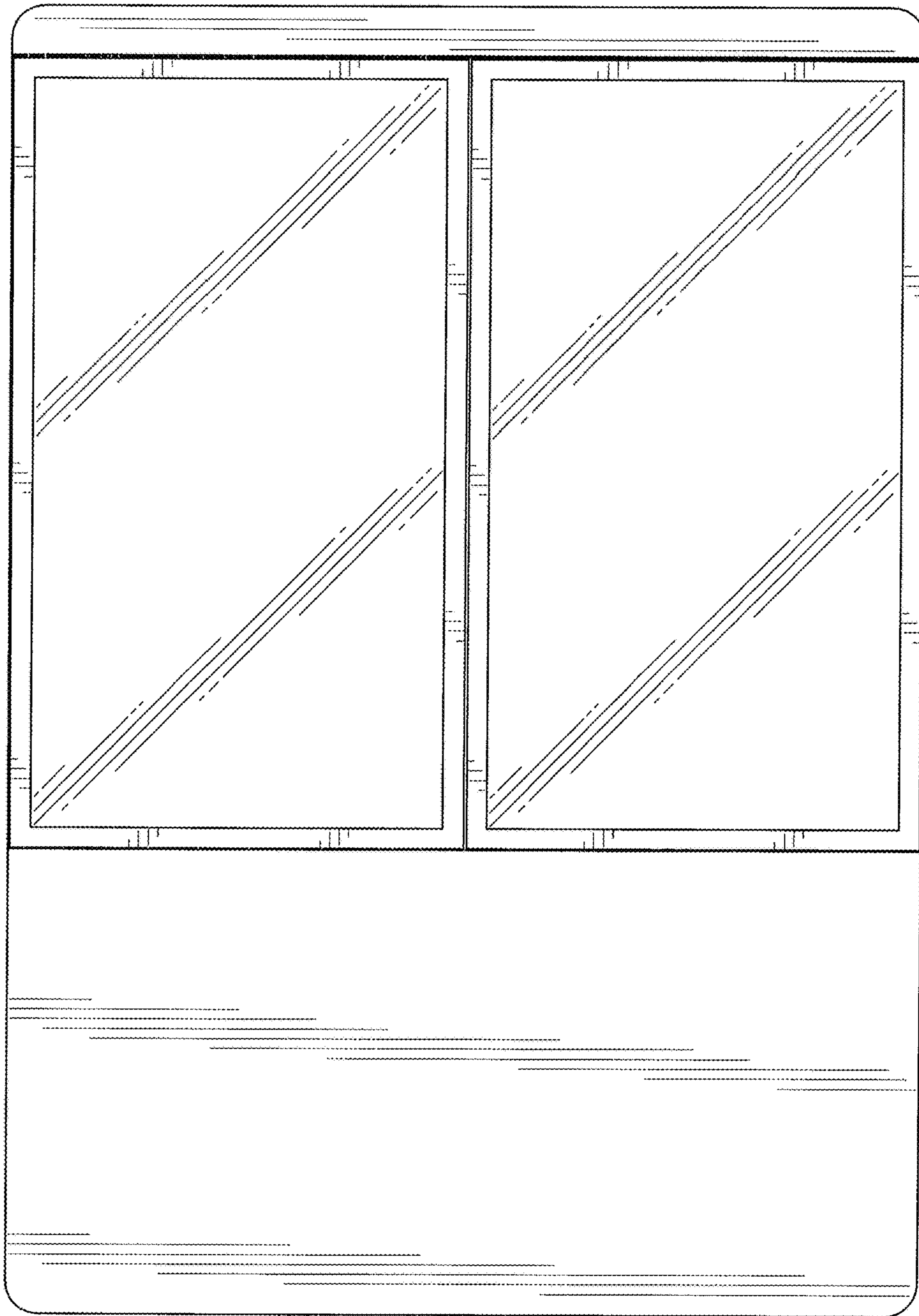

FIG. 9

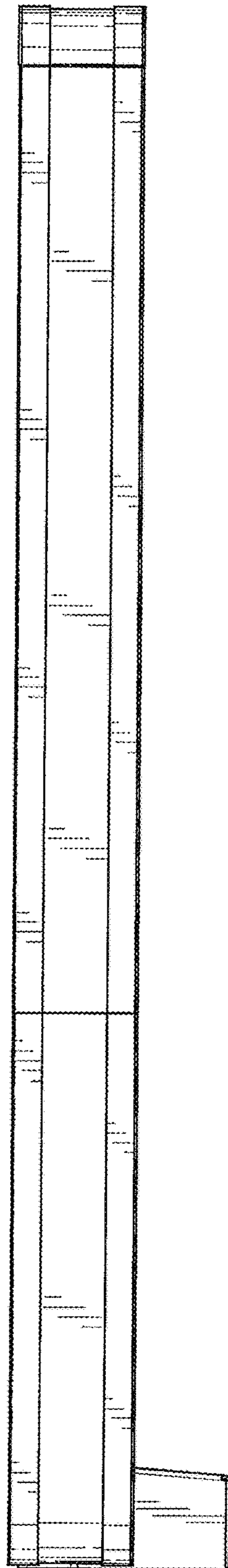

FIG. 10

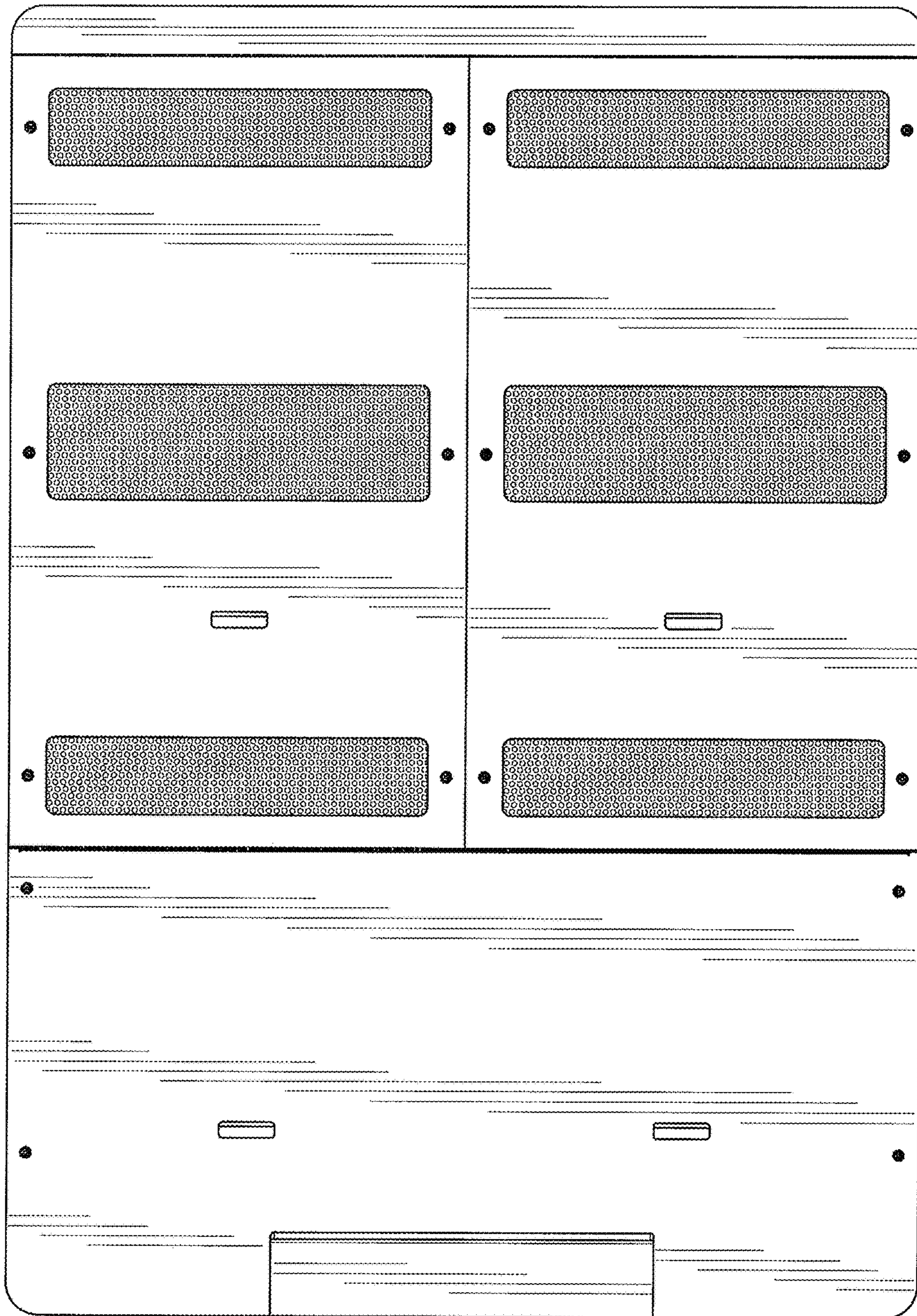

FIG. 11

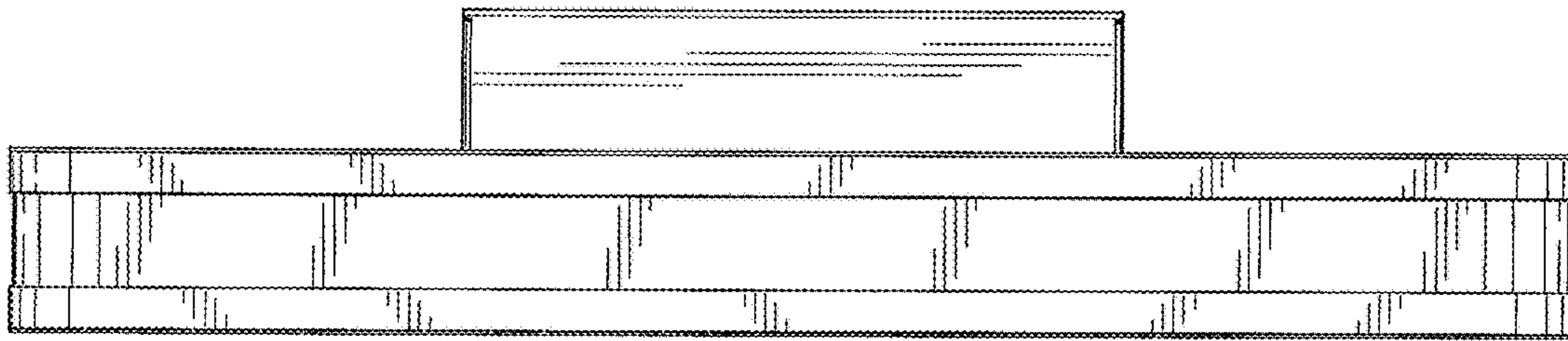

FIG. 12

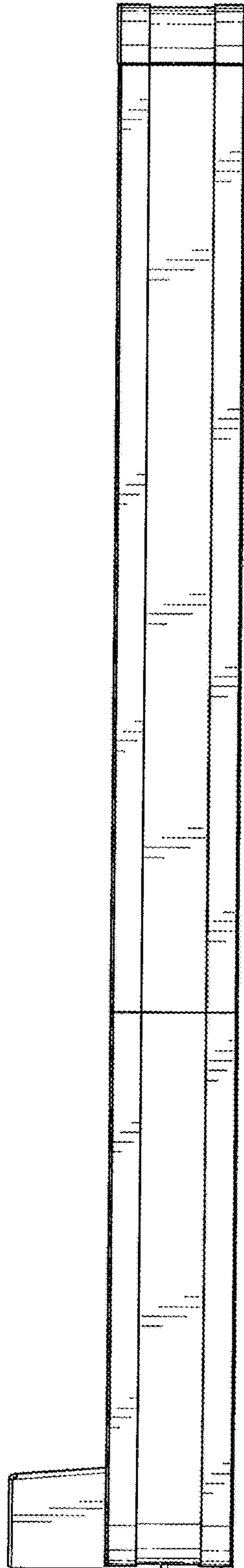

FIG. 13

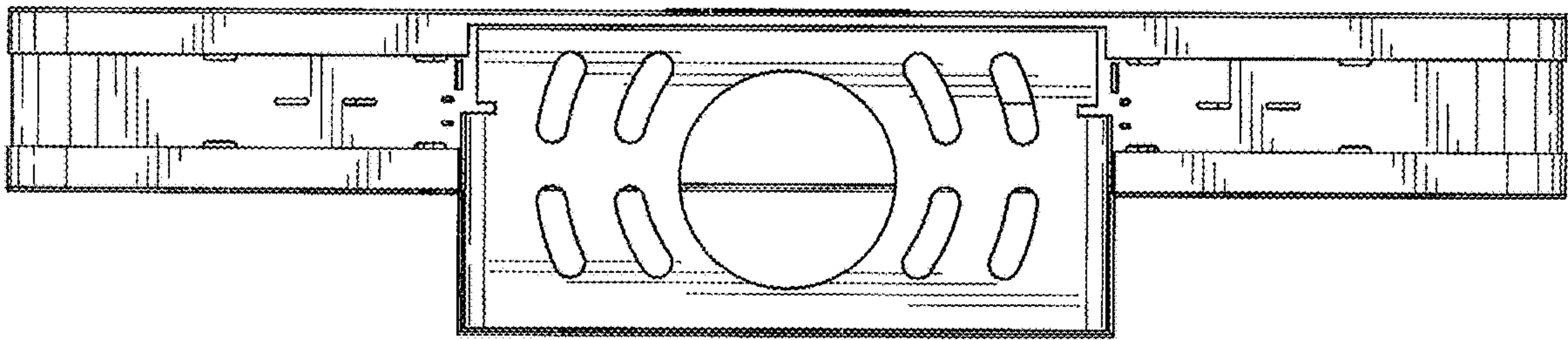

FIG. 14