



US00D869380S

(12) **United States Design Patent**  
**Kabata et al.**

(10) **Patent No.:** **US D869,380 S**

(45) **Date of Patent:** **\*\* Dec. 10, 2019**

(54) **CENTER CONSOLE FOR AN AUTOMOBILE**

(71) Applicant: **Nissan Motor Co., Ltd.**, Yokohama,  
Kanagawa (JP)

(72) Inventors: **Shigeyoshi Kabata**, Kanagawa (JP);  
**Yosuke Takaki**, Kanagawa (JP)

(73) Assignee: **Nissan Motor Co., Ltd.**, Yokohama  
(JP)

(\*\*) Term: **15 Years**

(21) Appl. No.: **29/623,091**

(22) Filed: **Oct. 23, 2017**

(30) **Foreign Application Priority Data**

Apr. 24, 2017 (JP) ..... 2017-008758

(51) **LOC (12) Cl.** ..... **12-16**

(52) **U.S. Cl.**  
USPC ..... **D12/415**

(58) **Field of Classification Search**  
USPC ..... D12/415, 419  
CPC .. B60N 3/10; B60N 2/46; B60R 13/02; C03C  
3/085

See application file for complete search history.

(56) **References Cited**

**U.S. PATENT DOCUMENTS**

D440,193 S \* 4/2001 Pfeiffer ..... D12/192  
D801,425 S \* 10/2017 Uhm ..... D16/335  
D824,324 S \* 7/2018 Gao ..... D12/415  
D826,838 S \* 8/2018 Boyes ..... D12/415  
D830,950 S \* 10/2018 Lee ..... D12/415

D835,567 S \* 12/2018 Gaudreau ..... D12/415  
D836,059 S \* 12/2018 Takagi ..... D12/415  
D836,060 S \* 12/2018 Takagi ..... D12/415  
D840,325 S \* 2/2019 Sandys ..... D12/415  
D852,100 S \* 6/2019 Ko ..... D12/192

\* cited by examiner

*Primary Examiner* — Katrina A Betton

(74) *Attorney, Agent, or Firm* — Global IP Counselors,  
LLP

(57) **CLAIM**

The ornamental design for a center console for an automob-  
ile, as shown and described.

**DESCRIPTION**

FIG. 1 is a front elevational view of a center console for an  
automobile in accordance with our new design;  
FIG. 2 is a rear elevational view thereof;  
FIG. 3 is a top plan view thereof;  
FIG. 4 is a bottom plan view thereof;  
FIG. 5 is a left side elevational view thereof;  
FIG. 6 is a right side elevational view thereof;  
FIG. 7 is a first perspective view thereof; and,  
FIG. 8 is a second perspective view thereof.

The center console is configured to be mounted to an  
automobile. The inside surfaces of the center console, shown  
in broken lines in FIGS. 1 to 8, form no part of the claimed  
design since the inside surfaces are hidden when the center  
console is mounted to the automobile.

A second embodiment of our new design includes the mirror  
image of the center console shown in FIGS. 1 to 8.

**1 Claim, 8 Drawing Sheets**

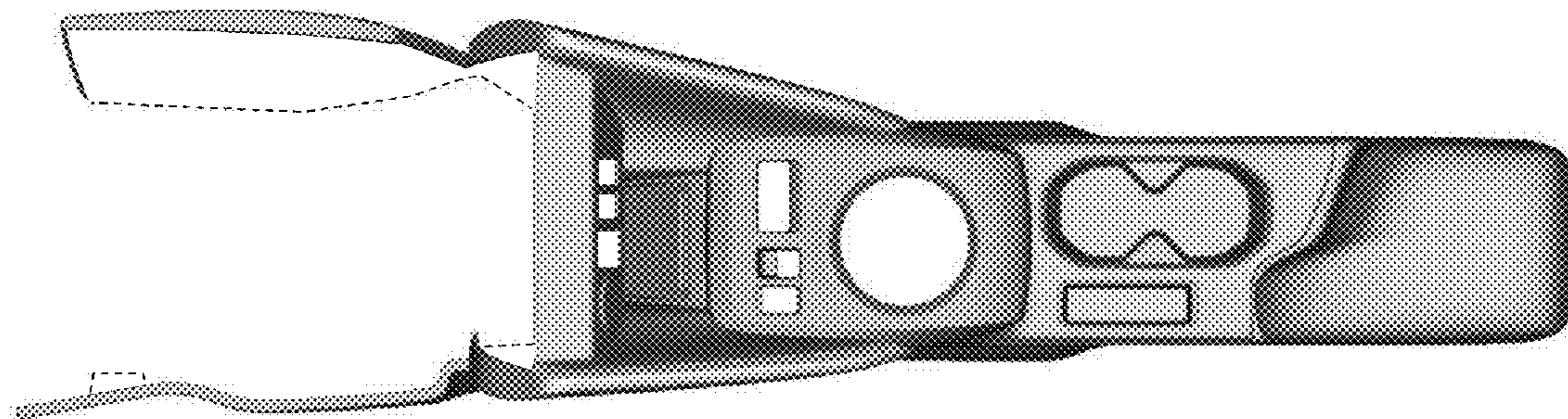

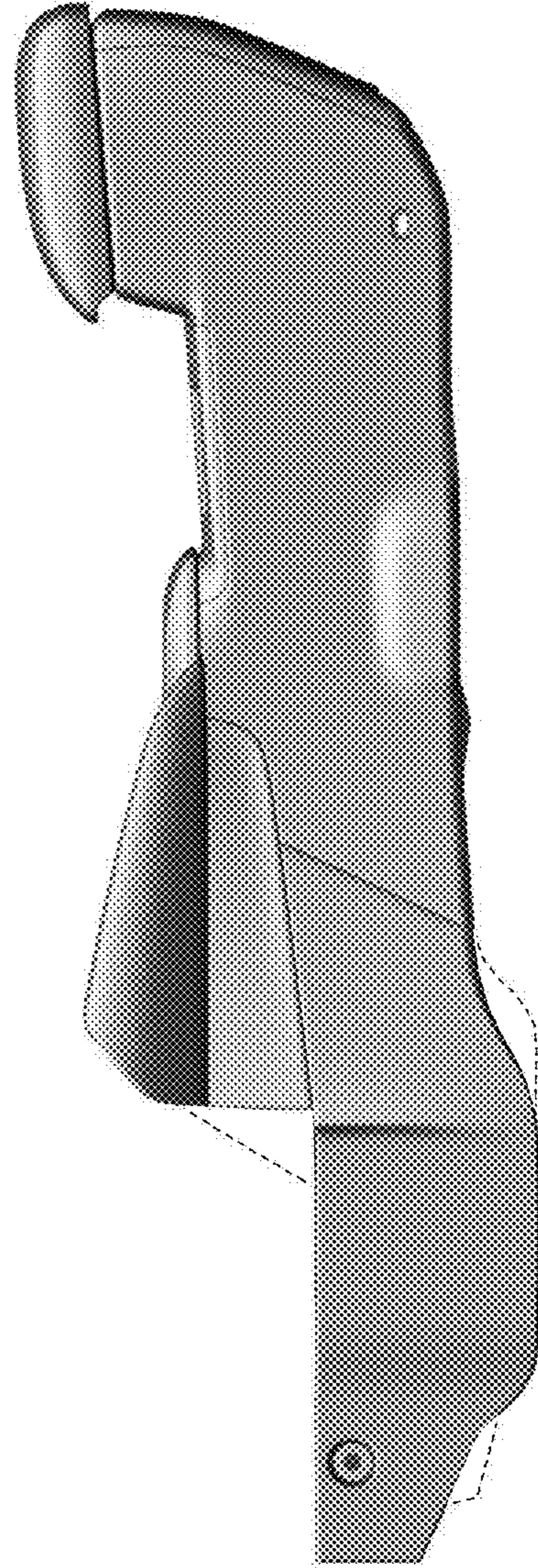

FIG. 1



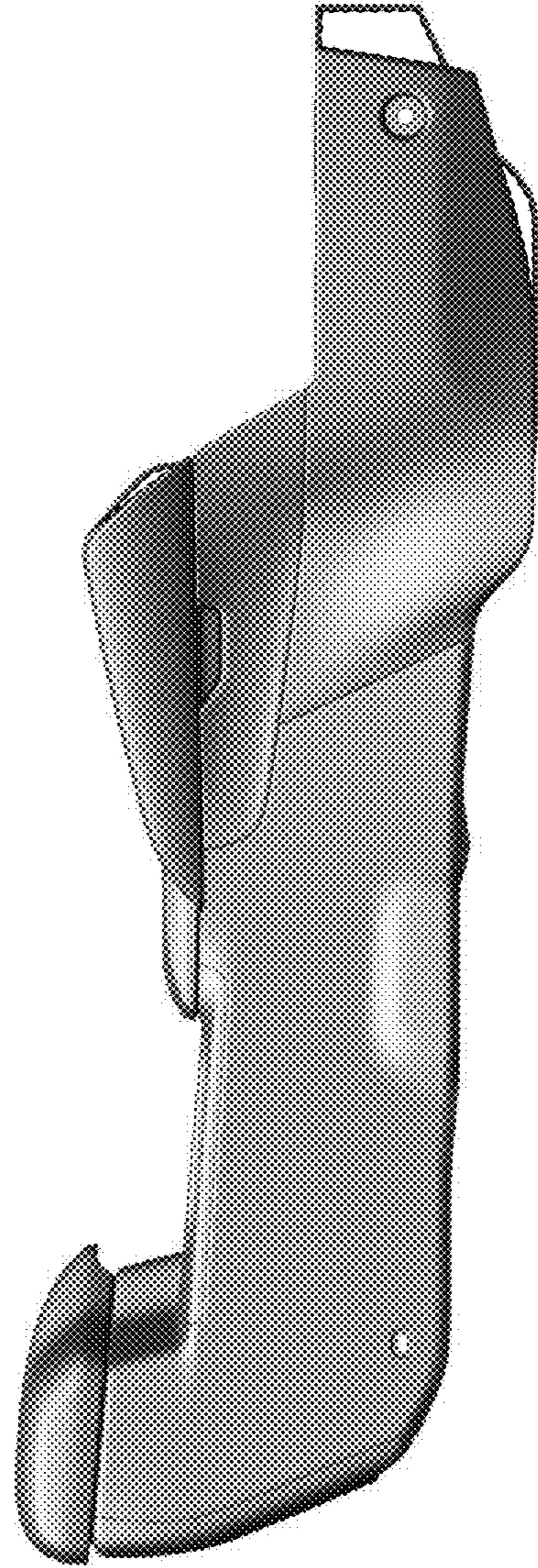

FIG. 2

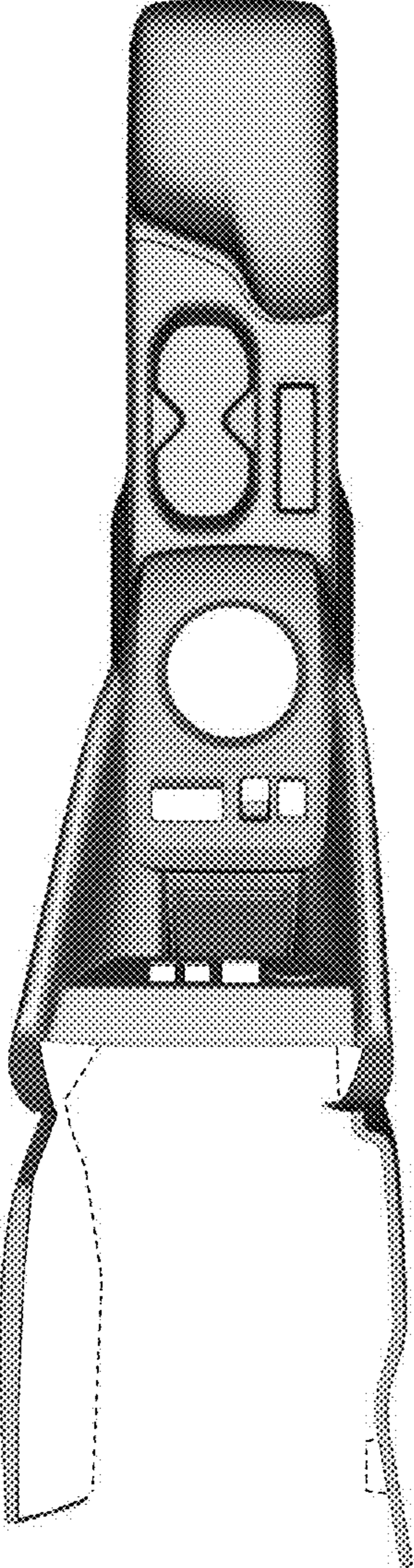

FIG. 3

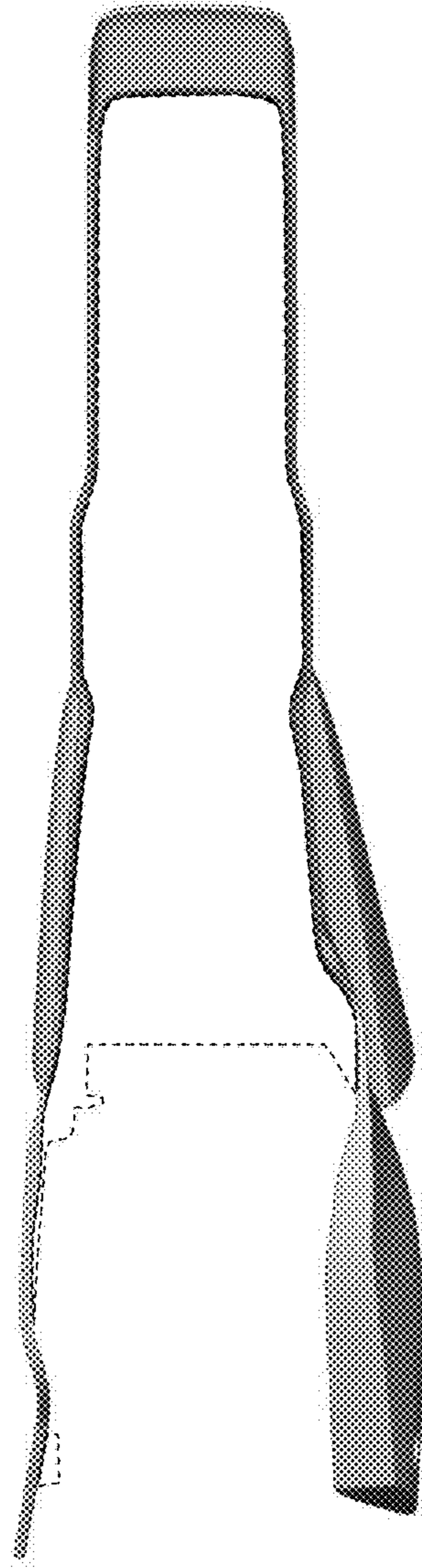

FIG. 4

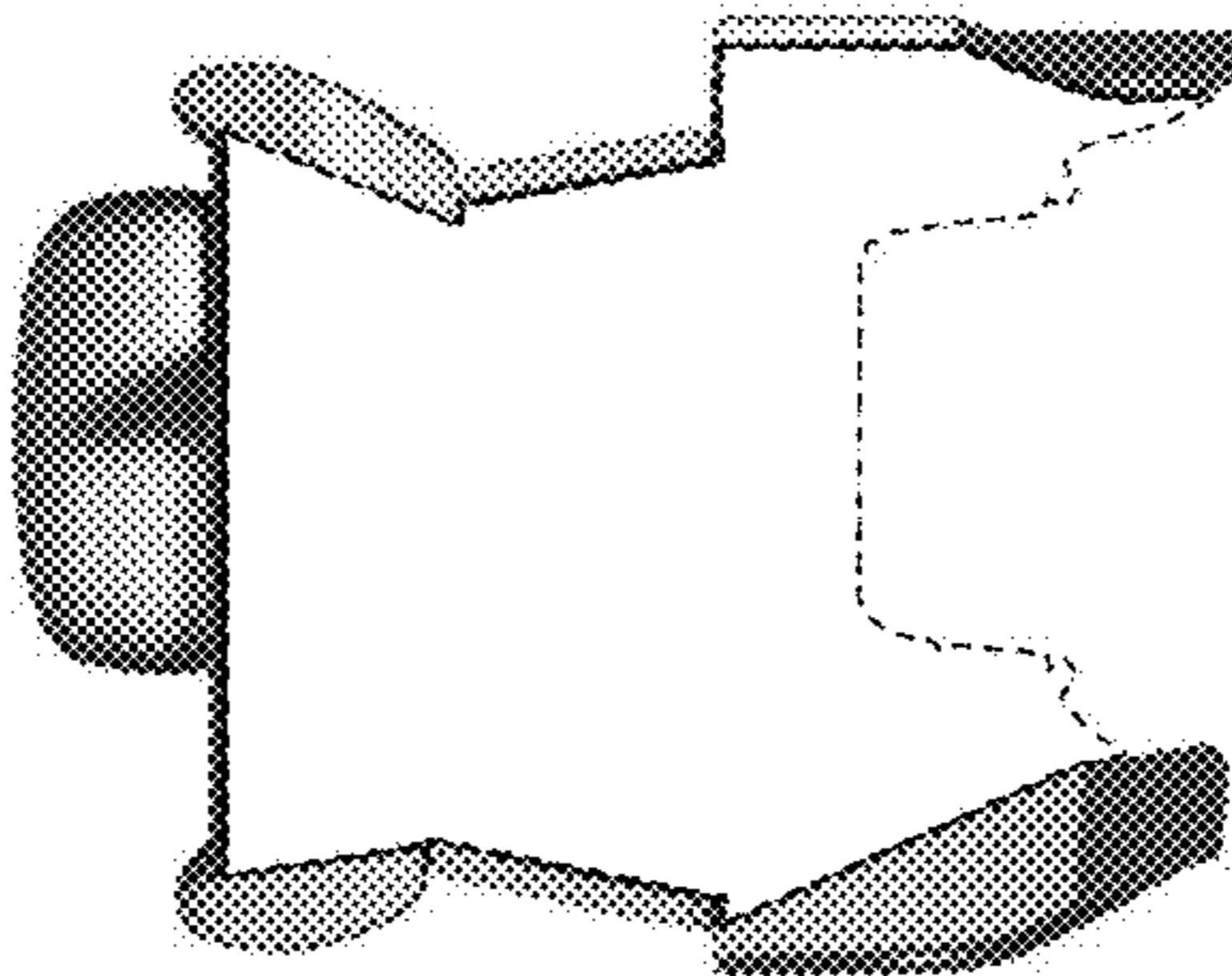

FIG. 5

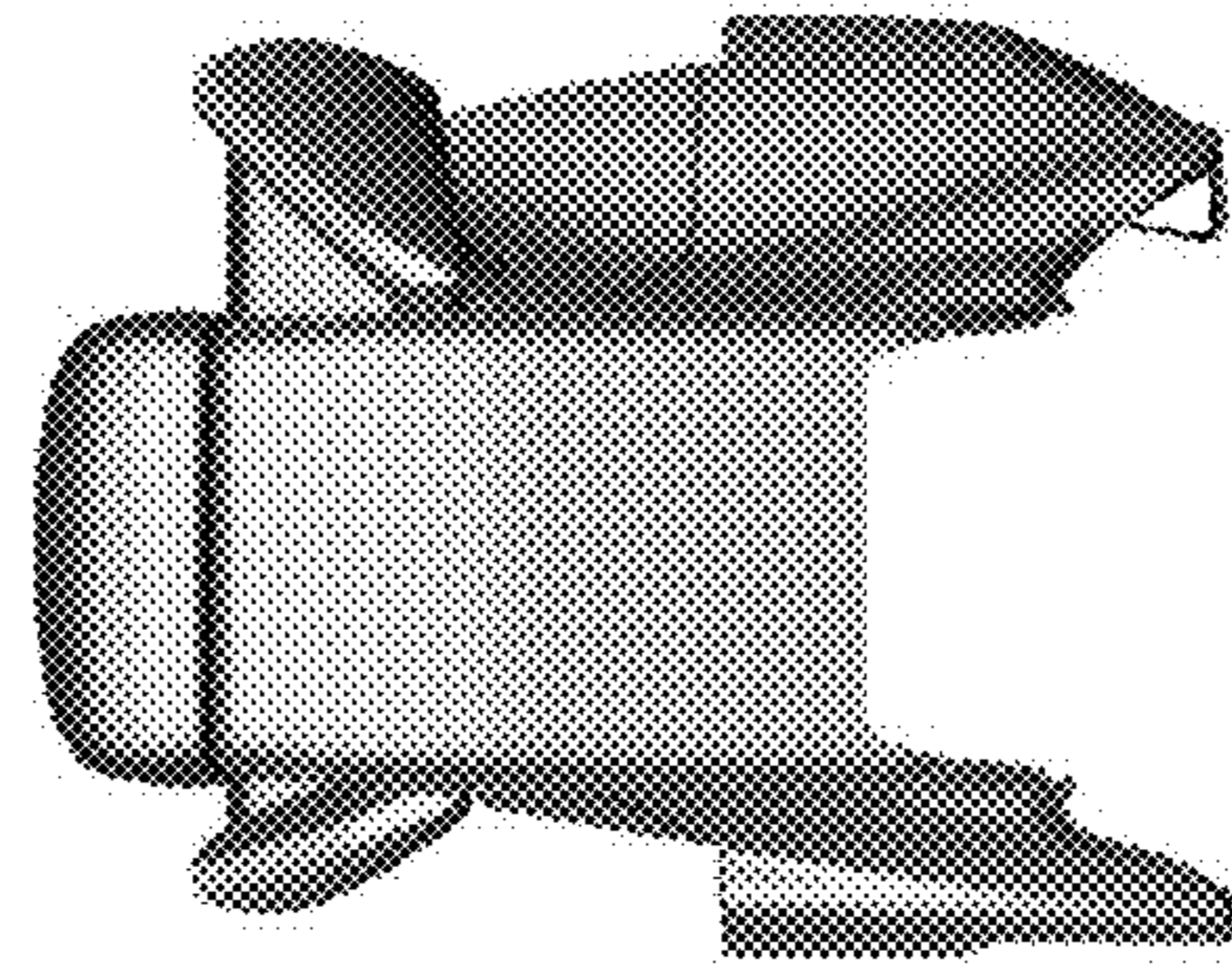

FIG. 6



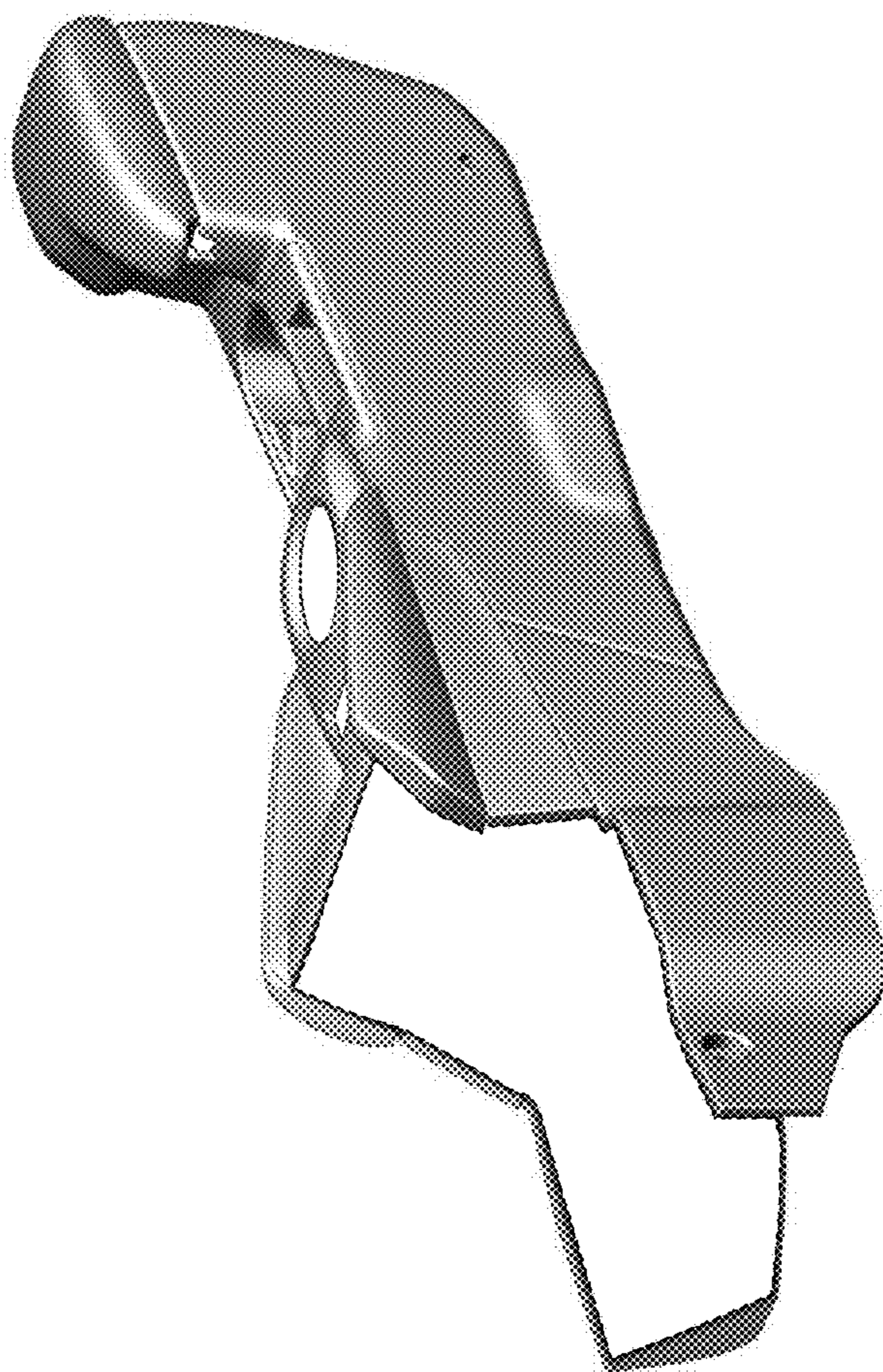

FIG. 7



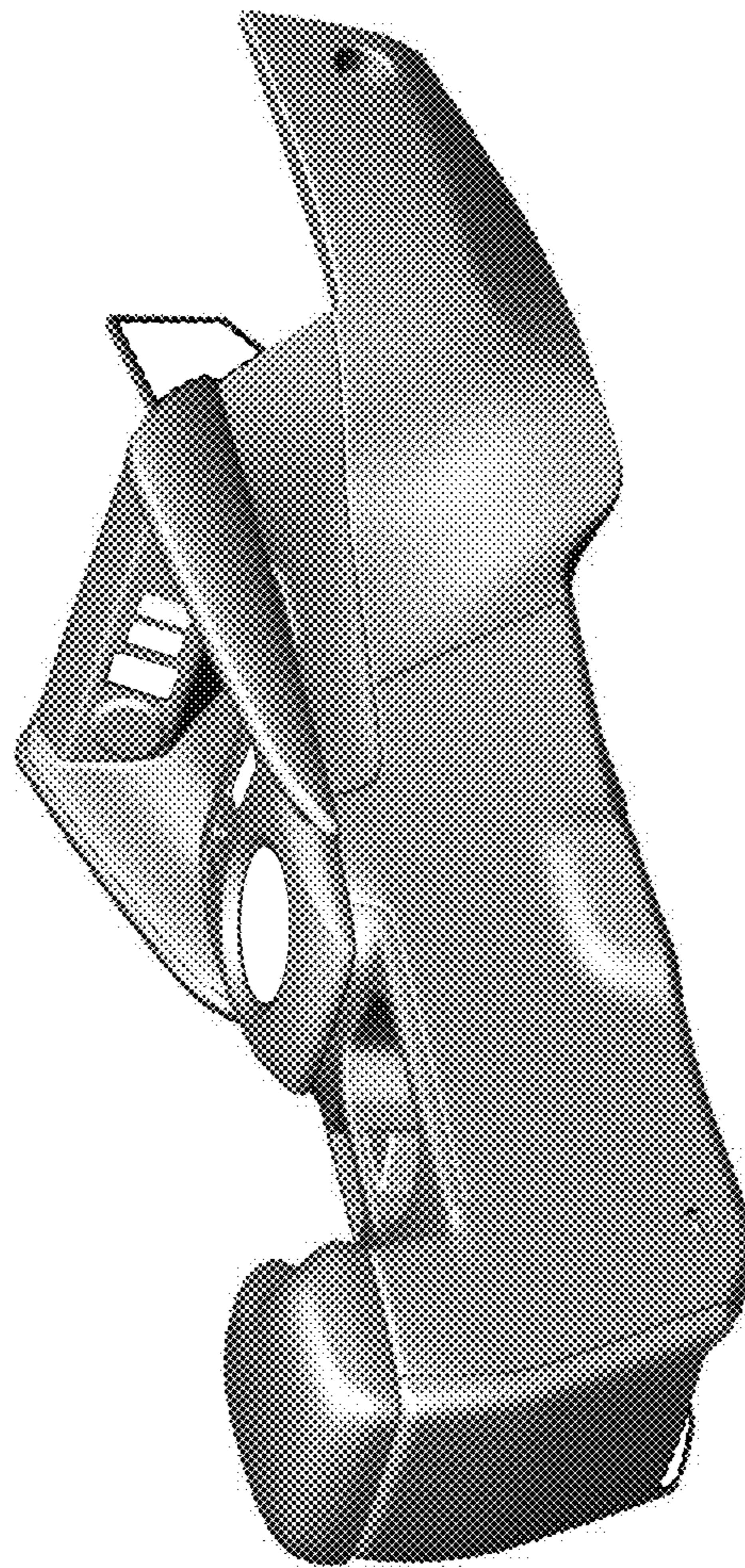

FIG. 8