



US00D868825S

(12) **United States Design Patent** (10) **Patent No.:** **US D868,825 S**
Paulik et al. (45) **Date of Patent:** **** Dec. 3, 2019**

- (54) **DISPLAY SCREEN WITH A GRAPHICAL USER INTERFACE**
- (71) Applicant: **Gamblit Gaming, LLC**, Glendale, CA (US)
- (72) Inventors: **Mark Paulik**, Wyoming, MI (US);
Edvard Toth, Santa Monica, CA (US)
- (73) Assignee: **Gamblit Gaming, LLC**, Glendale, CA (US)
- (**) Term: **15 Years**
- (21) Appl. No.: **29/622,879**
- (22) Filed: **Oct. 20, 2017**
- (51) **LOC (12) Cl.** **14-04**
- (52) **U.S. Cl.**
USPC **D14/488**; D14/486
- (58) **Field of Classification Search**
USPC D14/485–495
CPC A63F 2001/001; G06F 3/04847; G06F 3/0485; G06F 3/048; G06F 3/0488; H04N 1/00477
See application file for complete search history.

- D738,913 S * 9/2015 Cabrera-Cordon D14/491
- D766,297 S * 9/2016 Kim D14/486
- D772,930 S * 11/2016 Vazquez D14/489
- D773,531 S * 12/2016 Toth D14/491
- D781,880 S * 3/2017 Jeon D14/485
- 9,818,260 B2 * 11/2017 Arnone G07F 17/3227
- D817,981 S * 5/2018 Gofberg D14/486
- D819,663 S * 6/2018 Sharp D14/485
- D823,888 S * 7/2018 Toth D14/488
- 2015/0199868 A1 * 7/2015 Kelly G07F 17/3225
463/25
- 2016/0260287 A1 * 9/2016 Baron G07F 17/3244

* cited by examiner

Primary Examiner — Darlington Ly
Assistant Examiner — Katherine A Holbrow
(74) *Attorney, Agent, or Firm* — Caitlyn Ross

(57) **CLAIM**

The ornamental design for a display screen with a graphical user interface, as shown and described.

DESCRIPTION

FIG. 1 is a front view of a first embodiment of a display screen with a graphical user interface, showing our new design;
FIG. 2 is a front view of a second embodiment of a display screen with a graphical user interface, showing our new design; and,
FIG. 3 is a front view of a third embodiment of a display screen with a graphical user interface, showing our new design.
The outermost dual set of broken lines, outer circular features, and rounded rectangle illustrate an electronic device. The outermost broken line rectangle with square corners illustrates a display screen. The broken lines within the display screen illustrate portions of the graphical user interface. None of the broken line subject matters form part of the claimed design.

1 Claim, 3 Drawing Sheets

(56) **References Cited**

U.S. PATENT DOCUMENTS

- D416,550 S * 11/1999 Richter D14/489
- D452,692 S * 1/2002 Fukuda D14/489
- D481,041 S * 10/2003 Segal D14/486
- D500,047 S * 12/2004 Sevdermish D14/486
- D507,577 S * 7/2005 Totten D14/486
- D585,905 S * 2/2009 Hosokawa D14/485
- D591,305 S * 4/2009 Shimoda D14/485
- D595,727 S * 7/2009 Koes D14/485
- D628,584 S * 12/2010 Umezawa D14/489
- D667,451 S * 9/2012 Wujcik D14/492
- D678,307 S * 3/2013 Kanalakakis, Jr. D14/486
- D707,700 S * 6/2014 d'Amore D14/487

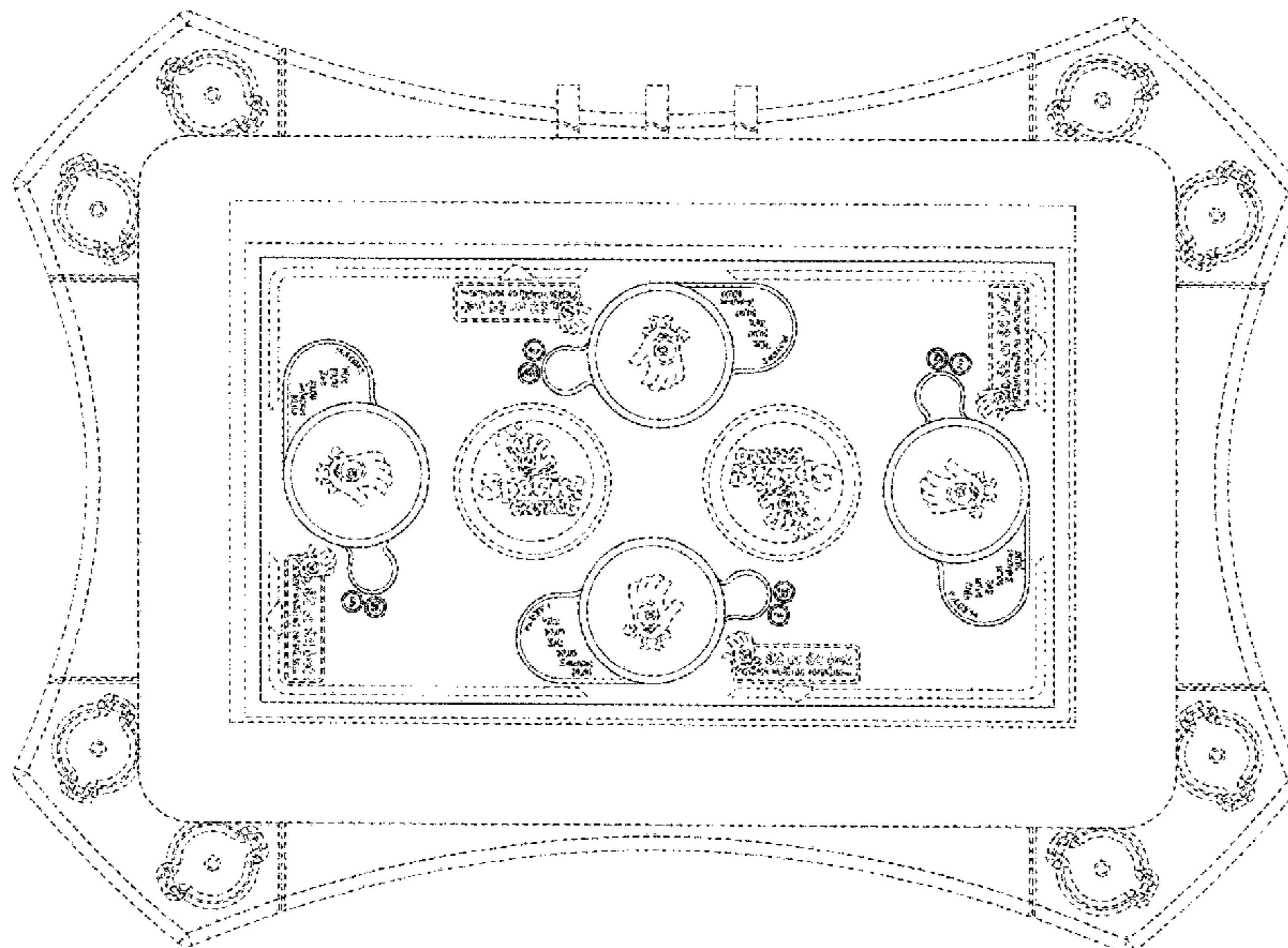

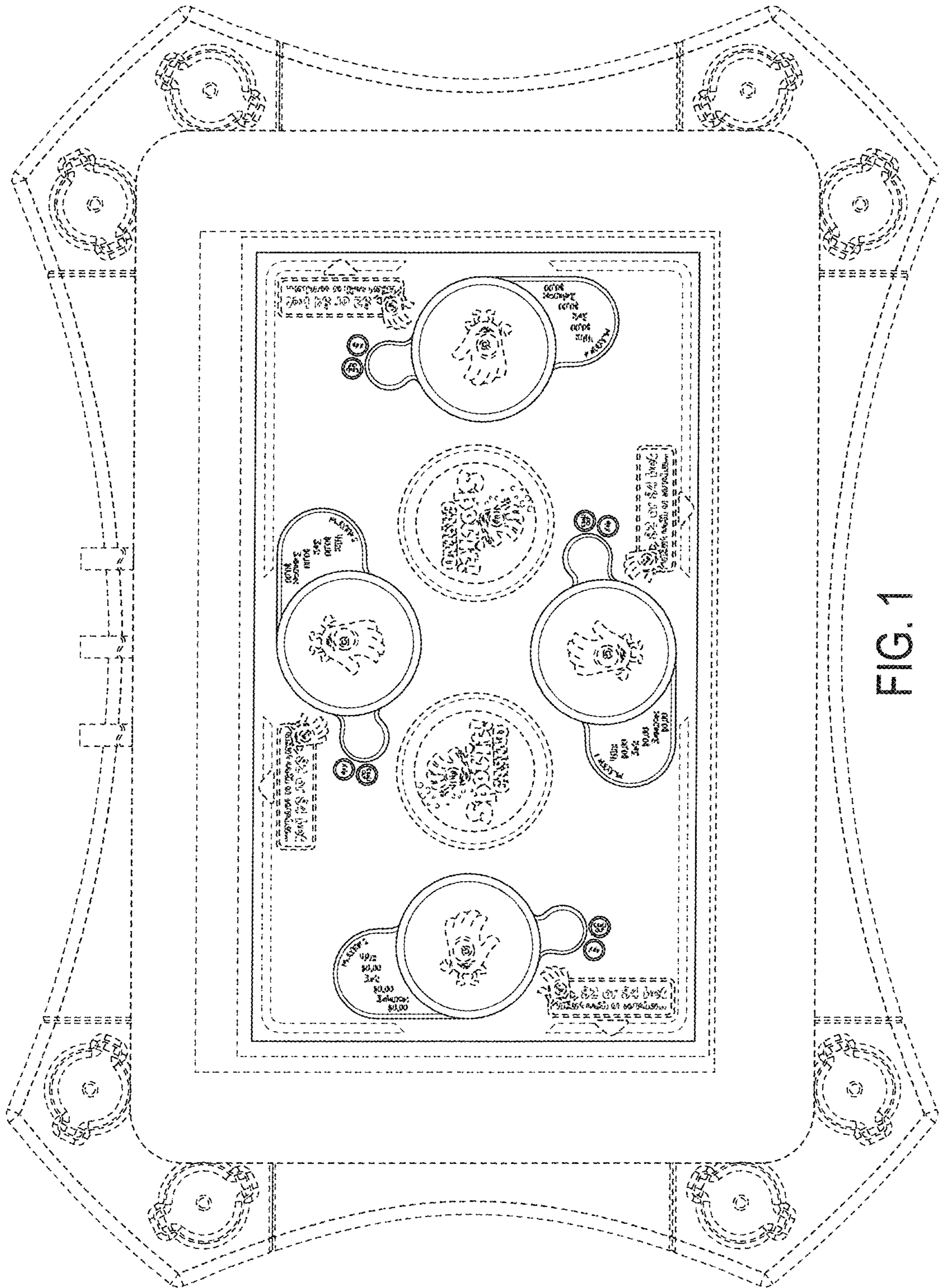

FIG. 1

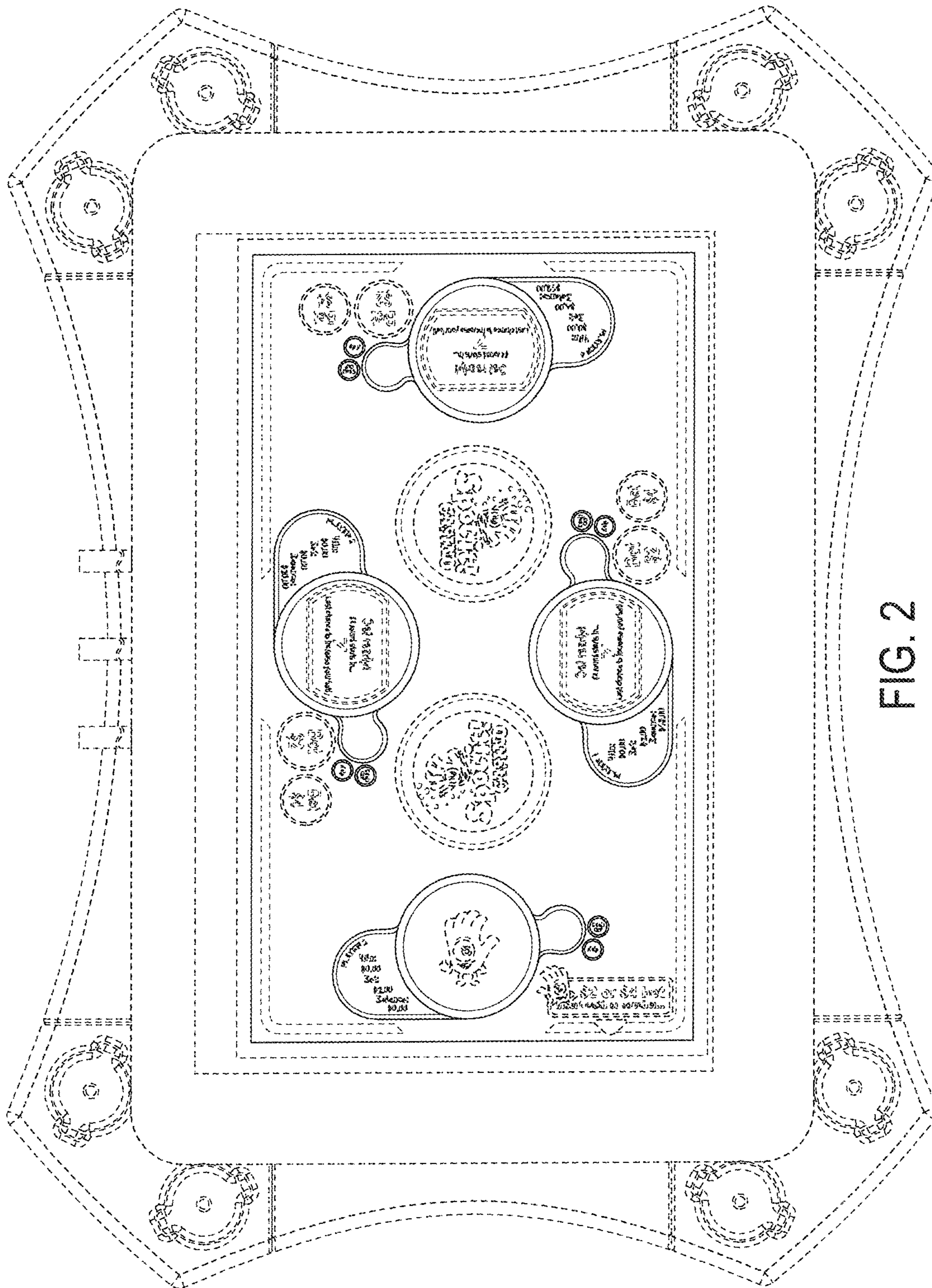

FIG. 2

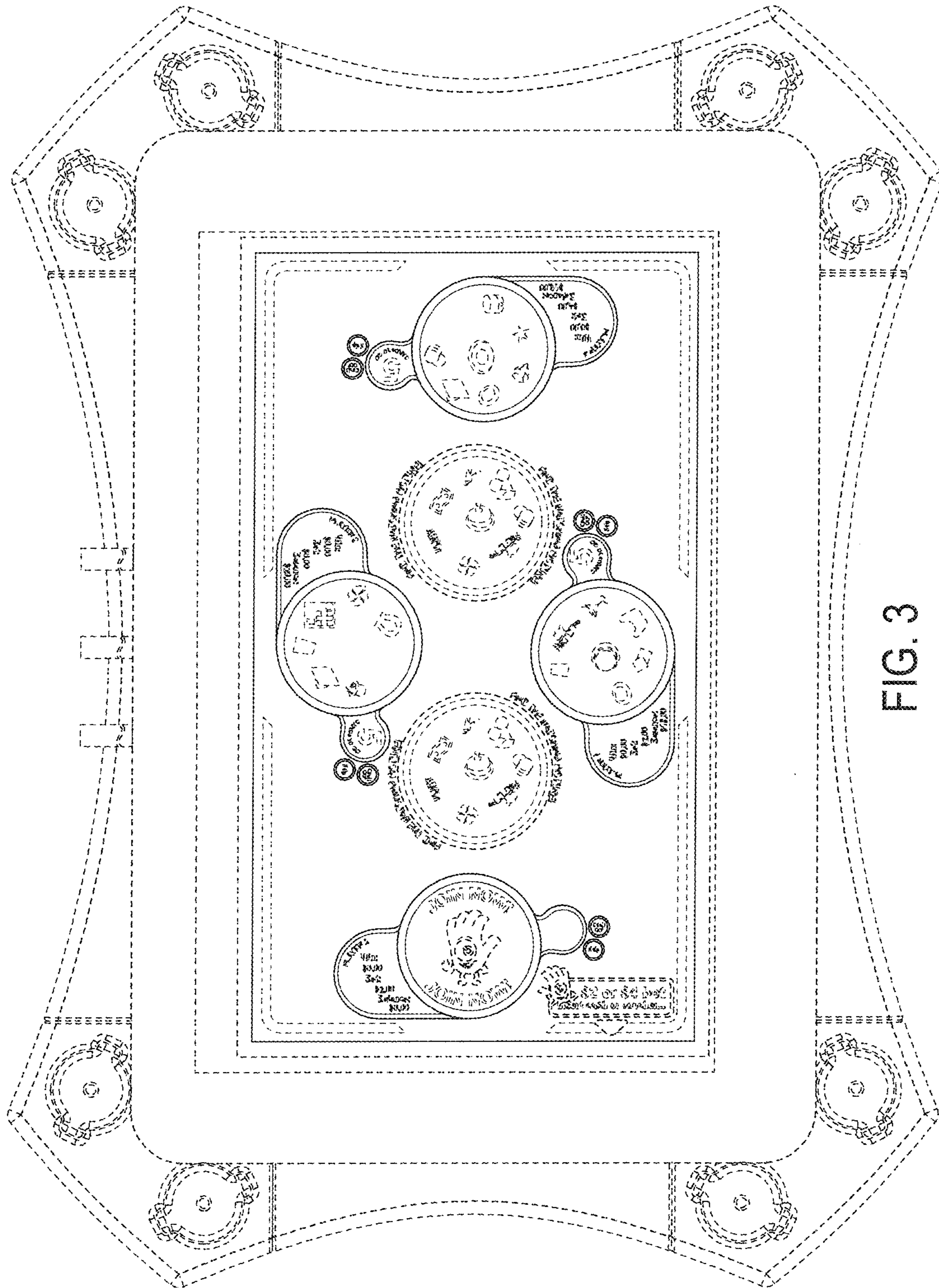

FIG. 3