

US00D867465S

(12) **United States Design Patent**  
**Francis**

(10) **Patent No.:** **US D867,465 S**

(45) **Date of Patent:** **\*\* Nov. 19, 2019**

(54) **ALPHANUMERIC GAME TILE**

(71) Applicant: **Raymond Lovell Francis**, Tallahassee,  
FL (US)

(72) Inventor: **Raymond Lovell Francis**, Tallahassee,  
FL (US)

(\*\*) Term: **15 Years**

(21) Appl. No.: **29/651,749**

(22) Filed: **Feb. 25, 2019**

(51) **LOC (12) Cl.** ..... **21-03**

(52) **U.S. Cl.**  
USPC ..... **D21/386**

(58) **Field of Classification Search**  
USPC ..... D21/386  
See application file for complete search history.

(56) **References Cited**

U.S. PATENT DOCUMENTS

D771,751 S \* 11/2016 Moscatelli ..... D21/386  
D772,344 S \* 11/2016 Moscatelli ..... D21/386

D795,352 S \* 8/2017 Moscatelli ..... D21/386  
D799,603 S \* 10/2017 Wang ..... D21/386  
D799,604 S \* 10/2017 Wang ..... D21/386  
D802,680 S \* 11/2017 Moscatelli ..... D21/386

\* cited by examiner

*Primary Examiner* — George D. Kirschbaum

(57) **CLAIM**

The ornamental design for a alphanumeric game tile.

**DESCRIPTION**

FIG. 1 is a perspective view of the tile; and,  
FIG. 2 is a top view of the tile.  
A notched/slotted tile that is imprinted with alphanumeric  
indicia.

**1 Claim, 1 Drawing Sheet**

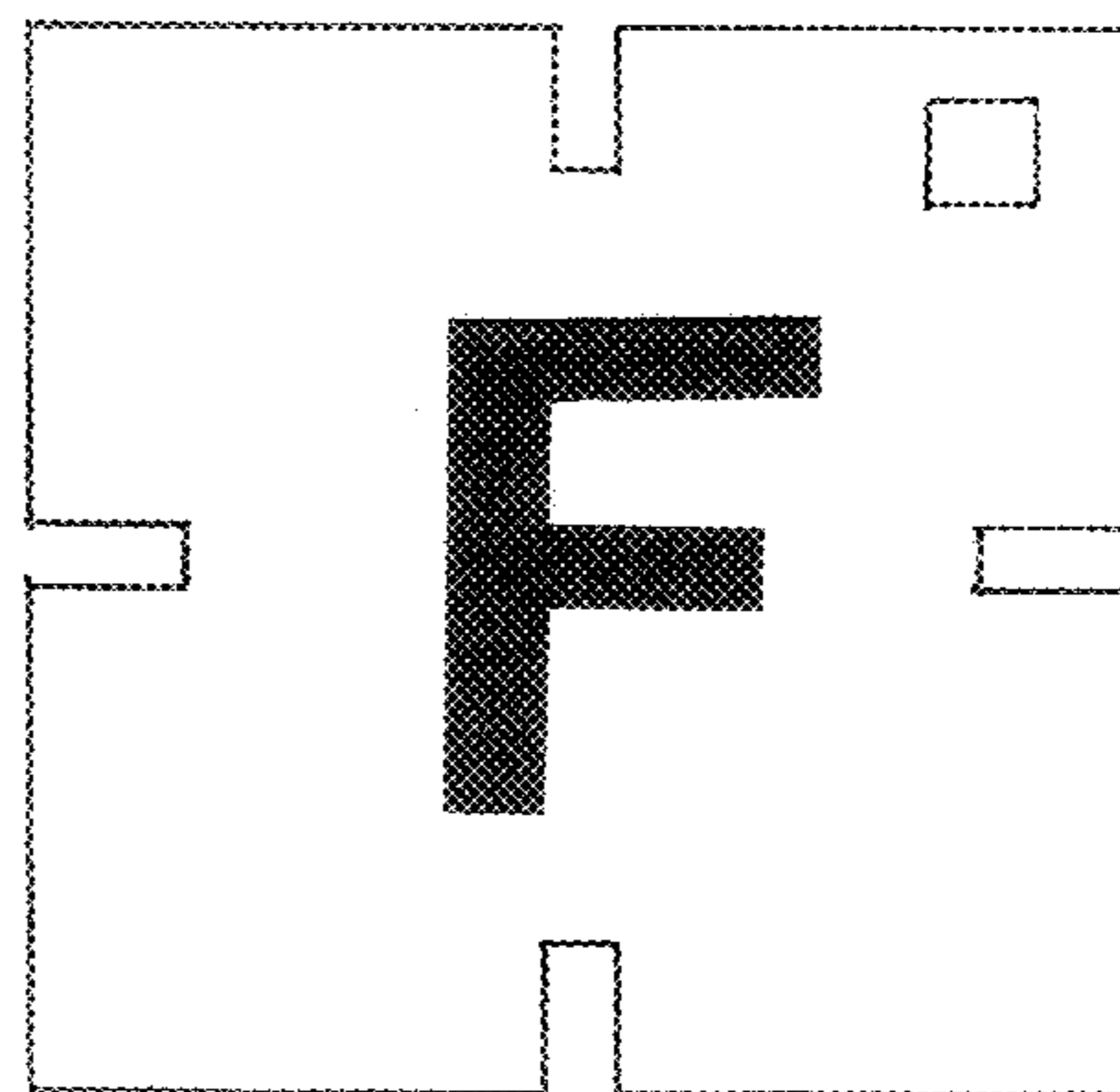
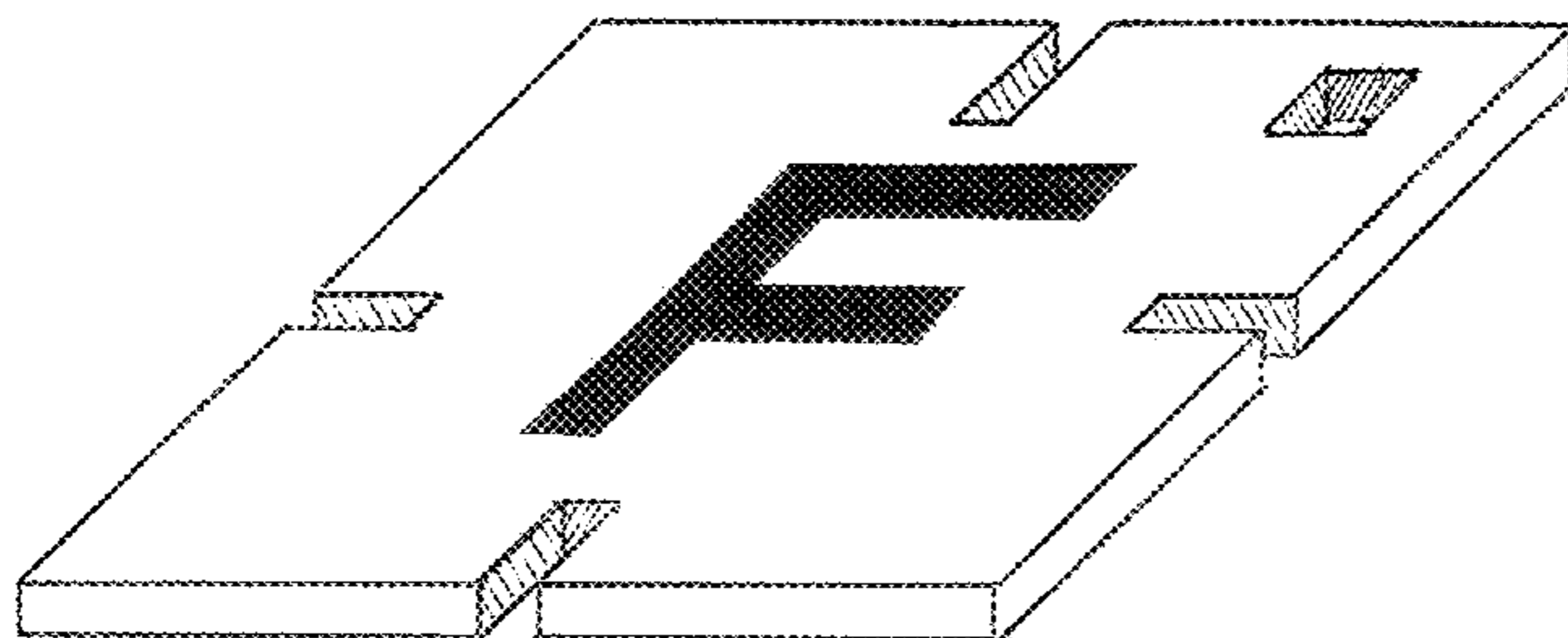

Fig. 1

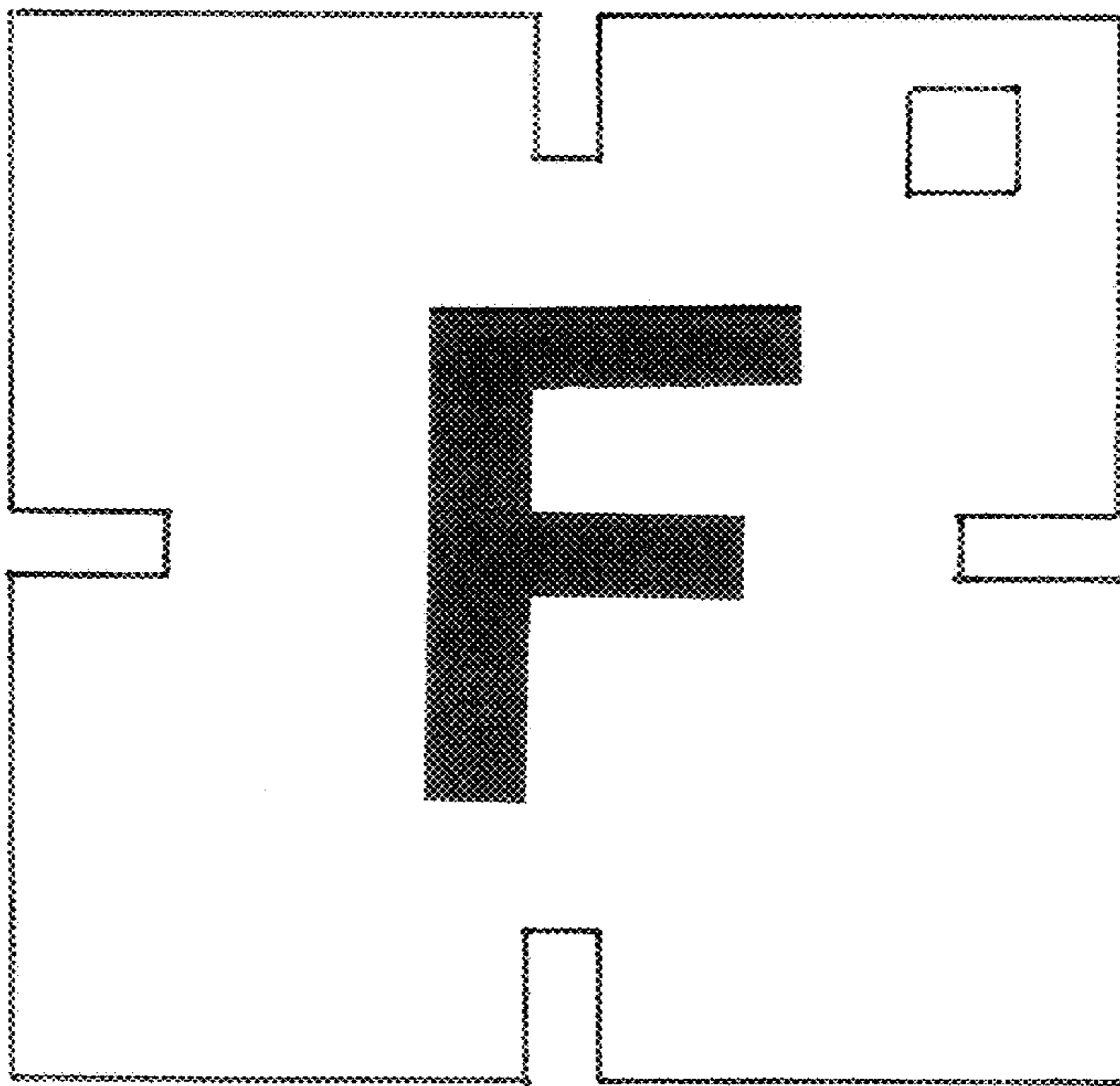
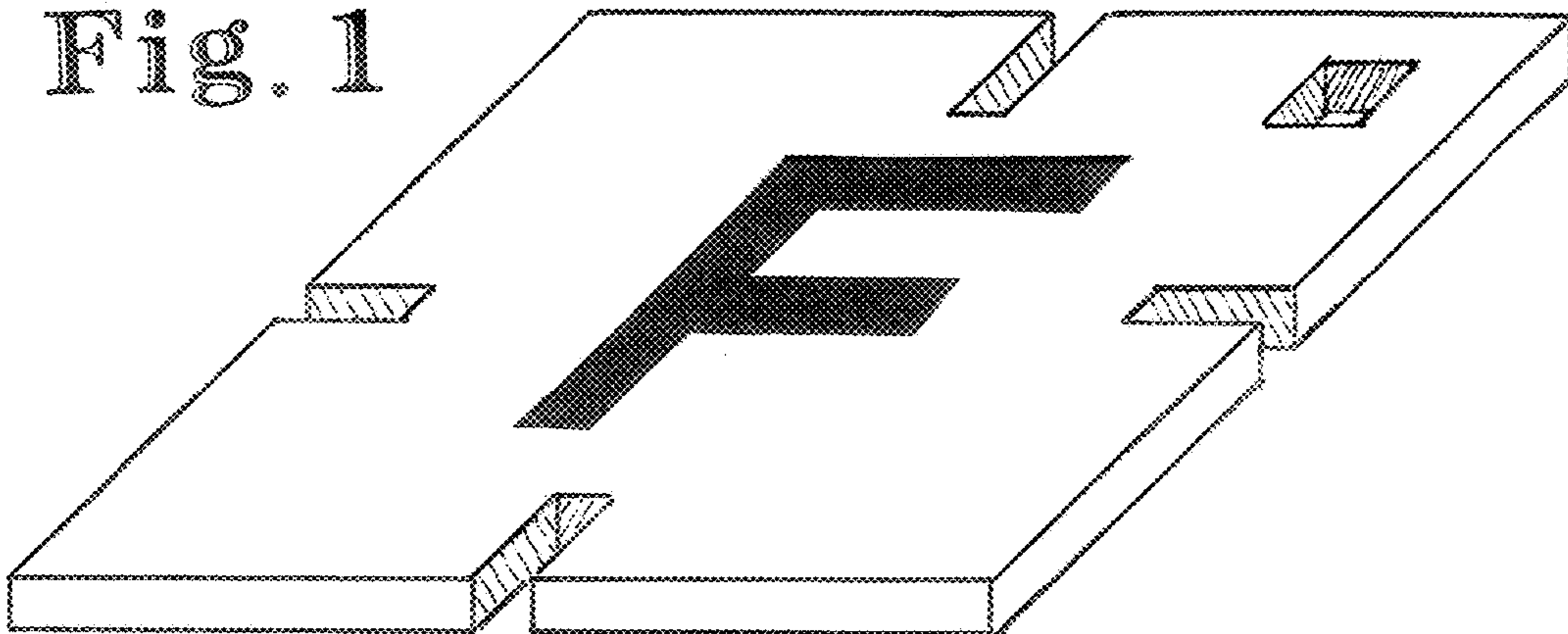

Fig. 2