



US00D866579S

(12) **United States Design Patent** (10) **Patent No.:** **US D866,579 S**
Kwon (45) **Date of Patent:** **** Nov. 12, 2019**

(54) **DISPLAY SCREEN OR PORTION THEREOF WITH GRAPHICAL USER INTERFACE**

D716,343 S 10/2014 Baumann et al.
D728,615 S * 5/2015 Guzman et al. D14/489
D729,270 S * 5/2015 Clare D14/486

(71) Applicant: **SAMSUNG ELECTRONICS CO., LTD.**, Suwon-si, Gyeonggi-do (KR)

(Continued)

(72) Inventor: **Wujong Kwon**, Seoul (KR)

FOREIGN PATENT DOCUMENTS

(73) Assignee: **SAMSUNG ELECTRONICS CO., LTD.**, Gyeonggi-Do (KR)

EM 002504340-0008 7/2014
KR 300512979 S 11/2008
KR 300560390 S 5/2010

(**) Term: **15 Years**

OTHER PUBLICATIONS

(21) Appl. No.: **29/633,112**

Creative Stall, Design, Printing and Modeling 1, Jun 2, 2016, iconfinder.com.pdf, iconswebsite.com [online], [site visited Feb. 11, 2019]. Available from Internet: <https://www.iconfinder.com/iconsets/design-printing-and-modeling-1-1> (Year: 2016).*

(22) Filed: **Jan. 12, 2018**

(30) **Foreign Application Priority Data**

Aug. 22, 2017 (KR) 30-2017-0038974

Primary Examiner — Darlington Ly

Assistant Examiner — Katherine A Holbrow

(51) **LOC (12) Cl.** **14-04**

(74) *Attorney, Agent, or Firm* — Cantor Colburn LLP

(52) **U.S. Cl.**
USPC **D14/486**; D14/489

(57) **CLAIM**

(58) **Field of Classification Search**
USPC D14/485–495
CPC .. G06F 3/0481; G06F 3/04817; G06F 3/0482;
G06F 3/04842; G06F 3/0486
See application file for complete search history.

The ornamental design for a display screen or portion thereof with graphical user interface, as shown and described.

DESCRIPTION

(56) **References Cited**

U.S. PATENT DOCUMENTS

D590,415 S * 4/2009 Ball D14/486
D593,571 S * 6/2009 Ball D14/485
D607,008 S * 12/2009 Kocmick D14/489
D613,301 S * 4/2010 Lee D14/489
D629,814 S * 12/2010 Lew D14/492
D642,196 S * 7/2011 Fong D14/492
D646,297 S * 10/2011 McLaughlin D14/488
D696,285 S * 12/2013 Hally D14/487
D708,210 S * 7/2014 Capua D14/488
8,839,106 B2 * 9/2014 Lee G06F 3/0481
345/418

FIG. 1 is a front view of a first embodiment of a display screen or portion thereof with graphical user interface, showing my new design;

FIG. 2 is a front view of a second embodiment thereof;

FIG. 3 is a front view of a third embodiment thereof;

FIG. 4 is a front view of a fourth embodiment thereof;

FIG. 5 is a front view of a fifth embodiment thereof; and,

FIG. 6 is a front view of a sixth embodiment thereof.

The outer broken lines in FIGS. 1-6 depict a display screen or portion thereof and form no part of the claimed design.

The remainder of the broken lines in the figures depict portions of the graphical user interface that form no part of the claimed design.

1 Claim, 6 Drawing Sheets

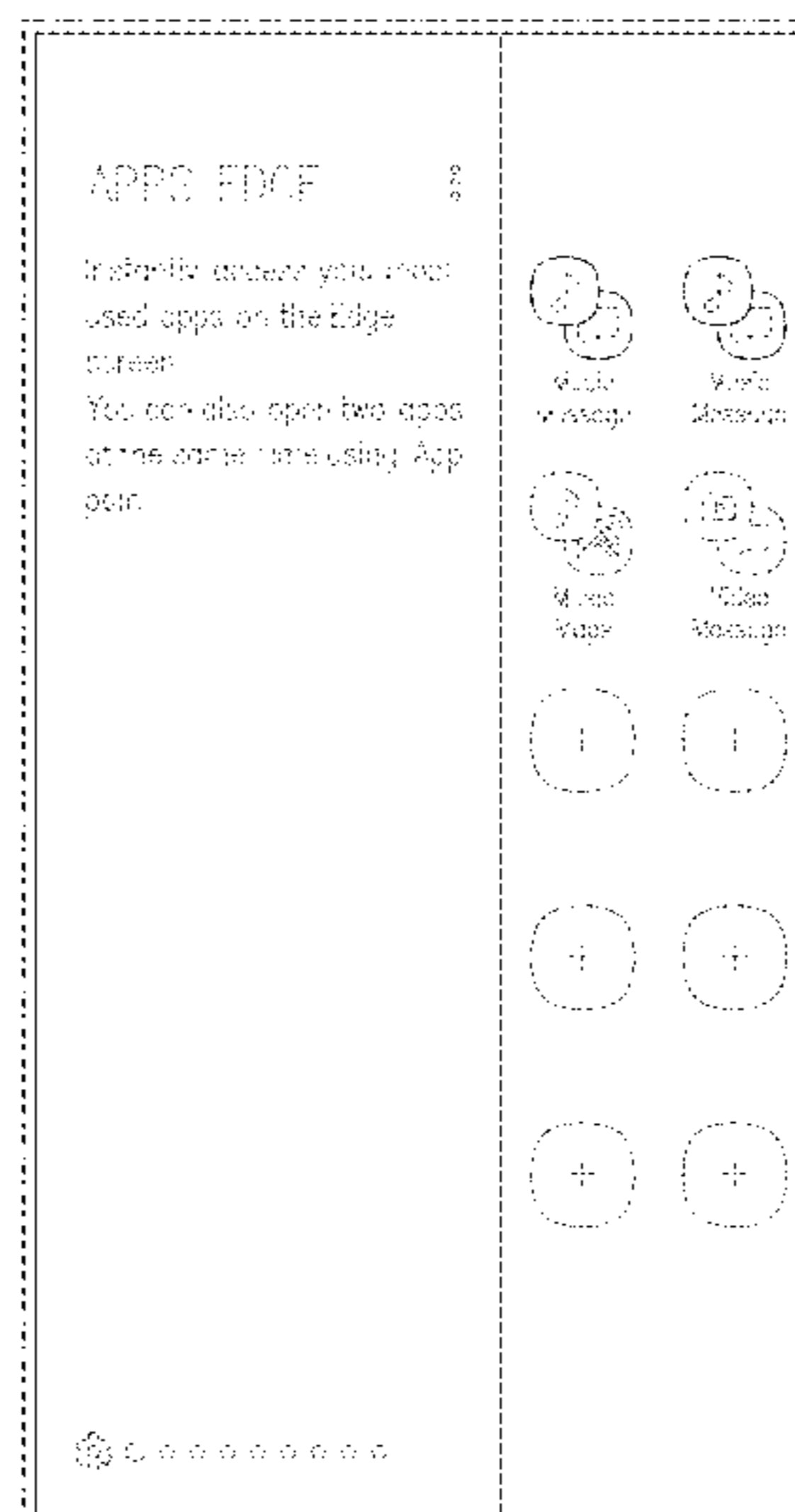

(56)

References Cited

U.S. PATENT DOCUMENTS

D731,532 S * 6/2015 Kim D14/488
 D737,279 S * 8/2015 Taniuchi D14/485
 D743,986 S * 11/2015 Pan D14/486
 D744,528 S * 12/2015 Agrawal D14/488
 D745,023 S * 12/2015 Kwon D14/486
 D745,895 S * 12/2015 Clare D14/495
 D758,380 S * 6/2016 Park D14/485
 D760,250 S * 6/2016 Myung D14/485
 D760,274 S * 6/2016 Haitani D14/488
 D765,099 S * 8/2016 Kim D14/485
 D772,936 S * 11/2016 Ryono D14/491
 D775,649 S * 1/2017 Anzures D14/486
 D776,150 S * 1/2017 Paulik D14/487
 D777,753 S * 1/2017 Matsuguma D14/486
 D778,941 S * 2/2017 Coffman D14/486
 D778,942 S * 2/2017 Coffman D14/486
 D779,544 S * 2/2017 Paulik D14/487
 D781,882 S * 3/2017 Rad D14/485
 D781,913 S * 3/2017 Vinmani D14/490
 D785,045 S * 4/2017 Coffman D14/492
 D786,903 S * 5/2017 Kim D14/486
 D788,791 S * 6/2017 Barry D14/485
 9,729,555 B2 * 8/2017 Ferguson H04L 63/104
 D797,134 S * 9/2017 Jung D14/486
 D798,334 S * 9/2017 Dye D14/489
 D800,747 S * 10/2017 Lee D14/486

D808,419 S * 1/2018 Liu D14/488
 D814,509 S * 4/2018 Coffman D14/488
 D816,103 S * 4/2018 Lim D14/486
 D816,111 S * 4/2018 Cho D14/488
 D817,998 S * 5/2018 Lee G06F 3/0416
 D14/488
 D819,058 S * 5/2018 Clediere D14/485
 D819,072 S * 5/2018 Clediere D14/487
 D820,289 S * 6/2018 Choi D14/486
 D834,060 S * 11/2018 Kim D14/488
 D836,132 S * 12/2018 Coffman D14/488
 2007/0035513 A1 * 2/2007 Sherrard G06F 3/04817
 345/157
 2008/0168353 A1 * 7/2008 Anzures G06F 3/04886
 715/716
 2010/0120470 A1 * 5/2010 Kim G06F 1/1615
 455/566
 2012/0030623 A1 * 2/2012 Hoellwarth G06F 3/04817
 715/811
 2014/0068516 A1 * 3/2014 Escobedo G06F 3/04817
 715/835
 2014/0125589 A1 * 5/2014 Kim G06F 3/033
 345/157
 2014/0149903 A1 * 5/2014 Ahn G06F 3/0488
 715/765
 2014/0325439 A1 * 10/2014 Sohn G06F 3/04845
 715/810
 2017/0332221 A1 * 11/2017 LeBeau H04L 67/306

* cited by examiner

FIG. 1

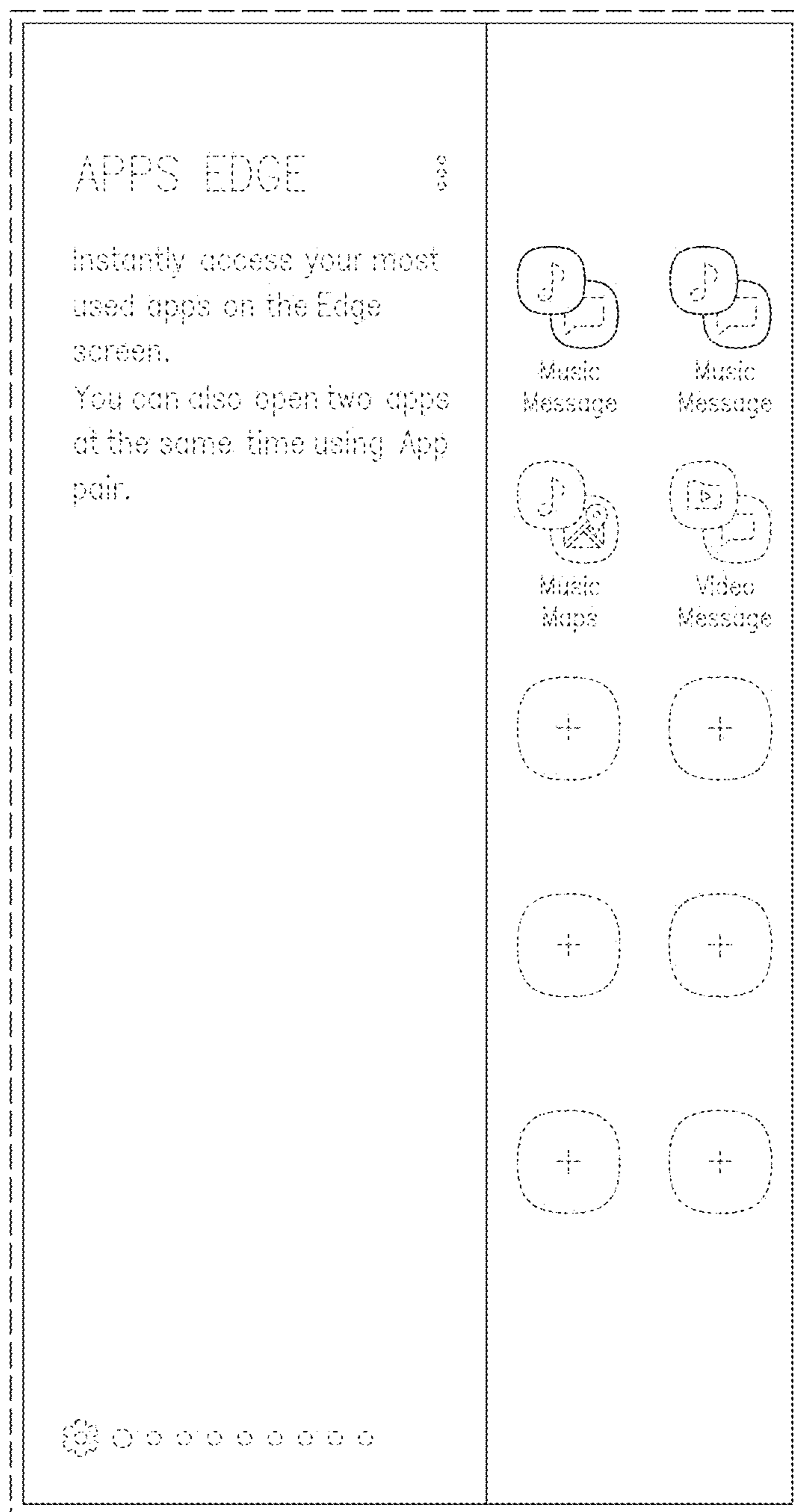

FIG. 2

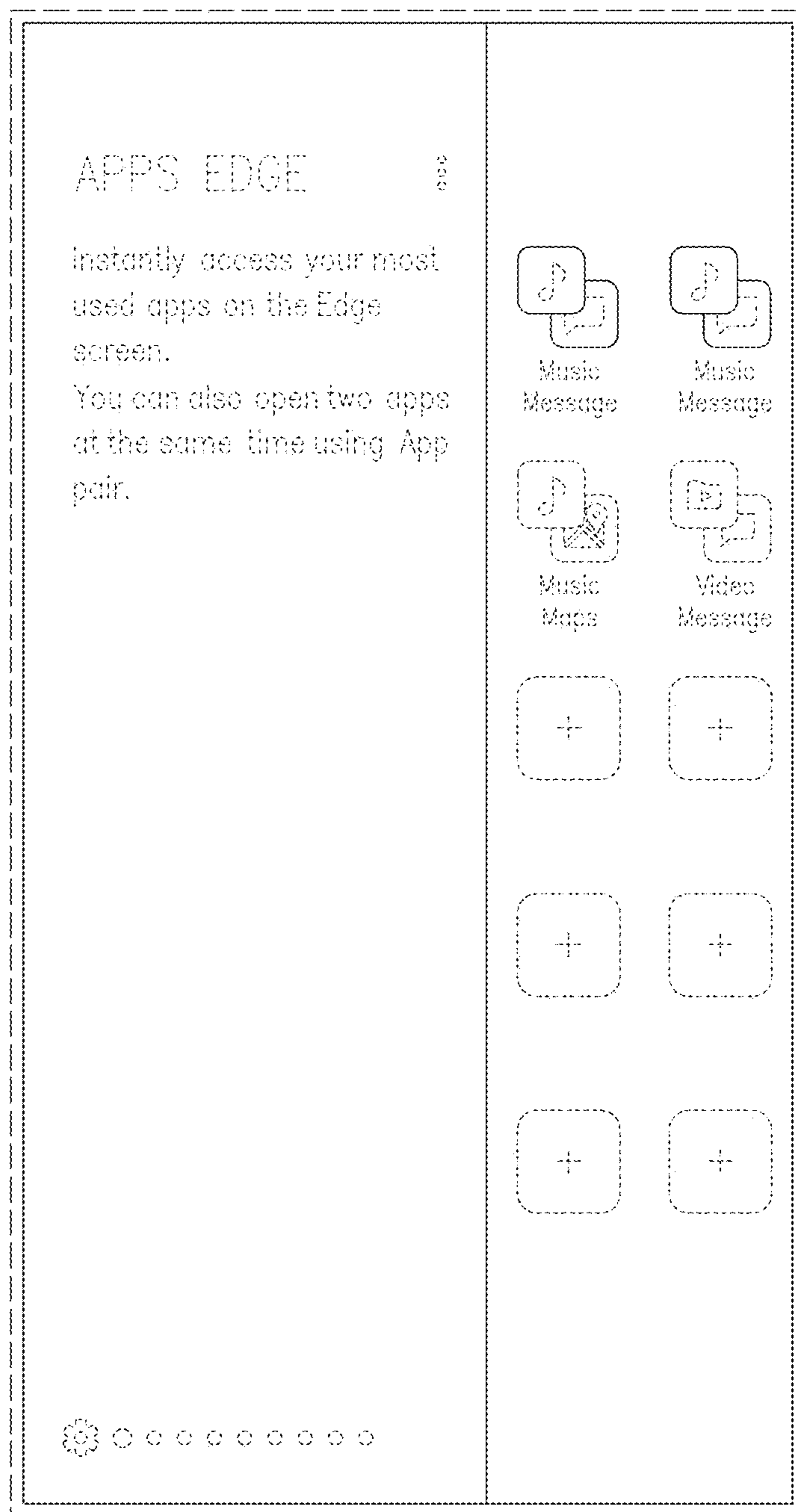

FIG. 3

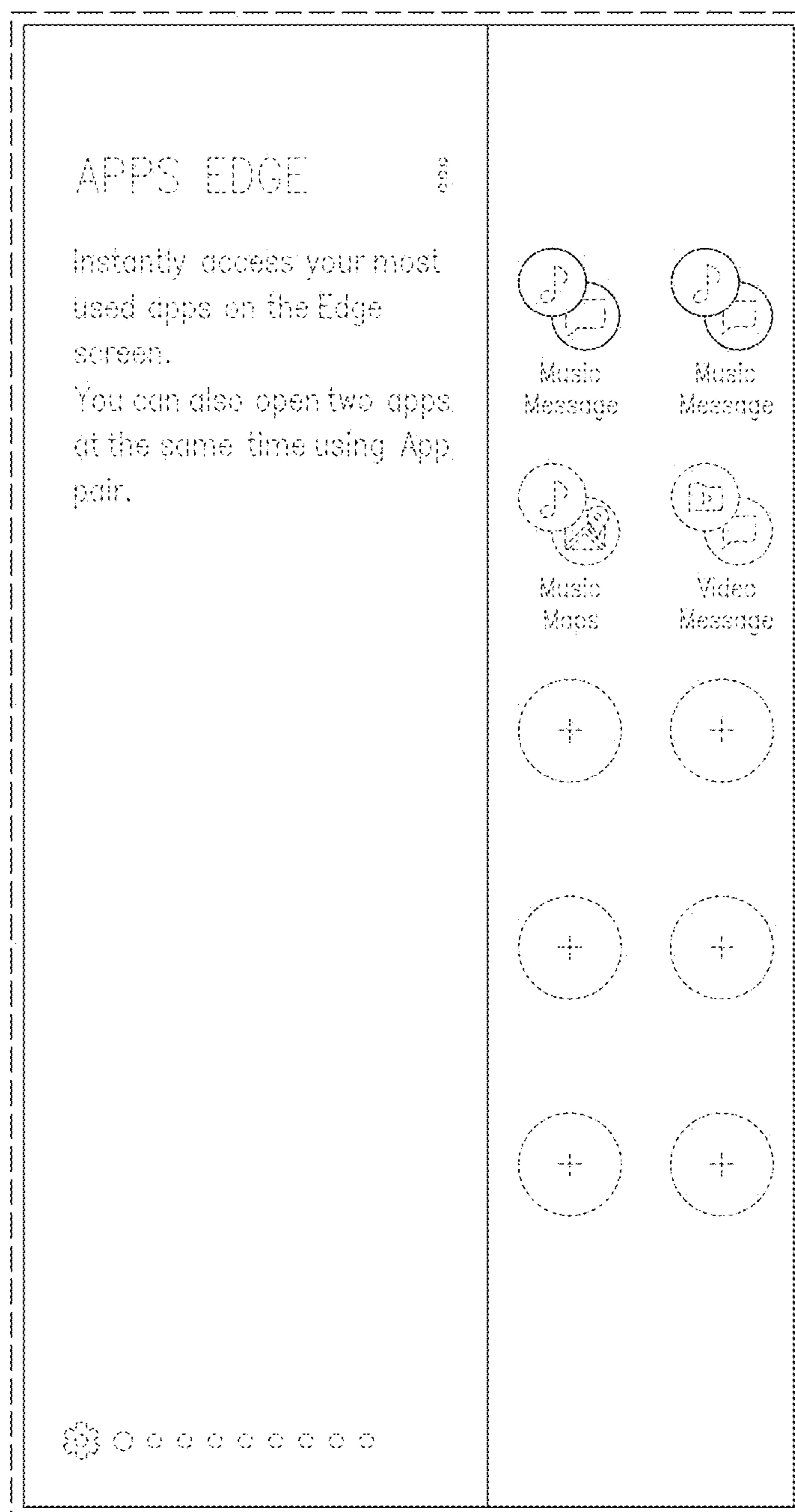

FIG. 4

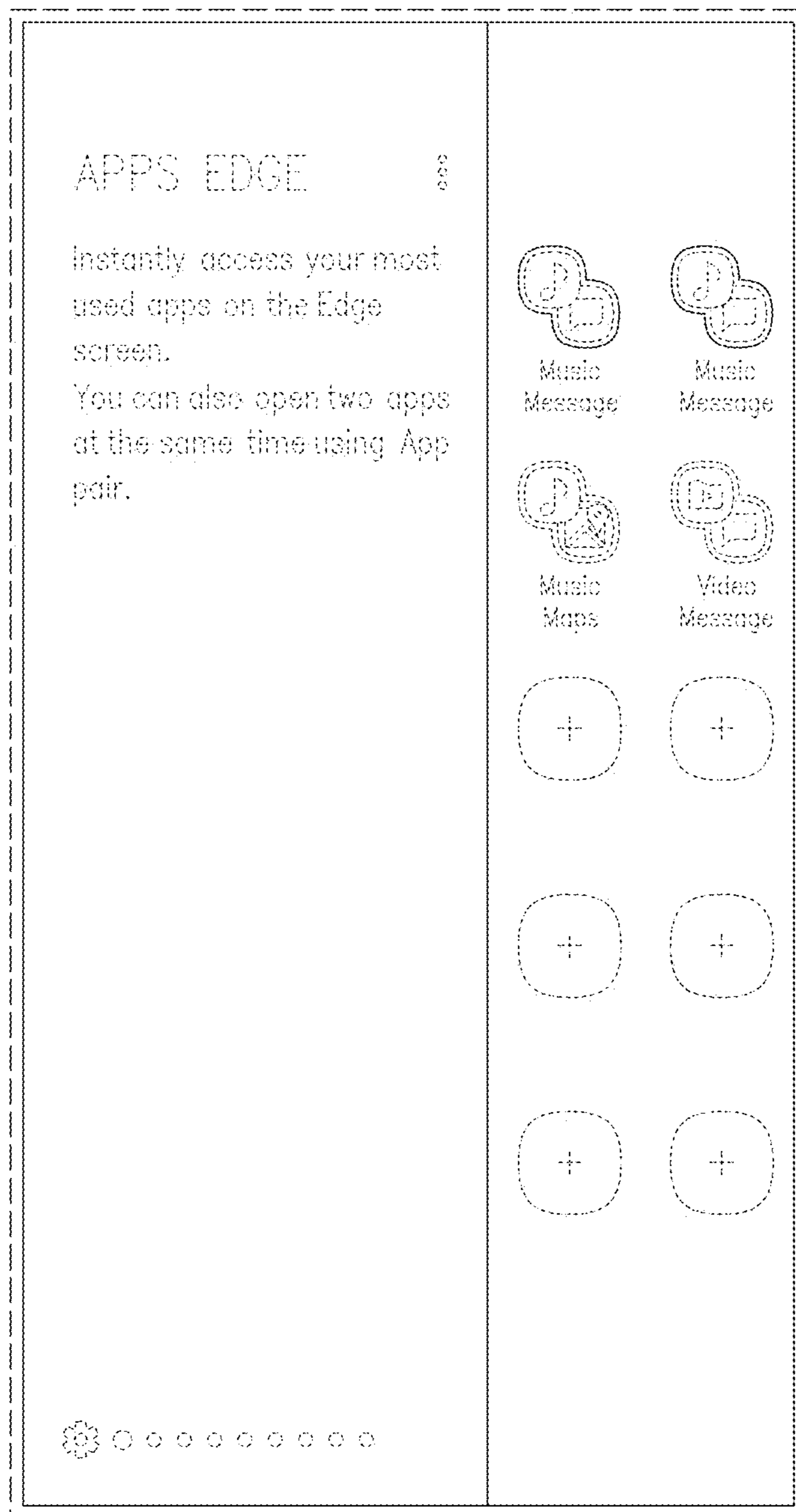

FIG. 5

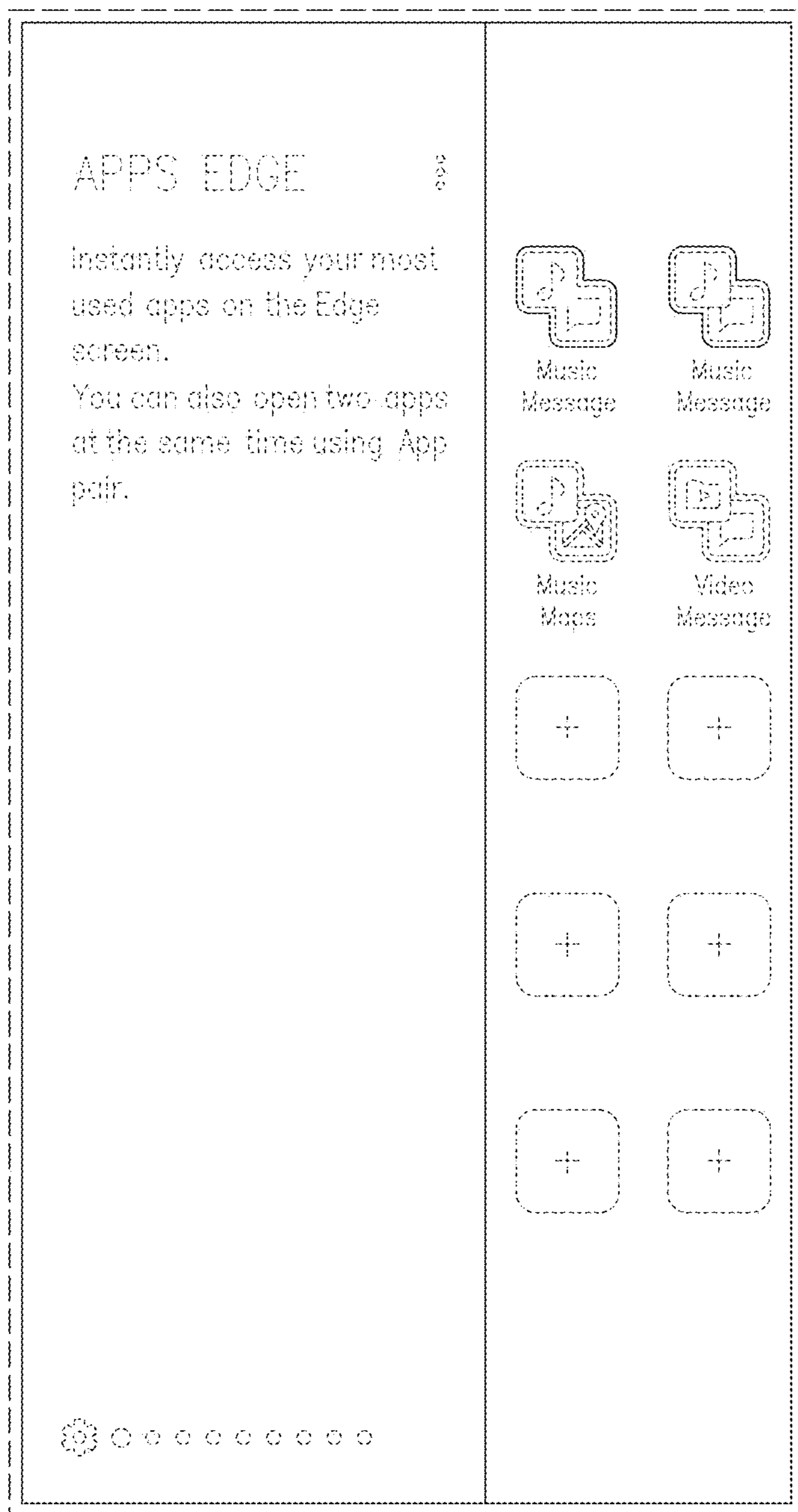

FIG. 6

