



US00D864599S

(12) **United States Design Patent**
Yamamoto

(10) **Patent No.:** **US D864,599 S**
(45) **Date of Patent:** **** Oct. 29, 2019**

(54) **PARTITION PANEL**

(71) Applicant: **Okamura Corporation**, Yokohama-shi,
Kanagawa (JP)

(72) Inventor: **Takayuki Yamamoto**, Yokohama (JP)

(73) Assignee: **Okamura Corporation**, Yokohama-shi,
Kanagawa (JP)

(**) Term: **15 Years**

(21) Appl. No.: **29/641,926**

(22) Filed: **Mar. 26, 2018**

(30) **Foreign Application Priority Data**

Sep. 27, 2017 (JP) 2017-021119

(51) **LOC (12) Cl.** **06-06**

(52) **U.S. Cl.**
USPC **D6/332**

(58) **Field of Classification Search**
USPC D6/332, 383, 406.1, 406.2, 642, 643.1,
D6/644, 672, 673, 713, 714, 653.14,
D6/653.21, 654.14, 654.21, 655.14,
D6/655.21, 656.16, 688.14, 688.26,
D6/688.27, 691.5, 695.3, 696.2, 708.22,
D6/708.23, 710, 711, 708; 160/351
CPC A47B 2200/01; A47B 2200/12; A47B
2200/0071; A47B 2220/0058; A47B
2220/13; A47B 83/001; A47B 91/02;
A47B 91/022; A47B 91/024; A47B
91/026; A47B 91/028; A47B 91/16; A47B
2200/0027; A47B 2200/003; A47B
2200/0033; E04F 10/04; E04H 1/125;
E04B 2/7416; E04B 2/7422; E04B
2/7427; E04B 2/7433; A47G 5/00
See application file for complete search history.

(56) **References Cited**

U.S. PATENT DOCUMENTS

2,893,568 A * 7/1959 Scholz A47F 5/13
211/204
D200,649 S * 3/1965 Johnson et al. D6/642

D215,011 S * 8/1969 Barnes D6/644
D215,309 S * 9/1969 Barnes 108/60
D268,715 S * 4/1983 Curry D6/696.1
4,726,552 A * 2/1988 Warshawsky F21S 6/002
248/122.1
5,342,137 A * 8/1994 Peng F16C 11/04
248/122.1
D353,959 S * 1/1995 Kovacevic D6/644
D380,915 S * 7/1997 Dadabay D6/656.17

(Continued)

Primary Examiner — Kevin K Rudzinski

Assistant Examiner — Kimberly Barnes

(74) *Attorney, Agent, or Firm* — Banner & Witcoff, Ltd.

(57) **CLAIM**

The ornamental design for a partition panel, as shown and described.

DESCRIPTION

FIG. 1 is a front perspective view of a partition panel showing my new design;
FIG. 2 is a front view thereof;
FIG. 3 is a rear view thereof;
FIG. 4 is a right side view thereof, the left side view being a mirror image thereof;
FIG. 5 is a top view thereof;
FIG. 6 is a bottom view thereof;
FIG. 7 is a cross-sectional view taken along line 7-7 in FIG. 2;
FIG. 8 is an enlarged cross-sectional view taken along line 8-8 in FIG. 2; and,
FIG. 9 is an enlarged cross-sectional view taken along line 9-9 in FIG. 2.
The broken lines shown in the drawings illustrate portions of the partition panel that form no part of the claimed design.

1 Claim, 7 Drawing Sheets

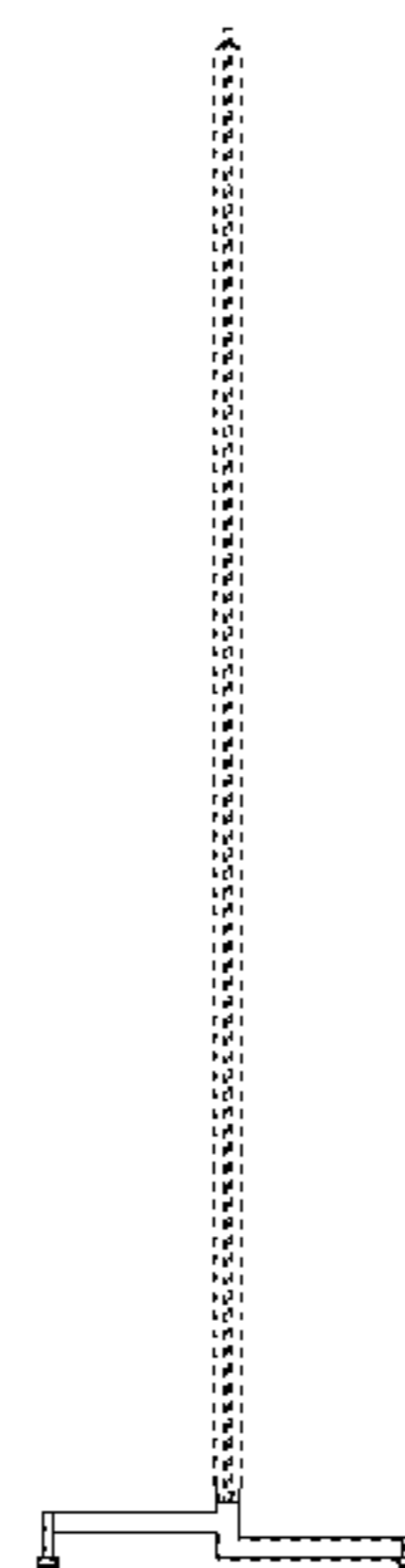
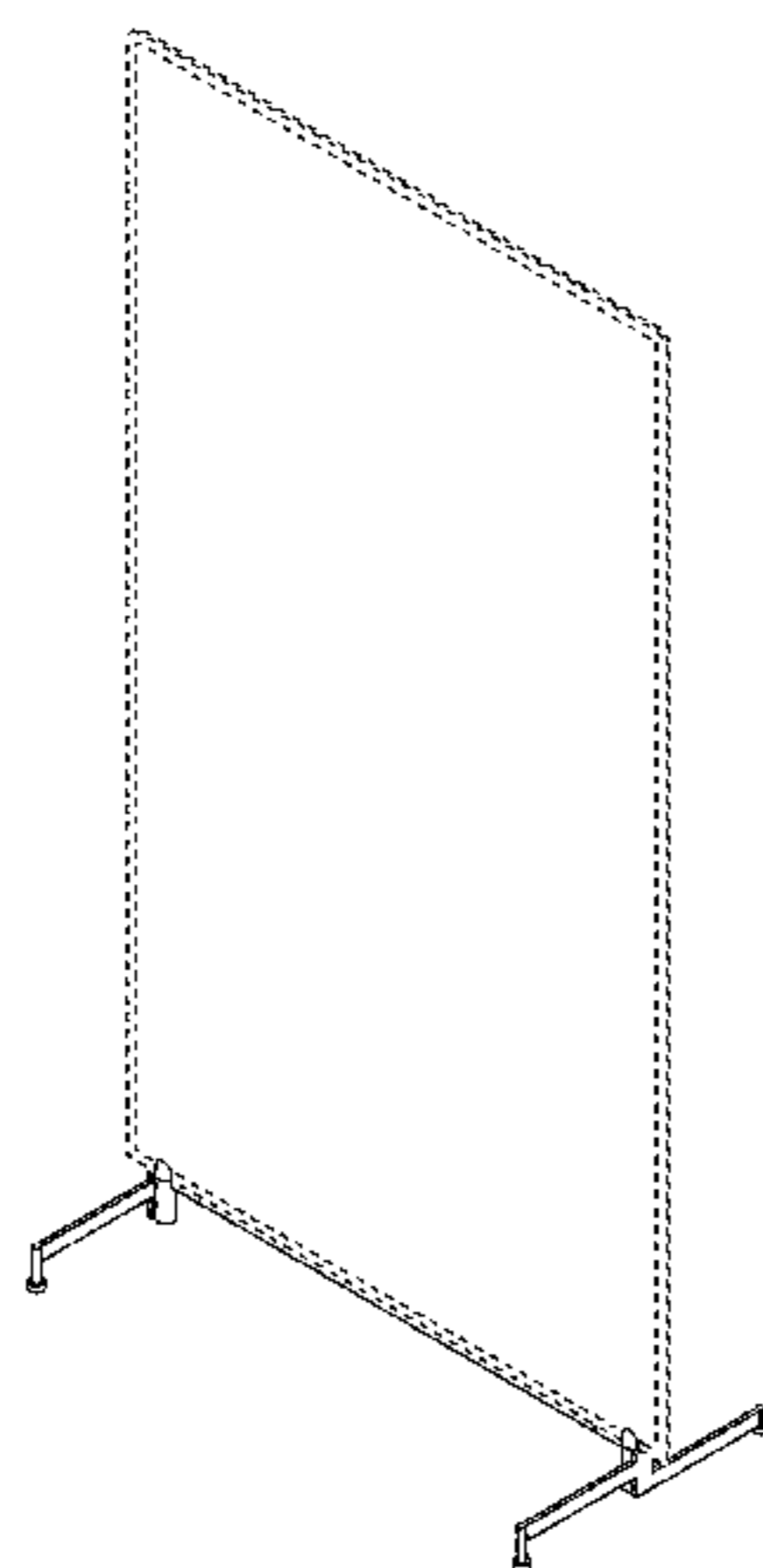

(56)

References Cited

U.S. PATENT DOCUMENTS

5,718,344 A * 2/1998 Joldeson A47F 5/13
211/182
D400,361 S * 11/1998 Sobrito D6/332
6,029,833 A * 2/2000 Yeh A47F 5/0838
108/108
D501,741 S * 2/2005 Risdall D6/644
6,935,523 B2 * 8/2005 Ahn A47F 5/137
211/189
7,077,277 B2 * 7/2006 Wang A47B 91/02
182/186.7
D556,373 S * 11/2007 Sussman D26/145
D668,894 S * 10/2012 Denby D6/708
8,393,585 B2 * 3/2013 Han F16M 11/046
248/158
D691,405 S * 10/2013 Pearsons D6/708.23
D691,406 S * 10/2013 Pearsons D6/709
D704,973 S * 5/2014 Denby D6/708
8,959,813 B2 * 2/2015 Denby A47F 5/10
211/175
D729,548 S * 5/2015 Denby D6/672

* cited by examiner

FIG. 1

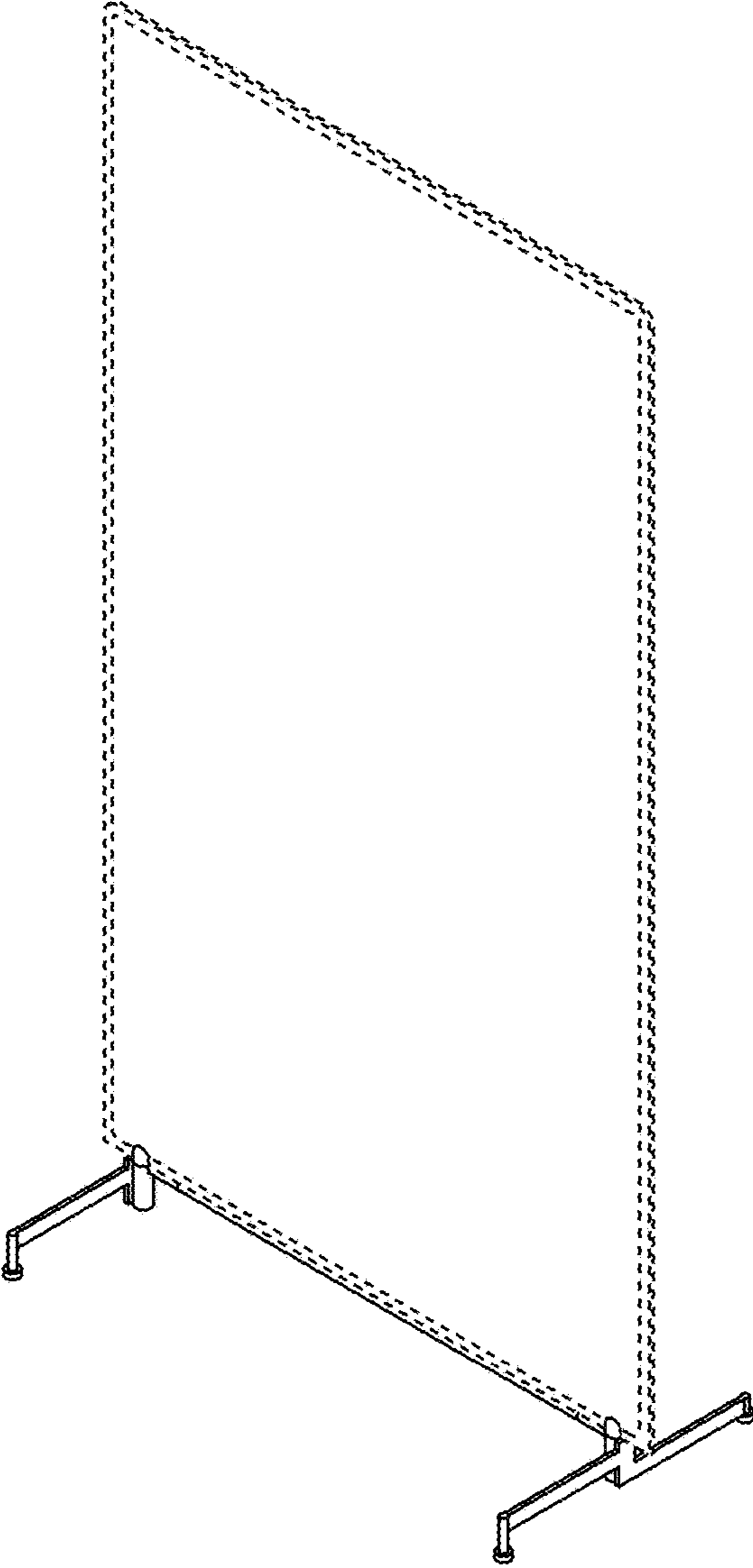

FIG. 2

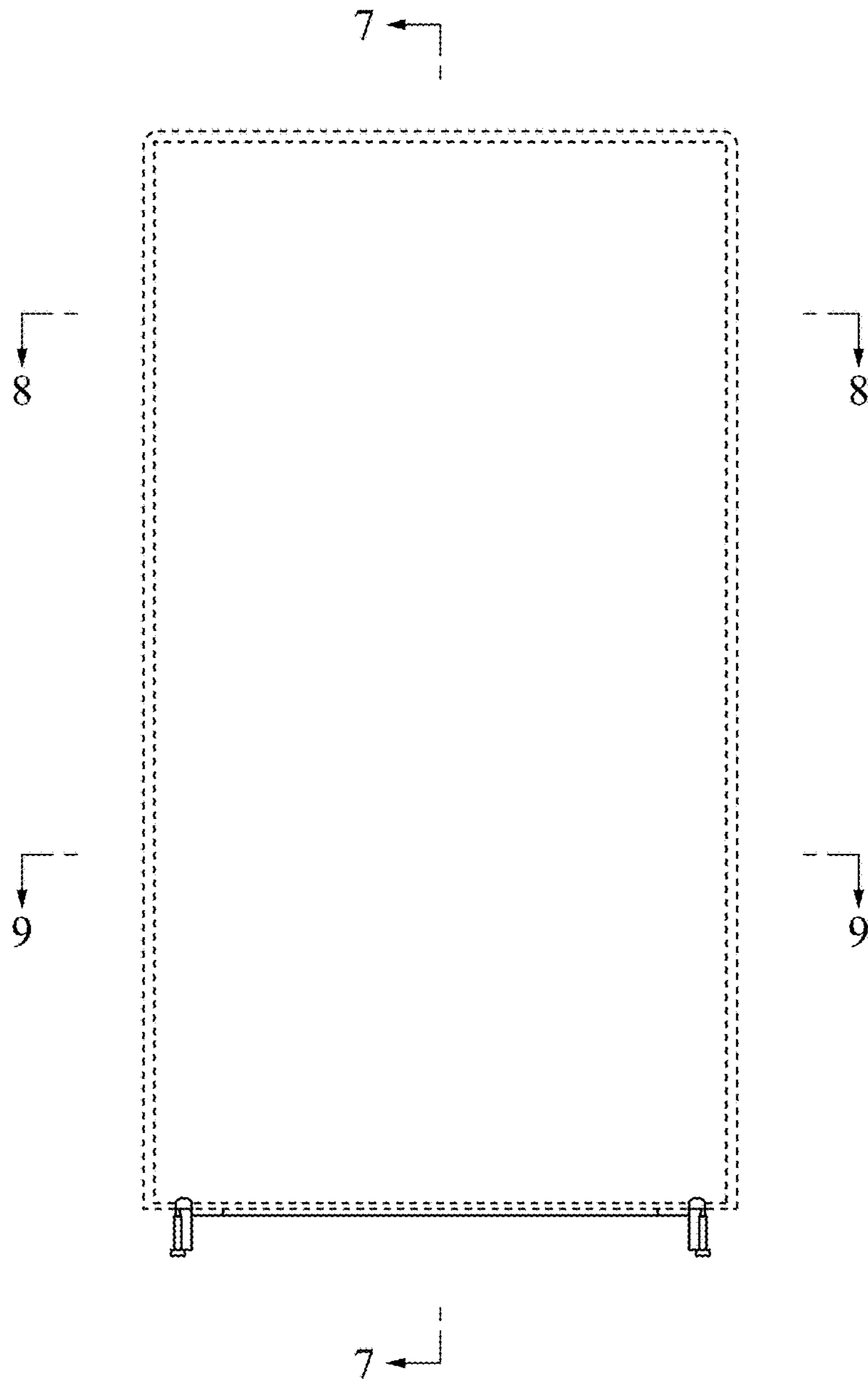

FIG. 3

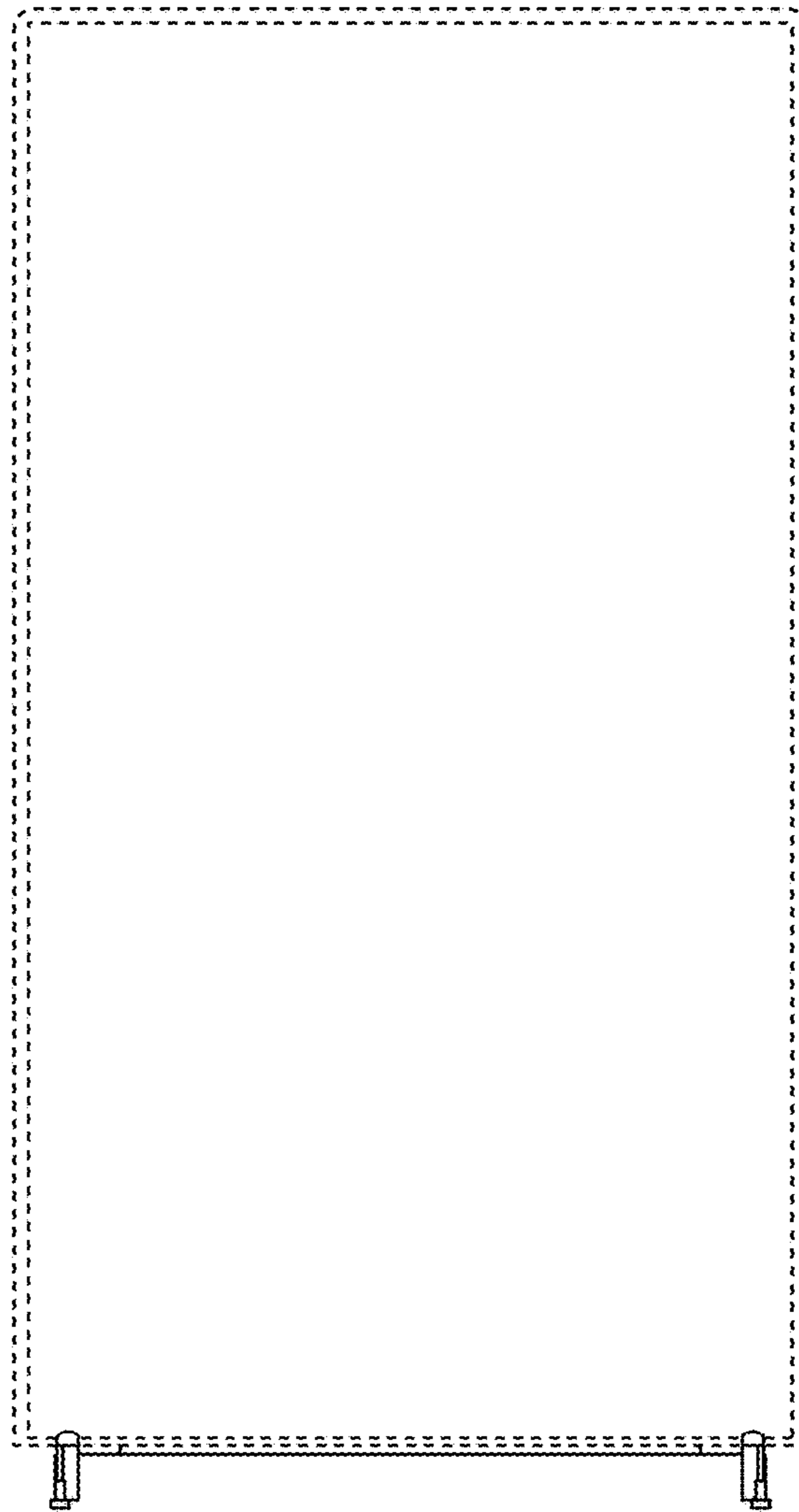

FIG. 4

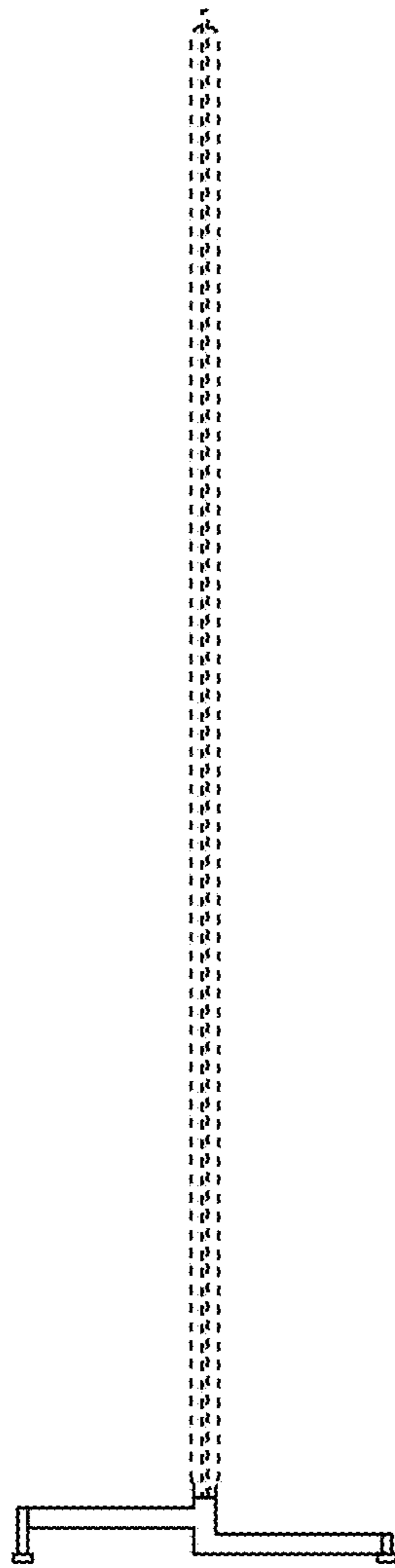

FIG. 5

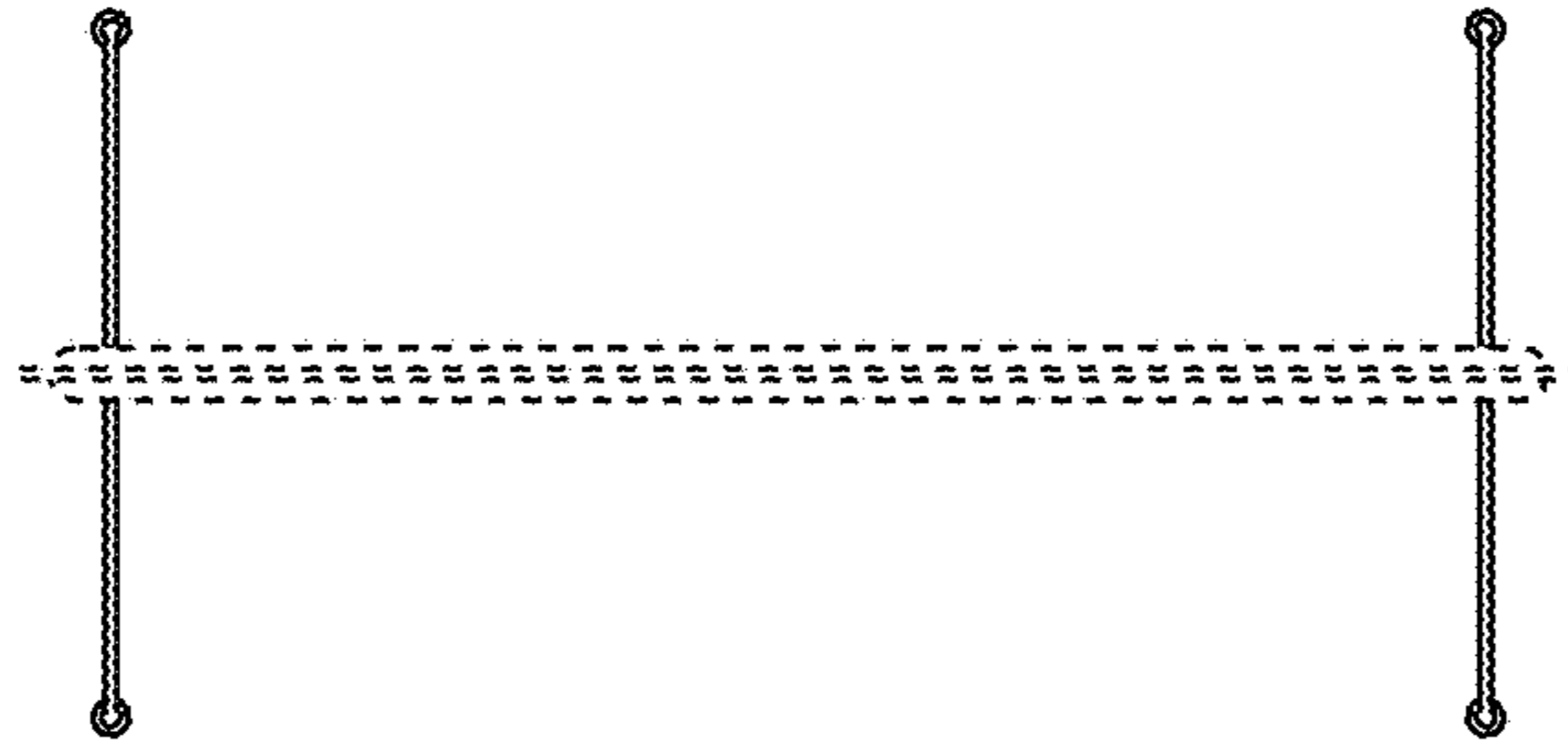

FIG. 6

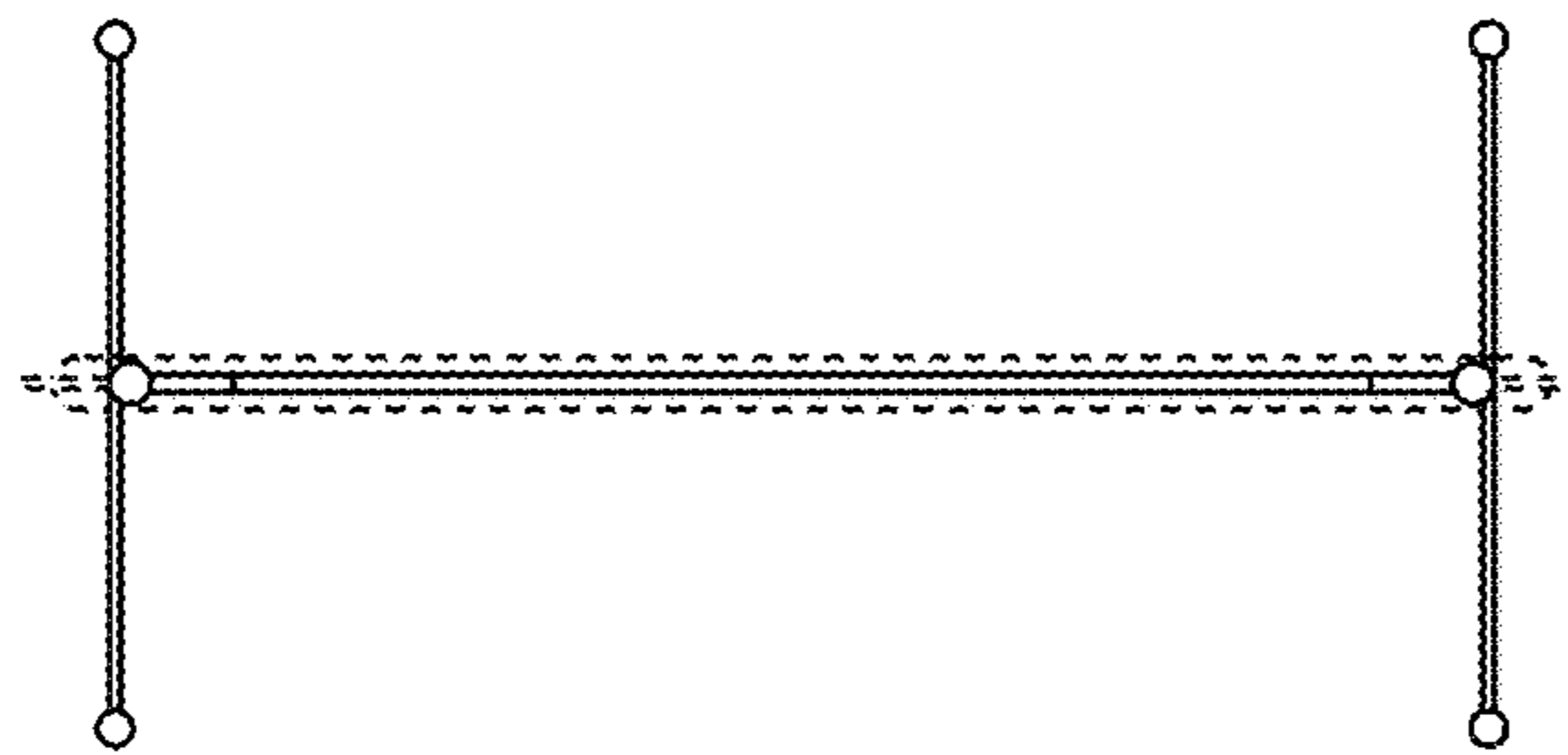

FIG. 7

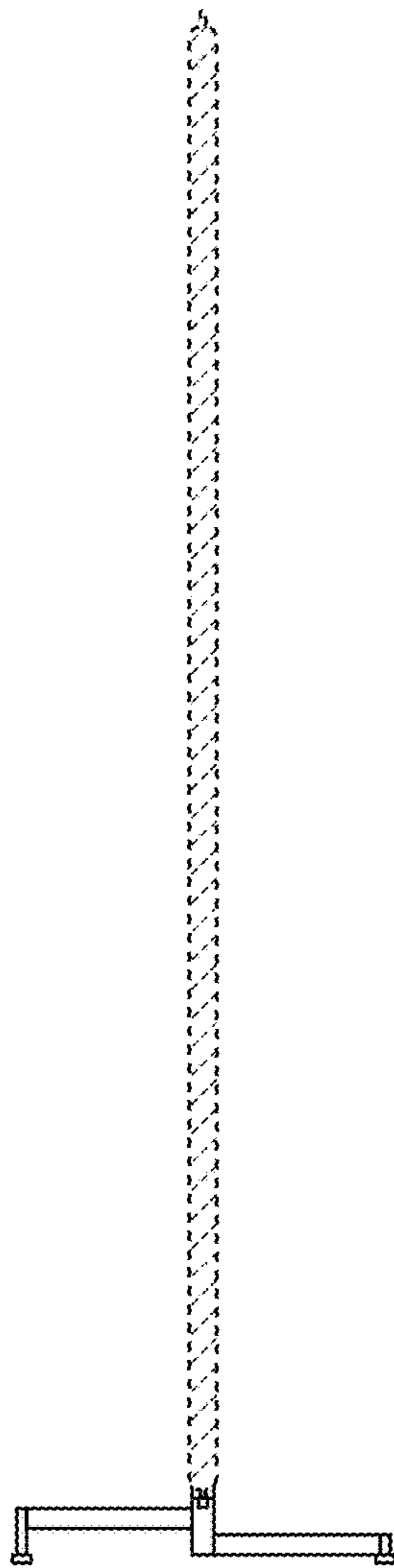

FIG. 8

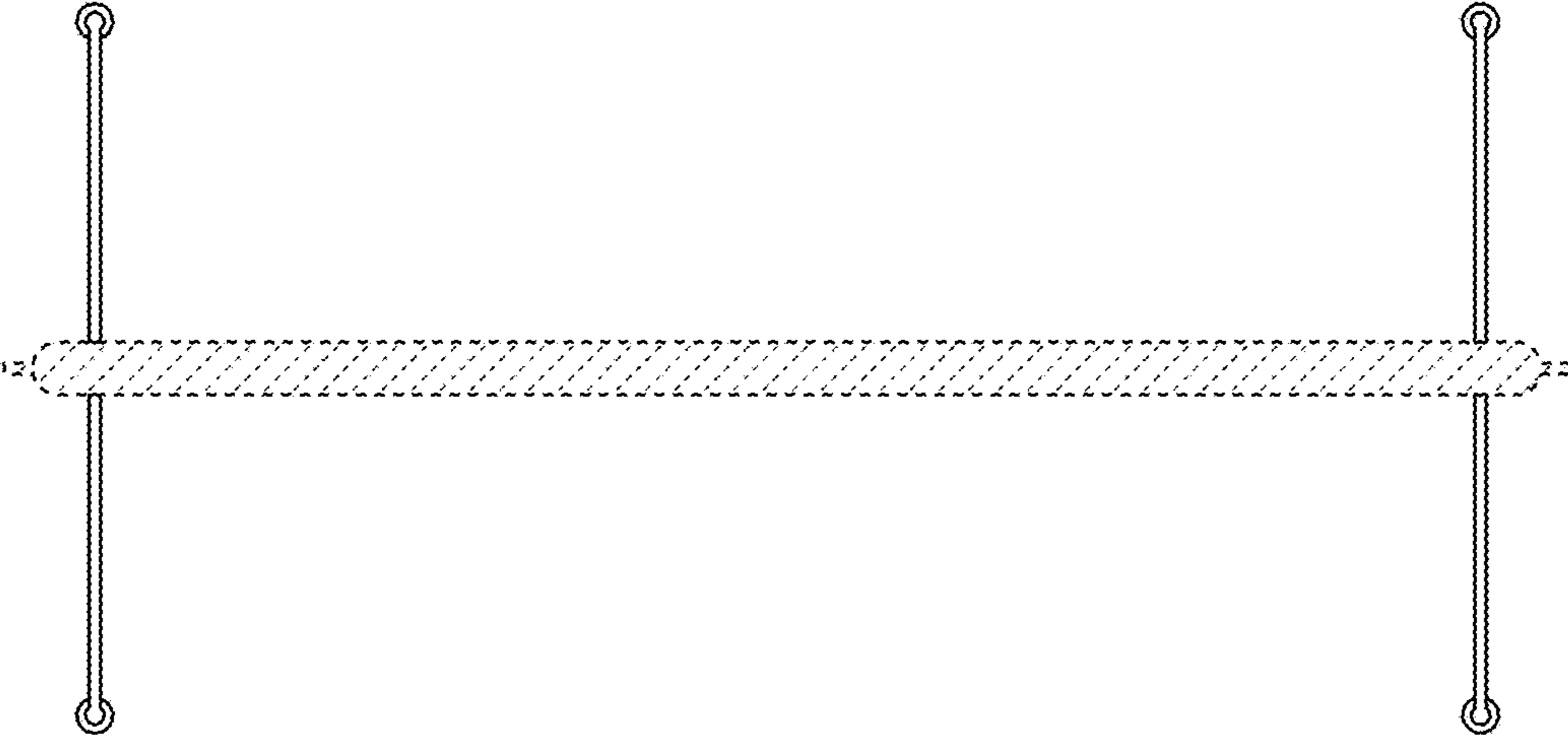

FIG. 9

