

US00D864379S

(12) **United States Design Patent**
Yang et al.

(10) **Patent No.:** **US D864,379 S**

(45) **Date of Patent:** **** Oct. 22, 2019**

- (54) **INJECTOR BODY**
- (71) Applicant: **Samsung Bioepis Co., Ltd., Incheon (KR)**
- (72) Inventors: **Jee Eun Yang, Incheon (KR); Sang Bin Park, Incheon (KR); Jae Min Song, Incheon (KR); Yong Kook Kim, Incheon (KR)**
- (73) Assignee: **Samsung Bioepis Co., Ltd., Incheon (KR)**
- (**) Term: **15 Years**
- (21) Appl. No.: **29/631,014**
- (22) Filed: **Dec. 26, 2017**
- (30) **Foreign Application Priority Data**

Jun. 26, 2017 (KR) 30-2017-0029241

(51) **LOC (12) Cl.** **24-02**

(52) **U.S. Cl.**
USPC **D24/112**

(58) **Field of Classification Search**
 USPC D24/112-114, 108, 130, 127, 133, 186;
 606/181, 185; 604/264, 523-528, 272,
 604/164.01-164.11, 187, 93.01; 600/101,
 600/139, 143; 128/200.24, 207.14,
 128/207.15
 CPC A61M 5/178; A61M 3/00; A61M 5/20;
 A61M 5/31; A61M 5/3146; A61M
 5/3129; A61M 5/3148; A61M 5/315;
 A61M 25/00; A61M 39/00; A61M 27/00;
 A61M 25/0043; A61M 25/0067; A61M
 25/0097; A61F 2/958
 See application file for complete search history.

(56) **References Cited**

U.S. PATENT DOCUMENTS

- D373,827 S * 9/1996 Polaniec D24/112
- D445,176 S * 7/2001 Landers D24/108

- D461,243 S * 8/2002 Niedospial, Jr. D24/130
- D492,404 S * 6/2004 Prais D24/112
- D578,210 S * 10/2008 Muta D24/114
- D609,807 S * 2/2010 Hashimoto D24/133
- D610,678 S * 2/2010 Kawamura D24/114
- D635,665 S * 4/2011 Kawamura D24/130
- 8,512,291 B2 * 8/2013 Ross A61M 25/0009
604/164.01
- 8,636,702 B2 * 1/2014 Schiller A61M 5/31511
604/181
- D724,199 S * 3/2015 Bambot D24/112
- 9,028,507 B2 * 5/2015 Cole A61B 17/32053
606/131
- D763,438 S * 8/2016 Gouret D24/108
- 9,416,905 B2 * 8/2016 Weeden A61M 25/00
- D792,579 S * 7/2017 Ohashi D24/114

(Continued)

Primary Examiner — David G Muller
(74) *Attorney, Agent, or Firm* — Novick, Kim & Lee, PLLC; Sang Ho Lee; Hyun Woo Shin

(57) **CLAIM**

We claim the ornamental design for an injector body, as shown and described.

DESCRIPTION

FIG. 1 is a perspective view of an injector body, showing our new design;
 FIG. 2 is a front elevational view thereof;
 FIG. 3 is a rear elevational view thereof;
 FIG. 4 is a left side elevational view thereof;
 FIG. 5 is a right side elevational view thereof;
 FIG. 6 is a top plan view thereof;
 FIG. 7 is a bottom plan view thereof; and,
 FIG. 8 is a cross-sectional view taken along line 8-8 in FIG. 6.

The broken lines shown in the drawings show portions of the injector body which form no part of design.

1 Claim, 7 Drawing Sheets

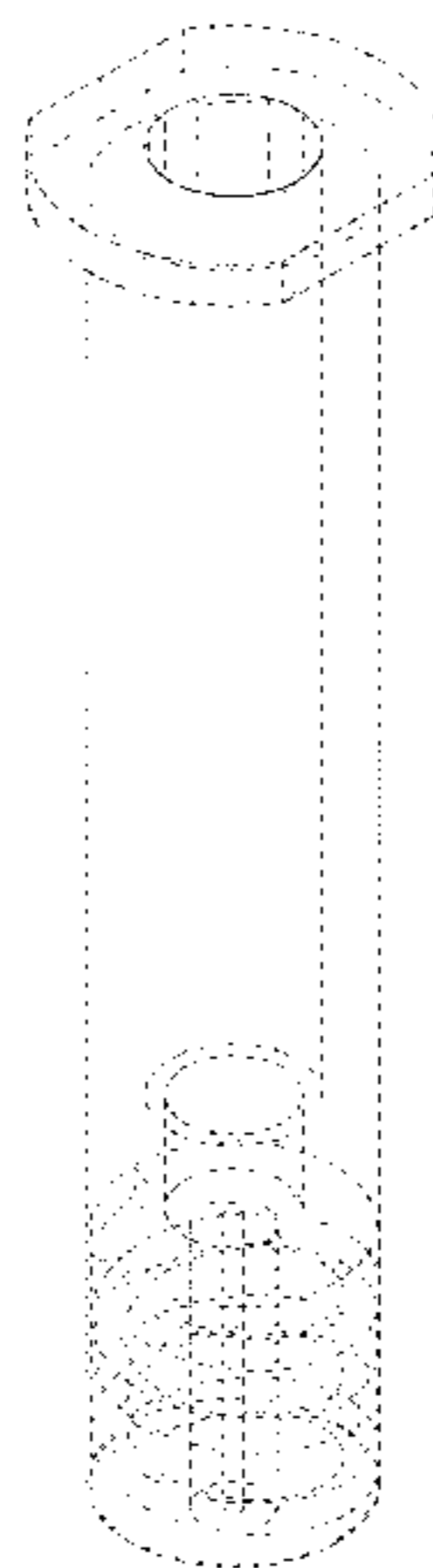

(56)

References Cited

U.S. PATENT DOCUMENTS

D804,651 S * 12/2017 Loonan D24/114
D818,117 S * 5/2018 Green D24/112

* cited by examiner

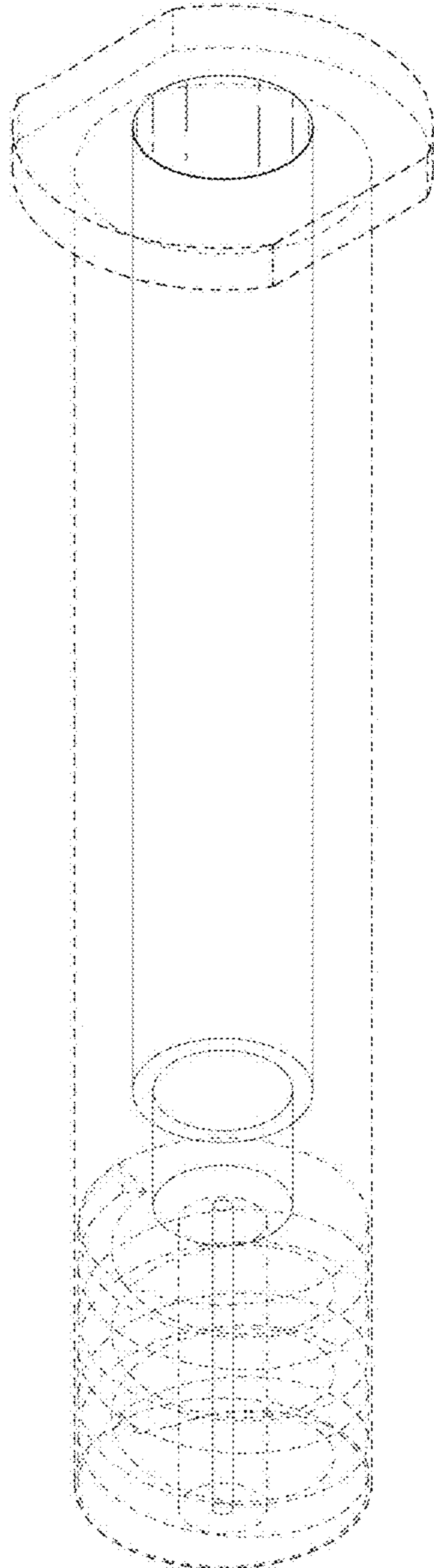

FIG. 1

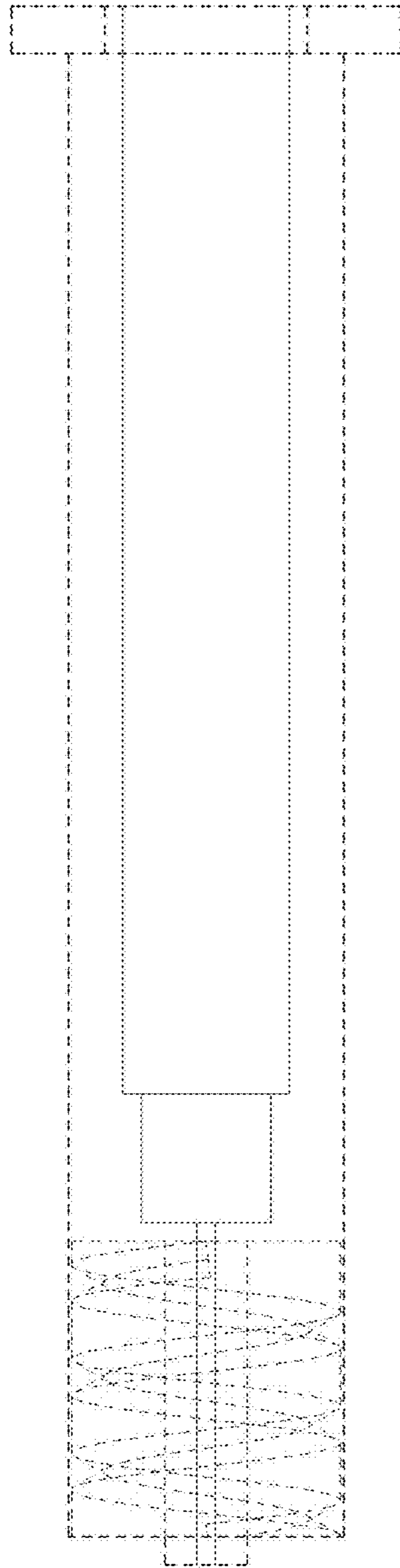

FIG. 2

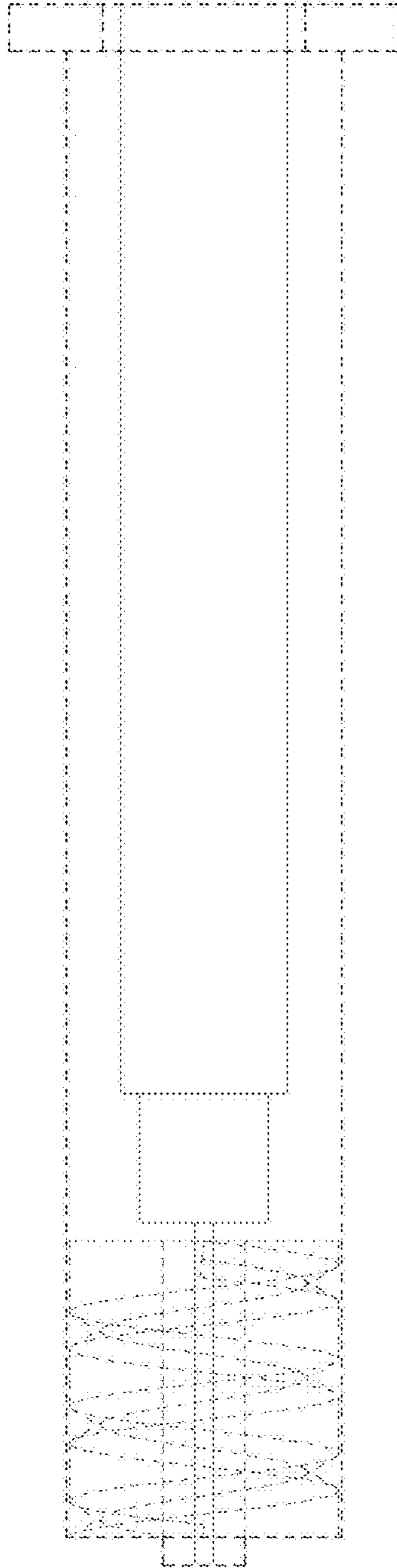

FIG. 3

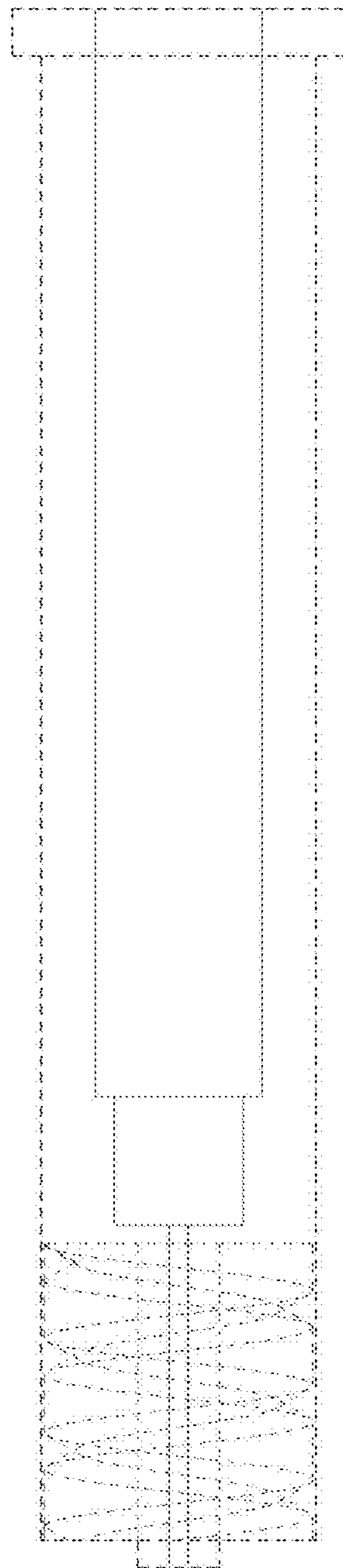

FIG. 4

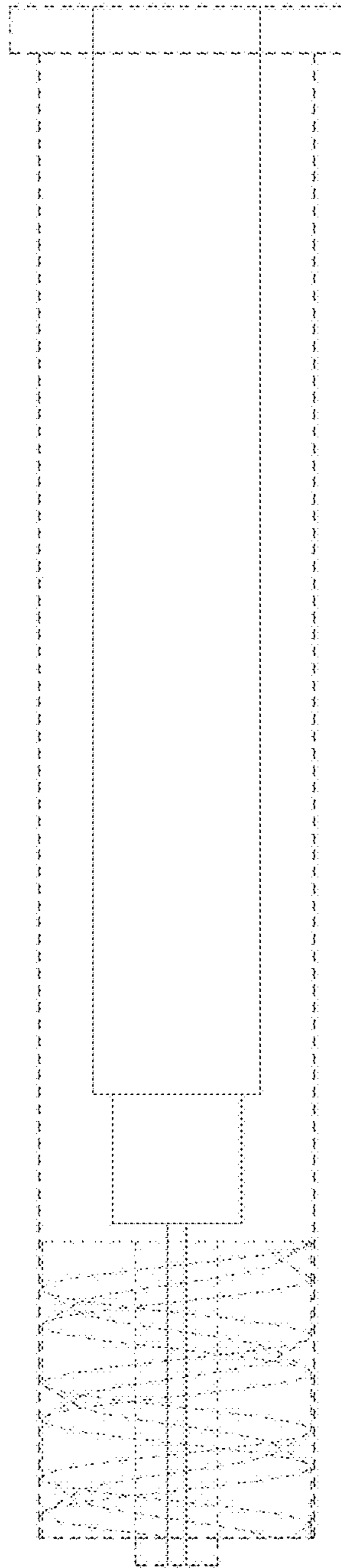

FIG. 5

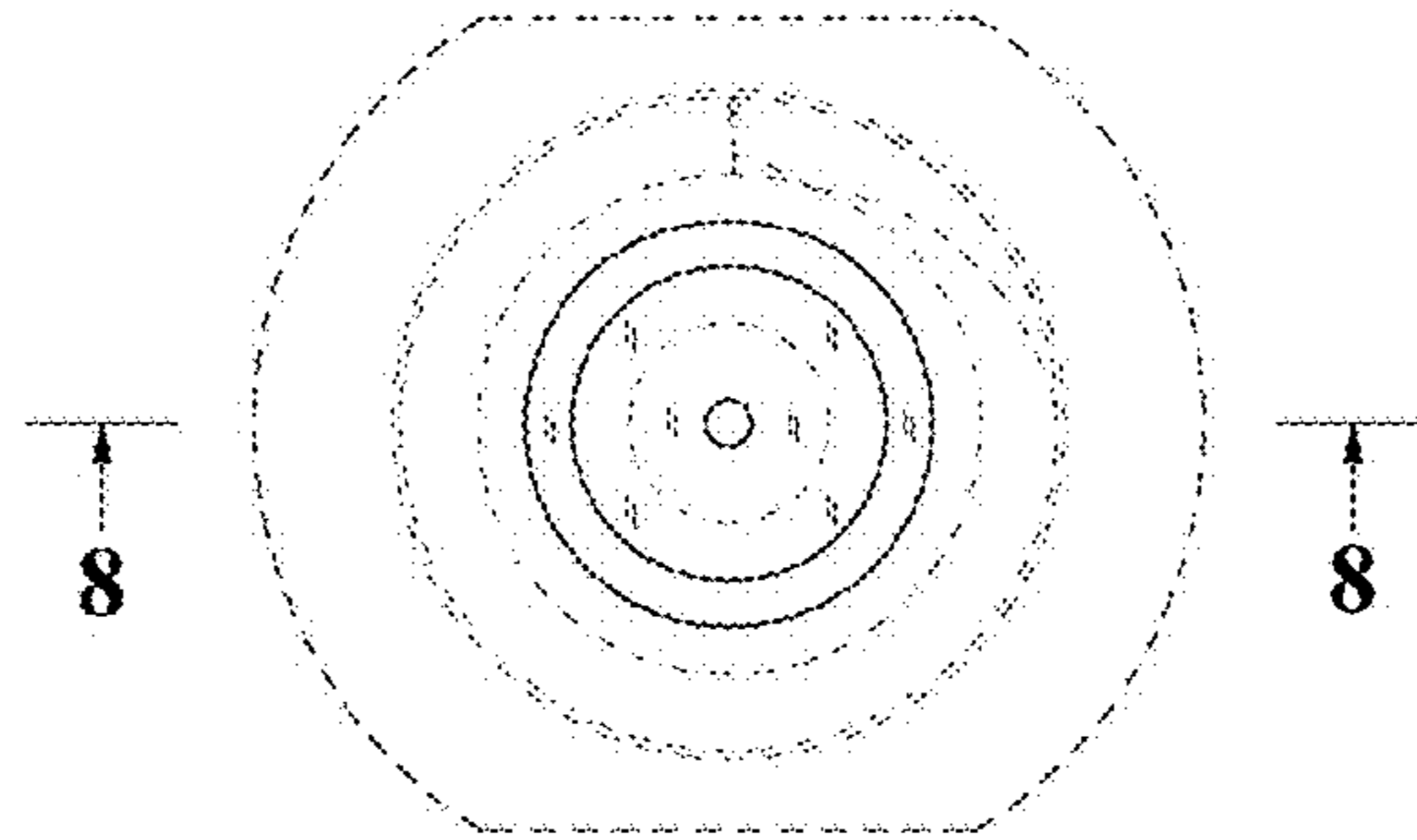

FIG. 6

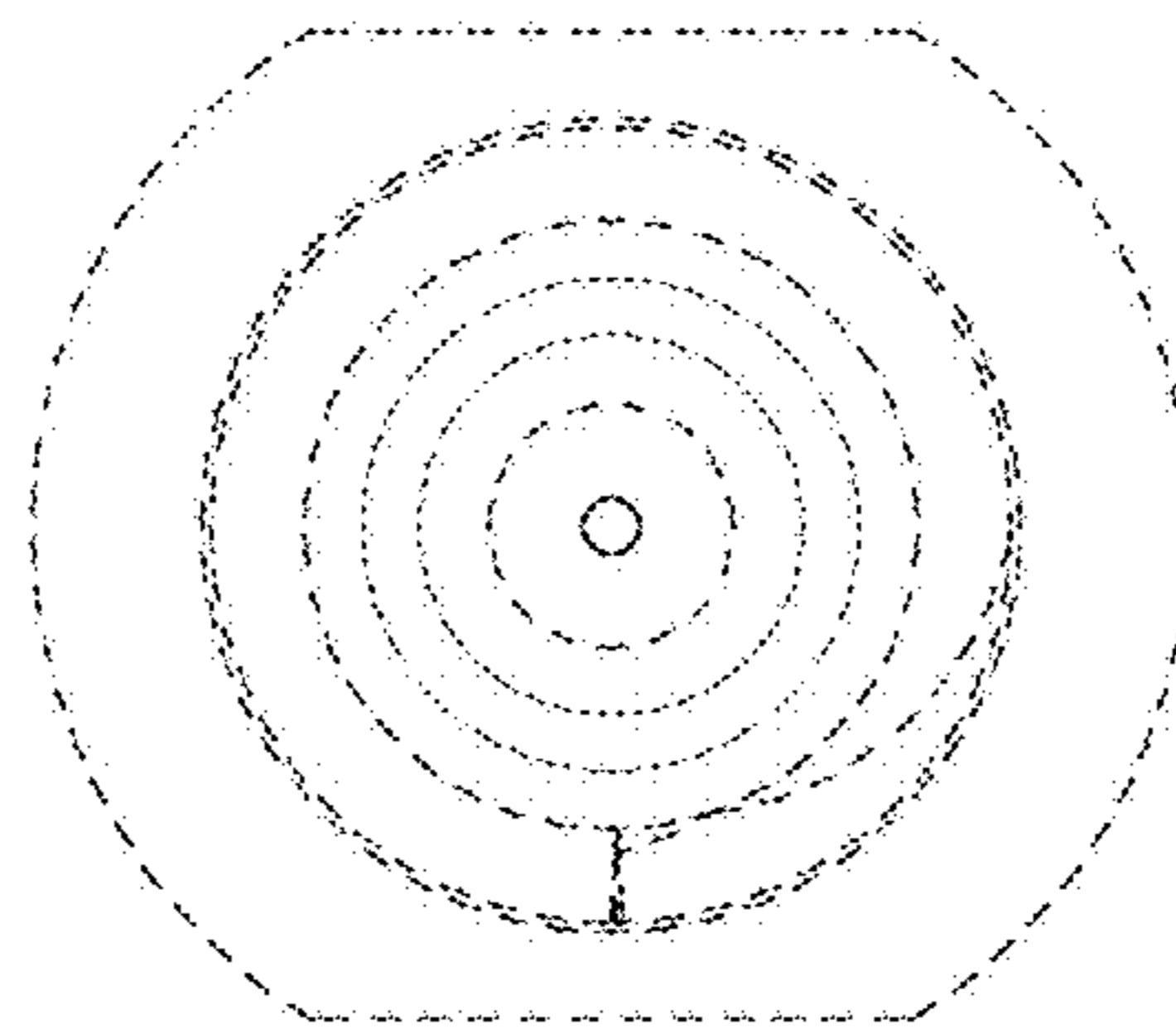

FIG. 7

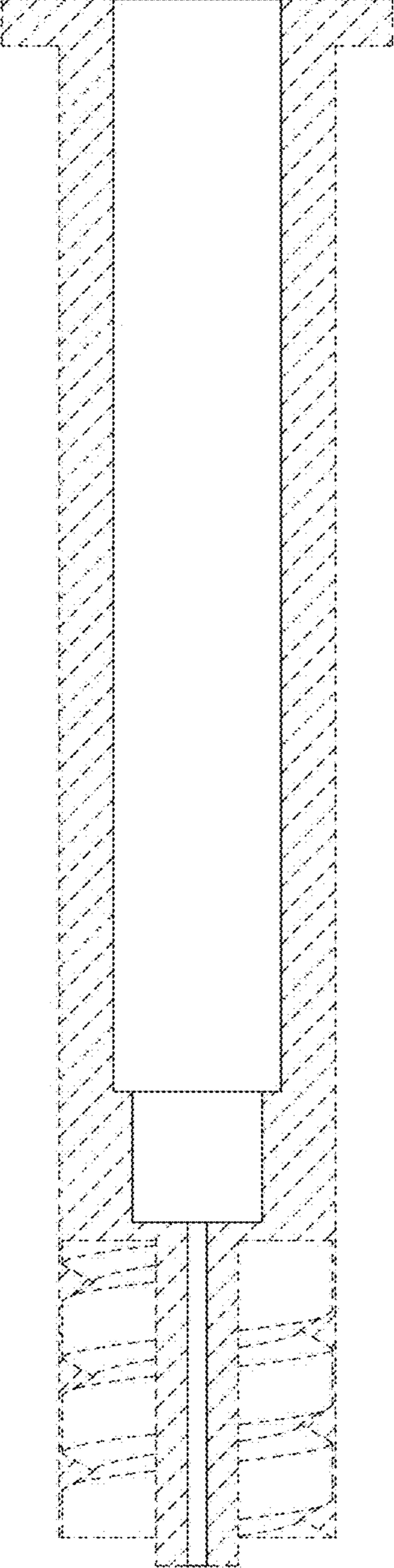

FIG. 8