



US00D863199S

(12) **United States Design Patent** (10) **Patent No.:** **US D863,199 S**  
**Adler et al.** (45) **Date of Patent:** **\*\* Oct. 15, 2019**

(54) **BICYCLE CARRIER**  
(71) Applicant: **Thule Sweden AB**, Hillerstorp (SE)  
(72) Inventors: **Jan Adler**, Skillingaryd (SE); **Henrik Eriksson**, Jönköping (SE); **Keith Prescott**, Cambridge, VT (US); **Jeffrey Edgerly**, Bristol, CT (US)  
(73) Assignee: **Thule Sweden AB**, Hillerstorp (SE)  
(\*\*) Term: **15 Years**

(21) Appl. No.: **29/639,894**  
(22) Filed: **Mar. 9, 2018**

**Related U.S. Application Data**

(63) Continuation of application No. 29/534,820, filed on Jul. 31, 2015, now Pat. No. Des. 817,256.  
(51) **LOC (12) Cl.** ..... **12-16**  
(52) **U.S. Cl.**  
USPC ..... **D12/408**  
(58) **Field of Classification Search**  
USPC ..... D12/111, 406, 407, 408, 412, 414  
CPC ..... B60R 9/06; B60R 9/10; B60R 11/00  
See application file for complete search history.

(56) **References Cited**

**U.S. PATENT DOCUMENTS**

D329,035 S \* 9/1992 Blackburn ..... D12/408  
5,690,260 A \* 11/1997 Aikins ..... B60R 9/06  
224/504  
D628,141 S \* 11/2010 Weaver ..... D12/408  
D637,137 S \* 5/2011 Weaver ..... D12/408  
D656,080 S \* 3/2012 Budd ..... D12/408  
D658,567 S \* 5/2012 Shen ..... D12/408  
D671,883 S \* 12/2012 Farber ..... D12/408  
D684,917 S \* 6/2013 Williams ..... D12/408  
D706,209 S \* 6/2014 Flaherty ..... D12/407  
D707,617 S \* 6/2014 Flaherty ..... D12/407  
D717,717 S \* 11/2014 Williams ..... B60R 9/10  
D12/408

D722,289 S \* 2/2015 Williams ..... D12/408  
D727,831 S \* 4/2015 Eriksson ..... D12/407  
D743,871 S \* 11/2015 Freet ..... D12/408  
9,174,584 B1 \* 11/2015 Cha ..... B60R 9/10  
2012/0234883 A1 \* 9/2012 Sautter ..... B60R 9/06  
224/502  
2013/0062385 A1 \* 3/2013 Pedrini ..... B60R 9/06  
224/501  
2013/0105534 A1 \* 5/2013 Farber ..... B60R 9/06  
224/314  
2014/0125045 A1 \* 5/2014 Nusbaum ..... B60R 9/06  
280/769

(Continued)

**OTHER PUBLICATIONS**

Thule.com, "Thule T2 2 Bike 916XTR," <[http://web.archive.org/web/20130703110705/http://www.thule.com/en-us/ca/products/carriers-and-racks/bike-carriers/hitch-mounted-bike-carriers/thule-t2-2-bike-916xtr-\\_916xtr](http://web.archive.org/web/20130703110705/http://www.thule.com/en-us/ca/products/carriers-and-racks/bike-carriers/hitch-mounted-bike-carriers/thule-t2-2-bike-916xtr-_916xtr)>, dated Jul. 3, 2013.

*Primary Examiner* — Darlington Ly  
(74) *Attorney, Agent, or Firm* — Sterne, Kessler, Goldstein & Fox P.L.L.C.

(57) **CLAIM**

The ornamental design for a bicycle carrier, as shown and described.

**DESCRIPTION**

FIG. 1 is a top, rear, and right side perspective view of a bicycle carrier showing our new design; FIG. 2 is a rear elevation view thereof; FIG. 3 is a front elevation view thereof; FIG. 4 is a left side elevation view thereof; FIG. 5 is a right side elevation view thereof; FIG. 6 is a top plan view thereof; and, FIG. 7 is a bottom plan view thereof. The broken lines in the figures show portions of the bicycle carrier that form no part of the claimed design.

**1 Claim, 7 Drawing Sheets**

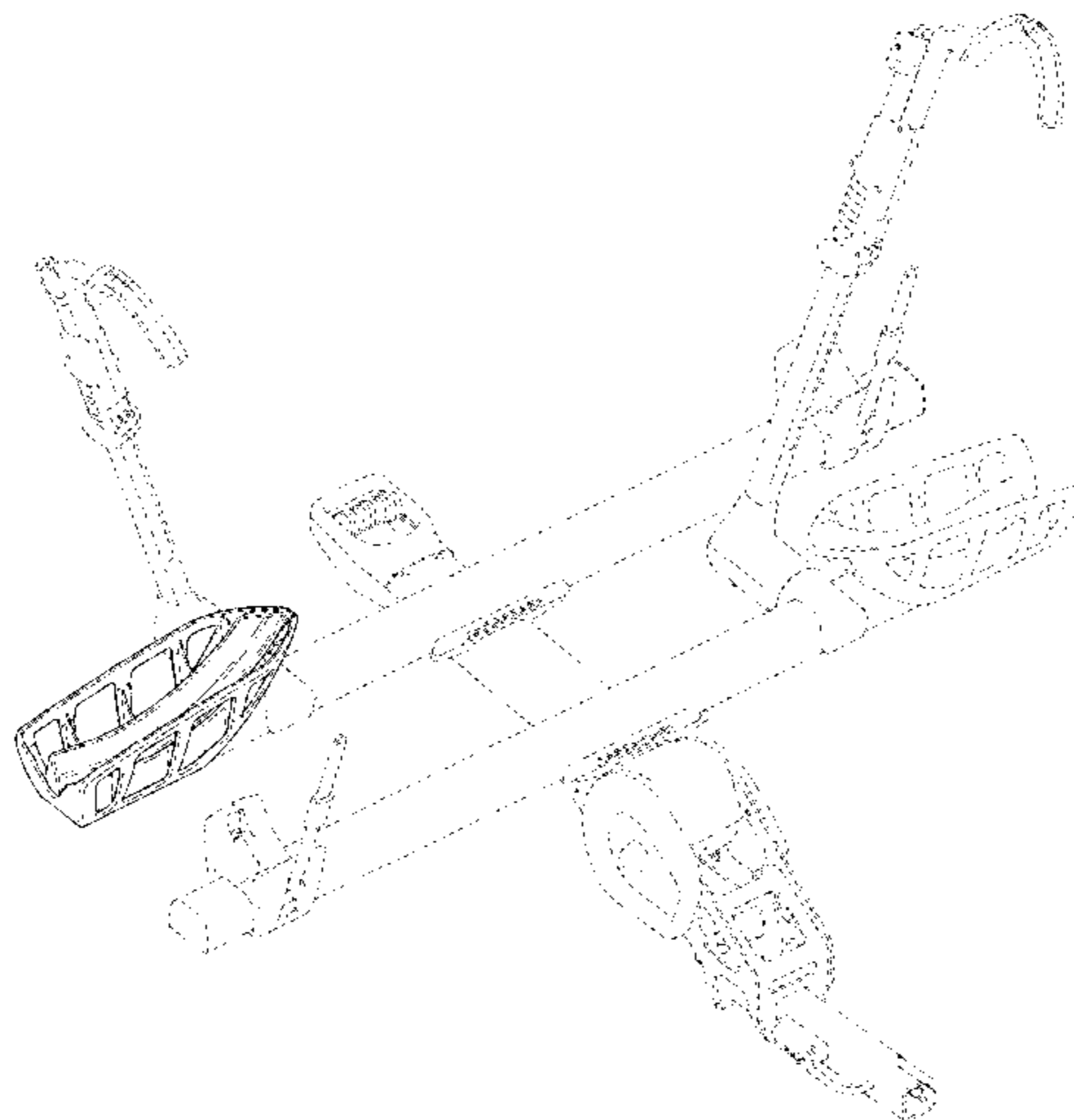

(56)

**References Cited**

U.S. PATENT DOCUMENTS

2016/0096482 A1\* 4/2016 Cha ..... B60R 9/10  
224/496  
2016/0096483 A1\* 4/2016 Cha ..... B60R 9/06  
224/496

\* cited by examiner

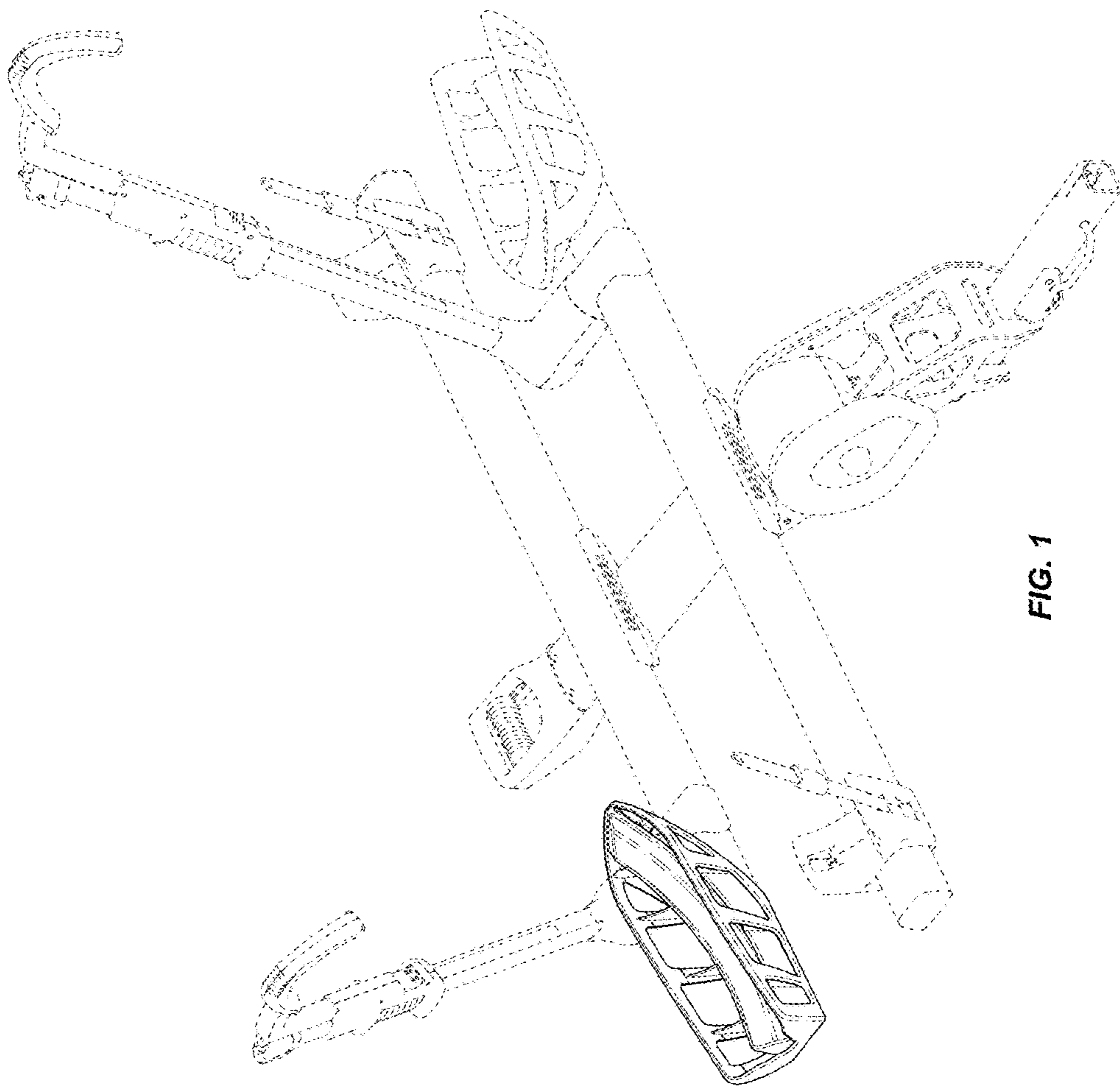

FIG. 1

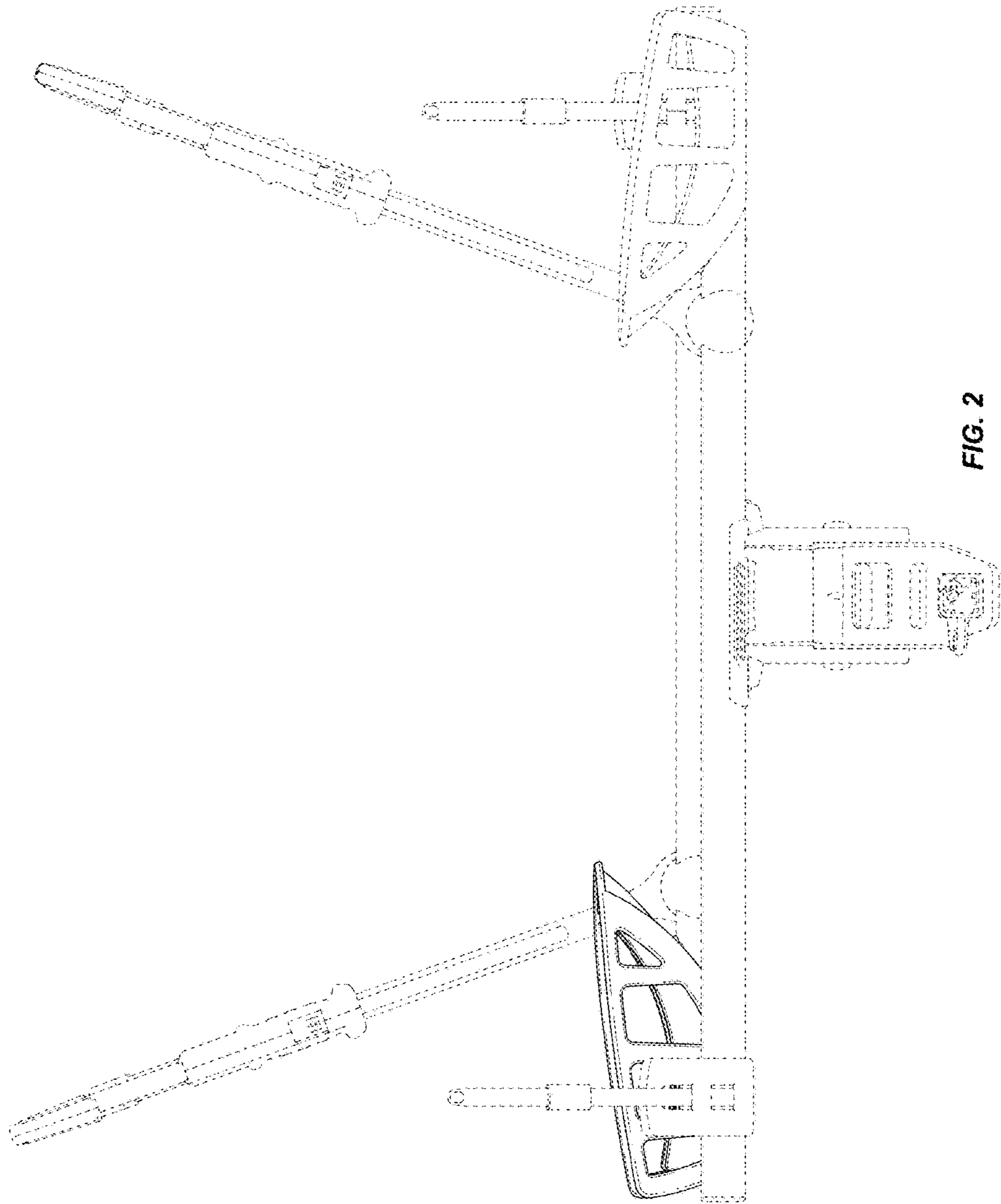

FIG. 2

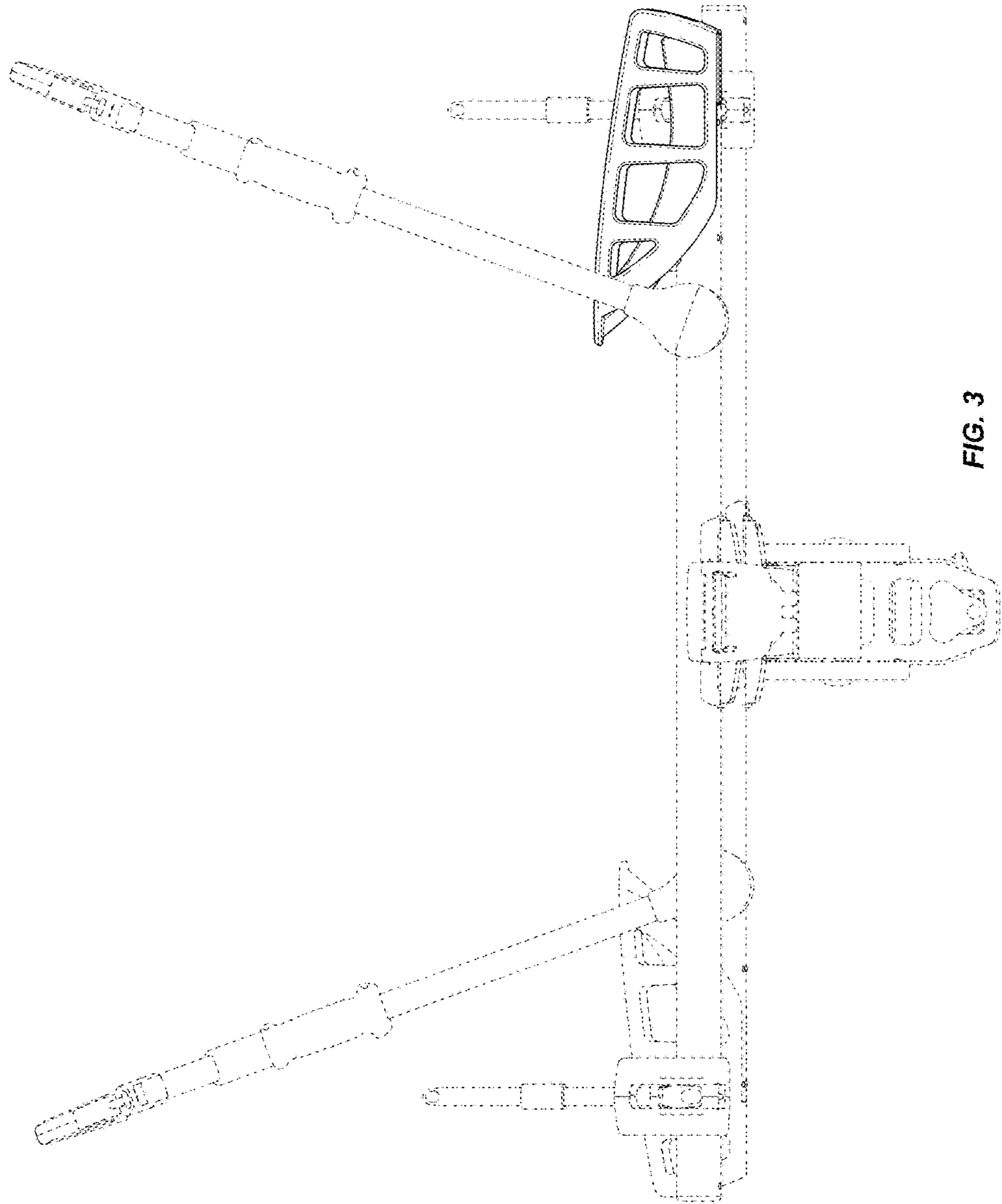

FIG. 3

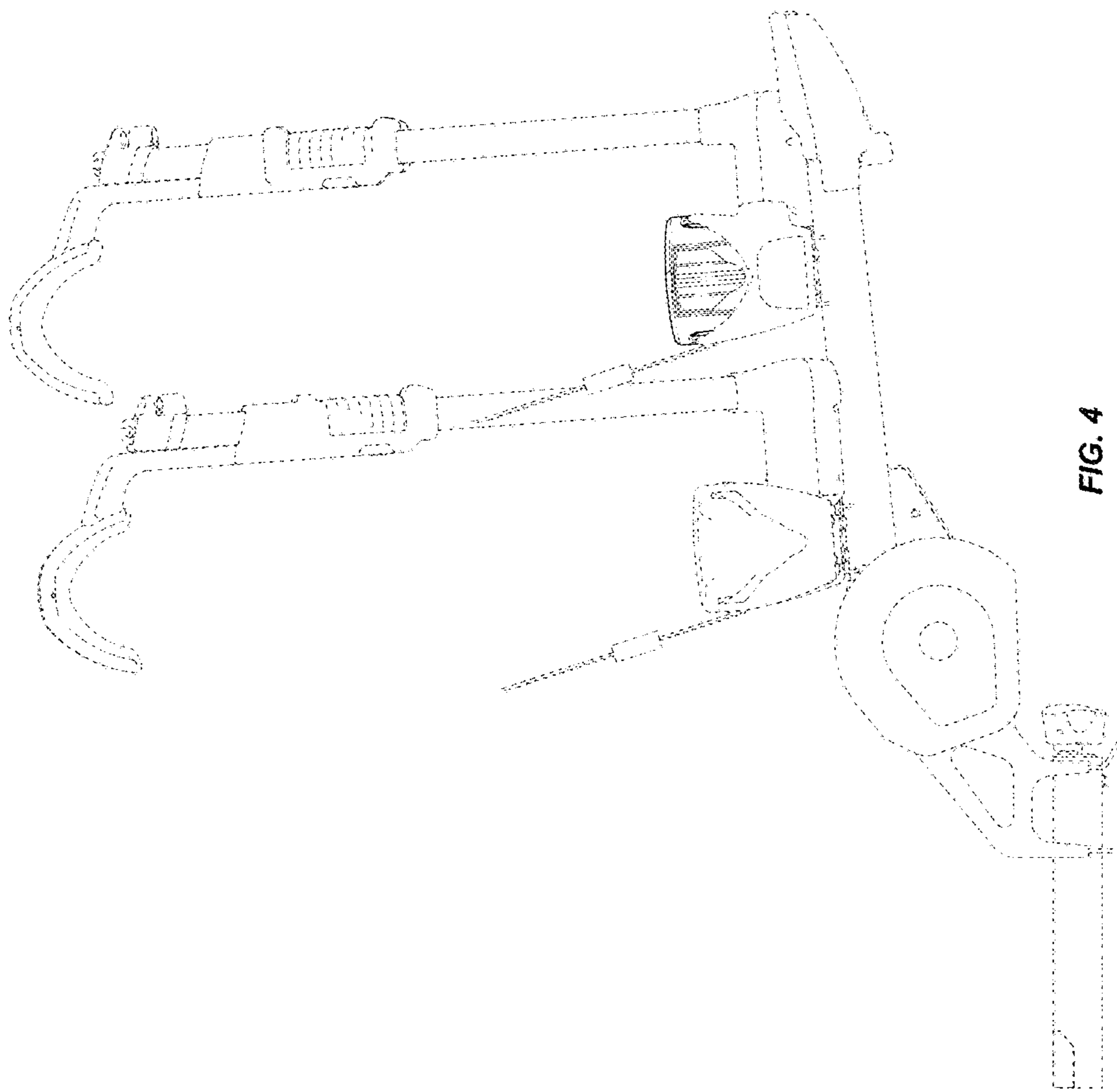

FIG. 4

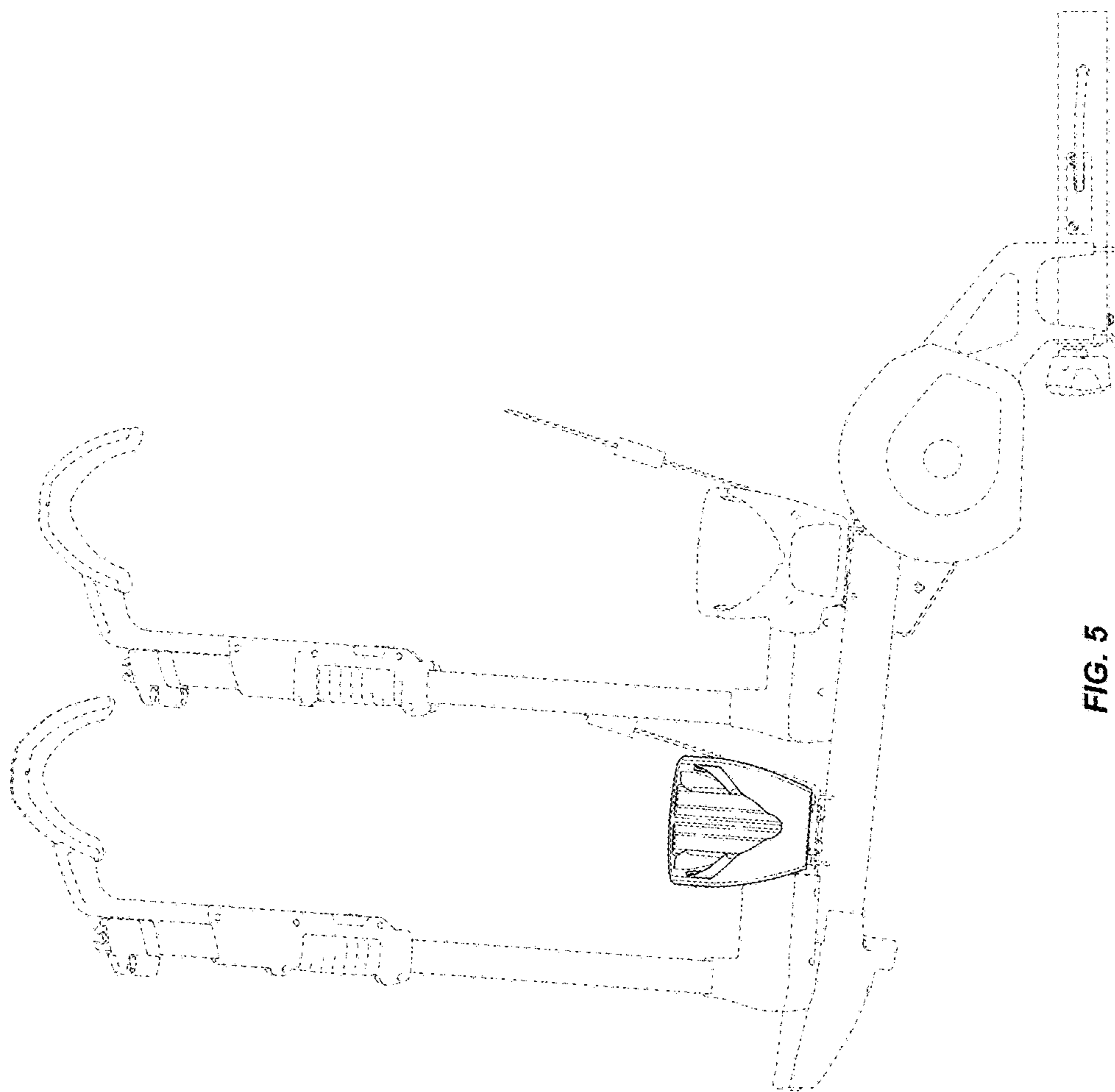

FIG. 5

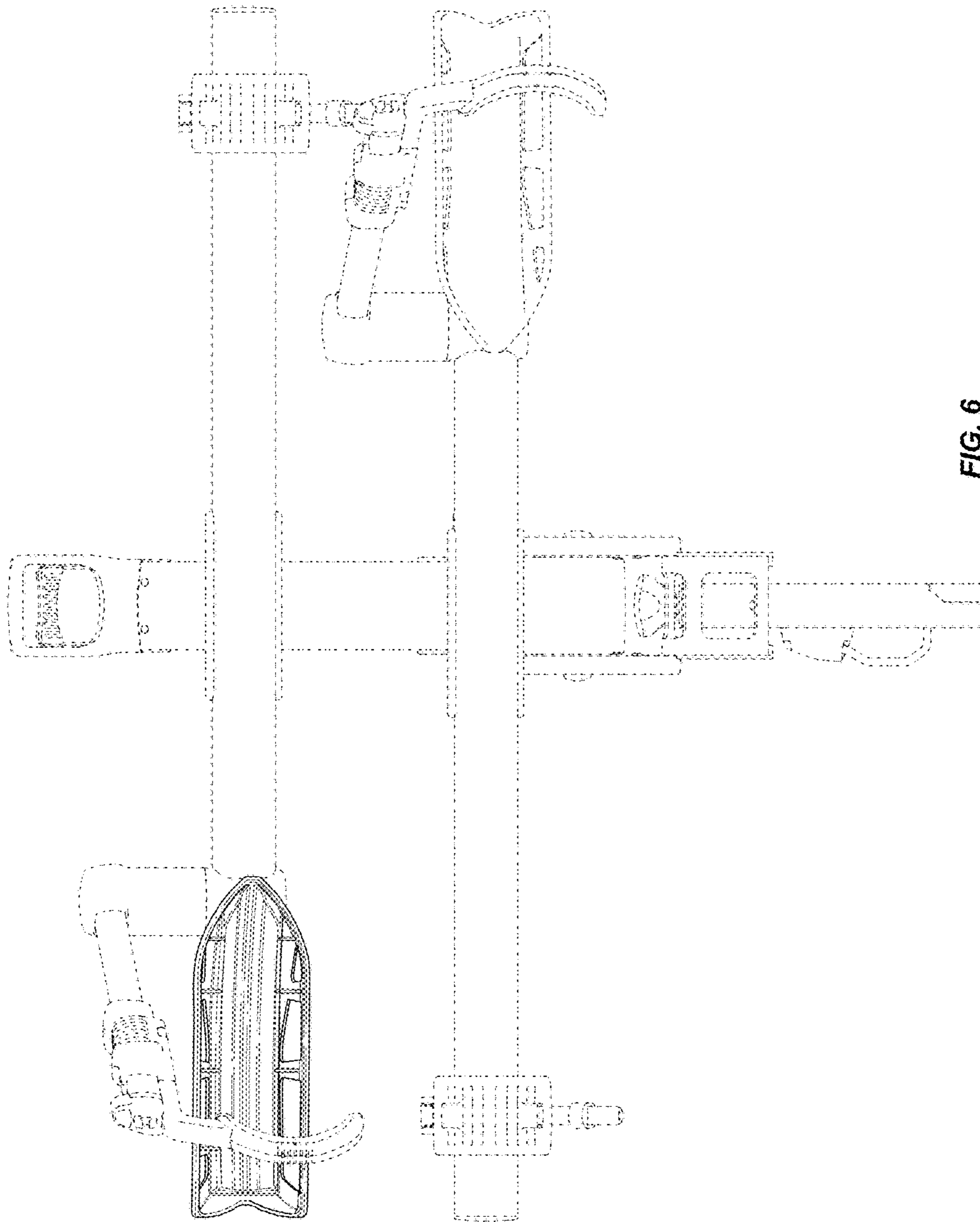

FIG. 6



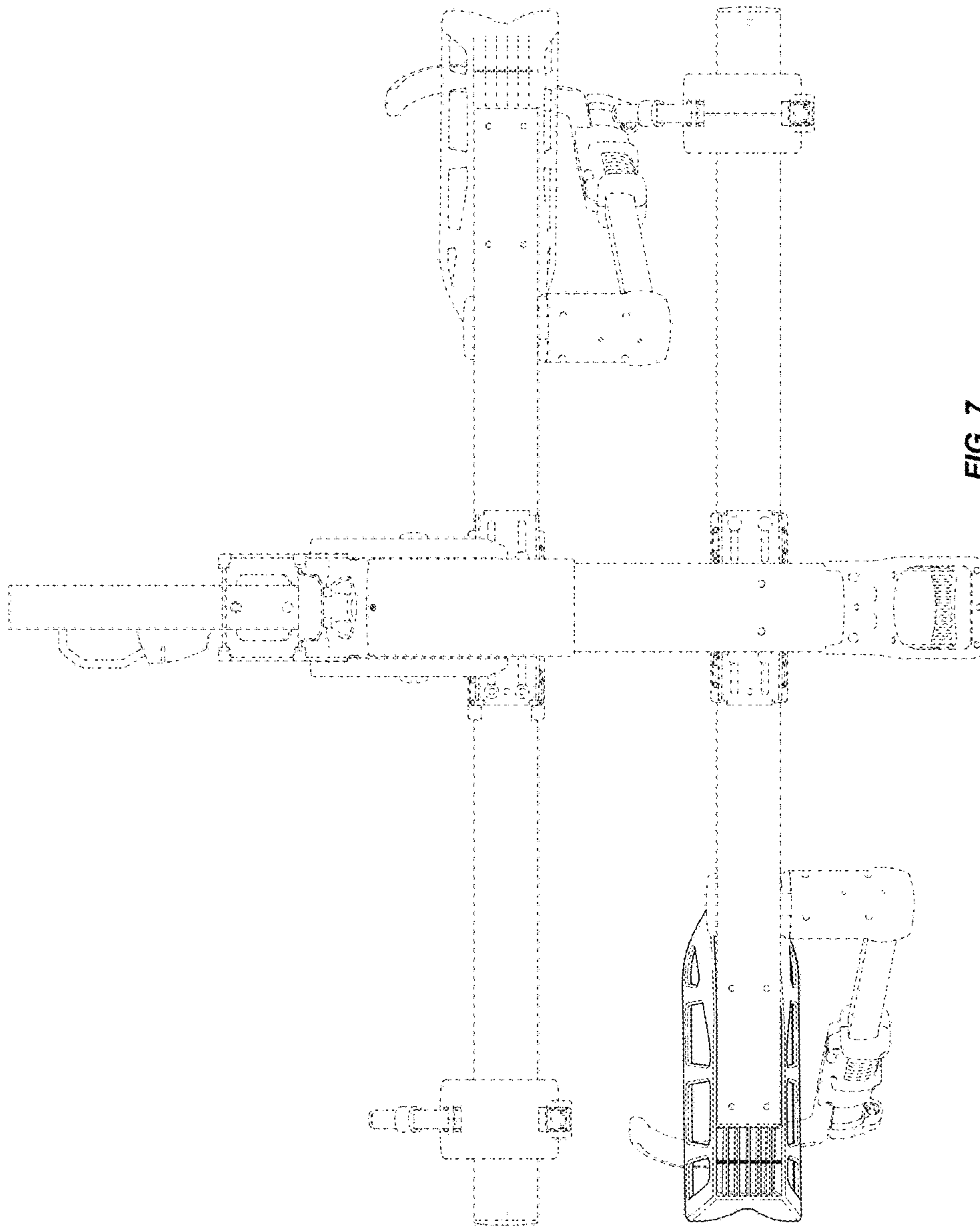

FIG. 7