



US00D861387S

(12) **United States Design Patent**  
**Bray**

(10) **Patent No.:** **US D861,387 S**

(45) **Date of Patent:** **\*\* Oct. 1, 2019**

(54) **CREDENZA**

(71) Applicant: **Blu Dot Design & Manufacturing, Inc.**, Minneapolis, MN (US)

(72) Inventor: **B. Bradshaw Bray**, Minneapolis, MN (US)

(73) Assignee: **Blu Dot Design & Manufacturing, Inc.**, Minneapolis, MN (US)

(\*\*) Term: **15 Years**

(21) Appl. No.: **29/629,146**

(22) Filed: **Dec. 12, 2017**

(51) **LOC (12) Cl.** ..... **06-04**

(52) **U.S. Cl.**  
USPC ..... **D6/671**

(58) **Field of Classification Search**

USPC ..... D6/657, 659, 661, 663, 669, 671, 671.1,  
D6/683.1, 672, 673, 675  
CPC ..... A47B 31/00; A47B 46/00; A47B 47/00;  
A47B 47/022; A47B 47/05; A47B 47/02;  
A47B 47/04; A47B 47/0066; A47B  
47/024; A47B 55/00; A47B 71/00; A47B  
67/00; A47B 67/02; A47B 67/04; A47B  
73/00; A47B 81/00; A47B 43/00; A47B  
43/04; A47B 45/00; A47B 61/00; A47B  
61/06; A47B 79/00; A47F 3/00; A47F  
3/001; A47F 3/005; A47F 3/0434; A47F  
5/08; A47F 7/0078

See application file for complete search history.

(56) **References Cited**

**U.S. PATENT DOCUMENTS**

289,311 A \* 11/1883 Selby ..... A47B 61/00  
312/213  
D97,309 S \* 10/1935 Stoltz ..... A47B 67/04  
D6/671  
D98,366 S 1/1936 Pumphrey  
D164,614 S \* 9/1951 Wallace et al. .... D6/671  
D165,241 S 11/1951 Porter

(Continued)

**OTHER PUBLICATIONS**

Houzz. <https://www.houzz.com/product/120934809-ingrid-mid-century-modern-dresser-with-6-drawers-white-midcentury-dressers>. "Ingrid Mid Century Modern Dresser With 6 Drawers, White." Date unknown: Viewed Apr. 2019 (Year: 2019).\*

(Continued)

*Primary Examiner* — R. Johnson

(74) *Attorney, Agent, or Firm* — Fredrikson & Byron, P.A.

(57) **CLAIM**

I claim the ornamental design for a credenza, as shown and described.

**DESCRIPTION**

FIG. 1 is a front perspective view of a credenza showing the new design;  
FIG. 2 is a front elevational view thereof;  
FIG. 3 is a rear elevational view thereof;  
FIG. 4 is a first side elevational view thereof; the second side elevational view, opposite the first side elevational view, being a mirror image thereof;  
FIG. 5 is a top plan view thereof;  
FIG. 6 is a bottom plan view thereof;  
FIG. 7 is an enlarged perspective view of the portion identified in FIG. 1, showing one of the four holes of the credenza, the other three holes being identical thereof; and,  
FIG. 8 is a sectional view taken along line 8-8 in FIG. 2, which runs through three of the four holes of the credenza, each hole being symmetric about the line 8-8 such that the cross-section of each hole opposite line 8-8 is a mirror image of the cross-section of each hole shown in FIG. 8.  
Where included, broken lines showing environment or structure are for illustrative purposes only and form no part of the claimed design.

**1 Claim, 7 Drawing Sheets**

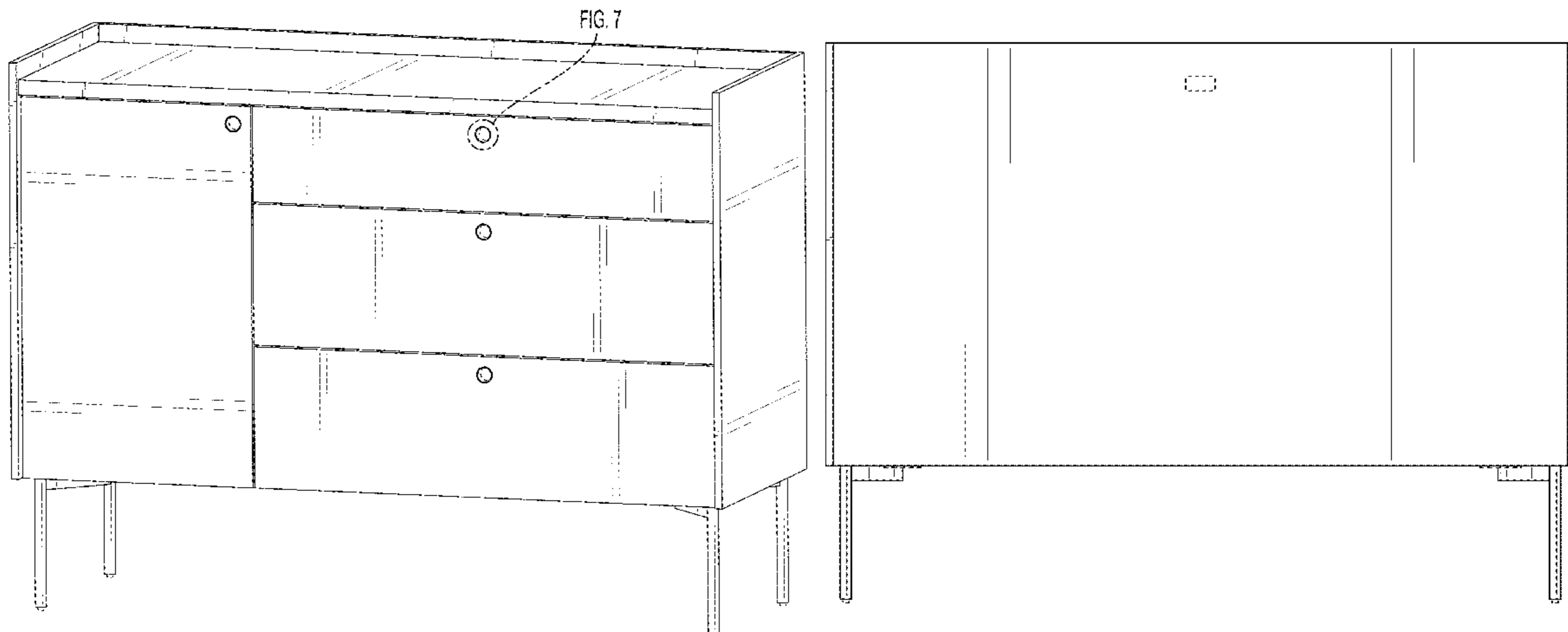

(56)

References Cited

U.S. PATENT DOCUMENTS

2,696,419 A \* 12/1954 Wallace ..... A47B 67/00  
312/265.3

D184,935 S 4/1959 Herrman  
D186,115 S 9/1959 Church  
D188,197 S 6/1960 Swarts  
D193,516 S 9/1962 Deaton  
D193,717 S 10/1962 Deaton  
3,700,300 A \* 10/1972 Davis ..... A47B 47/04  
108/61

D234,386 S 2/1975 Hodges  
3,971,608 A 7/1976 Gans  
D241,213 S \* 8/1976 Fertleman ..... D6/661  
D267,532 S 1/1983 Platner  
D293,521 S 1/1988 Handler et al.  
D304,980 S 12/1989 Bush et al.  
D336,392 S \* 6/1993 Whalen ..... D6/671.1  
D394,171 S 5/1998 De Blaay  
D401,080 S \* 11/1998 Zaidman ..... D6/671  
D401,443 S 11/1998 Zaidman  
D420,230 S 2/2000 Wanek et al.  
D427,453 S 7/2000 Lacroix et al.  
D427,806 S 7/2000 Lacroix et al.  
D439,076 S 3/2001 Mathieu et al.  
D440,430 S 4/2001 Hutton  
D499,274 S 12/2004 Juneau et al.  
D519,750 S 5/2006 Boudreau  
D526,142 S 8/2006 Schmitt  
D526,814 S \* 8/2006 Juneau ..... D6/671.1  
D532,624 S 11/2006 Juneau  
D533,732 S 12/2006 Juneau  
D553,879 S 10/2007 Juneau

D554,893 S 11/2007 Boerner et al.  
D609,496 S 2/2010 Kanthasamy  
D609,497 S 2/2010 Kanthasamy  
D663,136 S 7/2012 Thompson  
D667,653 S 9/2012 Lenney  
D669,704 S 10/2012 Zambelli  
D784,736 S 4/2017 Chen  
D791,516 S 7/2017 Everson et al.  
D812,935 S 3/2018 Hannoosh et al.  
D815,467 S 4/2018 Hannoosh et al.  
D815,468 S 4/2018 Hannoosh et al.  
D818,745 S 5/2018 Hannoosh et al.  
D825,230 S 8/2018 Massaud  
D825,231 S 8/2018 Massaud  
2009/0277715 A1 11/2009 Scharer et al.  
2013/0126452 A1 5/2013 Lo  
2014/0231404 A1 8/2014 Struck

OTHER PUBLICATIONS

Chairish. <https://www.chairish.com/product/1209920/edmond-spence-mid-century-modern-bedroom-dresser>. "Edmond Spence Mid Century Modern Bedroom Dresser". Date unknown: Viewed Apr. 2019 (Year: 2019).\*

Blu Dot Catalog No. 16, Designed in Minneapolis, Minnesota, Copyright 2015, 44 pages.

Blu Dot Catalog No. 17, Designed in Minneapolis, Minnesota, Copyright 2015, 52 pages.

Blu Dot Catalog No. 18, Designed in Minneapolis, Minnesota, Copyright 2015, 51 pages.

Blu Dot Catalog No. 19, Designed in Minneapolis, Minnesota, Copyright 2016, 54 pages.

\* cited by examiner

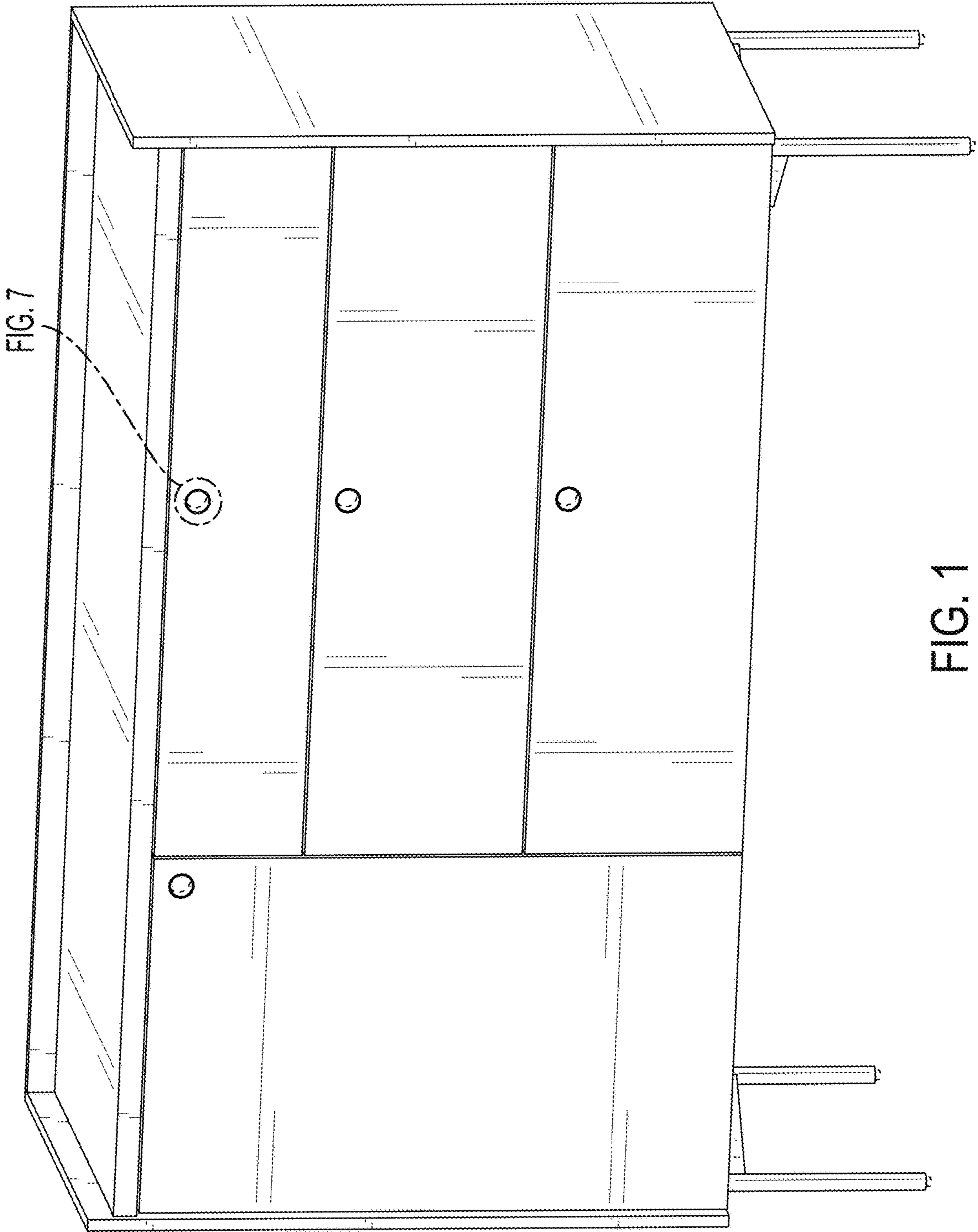

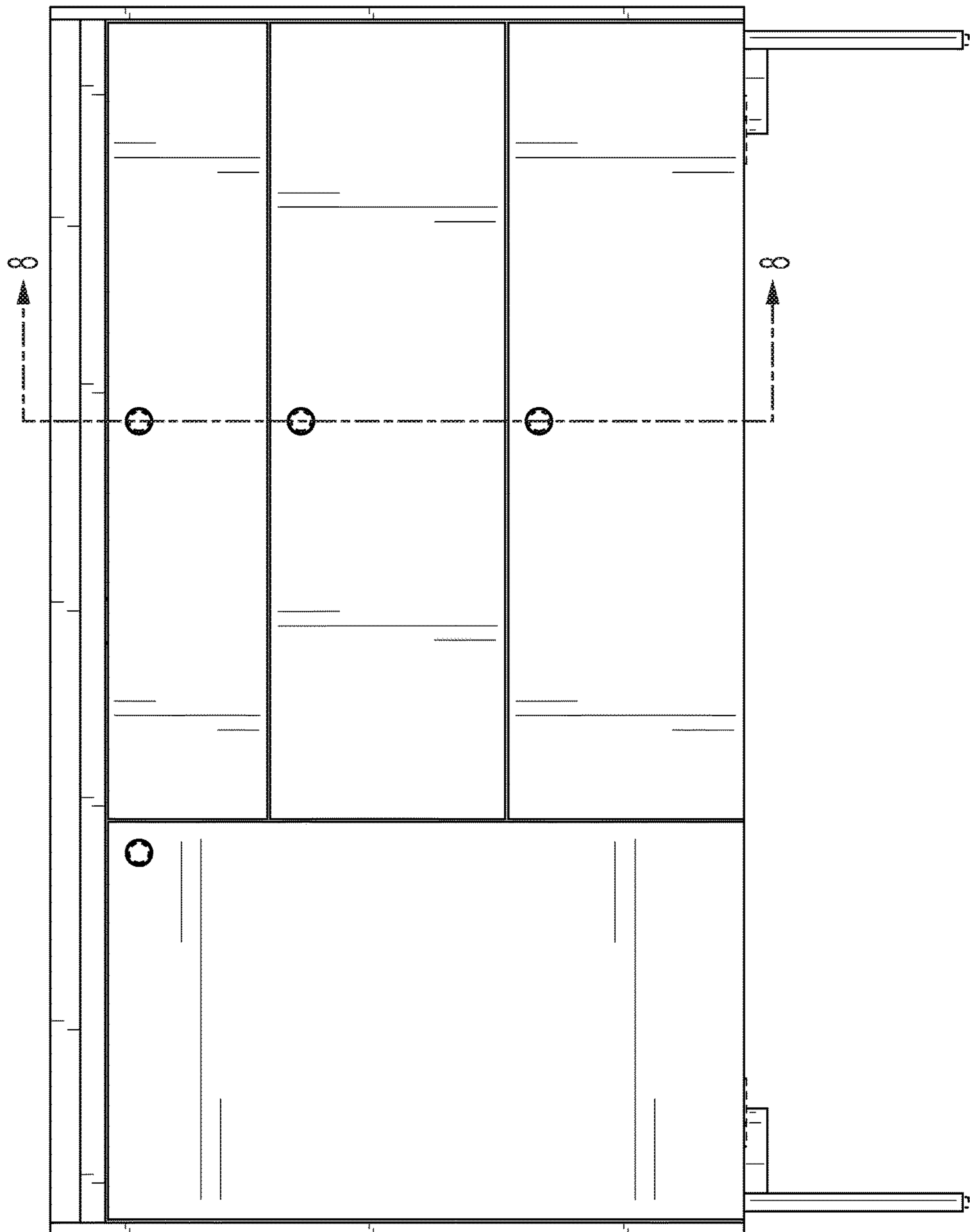

FIG. 2

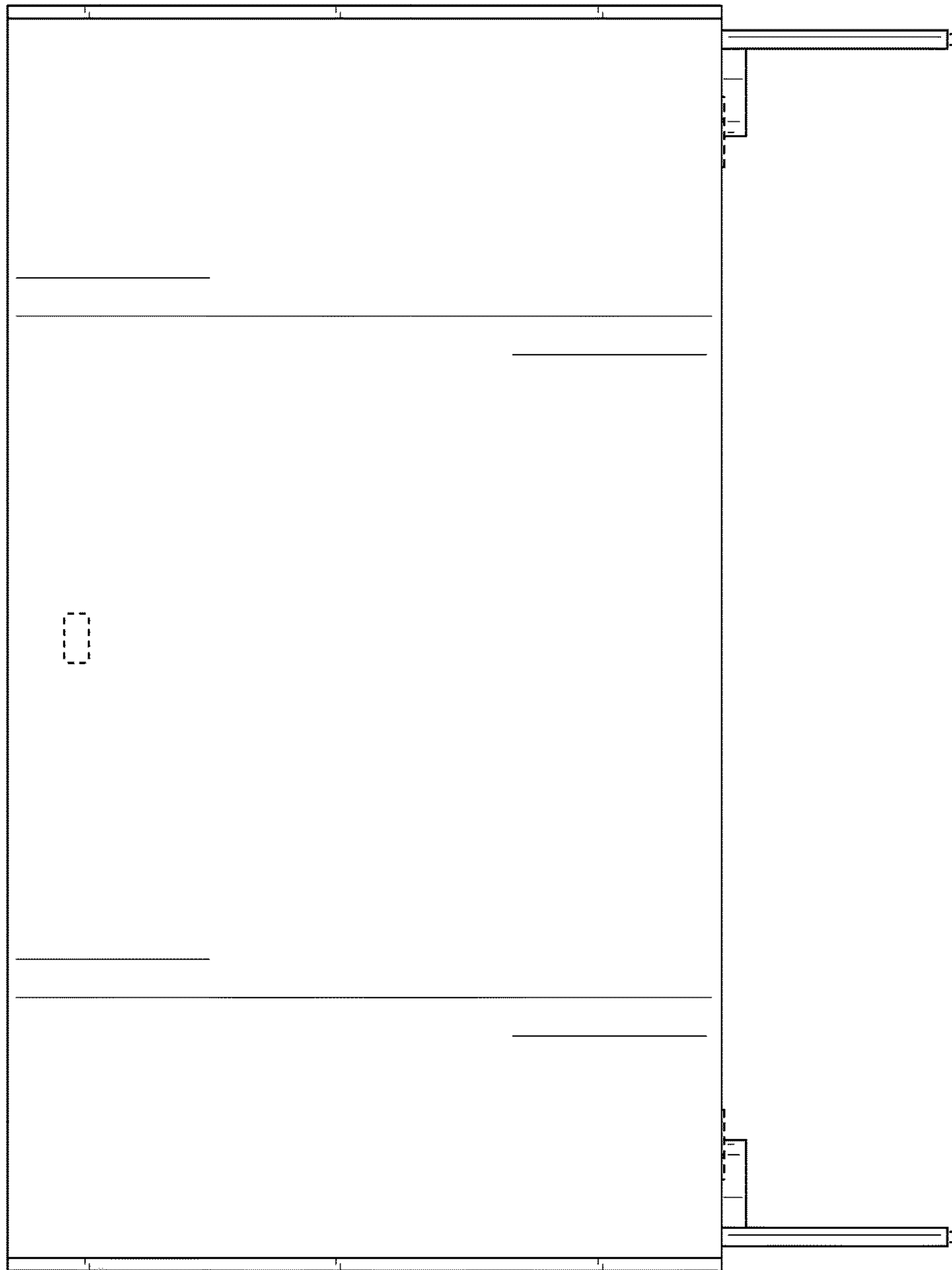

FIG. 3

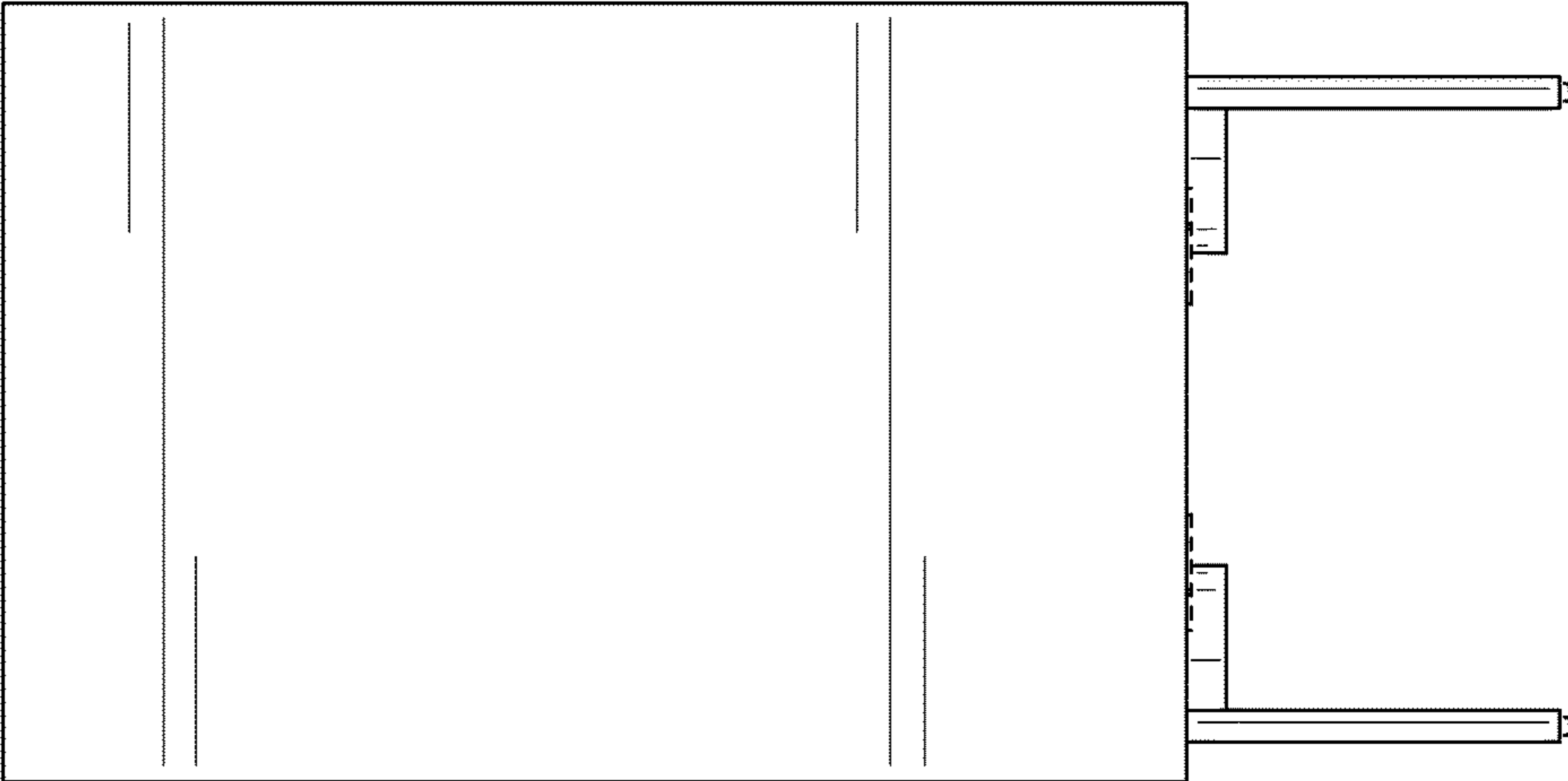

FIG. 4

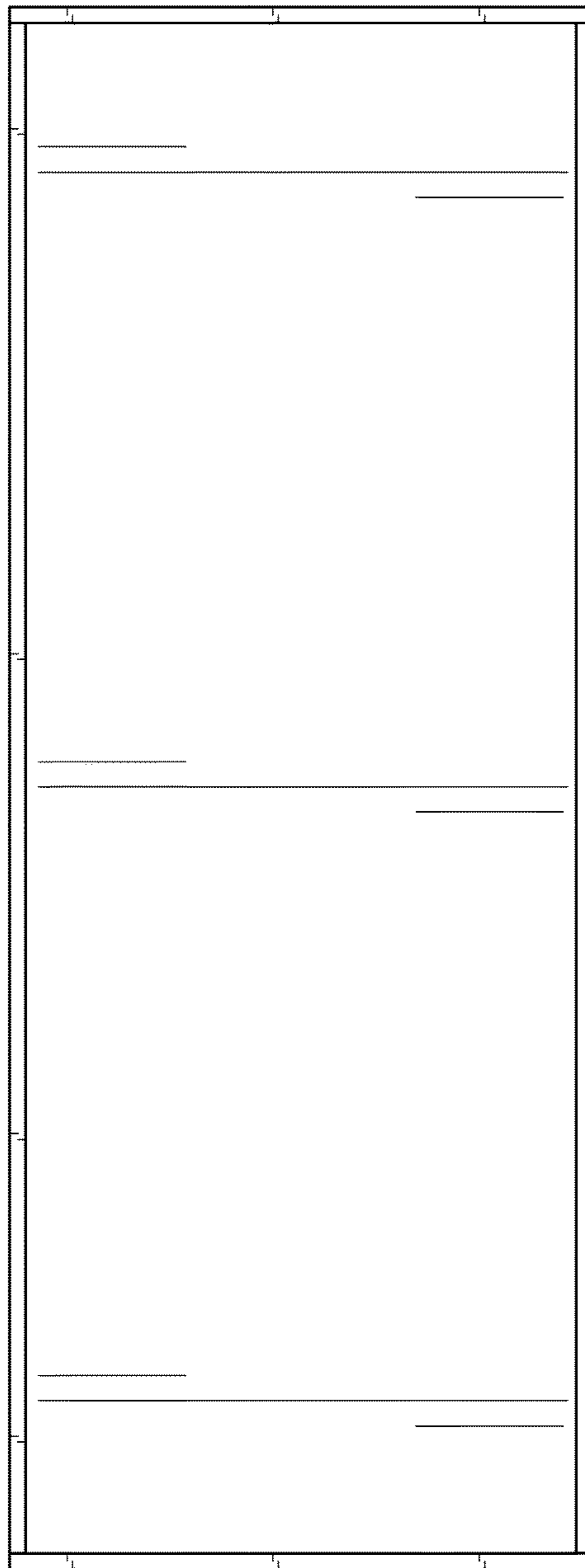

FIG. 5

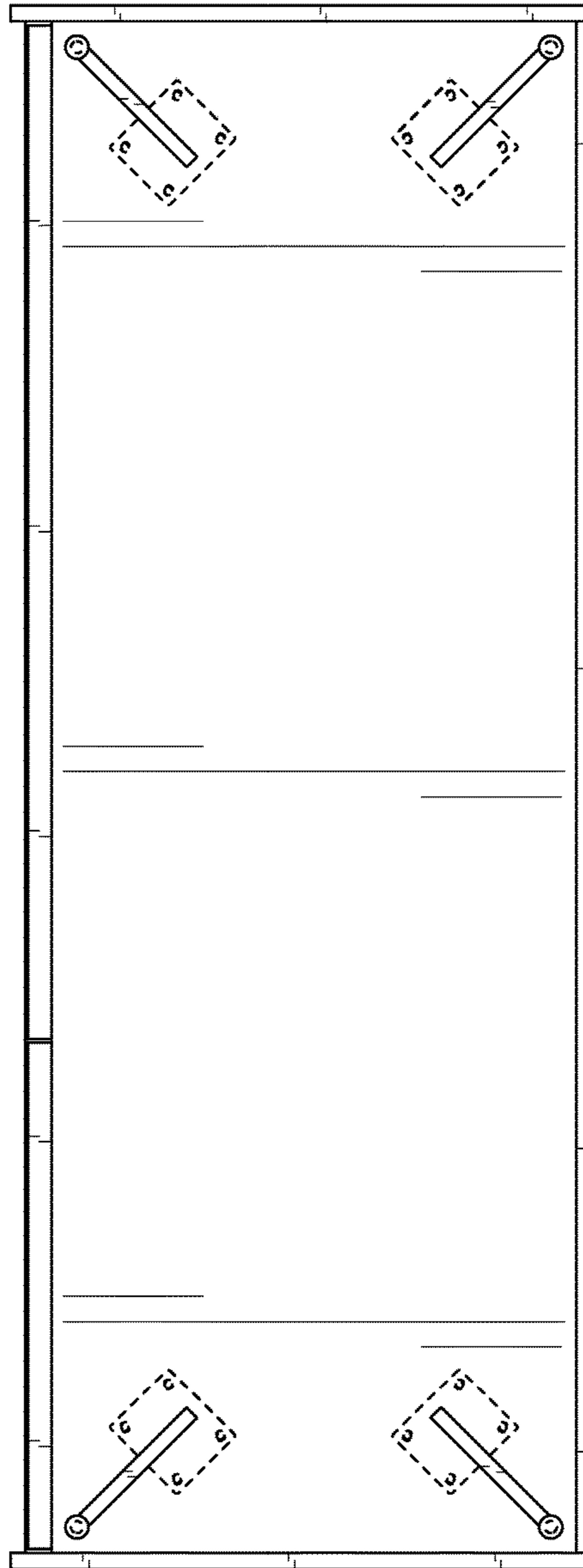

FIG. 6



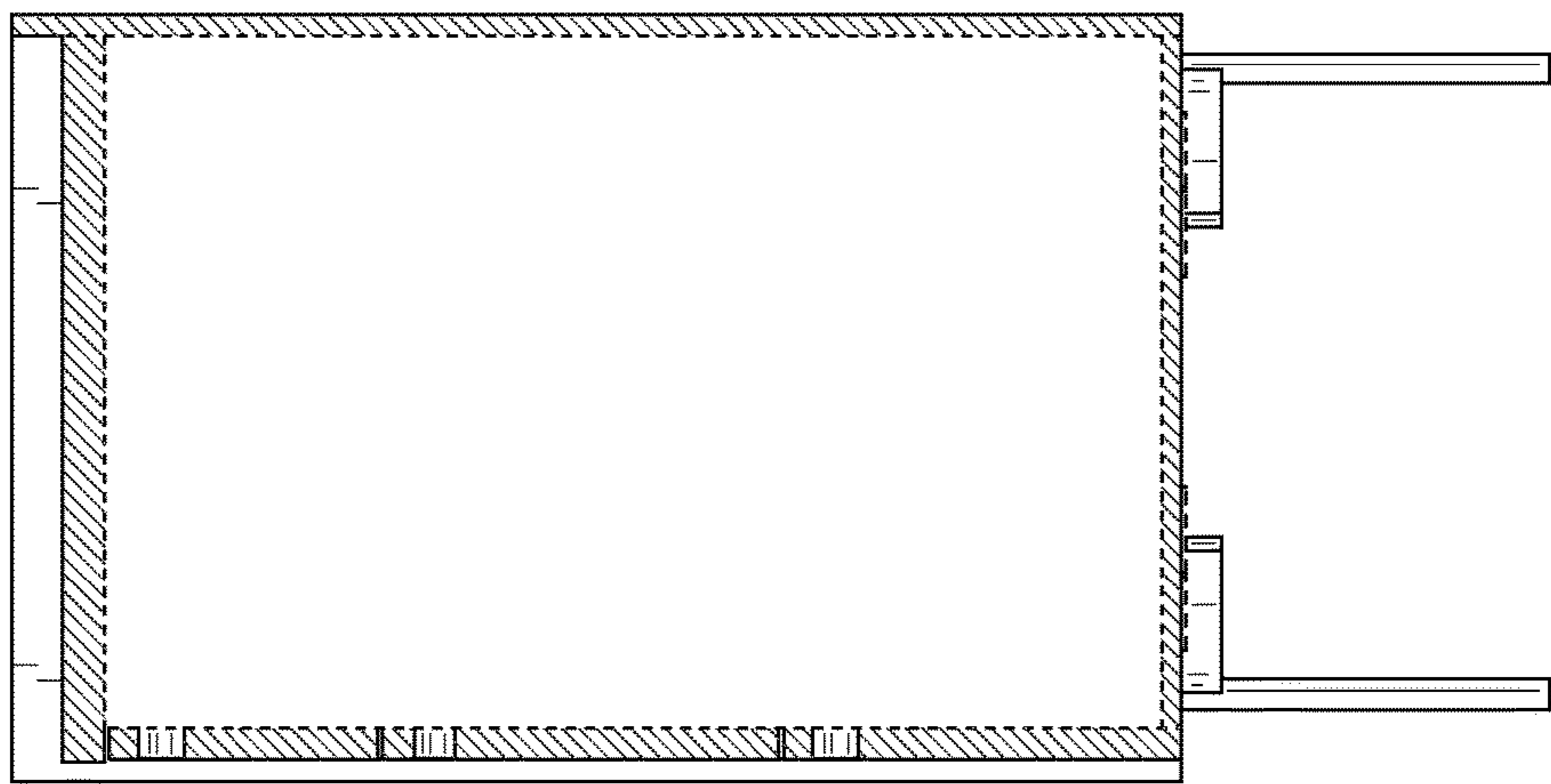

FIG. 8

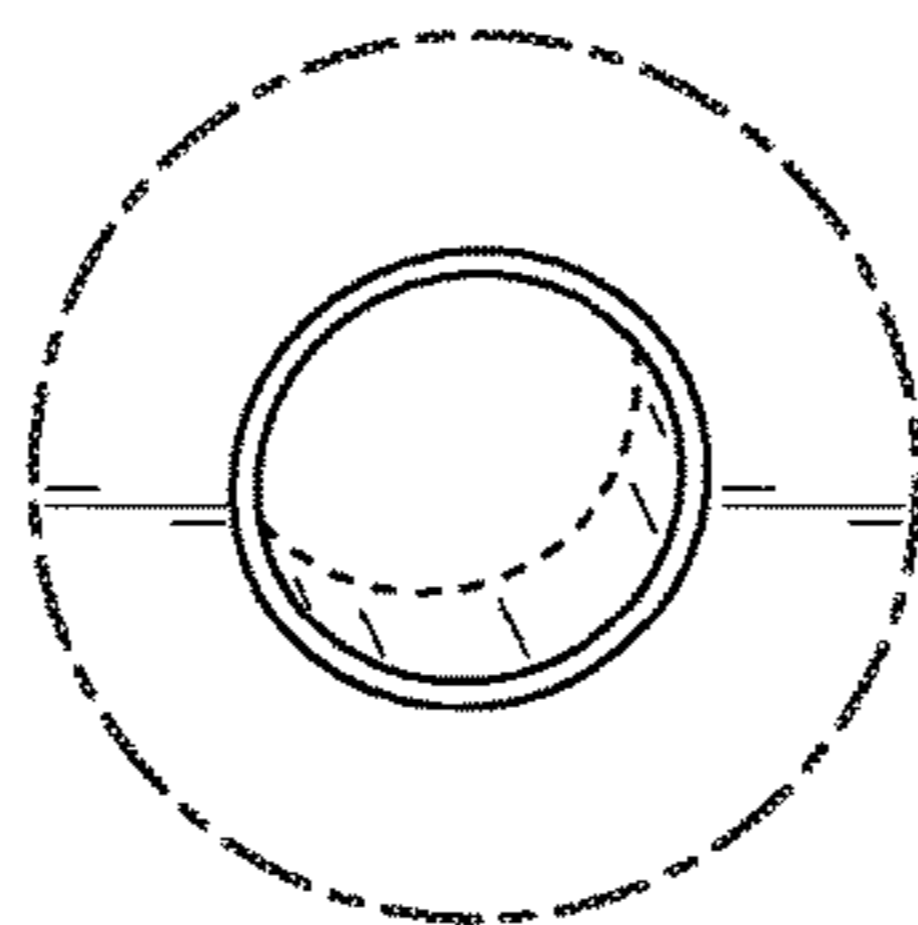

FIG. 7